

TASKING SHEET

SOURCE NO: 179

DATE: 24 Aug 92

SUSPENSE: _____

1. PROJECT NUMBER: 92-93-0-F

2. METHOD/TECHNIQUE: Method of choice.

3. BACKGROUND: Several vessels have been observed
in the [REDACTED]

The vessels are suspected of involvement
in a questionable activity.

4. ESSENTIAL ELEMENTS OF INFORMATION: _____

- Describe the nature of this activity and how it is being accomplished.

- Describe the crew members (their duties functions).

- Describe the national origins of the vessel, the crew.

5. COMMENTS: Additional requirements
may follow at customer's discretion.

SG1A

J

PROJECT: 92-93-0-2

DATE: 25 Aug 92

SG1A

INPUT: 2
(625)

SG1A

I. TASK: Several vessels have been observed in the [REDACTED] [REDACTED]. Describe the nature of their activity at this location; describe crew duties/functions; and determine the national origins of the vessels - the crew.

II RESPONSES:

a. KEY RESPONSES:

1. Vessels appear to be fishing and ~~game~~ ^{hunting} (mammal hunting) of medium-sized mammals.

b. OTHER RESPONSES

1. Fabric is ~~surely~~ involved.
2. Contraband transported by plane & sold on land.

III COMMENT:

- The notion of fishing and game-hunting also surfaced with the other two sources

PROJECT: 92-93-0-F

DATE: 25 Aug 92

INPUT (3)

049

SG1A

I. TASK: Several vessels of interest have been observed in the [REDACTED] Determine and describe the nature and extent of their activities.

II. RESPONSES:

A. KEY RESPONSES:

1. Small vessels go to a freighter
2. Tanks / cylinders are transferred / stored.
3. Crew is Asian & the ship as well.
4. Items taken out of country, possibly animals

B. OTHER RESPONSES:

1. Big ship is a freighter / petro ship.
2. Flat objects are stacked on the ship (objects are organic).
3. Glass bottles observed on their sides
4. Tubes related to activity measure 36" x 48" and 6" x 8"
 - (a) tubes fitted into a wooden container.
 - (b) contain papers, numbers, maps.

III. COMMENTS:

- analytically, the info reflected in II B (a) appears to be the same as that could be germane to the issue at hand.

SESSION INFORMATIONA. TARGET DATA:

Date: 25 Aug 92
 Task/Target Number: 92-93-0-F
 Session Number: 01

B. PERSONNEL DATA:

Source Number: 049
 Monitor Number: NA

C. SESSION DATA:

Session Start Time: ~~10~~ 1004
 Session Stop Time: 1108
 Method Used: CRV
 Distractions/Hunches: Headache/nausea; Puzet sound fish; boats.

D. EVALUATION DATA:

Viewer Confidence (H/M/L): ?
 Evaluator's Estimate: _____

E. SESSION SUMMARY:

Activity involves several small fish; boats going to a large freighter. The freighter is low, narrow & with an appearance of that of a post petro ship rather than a cargo ship. There is a transference of metal cylinders or tanks which is important. These tanks/cylinders are either transferred, or stored, within a 3 sided object or structure (see page 7.) These tanks/cylinders contain a lumpy/chunky material that is used to hold other objects. These objects have a heavy, "finished" ~~shape~~ concept associated with them. Their shape is sharp, definite angles or edges.

One vessel has wooden paneling interior. The interior is a lot nicer than the outside appearance indicates. ~~And~~ Exterior has purposely been left "undept". This vessel has flat objects stacked up which are organic in nature. There are large glass bottles lying on their sides as well.

The interior of a 2d vessel has white painted walls & ceilings which are ~~and~~ chipped and pitted. The location of coffee pot parts or pieces is important ^{In this location;} A row of objects ~~are found~~ ^{are found} clear bags or wrapping containing small dark, hard & roundish; some feel like they are coated with

2)

powder or dust. The bags/sacks are stacked vertically and are about hand-sized. (See page 3 of notes).

Pages 3 & 4 depict another object: its location which are significant to this activity. A blue or green painted tube 36"-40" long and 6"-8" in diameter is fitted into a wooden container with a door that can be secured. The "tube" contains paper; cardboard (papers with numbers; some maps; also something within a rectangular cardboard box, which slips into the center of the tube).

The wooden container is attached to the wall & ceiling in one corner of a specific cabin. The container is painted the same color as the cabin walls. It is less obvious than one would think. Page 4 depicts location and surrounding attributes of the cabin. There are also two blue metal tanks or cylinders which sit vertically and are short & "fat". A brown "doctor's" bag sits in one corner.

A vessel is in dry dock with men walking under & around the ship. A hold on this ship is used for fish "storage". There is a spinning object reminiscent of a wheel or reel is present. A metal trough-shaped object used for wrapping something is significant to this activity.

There is movement straight down along a flat surface. Machine parts & maintenance procedures are significant. The latter feels as if it is used to distract from the actual going-on. It is during these "maintenance procedures" that the previously mentioned transfers of tanks/cylinders occur. The concept of two large "eggs" feel significant to this activity.

There is a strong Asian & specifically oriental feel to the ships & crew. Phillipino's and an Arctic coast cultural type are present.

* Significant objects are being taken out of

this country.

3)
There are objects which are tightly wrapped. Their appearance is reminiscent of some sort of animal tightly bound into a fetal position; then wrapped w/ a heavy, light colored crinkly material.

There are also fables with wheels present on the "receiving" vessel (?).

SESSION INFORMATION

- A. TARGET DATA:
Date: 25 August 92
Task/Target Number: 92-93-0-F
Session Number: 1
- B. PERSONNEL DATA:
Source Number: 025
Monitor Number: N/A
- C. SESSION DATA:
Session Start Time: 10:00
Session Stop Time: 12:00
Method Used: ERN
Distractions/Hunches: N/A
- D. EVALUATION DATA:
Viewer Confidence (H/M/L): N/A
Evaluator's Estimate: _____
- E. SESSION SUMMARY:

92-93-0-F
025
25 August 92

The vessels observed in the

SG1A



SG1A

one game hunting/
fishing and gathering. Some
men aboard these vessels are
targeting animals for profit to
be sold on land. A questionable
activity occurring in the area
is hunting and killing medium
sized mammals, which are active while
in water, possibly for their
skins. They are valuable, live,
warm blooded creatures.

Black poles or posts and
^(round) wooden barrels are somehow
relevant to the vessels. Some
items are towed in from the

water. Fabric or clothing
is instrumental at this site.

Items gathered at this location
are, at some points, transported
by plane and sold on land for
people.

049
25 Aug 92
P: 92-93-0-F
S: 01
ST: 1004
ET: 1108

927 937 925 935

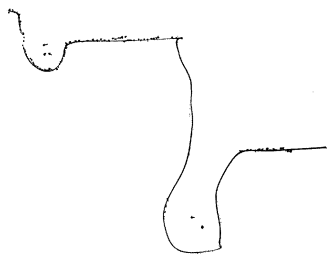

A - across, curve down,
loop up, straight forward,
small loop, wavy down,
curve forward, angle up,
wavy up, curve forward
hard
natural
B - rocks

A - hard
manmade
B - structure

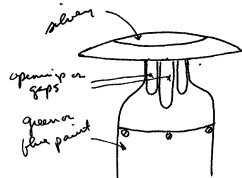

sits on top of a smooth
surface reminiscent of a
floor or roof area.

pieces

- row of clean bags or wrappings;
hole of small objects reminiscent
of small stones or pebbles

A/S
Rocks
best
approx
hard

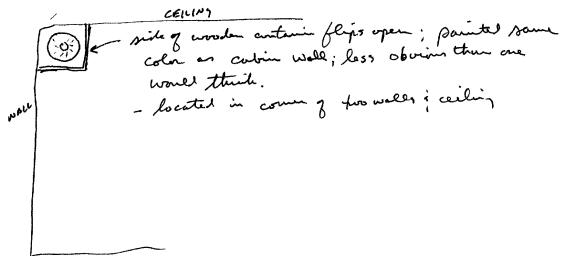

- spinning, over wheel a reel
- movement straight forward
also, flat surface
- machine parts
- maintenance procedures
- several small fish; boats
go to one large freighter
- freighter is low; narrow; almost
looks like a patrol ship
rather than cargo ship.
- transfer of metal cylinders,
or tanks is important

[what is in these cylinders or
tanks?]

* lumpy
chunky } this is used
to hold other objects

from
boat

7)

- heavy, "finished" concept,
sharp, definite angles
or edges

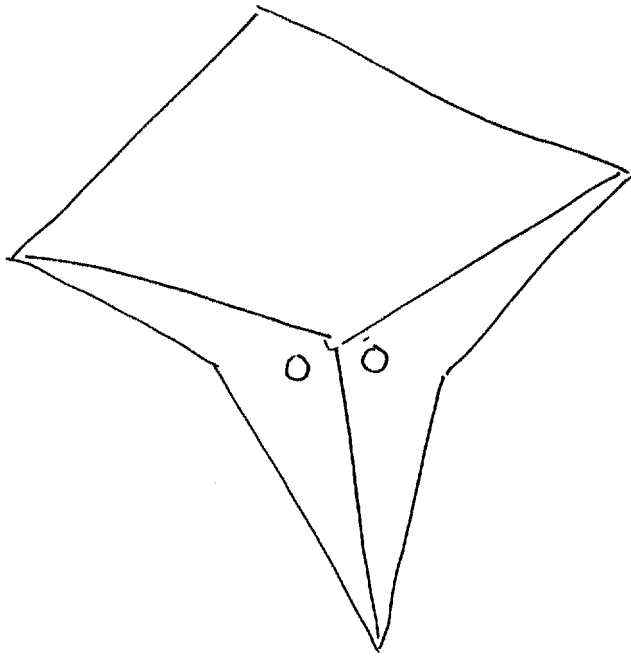

A/S
metal object
A/C
Machine part

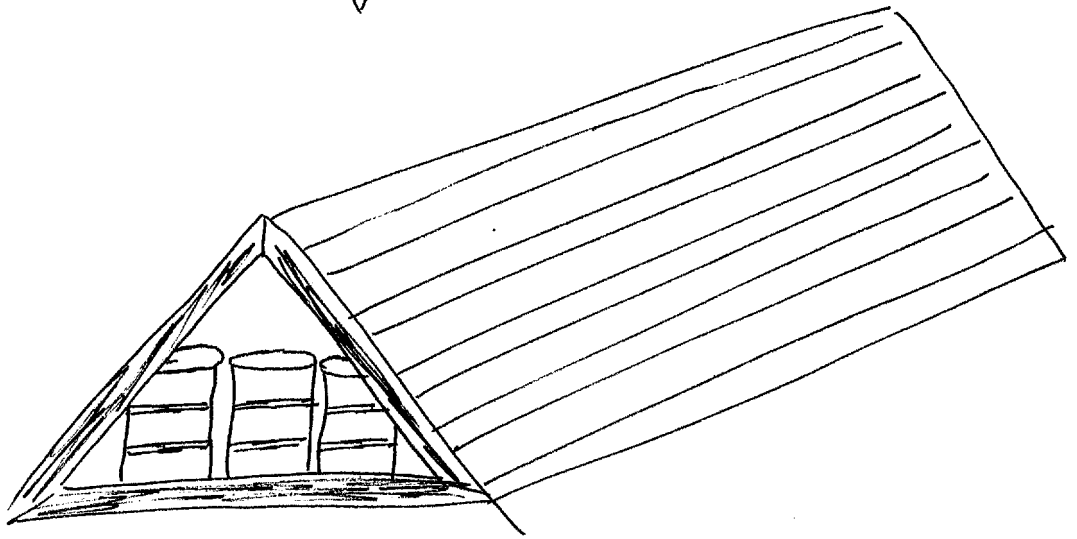

cylinders & cylinders are either transferred,
or storage stored, within a structure
a object shaped like this.

Two Large Eggs ?

A I B K
why eggs ?

8)
B AI EI T L AOC ALS

{ 927 937 }
{ 925 935 }

[What is nature of activity? what is going on?]

Tables
Tables w/ wheels

ALS
Hospital gurneys.

meat
animal
chicken
bird
feathers

AI BK
Makes no sense.

Phillipino
Atri coastal type

AOL
Eskimo

wrapped up tightly

ALS
Some sort of animal
tightly bound into
a fetal position;
then wrapped w/
heavy, light
colored crinkly
stuff.

Impression is that objects
are being taken out of this
country.

ET: 1/08

Source: 025

7 ASKING SHEET

Date: 25 Aug 92

1. Project Number: 92-93-0-F

2. Method of choice

SG1A SG1A

SG1A

3. BACKGROUND: Several vessels have been observed in the [REDACTED]

[REDACTED] Vessels are suspected of involvement in a questionable activity.

4. Essential Elements of Information:

- Describe the nature of the activity and how it is being accomplished.
- Describe the crew - address duties, functions -
- Determine the national origins of the vessels - the crew

5. COMMENTS:

- Additional requirements may follow.

TASKING SHEET

SOURCE NO: 049

DATE: 25 Aug 92

SUSPENSE: _____

1. PROJECT NUMBER: 92-93-U-F

2. METHOD/TECHNIQUE: Method of choice.

SG1A

3. BACKGROUND: Several vessels have been observed in the



The vessels are suspected of involvement in a questionable activity.

4. ESSENTIAL ELEMENTS OF INFORMATION:

- Describe the nature of this activity and how it is being accomplished.

- Describe the crew members (their duties/ functions).

- Describe the national origins of the vessel, the crew.

5. COMMENTS: Additional requirements may follow at customer's discretion.

Coordinates : 927 937
 925 935



~~92-93-0-F~~

92-93-0-F

079

92-93-0-F
DATE : 24 Aug 92
INPUT : 7
079

SG1A

I TASK: Several vessels have been observed the
[REDACTED] The
vessels are suspected of involvement in a questionable
activity. Describe the nature of the activity, the
crew members and the national origin(s) of the crew.

II. RESPONSES:

A. KEY RESPONSES

1. VESSELS APPEARED involved in innocuous
fishing related activity

B. OTHER. The expression "SSS's" appeared
associated with the activity / vessel.

III. COMMENTS:

- NO INTENTION TO PURSUE THIS ISSUE FURTHER

SESSION INFORMATION

- A. TARGET DATA:
Date: 24 Aug 92
Task/Target Number: 92 93 0 F
Session Number: 01
- B. PERSONNEL DATA:
Source Number: 079
Monitor Number: 072
- C. SESSION DATA:
Session Start Time: 930
Session Stop Time: 1100
Method Used: WRV
Distractions/Hunches: _____
- D. EVALUATION DATA:
Viewer Confidence (H/M/L): _____
Evaluator's Estimate: _____
- E. SESSION SUMMARY:

*See Summary reverse side
of tasking sheet.*

I. PROJECT NO: 92-93-0-F
(Source 079/Input 1)

II. DATE INITIATED: 24 August 1992

III. BACKGROUND (TO MONITOR):

IV: BACKGROUND (TO SOURCE):

SG1A

SG1A V: TASK: Several vessels have been observed in the [REDACTED] [REDACTED]. The vessels are suspected of involvement in a questionable activity. Describe the nature of the activity, the crew members and the national origin(s) of the crew.

VI: RESPONSES:

A. Key:

1. Vessels appeared involved in innocuous fishing related activity.

B. Other:

1. The expression "SSS" appeared associated with the activity/vessel.

VII. COMMENTS:

- A. No intention to pursue this issue further.

I. PROJECT NO: 92-93-0-F
(Source 049/Input 3)

II. DATE INITIATED: 25 August 1992

III. BACKGROUND (TO MONITOR):

IV: BACKGROUND (TO SOURCE):

SG1A

SG1A

V: TASK: Several vessels have been observed in the [REDACTED] Determine and describe the nature and extent of their activities.

VI: RESPONSES:

A. Key:

1. Small vessels go to a freighter.
2. Tanks/cylinders are transferred/stored.
3. Crew is Asian/the ship as well.
4. Items taken out of country, possibly animals.

B. Other:

1. Big ship is a freighter/petro ship.
2. Flat objects are stacked on the ship (objects are organic).
3. Glass bottles observed on their side.
4. Tubes related to activity measure 36"-48" and 6" X 8'.
 1. Tubes fitted into a wooden container.
 2. Contains papers, numbers, maps.

VII. COMMENTS:

I. PROJECT NO: 92-93-0-F
(Source 025/Input 2)

II. DATE INITIATED: 25 August 1992

III. BACKGROUND (TO MONITOR):

IV: BACKGROUND (TO SOURCE):

SG1A

SG1A V: TASK: Several vessels have been observed in the [REDACTED] [REDACTED] Describe the nature of their activity at this location; describe crew, duties, and functions; and determine the national origins of the vessels and the crew.

VI: RESPONSES:

A. Key:

1. Vessels appear to be fishing and hunting of medium-size mammals.

B. Other:

1. Fabric is involved.

2. Contraband transported by plane and sold on land.

VII. COMMENTS:

A. The notion of fishing and game-hunting also surfaced with the other two sources.

DATE : 24 Aug 92
INPUT : 7
079

SG1A

SG1A

TASK: Several vessels have been observed the
[REDACTED] The
vessels are suspected of involvement in a questionable
activity. Describe the nature of the activity, the
crew members and the national origin(s) of the crew.

II. RESPONSES:

A. KEY RESPONSES

1. VESSELS APPEARED involved in innocuous
fishing related activity

B. OTHER. The expression "SSS's" appeared
associated with the activity / vessel.

III. COMMENTS:

- NO INTENTION TO PURSUE THIS ISSUE FURTHER

Source: 025

TASKING SHEET

Date: 25 Aug 92

1. Project Number: 92-93-0-F

2. Method of choice

SG1A

SG1A

3. BACKGROUND: Several vessels have been observed in the [REDACTED]

[REDACTED] Vessels are suspected of involvement in a questionable activity.

4. Essential Elements of Information:

- Describe the nature of the activity and how it is being accomplished.

- Describe the crew - address duties, functions -

- Determine the national origins of the vessels - the crew

5. COMMENTS:

- Additional requirements may follow.

PROJECT: 92-93-0-L

DATE: 25 Aug 92

INPUT: 2

(025)

SG1A

SG1A

I. TASK: Several vessels have been observed in the [redacted]

[redacted] Describe the nature of their activity at this location; describe crew-duties-functions; and determine the national origins of the vessels - the crew.

II RESPONSES:

a. Key Responses:

1. Vessels appear to be fishing and ^{hunting} ~~game (mammal hunting)~~ of medium-sized mammals. I

b. Other Responses

1. Fabric is ~~suspected~~ involved.
2. Contraband transported by plane & sold on land.

III COMMENT:

- The notion of fishing and game-hunting also surfaced with the other two sources

PROJECT: 92-93-0-F

DATE: 25 Aug 92

INPUT (3)

049

SG1A

I. TASK: Several vessels of interest have been observed in the [redacted] Determine and describe the nature and extent of their activities.

II. RESPONSES:

A. KEY RESPONSES:

- 1. Small vessels go to a freighter - C
- 2. Tanks / cylinders are transferred / stored.
- 3. Crew is Asian & the ship as well: C
- 4. Items taken out of country, possibly animals P

B. OTHER RESPONSES:

- 1. Big ship is a freighter / petro ship. C
- 2. Flat objects are stacked on the ship (objects are organic).
- 3. Glass bottles observed on their side
- 4. Tubes related to activity measure 36"-48" and 6" x 8"
 - (a) tubes fitted into a wooden container.
 - (b) contain papers, numbers, maps.

III COMMENTS:

- analytically, the info reflected in II B & C appears to be the data that

2)

powder or dust. The bags/supplies are stacked vertically and are about hand-sized. (See page 3 of notes).

Pages 3 & 4 depict another object & its location which are significant to this activity. A blue or green painted tube 36"-40" long and 6"-8" in diameter is fitted into a wooden container with a door that can be secured. The "tube" contains papers & cardboard (papers with numbers; some maps; also something within a rectangular cardboard box, which slips into the center of the tube).

The wooden container is attached to the wall & ceiling in one corner of a specific cabin. The container is painted the same color as the cabin walls. It is less obvious than one would think. Page 4 depicts location and surrounding attributes of the cabin. There are also two blue metal tanks or cylinders which sit vertically and are short & "fat". A brown "doctor's" bag sits in one corner.

A vessel is in dry dock with men walking under & around the ship. A hold on this ship is used for fish "storage". There is a spinning object reminiscent of a wheel or reel is present. A metal trough-shaped object used for wrapping something is significant to this activity.

There is movement straight down along a flat surface. Machine parts & maintenance procedures are significant. The latter feels as if it is used to detract from the actual going-on. It is during these "maintenance procedures" that the previously mentioned transfer of tanks/cylinders occur. The concept of two large "eggs" feel significant to this activity.

There is a strong Asian & specifically oriental feel to the ships & crew. Phillipino's and an Ati coast cultural type are present.

* Approved For Release 2000/08/10 : CIA-RDP96-00751R0001002500017
* Definite impression that objects being taken out of

3)

Approved For Release 2000/08/10 : CIA-RDP96-00791R000100280001-7
There are objects which are tightly wrapped. Their appearance is reminiscent of some sort of animal tightly bound into a fetal position; then wrapped w/ a heavy, light colored ~~crinkly~~ crinkly material.

There are also fables with wheels present on the "receiving" vessel (?).