

Paul
15 Sep 87
F. W. W. W. W.
Gene
1013

SUI

52.

D

H

#1

T

L

APOL

#15

rounded
angles
flat

Shiny
grey
white
red

5x1/2 contoured surface

rough
grainy

flat
slippery

glass

segmented
lined

high
width
circumscribed

oblong
square
indented

project
surrounded

large

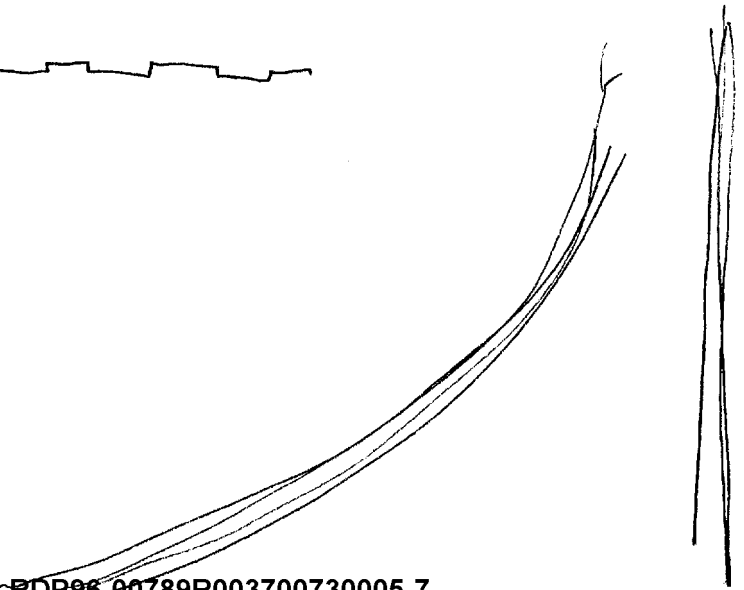
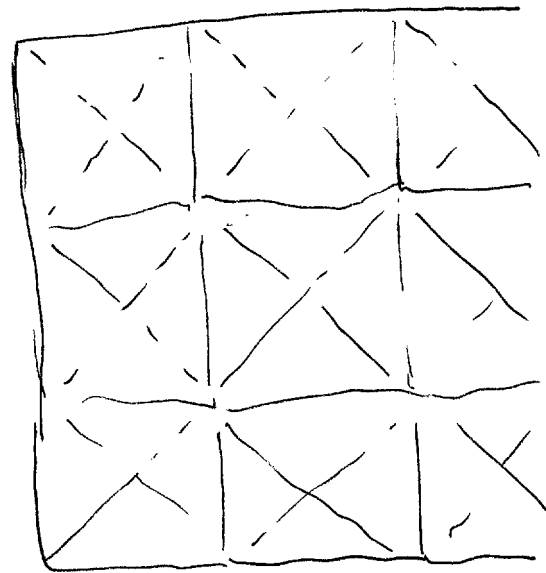
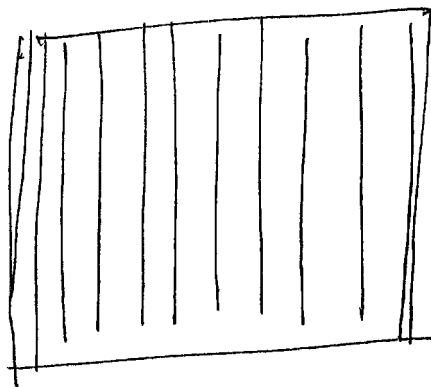

Flat
geese
rough
surface
with
blacks

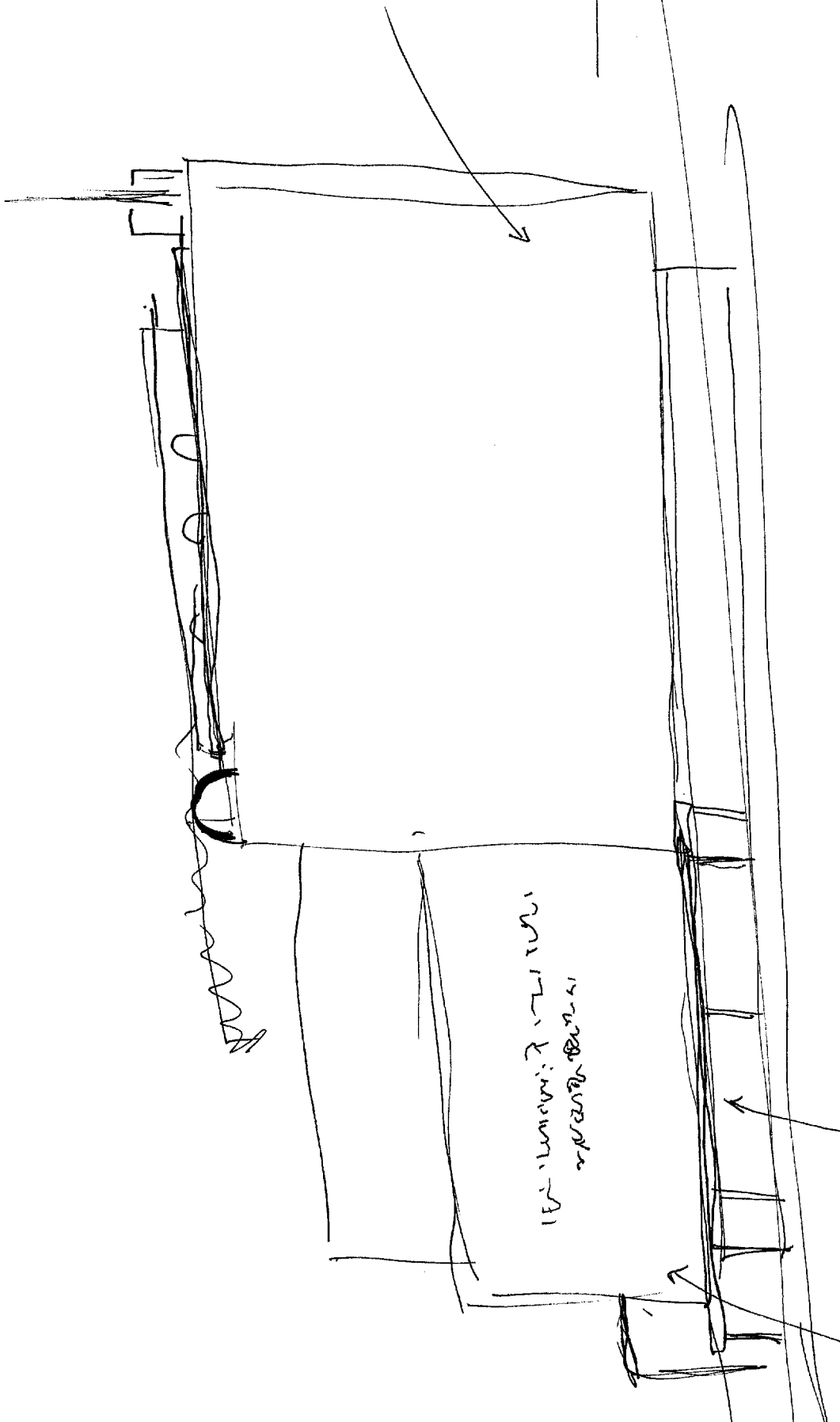

1st... 2nd...

underground
Glory

Handwritten notes at the bottom right, including '15 Sept 80' and other illegible scribbles.

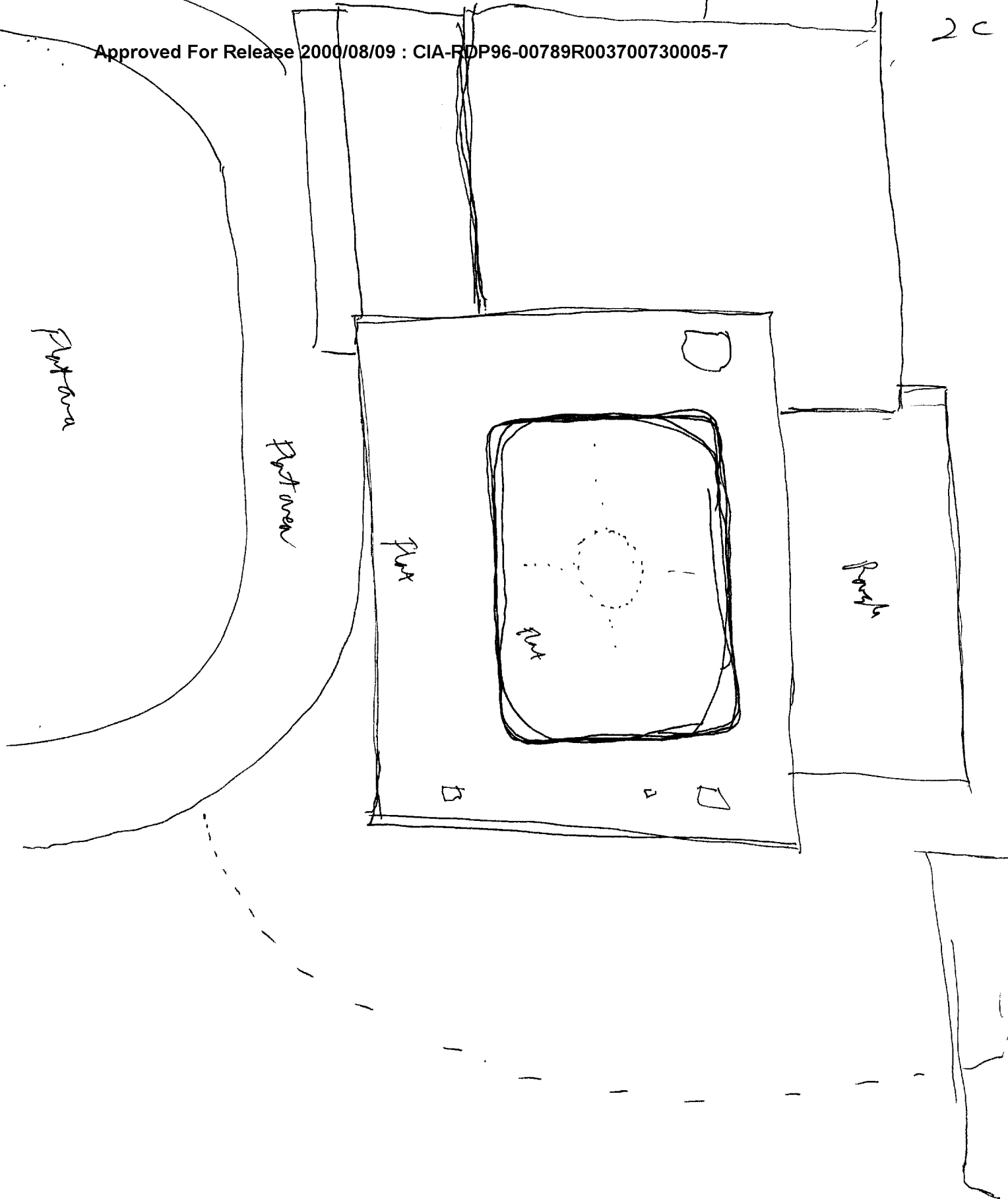

003
15 Sep 87

507

3

S2

D

A2

E1

T

I

DL

HL3

Portals
divisions
Complex
Connects
Space

Lines
Sprawling

Corrugations
Patterned
~~for~~

Diverse

extended

Slippery
curved
dry

God
breezy
slintily

54/2 non standard design "like" Modern wants grade architect turned loose
on structure. Grey, angles, design, aesthetics involved.
Appearance intended to "gift up" purpose of
structure.

ADL BK
DIAC

SKI

4

S2

D

A2

#1

T

I

APL HKS

bumpy
surrounds

decorative

no/s
freeze
letters

Patterned
underneath

Glass

attachments

to

Structural

arranges

Departments

S1/2

separate agencies/artists files
connection to each other

w/ ~~was~~ some

rough

gravelly

S1/2 "like" gravelled roof

warm
gold
shiny

SZ

B

AJ

S U I
B Z

T

I

5
AOL AB

tan
Sketchy
round

object

like
flag pole
or
thin
antenna

glass
doors

bars,

people

In-and-out

slit in
walkway

traces
shadows
frank

5 + 1/2 impressions of raised concrete object - "like"
planters or

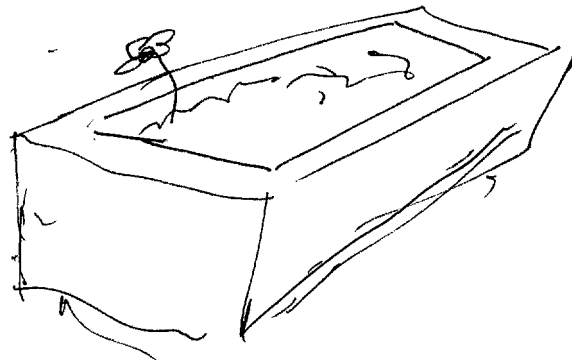

image making
and function

S V I

6

S2

D

A2

F I

T

I

AUL

Als

R C O L S P I M E

polytechnic

[Handwritten cursive scribbles]

Self: frieze/letter seems to be script or flowing a
derivative with meaning

M L I R Y O

prefecture
of

5 1/2 at least 3 words, no more than 5. But some are

SVI

#OL HCS 7

faudr

faudr

Slur
Smooth
Slide
Grainy
Polished
Grey
Speckled

AI Bb
Pleasing
to touch

polished
marble

1045