

~~SECRET~~



DEFENSE INTELLIGENCE AGENCY
WASHINGTON, D.C. 20301-6111

DT-S

30 Sep 87

MEMORANDUM FOR THE ASSISTANT DEPUTY DIRECTOR FOR SCIENTIFIC AND
TECHNICAL INTELLIGENCE

SUBJECT: SUN STREAK Operational Report - PROJECT N-1 (U)

1. (S/NF/SK) During the period of 16 August 1987 to 29 September 1987 inclusively, four remote viewers conducted eleven (11) sessions to determine their ability to identify the substantial content of a document. As an ancillary mission, the remote viewers were tasked to provide sufficient descriptive data of manmade and natural geographical features that would allow for an analytical determination to be made of the exact location of the target site. In this instance, the document was stored in a container located in a cubicle in the area known as DT-5 of the Defense Intelligence Analysis Center (DIAC).

a. (S/NF/SK) Viewer 003 described the target site as a large, flat-sided building with a predominance of structures that were square, rectangular, and brownish-green in appearance. The structure was perceived as a government building with established visitor control points. Viewer 003 stated, "The setting reminds one of the DIAC." The cover of the target document had a red background, odd-shaped yellow and black lettering, and a border. The document date was perceived as being 17 February 1987. The word "organization" appeared in the title; and, the letters "L, I, N, E, seemed identifiable. A listing of numbers in rows with codes reminiscent of a series of BE numbers, was associated with the content. The subject matter dealt alternately with arms control, technical aspects of weaponry, engineering constraints, design capabilities and strategic considerations. Appendices and tabs were part of the document. The first section of the document provided guidance, outlined responsibilities and

WARNING NOTICE: SENSITIVE
INTELLIGENCE SOURCES AND
METHODS INVOLVED

HANDLE VIA SKEET CHANNELS ONLY
SPECIAL ACCESS REQUIRED

CLASSIFIED BY: DIA, DT
DECLASSIFY BY: OADR

~~SECRET~~

~~SECRET~~

emphasized the need for safeguarding the information contained therein. Access was granted to select groups of personnel having divergent occupational (professional) responsibilities. The document was a synthesis of data compiled from various outside sources. It identified organizational tasks, "like an OB (Order of Battle) list," and outlined assets, quantities, limits and purposes. The document was arranged in about five groupings based on "type" starting "with the least capable" and ending with "the most capable." The concept of weaponry seemed to be a dominant theme in the document. The related use of large vehicles was also substantially associated with the document. Viewer 003's post-session summaries are at TAB A. Viewer 003's conceptual drawings of the target site are at TAB B.

b. (S/NF/SK) Viewer 011 described the target site as being located on the upper level, second or third floor, of an office area characterized by the presence of "cubicles, desks, work areas" in a building "like Building 213 (located at the US Navy Yard) or the DIAC." The cover of the document was reddish-brown with a black border. Substantially, the document dealt with symbols associated with mathematical concepts and formulas along with listings related to strategic arms and targets. It had the conceptual flavor of a computer printout. The document was viewed as controversial in that it caused misunderstanding between the scientific elements and the political elements of an organization. There appeared to be two distinct parts to the document. The first portion was theoretical in nature while the second part provided mathematical justification in support of the theory. Basically, the document dealt with a material designed to trap energy. The concepts of a crystal structure, use of frequencies, perceptions of vibrations and scattering all appeared germane to the basic tenor of the document. There was evidence of a surface material bonded by a crystal structure acting in the manner of a two-way mirror used to absorb and scatter energy (throughout the material) through the use of "rod-like inclusions." A gray, smooth, shiny, long, round, metallic, cylindrical object is functionally associated with the theory espoused by the document. Viewer 011's post-session summaries are at TAB C. Viewer 011's conceptual drawings of the target site and document content are at TAB D.

c. (S/NF/SK) Viewer 018 described the target site as a large, "walled-in", building resembling an art gallery replete with drawings and pictures on a wall. Well-dressed persons were observed milling about; and furniture was located in the middle of the room. The notion that the document was directly related to biological warfare persisted throughout both sessions conducted by 018. The document had a maroon cover and it was dated 8 April of an undetermined year. The document was substantially related to the effects of a high altitude burst of defoliants sent aloft by a missile. Imagery of wilted vegetation, the presence of a black, microscopic crystal (formed) material that was greasy to the touch, seemed persistently associated with the concept of a biological warfare scenario.

~~SECRET~~

~~SECRET~~

Incongruously, within this somewhat dismal scenario, the presence of pastoral green fields, rolling hills and brooks seemed conceptually and substantially associated with the document. Viewer 018's post-session summaries are at TAB E.

d. (S/NF/SK) Viewer 079 described the target site as a dark, glassy, curvy, modern-appearing structure located in a setting of low rolling hills amid interspersed fences and parking areas. The reception area within the building had long hallways, high ceilings, and displayed historical, representational paintings executed against a predominantly blue-colored background. The document was maintained in a second area characterized by much lower ceilings. Work of a scientific nature was conducted in this second area, the actual target site. The document was kept hidden (stored) in "a regular place - as if someone could forget (overlook the fact) it was there." It was sealed with a special gold seal. The document was brown and black in appearance and it was dated "1982." Substantially the document dealt with such concepts as energy, phases of implementation, and the notion of suspense dates and required responses. Small circles and black print were noted on the cover. Efforts to identify the document by its title resulted in the surfacing of the following letters: A. R. M. T.S. H. The classification was perceived as, "S.N.F. - Code Word." Letters related to the Code Word appeared as being "S. H. O. P. P.R. E.." In a second and subsequent session, Viewer 079 described the essence of the document as being directly related to the capture and storage of "light and energy" in "very small cubes" (crystals). Two principles appeared to be involved, the first was described as an "eye to eye principle" and that of transparency with a "reversing" effect. (Note - Viewer insisted on the use of the word "reversing" as opposed to "reflecting"). Viewer 079's post-session summaries are at TAB F.

2. (S/NF/SK) COMMENTS: All four viewers appeared to quickly and readily access the DIAC as the target site where the document was stored. It seemed as if the viewers benefitted from an experiential factor that seemed to facilitate this access. Suggest target storage sites other than the DIAC be considered in subsequent projects of this nature.

SG1J

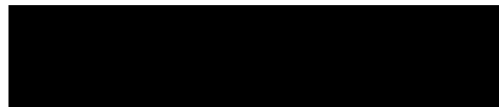

6 ENCLOSURES

- TAB A - SUMMARY-003
- TAB B - DRAWINGS-003
- TAB C - SUMMARY-011
- TAB D - DRAWINGS-011
- TAB E - SUMMARY-018
- TAB F - SUMMARY-079

LTC, USA
Branch Chief

~~SECRET~~

TAB

Site involves a large, flat-sided structure with glass doors in front, with the front and center portions lower than the side. Squares and rectangles are the primary dimensional elements of the structure. Brownish green is a predominant color at the site. It is sunny, warm, and the whole area evinces a definite man-made, man controlled ambience. Large flat areas--perhaps parking lots and roads--are ubiquitous. Lots of cars and people are present. The structure of interest is administered by some large, widely spread organization, "like" a government or similar establishment. Inside the building the first thing encountered is a large open area with a bar or desk behind which certain people sit to screen those who enter, to determine where they want to go and what their purpose is, or even if they are supposed to be there. It's essentially some sort of reception area. Beyond this are several different directions one could go, through various doors or down a hall with doors opening off of it. Seems to be a white or very light grey color. Someone in the hall is wearing what appears to be a white coat.

[Interviewer tasking] The document of importance needs to be safeguarded, restricted to only limited access by a select group of people--not all of the same occupation, associations, or responsibilities, but all of whom share similar common responsibilities designated by and for the document and as well as connection with it. Things specified within the document pertain to them and their responsibilities. AOL of Constitution. Document circulates very little; the fact that it exists is important, and that it can be retrieved and referenced as necessary. The concept of proponency seems important. "it is "like" a directive or plan--a guidance document. Though perhaps AOL, the sense that it has to do with arms control, technical and instructive concerning weapons and strategic considerations, etc. It inventories in some sense, and is technical in places, contains details, engineering constraints, limits, designs, essentials, capabilities, and has attachments, appendices, TABs, and similar things.

1st principal component of document: General guidance, purpose section, outline, content, assigns overall responsibilities; ties everything else together.

2nd section: Distribution, proportions, designation of assignments, organized, methodological organization, "deconfliction"--resources addressed, avoids redundancy--how resources are addressed and deployed without getting in the way of other things.

3rd section: Detailed responsibilities, chain of command, authority, who reports to who, who can do what, "like" a task organization, large groups of assets grouped and subdivided to make it all manageable.

4th section: Involves actual assets, quantities, abilities and limits, purpose, like an OR list, but doesn't detail what belongs to whom; it just categorizes and details what is available and what it can do. Assets are grouped according to type--least capable at beginning, most capable at end. Five or more groupings. Represent something tangible, solid, and usable, like weapons or something. Large vehicles are also involved.

003
1/1/87
26 Aug 87

5th section: Lots of numbers in rows; numbers are codes in some sense--codes not to disguise but to convey information in a short space. Deals with location, nature, purpose, and other subjects dealing with specific items for which each number stands. [reminiscent of BE numbers]. Seems to be the last section of the document.

Title of document appears not to be in English. Overall feel of it reminds one of a warplan. Some letters in title seem to be L, I, N, E; Sudden flash of the word "organization." Classification of document seems to be Top Secret, though not in so many English words--that's the sense of it. A caveat, similar to "ORCON" seems involved. Other, locally devised, informal caveats included which restrict the number of people who may have access to the document. Cover is red, and somewhat rough, like ~~construction paper~~. Both yellow and black lettering, which is funny shaped. Date of document may be 17 February 1987, though the year 1977 comes through as well [intuitive analysis: perhaps a revision or evolvement of previous similar document]. A line border around the cover. Date is center bottom third of cover. Left lower corner has a lot of lettering, with a control number or log number or something.

Information was gathered by a group, a specific office, who compiled it from various outside sources; other documents were used to compile it--a synthesis--they take in everything to formulate the whole picture. The room in which the document is maintained has light colored walls, is light inside, has safe or "like" safes; a flat long table with four or five chairs, book shelves along the wall with books and papers on it; a writing table or desk to one side. Two ways in--one door opening inward accesses the outside hall; another doorway without a door opens into the next room where meetings, discussions, and work session occur. Outside (observed through window) it's hazy outside--daylight; some distance up off the ground; trees not too far away, a road; setting reminds one of the DIAC. Nearby are other buildings that are connected in some way with this one, indirectly. On the other side of the structure is the side the sun is on. It's lower in the sky. Open grassy areas; not too far away is a structure with an arched top, like an old theater.

2
foreign
document
WJ

Structure at site is complex, made up of several major sections and components, primarily squarish and rectangular in layout, with several different levels and heights to the roof; it is grey with possibly silver trim, generally smooth with a matte finish, but it does have certain areas of glass, sectioned windows. One portion of the exterior face of the structure has a patterned/contoured/smooth appearance to it, with portions raising smoothly from the surface then merging again. The entire structure manifests the impression of the work of a modernist or avant garde architect who has been directed to create an interesting outside manifestation for it to house much more prosaic activities--"spiff up" the image, so to speak. The highest flat roof--roof to the main section--has an oval or rectangular shape with rounded corners on it. Associated with the structure is a tall, thin, rounded item suggestive of a flag pole or thin antenna. There is a sectioned walkway around the front, and may be trees, shrubs, and grass around the structure. There are large, raised masonry/concrete objects that suggest planters or barricades or etc. On the lower part of the structure over the entrance is a series of words or a decorative frieze imitating script. Perceived letters include R E O L S P I M E and M L I R Y D A. ADL/S words are "polytechnic", "prefecture", and "of"; there are at least three words, but no more than five, though some are long. Heavy ADL of DIAC.

2

~~SECRET~~

15 Sep 87

TAB

~~SECRET~~

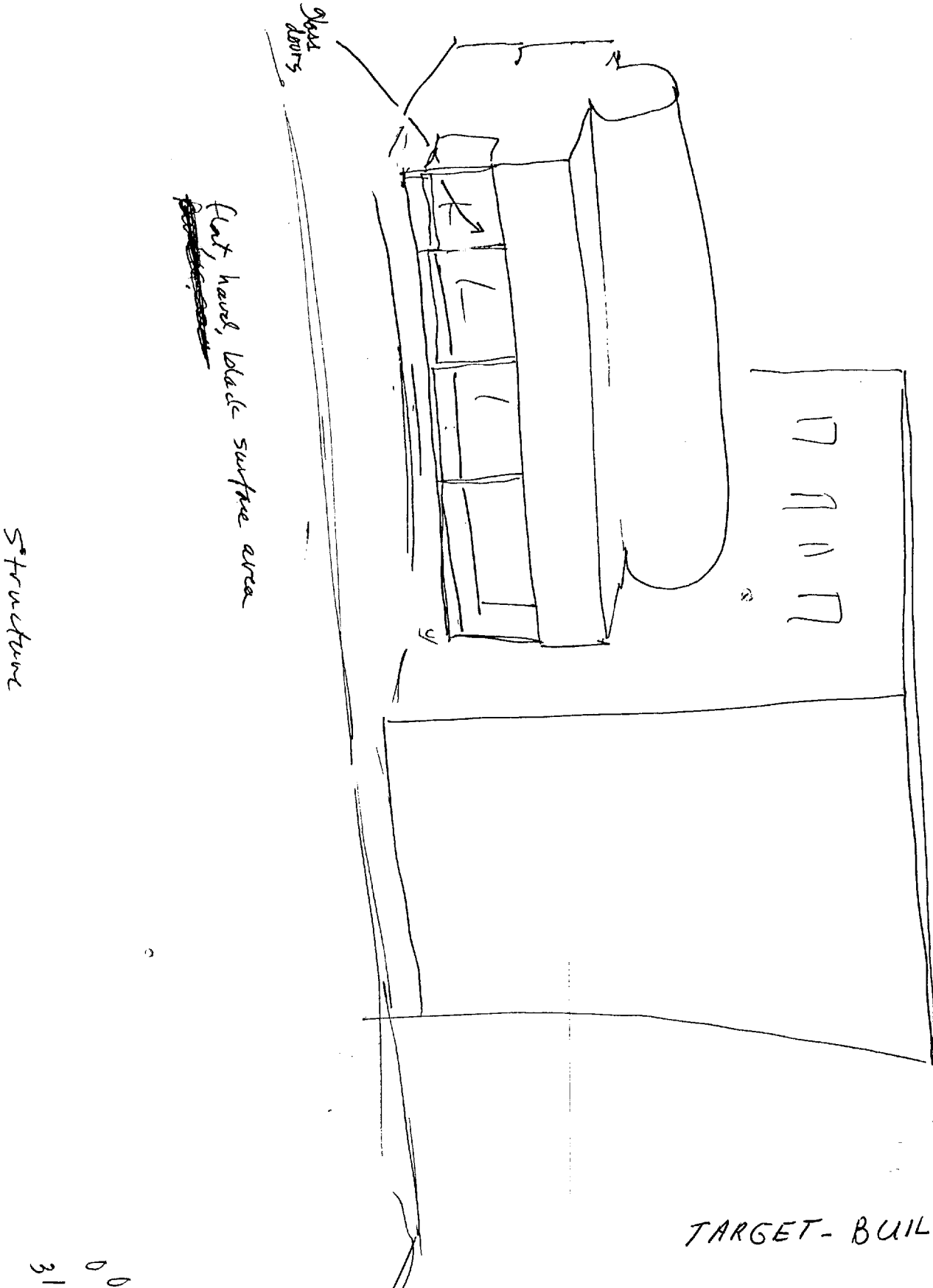

TARGET-BUILDING

31 Aug 87
003
009

VIEWER 003

~~SECRET~~

31 Aug '87

N-1

~~SECRET~~

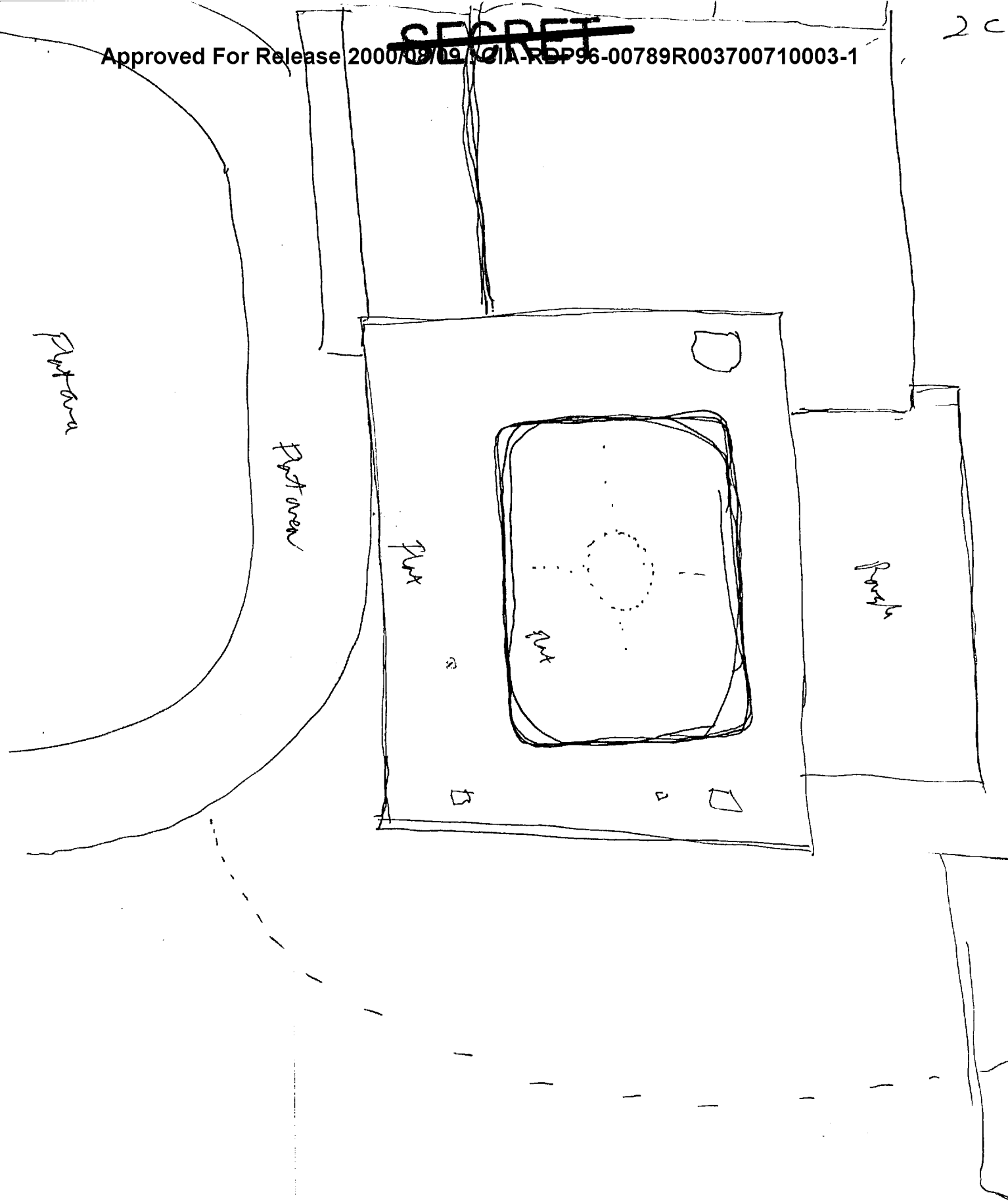

OVERHEAD

TARGET BUILDING

~~SECRET~~

June 003
5 Sep '87

TAB

~~SECRET~~

SESSION SUMMARY

SESSION: 25 AUGUST 1987, 0800-0906 hrs

The target appears to be a large, man-made object. This object feels ~~cool~~ to the touch. It is ~~hard~~, smooth and gray in color. The object's shape is, for the most part, angular, however, there is also something that is rounded and curving. This object seems to be metallic and is coated with something (AOL-like paint). There are people associated with this object

POST-SESSION AOL:

I feel that the target may be an object associated with a structure. There are other structures in the area. The people associated with this target may have been technicians. They were busy moving around on a platform associated with the structure/object. There is an impression that something is being sent and received, like radar or communications signals.

Target Bldg
7
i

Answer 011
25 Aug '87

~~SECRET~~

~~SECRET~~

SESSION SUMMARY

SESSION: 27 AUGUST 1987, 1304 - 1412 HRS

ASSOCIATED WITH THIS TARGET IS A LARGE, MULTI-STOREY STRUCTURE (see sketch, page 4). THE LOWER PORTION OF THIS STRUCTURE IS GRAY, HARD, SMOOTH, AND COOL TO THE TOUCH. THERE IS A PART OF THE STRUCTURE THAT SEEMS TO BE A LIGHTER SHADE OF GREY AND THE UPPER PART A DARK, BLUE-BLACK.

WITHIN THE STRUCTURE, ON AN UPPER FLOOR, THERE IS AN AREA WHICH HAS AN OFFICE, CUBICLES, DESKS, AND WORK AREAS (AOL-like bldg 213 or DIAC). THIS IS AN OPEN AREA, BUT SECURE (AOL-vault-like). WITHIN THIS AREA IS A DOCUMENT. THE CONTENTS OF THIS DOCUMENT APPEAR TO BE VERY CONTROVERSIAL BETWEEN SCIENTIFIC AND POLITICAL COMMUNITIES. IT SEEMS TO HAVE SOMETHING TO DO WITH A MORAL ISSUE. THE COVER OF THIS DOCUMENT IS REDDISH, OR REDDISH-BROWN IN COLOR WITH A BLACK BORDER ON ONE SIDE. CONTAINED WITHIN THIS DOCUMENT IS WRITING AND SYMBOLS. SOMETHING TO DO WITH MATHEMATICS, FORMULAS, ETC. THERE IS SOMETHING ELSE THAT IS CONNECTED WITH THIS DOCUMENT (see page 7). IT HAS THE APPEARANCE OF A COMPUTER PRINT-OUT AND CONTAINS LISTS OF SOMETHING (AOL-like a targeting list, a list of strategic targets).

WHEN ASKED TO DESCRIBE THE ORIGINATORS OF THIS DOCUMENT THERE WAS SOME CONFUSION. THERE IS A FEELING THAT WHOEVER PRODUCED THIS DOCUMENT, WERE NOT NECESSARILY AMONG THE ORIGINATORS.

*Number 011
27 Aug 87*

~~SECRET~~

~~SECRET~~

SESSION SUMMARY

SESSION: 16 SEP 87, 1315- 1443 HRS

This document contains words, figures, illustrations, numbers, symbols, technical terms, and mathematical concepts. Perceive an object that is gray, smooth, shiny, long, round, cylindrical and metallic. The object is interesting, the subject is interesting, the concept is new and interesting, but the document is dull and boring.

*perceive
object*

While focusing on the application of this concept there was a shift to an outdoors setting, complete with a white-water stream and large, tall trees. There is a feeling of excitement, challenge, diversion, and of something old - something new. This is stimulating, interesting and pleasurable to some person connected to this document.

*See
Vol 8
strip
All*

I am getting the impression that there is more than one document. One document deals with explanations and technical aspects, the other contains figures that support the theory or concept. It has something to do with crystal structure, frequency, vibrations, and scatter. There is a material which traps some kind of energy, or light. When this energy or light penetrates this material it is bounced around by rod-like inclusions and is contained within the material.

*See 018
report*

~~SECRET~~

*Number 011
16 Sep 87*

TAB

ORIGINATORS?

4 1/2 - Very confused, because the originators are not necessarily the ones who produced this particular document!

ORIGINATORS?

mathematics

mathematical

LOCATION?

squares
rectangles

glass

pale green

inside

ACL MATCHING
open area
but secure
vault like

~~1/2~~ - getting ^{feeling} of upper floor - 2d or 3rd. Office, ✓
cubicles, desks, work area

ACL break
like building
213

END SESSION

1412 hrs

CRV-DATA - STRUCTURE

Answer all
27 Aug '87

~~SECRET~~

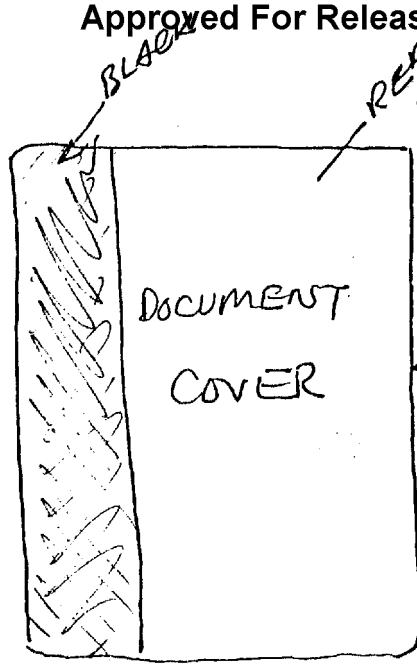

↑ CONNECTED
↓ SOMEHOW

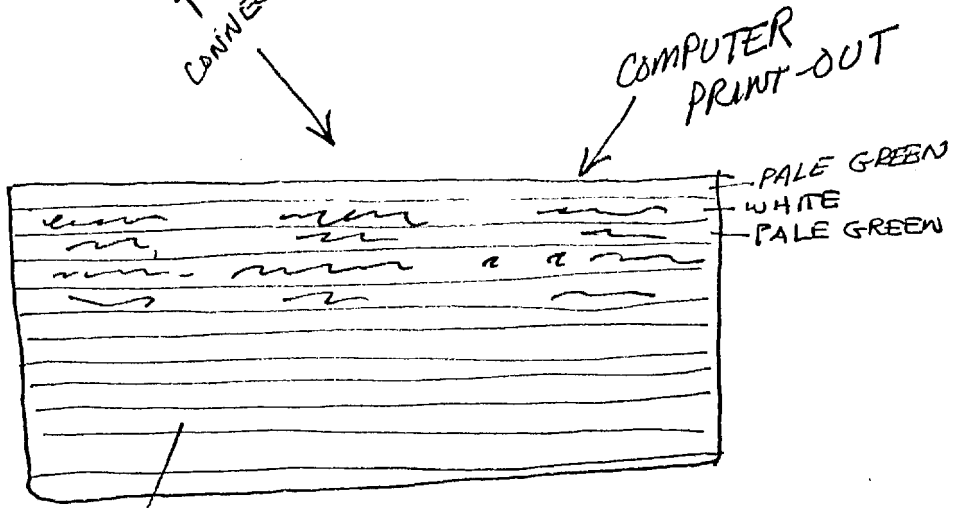

LISTS OF SOMETHING

DOCUMENT-RELATED-DATA.

*Viewed 011
27 Aug '87*

USE/APPLICATION?

structure
crystal

CRISS-CROSS
Cross-hatch



frequency
vibrations

scatter
bounce-off

rcd

rutile

THING & USE?

#3 all I got is some sort of material. When light or "energy" hits it, the light or energy is absorbed and/or scattered/diffused --- it will not reflect

surface of material
acts like a two-way mirror

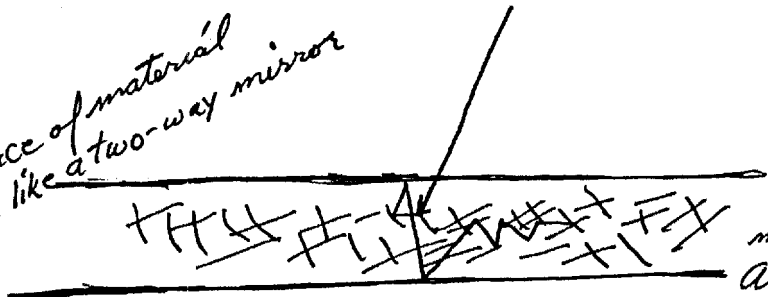

when energy/light enters this material, most of it is absorbed. Any that is remaining is scattered throughout this material by rod-like inclusions contained in the material.

Once the energy/light enters the material it cannot escape --- in theory, anyhow.

Viewer 011
16 SEP '87

TAB

~~SECRET~~

UNITED STATES GOVERNMENT

memorandum

DATE: 11 September, 1987

REPLY TO
ATTN OF: DT-S

SUBJECT: SESSION SUMMARY, PROJECT N-1 (C-SS)

TO: DT-S (ATTN: [REDACTED]) SG1J

1. (S-SS) Statistics:

Project #:	N-1
Viewer:	018
Session date:	15 SEP 87
Filename:	B7N1.L01

2. (S-SS) The outside of the site appeared at first as a large, oppressive, seemingly walled-in building. It reminded me (AOL) of a prison or a compound of some sort. The inside was very impressive and pretty. It reminded me (AOL) of an art gallery. There were people inside this structure who seemed to be well dressed and just milling about, as though (AOL) at a social gathering.

3. (S-SS) Having been cued to look for a single person, I detected a man whom I have the strong feeling that I have known personally. Asked to perceive the time of intersection between my path and his, I perceived two points, one past and one future (see sketch, p. 14)

4. (S-SS) Having the further cueing that I should describe the contents of a document which this person had, I got the following perceptions:

a. The person in question has a feeling of dread and fear about the contents of the document, and would like to prevent the results of the document.

b. The impression that the document addresses methods and concepts to bring something about (from concept into reality).

c. The "something" being brought about seems to require restricted areas.

d. There was a repeated impression of germ or biological warfare.

5. There was a final impression of another man firing a missile, again with the strong impression of biological warfare. This man seemed to be dressed in khaki clothing, and was chuckling evilly, as though he had just gotten away with something he knew he wasn't supposed to do.

~~SECRET~~

~~SECRET~~

UNITED STATES GOVERNMENT

memorandum

DATE: 21 September, 1987

PLY TO
ATTN OF: DT-S

SUBJECT: SESSION SUMMARY, PROJECT N-1 (C/SS)

DT-S (ATTN: [REDACTED] SG1J

TO: 1. (S-SS) STATISTICS: Project #: N-1
 Viewer: 01B
 Session date: 17 SEP 87
 Filename: 87N1.L02

2. (S-SS) RESULTS: In this session, I was tasked at the beginning to perceive and describe the future application(s) of the subject of the document in question. The perceptions gained are as follows:

a. There were recurring visual and tactile perceptions of (AOL) "wilted lettuce leaves". There was also a recurring perception of small, fuzzy orange "balls" on the leaves (AOL: like patches of mold).

b. There was a visual and tactile perception of a very small (microscopic sized) black "crystal" which felt very greasy. This was an exceptionally strong perception.

c. Again, as in the last session, there was a perception of a man "doing something mean", and feeling very self-justified about it. There was a very definite feeling on his part that this was justice. He is proud of what he is doing, and is getting a sense of revenge out of it.

d. When tasked with describing the exact application of the contents, there was a strong allegorical feeling that a door was to close; there would be no going back through it forever. This was a strong impression that something will end; something big and important to life, after which there will be no going back. This was followed by the sudden AI: "This guy's going to do it!"

e. Tasked to describe the event surrounding this, I got a visual (see drawing, p. 6) which was sand colored below, light blue in the middle, fading into black above. (AOL: it looked just like a picture of the horizon, taken from space.)

f. This, of course, led to the AOL drive of a high altitude burst and dispersal, and the session was forced to an end.

3. (S/SS) VIEWER'S CRITIQUE: Although I recognize that there were great amounts of strong AOL drive throughout the entire session, I feel that I was "on target". I have the feeling about this one that, if your information doesn't agree with mine, then yours is wrong, or else I am perceiving another target which is more important than the one with which I was tasked.

*Viewer 018
7 Sept 87*

~~SECRET~~

TAB

~~SECRET~~

summary.

8 SEPT 87
SOURCE 079

I FELT THAT I WAS OUTSIDE A LARGE, GREEN, HILLY AREA. I FELT THAT I HAD AN AERIAL VIEW OF THE AREA AND I COULD SEE ROLLING FLAT HILLS. I COULD ALSO SEE A STRUCTURE THAT AT FIRST SEEMED LIKE A LARGE OBJECT BECAUSE OF IT'S POINTED TOP AND SHARP FEATURES. THE STRUCTURE HOWEVER WAS WIDER AT THE BASE AND IT HAD A SWEEPING OUT EFFECT.

Handwritten scribbles and a rectangular box on the right margin.

AS I GOT CLOSER TO THE STRUCTURE, I COULD SEE THAT IT WAS MADE OUT OF STEEL AND IT SAT BY ITSELF. THE STRUCTURE WAS DARK IN COLOR AND THE SIDES WERE CURVY. I FELT THAT THERE WAS A FIXING UP TO THE STRUCTURE AND A RE-FINISHING AND THIS MADE THE STRUCTURE LOOK MODERN. I COULD SEE FENCES AND A PARKING LOT NEARBY AND I COULD SEE PEOPLE WALKING AND THE AREA AROUND THE STRUCTURE WAS BUSY. I FELT THAT THE STRUCTURE HAD MANY PARTS TO IT AND I COULD NOT SEE THE STRUCTURE AS A WHOLE BUT ONLY PART BY PART AND THE STRUCTURE DID HAVE AN OUTDOOR PART TO IT WHERE PEOPLE SIT AND WALK.

Handwritten note: "I stated session!! PL??"

WHEN I ENTERED THE STRUCTURE, I WENT THROUGH A LARGE DARK WOODED DOOR THAT HAD A ROTATING MOVEMENT. I COULD SEE A LONG HALLWAY AND AT THE END OF THE HALLWAY THERE WAS A LARGE HEAVY BOX. I COULD SEE PEOPLE BUSY WORKING AND THEY WERE NOT TALKING LOUD.

I THEN FELT THAT I WAS IN A RECEIVING AREA OF THE STRUCTURE THAT WAS QUITE BUSY. I COULD SENSE A LARGE TABLE AND THERE WERE HEAVY OBJECTS AROUND ME. IT WAS A SPACIOUS AREA AND I COULD SEE

Handwritten note: "summary 079 8 Sept 87"

~~SECRET~~

~~SECRET~~

PAINTINGS HANGING ON THE WALL AND THIS AREA WAS FIXED UP VERY NICE AND IT HAD A RICH EFFECT TO IT. THIS OFFICE WAS DISPLAYING HISTORY AND I COULD SEE THE COLOR BLUE.

I THEN FOUND MYSELF IN AREA WITH LOW CEILINGS AND A LOT OF GLASS. THERE WERE LOW SHELVES AND A DOCUMENT WAS HERE WITH OTHER SMALLER OBJECTS. THIS DOCUMENT WAS KEPT IN A REGULAR PLACE BUT I FELT THAT THIS DOCUMENT IS KEPT HIDDEN AND ONE COULD FORGET THAT IT IS HERE. THE WORK BEING CONDUCTED IN THIS AREA WAS OF A SCIENTIFIC NATURE.

THE DOCUMENT WAS OFFICIALLY SEALED AND I KEPT SENSING A SPECIAL SEAL THAT WAS GOLD. THE DOCUMENT WAS BROWN AND BLACK AND DATED 1982. THIS DOCUMENT CONSISTED OF EITHER 40 OR OVER 40 PAGES.

THE DOCUMENT WAS CONCERNED WITH PHASES OF IMPLEMENTATION, COUNTERING, FORCING, AND MAKING WORK. THERE WERE MESSAGES ARRANGED IN ORDER TO FILL OUT AND THE MESSAGES WERE CONCERNED WITH TIMES AND APPROXIMATE TIMES. THE DOCUMENT WAS DISTRIBUTED BY THE BLOCKS ON THE BACK OF IT. I THEN SENSE THERE WAS WIRING ON THE GROUND.

I SENSED THAT A MAN WROTE THE DOCUMENT. HE WAS IN A HIGH POSITION AND THIS DOCUMENT HAD SUMMARIES, PICTURES, AND REQUIRED STUDIES.

← Equipment
← Refine all the...

Werner 079
8 Sep 87

~~SECRET~~

~~SECRET~~

SOURCE 079
24 SEPT 87

summary.

I SAW A TALL AND WIDE STRUCTURE WITH SMOOTH AND ROUGH EDGES AND ONE SIDE OF THE STRUCTURE WAS ROUNDED ON TOP. THE STRUCTURE WAS SQUARE WITH A LOT OF ANGLES COMING TOGETHER. PARTS WERE BEING ADDED ON TO THE STRUCTURE AND THERE WAS REBUILDING GOING ON. I SAW PEOPLE WALKING AND THE AREA WAS BUSY. THERE WAS PARKING NEARBY.

WHEN FIRST LOOKING AT THE DOCUMENT, IT WAS HARD AND HAD A THE OVERALL COLOR WAS "BLACK WITH RED ON TOP. THE OVERALL CLASSIFICATION IS SECRET OR HIGHER. THE DOCUMENT WAS THICK AND THE NUMBER OF PAGES IT CONTAINED WAS IN THE HUNDREDS.

AN OLDER, EXPERIENCED ^{MAN} WROTE THE DOCUMENT BASED ON A STUDY. THE MAN HAS FIELD EXPERIENCE IN COMMUNICATIONS.

THE DOCUMENT WAS BASED ON A CONCEPT OF "LIGHT" I KEPT SAYING "EYE TO EYE" IN THE SESSION BECAUSE THIS WAS REPEATING ITSELF THROUGHOUT THE SESSION. I COULD SEE LIGHT OPENING AT DIFFERENT POINTS AND SPREADING OUT, AND CAPTURING DIFFERENT ANGLES. LIGHT WAS ALSO FORMING TRIANGULAR POINTS THERE WAS MEASURING HERE AND THE APPLICATION WOULD BE INTENSE. I KEPT SEEING THAT THE LIGHT COULD BE CIRCULAR AND COULD TRANSMIT OUT. THERE WAS A LOUDNESS CONNECTED WITH THIS LIGHT WORKING. ALSO, THERE IS NEW VISUALIZATION CONNECTED HERE. A DIFFERENT WAY OF LOOKING AT THINGS. THE LIGHT IS STORED UP AND CUT OFF.

THIS IDEA OR CONCEPT WAS BROUGHT INTO A STRUCTURE AND THERE WERE NEW MODES AND NEW CONCEPTS OUTLINED AND WRITTEN ABOUT IN THE DOCUMENT. THE CONCEPT WAS BASED ON PAST PRINCIPALS AND NEW

~~SECRET~~

Source 079
24 Sep 87

~~SECRET~~

OPINIONS WERE FORMULATED. PROVEN METHODS WERE ALTERED AND CHANGED IN THE DOCUMENT AND NOW THE METHOD IS MORE FLEXIBLE AND THERE WAS AN ADDITION OF MORE MOVEMENT AND ~~ADDING ON TO THE KNOWN~~ FACTOR. THE CONCEPT IS MORE FLUID AND MORE FLEXIBLE ALLOWING FOR AN INTER-DEPENDENCY. ALSO, THERE IS SWIFTNESS AND FASTNESS ASSOCIATED WITH THE OVERALL CONCEPT. THE METHOD OR ~~RIGHT OR~~ ~~FORMULAS STAY TOGETHER WHILE ALLOWING ONE SIDE TO GO FREE.~~ AT ONE POINT IT SEEMED AS THOUGH AN ~~IDEA WAS REVERSED AND UTILIZED.~~

THE WORK INVOLVED HERE IS A LONG PROCESS AND MUCH INTERWORKING IS GOING ON. I KEPT GETTING THE IMPRESSION THAT THIS WILL BE BROUGHT DOWN TO LOWER LEVELS AND SOMEHOW TAUGHT TO PEOPLE. ALSO, I KEPT GETTING THE IMPRESSION OF "NEW ADDITION." THERE WAS A HUMANISTIC SIDE TO THIS IDEA AND IT DOES DEAL WITH PEOPLE AND WILL BE BROUGHT TO PEOPLE.

ALSO, THE DOCUMENT IS COMPLETED AND THERE MAY HAVE BEEN SOME TESTING ASSOCIATED WITH THIS PROJECT. HOWEVER, I DID NOT SEE ANY TYPE OF APPLICATIONS YET.

*Newman
24 Sep 87*

~~SECRET~~ p. (2)