

memorandum

DATE: 8 Feb 90

REPLY TO
ATTN OF: DT-S

14 Feb 90

SUBJECT: SUBJECT: Project 9001-B (U)

TO: HQDA, DAMI-IO (U)

1. (S/STD) On 5 and 6 February 1990, two sessions were conducted in an effort to determine the current location of a target personality identified as [REDACTED] believed to be located either at [REDACTED] or at an area identified as the [REDACTED]

SG1A

SG1A

SG1A

2. (S/STD) Remote Viewer 003 the target structure as a white stucco-like building with a "sloping, bumpy roof", located in the midst of heavy vegetation. The is a "hard-packed" road, reddish in color, found in flat, open, area in the vicinity of the target structure.

3. (S/STD) Remote Viewer 011 described the target personality as currently residing in a "room/apartment" situated in a small cafe. The cafe appears situated in a small village found next to a park. The village is adjacent to a major highway. The target personality often uses a bus, a light blue vehicle that resembles an old school bus to travel to and from his place of (temporary residence. An inside view of the cafe is at TAB A. At TAB B is an overview of the cafe and its immediate surroundings. And, at TAB C is an overview of the village where the cafe is located.

3. (S/STD) OPS COMMENTS: Viewers 003 and 011 described the current residence of [REDACTED] with a view towards determining if their descriptions correlate with the locations known as [REDACTED] and the [REDACTED] area.

SG1A

SG1A

SG1J

3 ENCLOSURES
TAB A THRU TAB C
SKETCHES

[REDACTED]
Branch Chief

CLASSIFIED BY: HQDA, DAMI-IO
DECLASSIFY BY: OADR

~~SECRET~~

SKETCH * 1

INSIDE VIEW OF CAFE'

P 9001-B

D 900208

V 011

S 01

M ERV

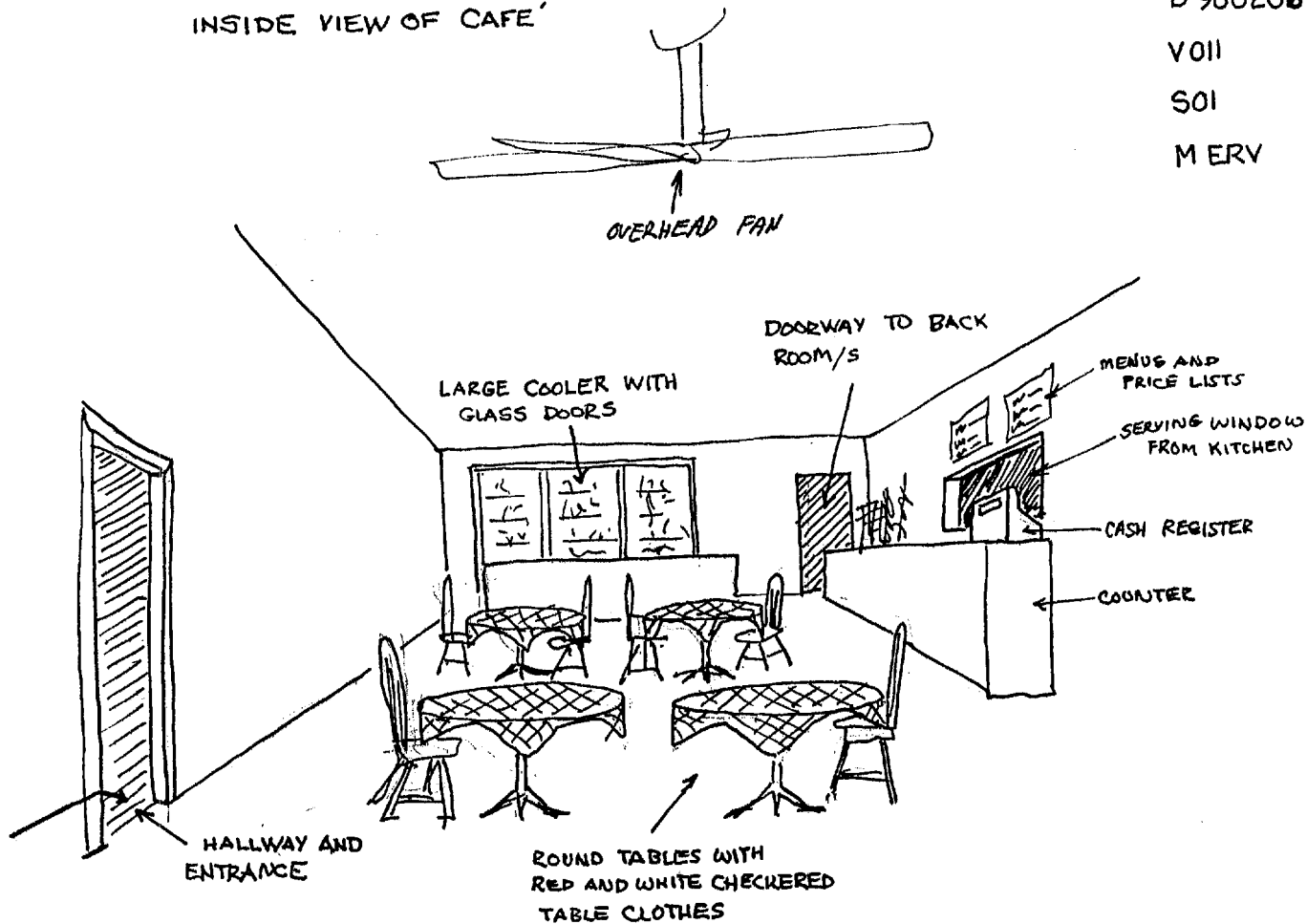

INSIDE OF CAFE'-LIKE RESTAURANT FROM THE BENCH/BOOTH AND TABLE LOCATED NEXT TO THE LARGE WINDOW, IN FRONT, WHICH OVERLOOKS THE PARK/VILLAGE SQUARE, THIS IS WHERE TARGET PERSONALITY USUALLY SITS. TARGET PERSONALITY LIVES UPSTAIRS FROM THIS ESTABLISHMENT.

HANDLE VIA SKEET CHANNELS ONLY

~~SECRET~~

TAB A

~~SECRET~~

SKETCH # 2

OVERHEAD VIEW OF TGT STRUCTURE AND IMMEDIATE AREA

P 9001-B

D 900206

VOII

SOI

MERV

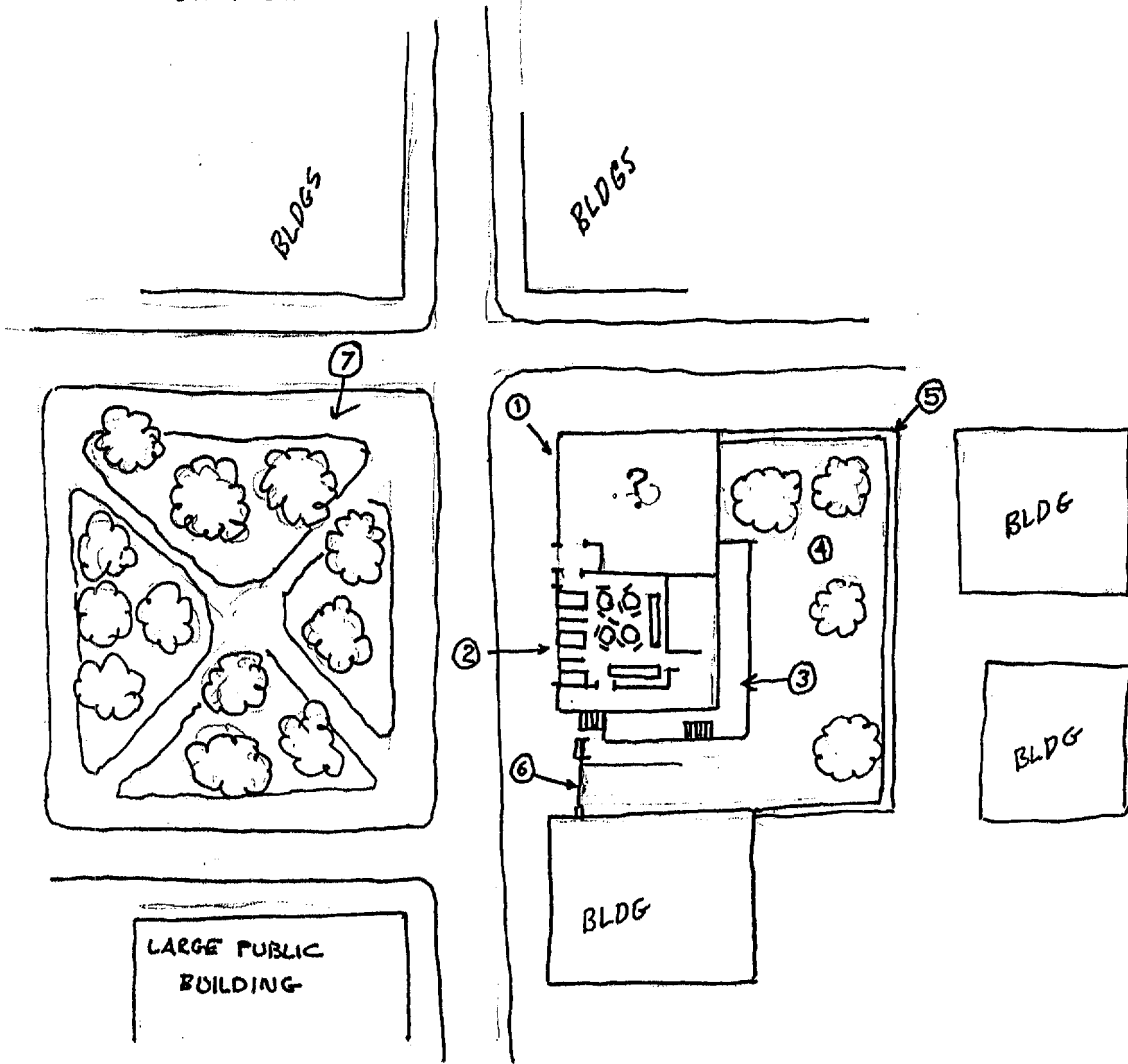

- ① TARGET STRUCTURE
- ② CAFE' WITH LRG WINDOW OYERLOOKING PARK-LIKE SQUARE (SEE SKETCH #1 FOR INTERIOR)
- ③ SECOND STORY PORCH/BALCONY (TARGET PERSON LIVES IN AN APARTMENT HERE)
- ④ COURTYARD
- ⑤ MASONRY WALL
- ⑥ DRIVEWAY WITH METAL GATE
- ⑦ PARK-LIKE SQUARE WITH BENCHES

HANDLE VIA SKEET CHANNELS ONLY

~~SECRET~~

TAB B

SG1A

Approved For Release 2000/08/09 : CIA-RDP96-00789R003500880004-4

Approved For Release 2000/08/09 : CIA-RDP96-00789R003500880004-4