

~~SECRET~~/NOFORN

*3/11/01/89*

PROJECT SUN STREAK

WARNING NOTICE: INTELLIGENCE SOURCES AND METHODS INVOLVED

PROJECT NUMBER:	B908	SESSION NUMBER:	01
DATE OF SESSION:	01 MAR 89	DATE OF REPORT:	03 MAR 89
START:	1003	END:	1045
METHODOLOGY:	CRV	VIEWER ID:	003

1. (S/NF/SK) MISSION: To access and describe an event which is suspected to have taken place at about 1830 hours (local), on 4 April, 1987.

2. (S/NF/SK) VIEWER TASKING: Stage I: encrypted coordinates. Well into Stage IV: "The target is an event which has already happened. The coordinates include cueing for both the time of the event and the site location."

3. (S/NF/SK) COMMENTS:

a. Inclemencies: None declared.

b. 003 appeared to have no trouble accessing and describing the site. A cursory look was made into each of the EEI requirements, but the target was not probed in great depth. Near the end of the session, the ADL of "drug trafficking" began to nag at 003, so the session was ended. Deeper probing into each of the EEI requirements will come in the following sessions.

c. Summary of Information enclosed.

4. EVALUATION:

3 encl: Viewer's summary  
Session transcript  
Tasking sheet

HANDLE VIA SKEET CHANNELS ONLY

~~SECRET~~/NOFORN

CLASSIFIED BY: DIA (DT)  
DECLASSIFY: OADR

~~SECRET~~/NOFORN

*X*

003

1003-1045

Site is a structure that is flat on top, white, masonry, in an opening amongst thick, green vegetation. It is surrounded by a wall/fence combination, and guarded by several people. There is an impression of several people gathering together here planning something--they go inside to talk over something of mutual interest to all of them. The talk is about several things--certain specific orchestrated actions to be performed, and also about "policy" as to how to represent what happens, A/S as in "cover," or "deniability," or "alibis," or "justification." Several convoluted game plans are interwoven. Some of the people involved seem to be non-US, some US; other languages are spoken, but English predominates. People don't wear ties, but rather open shirts, that are white, with dark "like" sportcoats. At least some of the people are shorter, dark complected; some are easily provoked. What they are anticipating would be welcomed by some, and very unwelcome to others in the larger community, maybe even world. There is a sense of international implications in which the US is involved--not as an actor, but rather as one acted upon. What is going on here depends on confidentiality--it can only function if more powerful agencies external to it don't know for sure what's going on.

Presently, the location is quiet, busy, but not extremely so--"like" a sort of low-key "command center" or "base of operations," keeping its finger on the pulse of what is continuing or proceeding. A sense of contentment with how things are proceeding thus far. What's going on at this location is not particularly significant. There is a person involved with the site who is short, non-Anglo but lighter-skinned than many 3rd world people. He has a pock-marked face and doesn't wear glasses. He has a cold, cruel sense of humor.

Some aspect of the activities occur within the US, as well as in other places. Strong feeling that location and activities are primarily confined to Western Hemisphere. It all involves more countries than where the first location is and the US, but not more than five countries altogether. Activity is covert (though there doesn't seem to be any governmental or official feel about it--i.e. in some sense private activity.) but there are significant resources available to support it. It is not beneficial to US interests. Activity involves clandestine meetings between parties involved. There's not a great concern they'll be discovered--they believe they will probably get away with it. However, disclosure would seriously disrupt goals.

Paul  
1 March 89  
F. Meade, mid  
hyn  
1003

74 35 22  
46 32 56

D —  
—  
—  
—  
—  
—  
—  
—

A. am  
flat  
med  
to long

A. am  
vsg  
oval  
solid

B. structure

A. op end  
cross on  
open  
solid  
B. structure

s2  
brown  
susp  
orange  
light  
whitish  
hard  
smooth  
bumpy  
raspy  
blech  
grey  
organic smells

red  
green  
faded  
lamp

surrounds  
open  
dotted  
box-shaped

A2 BK  
unpleasant, foreboding  
mystery.

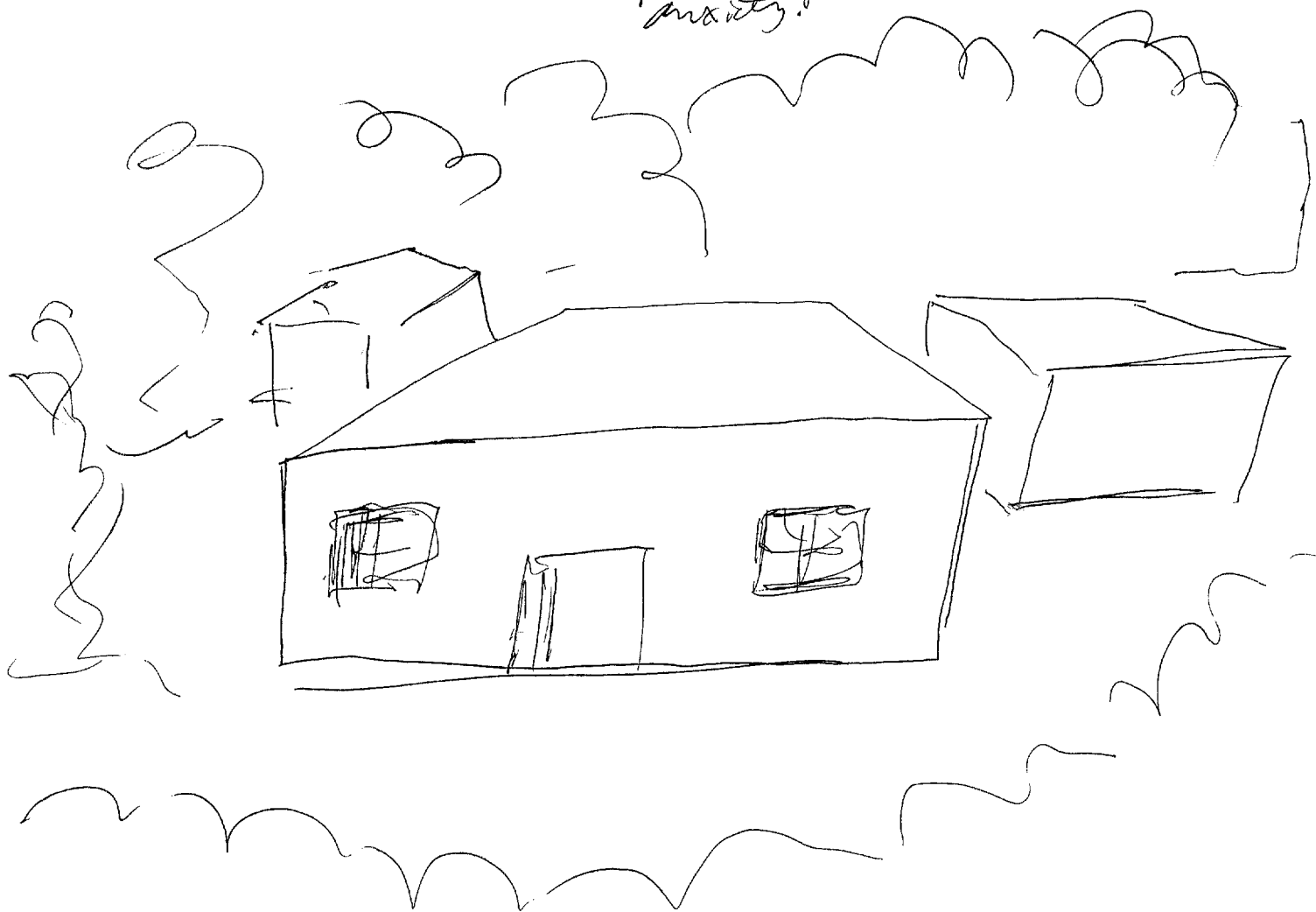

52.  
light  
weight  
green  
yellowish  
lytated

Als

Vegetation  
large low  
small low  
trees

5/12 Vegetation is a very noticeable aspect of site structure

white  
angles  
flat  
1 m  
wide

wall  
level  
gate

white

masonry

light +  
stair  
patterns  
Als

"Like" Sun of Hood through leaves.

Als BK  
etc.

52

D

AZ

FZ

T

I

HOL

Als

people

Self some us some non-us. Other language spoken but lots of English predominately, People don't wear ties. Open shirts.

private concealed secured.

Self people watching out - part of their job. Place depends on confidentiality - ie. can only trust if you powerful agencies don't know what's going on.

People

Some

ambitious  
~~conspirator~~  
manipulative

annihilating  
resistance

Self Impression of several getting together & planning something. Guests exterior make sure not interrupted. People arrive separately - those that wait already know who's coming & of mutual interest to all of them. About several things -

52

1/4  
ALS

54 1/2 (cont) about certain specific, undated out-says to be performed & also about "like" policy as to how to represent what happens i.e. "Cover" or "deniability" or "dibs" or "justification". Several convoluted game plans involved,

54 1/2 At least some of people are shabby, dark complexioned, wear white shirts & dark "like" sport coats. Some are easily provoked. What they are anticipated by would be welcomed by some, and very unwelcome to others in the larger community, maybe even world.

ALS of international implications.

54 1/2 US is in some way involved, but not as an actor, rather as one acted upon.

AOZ BK  
Salwan Rushdie  
Progs ops  
PLD

52

5  
ALS

Current time  
Present  
Weather (C)

People

waiting

carry  
out  
routine

organizing  
insults  
activities

Self location presently is quiet, busy, but not extremely so. "like" a sort of low-key "command center" keeps its pulse on what is continuing & proceeding. A sense of contact with how things are proceeding there ~~far~~ what's happening at this ~~present~~ location <sup>presently</sup> is not particularly significant.

Self Structure is "like" carved in white stucco that is somewhat cracked. (ALS) Reminds me of a place in Panama I saw photos and long time ago. Joe was working.

Person

ALS Person, short non-Anglo, but lighter skinned than many of other people I've met here.



52

P A2 E1 T I HSL ALS

Sup/2 Some aspect of activities occur w/in US, as well as in other places. Strong feeling that location and activities are primarily confined to Western Hemisphere. Involve more countries than that where first location is + US, but not more than 5 altogether.

Sup/2 Activity is covert (though doesn't have a governmental or official feel about it - i.e. in some sense "private" activity), but they are significant resources available to support it. It is not beneficial to US interests.

Activity involves clandestine meeting between parties involved. There's not a great concern they'd be discovered, but disclosure would disrupt goals.

~~SECRET~~

ALS  
drug  
trafficking

1043

~~SECRET~~/NOFORN

WORKING PAPER

1 MAR 89

TASKER

1. PROJECT : 8908
2. Encrypted coordinates: 743522/463256.
3. Tasking: An event of special interest is suspected of having taken place at about 1830 hours, local time, on 4 April, 1987.
4. Required EEI:
  - a. Describe the event (related activities, etc.) and the target area AT THE TIME OF THE EVENT.
  - b. Move to the present time, but remain at the target site location. Describe any current, ongoing, and related activity(ies) AT THE TARGET SITE.
  - c. Remain in present time and move to any current, ongoing, and related activity(ies) which are not at the site location.

~~SECRET~~/NOFORN