

6 Apr 1999

~~SECRET~~ / NOFORN

PROJECT SUN STREAK

WARNING NOTICE: INTELLIGENCE SOURCES AND METHODS INVOLVED

PROJECT NUMBER: 8906	SESSION NUMBER: 1
DATE OF SESSION: 890321	DATE OF REPORT: 890323
START: 1115	END: 1100
METHODOLOGY: CRV	VIEWER IDENTIFIER: 003

1. (S/NF/SK) MISSION: Describe the nature and purpose of an activity at encrypted coordinates 937201/907314.
2. (S/NF/SK) VIEWER TASKING: Coordinates.
3. (S/NF/SK) COMMENTS: 003 was exhibiting a couple of the behaviors associated with AOL. Don't know if this had any affect on the session or not - input on his site contact would be helpful before next session.
4. EVALUATION:

*Input?
Rev Ogant*

HANDLE VIA SKEET CHANNELS ONLY
SPECIAL ACCESS REQUIRED

~~SECRET~~ / NOFORN

CLASSIFIED BY: DIA (DT)
DECLASSIFY ON: OADR

Working paper

Proj. no: 8906
Date: 21 Mar 89
Viewer: 003
Session: 001

Summary of Information

Site involves a very large structure, apparently of thick reinforced cement, with interior stairs and heavy duty metal railings. Structure is large, voluminous, very substantial, as if to withstand significant shocks or strains. People inside are professional, skilled, technical, and are engaged in activity surrounding an object or objects that are sheltered within this structure. There is significant access to outside which can be blocked or open as necessary. The object(s) are only temporarily inside for current attention being given there. They are of metal, smooth, shiny, rounded, dark uniformly matte finish, sleek. Activity taking place here is uniformly preparatory--as if getting it ready to be used. Object moves, and is thin, long, tapered, swept, large, and in cross section is much thinner than one might expect. From top it seems much broader and curvy in unexpected ways. It seems to sit on long spindly legs. Its purpose seems to be primarily to move. Strong A/S of advanced technology aircraft of some sort. No feeling that it's flown before, but people involved have few doubts that it will work--almost as if they had had extensive experience with it already. "Uni-body" construction--like it was cast, formed in a mold, or somehow "poured out"--very smooth and integral. Made carefully and in a polished, professional fashion. A/S "flying pancake."

Huge power to weight ratio. Outside are large areas of flat cement; it is breezy, light, cool, sunny, crisp. Climate reminds me of the northern Rockies area--thinner air, low humidity, wind, bright sun. Impression that site involves an event of some sort.

Handle Via SKEET Channels Only

~~SECRET~~

Paul
21 March 84
H. Meade, MD
Arlo
1015

9372

miss back

937201
907214

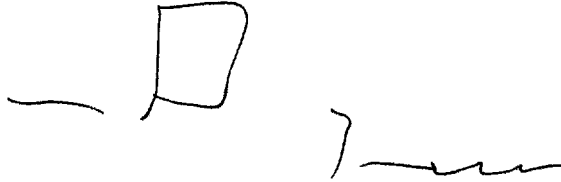

A am
plet
and
B. bar

A am
and
and

S. 12

B. - 12

A am
wavy line
B. vector

A1 Bc
dills
on bar
A. B.

S2
me
fresh
marty
dim

rough
bumpy
white
solid
vest
high
w/m

As Blc
some portentousness

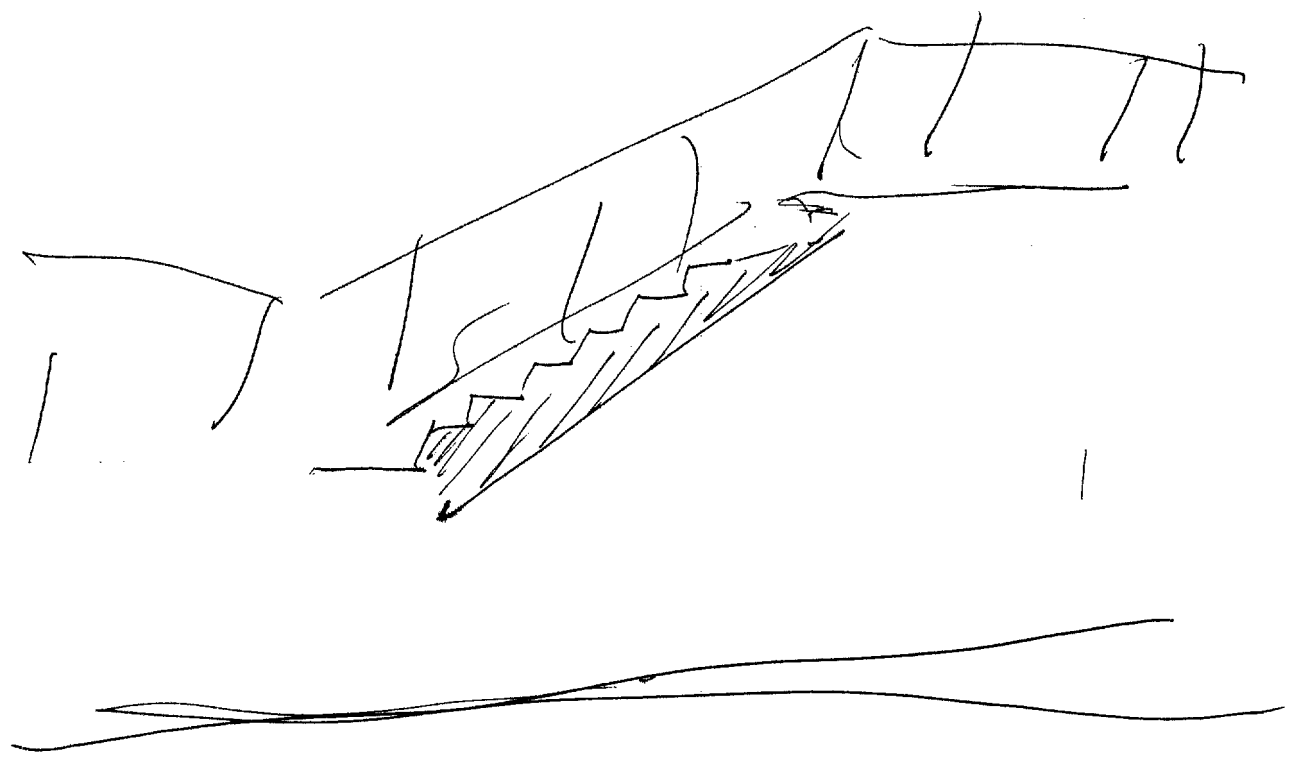

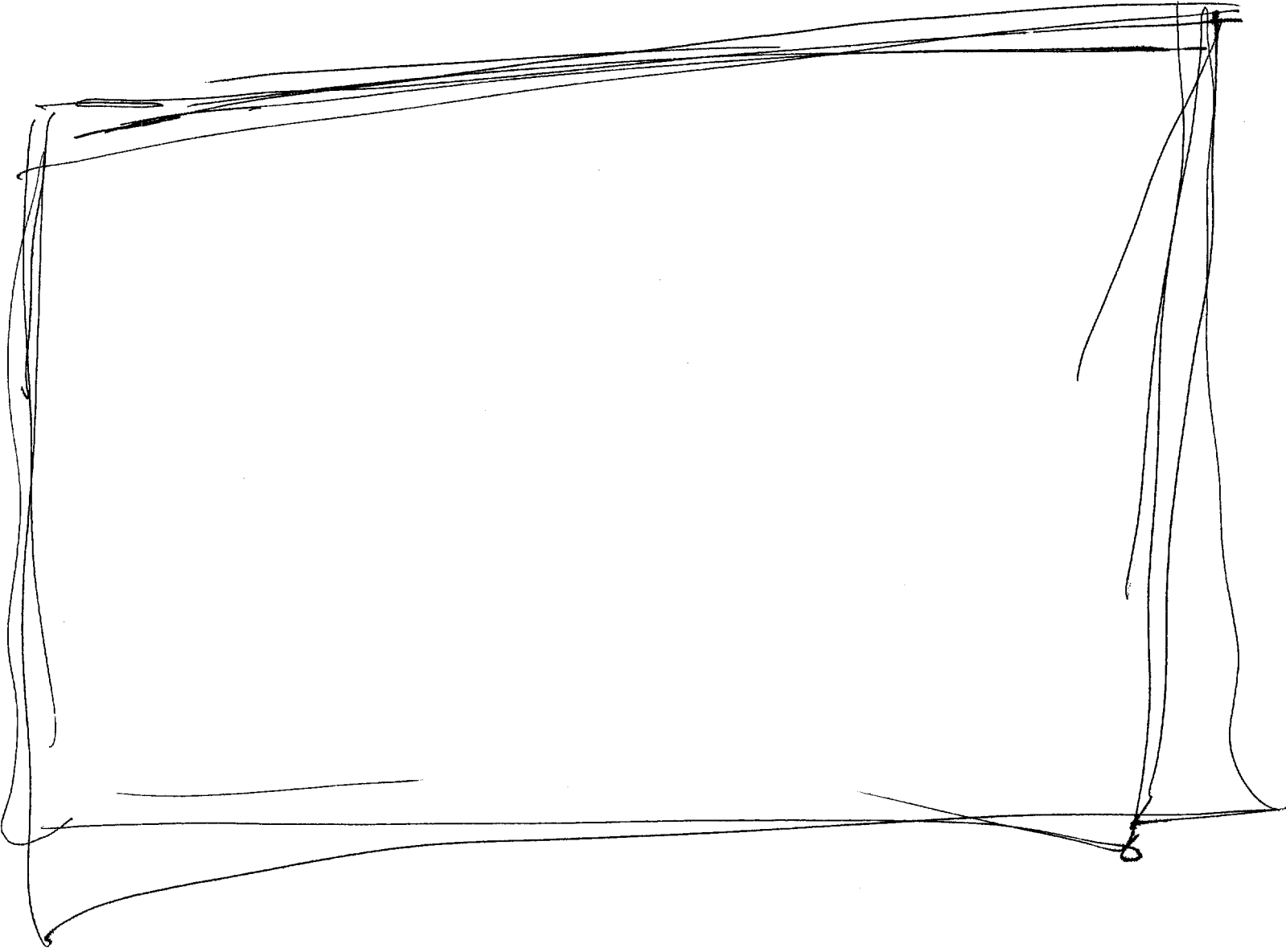

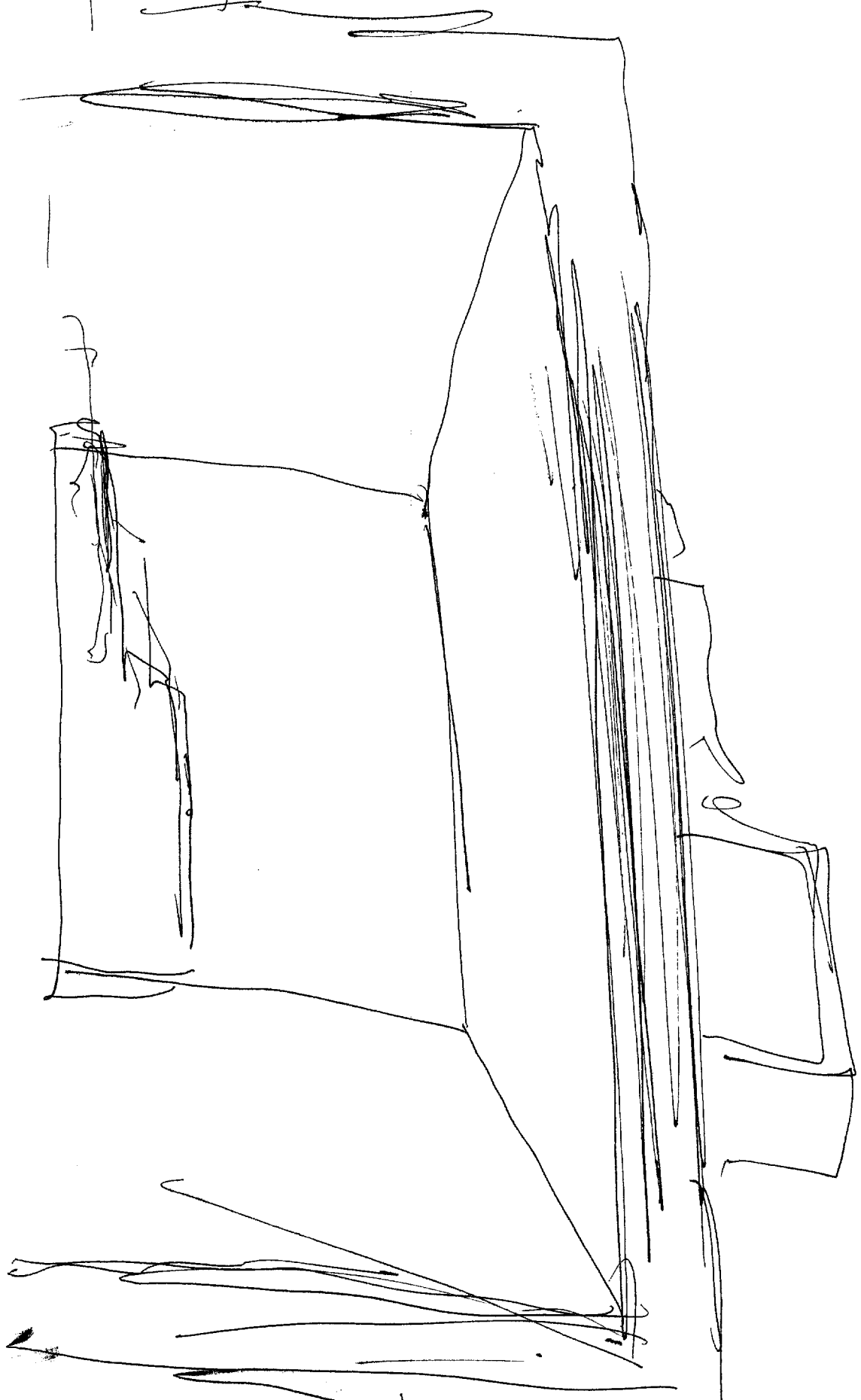

Sz

5

ts

studies

has
yellow
black

Solid
large
thick

concrete

industrious
like

carious

red

outside

light
cool
smooth
crisp
slight

flat

event

see 1/2 large areas of flat cement. Breezy

Also reminds me of Western Rockies area - the hue is
low humidity. red and bright sun

52

Ad As

As Impression that life involves an event of some sort.

Structure

Su 1/2 Structure is large, voluminous, very substantive as if reinforced to withstand significant stresses or strains. People inside are professional, skilled, technical & are engaged in activities surrounding an object or objects that are sheltered w/in this structure. There is significant access to outside which can be blocked or opened necessary. Object(s) are only temporarily inside for current attention being given there.

Object(s)
metal

smooth
shiny rounded

steel

dark
uniformly
matt
finish

Su 1/2

Activity takes place here is an interesting preparation

52

B AI E - T J AL AB 7

Object(s)

Machine(s)

more

fly

thin
long
faded
slight
large

5/16 in cross section much thinner than expected. In other dimension much broader and curvy in unexpected ways.

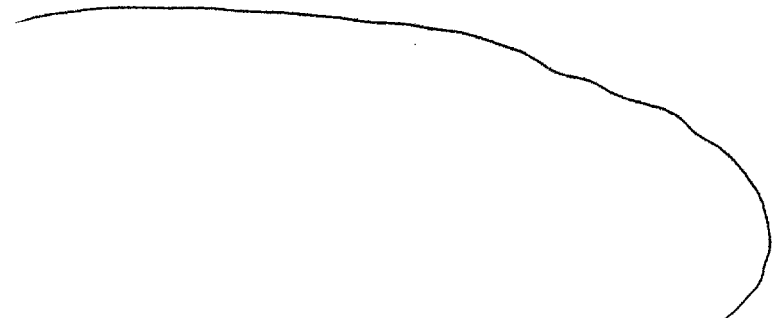
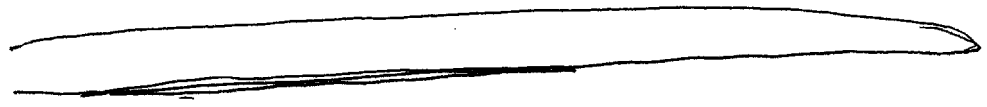

S2

S4 1/2 S17s "like" on ~~light~~ long spindly legs.

Purpose

of BK
drills

S4 1/2 Purpose is to move A/S strong circuits
it is a concept A/S natural technology.

No feeling it's from before, but people
involved have few doubts that it will work -
almost as if they had had extensive experience
with it already.

S4 1/2 "Uni-body" construction - like it was
"powered out" - real smooth and integral
Really polished & carefully made

A/S fly by pancake

S4 1/2 huge power to weight ratio

BK BK
stall

8u

