

SESSION INFORMATIONA. TARGET DATA:

Task/Target No. : 91-17-P-E Phase I  
Session No. : 1

B. PERSONNEL DATA:

Source No. : 018  
Monitor's No. : 370  
Beacon/Sender No. :

C. SESSION DATA:

Date Task Received : 16 OCT 91  
Session Date : 16 OCT 91  
Start Time : 1313  
Stop Time : 1408  
Method used : CRV  
Aids/Distractions (PIs) : None  
Pre-session hunches (AVs) : Mexico  
Date Summary Returned : 16 OCT 91

D. EVALUATION DATA:

Viewer's Estimate : Low  
Evaluator's Estimate :

E. SESSION SUMMARY:

Q: "Describe the vicinity/area of missing person."

A: (SEE SKETCHS ATTACHED)

- 1) The area is an area of shifting sand dunes which have hard packed, flat ground between the dunes (see Fig. 1).
- 2) There is a range of mountains very far away (15-20 miles) to the south and extending northwestward (see Fig. 1).
- 3) Several miles to the northwest is an old tower of some sort (see Fig. 2).
- 4) Also to the northwest, but more westerly, is a large flat area where there are no dunes. This area is flat, hard-packed, very dry and has whitish-looking ground (see Fig. 2).
- 5) About 1/4 mile from the the missing person, to the southwest, is a parking area for tourists. The tourists are roaming around on the flat ground between the dunes in the area between the parking lot and the missing person (see Fig. 2).
- 6) Approximately 1/4 mile further to the southwest from the parking lot is a road/hwy which runs southeast-

northwest (see Fig. 2). The entrance to the parking area from this road is a divided area with a large sign (see Fig. 3).

- 7) Approximately 1/4 mile down the highway to the southeast from this entrance is a larger sign with a rounded top.
- 8) This entire area is located east of Chihuahua, Mexico.

Q: "Is the target person alive or dead?"

A: The target person is dead. She is lying barely exposed under blowing sand.

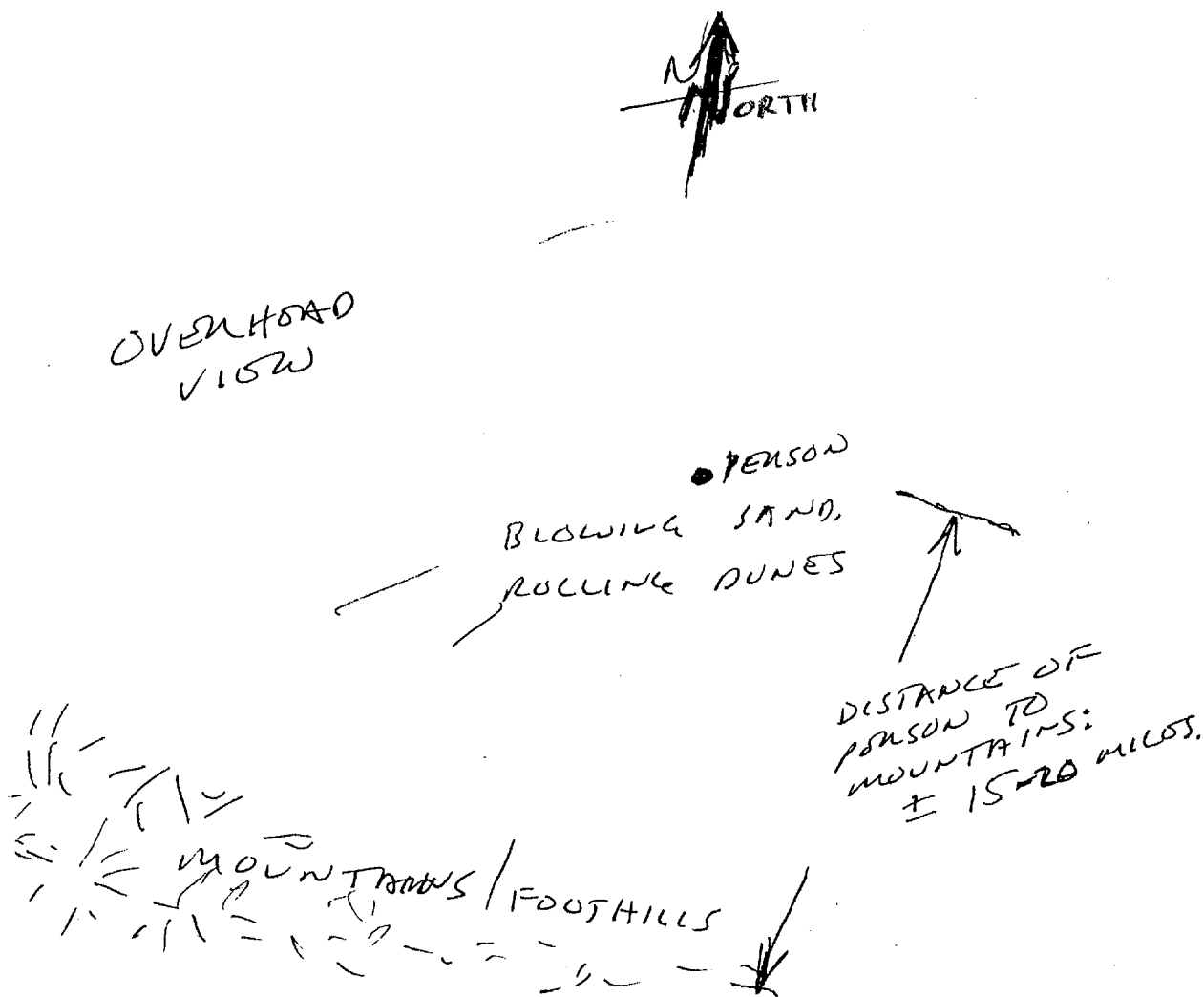
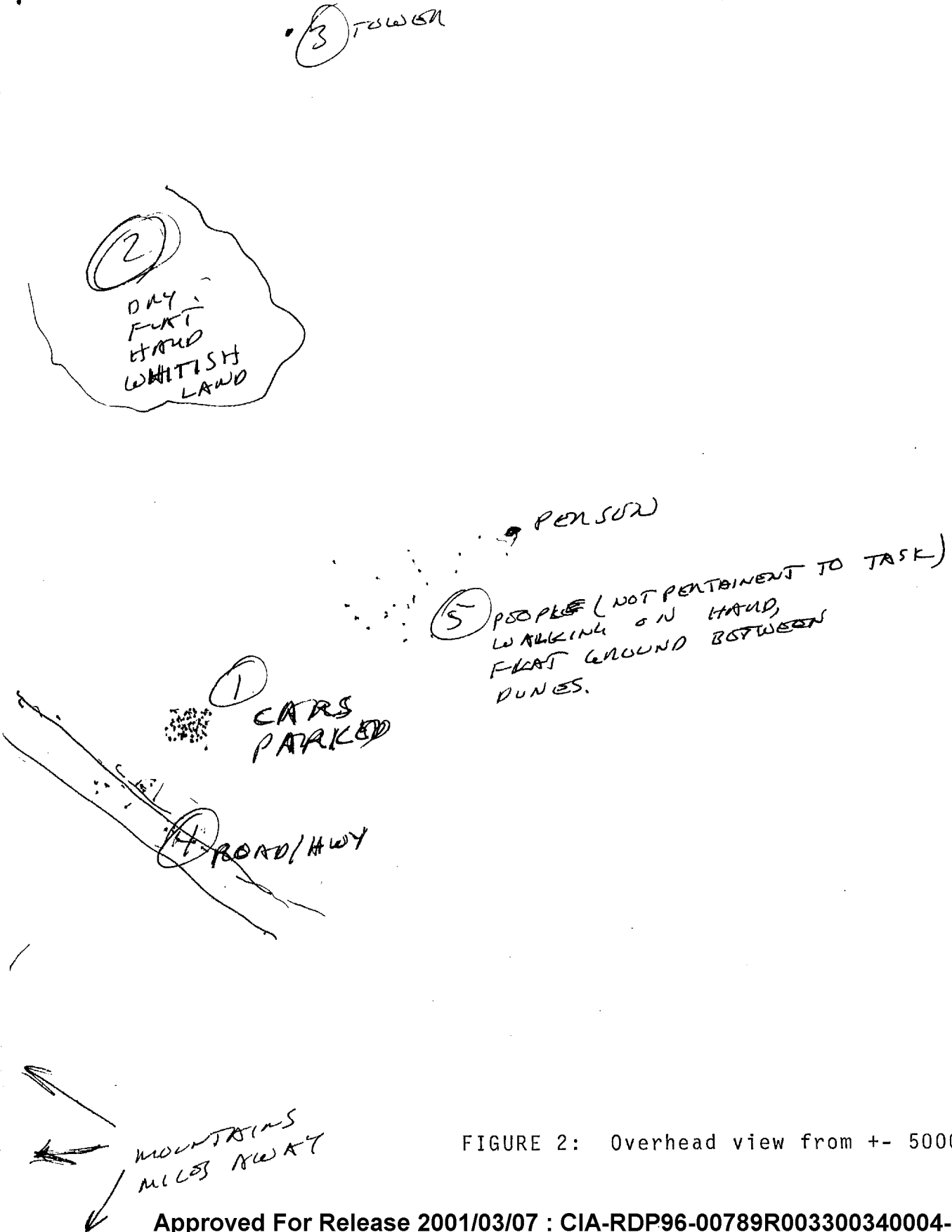

FIGURE 1: Overhead View of General Area



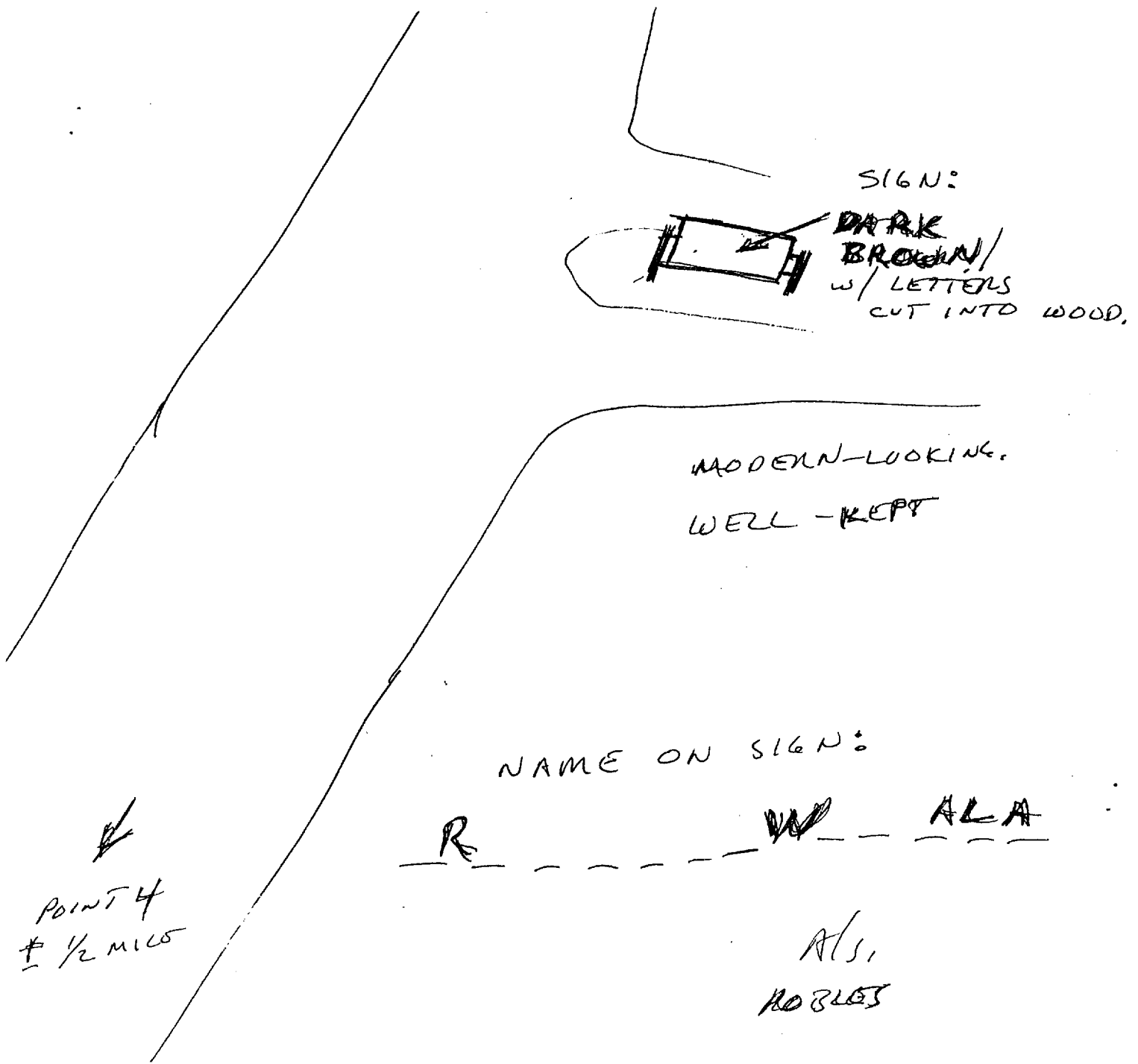

FIGURE 3: Entrance to Tourist Area

018

16 OCT 91

1313 HAS  
FR. MEXICO

320

P.I. DMS  
A.U. MEXICO

91-17-P-E

A: ACROSS  
SWEET  
DMS  
B: LAND

S2: FINE  
QUALITY  
SOFT  
TAN  
YELLOW  
WIDE

91-17-P-E

A: ACROSS  
SWEET  
B: WATON

CONF. BAK.  
FOOLS POWDER

ACZ PMLC -

CONF. BAK. FOOLS POWDER

(2)

91-17-P-E

A: ACROSS  
HAND  
SMOOTH

B: \_\_\_\_\_

SZ: SMOOTH  
FIRM

NO BARK  
WATER

91-17-P-E

A: ACROSS  
SMOOTH  
HAND

B: \_\_\_\_\_

SZ: FLAT  
ROUNDED  
CURVING  
SOFT  
SPONGY  
GIVING  
POWDERY

NO BARK: CLEARLY  
~~NO CLEAR CUT~~

3

ACR MK.  
LIKE A SAND-STREAM  
ON THE DESERT.



91-17-P-E

A: ACROSS  
HARD

B: LAND

S2: FLAT  
HARD  
BROWN  
TAN  
FLAT.

ACR MK.  
"PACKAGE" OF POROSITIES;  
POROSITY LYING UNDERNEATH  
SURFACE.

ACR MK.  
POROSITY BUNISH/DEAD



(4)

S1: GENTLY  
FINE  
SOFT  
POWDERY  
PILSD

..

AD BANK  
VISUAL:  
SAND DRIFTS  
W/ BANK (SMTH) EXPOSED.

S2: FLAT  
HORIZONTAL  
WINDY FEEL  
DUSTY SMELL  
WIND SOUNDS  
QUIET  
WIDE  
OPEN  
FLAT

AD BANK  
AD BANK

5

SZ O A I O T I per r/s.  
(PERSON)

PANK

PLUMP

INERT

S4 1/2 DEFINITE FEELING OF DEATH.

(my) ~~MEMORY~~ A/S. OF DRUG AGENT KILLED IN MEXICO SOME YEARS AGO.

SS!

(6)

DRUG AGENT

~~XXXXXXXXXX~~

PRIOR INVESTIGATION?

LYING DOWN  
UNDER GROUND

FOUL PLAY

MEXICO

MURDER

~~MALICIOUS~~ FEMALES INVOLVED

VICTIM

DARK SKIN

INTERVIEW SUMMARY:

PERSON IS DEAD, LYING PARTIALLY  
~~UNDER~~ COVERED BY LOOSE, BLOWING SAND.

DESCRIBES THE AREA.

(2)

S2 D M O T | AIR W/S.  
(AREA)

LEASY

COOL

WINDY

"POPPERY" FEELING ON SKIN

W/S.  
LIKE BLOWING SAND.

W/OZ BRK.  
WHITE SANDS, N.M.

S2 D M O T | AIR W/S.  
(AREA)

TAN

LOOSE

POWDERY

WIDE

ROLLING

8

S2 D H C E T 1 N R A A L S.

S4 1/2 NOTABLE ABSENCE OF VEGETATION.

DUNES

VISUAL:

VERY DISTANT HILLS

ORANGE COLOR.

PR25.

10

(9)



GROUND LEVEL VIEW  
AS SEEN, LOOKING TOWARD  
SUN, FROM PERSON'S POSITION

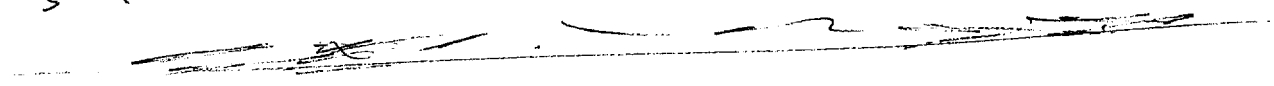

OVERHEAD  
VIEW

● PERSON

BLOWING SAND,  
ROLLING DUNES

DISTANCE OF  
PERSON TO  
MOUNTAINS:  
± 15-20 MILES.

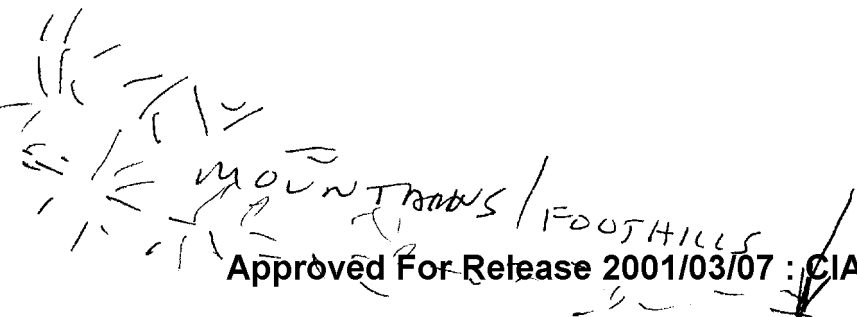

10

S 4 1/2 BOTTOM OF ROLLING DUNES IS  
HARD, FLAT GROUND



MOVE TO 5000 FT. ABOVE POUNSON'S  
LOCATION + DESCRIBE SPECIFIC  
IDENTIFIERS.

SZ 0 101 07 T 1 AM 415.

(SEE MAP, P. 10A)

CARS PARKED

①

AOL

WHITE SANDS N.M.

10A

(SEE XCPT, P. 10)

• 3 TOWER



• PERSON

⑤ PEOPLE (NOT PERTAINENT TO TASK)  
WALKING ON HAND,  
FLAT GROUND BETWEEN  
DUNES.

① CARS  
PARKED

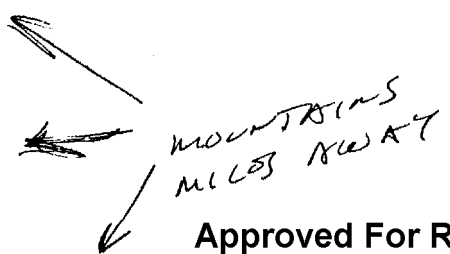
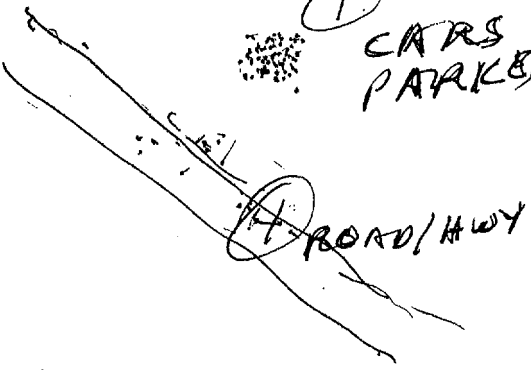



(585 MAY, P. 10A)

(14)

S2 O M N T I AN A/S

(2) FLAT

LAND

PACKED

WHITISH COLOR

LOW-MEDIUM ELEVATION.

(1)

BLUE

LT. BLUE

BLUE TRIM

SIGHT-SEEING FEEL

TOURIST FEEL

STRUCTURE

STORE

LARGE WINDOWS

WHITE SANDS.

12

S2 O M O T , 1982 NLS,

3

WALL  
VERTICAL  
DARK COLOR  
UNOY

TOWN

OLD  
UNOY.

4

SAME  
FLAT  
LONG

ROAD  
LIGHTWAY

CLOSE TO PARKED CARS

5

5 1/2 IMPRESSION OF PEOPLE WALKING  
ON FLAT, HARD GROUND BETWEEN  
TWO DUNES. — PEOPLE NOT RELATED/  
CONNECTED TO PERSON.

13

(SEE MAP, P. 8A)

S2 D A1 D T 1 per als,

④ DARK

PROUMENT

S4 1/2: LITTLE TRAFFIC = TRAFFIC CAN  
NOT BE SEEN OFF IN FAR DISTANCE.

STRUCTURE

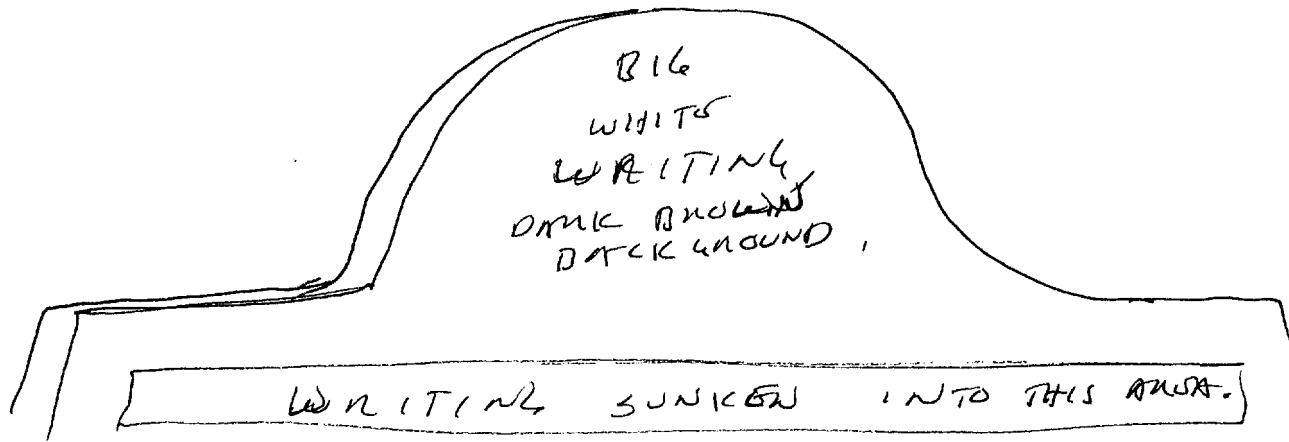

S4 1/2 CANNOT SEE POINT #1 FROM POINT #4,  
BECAUSE OF UNUSUAL GROUND DISTANCE,  
IS LESS THAN 10 MILES.

174

SZ O OX OZ T 1 NOC ALI,

TRAVERSE UP ROAD - LOOK FOR SIGNS

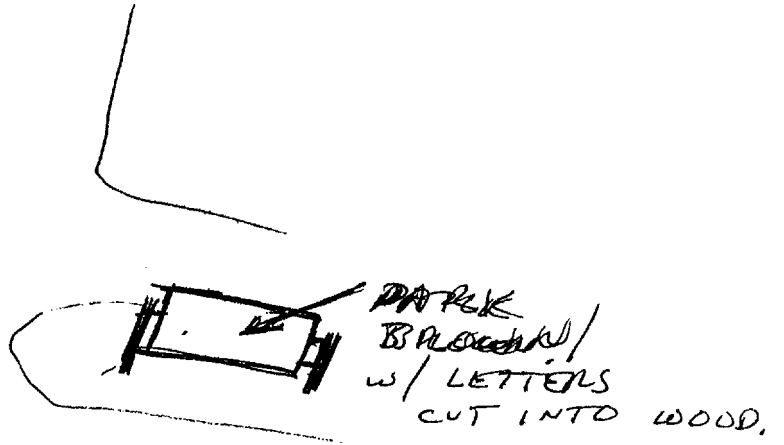
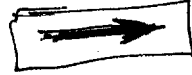

MODERN-LOOKING.  
WELL - KEPT

R W ALA

POINT 4  
± 1/2 MILES

ALI,  
ROBLES

SESSION TASKING SHEET

Source No. \_\_\_\_\_

Date Task Initiated 16 Oct 91

Suspense Date { 17 Oct 91 - PHASE I

{ 18 Oct 91 - PHASE II

Task/Targeting No.: 91-17-P-E

Project Type: SEARCH (PROFICIENCY/OPS).

Targeting Method/Technique: \_\_\_\_\_

Target Data Desired:

1. DESCRIBE KEY TARGET FEATURES (include forms, shapes, spatial aspects, color, motion/dynamics):

- Emphasize the following: \_\_\_\_\_
- Do the following perspectives:
  - Ground-level
  - Overview
  - Other: \_\_\_\_\_

2. IDENTIFY KEY TARGET CONTENT (include meaning, purpose, function, nature of activity, type/nature of people, if present):

- Emphasize the following: \_\_\_\_\_

3. IF PERSONALITY, DESCRIBE: \_\_\_\_\_

4. OTHER: (or see attached) LOCATE MISSING PERSON

5. ADDITIONAL GUIDANCE: (see attached)

TWO PHASES ; SEE ATTACHED.

16 OCT 91

91-17-P-E

PHASE I:

TASK: LOCATE MISSING PERSON

GIVEN: (1) PERSONS NAME: ROSA GONZALES

(2) LAST SEEN: 4 OCT 91

REQUIRED: (1) PROVIDE DESCRIPTION OF VICINITY / AREA OF MISSING PERSON, TO INCLUDE:

- OVERVIEW OF AREA
- SPECIFIC LANDMARKS.

(2.) IS PERSON ALIVE OR DEAD?