

92-9-L
049
12 FEB '92

SESSION INFORMATION

A. TARGET DATA:
Date: 12 Feb 92
Task/Target Number: 92-9-L
Session Number: 01

✓ B. PERSONNEL DATA:
Source Number: 049
Monitor Number: N/A

C. SESSION DATA:
Session Start Time: 0926
Session Stop Time: 1026
Method Used: Solo CRV
Distractions/Hunches: see below

D. EVALUATION DATA:
Viewer Confidence (H/M/L): M
Evaluator's Estimate: _____

E. SESSION SUMMARY:
(see attached)

Distractions/Hunches: (H) sinus infection
(H) Australian setting; aborigine using a bullroarer;
association w/ Ayers Rock.

Summary of Information

The target area contains, in places, rolling terrain with arroyos dissecting the landscape. There is exposed bedrock, small brush and a dramatic stratification of the rock. Elsewhere there is water at the bottom of a steep/sheer cut in the earth which is reminiscent of a sinkhole or cenote. A lot of the target area is wild and overgrown. The latter is causing a change in the integrity of the site in general (e.g., a tearing apart, decomposing, disintegration of indigenous features).

There is a structure constructed of shaped stone which sits high above a steep downslope. It occurs near the edge and sits isolated. It feels as if a dome should be part of this structure (diagram page i). There are stepped levels of stone reminiscent of a stone staircase going up/down at a steep angle. There is a path or passageway which goes through rough terrain (see diagram, page ii).

Elsewhere occurs a round, green disc with a surface which appears to be concave. This "disc" appears to sit within the side of a cliff/mountain/canyon, etc. The terrain both rises and falls away from this feature (see diagram, page ii). The surface is soft, sweet and has an oily feeling to it. This place is sacred to some. These people throw objects into this green disc. There is a large object within the green disc. The scene is reminiscent of an animal floating in a pool of water.

Nearby is an area which has the taste of "coal". The earth is exposed here and the material is black and angular; it breaks off into squares or cubes. There are holes which appear to have been haphazardly excavated into the ground. The work is sloppy and appears to have been done in a hurry.

One feature is long, wide, flat and "feels" well used. There are stepped, jagged and lumpy features which are both simple and complex in their makeup. Another feature has a complex end or corner (see diagram page iii) to it. This is associated with a soldier, warrior/priest and/or snakes.

Another area of the site is cold and dank with a draft. It is reminiscent of the air in an old chamber or passageway which is buried or enclosed.

Diagram iv depicts either a door/entry way or arch way constructed of stone blocks. This place has the feel of an old, abandoned city.

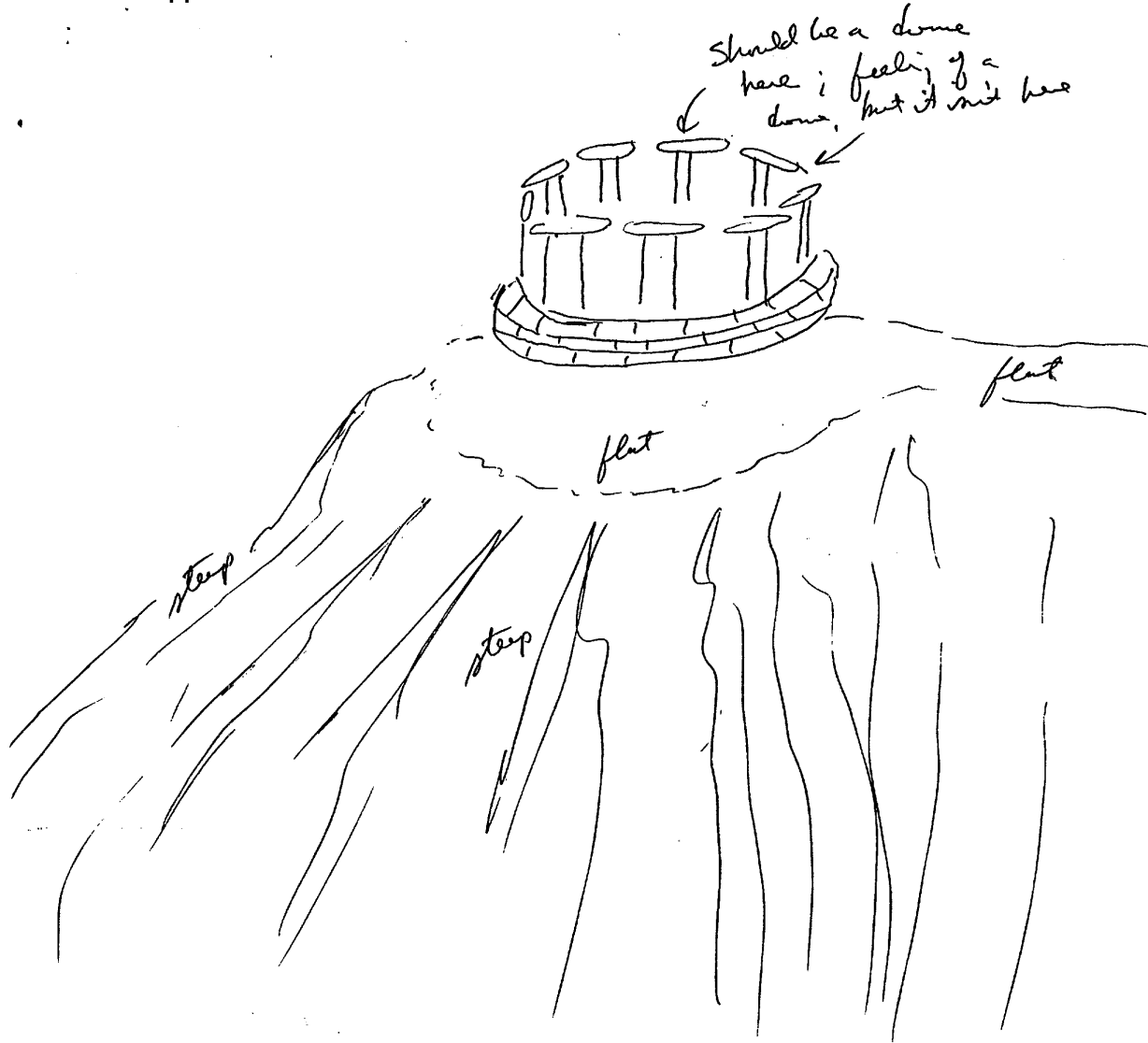

i

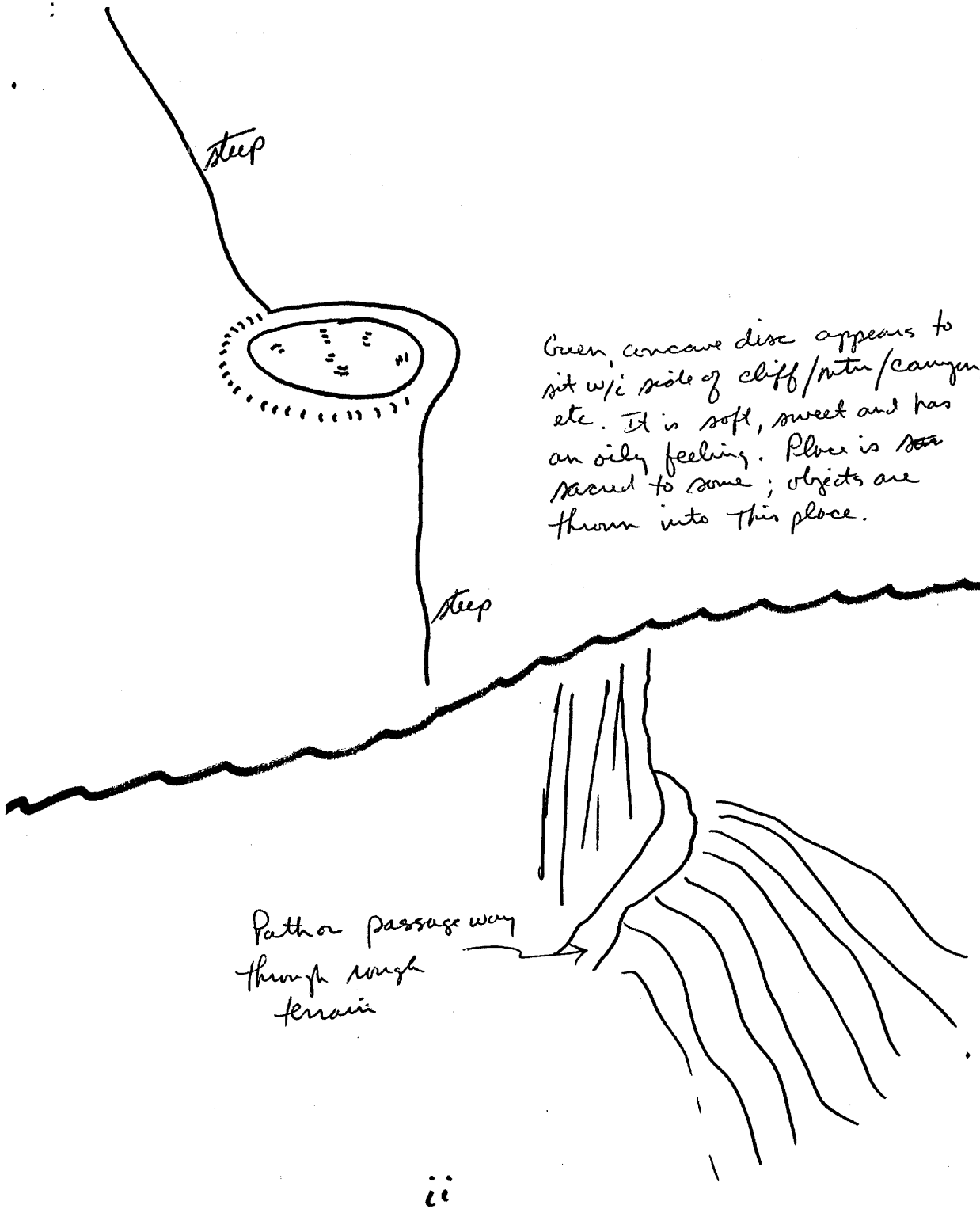

Green, concave disc appears to sit w/i side of cliff/mtn/canyon etc. It is soft, sweet and has an oily feeling. Place is ~~not~~ sacred to some; objects are thrown into this place.

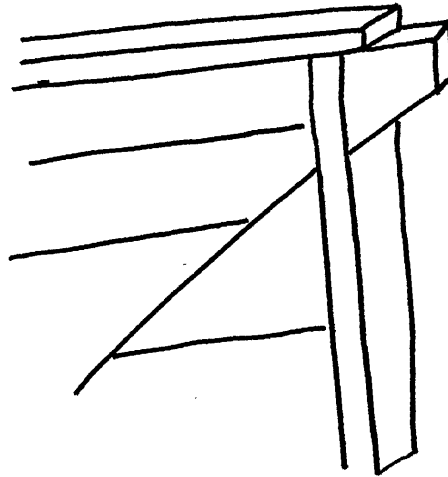
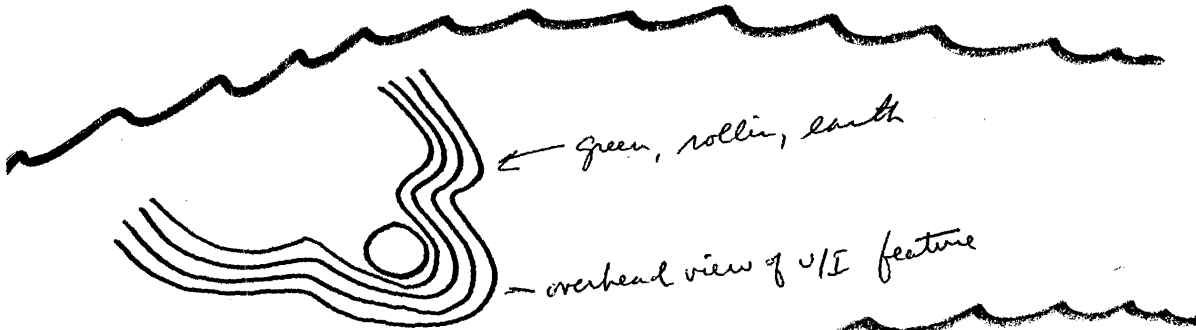
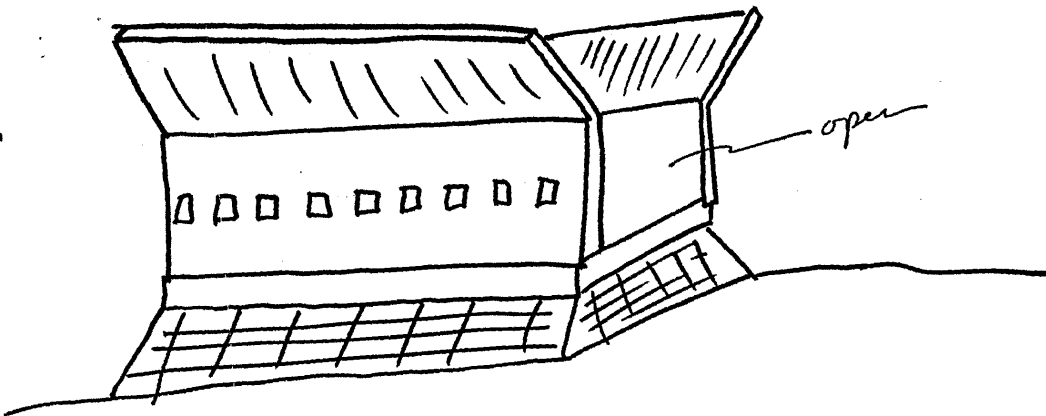

U/I object
* associated with soldiers,
warrior/priests and
snakes.

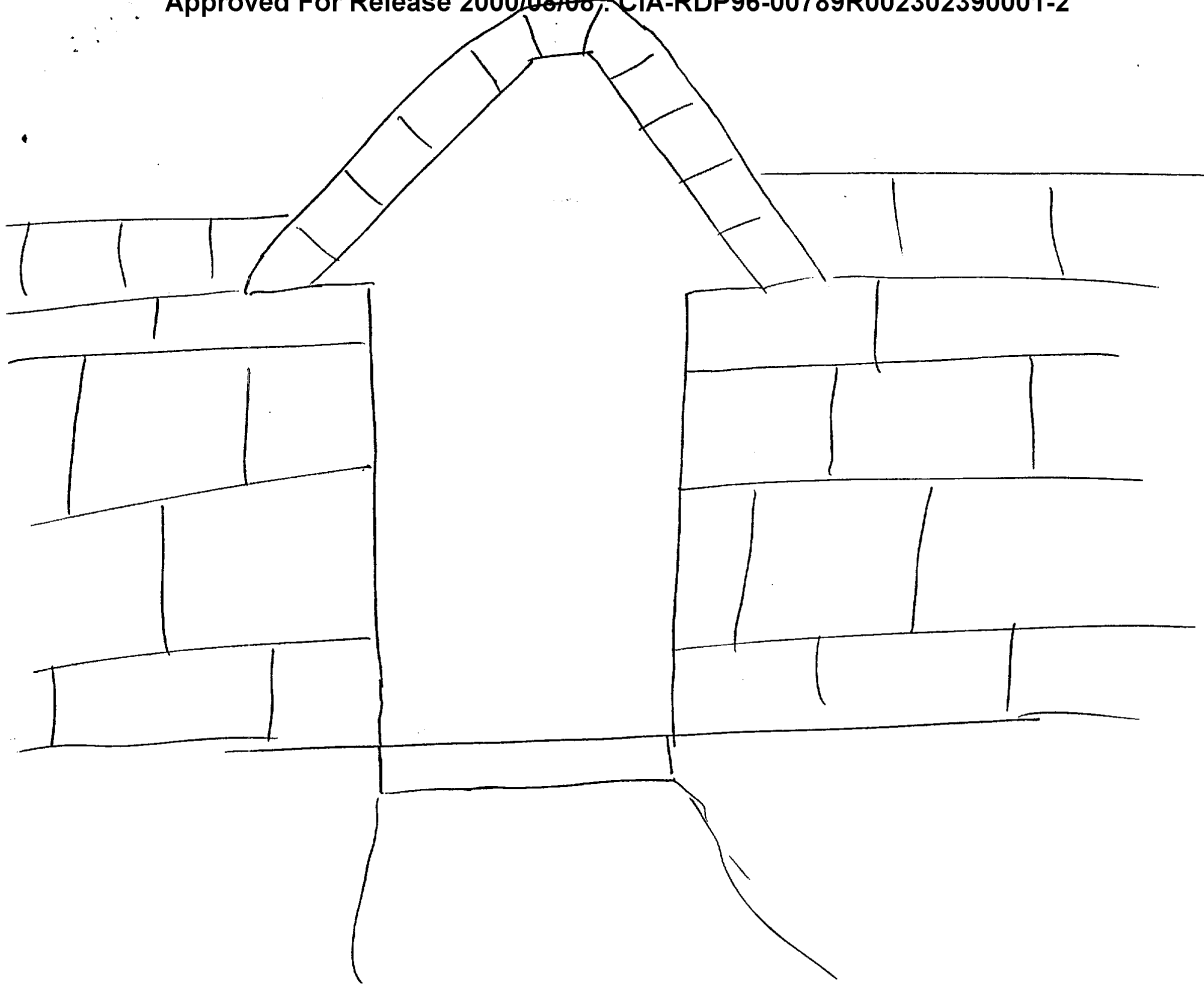

10



TASKING SHEET

SOURCE NO. _____

DATE 12 FEB '92

SUSPENSE: 1600 hrs
12 FEB '92

TASK NUMBER: 92-9-L

METHOD/TECHNIQUE: Methods of choice

TARGET DATA:

1. DESCRIBE KEY TARGET FEATURES:

- Include forms, shapes, densities, dimensional aspects, colors, Dynamics.
- Provide an overhead, ground-level perspective.

2. IDENTIFY KEY TARGET CONTENT:

- Describe purpose, function, and people at the site (if any).
- Other: _____

3. PERSONALITY TARGET:

- Address physical, mental, emotional, intellectual and philosophical and professional aspects of target personality.
- Describe avocations and dominant interests.
- Describe notable accomplishments ascribed to the target personality.

✓ 4. DESCRIBE THE TARGET:

5. OPTIONAL COORDINATES: 586990/696840

6. COMMENTS:

- This is a long distance parameter series target.