

SESSION INFORMATION

- A. TARGET DATA:
 Task/Target No. :92-79-B
 Session No. :01
- B. PERSONAL DATA:
 Source No. :025
 Monitor's No. :N/A
 Beacon/Sender No. :
- C. SESSION DATA:
 Date Task Received :28 Jul 92
 Session Date :28 Jul 92
 Start Time :1:00
 Stop Time :2:00
 Method Used :ERV
 Aids/Distractions (PIs) :N/A
 Pre-session Hunches (AVs) :N/A
 Date Summary Returned :28 Jul 92
- D. EVALUATION DATA:
 Viewer's Estimate :N/A
 Evaluator's Estimate :
- E. SESSION SUMMARY

The target is a red building with stairs. This building stands alone and is in good condition. It consists of several floors and can be viewed from a car. Roads, white trim, greenery and a fence can be found at this location. A double combed pattern is present (See Sketch). There is quite a lot of movement and activity on the premises. This can be considered a somewhat historical structure wherein people come and go. This target is in a vicinity not too far from an airport. Flat, black top and white concrete roads / surfaces, are prevalent in the area.

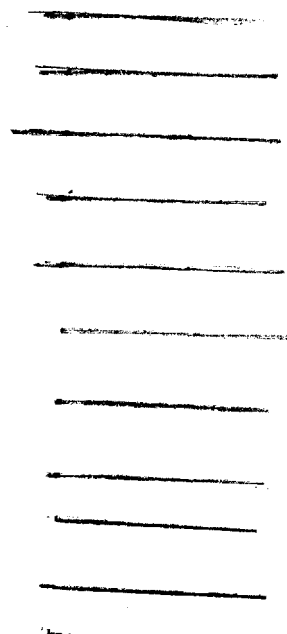

Busy
area where
people
come and
go. Roads.

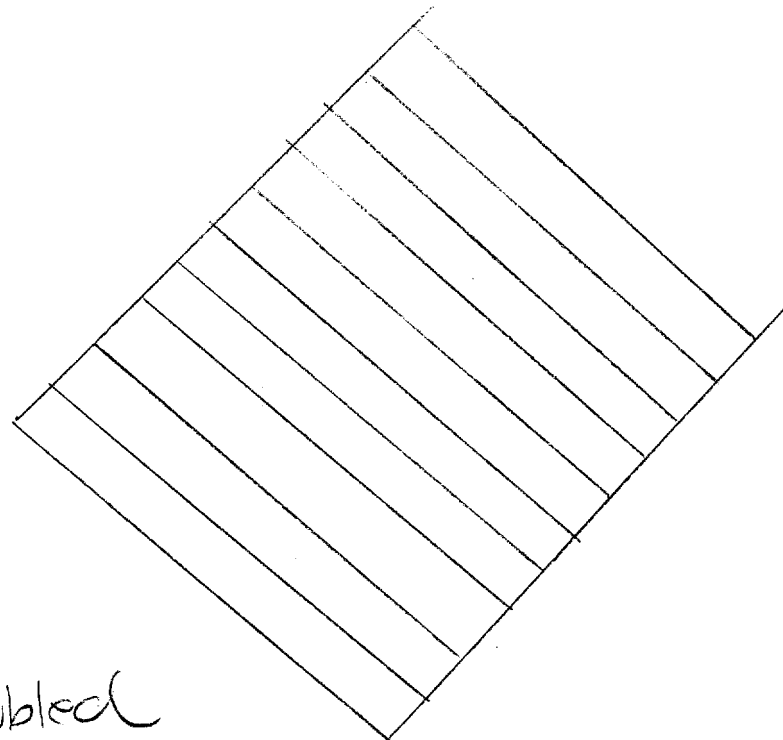
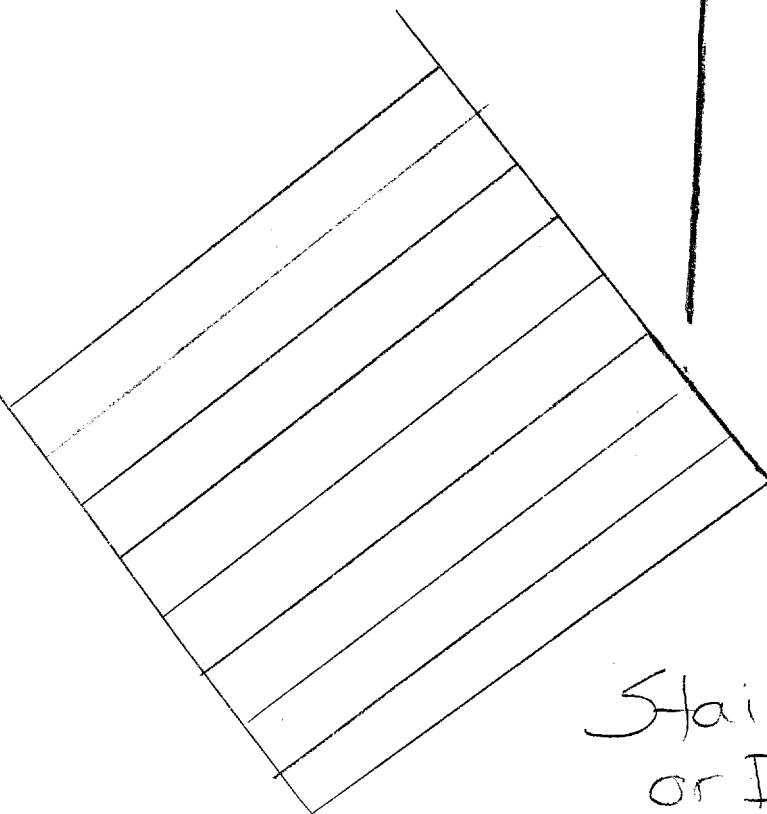

Stairs
or Doubled
Combed
Pattern

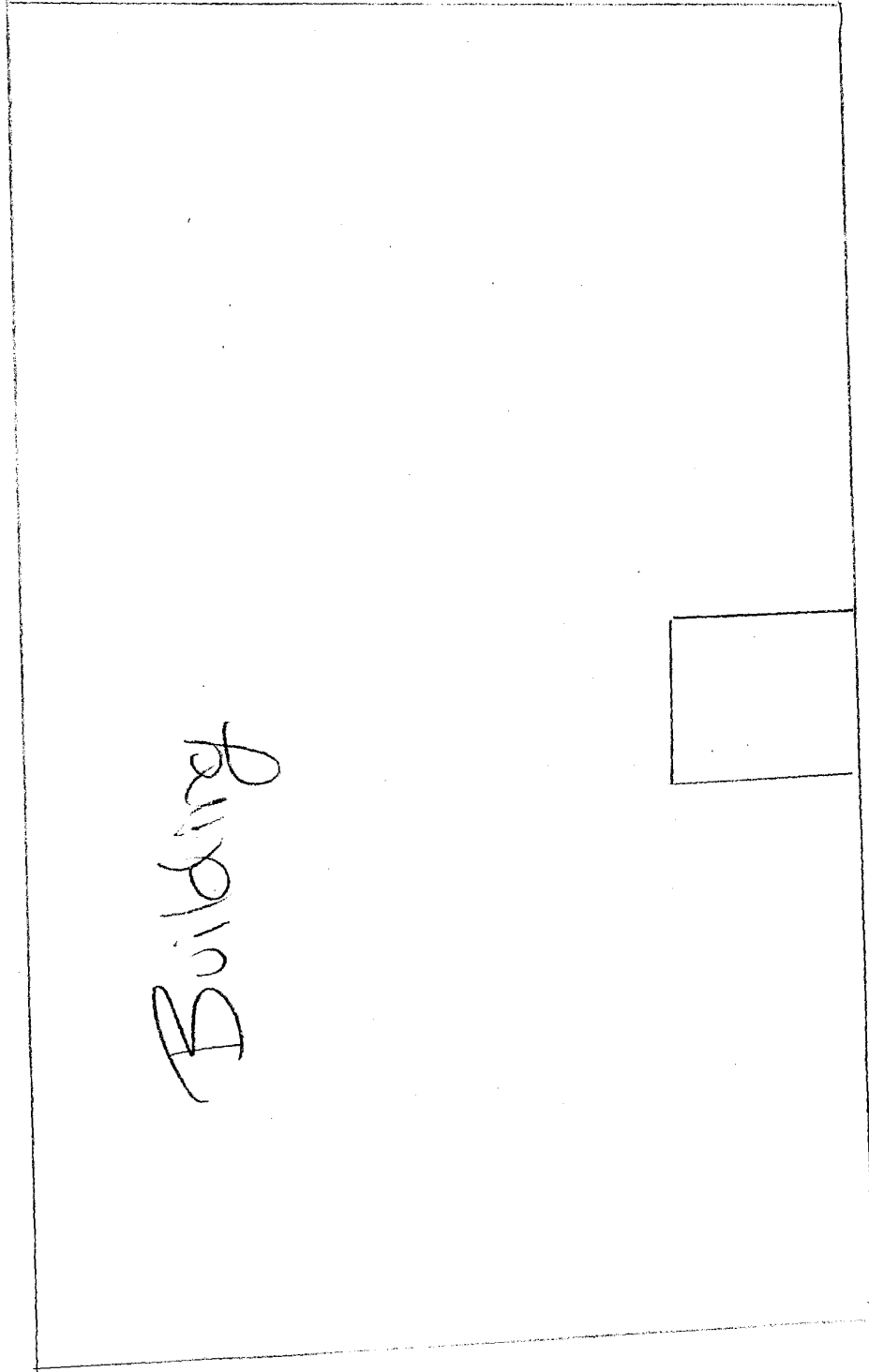

Fence

Building

trip

Railways + Concrete surfaces

*Transient
Activity*

TASKING SHEET

SOURCE NO: 025

DATE: 28 ~~JUL~~ 92

SUSPENSE: 28 ~~JUL~~ 92
1600 HRS

1. PROJECT NUMBER: ~~92-79~~-B
2. METHOD/TECHNIQUE: Method of Choice.
3. BACKGROUND: Two witting DIA travelers acted as beacons on Monday, 27 July 1992. Copies of photographs of the beacon persons are made available for your use/information.
4. ESSENTIAL ELEMENTS OF INFORMATION:
 - Describe the key features of the single selected target visited and observed by the beacon persons on Monday, 27 July 1992.
 - Describe the immediate surroundings of the beacon persons while they are on target.
 - Submit sketches in support of your findings.
5. COMMENTS: Optional Coordinates: 841375/159276.

BEACON PERSONS

SG1J

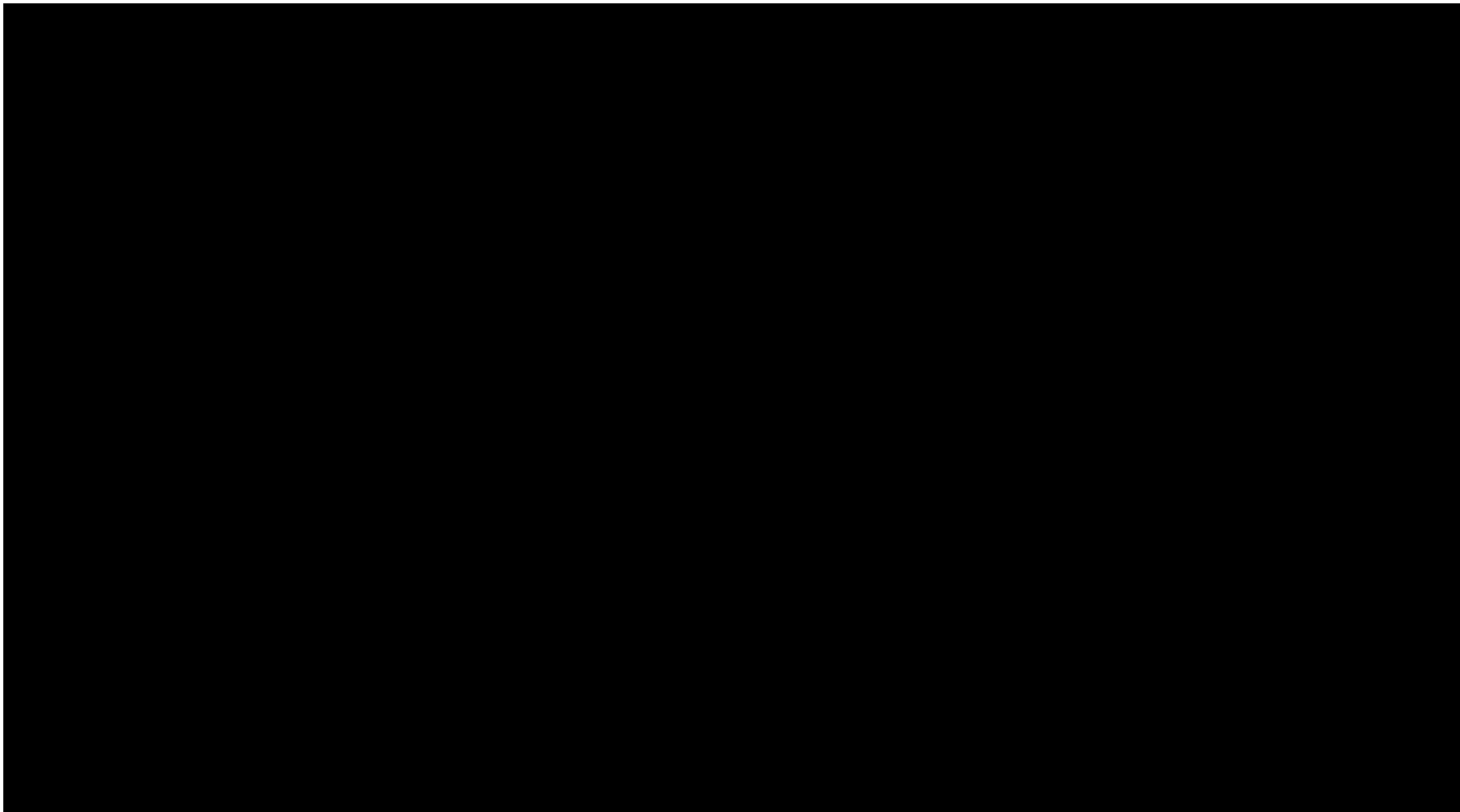

PROJECT: 92-79-B

DATE OF BEACON ACTIVITY ON TARGET: 27 JUL 92

DATE OF SESSIONS: 28 JUL 92

SOURCE 025:

----The target is a building of historical significance.

----It is comprised of several floors and is located in the vicinity of an airport.

SOURCE 049:

----The target involves the presence of a large hall in a huge cathedral/temple type atmosphere.

----There is cultural significance attached to the building and its contents - paintings - artifacts - memorabilia (olympics?).

SOURCE 079:

----The target is a structure that apparently was made of marble.

----The structure was partially opened and provided access to water.

----People were present - there was a great deal of motion at the site.

GENERAL SUMMARY:

The target appears to be a structure whose configuration and significance is described differently by the individual sources.