

SRV 001 NOVEMBER 1986

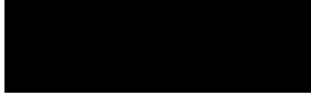

Site involves a land/water interface. Strong suggestion of ocean/sandy beach with windblown dusty-green vegetation inland. Sense of being an island; feel of isolation, abandonment, and remoteness. Important to the site is a man-made, metallic structure which is tall, vertical in orientation, rounded, curved, with angles, old (been there for several years without exterior care), decrepit, rusty colored, with compartments and rooms, interior, without windows. Something associated with the structure is important or valuable; people are looking for it. Structure is near the land/water interface, perhaps in the water itself, though not far from land, and projects up into the air some distance.

003

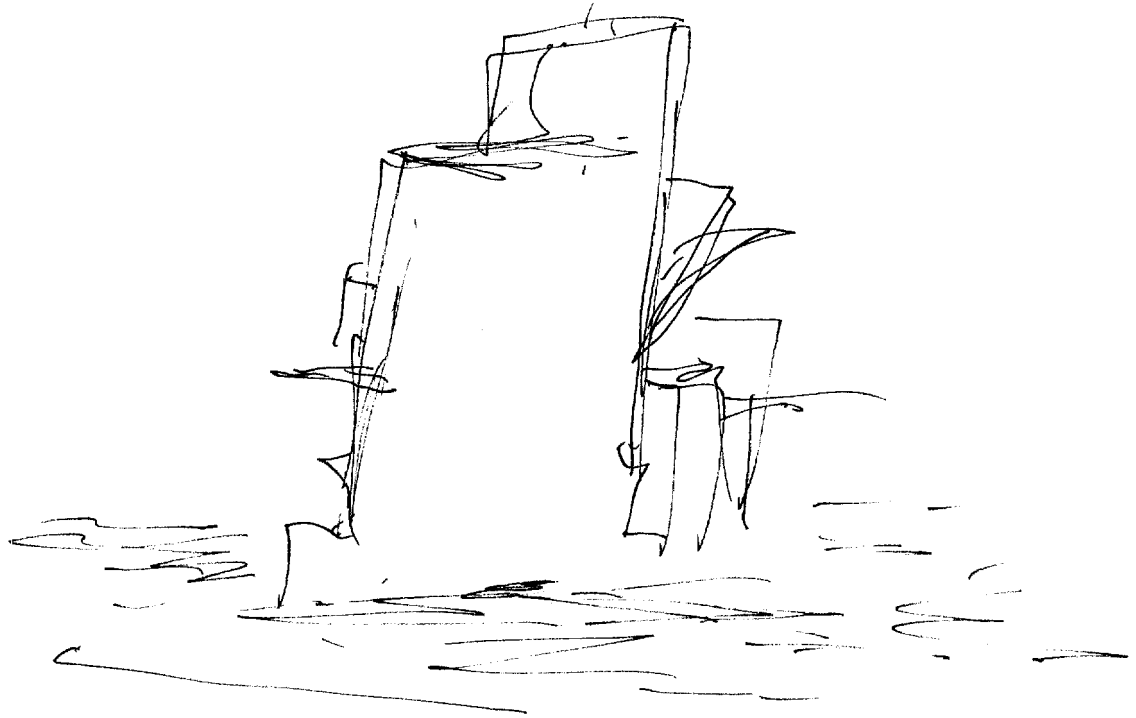

101

Temperature is pleasant, area is small city, village. Middle to lower middle class, but there is pride in community. Some of people here are dark skin (Spanish heritage?). Buildings are of natural materials (adobe?) and most front the street. There is one dark rose colored building set back from street, steps lead to front door. Looking from street there are balconies on left with white wood railings (see sketch 1) inside rose building there is a feeling like a boarding house. There is a tall thin good looking woman here with long straight blonde hair and very sandy brown. Upstairs

2

laying on top of bed is a
man, expensive slacks, 40 dollar
shirt and 30 dollar haircut.
Man is caucasian.

Outside in the street
there are occasionally
animals, maybe burros or
donkeys.

I sense or see No
activity going on other than
pretty girl walking + expensive
man laying on bed

SK 2

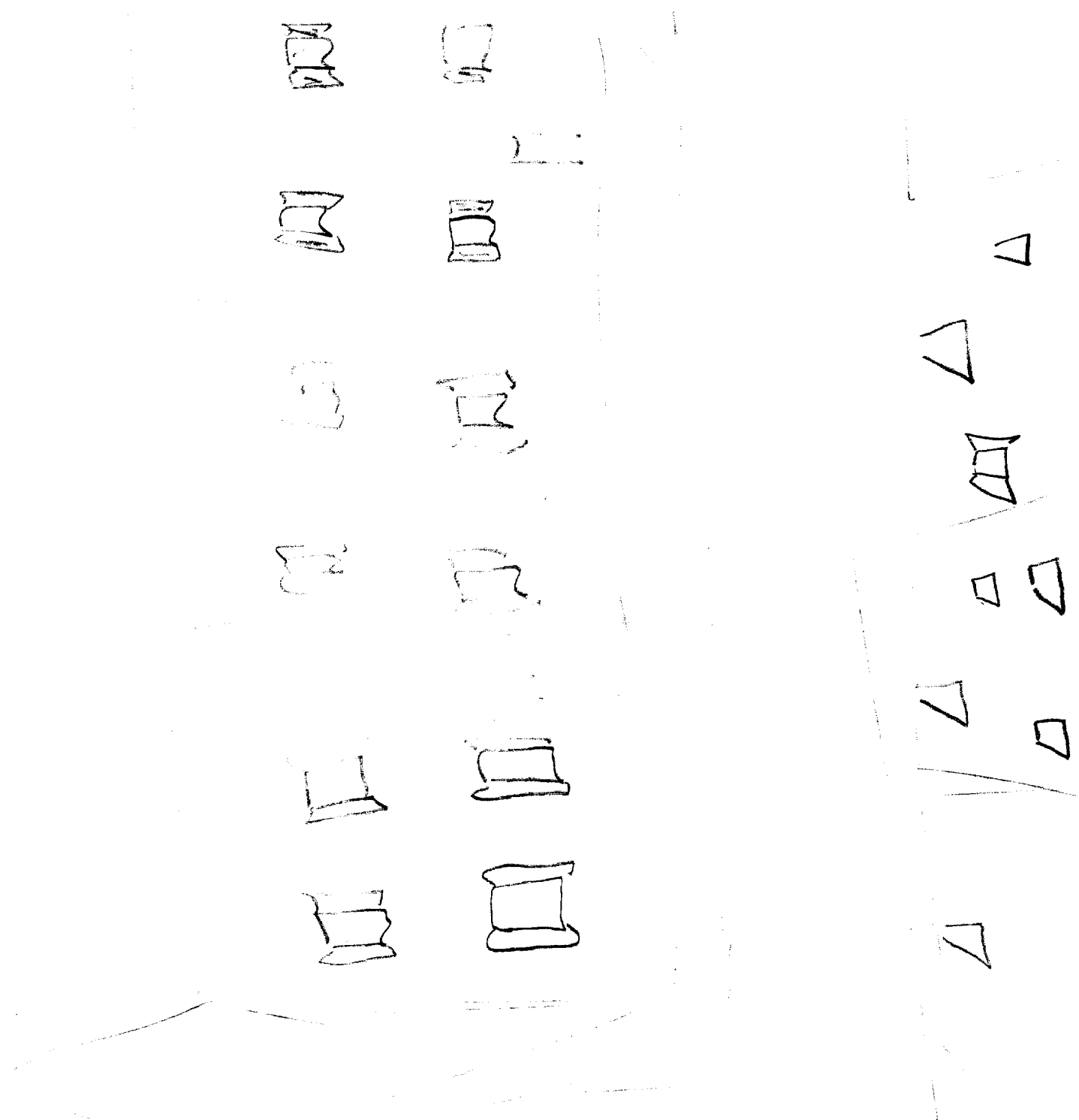

SK # 1

DARK
PIVOT

WHITE
TRIA

BALCONY
WOOD
RAILING

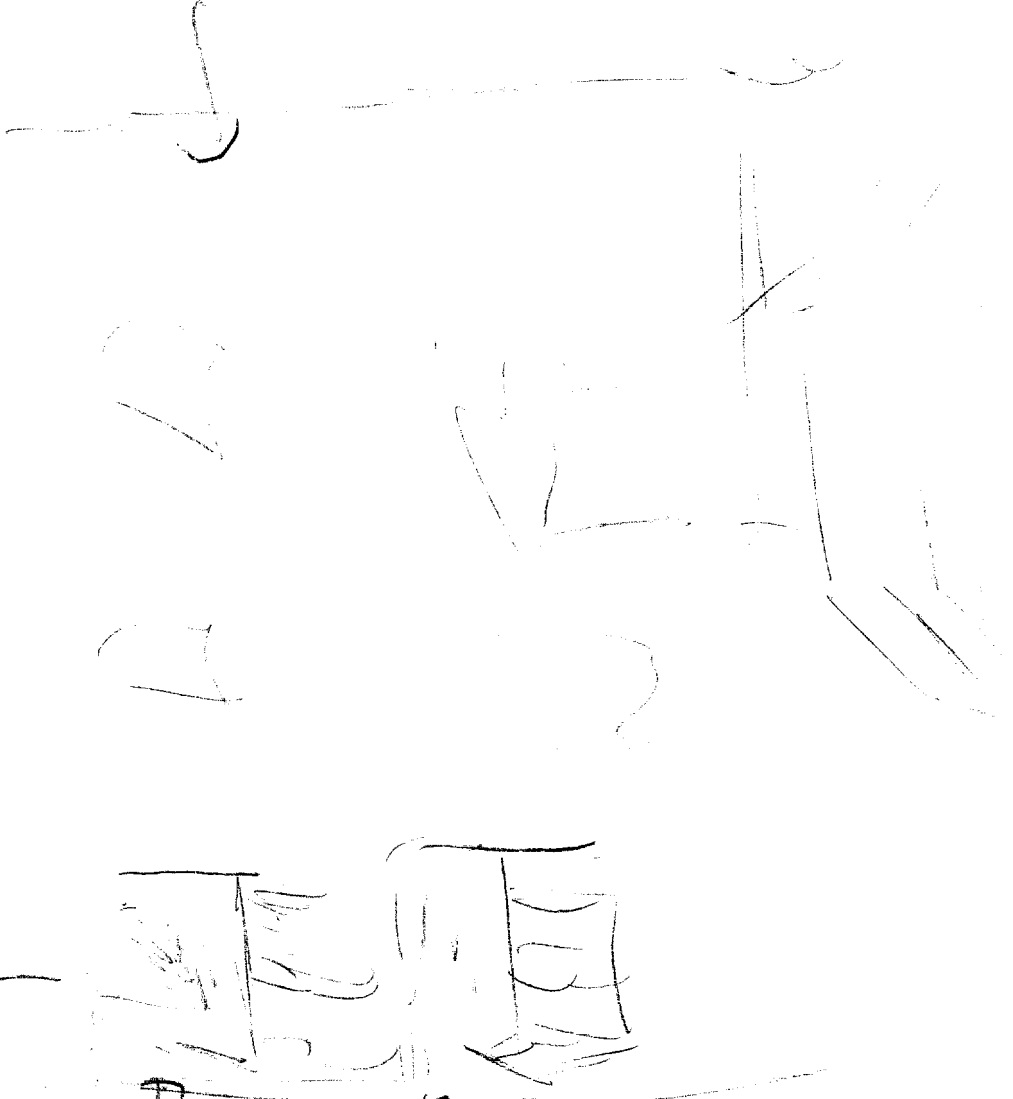

Source # 21

There is a sense of two totally different landscapes. The first is a very hot and arid area. Bright glaring sunlight. Hills in the distant background. The soil is sandy and there is very little vegetation. It makes me feel very languid.

The second is a darker (almost ominous) place, cooler, almost cold. It is also a mountainous area, but very green with vegetation and the mountains give off a black/gray appearance. There is a body of water - it appears to be a lake or river feeding into a lake. There is a large, old truck-like building with many chimneys or smoke stacks and what seems like chutes (chutes) on the outside.

Approved For Release 2000/08/08 : CIA-RDP96-00789R002000780004-1

There is a third perception of moving
earth, (AOL) like a mud-slide.

The first scenario is also near a
body of water but this brings a more
slimy taste.

Approved For Release 2000/08/08 : CIA-RDP96-00789R002000780004-1

Approved For Release 2000/08/08 : CIA-RDP96-00789R002000780004-1

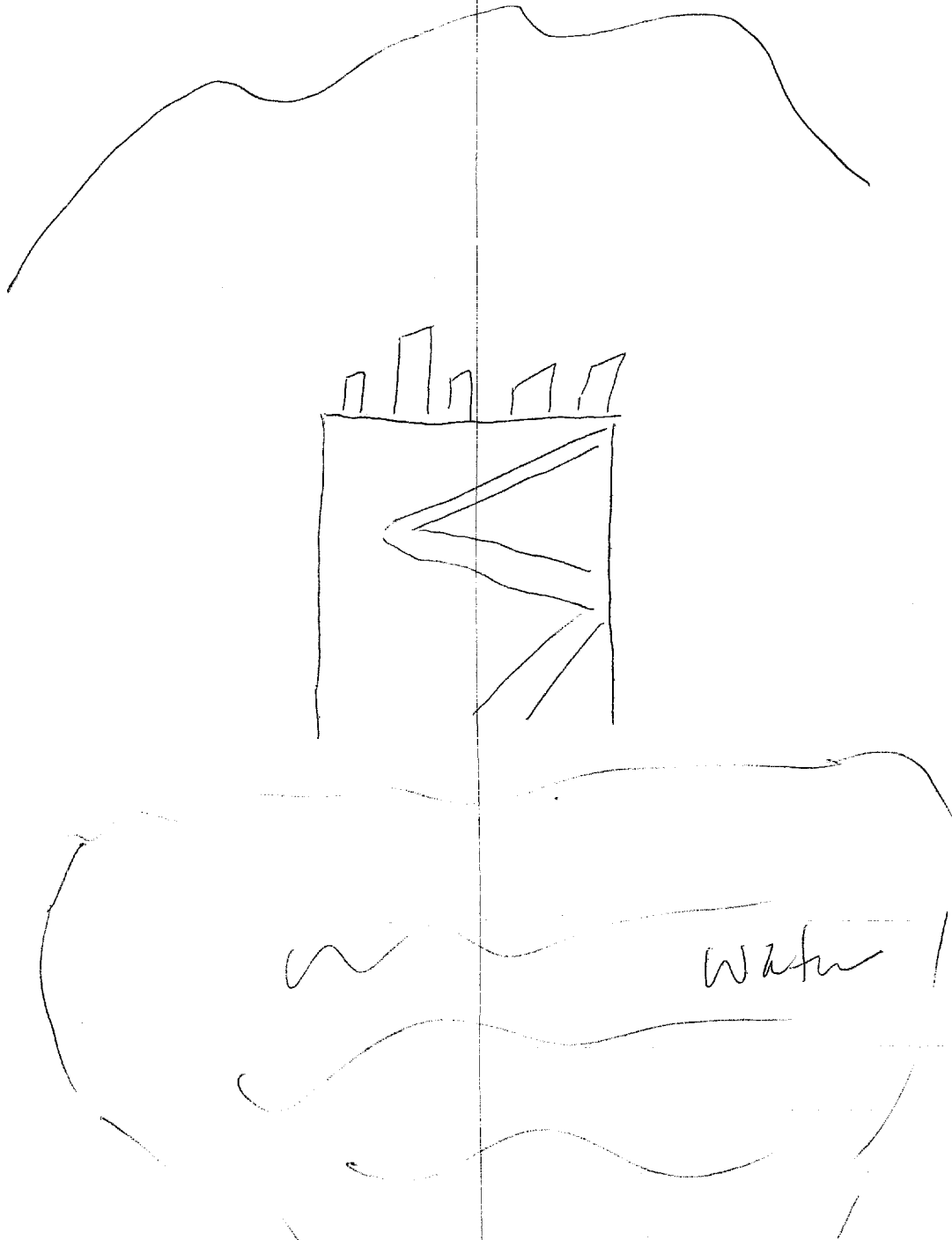

Approved For Release 2000/08/08 : CIA-RDP96-00789R002000780004-1



011

1.

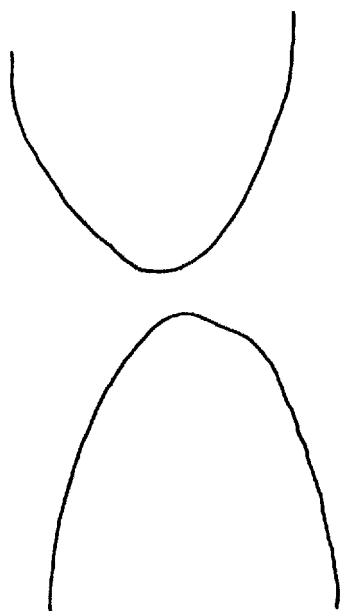

a meeting or
"coming together"
of two elliptical shapes

2.

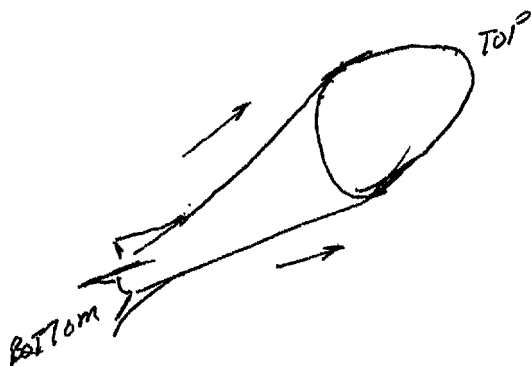

very tall, man-made
cylindrical object

smooth
metallic
slender
fall
movement

ACL-like rocket or missile

3.

coming together
moving
orbit
energy
radiating/radiation
cobalt
blue

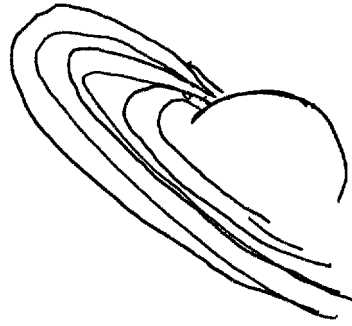

AOL-like
Saturn with
rings and asteroids
orbiting

4.

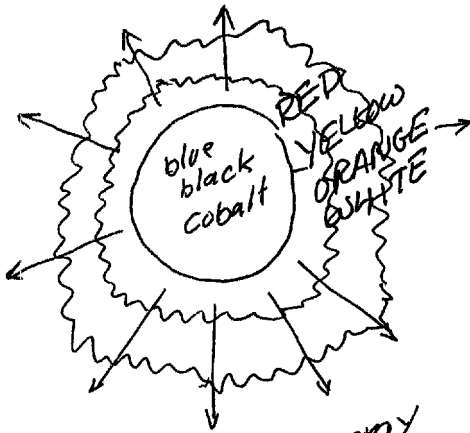

energy
halo
radiating

END 1530hrs