

Paul
26 June 86
F. Wood, and
Ed
09:21

from 1,000 feet
something should

Confusion level

from 1,000 feet up
something should
be visible

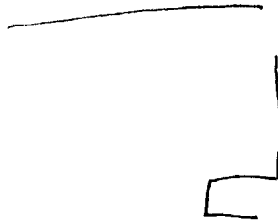

A. more
to
Confusion level

1,000 feet
up.

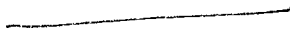

A. arms
flat
has

B. level

A. spiraling
around
hard/any

B. wire

ALL BK wire

1,000 feet up

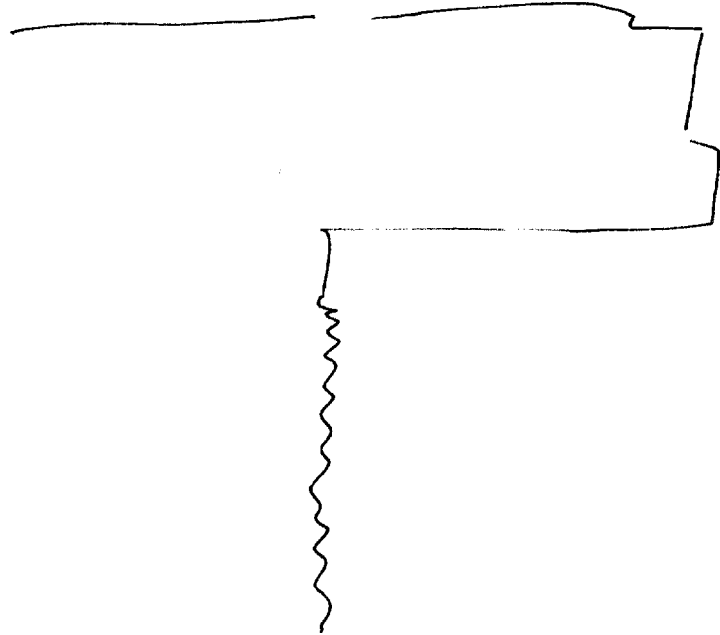

A - area
 flat
 trap
 B. lens

A. cavity above
 sword
 head
 wren
 B. sword

A. along with
 along
 with
 along
 Sulu

B. Sulu

A. area
 flat
 trap

B. suspicious local

1,000 feet up

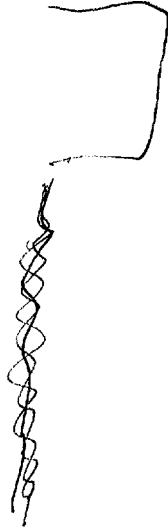

A. lines
are
solid
B. structure

A.
miss break

1,000 feet up

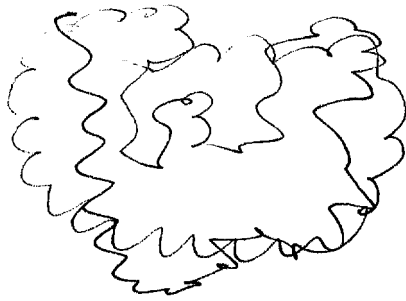

A. moving
around
solid

B.

From 500 feet up
Something
should
be visible

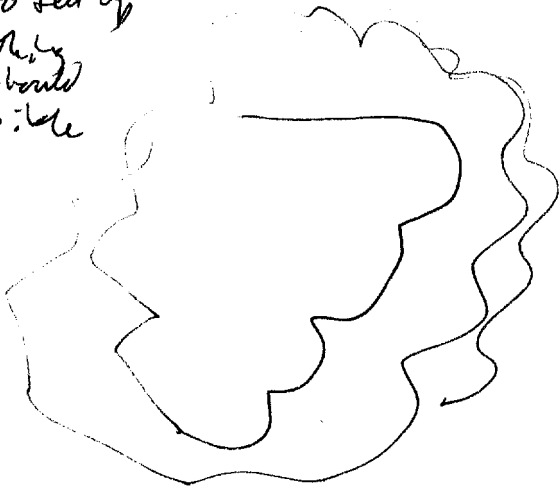

A1 Bk
Chilly

From 500 feet up
Something
should be visible

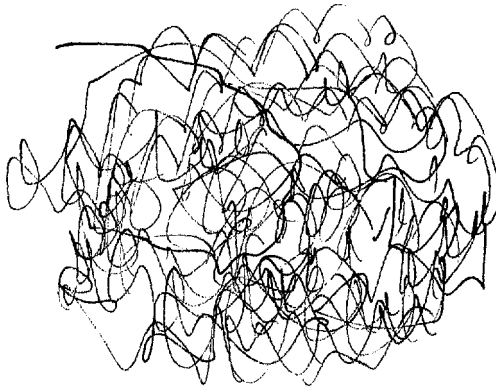

A. around
intercomer
cold/air
moving
B. activity

red
orange
brown
yellow

Sounds

wire sounds

filzigly smell

hot shell

dry taste

warm

muffled sounds

snop, pop sounds

high pitched "woop" sound

open

raised up

spread out

A2 Bk

tense, excited

anticipatory

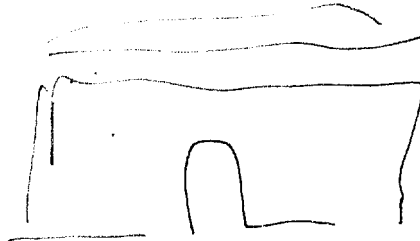

AOL Bk
parade field
at
Heidelberg

S-2

D I E I T I AOL ALB

lytic
thumping
noise or
sensation

↓
ARBL
reminds
me of
a thing
idly on
ground

dit
wand
packed
dusty

through
ground

hart,
sweaty

people
in
groups
&
separates

coordinating
getting ready

S2

D

#2

EI

T

I

AN

ALS

structure
builds

reddish
color

masonry

Older

imperial

architecturally
interesting

facade

fast

long

b.g

sense of
venerability
of
long association
and history

object
material

shiny

complicated

sophisticated
well made

S2

D

A7

EI

T

I

AK

ALS

equipment

polished component

close tolerance

precision

special purpose

S42 not self-moveable - must be transported

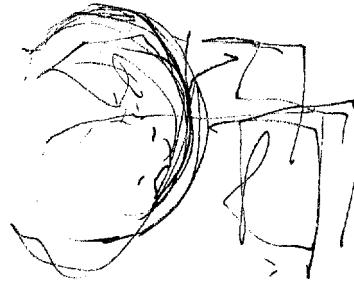

needs

Sharp edge

smooth

Some part dark, & flat in way
Some parts highly reflective & smooth

S 2

D

A 2

F -

T

I

ASC

ALS

9

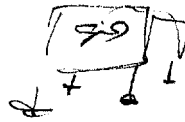

Calibrates
 supports
 adjusts

"levelled"

electronics involved

power cables

motor sounds

generator

directive

S4 1/2 not used very often because so
 specialized. But for the purpose,
 its best tool or thing for job

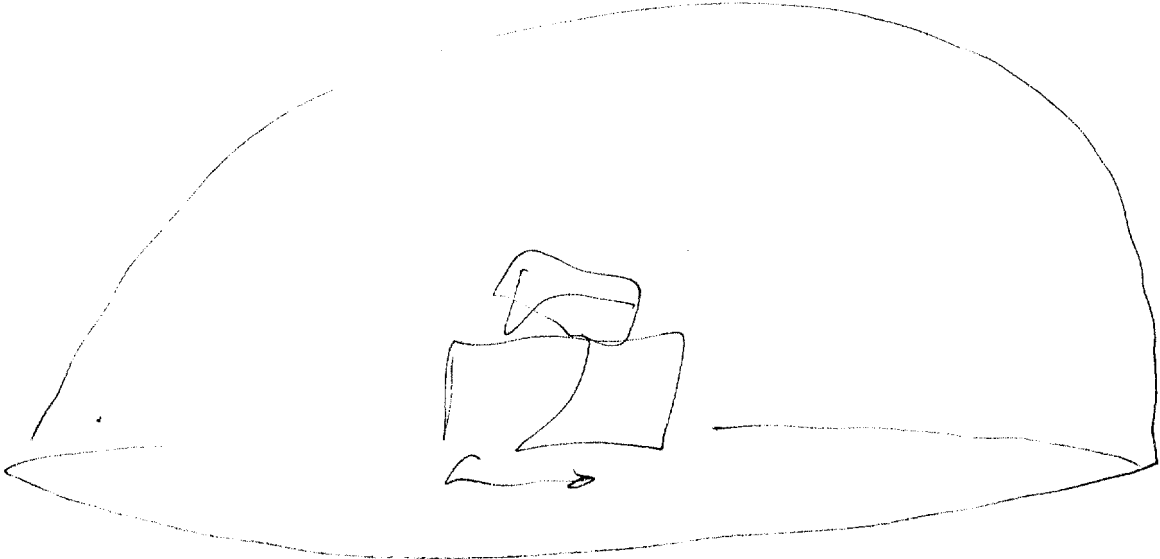

S2

D AI EI T I A/L A/S

input

electro
magnetics

direct do
or
controls
water

~~etc~~

communications
link

high
power
demands
sound

AOL BLK
sound makes
are the like of
electric welds
arc

AOL BLK
of
beam weapon

high
directions

focused

S442 direction can destroy

52

12
ALS

for bk
like vaden

Series of
parabolic
reflector
on list
line feed

vehicle

break

from 5 miles up
should be visible

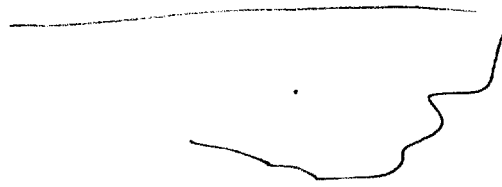

A. across
flat
road

1/3 low

the across
way

flats

B. water

S-2

blue
white
green
brown

cool

brown
yellow
green
rough
fuzzy

warm
dry

bright
glaring
bumpy

fast
with
spread out

to Bk
belong
pleasant

14

Body of water

land

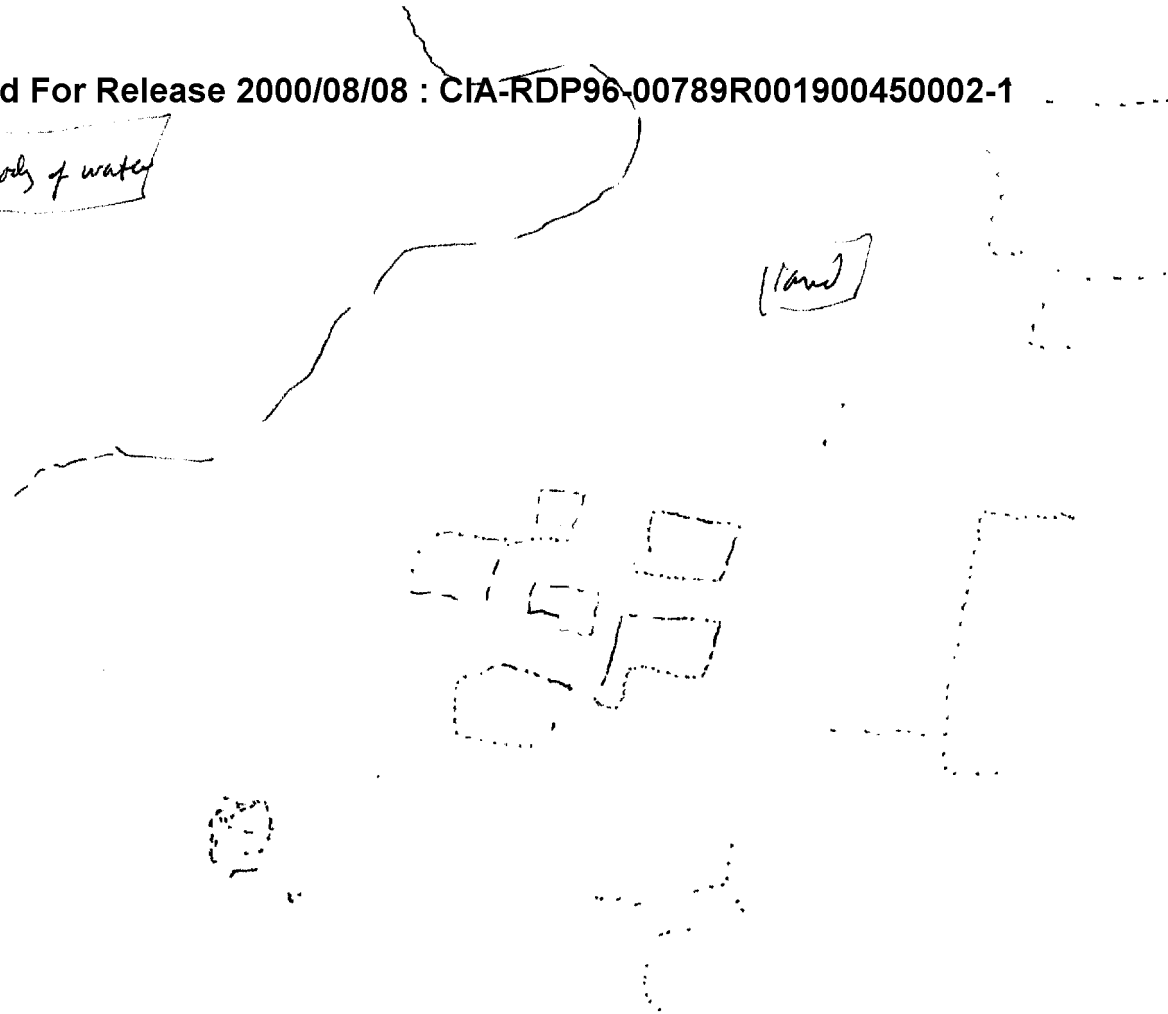

A/S
fields
streams
buildings

hazy

Site is composed of various structures generally across an open area, evincing a "cantonment" feel. Structures (including others perhaps not site-connected) are located in a wide, low-relief area with probable farming fields/activities surrounding. A body of water is nearby over which people at site may have to cross to arrive at objective. Air-transport may be involved in this "travel," but before reaching objective people are back on ground.

An elaborate apparatus involved, which is both dark & flat. It is highly polished, & uses high power input. It involves focusing & high directivity, & has concept of "command link" input.

How best
willow
valley

end 10:40