

~~SECRET~~
WORKING PAPER

890424

V: 032

S: 02

SUMMARY OF INFORMATION

Site consists of multiple structures in several areas of concentration. The predominate material used in the formation of the site and it's surrounding area is that of concrete. This concrete is stretched to a great distance in all directions (see sketch page 2, an overhead from 5000'), but principally to the west and north of the site. There are markings in all directions -- and the layout of the area seems to symmetric; that is, there is a plan to it.

I perceived several A/S, insect like objects looming on the surface of the site. They are positioned in such a way as to form a pattern on the ground. Insect is only a descriptor -- the objects are composed of plastic, tubes, round objects and pipes similar to skids, ski's, or ramps. There was a very strong grease smell associated with this section of the site. The area was dark at the time I was there -- and the temperature was very cold.

From overhead (see sketch page 02) I was able to see several structures that had rounded roof tops with elongated sections. These structures were tied or positioned together and they are considerably larger than the insect like objects described earlier.

After being given the cue "the most unique aspect and function of the site" I perceived the object sketched on page 4. This object has the dimensions of rounded and cone shaped A/S, like a nose cone. I perceived something pushing up on something. It was pushing up on a cap or cover.

I began to have perceptions of foreign, manufactured, built and designed. The object seemed to be locking and airtight -- it was associated with sealing or releasing something. There were also perceptions of military, dangerous, concealed, and hidden. Movement and flight were aspects of the site as well as flame, pushing, thrust, burn, turn and smoke. Further perceptions associated with this part of the site were those of repeated military, weaponry, long range and short range.

~~SECRET~~

HANDLE VIA SECRET CHANNELS ONLY

AD-None
PI-TIRES

RESUME

032
24 APR 89
0910

SZ...

D

AI

I-I

T

I

ACL /AS

metal
BRMS
BRACES
TUBES
PLASTIC

ACL/S
skids
RAMPS
skis

BOLTS
SCRS
WHEELS

Black
Dark
crease shell
cold

Dark

..

1/2

(outside)
Dark ~~was~~ insect like object, Exposed former
cant make it out cleared around it.
Other similar objects - positioned --
pattern like - in line in sequence -
Assigned places.

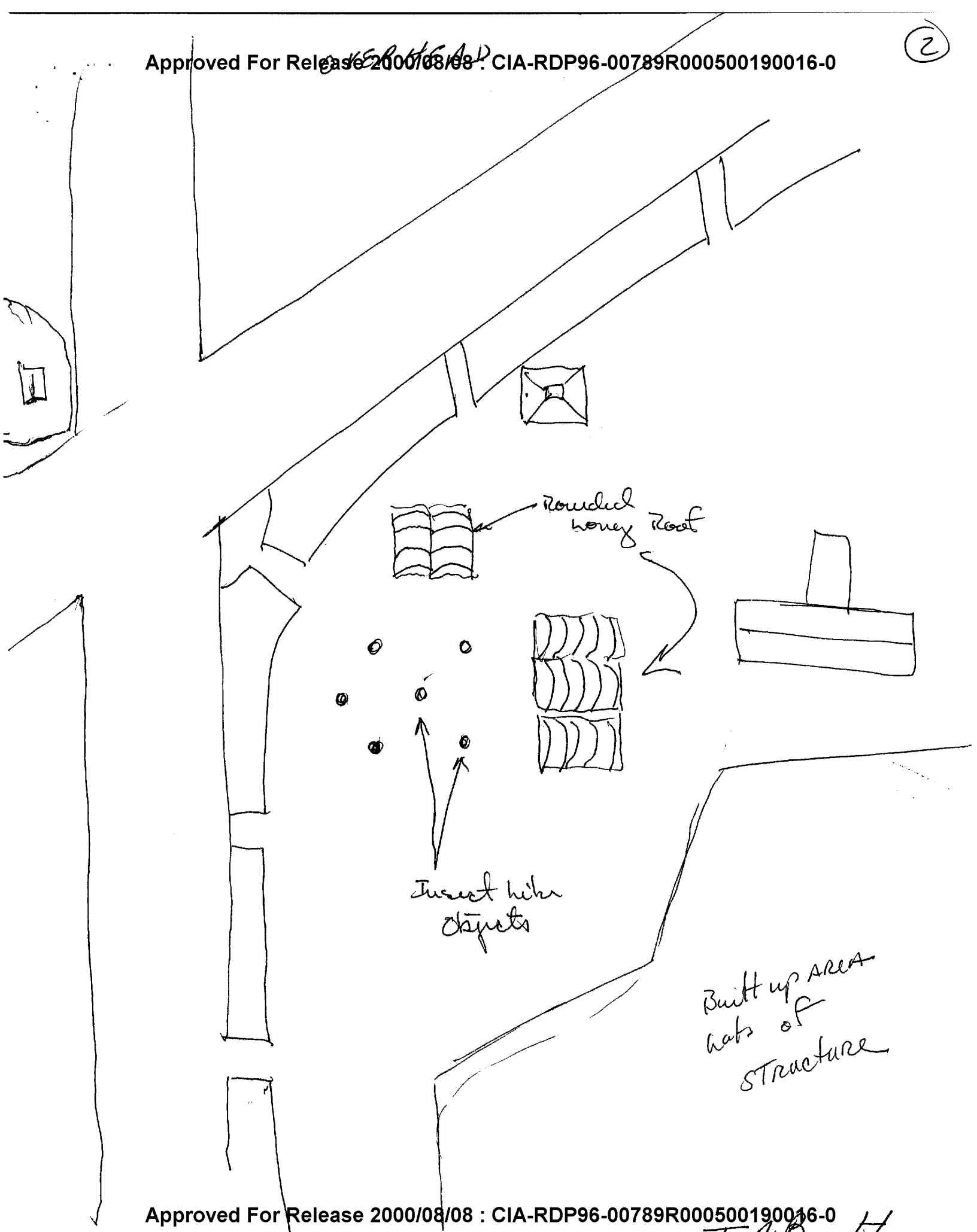

B2

D

AI

EI

T

I

AOL/AS

From 5000'
up.

Rolling
Roofs

Rounded.

long
Together

flat

open

Barren

Bumps - Bumps

AOL Break
AIRPORT

SZ

D

AI

EI

T

I

ROL/AS

[most unique
ASPECT AND
FUNCTION]

Silver
Black

Round
cone
nose
cone

4 1/2 something pushing something up -- A cap
A cover

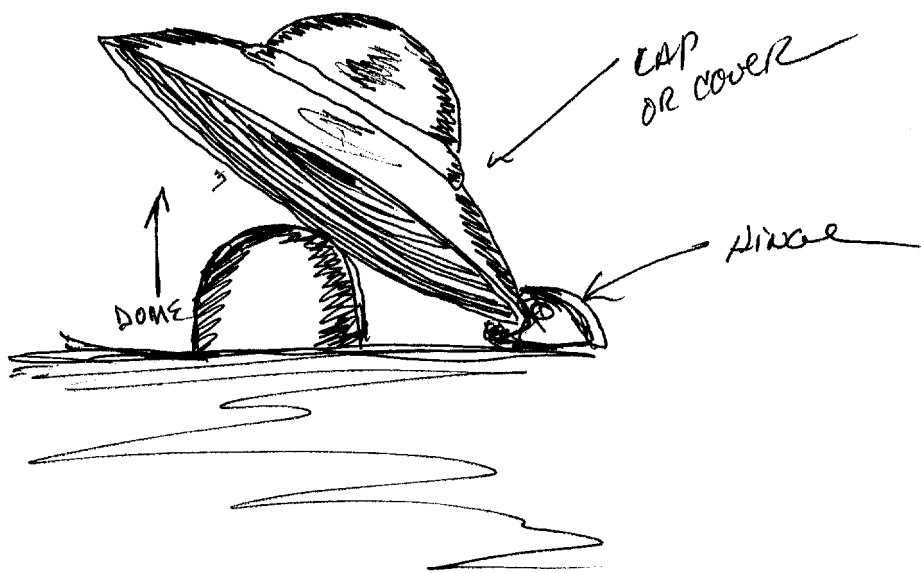

Foreign
manufacturer
Built
Designed

5

STAGE 6

SZ > AE EI T I AD/AS

silver
hard
smooth

AIR TIGHT
locking
Release
Seal

metallic
metal
Rubber,

hidden
concealed
Suspicious

movement,

Doc Break
Weaponry.

Flight

ADL/S
AIRCRAFT.

Flame
Push
Thrust
Burn
Turn
Smoke

movement.

military
Foreign
- Object

Black
smooth
rough
char

plastic
Duct

STAGE 6

Approved For Release 2000/08/08 : CIA-RDP96-00789R000500190016-0

⑥

52

D

AI

EI

T

I

NOY/AS

military
weapon
long range
short range

men

NOY/S
soldiers
Brake
1015