

~~SECRET~~/NOFORN

PROJECT SUN STREAK

WARNING NOTICE: INTELLIGENCE SOURCES AND METHODS INVOLVED

PROJECT NUMBER: 8914-I	SESSION NUMBER: 3
DATE OF SESSION: 890421	DATE OF REPORT: 890424
START: 1420	END: 1455
METHODOLOGY: SOLO	VIEWER IDENTIFIER: 018

1. (S/NF/SK) MISSION: Describe the most unique aspect and function of the target site and provide an overhead sketch of the target area.
2. (S/NF/SK) VIEWER TASKING: Instructions to viewer to obtain information about the machine which produces the effect in the silvery block described in the last session.
3. (S/NF/SK) COMMENTS: Note sketch page 6. 018 has answered both requirements recommend his role in this project be considered completed.
4. EVALUATION:

HANDLE VIA SKEET CHANNELS ONLY
SPECIAL ACCESS REQUIRED

~~SECRET~~/NOFORN

CLASSIFIED BY: DIA (DT)
DECLASSIFY ON: OADR

~~SECRET~~

WORKING PAPER

Project: 89/41
Date: 890421
Viewer: 01B
Session: 03

SUMMARY OF INFORMATION:

1. A stage 6 "tracker" was made of the "machine" which produces the effect in the "silvery block" mentioned in the last session (see page 1A).
 - a. (#1 on the tracker page) This point was marked as the beginning of the tracker sketch. It has no special meaning.
 - b. (#2 on the tracker page) A thick metallic plate on one side of a "work" area. The purpose of this plate was not perceived.
 - c. (#3 on the tracker page) The power supply. It is enclosed in a black container.
 - d. (#4 on the tracker page) An enclosed box full of electronic circuitry. There was an impression that over half of this circuitry is specifically designed for accurate timing.
 - e. (#5 on the tracker page) The "working" space (where the silvery cube is placed to be changed. This has a smokey grey plastic cover, for the operator to watch.
 - f. (#6, #7 and #8 on the tracker page) There is a cylindrical apparatus on one side of the "work" area. This cylindrical apparatus is made of a front part (#6 and #7) which is a circular arrangement of bright, metallic rectangles facing outward, with sunken-in areas of a dark, maroonish-brown "waxy" material in between the rectangles. Behind this (on the opposite side from the "work" area) is a cylindrical arrangement of tubes. These tubes do not appear to be a single tube in a helix, but many

HANDLE VIA SKEET CHANNELS ONLY

~~SECRET~~

~~SECRET~~

circular tubes, side by side. There is no physical motion (i.e. rotation) to this whole apparatus.

g. (#9 on the tracker page) The area not already designated by a number appears full of wires, junky-looking equipment (appears electronic), and open spaces, allowing one to see all the way through the machine.

h. There was a general impression that many of the parts of this "machine" have covers, but that they are not used. This appears to be a type of "breadboarded" setup, "kludging" things together to make them work. This is not a machine which one buys ready-made.

i. Another impression (this one post session), was that the "work" area involves a general "field" which is somehow contained, but that the real "business" within that field is a narrow pinpoint area lined up with the center point of the cylindrical apparatus. There was the impression that this narrow pinpoint can be focused.

2. At the end of the session, the tracker page was traced onto a clean sheet to form a more presentable representation (see page 6).

HANDLE VIA SKEET CHANNELS ONLY

~~SECRET~~

018
1420
21 APR
FF. MORRIS
SOLO

P.I. NOW
A.V. NOW

DESCRIBES THE "MACHINE"

SG: (SEE TRACKER, P. 1A.)
S2 D A1 07 ✓ / NOR N/S.

① START POINT

② THICK
METALLIC
HAND
STRONG

PLATE

③ HOT
HUM SOUND
WARM
DUSTY
MAGNETIC VIBRATION
SOLID
BIG
LONELY
WARM

POWER
~~POWER~~
POWER SUPPLY

1A

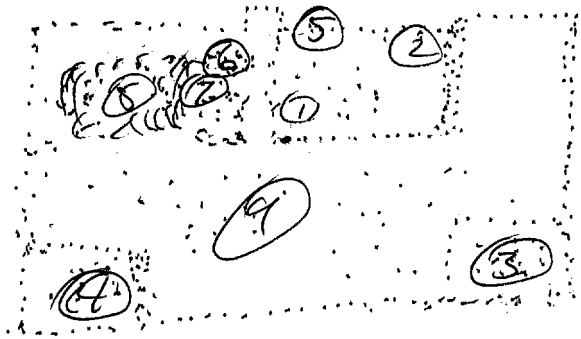

- ① START POINT OF TRACKER
- ② THICK METALLIC PIECES
- ③ POWER SUPPLY
- ④ EQUIPMENT
- ⑤
- ⑥ BRIGHT PIECES
- ⑦ DARK PIECES
- ⑧ CIRCUM TUBES
- ⑨ WINGS, JUNK, "GUTS"

56: (SEE TRACKER, P. 1A)

SL D M J T , AC N/S.

④ BLUE
LT. BLUE
COOL

LIGHTS
SMALL LIGHTS
ELECTRONICS
TUNING
CIRCUITS
ELECTRONIC EQUIPMENT

⑤ CLEAN
SMOKY DARK
THIN
RESILIENT
PLASTIC FOIL

PLASTIC
COVERING
VIEWING

56 1/2 IMPRESSION OF A SMOKY-COLORED CLEAN
PLASTIC COVER TO ALLOW SMN TO ~~SEE~~
WATCH INSIDE.

3

S6: (SEE TRACKER, P. 1A)

S2 D AT OT T, AN W/S.

6 BRIGHT
RECTANGULAR
METALLIC
SOLID
NOT VERY

AL PINK
SURPRISE,
THIS IS REALLY INTERESTING!

S6 1/2 IMPRESSION OF A SERIES OF BRIGHT
METALLIC PIECES ARRANGED AROUND A
CYLINDER!

SKETCH:

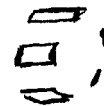

NO IMPRESSION OF WHAT'S IN BETWEEN
THEM

4

S6: (S6 TRACKER, P. 1A)

SL D A1 07 F , A02 A/S.
(IN BETWEEN)
(BRIGHT PIECES)

7 DARK BROWN
MATT/SHINY BROWN
STICKY

A/S LIKE MORTAR
WAX COATING.

SOMETIME SUNKEN IN

S 6 1/2: IMPRESSION OF A STICKY BROWN COATING
OVER SURF:
A/S WIRE COILS

18

CIRCULAR
PARALLEL

TUBES

METALLIC
BRN
DULL SHINE

A02 BRN
LIKE ALUMINUM

S6 1/2 IMPRESSION THAT THIS IS NOT ONE SINGLE

PARALLEL TUBES WHICH ENCIRCLE THE FORM, STRAIGHT.

(5)

S6: (SEE TRACKON, P. 1A)

S2 D AT 07 T, AD N/S.

(9)

S6 1/2 PROBING THE "MACHINE," I GOT THE IMPRESSION THAT THERE MAY BE COVERS FOR PARTS OF THIS THING, BUT TADY KNOWS ON IT. THE ONLY COVER IS THE PLASTIC ONE. LOTS OF OPEN SIDES + JUNKY MACHINERY SHOWING. WIRES - JUMBLES - "GUTS" SOME OPENINGS WHERE YOU CAN SEE RIGHT THROUGH THE WHOLE MACHINE.

SESSION END
1455

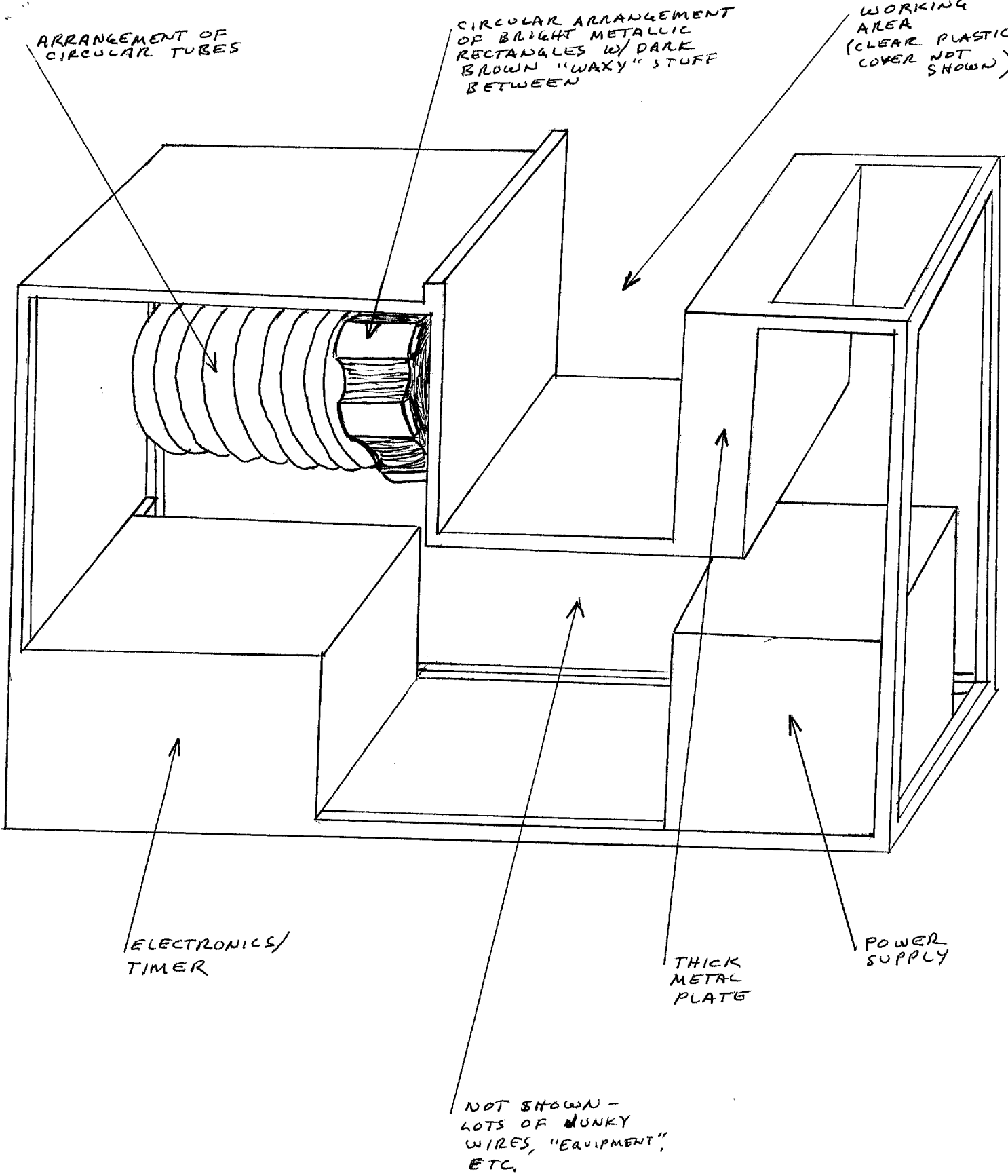

ARRANGEMENT OF CIRCULAR TUBES

CIRCULAR ARRANGEMENT OF BRIGHT METALLIC RECTANGLES W/ DARK BROWN "WAXY" STUFF BETWEEN

WORKING AREA (CLEAR PLASTIC COVER NOT SHOWN)

ELECTRONICS/TIMER

THICK METAL PLATE

POWER SUPPLY

NOT SHOWN - LOTS OF MUNKY WIRES, "EQUIPMENT", ETC.

SKETCH MADE FROM TRACKER MACHINE WHICH CREATES MATERIAL.

PROJ: 8914-I
Viewer: 018
Session: 3