

*J*  
*21 MAR 88*

~~SECRET~~/NOFORN - HANDLE VIA SKEET CHANNELS ONLY

PROJECT SUN STREAK (U)

WARNING NOTICE: INTELLIGENCE SOURCES AND METHODS INVOLVED

-----

PROJECT NUMBER: 8802	SESSION NUMBER: 1
DATE OF SESSION: 11 MAR 88	DATE OF REPORT: 14 MAR 88
START: 1308	END: 1400
METHODOLOGY: <u>CRV</u>	VIEWER IDENTIFIER: 079

-----

SG1B

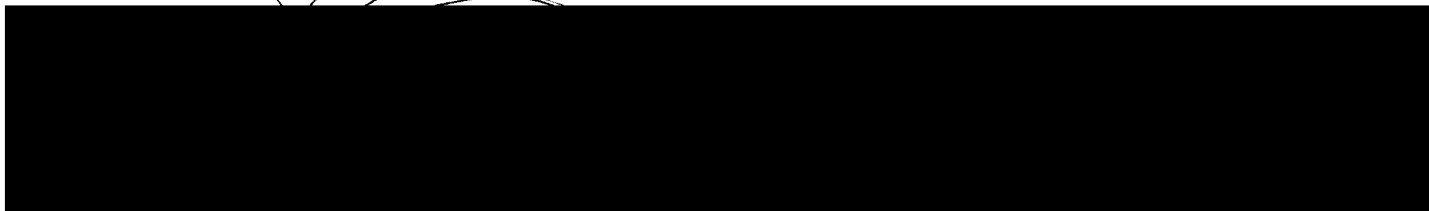

2. (S/NF/SK) VIEWER TASKING: The viewer was informed at the outset that this was to be a "first cut" against an operational target. 079 acquired the target building and was directed to describe activities and things within it. This session was intended to be a general, first impression, of the target area.
3. (S/NF/SK) COMMENTS: Although a little AOL drive was detected by the monitor, 079 did a fine job.

SG1J



CPT, USA

*See following*

~~SECRET~~/NOFORN - SKEET CHANNELS ONLY

CLASSIFIED BY: DIA-DT  
DECLASSIFY ON: OADR

SOURCE 079  
11 MARCH 88  
CRV

DURING THIS SESSION, I ACQUIRED A LARGE, THICK, WIDE, AND VERY LONG STRUCTURE. I KEPT ASSOCIATING "WHITE" WITH THE STRUCTURE. ONCE I WAS INSIDE THE STRUCTURE, I FELT THAT IT HAD VERY THICK WALLS. I COULD SENSE PEOPLE WALKING AROUND. IT WAS A WORK PLACE. THE PEOPLE WERE RATHER QUIET, SERIOUS, AND CONSERVATIVE. I COULD SENSE A LOT OF DESKS, CHAIRS, AND EQUIPMENT.

WHEN I ACQUIRED A CERTAIN AREA WITHIN THE STRUCTURE, I COULD SEE A LARGE, ODD-SHAPED PIECE OF EQUIPMENT SITTING ON A TABLE. I FELT THAT THIS WAS A LABORATORY. I FELT THAT IT WAS STERILE HERE. I FELT THAT THE PEOPLE WHO WORK HERE WERE EXAMINING EVIDENCE AND I ALSO SENSED A LOT OF PAPER WORK. I FELT THAT THE PEOPLE WERE WORKING WITH MINUTE PARTICLES. I FELT THAT THE PEOPLE WERE EXAMINING AND PROBING. WHEN LOOKING AROUND IN THIS AREA, I SENSED THAT IT WAS ROUND OR CIRCULAR AND THE LARGE PIECE OF EQUIPMENT WAS BLACK AND SILVER. WHEN GOING BACK AND LOOKING AT THE PEOPLE WORK, I FELT THAT THEY BEND OVER TO WORK AND THEY GET TIRED QUICKLY. THEY TAKE A LOT OF BREAKS. WHEN GETTING CLOSER AND WATCHING THE PEOPLE, I SENSED THAT THEY HOLD A VERY SMALL SILVER OBJECT AND SOMEHOW PICK THROUGH THEIR WORK SOMEHOW SEPARATING AND SCATTERING SOME TYPE OF SUBSTANCE WHICH SEEMED LIQUIDITY OR MOVEABLE. I THEN HAD THE FEELING THAT THE PEOPLE STUDY AND RESEARCH AND LOOK AT RESULTS. WHEN TRYING TO DESCRIBE THE WORK, I USED WORDS SUCH AS OPTICAL, ILLUSIONARY, BINARY,

COMPULSORY, MOVEMENT, MOBILITY, FLOWING OF DATA, TAKING ACTION,  
CHARTING, MAPPING, EXAMINING.



275  
601  
958  
588

11 March 88  
1308

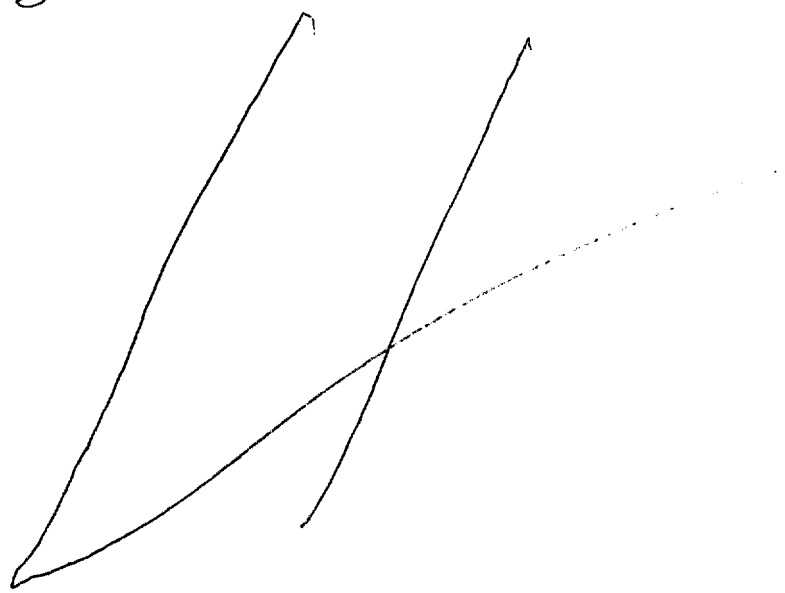

A. Diagonal  
Down  
angle across  
hard  
straight  
smooth

B. Structure.

A. Diagonal  
Down  
hard  
straight

B. ~~land mass~~  
structure.

~~A. |~~

A. smooth  
curving  
rolling up

B. Land

(2)

Stage 2  
Large  
Gummiours  
Spacious.

Browns

Green

Orange

pink

Ad - Energetics.

275607

958588

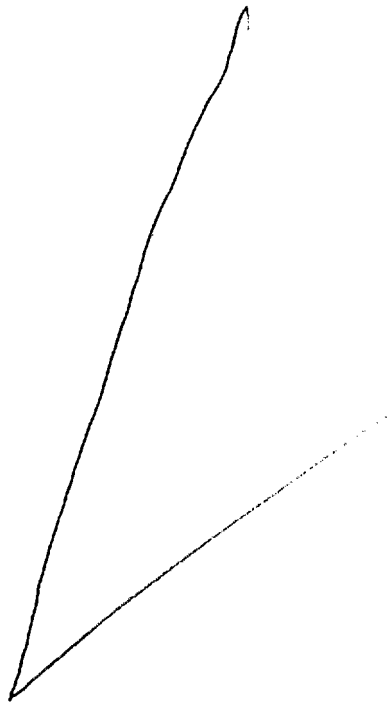

- A. Diagonal down angle across straight hard smooth
- B. Structure.

Stage 2

Large white yellow.

Acute Protection.

wide  
deep  
angular  
sharp  
hort-  
flat  
long

4

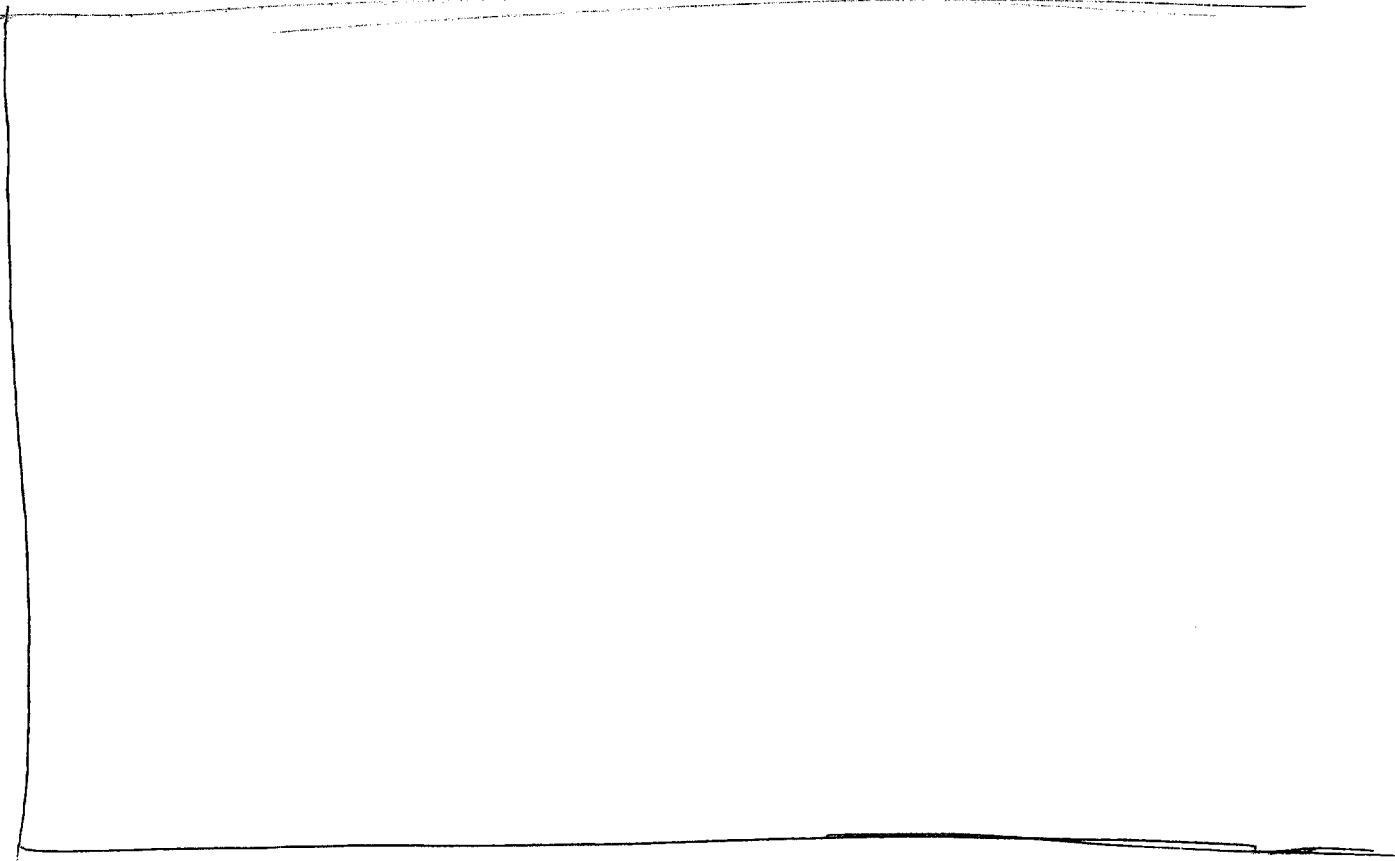

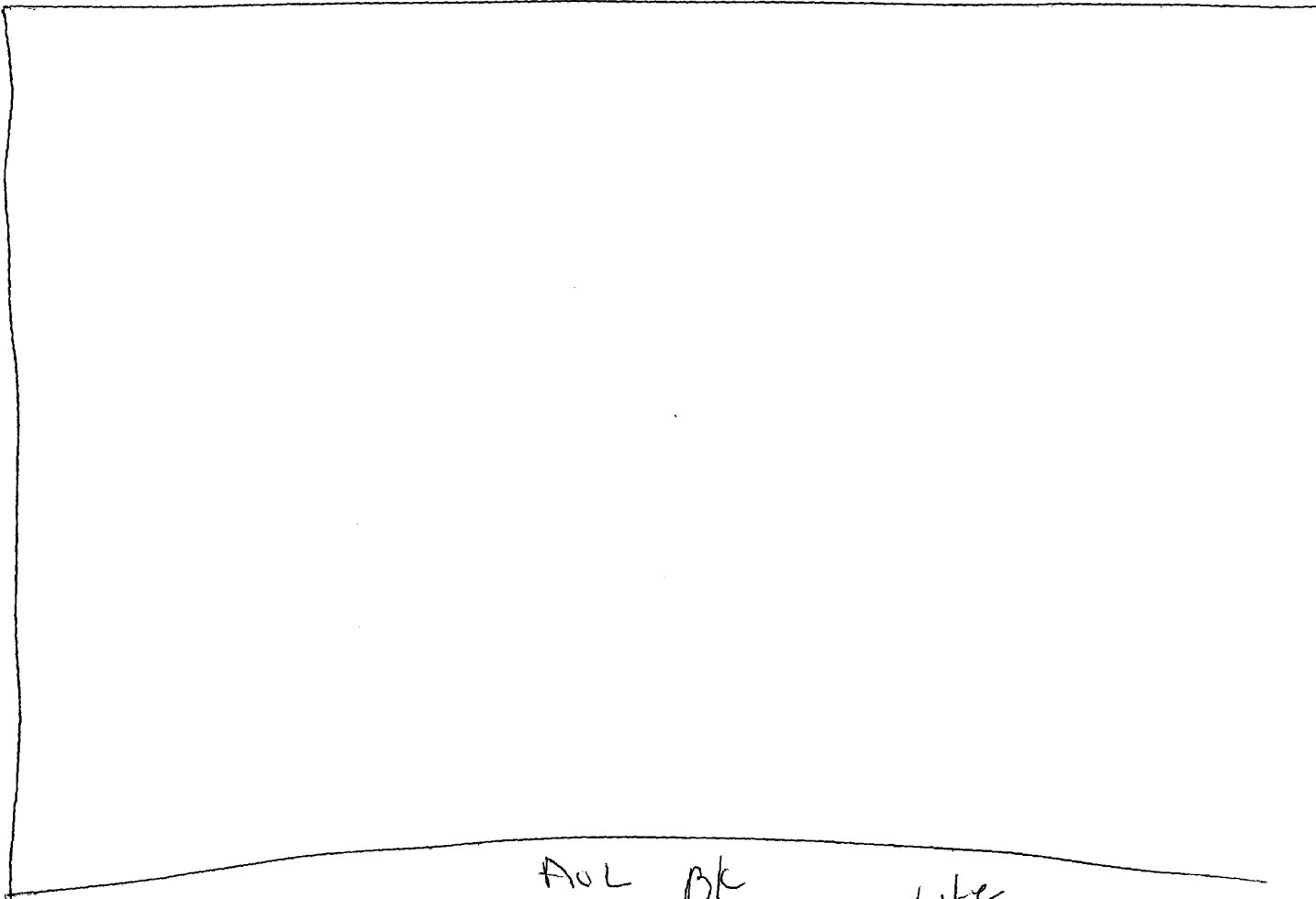

AOL BK  
Like  
a big white  
wall  
|



2

3

Big  
wide  
Deep  
large

white  
liquidity.  
quiet

Inside  
thick walls

serious

people

working.  
~~serious~~  
walking.

sterile  
conseru.

4/2

at walking  
like thei  
numb-  
not feeling.

~~but~~  
do like they  
have business to  
do. but that's  
all.

desks  
chairs  
equipment

Large  
Equip takes up a  
lot of room

black  
silver

S2

AOL/S

Bto

Big  
odd-  
shaped

(8)

black  
silver

~~LAB~~-x-  
ray

Examining  
Laboratory  
4 1/2

working with minute  
particles  
concern with humans  
concern/caring  
studying humans.  
equipment

9

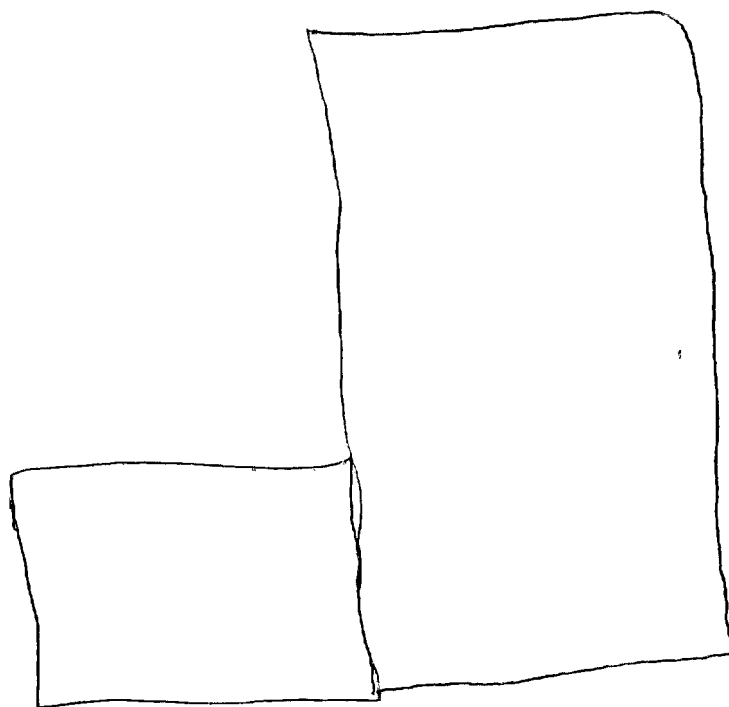

piece  
of  
equipment

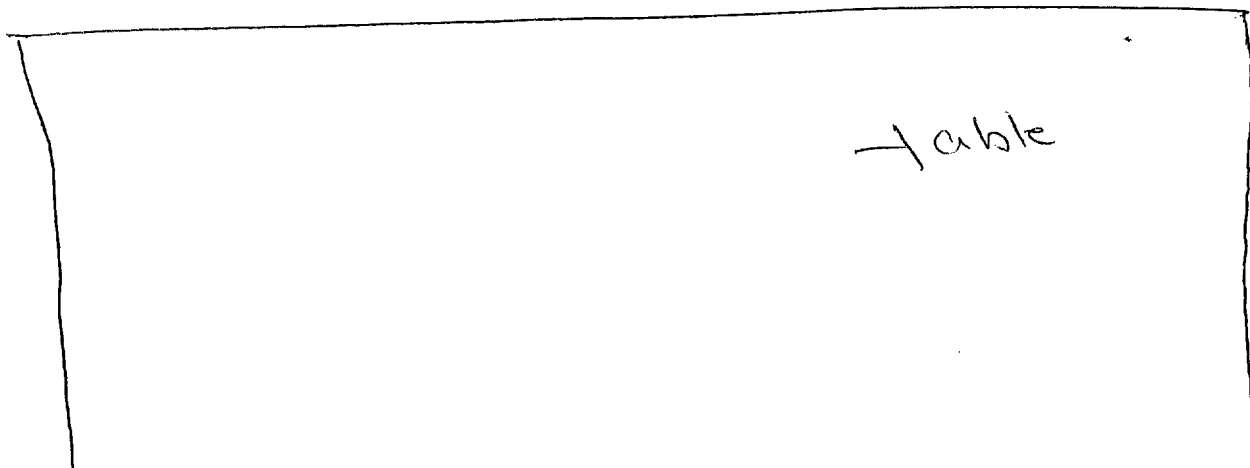

S2

(10)

soft

people

examining  
looking at  
this.

~~fly away~~

people      <sup>to</sup> placing  
                 touching

Fly a  
way

round  
hard  
circular  
core  
center  
colorful inside.

~~Inside~~

Inside

cold.  
blue  
hard  
soft

liquidity

round  
p

probing  
examining.

AcL Bl-

high  
techn.

S2

probing

medical.

12

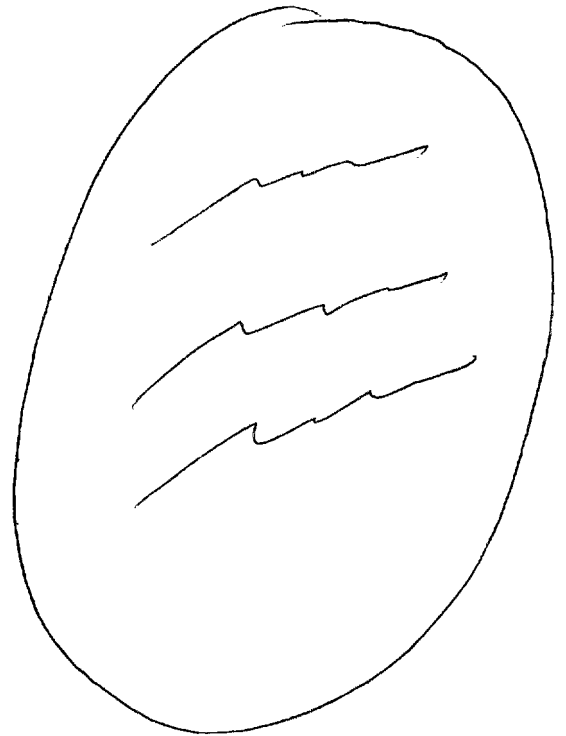
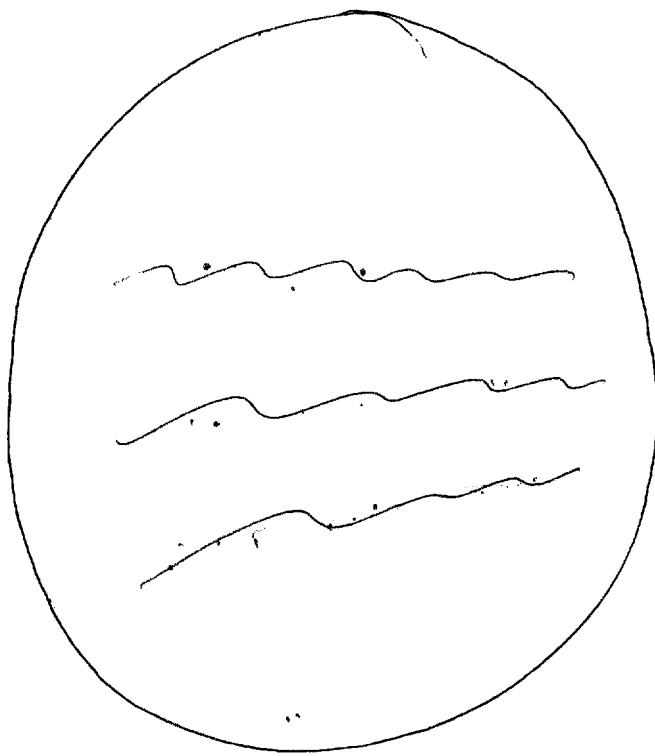

Don't know  
if this is  
a piece of  
equipment  
or if this  
is the end  
result



15

Probing  
objects  
emanations?

5 4 1/2

Small object,  
silver, picking  
through  
separating  
scattering  
object is hooked.

Probing  
Attribute  
Emanations?

silver  
hard object  
small  
hooked  
keeping in line

5 4 1/2

people kept  
over & working  
they get tired  
easily.

AdBk -  
People taking  
breaks &  
then coming  
back to work  
on this issue.

Probing  
Subjects &  
Emanations?

19

~~Probing~~

studying  
researching  
looking at results

Probing  
Topics  
Emanations?  
Lasers.

ALOK  
laser

optical  
illusinary  
binary  
compulsory  
taking action  
movement  
mobility  
flowing of data  
charting  
mapping  
examing.

S2

ACUS

(END Product)

(15)

~~upgrade~~

upgrade  
update  
new

~~new~~

light  
light movement

capturing

ALBT split

new

fast  
movement  
outwards  
Beaming out  
capturing  
SPINNING  
turning  
wisky

seconds