

①

~~SECRET~~/NOFORN-SKEET CHANNELS ONLY

PROJECT SUN STREAK (U)

WARNING NOTICE: INTELLIGENCE SOURCES AND METHODS INVOLVED

CRV Session Procedures Report (S/NF/SK)

```
Control Number : 8704
Date of Session : 18Mar87
Date of Report : 18Mar87
Source Identifier: 003
```

1. (S/NF/SK) Tasking: Received and reviewed this date. Tasking data sheet attached. No other info provided, other than to collect indicators.

2. (S/NF/SK) Session: Source seemed to acquire target immediately, however it appears that he shifted attention quickly from the open area to the associated structures (6 km SW). Monitor moved source back later in the session. Monitor introduced the words "activities" and "test" into S4. Source was continuously instructed to remain in the S2 column in order to keep analysis and AOL to a minimum.

3. (S/NF/SK) Summary: Site is surface and structure. Structure seems to have a unique form, (see S3 sketch). Sense of "oriental"; foreign language. People at the site are in the process of a major rearrangement, "like if you were at NSA and realized that to better accomplish your particular mission you would need to completely move all of the equipment from one room into the next, and all the equipment there into the next room...and so on, so that it would be weeks before it was all organized and functioning again". People here are aggravated, frustrated, annoyed and tired; they feel that the routine has been unnecessarily disrupted and they are disgruntled at having to do extra work (which they are not normally required to do). [Note: Source #003, by his nature, probably has good "empathetic contact" with these people]. New equipment and crates are present within the structure, old equipment outside. There is a large, flat surface that is part of the site. It has to be open and spacious (for some reason), (AOL-"like a gunnery range or nuke testing range"). There is a vehicle (possible tracked) moving around the area. The purpose of the area is for trials or testing. The area is rocky/gravelly, brown, gritty, warm and windy. It is smoothed out (as if leveled or graded) periodically. [Note: Strong source AI of "exposure" connected with being "fixed" (movement exercise) at the center of this area; (AOL-"biochemical or

~~SECRET~~/NOFORN-SKEET CHANNELS ONLY

CLASSIFIED BY: DIA-DT
DECLASSIFY : OADR

~~SECRET~~/NOFORN-SKEET CHANNEL ONLY

nuclear tests"1. The "test" (introduced word) involves the following concepts: Three vehicles--assessing, protective, observing, carefully controlled; The activity must be observed from a distance. Just prior to it, a few people and vehicles are present in the area, but they must then depart. There is a sharp vibration, a puffy cloud (translucent green) with associated ammonia-like smells (AI-"feels like my eyes are watering" and "stingy nose"). The activity produces a (possibly) circular, black, crumbly patch on the ground. This patch is subject to scrutiny by a group of people who walk around it, pointing, discussing, considering, measuring, examining, recording, analyzing, learning, and adjusting. Towards the center of the activity area are a few proportionately small structures (among them a tower) and objects together which serve to monitor and/or possibly initiate (the activity). (See source sketch of the area, p.14).

4. (S/NF/SK) Feedback: Source was informed that he had acquired what seemed to be the (correct) target.

SG1J



CPT, USA

~~SECRET~~/NOFORN-SKEET CHANNELS ONLY

Project FY 8704

Interview, Monitor Tasking

1. Describe the area (purpose of) located vic:

SG11



↳ (check w/ops to see if any details are in any) ↓

2. Describe the structure(s) located 6km SW of the above area.

personnel, activities, equipment, etc.

3. to be announced

Fahl
18 March 87
F. M. ...
Ed
10:19

SG11

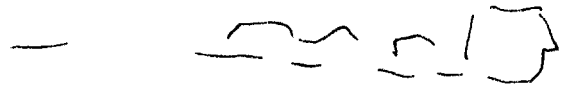

miss break

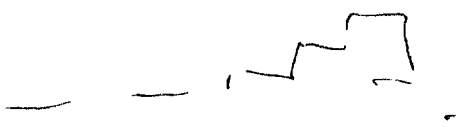

A. along
top
hand

B. Super

A. more
fug
split

B. low

A. and
around
and
up and

split

B. starts.

52

with
green

Feb

grey
brown
rough
piddly
Slaly
bumpy
Smoothly
Cold

warm
pleasant smell
aromatic
white
around
angled
large
windy

A1 BK
mildly int. mis dated
uncomfortable

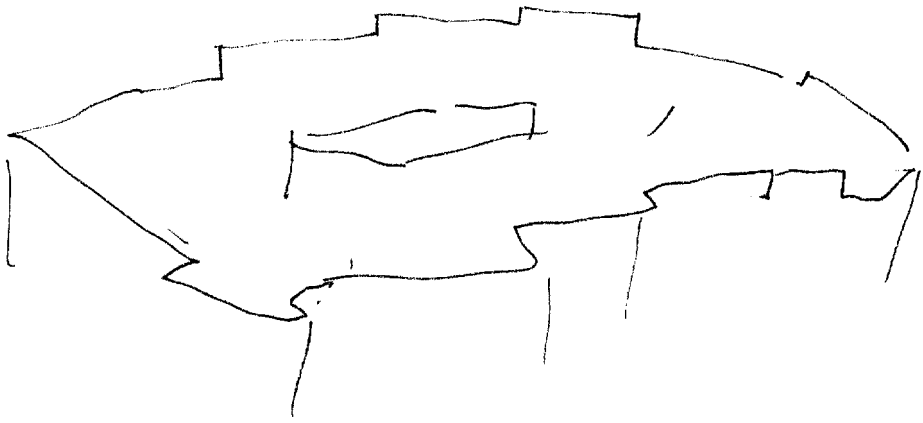

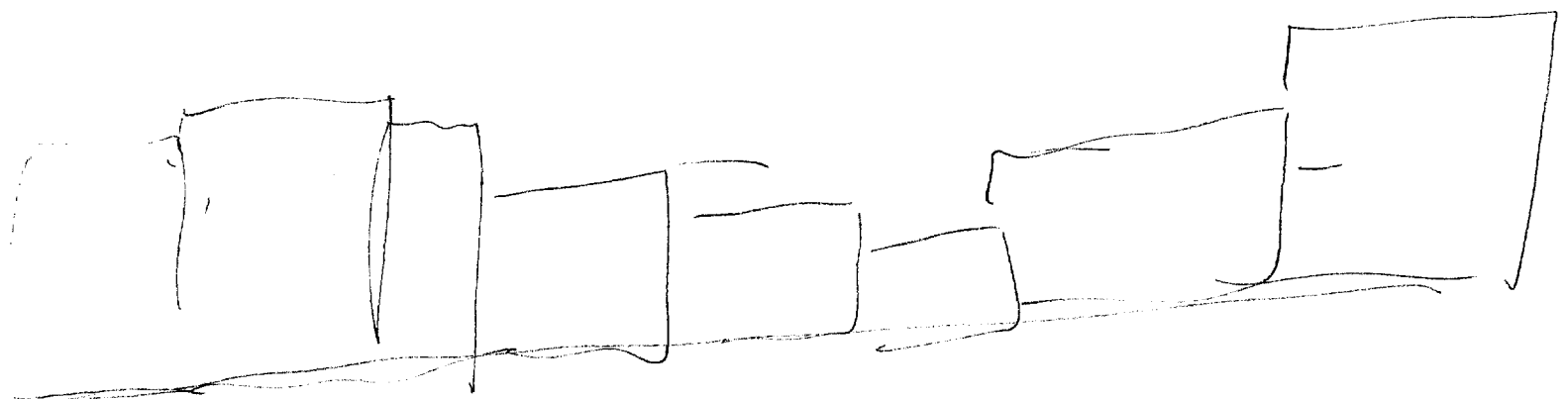

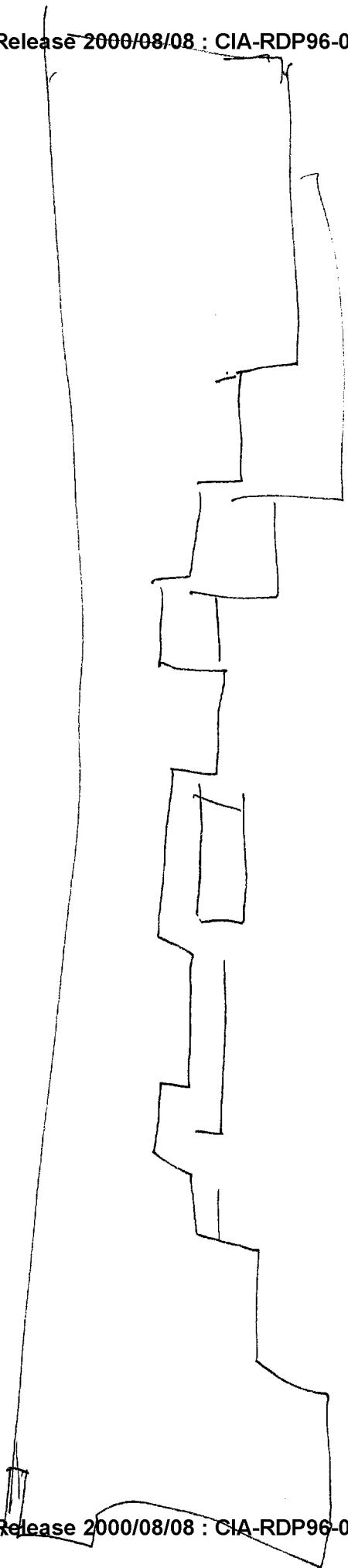

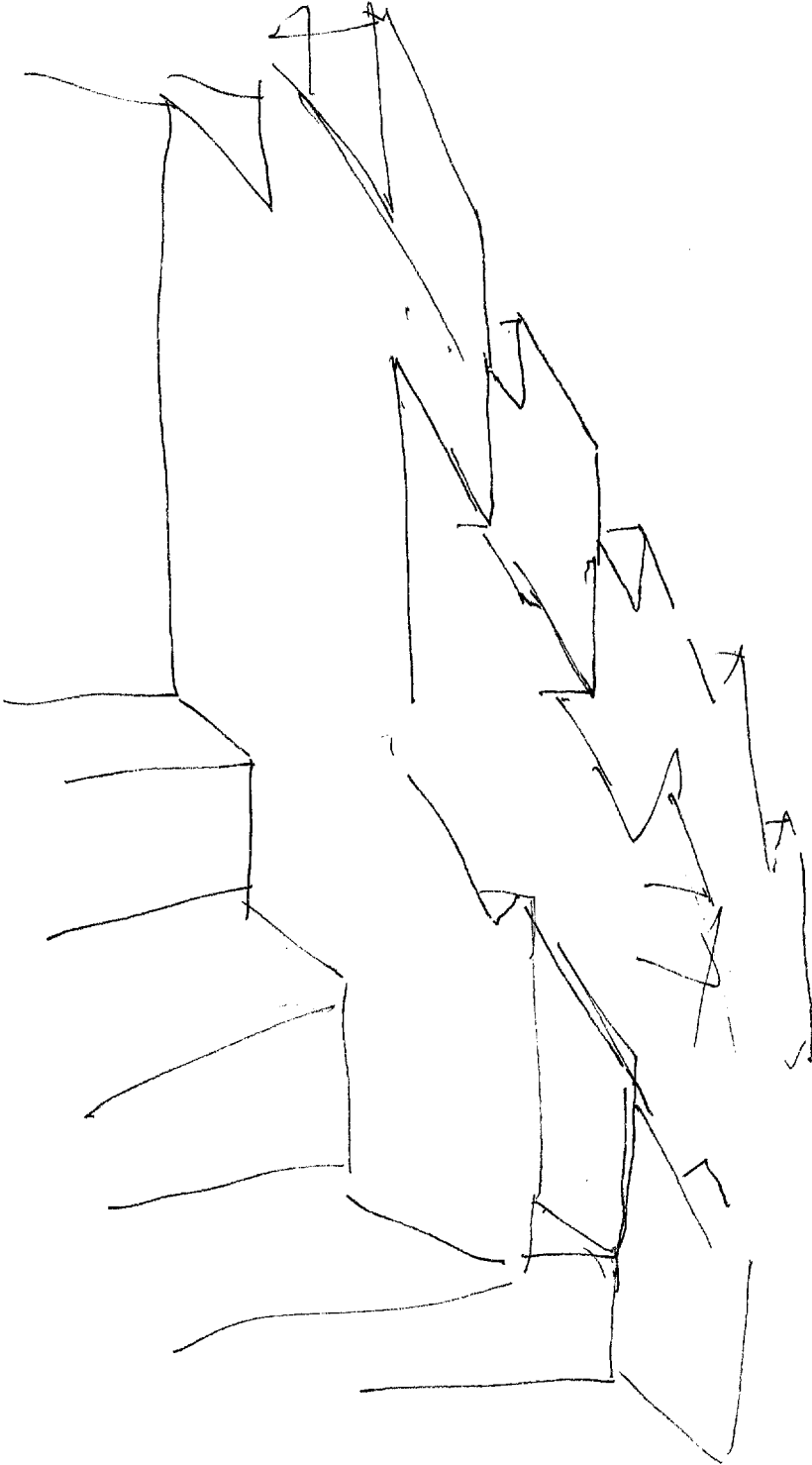

S-2
White

D AI FI T I ADL AB

level
lots of
rough
open
closed in
surrounded
large
massive
asymmetrical
slanting
slightly

Structure

→ lid

black
red

vegetation
nearby

masonry

tall

window

summit

room

S2

D

DI

EI

T

I

Jul

AS

Sound of tranquility

room

Spacious

light

large window
with
view

little
furnishings

person
standing

relaxed
contemplative

Outside
inside

o

noise

bedroom

AS
inner
courtyard

Jul 16
lie
pentagon

S2

activities

8
Also
oriented
sense
construction

people
moving
things -
large objects
motor sounds
low voices
sounds

foreign
language

S4 1/2 people doing something.

rearranging
moving

S4 1/2 moving something around to better accomplish a purpose. Fairly major rearrangement.

S4 1/2 it's "like" if you were at NSA, & realized to ~~better~~ better accomplish your particular mission you needed to completely move all your equipment in one room into the next, and all the equipment there into the next and so on and it might take weeks to get it all rearranged and organized & functioning again.

SVI

for HLG 9

people

agitated
frustrated
overwhelmed
tired

50% people doing work aren't happy - feel normal routine is unnecessarily disrupted & are disgruntled about having to do extra work. Being pressed into service doing something that isn't something they're normally expected to do.

new
equipment
crates

old equipment
outside

old equipment

green

smooth

metal

worn worn

heavy

rounded
corners

complex

complex

S2

SUI

10

W/L

A/S

remnants of
old
heavy duty
ship equipment

equipment
to make
something
else

Surface

flat

hard

long
narrow



5 1/2 up on raised part of land

A/S
Airfield

rough

large

2 1/2 has to be open + spacious for same
reason

for the
like gunnery
range -
make for 4.5
men

SUZ

11

S-2

D

A2

EI

T

I

7002

A/S

A2 B/C
Feed Expt
Under observation

Urnid
mays
dread

Purple
fruits
to ting

fraded

Volley/
grandy

brum
gritty
warm
trinky

A2 B/C
Faltz
relaxation
exposure

AOL B/C
Biochemical
tests
Nuclear tests

3 1/2 am is smoothed-out - as if leveled + graded periodically.

S I
Test

ADL

12
ALS

S2 D

A2

F -

I

3 vehicles

in line

dusty

messing
around
prototype
obscure
camouflaged
controlled

S4/2 must be observed from a distance.

-vibratescent
green

puffy
cloud

A2 BK
feet like eyes
and water hng

sharp
vibrating

strong
humming like
smell

A2 BK
stingy
noise

circle
shape

black
annuity
S4/2 on ground

SVI

13

52

D

AI

EI

T

I

AA AC

peeps
walks
group
observes

measuring
examining
(country
adjusting

5 4 1/2 group + people, pointers, discussing, considering,
heavily, visually analyzing, walking out on
surface. Discussion + examining agreement markings
on ground, overwatch created.

5 4 1/2 Sometimes vehicles + people (a few of each) on surface at
times. But when it's time to do whatever is done, then
are kept off the edges of the area, & perhaps protected.
On the surface itself at time of use, well out towards
the middle, is a ^{small} ^{structure} ^{that} ^{monitor/initiates} ^{the} ^{activity}.
Few hollows/hills on surface; but nothing significant.

SR →



blade
marks
ground

Site involves a large, solid structure with many angles and a large open, relatively flat area ^{surface} that is leveled/graded periodically & is used for test or trials. There are occasionally people & vehicles on this surface, but when it is about to be used, they are kept off the edges. There are a few relatively small objects/structures well out onto the surface. After the test/trials measurements & analysis occur, with a small group of people discussing nearby marks on the ground that are black & crumbly, & possibly circular.

622