

5 Nov 87

~~SECRET~~/NOFORN - SKEET CHANNELS ONLY

PROJECT SUN STREAK (U)

WARNING NOTICE: INTELLIGENCE SOURCES AND METHODS INVOLVED

Session Procedures Report (S/NF/SK)

PROJECT NUMBER: 8718	SESSION NUMBER: 2
DATE OF SESSION: 3 NOV 87	TARGET COUNTRY: IRAN
REFERENCE:	MISSION STATUS:
TECHNIQUE UTILIZED: CRV	SOURCE IDENTIFIER: 018

1. (S/NF/SK) Monitor Tasking: Obtain an overhead sketch of the target area.
2. (S/NF/SK) Source Tasking: Stage 3 movement drills and Stage 6 perspective descriptions were employed throughout the session to produce the attached target site sketches.
3. (S/NF/SK) Summary: 018's summary is attached. The monitor suspects that two separate aircraft flights are being superimposed on each other in the mind of the viewer: one flight transports the objects from the airfield to another area, another flight (which may also be connected with similar objects) may land at the same airport from a distant location.
4. (S/NF/SK) Comments: Good corroborative information; 018 is most useful in perceiving abstract relationships vs. detailed physical descriptions. The monitor requested a debrief period in order to try and sew data together a little more neatly, but 018 had other things to do.

Debriefing and any other operational tasks must and will take precedence over any other activity-

[Redacted Signature]

SG1J

CPT, USA

5 NOV 87

~~SECRET~~/NOFORN - SKEET CHANNELS ONLY

CLASSIFIED BY: DIA-DT
DECLASSIFY : OADR

memorandum

DATE: 3 November, 1987

REPLY TO
ATTN OF: DT-S

SUBJECT: SESSION SUMMARY (C/SS)

SG1J TO: DT-S (ATTN: [REDACTED])

1. (S-SS) Statistics: Viewer: 018
Session date: 3 NOV 87

2. (S-SS) This session was conducted entirely in stages four and six. The point of origin for the session was the "end point for the 'thing'", described in the previous session. An attempt was made to generate maps of those areas related to the target. The results were:

a. Map, Page 1A: The area close in to the target

1) The general terrain give the impression of being flat, with "bumps". To the north are larger "bumps", presumed to be small hills.

2) The "long, flat thing" described in the previous session appears to be situated in a WSW to ENE direction.

3) A small distance south of the "long, flat thing" is a square topped structure (identified on page 1A as item #1) which has an unusual top (see drawing, page 1).

4) Given the cue to describe a nearby structure by which this site could be identified, a structure was perceived slightly to the north of the "long, flat thing". This structure is identified on page 1A as item #4, (see also drawing, page 5).

5) The area circled and marked as "Target" was found in response to the cue "final resting place of the target".

6) The point on the "long, flat thing" which is marked as "plane" was found in response to the cue "locate the plane". Another point of location of this "plane" was found in the air. It is from this other point of location that the descriptions on the top of page 6 were perceived.

b. Map, Page 1B: Larger area involved with the target:

1) The cue to follow the flight path of the "plane" resulted in the dotted line which leads from a point generally to the SSW of the target's final location.

2) There was the perception that this "line of flight" left land, traveled over a large body of water, then over land again to the "long, flat thing", and that it was not a

straight line.

3) The point on the bottom of page 1B which is marked as #2 is perceived as the origin of the "flight". It is perceived as a very flat area, wide and open, but with lots of haze which is more like pollution than natural.

4) Directly West of point #2 is perceived as being dry, very hard land. At point #3, the land begins to have a softer feeling which continues further west. This area is also perceived as having "catching things" which remind me of desert plants.

5) Directly South of point #2 (see map, page 1C), is perceived as being rough, hard, rocky land.

3 Nov 87
0821 HNS
FR. MOARS

SG1J

A.V. NONS
P.I. HUNGARY

S6: DESCRIBE TERRAIN SOUTH OF TARGET (P. 1A)

S2 D A1 E7 T C A02 A/S.

① S4⁴ ~~FROM~~ IMPRESSION OF STRUCTURE
SQUARE

4254

S4² IMPRESSION OF D1 OF STRUCTURE
AS WALLED IN

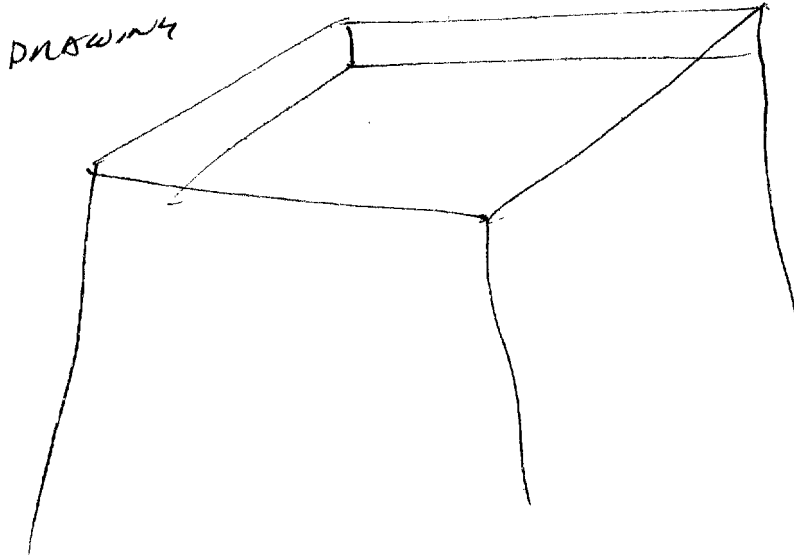

1A

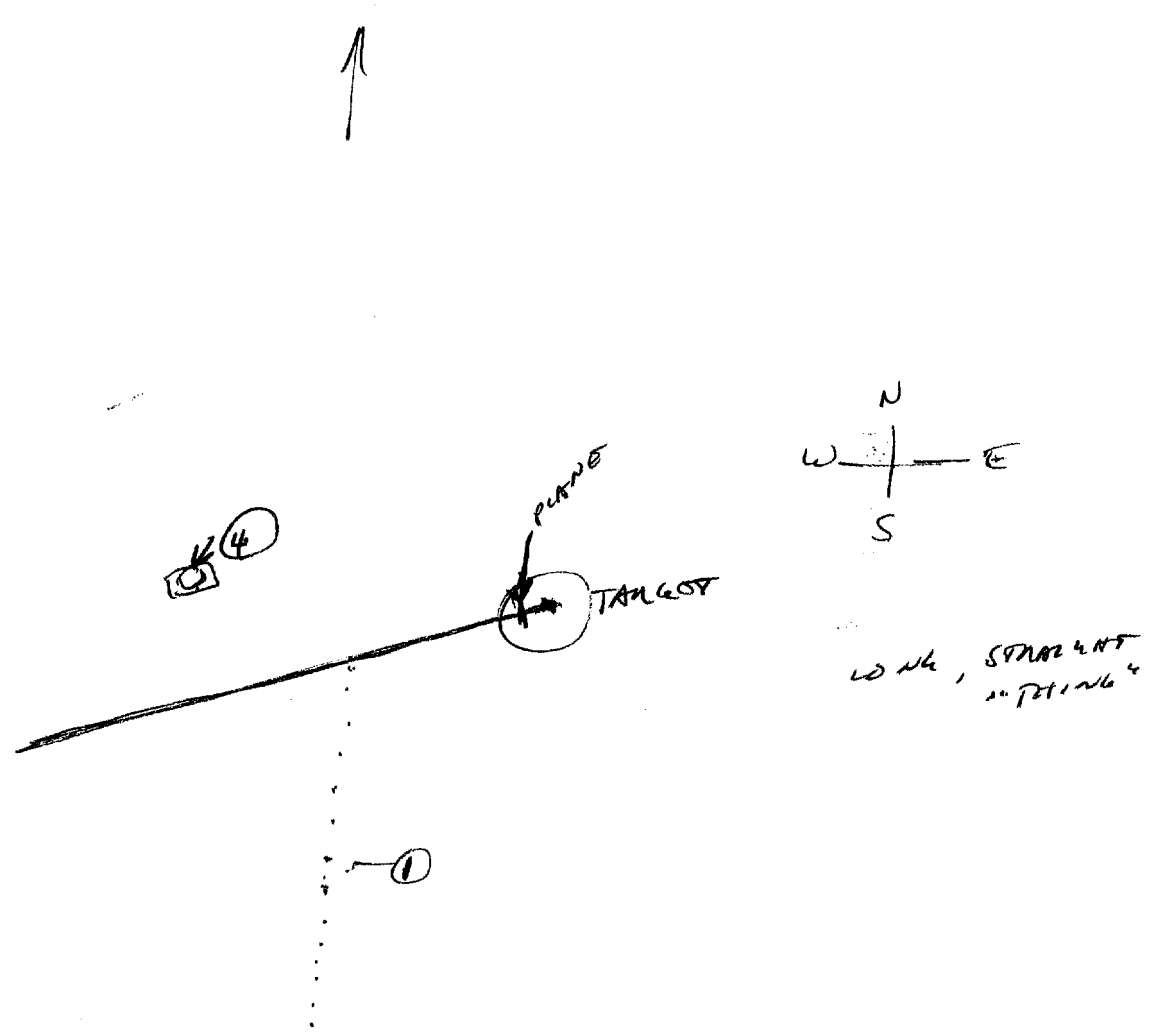

(B)

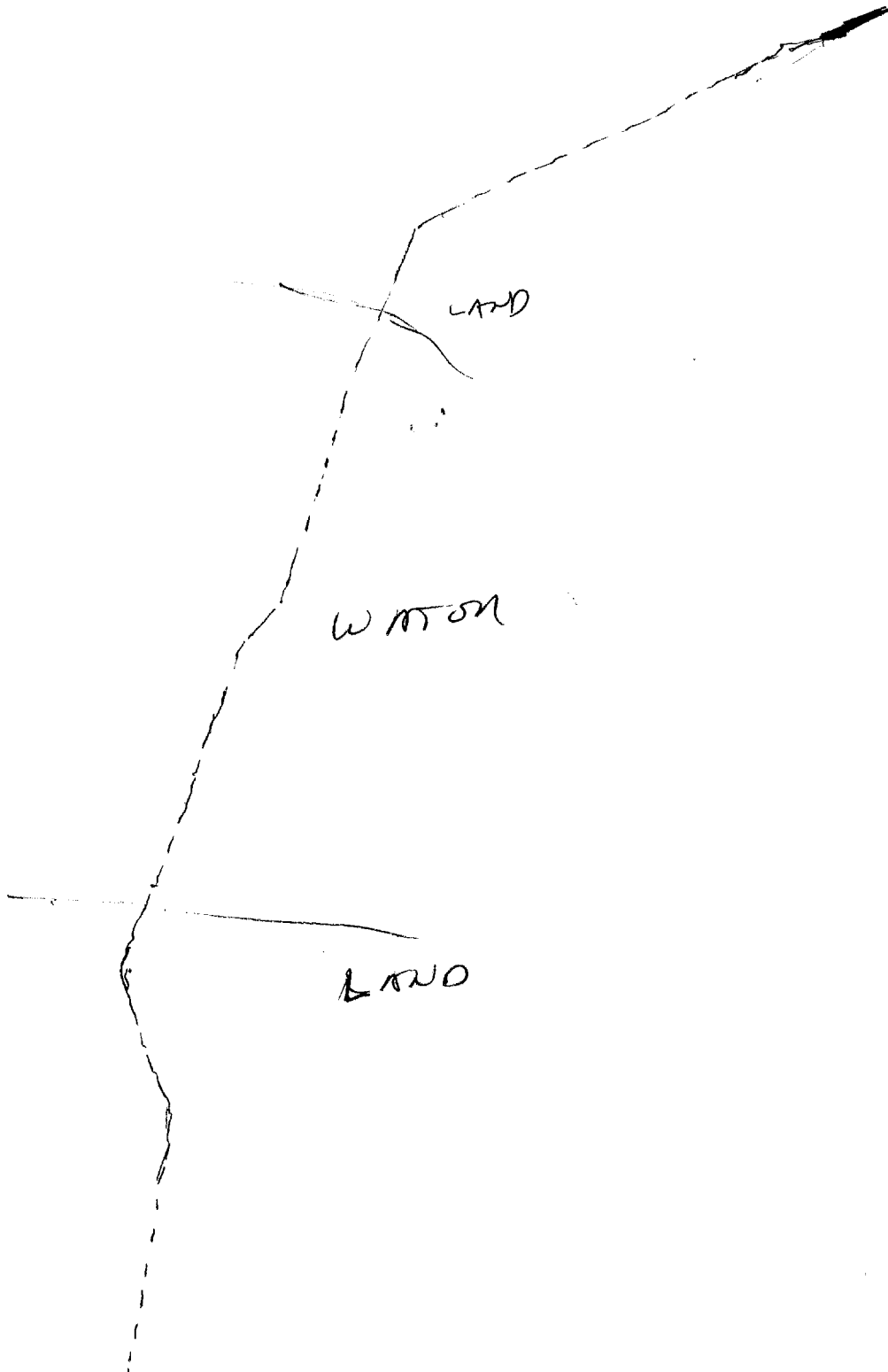

(B)

1C

2

(2)

SB: DESCRIBE (2)

S L D M T 1 1000 hrs.

TRANS
LIGHT
WARM

DAY

S4/LAIR HAS HAZY LOOK,

ALL DARK
LIKE POLLUTION

ALL DARK
DESERT

SB: DESCRIBE TOWN AND TO WEST OF (2)

S4/2 IMPRESSION THAT NORTH OF (2) IS ~~THE~~
LOTS OF WATER AREA.

3

S6: DESCRIBED FORMATION WEST OF (2)

S2 D M OF T 1 AM NLS.

HARD
DIRY
HARD

(30) SOFT

FLAT

DIRY

WIDE
DOWN

DIRTY

S4 1/2 FOLIAGE OF CATCHING SW PLANTS

ALL PLANT
LIKE POSSIBLE
PLANTS

(4)

S6: DESCRIBE TOWN AND SOUTH OF (2) (P. 1C)

SE D M S T , ON ALS.

ROCKY

HARD

SOFT

HARD

ROCKY FORD

FOR RUC
WATER HAS
MODIFICATION

FOR RUC
WATER AT YEMON

ALS.

FOR ALL DIRECTIONS FROM
MAIN "TANK" (P. 1A) THERE IS
THE IMPRESSION OF "BUMPS"
NORTH HAS LARGER "BUMPS".

5

S6: PISCINOS A RECOGNIZABLE LANDMARK
AROUND THE "TOWER" (P. 1A)

SZ D M O T I W A S I,

4

SEVEN
ROUND
VERTICAL
ANCIENT
TILE

SK:

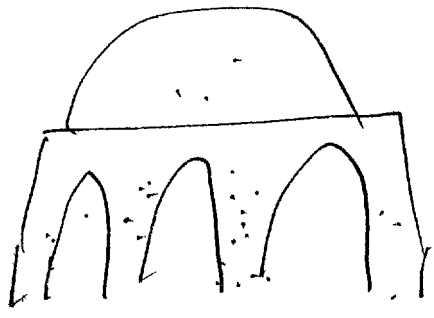

W/D

WHITE
WHITE

TOP

ROCK
UNKNOWN
WALLS
UNKNOWN SHAPES
ZIGZAGGY LINES

ALL BACK
"WORSHIP"
(BUT THAT POSSIBLY
FOR LIGHT)

②

54! POSKIDO AIRCRAFT.

SZ O M S T , per etc.

BROWN
DIE BROWN
PLAIN

WHISTLE SOUND
ROAR,

ROUND

BROWN

BROWN
"THINK"

HARD

ROUND
LONG

COLD ~~SE~~
METALLIC

SESSION END 0855