

Handwritten signature and date: 20 Sep 87

~~SECRET~~/NOFORN - SKEET CHANNELS ONLY

PROJECT SUN STREAK (U)

ERV SESSION PROCEDURES REPORT

WARNING NOTICE: INTELLIGENCE SOURCES AND METHODS INVOLVED

CONTROL NUMBER: 8715	NICKNAME: None
DATE OF SESSION: 30 Sep 87	TARGET COUNTRY: Unknown
REFERENCES: None	SESSION NUMBER: 03
DATE OF REPORT: 28 Sep 87	MISSION STATUS: Continuing
TECHNIQUE UTILIZED: ERV	SOURCE IDENTIFIER: 079

1. (S/NF/SK) INTERVIEWER TASKING: This is the third session of a new project provided to the Interviewer. Specifically the Interviewer is to task the Remote Viewing Source to provide data on a specific site to include the general external and internal configurations, purposes of the various structures and objects at the site and data pertaining to the development and utilization of materials/objects at this site. The Interviewer still has not been made cognizant of the true nature of this site. As in the previous session, the Interviewer utilized the same encrypted coordinate of "1284/6712" which is a departure from accepted protocols of two six digit coordinates. The Source was able to quickly adapt to this rather small departure from past procedures.

2. (S/NF/SK) SOURCE TASKING: Source was told that this was a "revisit to a site you worked in the last session. You will be given a set of shortened coordinates but as before, it should not affect your performance". In addition, Source was provided the same encrypted coordinates cited above as per Extended Remote Viewing protocols. No other cuing or descriptive data was provided to Source prior to this session.

3. (S/NF/SK) INCLEMENCIES: There were no reportable incidents or anomalies which may have influenced the data obtained in this session.

4. (S/NF/SK) SUMMARY: Source furnished the attached summary which was prepared following the session and submitted to the Interviewer within 24 hours after the session. The completeness of the typewritten summary has been compared to the Interviewer's notes and all omissions, changes, and/or corrections have been verified as

AI SAR 79-15.#03

1 p 9

Handwritten notes: Summary which is attached 20 of 1

~~SECRET~~/NOFORN - SKEET CHANNELS ONLY

acceptable by the Interviewer. The information provided in the summary was found to be a complete accounting of the data provided by the Source during the session and did not require further modification, clarification or additions by the Interviewer. In post-session interviews, Source detailed a strong image of what She termed a, "factory like" atmosphere in an older facility who temperature was hard to control resulting in a chilly, cold internal working conditions. Source further had a problem with an image of a large cylindrical object which she insisted was located outside the building itself. This object, as described by Source bears striking similarities to a central object reported by other Sources, however in the cases of those Sources, the object is located in a large open area of the building. The fact that this object, described as technical in nature, is in a large open area of the building may be confusing the images perceived by this Source who is then interpreting the image as being outside.

5. (S/NF/SK) COMMENTS: It is planned to continue to utilize this Source on this target in the near future. Her data in this session bore strong correlations to data obtained by other Sources targeted against this site. In future sessions and attempt will make to gather further data on the activity within the structure and to further clarify the confusing images of the objects associated with this site. It is believed that once these objects are clarified both in Source's perceptions as well as the impressions provided to the Interviewer, this particular Source may well hold the key to the actual intelligence questions pertaining to this site.

SGFOIA3



30 SEPT 87
SOURCE 079

Summary

DURING THIS SESSION, I FIRST SAW MEN WORKING ON A VERY WIDE AND SPACIOUS AREA AND THEY WERE MOVING AROUND A VERY BIG CIRCULAR OBJECT. THIS OBJECT WAS SITTING ON THE GROUND AND MEN WERE CARRYING SMALLER OBJECTS AND WALKING ON AND AROUND THIS BIG OBJECT. ON THIS LARGE OBJECT, THERE IS ANOTHER OBJECT WHICH EXPANDS WHICH GAVE ME AN AIRY FEELING OR A FEELING OF FLOATING. MEN LOOK DOWN AT THIS LIGHT OBJECT WHEN IT IS NOT IN USE AND SOMETIMES THIS OBJECT IS FOLDED. I ALSO KEPT SENSING MOVEMENT SIDWAYS.

WHEN ENTERING THE STRUCTURE, I SENSED A LOT OF MEN DOING PHYSICAL WORK. THE INSIDE OF THE STRUCTURE REMINDED ME OF A FACTORY BECAUSE OF ITS SPACIOUSNESS AND IT WAS HARD TO KEEP HEATED. THE WALLS WERE LIGHT IN COLOR AND WERE SQUARE AND TRIANGULAR. THE FLOORS WERE UNCOVERED. THE MEN WERE DRESSED IN COMFORTABLE CLOTHING. THEY WERE LONG SHIRTS AND LONG PANTS.

THE MEN WERE WORKING WITH MANY PIECES OF EQUIPMENT AND THESE PIECES SEEMED TO BE OLD. THERE SEEMED TO BE A RATHER LARGE OBJECT WHICH WAS POWERFUL AND IT MADE A SWEEPING MOTION. IT WAS NOT A NEW MODEL AND I KEPT SEEING PIECES BEING PLACED ON THE OBJECT. SOME SORT OF READJUSTMENT WAS BEING MADE. ONE OF THE PIECES OF EQUIPMENT BEING PLACED ON THE SIDE OF THE OBJECT WAS A CRANK. IT HANGS ON THE SIDE AND IT GENERATES MOVEMENT. THERE WERE ROTORS ON THE FRONT OF THE OBJECT. OVERALL, THE OBJECT MOVED SIDWAYS AND SLOW BUT THE PIECES ON THE OBJECT MOVE FAST.

View 079
30 Sep 87

I COULD ALSO SEE THE MEN LOOKING THROUGH LITTLE BLACK CIRCLES AND THEY COULD THEN "MARK OFF" AN AREA AND THIS PROCESS WAS DONE FOR IDENTIFICATION PURPOSES. I COULD ALSO SEE MEN CARRYING LONG, TUBULAR TYPE OBJECTS WHICH WERE RATHER HEAVY.

THE MEN HERE WERE CONCERNED WITH CHECKING THINGS OUT, INSPECTING, GUARDING, AND SECURING.

*Reviewed 079
30 Sep '87*

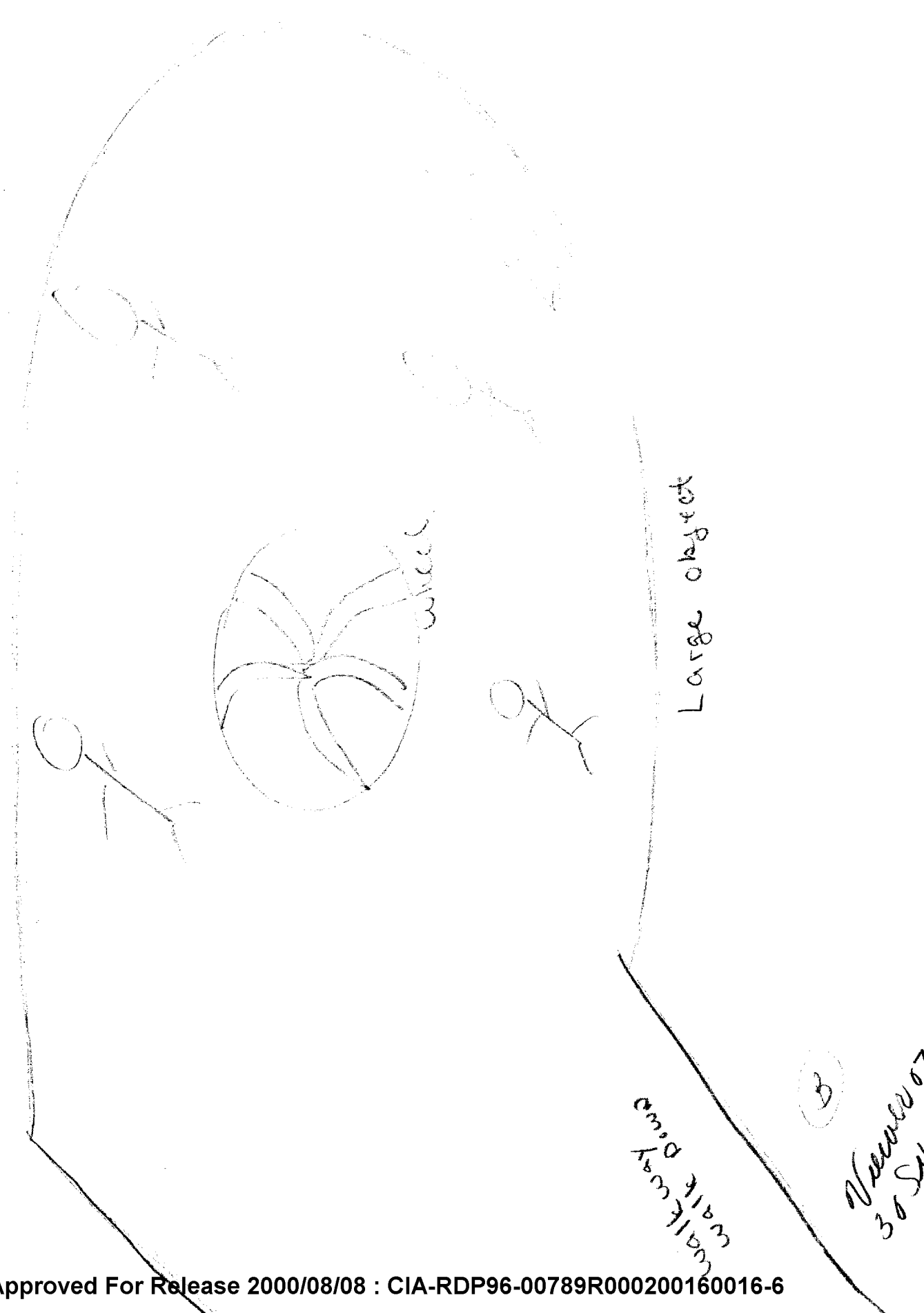

Inside structure

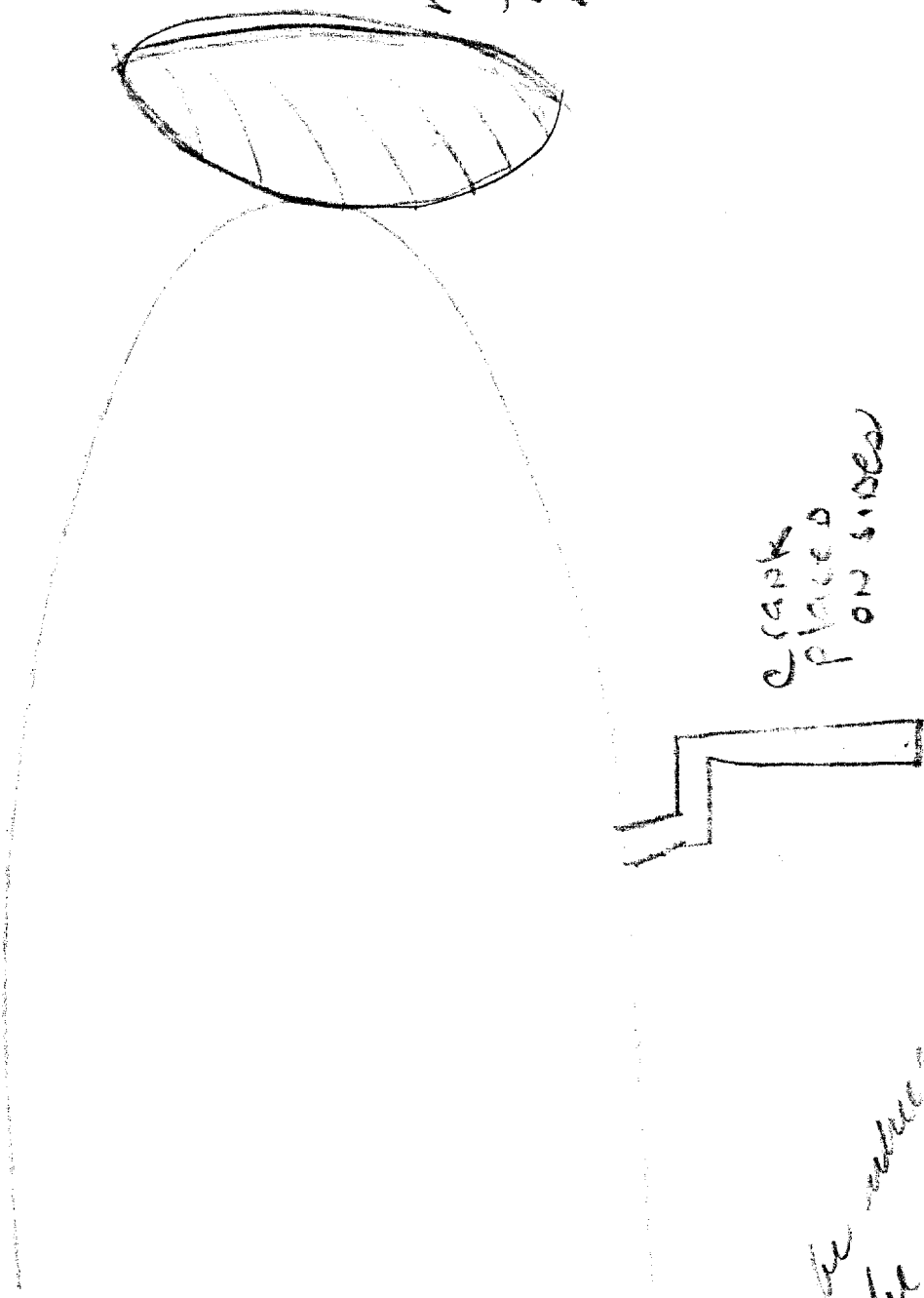

rotor
part
part

crank
placed
on side

may be added
may be separate
part for efficiency

Answer 079
2 Oct 87

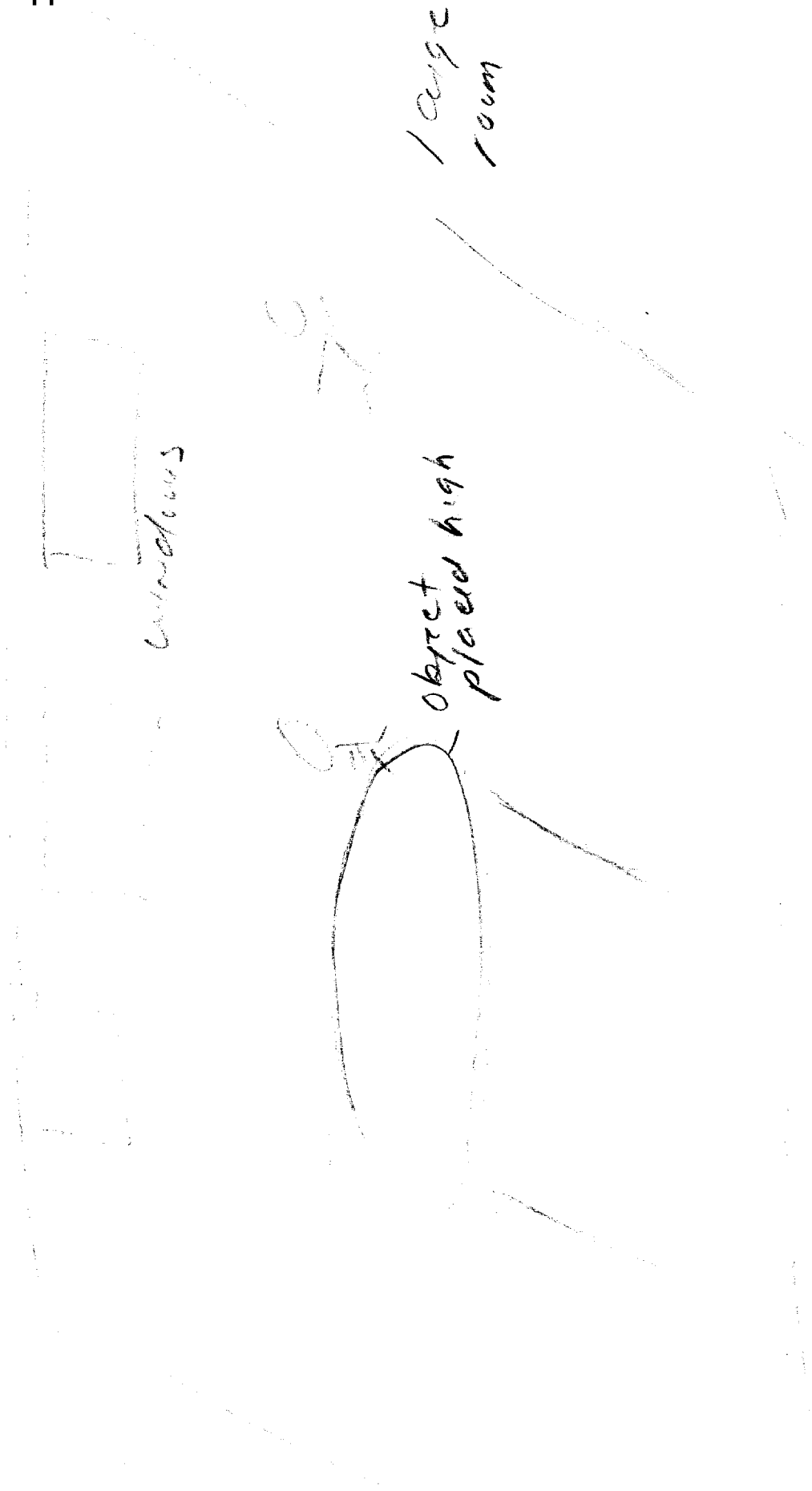

(2)

→ 1 2 8 4 / 6 7 1 2

★ MEN WORKING AROUND A BIG AREA, SPACIOUS, OBJECT, VERY LARGE

→ AVOID THE OBJECT FOR NOW - JUST THE AREA

★ ARID, SPACIOUS DRY, GREEN GRASSES, TREES IN THE BACKGROUND
THE OBJECT IS TAKING UP A LOT OF SPACE

~~★~~

→ GO AHEAD NOW WITH THE OBJECT

★ LONG, HARD, ROUND, MEN WALKING ON IT, MEN PLACING THINGS ON, ON TOP OF THE OBJECT THERE IS AN EXPANSION, MEN LOOKING, OBSERVING, TAKING NOTICE, MEASURING, MEN WORKING TOGETHER, LOOKING DOWN AT INFORMATION, TAKING CARE, CARING, HOLDING, SOME MEN CARRY OBJECT, GUARDING, MOVEMENT SIDEWAYS, MOVEMENT, ACTION, A LOT OF MEN, STACKING

→ RAW DATA

★ GROUPING, PLACING CERTAIN THINGS TOGETHER, MAKING SURE, EQUIPPED, READY, TRYING TO REMAIN ON TOP, CROSSING OVER, A LOT OF CROSSING OVER

→ RAW DATA

★ A LOT OF, I DON'T KNOW, MEN PUSHING FORWARD, STANDING

→ STANDING RAW DATA

★ MEN PUSHING FORWARD, STANDING.

(3)

→ TELL ME ABOUT OTHER THINGS IN THIS AREA

★ THE LAND IS SLOPING, TREES, GRASS, STRUCTURES TO THE SIDE

→ RAW DATA

★ STRUCTURES ALONG SIDE THE OBJECT, THE OBJECT IS SITTING ON THE GROUND, AIRY, FLOATING, EXPANSION, EXPANDING, MEN WALKING BACK AND FORTH, CARRYING, THEY WALK DOWN, OFF THE OBJECT, COMING DOWN

→ TELL ME ABOUT THE STRUCTURE

★ TO THE SIDE, MEN ENTERING, ITS POINTED AT THE TOP, TALL, HARD, ROUGH, ITS OLD, DUSTY, JUST, DRY,

→ FEEL THE DUST IN YOUR HANDS

★ LIGHT, LIGHT COLOR, BLOWING, YOU CAN BLOW THE DUST AWAY

→ TELL ME MORE ABOUT THIS DUST

★ YOU CAN HOLD IT, BLOW IT AWAY, LIGHT, GREYISH, IT COMES IN BALLS

→ RAW DATA

★ ROUND BALLS, SMALL, MEN, THE STRUCTURE, MEN WORK INSIDE, RECEIVING ORDERS FROM OUTSIDE, NOT FROM WITHIN THE STRUCTURE, FROM SOMEPLACE ELSE

→ DESCRIBE THE INSIDE

(5)

- TELL ME THE PURPOSE OF THIS OBJECT
- ★ MEN, MEN TAKE VERY GOOD CARE OF IT, WELL KEPT, TREAT IT WELL, TO ~~SEIZE~~ SEIZE, CATCH, GATHER
- BACK AWAY YOUR BEGINNING TO WANDER - TELL ME ABOUT THE INSIDE OF THE STRUCTURE
- ★ TRIANGULAR, THERE ARE LIGHTS, CROSSING OVER MOVEMENT, AN ENERGY BEING CONTROLLED BY MEN, A FLOATING OUT, COMING OUT, SENDING OUT ENERGY, MEN ARE CARRYING A LONG --
- CONTINUE
- ★ MEN ARE CARRYING THINGS UP, LONG PIECES, TRYING TO PUT TOGETHER HOLD TOGETHER, MAINTAINING, MEN RUN THE OBJECT, PUTTING, SMOTHERING OUT, CLOSING IN, CLOSED IN - THE OBJECT CAN BE CLOSED IN - WHEN ITS OFF
- PAUSE - CONTINUE TO FOCUS INSIDE THE STRUCTURE, FOCUS ON THE THING THAT INTEREST ME
- ★ MEN WORKING, LOOKING DOWN, MEN HOLDING OBJECTS IN FRONT OF THEM, PASSING, CHECKING OUT
- OBJECTS IN FRONT OF THEM
- ★ ROUND SQUARE, THEY CARRY THEM, THEY'RE INSPECTING, CARRY THEM TO HIGHER UPS, INSPECTING, CHECKING OUT
- DESCRIBE THE OBJECTS

(6)

★ ROUNDS, SQUARE, SEE THROUGH, MEASURE, HOLD THEM UP, LOOKING THROUGH, LOOKING AT, SIMPLE, ...

→ TELL ME ABOUT THESE MEN

★ THEY'RE YOUNG, COMFORTABLE CLOTHING, WORKING CONDITIONS NOT THAT GOOD -

→ RAW DATA

★ COLD, DAMP INSIDE, NOT COMFORTABLE, MEN WEAR COMFORTABLE CLOTHING, MOVE AROUND A LOT, ~~GO~~ GO TO DIFFERENT AREAS,

→ COMFORTABLE CLOTHING

★ TO MOVE, LONG SLEEVE SHIRTS, THE MEN JUMP AROUND

→ CLOTHING, STAY WITH THE CLOTHING

★ LONG PANTS, THICK, BELTS, BOOTS,

→ NOW TELL ME ABOUT THEIR ACTIVITY

★ MOVE A LOT, GO FROM ONE PLACE TO THE OTHER, CHECKING, LOOKING, INSPECTING, NOT STAYING AT ONE PLACE FOR A VERY LONG, THEY MARK LITTLE CIRCLES, THEY LOOK THROUGH LITTLE CIRCLES, MARK

→ TELL ME THE MEANING MARKS

★ IDENTIFYING, MARKING OFF, TO KNOW THE AREA, HOW MUCH,

(7)

- Focus AGAIN on The Thing The turns, The cranking
- ★ I can draw it, it comes down, hangs, adjusted on to the object, movement around, generates, starts, holds the device, makes power, helps, it looks small,
- Leave it now - something else have interest me - you haven't told me about it yet - focus on it
- ★ TIED INTO A, dropped, A hole, there's many different parts one part has the ability to drop, drop down, hidden, there's a storing; PUTTING FORTH WITHOUT SHOWING; NOT SEEING, NOT BEING ABLE TO SEE,
- TAKE YOUR TIME - FIND THE THING YOU HAVEN'T TOLD ME ABOUT YET,
(55 minutes)
- ★ The connecting, Big rounded,
- Tell me your location -
- ★ Inside the structure
- Tell about the walls
- ★ Light in color
- More data
- ★ Square, hallways, different colors, floors
- Stay with the walk -
- ★ I am, darker at the bottom

(8)

~~the~~ better → That very good - Now tell me about the floor

★ hard, not covered,

→ Floor

★ hard, square, long boards, placed in the

→ Pause now - Describe your feelings inside this structure

★ Damp, not comfortable -

-1406- Terminate