

Project CY 8609

Task

1. Describe the Technical Facility located vic:

SG1A

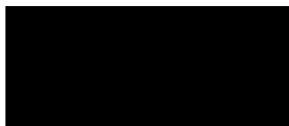

2. Within the following ten year period determine if and when any "special events" occur:

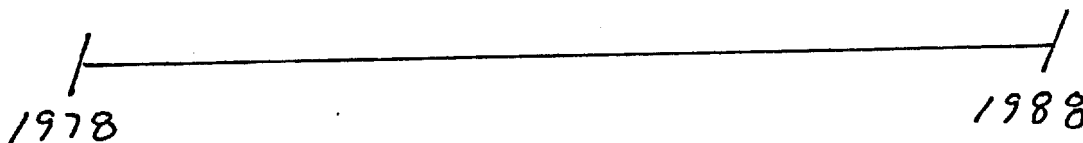

* Note: If you do find any "special events" - - - subsequent sessions will be focused on each separate "special event."

SG1J

██████████
9 Feb 87
F. M. M. M. D.
██████████
0845

SG1J

SUI

SZ D A1 B1 T I #UL #AS

whitish
grey
hard

Solid

in 42000

red
grey
swords

talkish
level
flame
general

#AS
impression
of tile
root

Subs ground
level
Component

like a
basement

S 4 1/2 deeper than average basement - it's "y'ice" 2 levels down.

S 4 1/2 W. A has more open space inside it. "Like" a workshop or shop area - where things are brought together or analyzed or organized or fashioned.

"Basement" area in red

Basement extends
to connect
further to
lower level
in other
part of
structure

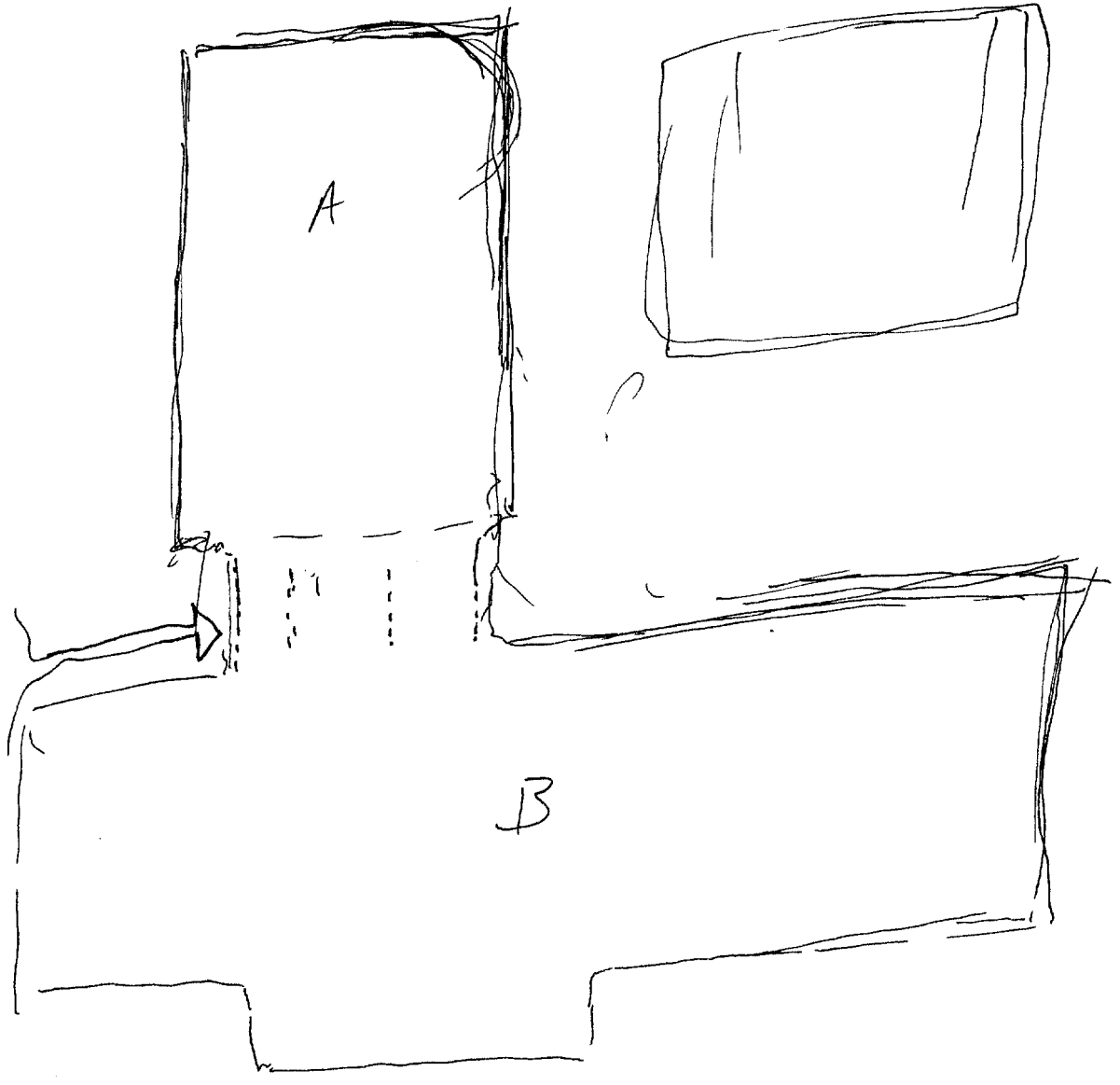

SUI

Sz

ALS

birds
in A

high ceilings

noise -
bays
clanging
choir voices

Sz/k Various projects & activities taking place in A -
perhaps all in some way connected, but at current
level these distinct & separate. Separate.

peeps

drinks
industrious
interested
dedicates
believe in
what they're
doing as far as
they understand
the purpose.

Sz/k Pt. B has a wide variety of activities of an
admin/bureaucratic/other nature. Some are related, some
are distinct. "like" "format unit" idea for some of the
activities.

ALS

Several years
this is
Asian level
highly
advanced
Asia

like intera
China, E. USSR
or N. Korea

52 D A2 E2 T I Hs

Basement
weave in
place machine

54 1/2 Spool standard heating/cooling etc. Some mass.
 Equipment involved w/ projects above. 3-5 times as
 tall as a person. Very complex - tubes, pipes, cables
 heat, flux, meters, dials, fail safe, redundant
 circuits, steady operation; not fluctuating - as it fluctuates
 would be disadvantageous to purposes. Human boss
 sound steady. Pass on manual controller. Watches
 dial and makes adjustments in response to order
 from elsewhere in bldg. "Basement" may seem to be
 under part A at least; outcrops passenger
 cubicles; rooms; ~~offices~~

Hs
offices

Block
sking

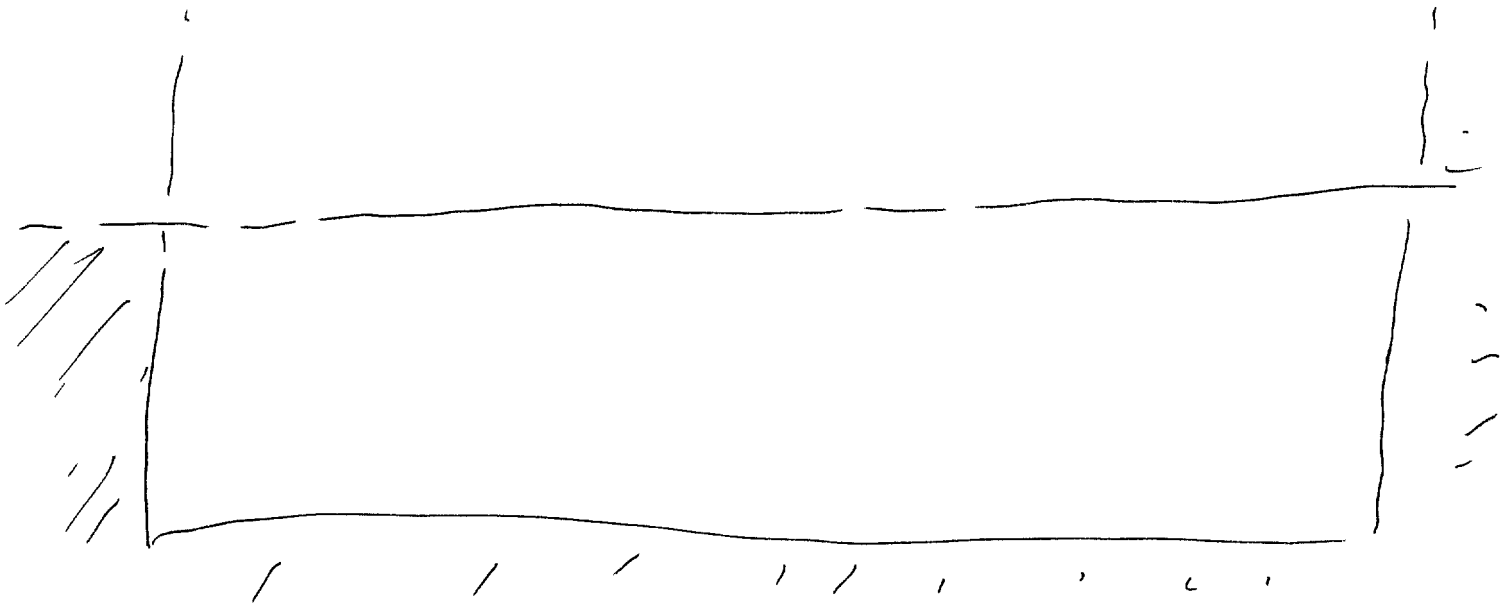

ADL A15

ADL Bl Boat

ADL Bl
Mouland

White
light
cube
many
facets
+
angles
+
curve

A2 Bl
some bad
feeling of
aversion
or
incompatibility
like I don't
like it
like in which
of some activity
occurs at this
point

54 1/2 in basement, big equipment is manifested
some sort of pulsing or rhythmic activity in
support of the main activity taking place
Conduits

long
thin
things

SVI

in D AI BI T I ADZ Als

94/2 passageway/corridors served as conduit, but also
walkways/passageway for people observing/adjusting/monitoring
altering/adapting.

Building
outlines in red

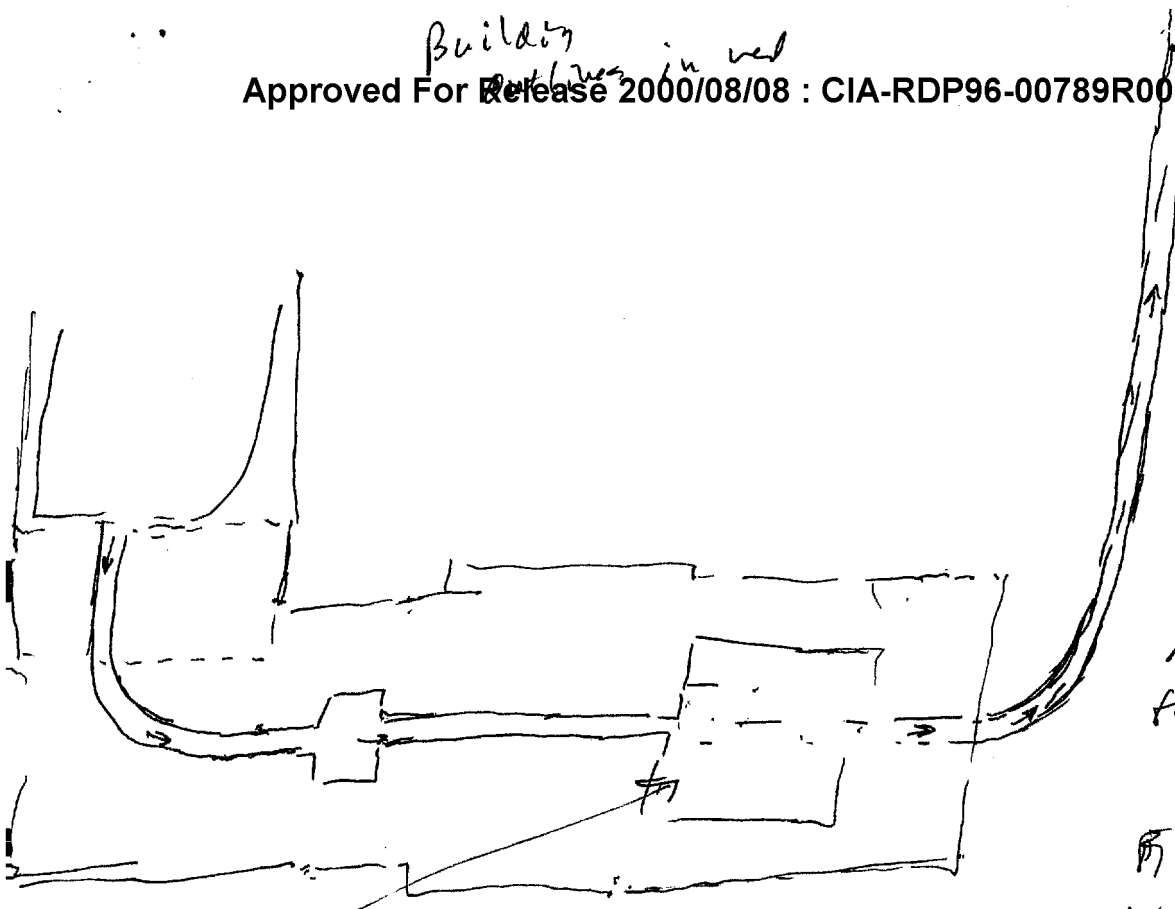

Sense of
looking down
this passage
or tunnel leading
for a long, long
way, into distance
rounded component,
like a pipe or
rail or tube or
cable

people here waiting for whatever to arrive. They use
equipment, some of it of stainless steel, they something to
it, then whatever proceeds on out opposite end



ATC Bc
High
side
table

By way of Analogy - if this were a submarine, it would have all its hatches closed & locked, periscope retracted, and dead in the water on the bottom while all kinds of activity takes place. During attacks, it's like site is "hermetically sealed" to prevent any inking, getting out to outsiders as to a boat taking place.

D142