

SG1J

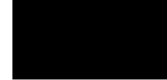

*17 apr*

### Problem 2

The site in Problem 2 seemed first to involve a structure on land, which evolved into an AOL of a large, damaged masonry building. Later, however, a persistent impression developed of a swirling around cloud with a stinging, acidic smell, grey, cream colored, and brown in color. This was followed by an even more persistent idea of some sort of manmade object under lots of water, resting on sand with land off to the left. The Arabic phrase of "tahta al-ma'e" ("under the water") spontaneously presented itself.

Problem 2

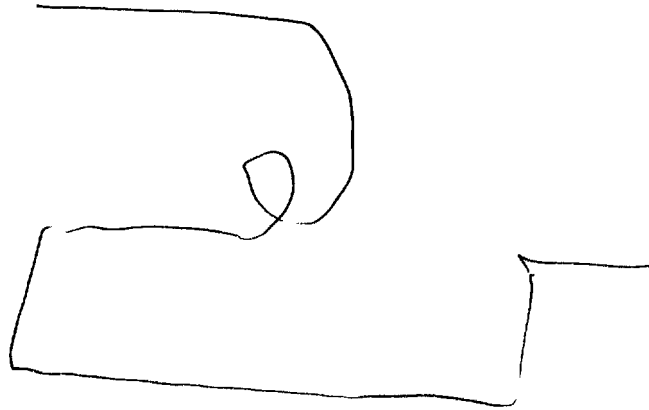

803  
8607

SOLD  
14 APR 88  
7

A. above  
flat  
hard  
mounted

B.

AOL BK  
Airport/  
airfield

Problem 2

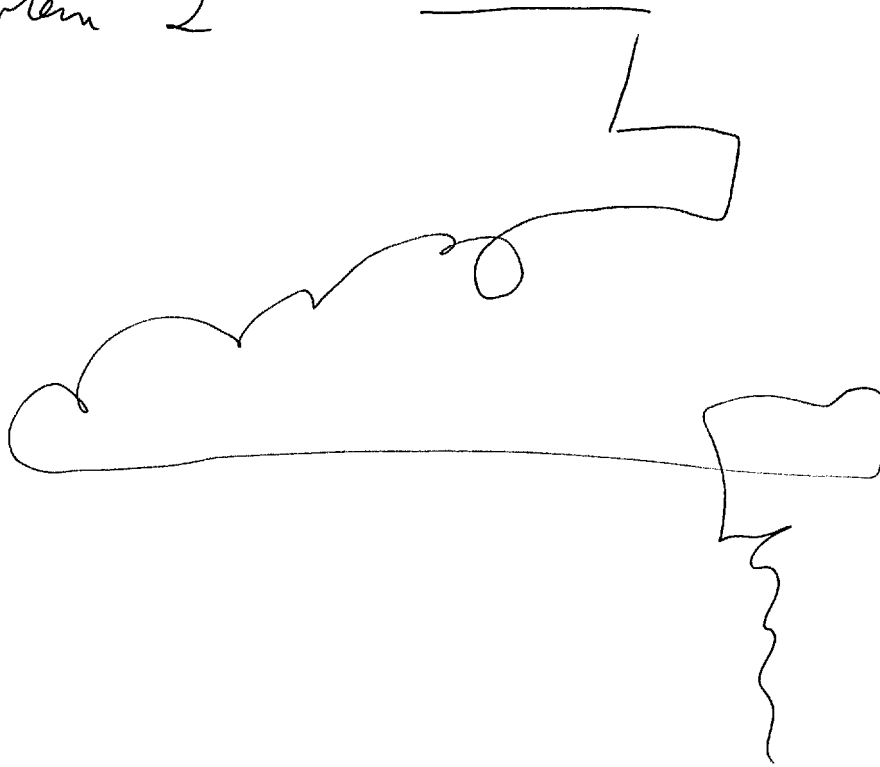

Confusion  
brede

Problem 2

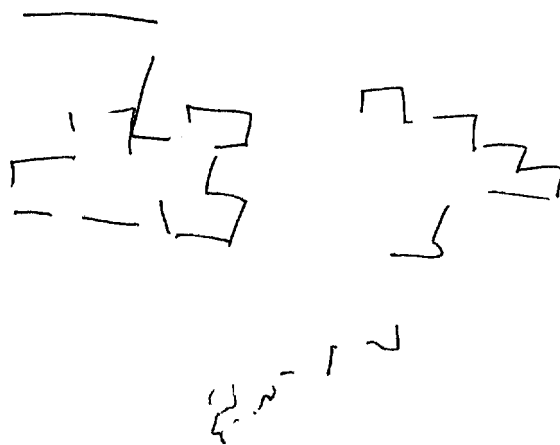

HAL SK  
A person

Problem 2

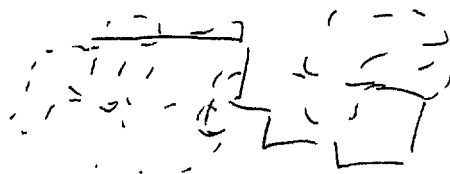

~~miss~~ miss break

problem 2

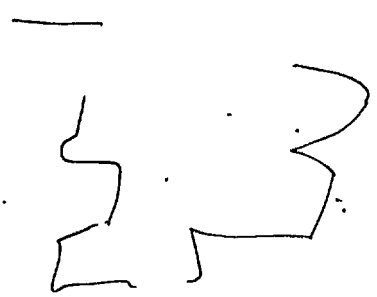

A. across  
angle

hard  
flat  
~~flat~~

B. structure

A. four

rough

solid

B. land

A or B

beach

A or B

large complex  
flat-topped bldg  
on diff overlooks  
ocean



Asr Sketel  
break  
ruined bldg

Problem 2

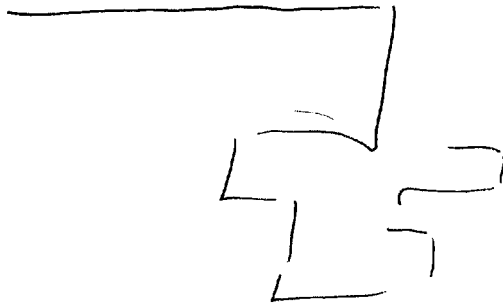

A. long struts  
solid  
braced

B.

A. around  
angly  
solid

B. structure

sol BK  
p. pipeline  
w/ bldg

Break  
2/15



11/9/66  
0934

The Center of Interest in Problem 2  
Should be describable -



A. Swirling  
around  
Soft  
B. Cloud

4.2  
grey  
cream color  
brown  
fluffy  
stinging smell  
acidic smell  
~~stinging~~  
Pattering sound  
hard  
orange  
s,

Red Blk  
Jet Crash

breezy  
drifting  
grey  
green  
salty  
Stinging  
Shadow on walls



Center of Interest for problem 2 should be  
discernible



A. Sand  
B. mud  
C. "

Break

The Center of Interest  
for Problem 2 should  
be perceivable.



A. above  
rough  
flat  
B. water

A.

A. porous  
angular  
hard  
wounded  
B. object

82

W/Map  
Surrey

band  
knocking sound  
grey  
large  
found  
wood  
board  
A2 Bk  
Unusual  
feeling

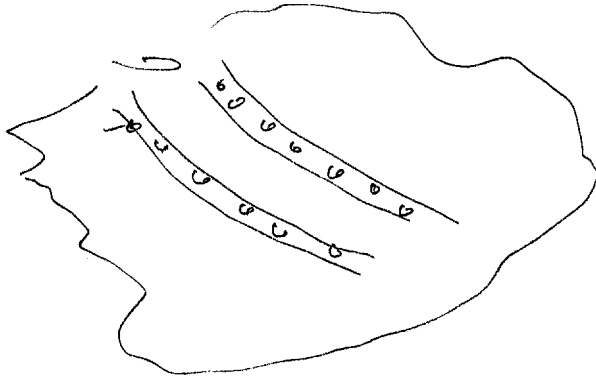

A2 Bk  
like a long  
piece of  
wood

A2 Bk  
piece of  
shuttle

