

101  
8607  
5060

at 2300, 16 April Hilda style.

Set down in a narrow street level at night on a warm evening. Looking up STREET (SK#1) SEE ROWS OF TAN CONNECTED BUILDINGS, NONE HIGHER THAN FOUR STORIES, STRETCHING UP HILL. BUILDINGS LOOK ALMOST EUROPEAN. LIKE WHAT YOU MIGHT SEE IN AN OLD MID-SIZED TOWN IN FRANCE OR GERMANY. LARGE BUILDING ON CORNER APPEAR PARTIALLY DAMAGED. THERE IS NO ONE ON STREET AND NO LIGHTS IN BUILDING. STAR LIGHT IS VERY BRIGHT HOWEVER.

TURNING AROUND AND LOOKING BACK ON THE SAME SIDE OF STREET AS DAMAGED BUILDING BUT SEPERATED FROM THAT BUILDING. IS A COMPOUND. COMPOUND IS SURROUNDED BY LOW WALL (MAYBE 7') WALL TURNS AT ANGLES SO COMPOUND HAS MORE THAN 4 SIDES



THERE IS ONE GAYRD, IN A LIGHT TAN UNIFORM OUT SIDE GATE. GATE MAY BE METAL, REST OF WALL APPEARS TO

THERE IS NO ACTIVITY IN COMPOUND.

LARGE BUILDING IN COMPOUND IS IMPORTANT.  
BUILDING IS LIGHT COLORED, MADE OF STONE  
OR BRICK AND APPEARS TO BE EUROPEAN  
IN DESIGN. MOST OF THE LIGHTS IN  
THE BUILDING ARE ON, BUT THERE  
IS NO ACTIVITY. THERE ARE \*SOME  
"WATCH OFFICERS" AWAKE, BUT THAT  
APPEARS TO BE THE ONLY ACTIVITY.

WHAT IS IMPORTANT HERE IS  
LACK OF ACTIVITY.

COMPOUND

SK 1

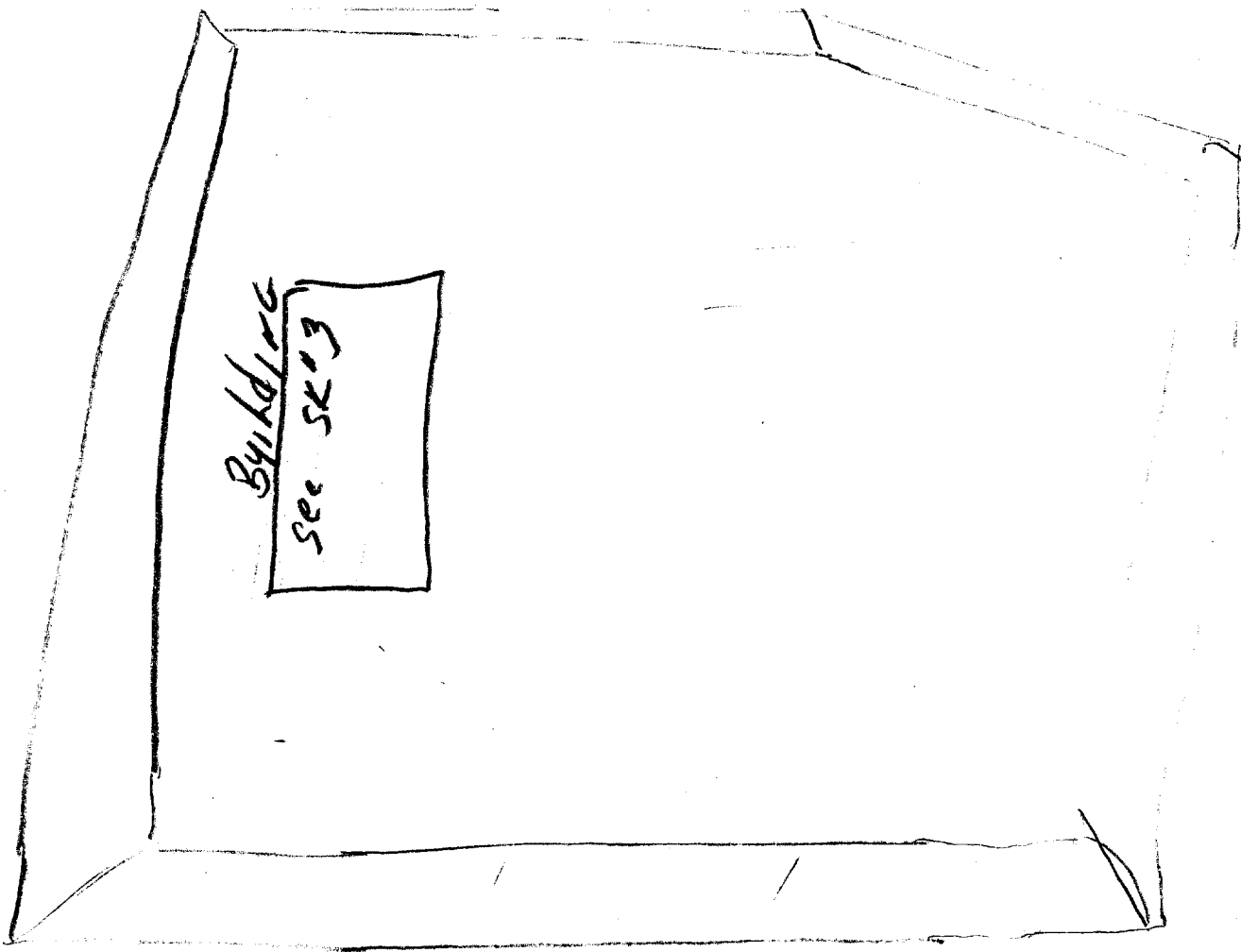

see  
SK#2  
→

SR 2

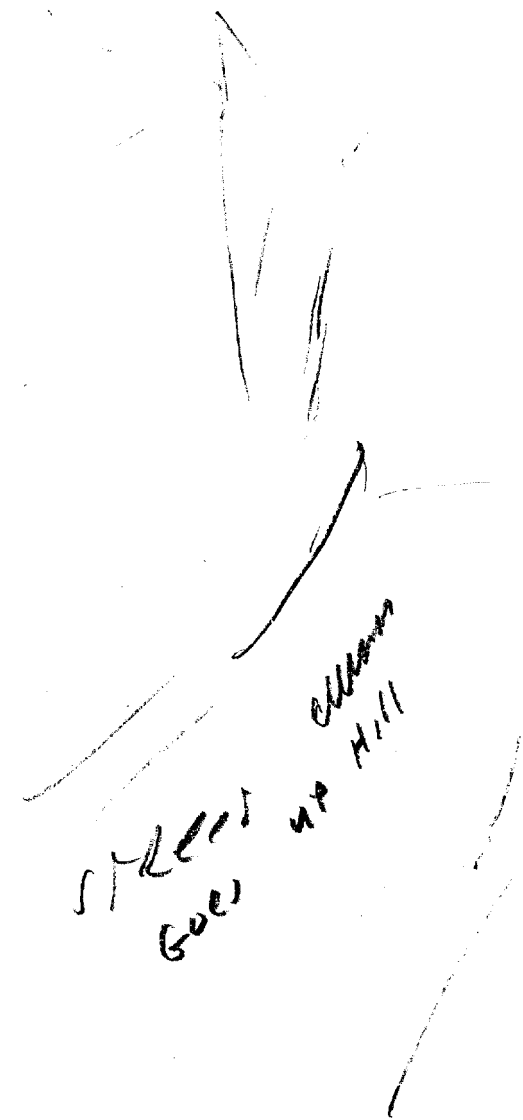
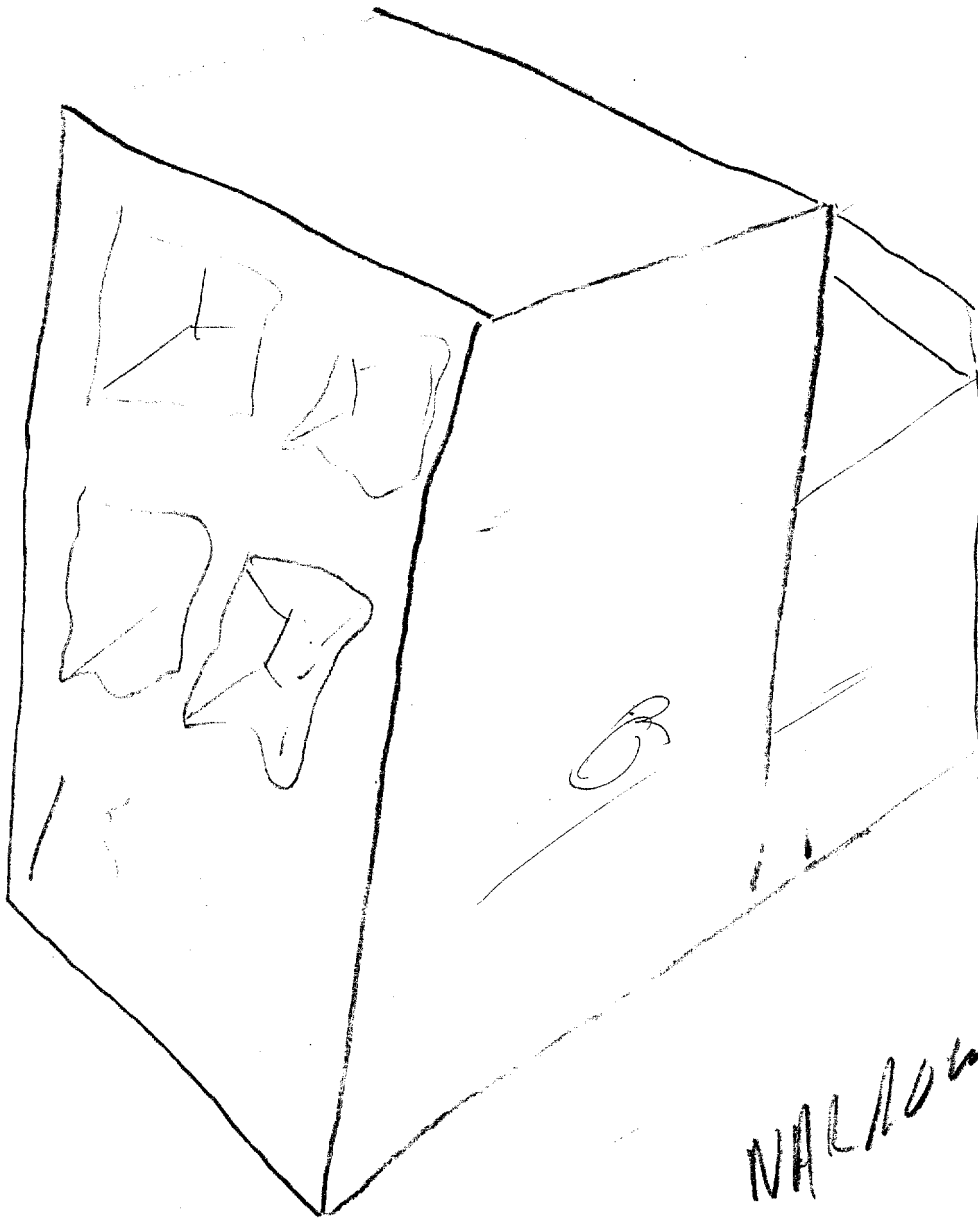

NARROW

STREETS  
GOES UP HILL

Hill

ADL LOOKS LIKE  
A NARROW EUROPEAN  
STREET, EXCEPT IT  
FEELS TOO SPICY

Building, LONG, LOW 2 OR 3 STORIES MAYBE 2 1/2 STORIES  
MADE OF STONE. SEMI-ORNATE. LOOKS ALMOST  
EUROPEAN.

