

Next 2 Page(s) In Document Exempt

SECRET

INTERVIEW

- 66: This will be a CENTER LANE interview for 6 January 1983. The time is 1000 hours. Focus your attention now on the building in the photograph I have shown you. As you do, move your awareness to the inside and describe the activities in the interior of this building to me.
- 08: The top floor,...higher stories...in the right wing, right front and extending to the right wing...as if a...what I see there is a...computer type console, with a bunch of little bulbs...There's a diversification for their use. There's a...heavy impression about...the weather, meteorology... This kind of bugs me, so I got to say it. This is a..east, the building is in the east,...east European country. It's a...there's a heavy soviet financial sponsorship. There's a token soviet presence. With the entire operation's run by..the nationals of the country, with a--
- 66: Describe the interior areas of the building to me.
- 08: There's a middle..midsection of the right front wing are classes, classroom.
- 66: Describe the impression which makes you say classrooms.
- 08: Oh, open windows, conference type things, pointers,..glass inclosures, like a place where series are discussed and before being put into practice in some other section of the building...It's instructional, but it's not a college or an institute, it's not even university type..It's..The scientists.. giving or receiving knowledge and applying that knowledge..experiment type.. atmosphere...to do research, applied sciences I thinks.
- 66: Move through the building and describe the areas of the building and the activity in those areas, to me.
- 08: I see..., this is too vast for me to call at one time,...the first floor's right front is an impression of a lot of glass... tubes and weird shaped bottles, associated with chemistry or something.
- 66: Okay, move to other areas and describe briefly other areas of the building.
- 08: Above that is administration, above that classrooms, conference rooms and above that the electronic gear, computer type electronic gear, that's the right front.
- 66: Describe areas to the left, to the left wing of the building.

CLASSIFIED BY: MSG,DAMI-ISH
 DIG: 051630ZJUL78
 DECL: Origination Agency's
 Determination Required

NOT RELEASABLE TO FOREIGN NATIONALS

SECRET*INCI 2*

SECRET

- 08: That left wing, left front, the general impresssion is that this is....it has a school atmosphere, a mixture of school and government an administrative offices. Although..there's a continuation of the same impression..that the very top floor's are still dedicated to research and stuff, although it's dimmer there.
- 66: Describe for me the activity on the top floor's left wing.
- 08: It's a very somber place...Something about heavy, dark curtains and shields...like--
- 66: Describe the impression that makes you say this.
- 08: It's energy activity that can, ..can hurt people if it's not shielded. Has to do with high energy vibrations if you wish.
- 66: Describe the impression that makes you say this about that image.
- 08: It's like...the area of concern...It has to do with high energy ...frequencies....It's the somber atmosphere and the heavy curtains, and the protection. They're related to high energy frequencies.
- 66: Now, from the top floor, left side, move to the top floor, extreme right wing and describe the top floor, extreme right wing, activity and locations.
- PAUSE
- 08: By comparison, this is a research area, but it's primitive. Impression is one of old..telephones, earphones and wires that are brown covered, wires that were used before the coil wire for telephones. It's as if it were a basic course..in electricity and communications or something.
- 66: Okay, now the floor just beneath the tpp floor, just under that one, describe the activity of that one.
- 08: Classrooms.
- 66: Classrooms is a label, describe the room to me.
- 08: Older professors instructing...college type students there, in basic electricity and electronics,..just classroom.
- 66: Okay. In this side of the building begfore, you mentioned you thought you had an area of computers. From where you are now in which direction is this room?
- 08: The computers are in the, right front, facing the street, those directions we agreed upon.

SECRET

SECRET

- 66: All right. I have no further questions. I'd like now to allow you a few moments to explore this building and comment as you see fit. Do so now.
- 08: This is a self sustaining building here,..about three or four cafeterias. There are quarters. It's a real mixture..of an.. administrative kind of bureaucracy,..school instructions, from great sophistication to very basic things...A wide range of undertaking from most basic courses to highly sophisticated R&D type stuff going. I don't have anything more.
- 66: All right, fine, thank you.

SECRET

SECRET

DRAWING EXPLANATION

- 08: To give perspective to areas of the building mentioned in the session, we agreed that that portion of the building facing the street or road would be the front which is separated as in the picture by a gap in the right portion of the front of the building. So the computer area that I'm talking about is in the front right wing, which I've so labeled. The dark somber area, with the gray and black curtains in protection afforded against high energy emitting things, is in the left front wing of the building. The area labeled right wing which is 90 degrees or adjacent to the front right wing is, where the basic courses in basic electronics and electricity were being given. I sort of glanced at the rear portion of the building and got a quick impression of quarters for staff and faculty there, but I didn't really look at that too intensely. It was just a passing impression. I really did not study that area too well, but there were, I had the impression ^{that} there were quarters for faculty and staff there. I think the other stuff is pretty self explanatory. I did not go to the left wing, extreme left wing, at least I don't recall going to the extreme left wing.
- 66: Okay. Why don't you kind of put a either brackets or big circle and put area not explored or something like that.
- 08: Okay. That's all I have unless you have some questions.
- 66: Okay. That's fine. Thank you much.

SECRET

SECRET

BASIC SECURITY

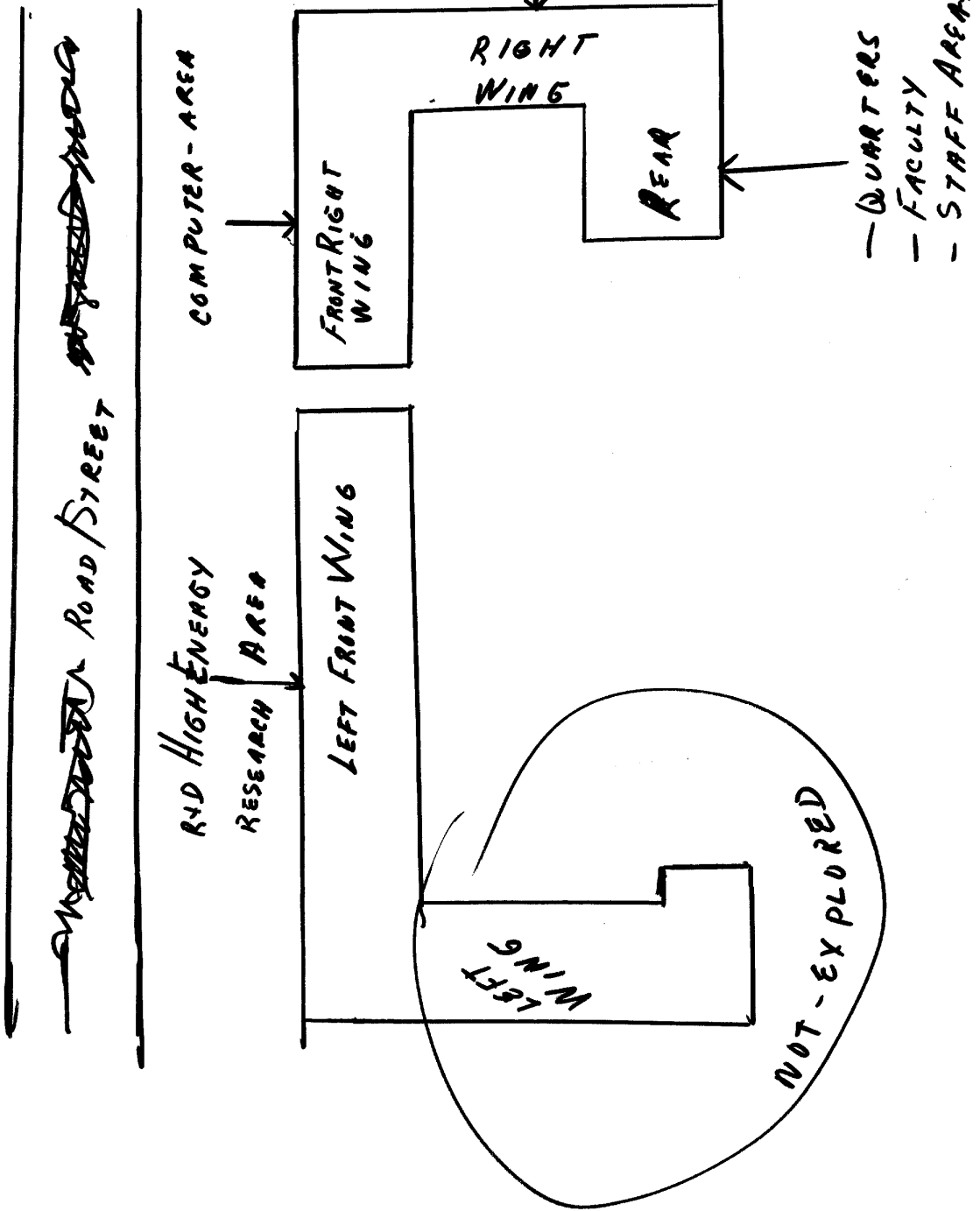

SECRET

AGENT REPORT

For use of this form, see FM 30-17(C); AR 381-130; the proponent agency is the Office of the Assistant Chief of Staff for Intelligence.

1. NAME OF SUBJECT OR TITLE OF INCIDENT [REDACTED] SG1A	2. DATE SUBMITTED
	3. CONTROL SYMBOL OR FILE NUMBER CL-989/8210/08 SG1A

SG1A

4. REPORT OF FINDINGS

On 6 January 1983, Source CL-08 was interviewed concerning [REDACTED]. Source stated substantially as follows:

Source described the interior of the building which he felt was in an east European country. Source reported that the building had a heavy Soviet financial sponsorship, token Soviet presence, and that nationals of the country ran the entire operation. Source stated that this was a self sustaining building with about three or four cafeterias and quarters. Source stated that this building had a real mixture of an administrative kind of bureaucracy; school instructions, from great sophistication to the very basic and a wide range of undertaking, from the most basic courses to highly sophisticated research and development.

The left Front Wing had a school atmosphere, a mixture of school, government, and administrative offices. The very top floor, however, was dedicated to some sort of high energy research. This research activity required shielding to protect personnel. The research had to do with high energy vibrations or frequencies. This area was described as being a very somber place.

The Front Right Wing first floor was an area in which there were many glass tubes and "weird shaped" bottles, associated with chemistry or some other unknown. Above this first floor was an administration area. Above the administration area were classrooms and/or conference rooms. In this area discussions were held concerning activities to be conducted in some other section of the building. In this area scientists were exchanging knowledge and applying that knowledge in an experiment type atmosphere to do research. Source thought this area to be involved in applied sciences. Above the classroom/conference room area was an area which contained electronic equipment to include computer type electronic equipment. The computer type console was described as having a front with multiple light bulbs.

Source did not describe the Left Wing of the building and no further amplifying information was obtained from Source during this interview.

Attached hereto is EXHIBIT I, a drawing provided by Source concerning the areas described above.

CLASSIFIED BY: MSG,DAMI-ISH
 DIG: 051630ZJUL78
 DLCL: Origination Agency's
 Determination Required

5. TYPED NAME AND ORGANIZATION OF SPECIAL AGENT	6. SIGNATURE OF SPECIAL AGENT
---	-------------------------------

DA FORM 341
 1 APR 52

REPLACES WD AGO FORM 341, 1 JUN 47, WHICH MAY BE USED.

GPO: 1970-390-907/248

Incl 3

EXHIBIT COVER SHEET

EXHIBIT I:

Drawing

SUBJECT:

SG1A

████████████████████
CONTORL NO:

CL-989/8210/08

NOT RELEASABLE TO FOREIGN NATIONALS

SECRET ~~BASIC ELECTRONICS~~
INSTRUCTIONAL AREA

~~MEMORANDUM~~ ROAD STREET ~~ROAD~~

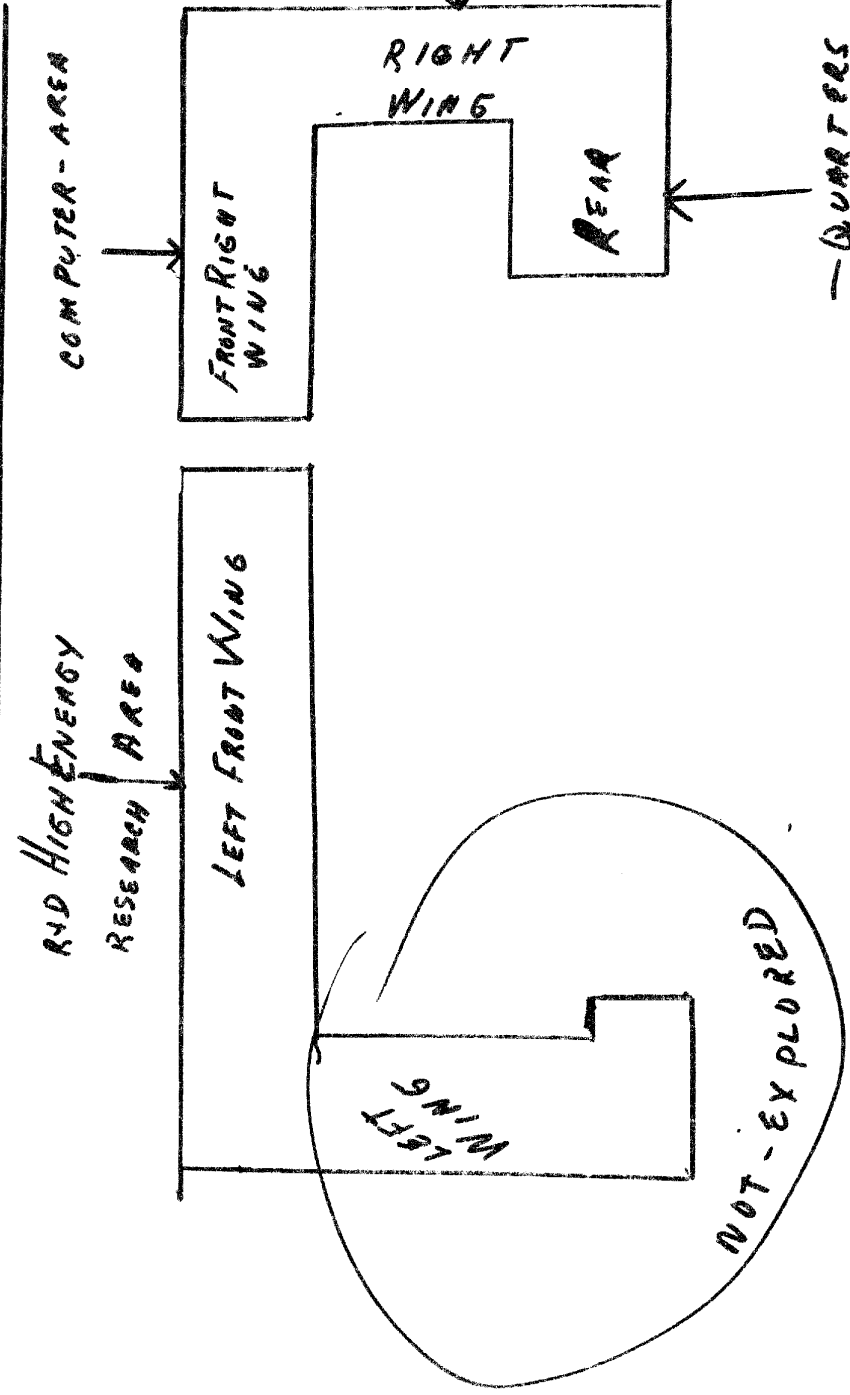

- QUARTERS
- FACULTY
- STAFF AREAS

SECRET