

COORDINATE REMOTE VIEWING TRAINING (CRVT)

CRVT Report: 943

DATE/TIME CONDUCTED: 221503 Oct82

SOURCE #: 63

FILE #: 14

SITE: The White House

EVALUATION: No S1's
No S2's
No site signal

TOM
22 OCT 82
1503

38° 53' 52" N
77° 35' W

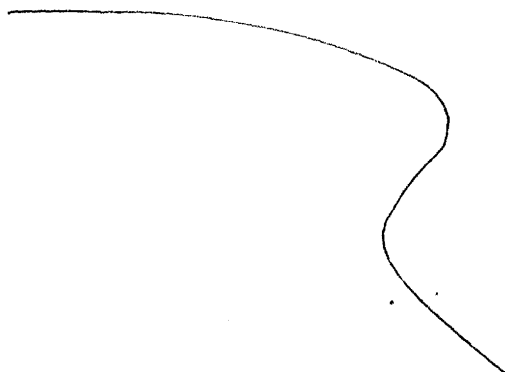

A Curving
B-land

38° 53' 52" N
77° 35' W

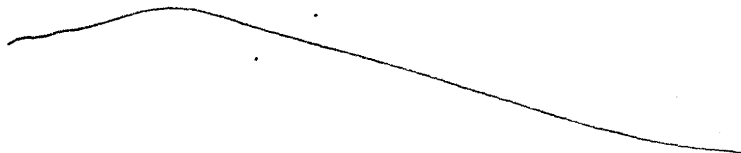

A falling
B-land

38° 53' 52" N
77° 35' W



A Cunningham
B land

S-Z green c

yellowish

Hills

interior

Aol Break
green vegetated
Island

38° 53' 52" N
77° 35' W

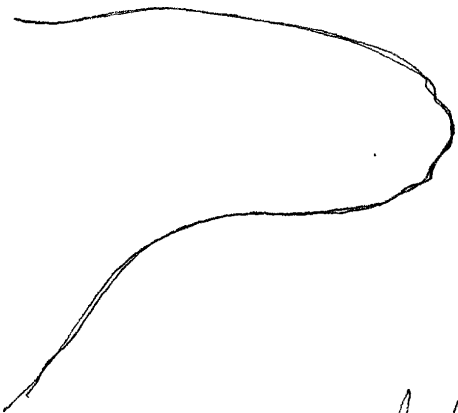

A Cunningham
B land

S-Z

Rocky

Aol Break
interior

38° 53' 52" N
77° 35' W

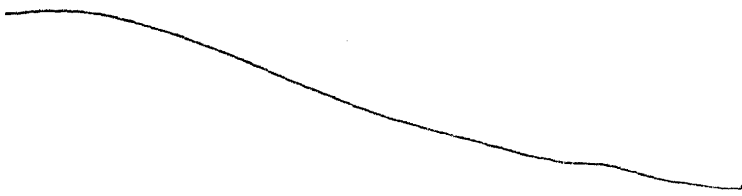

A smooth
B land

5-2 light colored
smooth
hills vs
hot
white
w ch. FB

Ad Break
Snow

38° 53' 52" N
77° 35" W



38°53' 56" N
77° 35' W

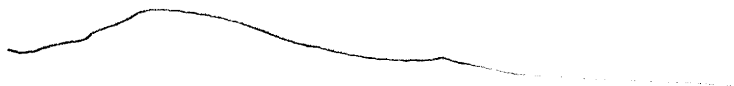

A rising to dropping

B hill

S-2 green

flat open c

wooded c

steamy

Woodsey on d/c

cold r

smooth texture

38°53' 52" N
77° 35' W

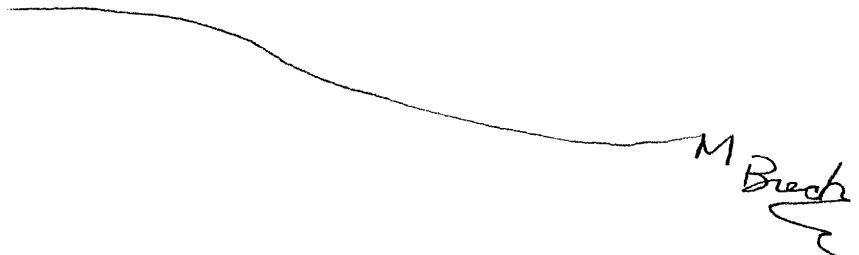

M
Break

38°53' 52" N
77° 35' W



A M Break

38° 53' 52" N
77° 35' N

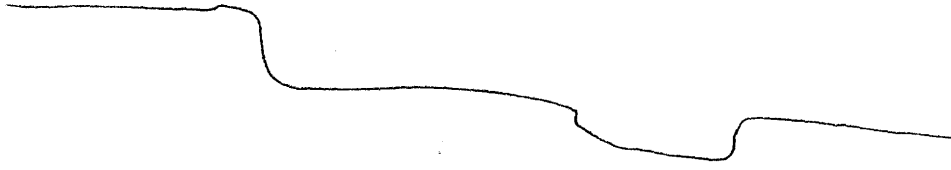

Achaguis
levels

Bland

S-2 dirt
drown
white
flat
open

Aul Beck

Volcano w/ snow

End

The Living White House

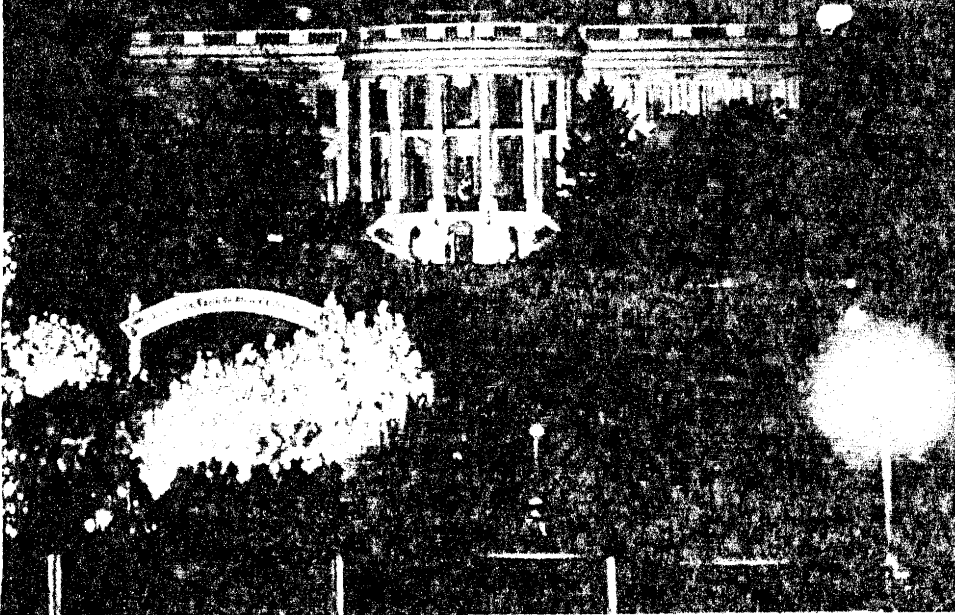

CPYRGHT

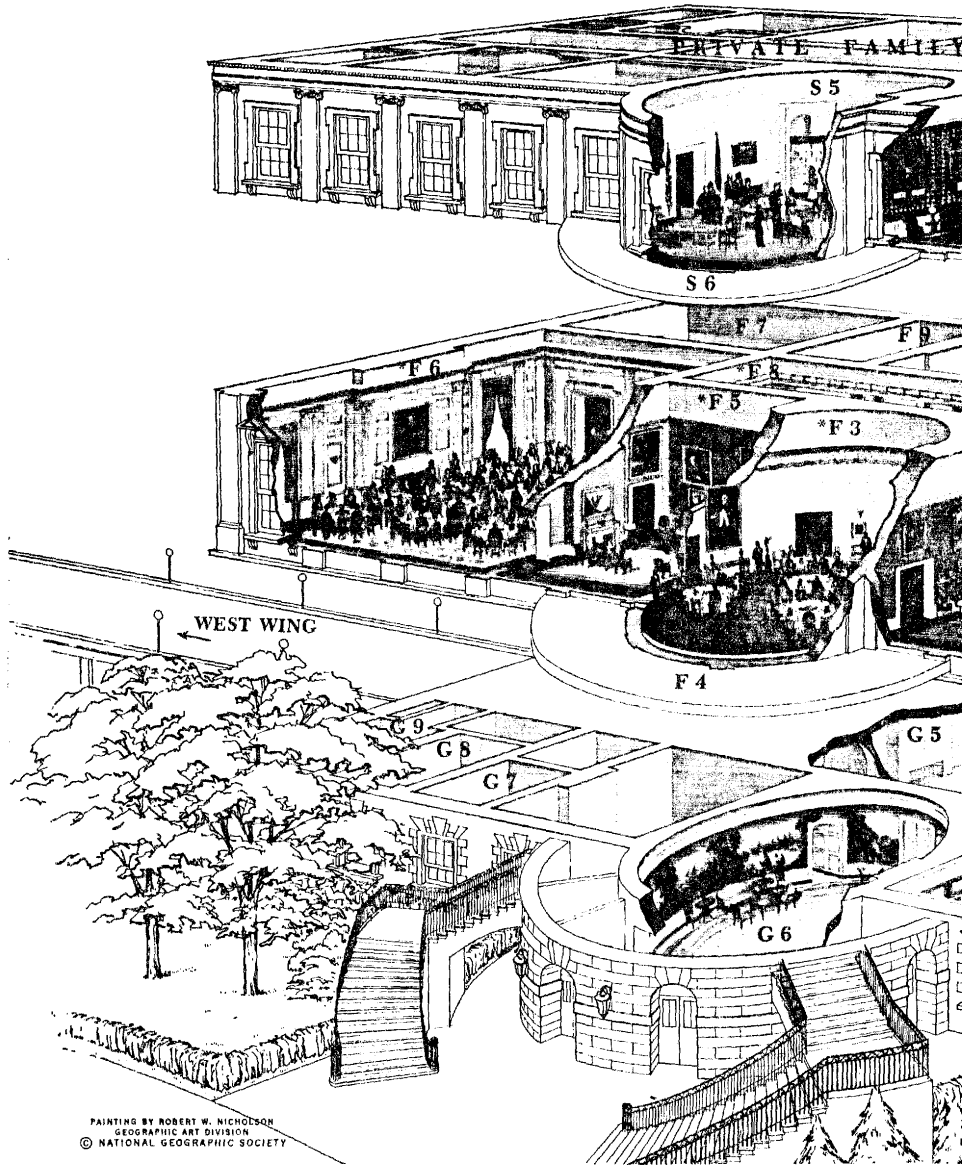

Ground Floor

A CUTAWAY VIEW of the White House, with the South Portico in the foreground. *An asterisk marks rooms open to the public.

- | | |
|----------------------------|-------------------------------|
| *G 1 Vaulted-arch Corridor | G 6 Diplomatic Reception Room |
| G 2 Library | G 7 Physician |
| G 3 Vermeil Room | G 8 Clinic |
| G 4 China Room | G 9 Housekeeper |
| G 5 Curator's Office | |

CPYRGHT

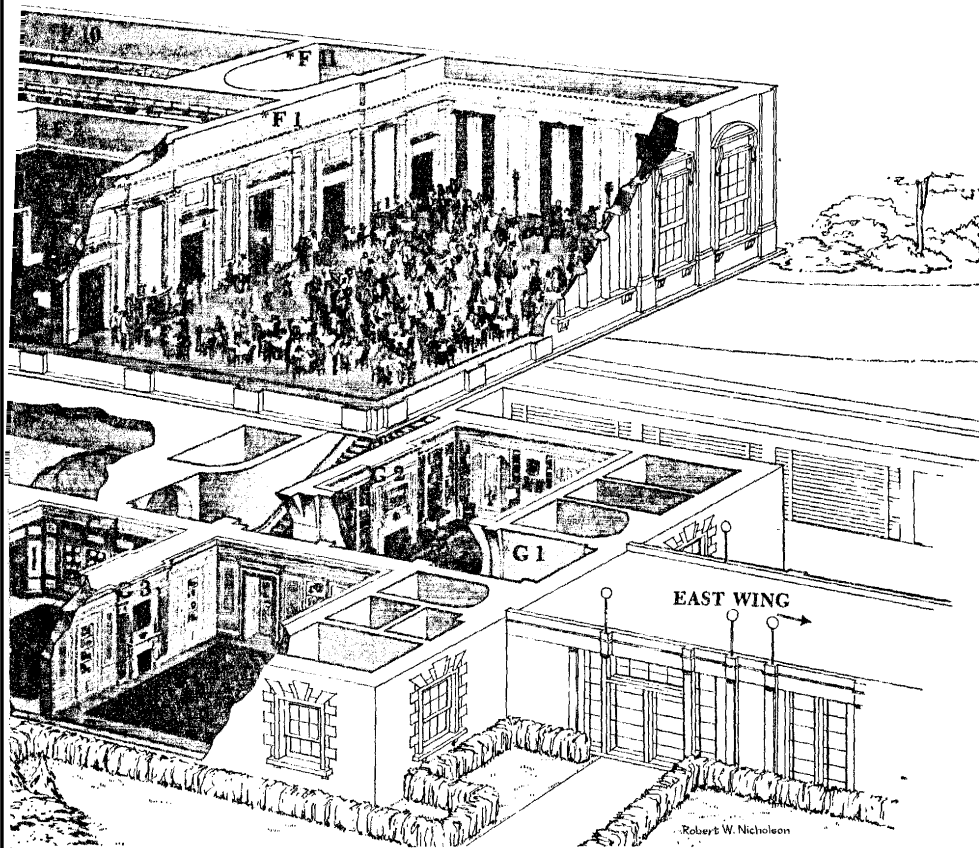
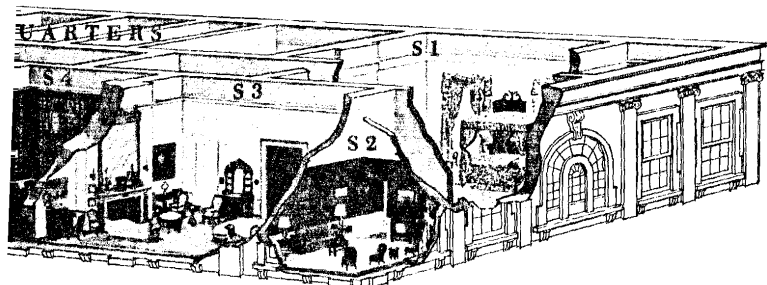

First Floor

Second Floor

- *F 1 East Room
- *F 2 Green Room
- *F 3 Blue Room
- F 4 South Portico
- *F 5 Red Room
- *F 6 State Dining Room

- F 7 Family Dining Room
- *F 8 Cross Hall
- F 9 Ushers' Office
- *F 10 Entrance Hall
- *F 11 Main Stairway

- S 1 Queens' Bedroom
- S 2 Lincoln Sitting Room
- S 3 Lincoln Bedroom
- S 4 Treaty Room
- S 5 Yellow Oval Room
- S 6 Truman Balcony