

**SECRET**

INSCOM  
GRILL FLAME  
PROGRAM

SESSION REPORT

CLASSIFIED BY: MSG, DAMI-ISH  
051630Z JUL78  
REVIEW ON: *Feb 2002*

NOT RELEASABLE TO FOREIGN NATIONALS

**SECRET**

**GRILL FLAME**

**SECRET**

SUMMARY ANALYSIS

REMOTE VIEWING SESSION 863

1. (S/NOFORN) This report provides documentation of a remote viewing session conducted for training purposes only.
2. (S/NOFORN) The protocol used for this session is detailed in document GRILL FLAME Protocol, AMSAA Applied Remote Viewing Protocol (S), undated.
3. (S/NOFORN) Post session analysis of target viewing indicated the viewer had a considerable amount of correlation. The viewer's attitude was positive. Training goals were achieved.
4. (S/NOFORN) Following is a transcript of the viewer's impressions during the remote viewing session. At TAB A are drawings and narrative by the remote viewer. At TAB B is the target cuing information. Also included is available target data.

NOT RELEASABLE TO FOREIGN NATIONALS

**SECRET**

TRANSCRIPT

REMOTE VIEWING SESSION 863

#66: This will be a remote viewing session for 0900 hours, 18 February 1982.

PAUSE

Relax, relax and concentrate, concentrate solely and completely on today's target:

27 degrees, 45 minutes, 45 seconds North  
085 degrees, 15 minutes, 40 seconds East

Again:

27 degrees, 45 minutes, 45 seconds North  
085 degrees, 15 minutes, 40 seconds East

Focus now on the target area, closer, clear, precise and describe the target to me.

PAUSE

#25: River, mountains on both sides of river...really curvy river...it's on the side of the mountain.... stone..... ✓

#66: Go on.

#25: (Mumble)

#66: Describe your position of observation as you look at the target.

#25: I'm standing in it-on it.

#66: Move up above 50 feet, now 100 feet...look down and describe only the target to me.

#25: Squares, several squares, connected, stone, made out of stone, carved stone. ✓

#66: Describe the time of day at the target now.

~~SECRET~~

~~SECRET~~

- #25: Afternoon.
- #66: Describe the impressions, the raw data which makes you say afternoon.
- #25: Position of the sun, high.
- #66: Describe the weather to me.
- #25: Cloudy.
- #66: Look down. Describe the target to me.
- #25: Courtyard. Garden...
- #66: Go on.

PAUSE

- #25: Can see a great distance from the target. Can look out and see over a valley or a plain ✓ or some-
- #66: Describe the terrain.
- #25: Mountainous around the target. ✓ Target's on the mountain....side of the mountain.
- #66: Describe the foliage.

PAUSE

- #25: Green.....
- #66: Focusing solely on the target, solely and completely on the target, right now, right now, describe the activity at the target.

PAUSE

- #25: Not much going on there. It's cold. People, ah... people are there to take care of the target. ✓
- #66: Describe the people to me.
- #25: Old man, blue hat. He's got a shovel or a broom.

~~SECRET~~

~~SECRET~~

#66: His race.

#25: White, caucasian, German. He has some equipment (mumble).

#66: Is he.....

#25: His job's outdoors.

#66: Describe the outdoors.

PAUSE

#25: Courtyard, big, football field size. Takes care of it, managers it now, gardener like.

#66: I have no further questions concerning this target. However, I would like to allow you the freedom to explore the target and comment on the perceptions you have. Do this now.

PAUSE

#25: .....thick stone..looking at plane sort of left from my position, and a river, mountains on the other side of it, way high.....  
I mean really close to the river to the right. Target is something aside the mountains (mumble) There's just snow on the ground, stone floors It's on floors. That's it.

#66: Remembering all that you've perceived about the target, remembering all the pictures, all the sensations of all the perceptions let's prepare now to draw those perceptions which you have.

**TAB**

REMOTE VIEWING SESSION 863

(DRAWING NARRATIVE)

- #25: Okay. This is the....following is the description of the drawings. Drawing 1 is the image that I first received when I said valley with mountains on the side and river in the middle. My perspective is sort of in...where the asterisk is on the page.
- #66: Okay. At this point in the session you said it's on the ridge and I thought you said, you said it's on the ridge or on the mountain, and I thought you were saying the river is on the ridge or on the mountain. I was somewhat confused. Did you mean at that time that you were perceiving that the target was on the ridge or something?
- #25: Yeah. The target, I think. I don't remember that that well. But, I think I was talking about the target was here. But, the river, itself, is sort of in between the mountains there. At least in the drawing there, and as I recall. There is something down here, but I'm not going to draw anything in because I don't know what it was. But, I think it was buildings in this area.

Drawing 2 is the overhead view with the asterisk roughly in the same place...just turning it overhead. And, I noticed now that I didn't draw some stuff in here that should have been on the drawing 1. I can't remember what it was. The square shapes are the double squares in the center of drawing 2, and the asterisk is my sort of perspective of where I tried to look at things from. This is a mountain behind and above the target, and this is a valley below the target. It sort of goes out for miles. Almost like turns into plains (phonetic). At least it looked like it.....a lot of flat land. The target itself was on the side of the mountain. Relatively high up. I keep wanting to draw in some very steep elevation here, but I don't know how to draw it in. By that I mean, here I mean to the left of the stone building as you look at the drawing. Didn't get much on this building. I drew it as a square, but I kind of think there's much more detail to the outline of the building.....

~~SECRET~~

~~SECRET~~

- #66: Okay. Sometimes at the end of the session we look at five gestaltic descriptors. How would you categorize the target today?
- #25: Okay. It was definitely land mass.....  
What were the...
- #66: The actual target or are we dealing with.....
- #25: Oh, no. The target itself was made out of stone. But, it sat on the side of the mountain. We should write this down here.
- #66: Well no. It depends on the particular target. Here you have...let me phrase it this way. If I understand you correctly you have a man-made structure of some type which you feel is made out of stone. Do you have an inside or outside perspective as to the target?
- #25: Well, my whole perspective while I was there was outside. So, I assume from that that it was an outside target. The target was intended to be looked at from the outside.
- #66: Okay. But, by the inside, outside thing is if we're talking about an oil well, you can't get inside an oil well. But, if we're talking about a farm, one can go theoretically inside a farm too.
- #25: Yeah, and a house. I don't know. I guess you could in this thing, but I'm going to still say that even now, that's your description of inside target. I'm not sure enough about it to say that. I think it's an outside target.
- #66: Your perceptions were of an outside situation.
- #25: Yeah. Ruins mostly is what I thought they were. And, that might be analysis. I thought that was analysis and overlay. But, it's old, I know that. I don't know if they're ruins or not, but whatever it is is really old.
- #66: An old, man-made stone structure primarily outside. Now tell me about the surrounding area.

~~SECRET~~



- #25: Uh...there's something here that's higher in elevation, and that's in the upper left corner of the building. The man with the blue hat is indicated in the drawing. I think his responsibility was to take care of this courtyard right here. At first I thought he was shoveling or sweeping snow and then I tried to make the snow go away and I figured if it stayed away it wasn't there. But, it didn't stay away. The courtyard I think has trees in it. It's sort of like a manicured thing....uh.....this guy, all he does is do that. Over here is another square shape that was in the image but I don't know what it is. I think it might be another courtyard, but I don't know that for sure. And, this is just a grassy lawn. These arched shapes were there.
- #66: Arch shapes at the top of the paper drawing ?
- #25: Yeah. Yeah. They're stone and they're...I don't know...see if I can draw in a recess area. I can't draw in too much shadow because there wasn't too much shadow. It was early afternoon. When you asked me about time I think it was around 2 o'clock. And that's all I got to say about the drawings.
- #66: What overlay problems did you experience in this session?
- #25: Okay. When I came upon the image that's drawn on drawing 1, I thought I recognized that place as being the Neckar River in Heidelberg...long Germany, and the target itself has a castle in Heidelberg...the Heidelberg Castle which is sort of a famous in the area there. Probably, since I've been there and walked around the castle once there's a lot of overlay here. I think maybe the squares might be after it, and the terrain description might be after it, but I don't know where it was. I think the Germany part is probably overlay. That's it.
- #66: Okay. How do you feel about this session?
- #25: It wasn't hard. It was easier than I expected. I just don't know. As far as my evaluation of the accuracy of the viewing today, I got no idea.

~~SECRET~~

~~SECRET~~

#25: Okay.

#66: Are we in the middle of the desert. Are we in the mountains. Are we near a lake.

#25: We're in the middle of the mountains near a river. There's no problem with water. The climate is humid. It was cold.

#66: Okay. Good. Those are the group fo descriptors that are nice to know about the target. Okay. Anything else?

#25: No.

#66: Okay. Fine.

~~SECRET~~

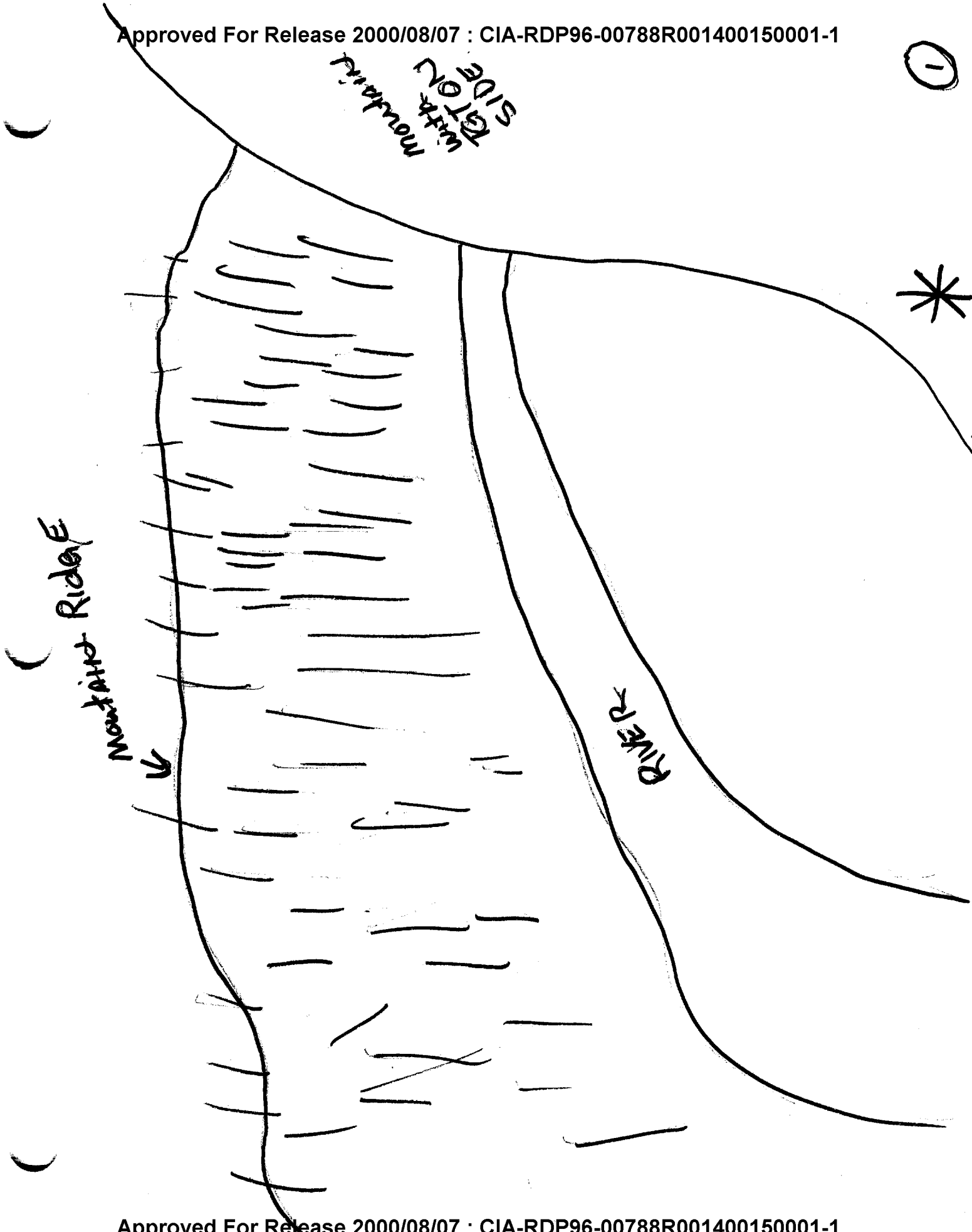

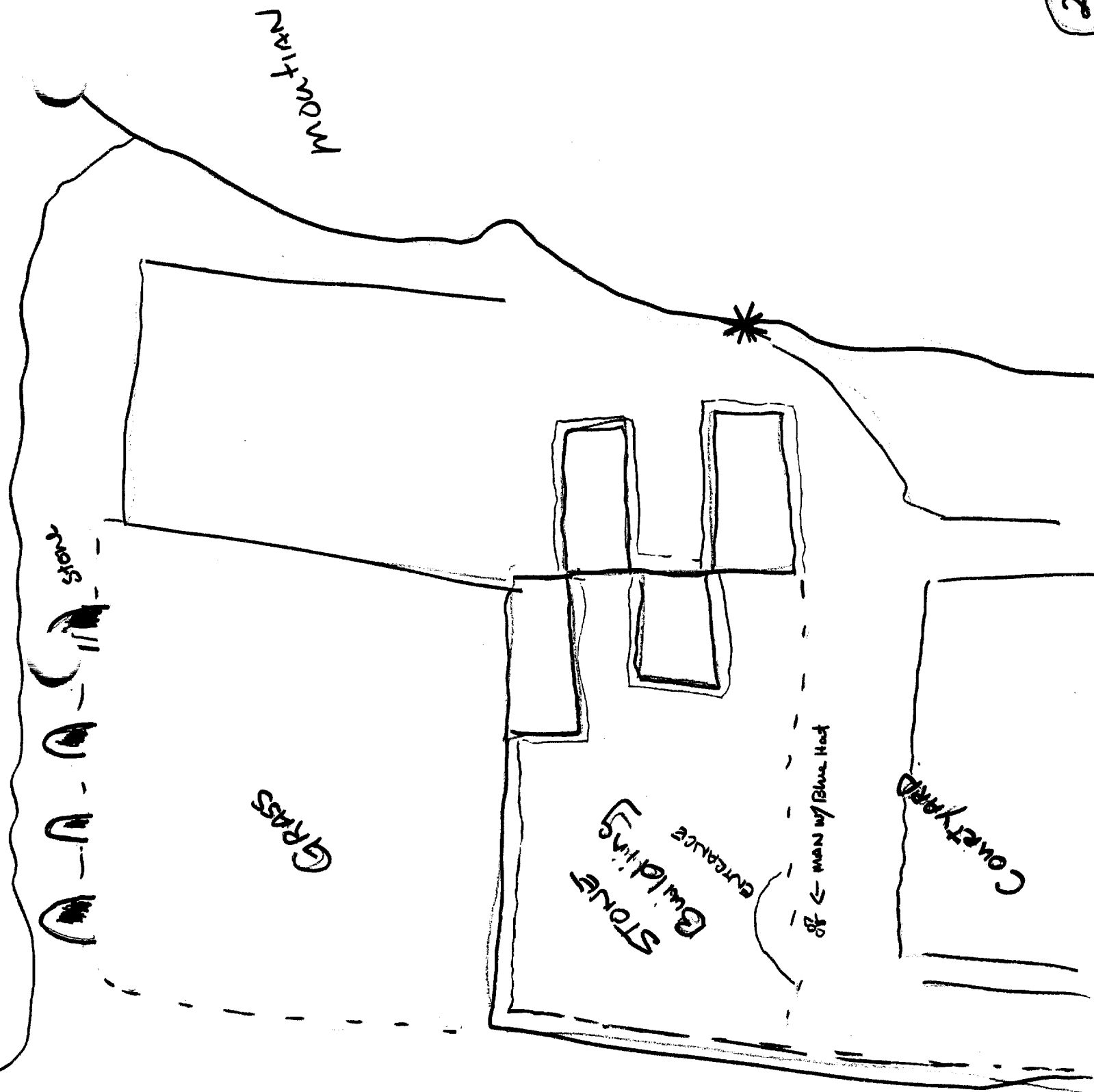

↑  
Light Below

**TAB**

KATHMANDU VALLEY

CPYRGHT



*Still the world is wondrous large—  
common sense from mosque to mosque*

*worshiped with offerings of ornaments,  
food, and money. Even the king of Nepal.*

# KATHMANDU'S REMARKABLE NEWARS

PICTURE STORY BY JOHN SCOFIELD

CPYRGHT



**S**ACRED AND PR  
the main square  
of the least mod  
I have seen in Asia. New  
half the population of  
some—Buddhists as w  
daily respects at these p  
shrines, as if visiting of  
from all corners of the  
around residents who  
watch children play o

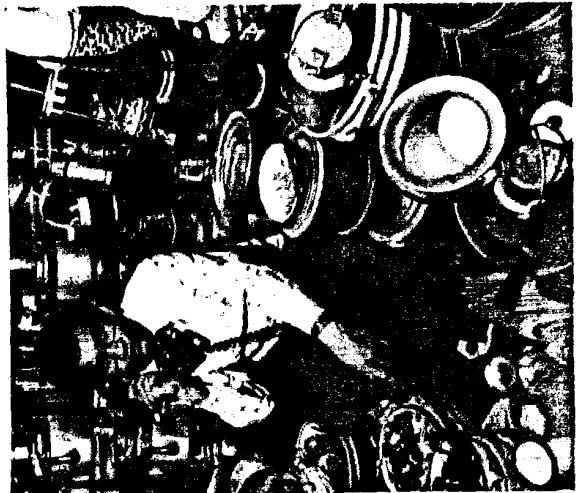

**L**OFTY ABODE of the gods, Himalayan  
peaks rise more than 23,000 feet above  
sea level some forty miles north of the  
Kathmandu Valley. The productive ba  
sin—4,400 feet in elevation and at the  
same latitude as central Florida—basks in

CPYRGHT



27° 45' 45" NORTH  
085° 15' 40" EAST

TARGET AS