

ORCON/NOFORN

INSCOM

GRILL FLAME

PROJECT

SESSION REPORT

CLASSIFIED BY: Director, DIA
REVIEW ON: 31 Jul 99
EXTENDED BY: Director, DIA
REASON: 2-301-C (3) (6)

~~SECRET~~

GRILL FLAME

~~SECRET~~

SUMMARY ANALYSIS

REMOTE VIEWING (RV) SESSION XCI

1. (S) This report provides documentation of a remote viewing session conducted for the purpose of orienting a remote viewer to an applied remote viewing protocol.
2. (S) The remote viewer's impressions during this session appear to correlate well with the geographic features of this location. The viewer described a narrow, meandering body of water on a flat plain with cliffs on either side. The target coordinates fall near the town of Pisgah, Iowa, which is located on the Soldier River (see map at TAB B). The Soldier River flows along a flat plain, with cliffs on either side reaching a height of over 200 feet in some places. The remote viewer expressed a very high level of confidence at the conclusion of this session. This was an unusual session in that the coordinates for the original target (Offutt Air Force Base, Nebraska) were erroneous. Upon double checking these coordinates, the interviewer determined that the target actually fell much farther North of Offutt Air Base. The remote viewer accurately described the geographic area that was pin-pointed by the coordinates and did not receive any overlay that related to the air base.
3. (S) The protocol used for this session is detailed in the document, Grill Flame Protocol, AMSAA Applied Remote Viewing Protocol (S), undated.
4. (S) Following is a transcript of the viewer's impressions during the remote viewing session. At TAB A are drawings made by the viewer reference his impressions of the target site. At TAB B is a map of the target area.

~~SECRET~~

~~SECRET~~

TRANSCRIPT

REMOTE VIEWING (RV) SESSION XCI

TIME #11: This will be a remote viewing session (edited for security).

PAUSE

I'm now opening up the outer envelope. And we have an inner envelope with a set of coordinates on it. For the record, the coordinates are:

41 degrees, 47 minutes, 30 seconds, north
95 degrees, 55 minutes, 0 seconds, west

PAUSE

When you start getting images, describe what you see.

PAUSE

+12 #24: I'm looking up through a round hole as though I'm down in a well. Up through a round hole at the sky and trees, maybe fir trees, pointed, tall, slender trees.

PAUSE

Some kind of white streak, I keep seeing like . . . like a sun. . sun rays. That's sort of above the trees.

#11: Are you still in this hole looking out?

#24: Um hm.

PAUSE

+15 Its definitely some sort of a wilderness area. Probably in the west. I mean it looks like the west but I don't see any mountains.

PAUSE

Well, I'm not getting anything.

#11: Let's see. Try and go back to your first image, looking up and seeing the sky and the trees and

~~SECRET~~

~~SECRET~~

project yourself above the trees and look around and tell me what you see.

PAUSE

+20 #24: I see a road. Long, narrow road with trees on either side. Looks dusty. Might be water. Yeah, it could be water. Its like forked down, its a narrow, relatively narrow, meandering, possibly water. Trees on either side. The ground is dry. The trees are probably semi-desiduous. Brown, the ground is brown.

There is some kind of drop, it looks like down to the water or road. Its probably water because its too wide for a road to meander, I think. Like a cliff of some kind.

PAUSE

+24 Yeah, definitely cliffs. Cliffs on both sides. And this, what looks like water, dark water. Its very meandering.

PAUSE

Well, I keep getting that. Those same images.

PAUSE

#11: Feel free to wander around the area if you like or select an image that you like and concentrate on it in more detail.

PAUSE

+26 #24: Now, I'm down by the water. It seems very rocky. Its rocky on either side. Like the bottom of some cliffs are very rocky, that's what it seems like.

PAUSE

I'm getting a lot of rocks now. Just a whole rocky area. Flat area. Close to this water. Now I'm back in the trees. Ah, yes, the trees. The trees are like at the top of the cliff. Pine, sort of like pine trees. They are those tall, skinny trees that you see in California.

PAUSE

Its really pretty. Ha ha ha ha.

~~SECRET~~

~~SECRET~~

PAUSE

+27 Now I'm down looking up and the cliffs seem higher but they are not mountains, its cliffs of some kind.

PAUSE

+29 If I were analyzing, I'd be tempted to say Grand Canyon.

PAUSE

I'm not getting anything beyond that.

#11: Do you feel that you're all alone at this location? Do you have a feel for other people?

PAUSE

#24: I don't really get a feeling of tremendous aloneness but yet I don't get a feeling of people around either. I don't get a feeling of serenity like its the middle of nowhere.

PAUSE

+30 Now, I'm way above and I see this river. It looks narrow from up high. Cliffs are very high. Rocky cliffs.

PAUSE

+33 I'm way above it but I can't make it out now. Its just brown, I see a lot of brown like, you know, dry, arid.

PAUSE

A big area.

PAUSE

#11: Would you like to try to put some of your impressions down on paper?

#24: Yeah, in a minute. Okay. Do you want to hit one of the lights?

#11: Yes. How's that?

#24: Yeah, that's fine.

PAUSE

~~SECRET~~

~~SECRET~~

#24: This is always so embarrassing because I'm the only one that can't draw.

PAUSE

That's mainly it. Anything else would be variations on that. That's mostly what I saw. That's an ungodly drawing, but . . . Don't laugh, #11.

#11: Oh, I'm not laughing, I've seen worse than that.

#24: I can't believe it.

#11: From #15.5.

#24: From #15.5! That's really hard to believe.

PAUSE

#11: How confident do you feel about this session?

#24: I feel very confident that I was there. I got continuous, continuous. . . that same area from different angles, even when I was above, below down at the water, it was still that same type of thing. And again, that very arid, you know, with the trees. It wasn't a lush area, like a tropical area. And definitely that river from way up and down, it still was sort of a narrow meandering kind of relatively narrow, very meandering.

I almost got the feeling the place was planned in the sense that it wasn't wild or overgrown . . . and it was very pretty.

#11: Um hm.

#24: Like a state park or something like that. Kept up.

PAUSE

#11: And on that, we shall end the session.

~~SECRET~~

TAB A

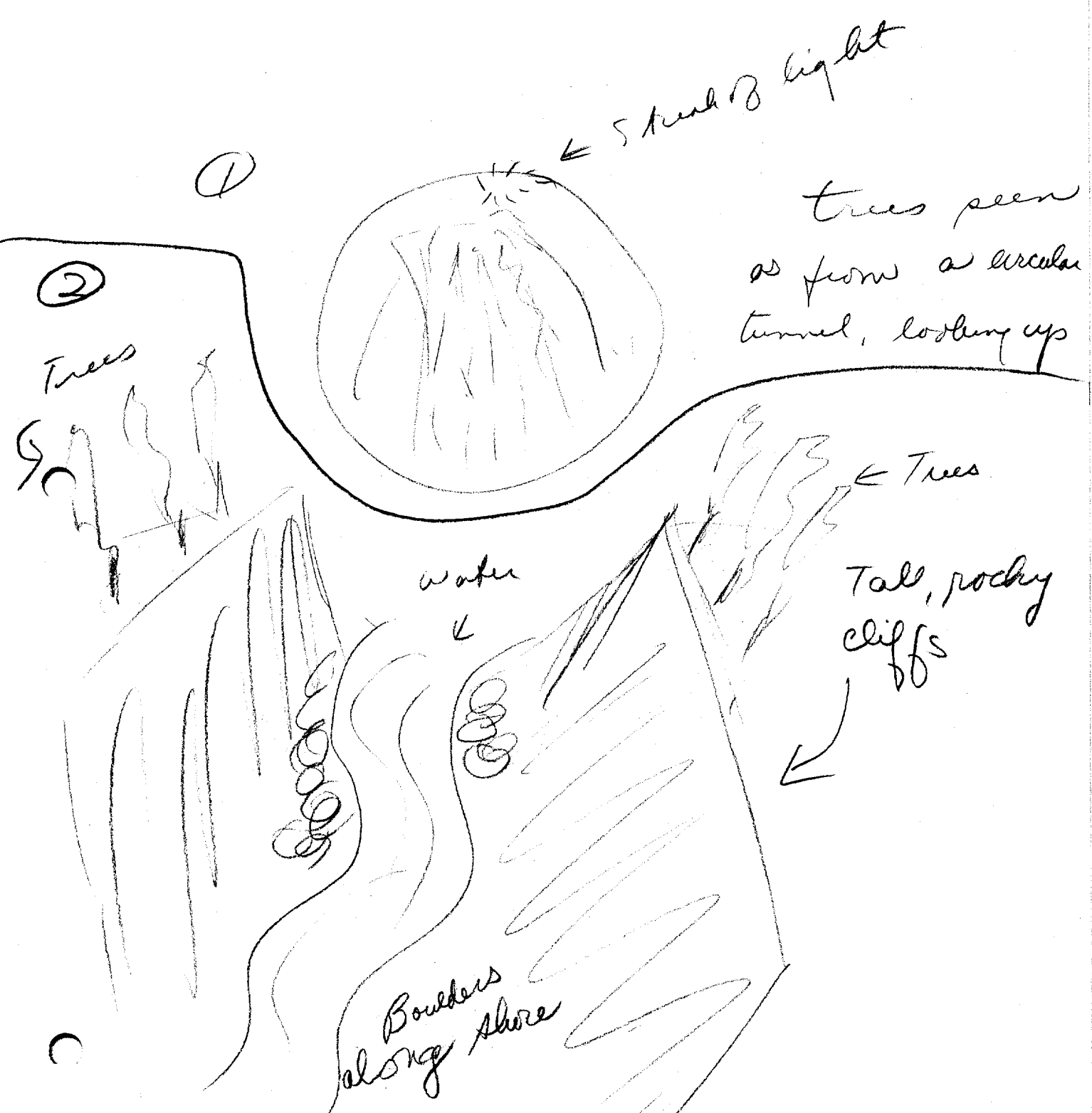

trees seen
as from a circular
tunnel, looking up

water
←

← Trees
Tall, rocky
cliffs

Boulders
along shore

TAB B

Approved For Release 2003/09/11 : CIA-RDP96-00788R000900970001-7

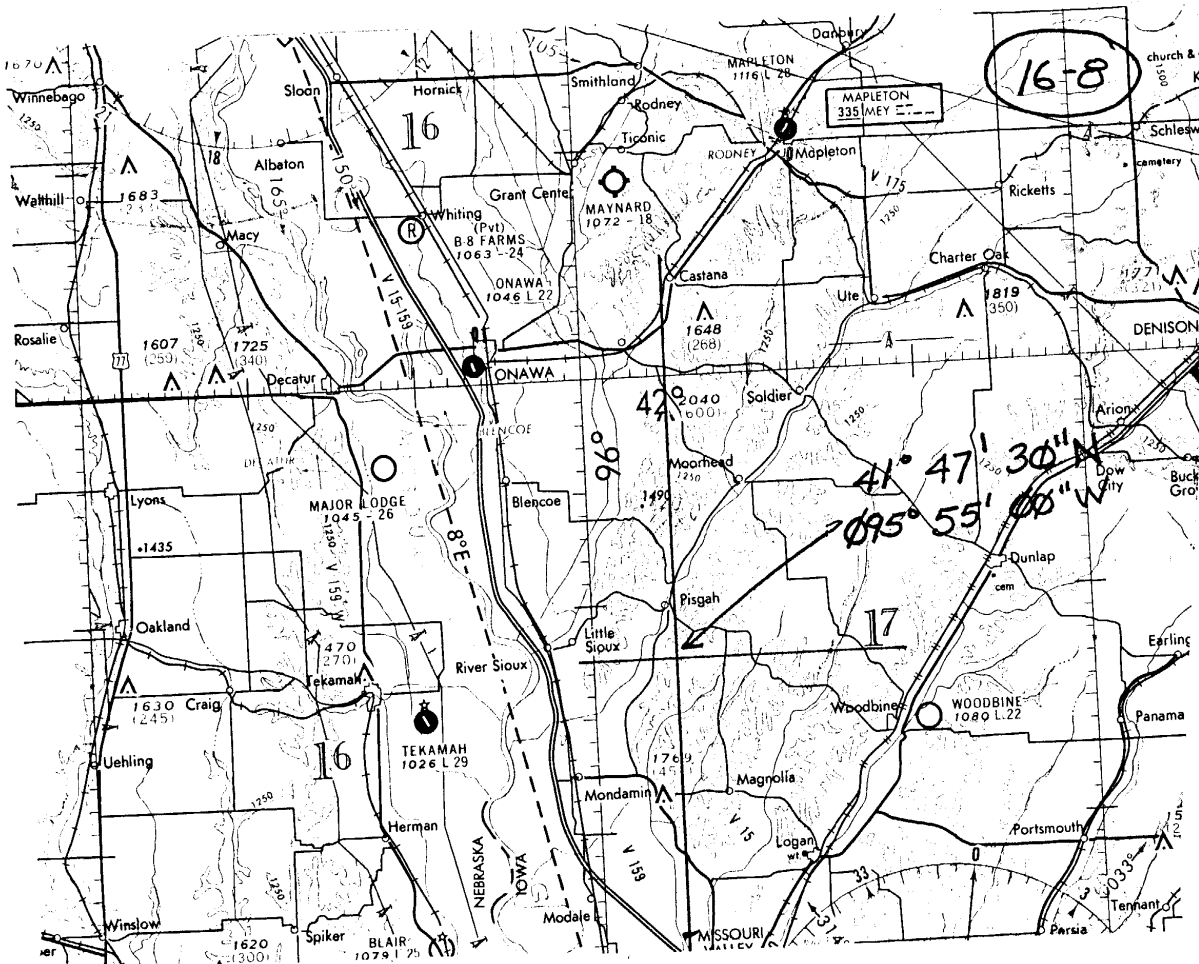

Referral Review by NIMA/DoD

Approved For Release 2003/09/11 : CIA-RDP96-00788R000900970001-7