

~~SECRET~~

Approved For Release 2000/08/07 : CIA-RDP96-00788R000900460001-3

INSCOM

GRILL FLAME

PROJECT

SESSION REPORT

CLASSIFIED BY: Director, DIA
~~DECLASSIFY~~ ON: 31 Jul 99
EXTENDED BY: Director, DIA
REASON: 2-301-C (3) (6)

GRILL FLAME

Approved For Release 2000/08/07 : CIA-RDP96-00788R000900460001-3

~~SECRET~~

~~SECRET~~

SUMMARY ANALYSIS

REMOTE VIEWING (RV) SESSION C 1

1. (S) This report provides documentation of a remote viewing session conducted for training purposes to enhance a remote viewer's demonstrated ability.

2. (S) The viewer appeared tense and frustrated during the first 30 minutes of the session. He answered many of the facilitator's directions with long deep sighs or exhaled deeply between tense drawn lips as if he were trying very hard and becoming frustrated with failure. Dialogue was weak and sporadic but dominated by an impression of an ICBM site somewhere in the Soviet Union. The viewer was directed to enter the largest of two bunkers at about 1030. From that point on the description of his surroundings was more clear, detailed and abundant. The viewer seemed apprehensive about the site and indicated there was a possibility that he was fabricating the whole thing, that the site was similar to some he had previously studied. [REDACTED]

SG1B

[REDACTED] The viewer's previously observed state of relaxed concentration was not observed today. This was probably due to the higher than normal noise level outside the room.

SG1B

3. (S) The protocol used for this session is detailed in the document, Grill Flame Protocol, AMSAA Applied Remote Viewing Protocol (S), undated.

4. (S) Following is a transcript of the viewer's impressions during the remote viewing session. At TAB A are drawings made by the viewer reference his impressions of the target site. At TAB B is a map and description of the target site.

~~SECRET~~

~~SECRET~~

TRANSCRIPT

REMOTE VIEWING (RV) SESSION C 1

TIME

#11: This will be a remote viewing session (edited for security).

PAUSE

#36: #14, the time is now 10 o'clock. In a moment I want you to view a portion of the Earth's surface that will be represented by some coordinates I will provide you. After you have viewed it and examined it thoroughly, I want you to tell me about it and then afterwards I want you to draw what you have seen.

PAUSE

These are the coordinates:

SG1B



I'll give it to you again. I want you to look at this point on the Earth; examine it thoroughly and tell me about it. The coordinates are:

SG1B



PAUSE

Relax and view that area for me.

PAUSE

Do you see the target, #14?

PAUSE

#14: I'm not getting a whole lot of imagery. I did have several impressions though. Now, there it is again.

#36: Describe for me some of your impressions; some of your feelings.

~~SECRET~~

~~SECRET~~

+08 #14: The one I see over and over from my first perspective there was a . . what appeared to be a pointed object coming out of a hole in the ground; such as a missile coming out of an underground silo. Unusual though. . . Missile was very pointed. If I turned it sideways, it would look like the cone coming out of the nose of a MIG-21.

PAUSE

#36: That's very good. Tell me more about it.

PAUSE

Go on the other side and look back at it and tell me what you see.

PAUSE

+10 #14: Oooo! I'm not back to the images I was describing. I'm getting this silhouette of a person. Very unusual.

PAUSE

#36: Is the person part of the scene?

PAUSE

Where is that person?

PAUSE

#14, I want you to go back to the area where you saw the pointed object sticking up from a hole in the ground. Then go up the elevation and then look at the entire scene.

PAUSE

#14: It might take me a while to get it back. I'll . . . I'll let you know if and when I can get there.

PAUSE

+16 I don't seem to be getting anywhere. I think the best thing to do is to erase everything and start over again.

PAUSE

~~SECRET~~

~~SECRET~~

#36: Go up to altitude and make an area search as you often do.

PAUSE

I think that may help you.

PAUSE

+20 #14: I'm not sure if I'm manufacturing all this or not, but I just keep constantly seeing this huge ballistic type missile coming out of an opening, out of a tube. It seemed to be in the ground. I even had a feeling for a very heavy lid which rolls over this silo or tube that's in the ground. I had a feeling associated with this complex was a very large earth covered bunker type thing. Perhaps partly underground, maybe not. And, the only thing that kept popping into my head is Command and Control. Command and Control type bunker. I'm not sure exactly where I am, but I feel or I have the impression that I'm in the Soviet Union. That may or may not be accurate. I really don't have a feeling for where I am. But I lean more towards Soviet Union than anything else. Just as a hunch.

PAUSE

I just keep seeing these profusion of large missiles. They're not surface-to-air type missiles or anything; they're the large ICBM type or something like that.

PAUSE

#36: #14, I want you to go up about 5,000 feet and look at the entire area and describe any unique features you see.

PAUSE

This is very easy for you. Go up to 5,000 feet and describe the unique features of this area.

PAUSE

What do you see, #14?

PAUSE

~~SECRET~~

~~SECRET~~

+26 #14: I'm having a very difficult time. The noise out there is starting to get to me. The only additional thing I did see from any altitude; it was only a few thousand feet. The first bunker I described was almost square, very large, but square. I just saw another one that was extremely large or high. It was earth covered. It wasn't square, it was long and rounded on top. Like a huge missile storage bunker for ICBM type missiles. Like I say, I may be manufacturing all this stuff.

#36: Don't analyze. Tell me what you see.

#14: Yeah. I'm trying not to. The thing that bothers me is that all this stuff is fitting together so nicely. That's what worries me about the analytical part.

#36: It would fit normal conditions that are familiar to you. I want you to go into the first bunker you saw. Not the second one, not the large one, but the first one you saw. Go inside. Tell me what you see.

PAUSE

+30 #14: Hmmm. I'm in a . . . some type of corridor or hallway or something. There's pipes or conduit or something on the walls up higher; up near the ceiling or whatever.

#36: Are they insulated?

#14: Ummm. . . .

#36: Or plain? Describe the pipes.

PAUSE

#14: It appeared to be large, smooth, metallic, light conduit.

#36: Very good. Continue down the hall, tell me what you see.

PAUSE

+32 #14: Seem to be . . . in a room. There's a glass door and some large glass windows there. The room is full of the electronic equipment. Looks a lot like our computer equipment or whatever, but this stuff is just huge. Very bulky.

~~SECRET~~

~~SECRET~~

PAUSE

The. . . There's two sets of equipment or whatever and they're. . in the center of this room or the room is specifically for this equipment.

PAUSE

I have a feeling there's. . two console type things where somebody sits and works. And, whoever sits there and works there would be sitting back-to-back. Its difficult to explain. It would be easier to draw.

#36: You're doing fine.

PAUSE

By huge electronics, do you mean huge cabinets or could you describe that further.

#14: All I just see is the huge bank of electronic equipment. One on each side. Where if I was in the center of the room there would be one on each side of me but this is located in the center of this big room. There's other stuff. . There's a space between this equipment and whatever is going on in the rest of the room.

PAUSE

But, these two banks of equipment are just very large and very bulky. That's the only way I can describe it.

#36: Is it operational now?

PAUSE

#14: I don't know. I don't know.

#36: Do you see any personnel around?

#14: Well, I had the feeling of people in the room, but I . . You know, where do I draw the line. I may have saw the stuff, then manufactured the people to go with it.

PAUSE

+35 But, if I'd have to. . Well, on a hunch, I'd say its active. There would be people there.

5
~~SECRET~~

~~SECRET~~

I don't get a feeling for a lot of people. Kind of like the minimum amount to make this place operational. Two people. Maybe three people out of this whole. . this large room.

PAUSE

I have a feeling that there's a lot of other electronic equipment all along. . all over this room along the walls and all that stuff but these two huge banks of equipment in the center of the room seem to be the focal point.

#36: I want you to look around the room very carefully and see if there are any other doors. Other than the one that leads to the hallway you talked about.

PAUSE

#14: I have the feeling that there's another door off to my left. But I feel I've already checked it out. Its either a storeroom or there's more electronic equipment there. I'm not sure which.

#36: Did you go in that room?

+36 #14: Kind of. Half in and half out. I feel there's more electronic equipment there.

PAUSE

You know, lots of wires. . it reminded me of what I would imagine a huge telephone company switching branch would look like. Just tons of wire harnesses and wires and things like that.

I'm outside of that facility now. And, maybe I'm not. I don't know. But right now, I'm looking down. . the only thing I can describe, its a silo and looking at the nose of a missile.

PAUSE

#36: You are looking into the silo and see the nose of a missile?

#14: I seem to be standing on the top edge looking down.

PAUSE

~~SECRET~~

~~SECRET~~

You know, its funny. When I saw some of these things earlier blasting off on the silo. . . there were several instances, I'm not sure, but I almost had the feel for a liquid fuel. You know, how its streaming out of the overflow areas or whatever, this liquid fuel. Liquid fuel??

#36: You're describing vapors?

+38 #14: Yeah. I had that impression several times and associate it with liquid fuel. I think that's rather primitive though for an ICBM, a liquid fuel, isn't it?

#36: I don't know. Just tell me what you see and we'll find out later.

I understand you were talking about vapors that are often seen with refueling liquid fuel?

#14: Yeah. That's what. . liquid fuel. Liquid fuel.

#36: I'd like you to go down the silo (not audible) and tell me what you see.

#14: Well, right now I'm floating directly above the nose of that missile and I don't see anything but a long, long way down.

PAUSE

#36: Does the depth of that silo make you uneasy?

PAUSE

#14: Not really.

#36: If it does, don't go down. Just tell me what you see.

PAUSE

#14: No, it doesn't make me uneasy, its just that I have a feeling that there's not much down there. You know, the missile is there and. . you know, nothing else but garbage around.

#36: Well, since you're up above the facility. . . .

#14: Whoa! Whoa! Whoa! Whoa! Wait a second!

#36: Okay, what'd you get?

~~SECRET~~

~~SECRET~~

#14: Ha ha ha. When you said, since you're up above, I was. . .

#36: You moved on me.

+40 #14: Ha ha, I now appear to be in the silo looking out.

PAUSE

Oh, that was just a flash. But I was in. The hole was overhead. I was down in the silo.

#36: Um hm.

PAUSE

#14: I don't know where I am right now.

#36: All right, #14, you've had a very good session. Do you want to look around the area again before we draw some of those things you've seen? Take one more look around the area.

#14: Okay, let me see if I can't just float up and look around.

PAUSE

+48 I'd better start drawing some of this stuff while I still have a handle on it.

PAUSE

#36: Would you like to have some light?

#14: No. That's fine.

PAUSE

Page 1, Item A.

#36: Is that the first cone you saw in the hole in the ground?

#14: Right. Like I said, this one I saw, if you turn it sideways it would be like looking at the nose of a MIG-21.

#36: I remember that description. I see what you mean. It does look like that.

~~SECRET~~

~~SECRET~~

PAUSE

#14: Boy, that's a neat one. Next impression I had was that "B". I still had this sharp pointed column coming out of the hole but there was this huge thick lid next to this hole.

PAUSE

#36: That is labeled "B".

#14: Right.

PAUSE

#36: While you were describing the heavy lid, you also . . .

TURN OVER TAPE

#14: I fyou want to, you can throw a little bit more light on.

PAUSE

Yeah, that's good.

#36: How's that?

#14: Good. Fine.

#36: At the time you were describing this, you mentioned a large bunker and you used the words Command and Control.

PAUSE

#14: There were other things before that, weren't there?

#36: I believe the only thing you mentioned before that was a silhouette of a man.

#14: You know, I had . . . I saw . . . I'm seeing it right now. Silhouette of a man. I wonder if that couldn't be symbolic for a shape instead of buildings or something. I don't know.

PAUSE

The reason I say that is because when I was studying strategic missiles I used to identify a certain support facility by the shape; the way the buildings were put together which was a key identification feature. And I used to call this

~~SECRET~~

~~SECRET~~

my little man all the time because it almost looked like a man. There may be some symbology towards that.

#36: Does that fit the kind of specific (not audible).

#14: I don't know but it seems to fit this whole thing. If I was just to draw the man here it would be nothing. So let me, In Item C, . . I'm trying . . I believe the buildings were shaped like this.

#36: I see why you use that particular cueing device for your memory.

#14: Yeah. Well, let's go on to the next one. The bunker.

PAUSE

Then, of course, I saw it from several angles. It had a square top.

#36: You said square, flat top that you could see through.

#14: Right.

#36: You did mention that it was earth covered.

#14: Yeah. But even earth covered, the top was flat.

#36: I just wanted to be sure I was understanding what you were saying. You could see a square flat shape.

#14: Um hm. Right.

PAUSE

This is kind of a . . at "D", kind of oblique . . not too good I guess.

PAUSE

"E" is more of a top view.

#36: Is that the second bunker?

#14: No, that's. . . .

#36: Another view of the same one.

#14: Right.

~~SECRET~~

~~SECRET~~

PAUSE

#36: Could you label those B Prime and B 1 and B 2, to we know that they are the same one - different views.

#14: Yeah.

PAUSE

How's that?

#36: That's good.

#14: Another bunker shape that I had, and I also saw that from several angles. I'll draw the first one. It was odd, it was kind of like this. I'm going to make it look long. As if I'm looking up.

PAUSE

#36: You say you flew along in this direction like a loaf of bread?

#14: Yeah. Why is it so difficult to draw?

PAUSE

E 1 is kind of a front view, a like view. Not very good.

#36: Its a good drawing; I can see it.

#14: I'll draw an aerial perspective. . from where I was. I'm not sure whether it had an entrance on each end. It could have had.

PAUSE

Oh, that's not too well either.

PAUSE

That looks more like it, I guess.

PAUSE

#36: Is that part of your bunker or is that E-3?

#14: No, that's E-3. Its trying to make a better drawing of 2.

~~SECRET~~

~~SECRET~~

- #36: All right, #14, the next thing that you described in clarity was being in a long hallway with large metallic pipes up high.
- #14: Well, at first I went through the whole thing. First I approached this bunker and there was a small doorway there or whatever. I seemed to be inside, but this. . this would be Page 2, F-1.
- #36: Um hm.
- #14: There appeared to be a small opening here, a doorway.
- #36: But that opening is of size for a human to get into.
- #14: That's where I wnet in. Yeah, its . . .
- #36: Very large doorway.
- #14: Ahhh. . . at 2, I moved closer until all I saw was this opening. It was. . . I don't know if there's a . . . It was large enough for two doors to be in there.
- #36: Um hm. I can see from your heights or width ratio that it could take two normal size doors.
- #14: That was kind of set back, recessed.

PAUSE

I decided not to try to open the door and go in through the usual means. The next thing I remember in F-3 was this hallway.

PAUSE

There appeared to be this, large pipes of conduit. It was attached to the wall and they were various sizes. There was a large one, there were several small. . this was dark down here. I had the feeling of. . there were several doorways or whatever down here.

PAUSE

There didn't seem to be any doorway on my right or access way.

PAUSE

~~SECRET~~

~~SECRET~~

- #36: Do those windows lead to the outside or to another area?
- #14: No. No. It seemed it was either a hallway outside of there or it was all internal.
- #36: Um hm. Are you suggesting that those windows were used to view inside the room or outside the room?
- #14: I don't know. Its hard to say.
- #36: Don't worry about it, go ahead.
- #14: And in relation to this. . .this is really not a fair representation.
- PAUSE
- #36: What is that #14?
- #14: This is a chair here. Whre somebody would sit or whatever.
- #36: Okay. I see what you mean.
- #14: Yeah. And there's . . . just all kinds of gadgets and stuff like that. And, they were just huge and bulky. Okay, we'ge got one here. And, we've got one over here. This is another console here. And there'd be another chair here. And, as I described, these two operators or whatever, would be sitting back-to-back. And that's. . and looking inbetween them, if you were standing back, you would see the doorway and these two window type things.
- PAUSE
- #36: Label that "G".
- #14: I've got F-4.
- #36: Oh, F?
- #14: Yeah. These are all related to . . .
- #36: Okay. All right.
- #14: And . . .
- #36: Your "F" which is hallway. Okay, same complex. Okay.

~~SECRET~~

~~SECRET~~

#14: Well, I can label this "G". Well.

#36: It doesn't matter.

#14: As long as its labeled, I guess.

#36: It doesn't matter.

PAUSE

#14: Let me come up with an F-5 here.

PAUSE

I'll draw an aerial type.

PAUSE

#36: That's the consoles.

#14: Right. Over here is the door. Window. I had a feeling that all along the outer edge of this room, of course, it was broken up in different areas.

#36: Electrons.

#14: Yeah.

#36: Captives, whatever.

#14: Electronic equipment. I don't know why anybody would want to put something together like that but . . .

#36: Do you know where the other door was?

#14: Yeah. I'll get to it. The other door was over here. And there was another, Oh God, I don't know how far this room went back, it was another large room, I'll put it back at least to here. And back in here was just a profusion. Electrical wiring. This was all inside this bunker. The square bunker.

#36: Later you were seeing silo's again. Was that the same silo that you looked at earlier.

#14: Well, I had a much better view. I'll label this "G". This time, I was looking at a round nosed missile and I was standing up above looking down.

#36: Um hm.

14 ~~SECRET~~

~~SECRET~~

#14: I'm going to have to draw one thing or the other. I'll draw the missile solid. It will stand out against the rest of it.

PAUSE

I don't know why I drew it that way.

PAUSE

Anyhow, I was standing on the edge, looking down. Call that G-1, G-2.

#36: That;s when you (not audible) overhead.

#14: Right. Oh, don't ask me how I draw some of these. And there appeared to be some type of pipes or whatever alongside the walls at different places. I didn't. . . It was difficult to pay a whole lot of attention to it.

PAUSE

But it was dark way down in the recesses.

PAUSE

#36: You appeared a little apprehensive above here looking down on it and then I discovered that you were down there anyway.

#14: Yeah. There was a little lapse of time there and the next thing I knew, when you were suggesting that I . . .

#36: I thought you were still up there looking down and I said go down.

#14: Yeah, and when you suggested that I go up higher and I looked up and I was looking out of the hole from down below. The only thing I had . . I wasn't apprehensive, it just looked a little bit crowded down there. You know, there wasn't a whole lot of room.

#36: That was about it as far as the descriptions you gave me. Do you have anything else?

#14: No. In G-3, like I said I was getting a lot of different shopts of this thing coming out. This is just another huge, I had the feeling it was a huge round shapeness so I didn't, couldn't get any fins or anything associated with it.

~~SECRET~~

~~SECRET~~

PAUSE

And this was where I had this feeling of liquid fuel, of fumes venting out or whatever. And then there was a lot of stuff coming back and out of here.

PAUSE

And when these things were exiting the silo it was almost as if it was slow motion, you know, you could just see them coming and going up.

PAUSE

#36: Is that about it?

#14: That's about it. If this isn't the target we sure built a heck of a story around it.

#36: The time is 1113. End of session.

~~SECRET~~

TAB A

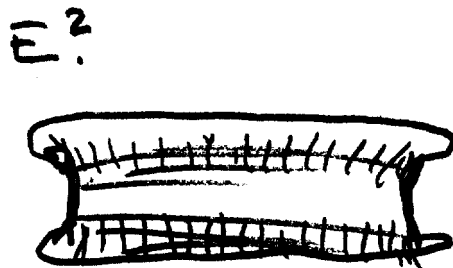
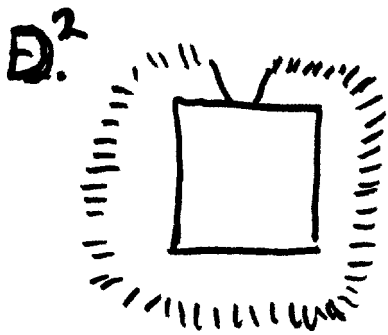
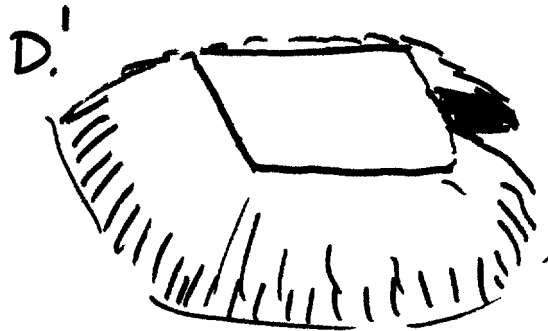
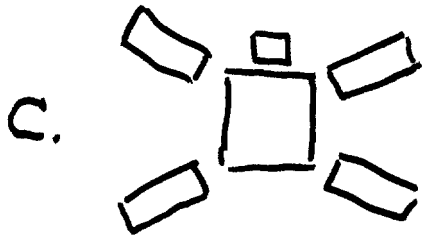

F.1



F.2

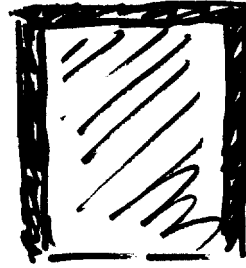

F.3

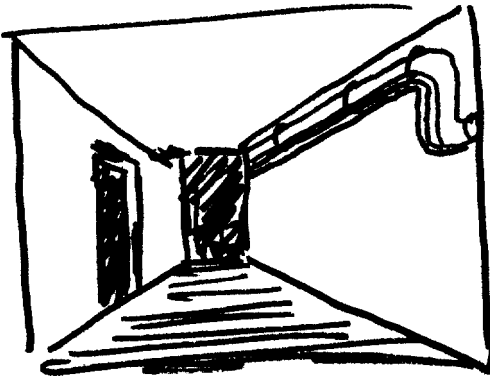

F.4

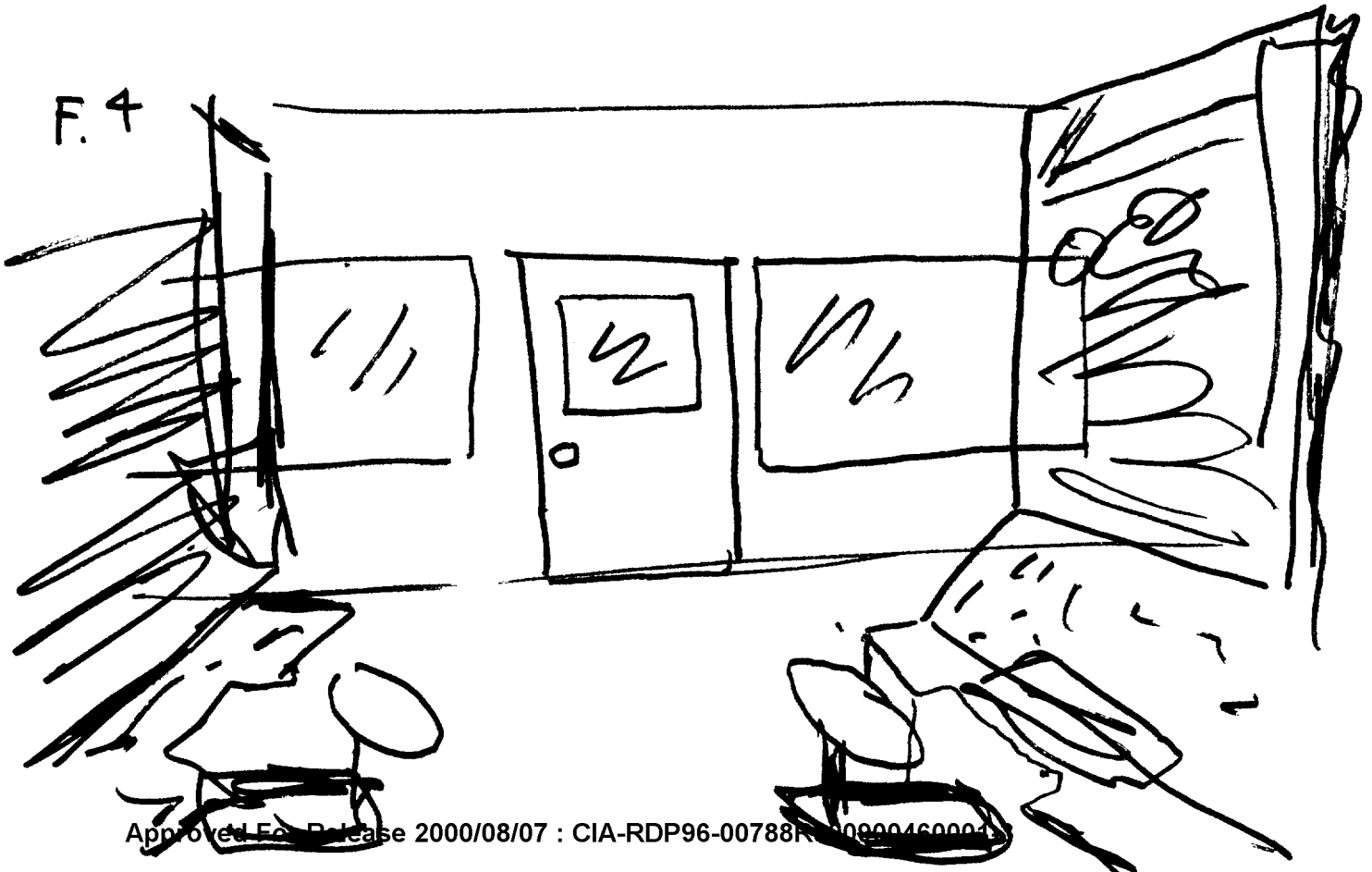

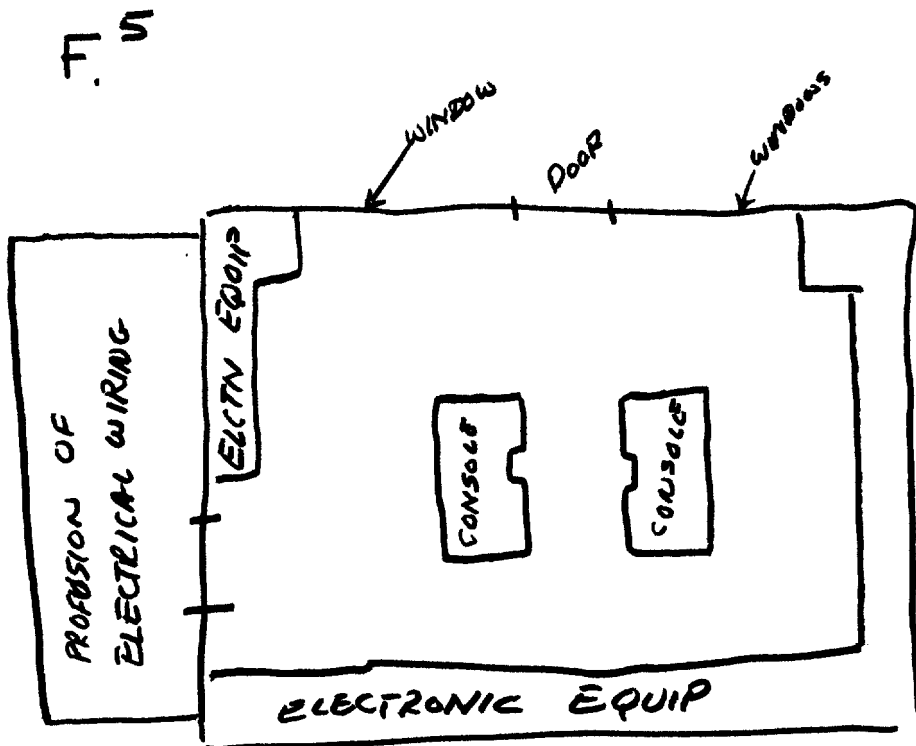

G¹

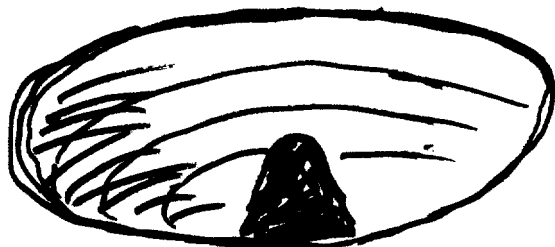

G²

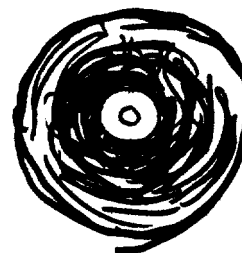

G.³

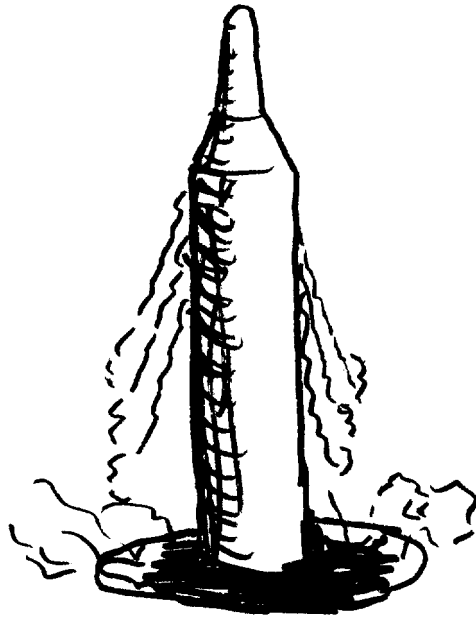

TAB B

SG1B

Approved For Release 2000/08/07 : CIA-RDP96-00788R000900460001-3

Next 1 Page(s) In Document Exempt

Approved For Release 2000/08/07 : CIA-RDP96-00788R000900460001-3