

SECRET

INSCOM
GRILL FLAME
PROGRAM

SESSION REPORT

CLASSIFIED BY:MSG,DAMI-ISH
DATED: 051630ZJUL78

NOT RELEASABLE TO FOREIGN NATIONALS REVIEW ON: Aug 2001
62-060-81

SECRET OR U **GRILL FLAME**

copy 1 of 2 copies

NOT RELEASABLE TO FOREIGN NATIONALS

SECRET

SECRET

TRANSCRIPT

REMOTE VIEWING SESSION 800

TIME

#14: This will be a remote viewing session for 30 July 1981; mission time is 0900 hours.

#08: Nine hundred hours.

PAUSE

#14: All right #08, the time is 0900 hours. What I'd like you to do today is focus on [redacted] He's an employee of the Embassy in the photograph shown you. I would like you to focus on [redacted] while he is at his job in the Embassy, and describe his job to me.

SG1A
SG1A

PAUSE

+02 #08: This person's full function has to do with the processing and ... papers, official papers somehow connected with the nationals of that country. Also something about some form of receptionist duty at the Embassy itself, and there's a third function of equal importance is that of translator, interpreter if you wish.....his principal supervisor is an attache..... but, only.. appears to work almost directly and exclusivelythe attache is the.....man mainly responsible for the culling and reporting of political information that was in that country for a particular region.

+05

PAUSE

#08: Okay. Anything else?

SG1A

#14: Is [redacted] involved in anything that would be of interest to US Intelligence?

PAUSE

+10 #08: I, I don't really see anything extraordinary here. It's.....what appears to be happening is.....this man has helped the US Intelligence...not greatly, but...kind of continually through his abilities and contact, and now (mumble) intelligencethe man has contact with, with our representatives. (Mumble) regional office of national intelligence with that country, but that's not a great, that's not a big deal. I.. you don't see the man as having made a (mumble) officially or formally to make a, to undertake a very specific, definite

SECRET

SECRET

#08: (mumble) mission..... However, the attache should not be overwhelmed by this man's ability, because his loyalty lies with his government not ours, and that's the danger. Again, I repeat, the man is in contact with a representative and....a regional intelligence representative of the country, that..... and there is an exchange (mumble) but, there is no categorical for long tasking for a specific espionage activity It's like their representative trying to keep..... the rest of...(mumble) is at the Embassy through the, almost informal contact.....(mumble)....Got anything else?

SG1A #14: Focusing back on [REDACTED] job, describe again the area that he normally works at.

#08: He works among a group of several people in a large... office. He occupies one of....one of severa-eight desks... and, but again he seems to be...called upon by that attache who seems to use it exclusively, but there also is...no, let's not go back to the duty....He's also involved in normal routine paper work. I see a library type atmosphere... open area with desks lined up...one side a book of shelves... open to some light, and the other three walls aren't..... Something about a lot of books on shelves. It's a very library type atmosphere. Anything else?

#14: No. I have no further questions at this time.

PAUSE

#14: We're now ready for debrief.

#08: Okay. The sketch that I've made is labeled sketch number one, it's the work area, sort of an overview. And, what it is, it's a open area in a conference, library type atmosphere with about seven or eight desks, and the...perhaps the predominant impression that I got about the area was a library type shelving to the right of [REDACTED] desks. That seems to be strong along the

SG1A wall, towards the street area. And, on the street area where the windows are, I don't know, there seems to be a curvature on that wall where the windows are. This may be significant, I don't know. The rest of it is pretty mundane. There are conference tables and chairs. Kind of a plush area with.... a wooden furniture, vineer wooden furniture, and made out in good tast and very intellectual atmosphere where they handle a lot of paper and file a lot of paper and so on. And, there is a door that leads to a chamber, that in turn leads to the man that I've described as an attache for whom [REDACTED] works. SG1A So, I don't see him in the attache's, working physically and directly in the attache's room. He works in another room. But, he's used a great deal by the attache. Anything else you want described or added or.....

SECRET

SECRET

#14: Yeah. You were describing your feelings about his recruitment or, something like that.

#08: Well, I don't see him as a.....I don't see him as a specific recruiting threat with an assigned mission by far in intelligence at this time. It doesn't preclude the fact that... and, he does have the circumstances, and the informal contacts to make himself look good and sort of discretely. I must emphasize very discretely....indicate what's going on at the Embassy in a very discrete fashion. Insofar, that it makes them look good and important. But, he's not a specific, direct espionage threat at this time. I perceive the danger that, the only danger that I perceived was that the man is very good and does his job so well, and has opened a few doors on behalf of the attache...the danger is to develop, or have developed a very perceptible personal friendship, relationship between the attache and [REDACTED] Wherein, the attache might be tempted to trust this man beyond what he should under the circumstances. What he should do is keep in mind this guy's a foreign national. His loyalty's to the foreign country, and whatever he says he should be saying with the attitude that it's going to go back to the nationals of that country. He's not a..... let's just say, he's not a fellow-American. I don't perceive any other threat at this time.

SG1A

#14: Okay. Anything else?

#08: No.

#14: End of session.

SECRET

TAB

Dark Area Overview

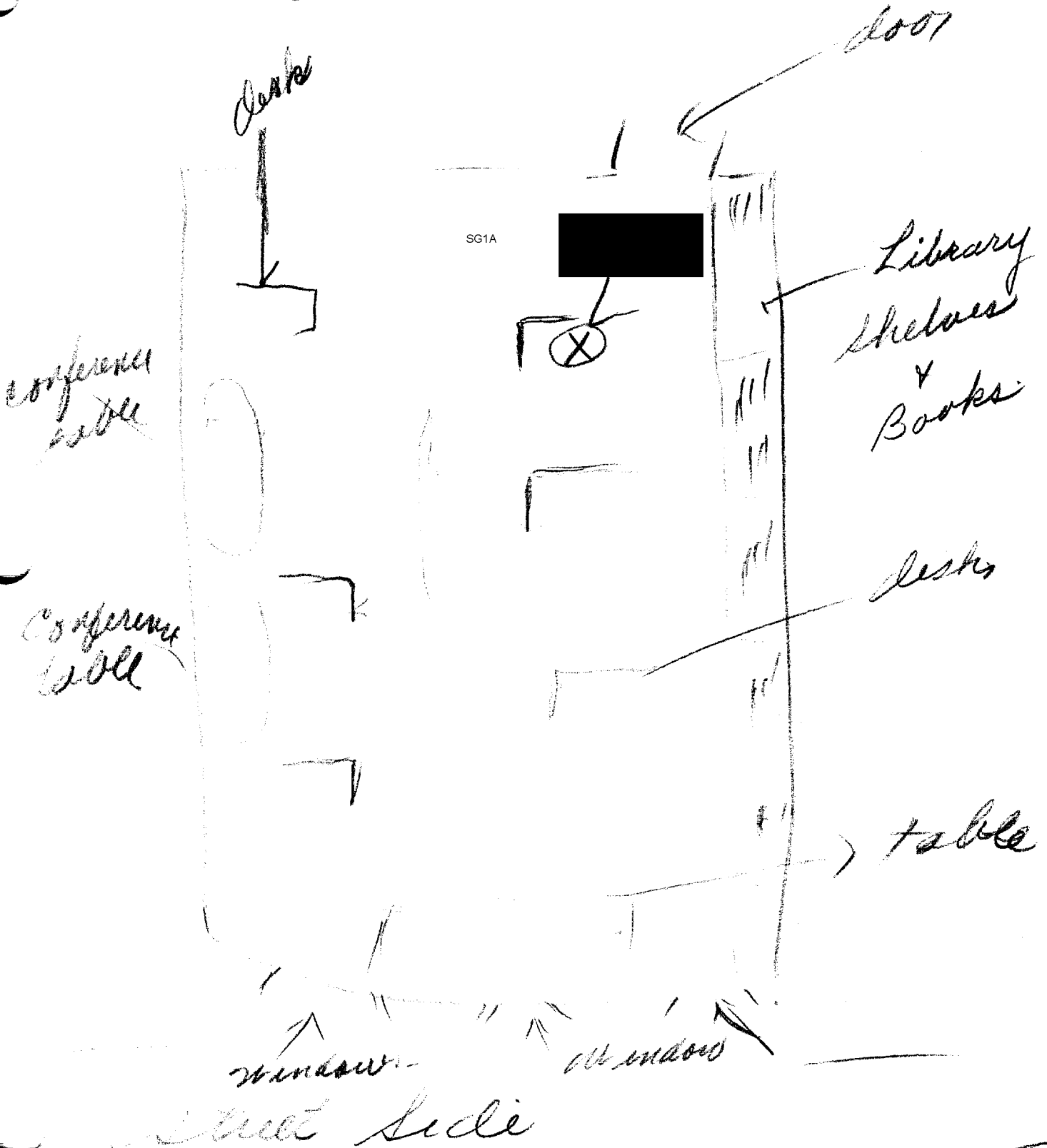

TAB

SECRET

TARGET CUING INFORMATION

REMOTE VIEWING SESSION 800

1. (S/NOFORN) The remote viewer was shown the following photographs prior to the start of this session. He was told that [REDACTED] works at the U.S. Embassy shown in the photograph.

SG1A

2. (S/NOFORN) During the session the viewer was asked to focus on [REDACTED] and describe his job and work area. He was also asked if [REDACTED] was involved in any activity of concern to USI.

SG1A

SG1A

NOT RELEASABLE TO FOREIGN NATIONALS

ORCON

SECRET

SG1A

Approved For Release 2000/08/07 : CIA-RDP96-00788R000500610001-0

Next 1 Page(s) In Document Exempt

Approved For Release 2000/08/07 : CIA-RDP96-00788R000500610001-0