

SECRET

ORCCN/NOFORN

INSCOM

GRILL FLAME

PROJECT

SESSION REPORT

CLASSIFIED BY: Director, DIA
REVIEW ON: 1 Nov 99
EXTENDED BY: Director, DIA
REASON: 2-301-C (3) (6)

SECRET GRILL FLAME

SECRET

TRANSCRIPT

REMOTE VIEWING (RV) SESSION C 75

#66 This will be a remote viewing session (edited for security).

PAUSE

It's time now to focus your attention on the large building that you've told us about before located in the vicinity of:

SG1A



PAUSE

This is the target for today. Focus your attention now at the present time on the target and describe it to me.

PAUSE

+06 #10.5 I got familiar imagery. I was going to say..... mumbling.....above the end of.....peak building it seemed to be smaller and across the way there was.....was....a...was a familiar east wall with tunnel. Close in tunnel.

#66 OK. Relax and concentrate. Go above this area, go above this area that you perceive is the east 100 feet in the air, look down on this area and describe it to me.

PAUSE

+10 #10.5 Uh.....uh..looking down..uh..building seems to have uh...a big center line...looks smaller than the other one. Center line seems to run perpendicular to the other one. Uh...feel..uh.....on the....uh..some funny long thing sticking out of the bottom corner...of the main building. I feel banks....I feel as though I'm sort of in between banks. I'm standing on..a.on south side of the building. Uh..a big one.

SECRET

~~SECRET~~

66 Alright.

#10.5 Going back up the upper right of my.....another side of that small building....have a....right of that small building.....I have a feeling there's a rush in the water. It seems to be a bolder dam up there..water running towards me. It seems to be out.....I don't get the feeling it's massive. Get the feeling more like it's just a lock.

#66 OK. I'd like you to focus your attention now back on the large building. Take your perspectives standing on top of the small building, on top of the small building you just described and look at the large building. Stand on top of the small building and look at the large building and describe what you see.

#10.5 It's massive.

#66 Look down towards the ground and describe. Look down towards the ground.

PAUSE

#10.5 Looking down towards the ground, between the two structures....I don't really.....I don't see anything

#66 What do you see?

PAUSE

+15 #10.5 I have feeling of..a..that on the right, on the ground is connecting thing between the corners of these two buildings that face each other. I still feel that that is there. I'm on the ground looking back at what I think is the small building. And I have a.....have a large.....I'm on hard ground...uh.. I have a large.....uh....on the face of the building there seems to be exceptionally large rectangle, vertical rectangle like the..a..large door...uh....

#66 Tell me more about the connecting thing.

PAUSE

~~SECRET~~

~~SECRET~~

#10.5 It appears to be a...about 20 feet high. It appears to be off the ground a little bit. (Mumbling...sides and then I went down...like looking under it or...like it was up off the ground about 2 feet.....

#66 Yes. Alright. Move in underneath it now. Tell me about the inside of it.

PAUSE

#10.5 I think it is over and on the bottom and it's just a cover...more for...whatever observation in structure. I have the feeling that it's open off the ground, and it's almost like a little railroad track in there. It looks like maybe...uh...just a single track. I have the feeling of rails...of two...of two tracks parallel on the ground.

#66 Tell me where they go.

#10.5 They go into the.....straight line.....they go... ..uh...into the little building.

#66 Follow them into the little building. Describe as you go.

+20 #10.5 About where...uh...where it enters the building there...let me see...(mumbling) ...a big...a big area...uh...tracks...uh...seemed to...uh...seems to split down into a couple.

#66 Alright.

#10.5 OK.

#66 Stand observing the tracks. Stand observing the tracks and see in your mind, see in your mind what is moved along these tracks. Describe it to me.

#10.5 I have a...I had a thing that looks like a miniature railroad flat bed car.

~~SECRET~~

~~SECRET~~

#66 What is on this...

#10.5 On this thing is something rounded and long. It's carried long-wise laying on it...it has like two different...uh...it looks...it is a...it's round ...it's got like three different layers. I feel...uh... coiling...coiled inside...uh...a center core. Almost like a turbine of some kind that is, maybe, on the track, on the dollie, is a...stands...half again man's height. It's got a bunk on...it's funny shape. It's hard to describe it. It has something long and skinny sticking out at one end. But...and this big round thing and it's got a round knob on the other end of it.

#66 Which direction do these move on the tracks, between the buildings. Which directions do these things move?

#10.5 I feel that they move from here to the other place. I feel it moving out the way I came in. This is the way I perce...I felt that it was coming from the forked end to the track and it was linked on to this main thing and then it went...was going passed me.

#66 OK. And it is going towards.....

#10.5the big building.

#66 OK. I'd like you to leave the small building now following down the tracks and describe where these tracks lead.

PAUSE

+25 #66 Where are you now.

#10.5 Up half-way. I'm taking it slow.

PAUSE

#66 Are you under the cover?

#10.5 Yeah.

#66 What's the purpose of this cover?

⁴
~~SECRET~~

~~SECRET~~

#10.5 It....it's just sheet metal...wood. Weather shield or something. Not structural. Nothing hangs in the roof. It wouldn't support any internal weight. It's just a shield. I want to say it...a...not even sheet metal. I want to say it's wood. That's all, just wood lapping. I see...uh...guys coming down with big brooms. They just sweep the dust and the dirt and snow, if there's snow...keep it out from under this thing so they can get their stuff through.

#66 Alright. Move now on down the tracks.

#10.5 Seems to be a...(mumbling)...stairwell outside the building, where I am. I can just sort of see it as I go by. I'm going into the building now.

#66 That's fine. Tell me about it.

PAUSE

#10.5 I have a.....pause.....

#66 Go on.

#10.5 I feel like I got pulled off of it...by something. Just a minute...sigh...I know I've been someplace. I don't see anything in there. I have the feeling there's stuff stacked all along the wall, on the sides of me as I go by. Big mass of parts of things sitting on pallets of some kind...stands of some kind lined up...like a overhead...uh...heavy jacks, pullies, jack stands, dollies overhead. I see some of these round things that I'm following. And they seem to be on my left. Just goes on...I'm going along with it. On the right seems...uh...more pallets of things. Big parts. They're hard to see what they...they're so big.

+31 #66 Follow the tracks.

#10.5 I think I got over in a ditch...over on one side there, I think I see curved things. I'm going on.

PAUSE

This is weird. I'm moving along and a...slowly drifting down these tracks, taking in the sights, and, on my left I had this feeling there was some funny tall glassed-in booth, almost like a control tower. There

~~SECRET~~

~~SECRET~~

is some sort of a rounded glass face on it. And the old track just went right on by it. It was like up on a pedestal. I had this feeling when I got just about past that the track ended abruptly, at a deep edge. Like a deep pit. Just a drop off. But, this control tower, about 25 feet high, sat up on the edge of this...a...pit, and could look both at, where I was, and could look over the edge down into this big pit, at the same time, and that he, like for...like...the, that was like a control area...like a monitor, everything that was going on...like monitored some part of what was going on. They could see all over the place. They could lift things and move things and direct things and.....

#66 OK. Fine.

PAUSE

#10.5 Uh...that's about.....I have the feeling that I've come into the building, like maybe 150-200 feet along this track. Because I could look back down the track and I can see what I came through as being just a little square a light area...what...where I came in.

#66 OK. Move up to the observation area that you've described to me. Move up there yourself and look down at the pit.

PAUSE

#10.5 It's going to take some doing because I love pretty lights.

+35 #66 Keep your eyes down as you move up.

PAUSE

#10.5 I am trying to get a view...get it in a second. What have we got here.....OK.....

#66 Tell me about the pit.

#10.5 Oh. About the pit.

PAUSE

~~SECRET~~

~~SECRET~~

PAUSE

#10.5 OK. I'm looking at it so.....a....so big across it.....

#66 What's the shape of the pit?

#10.5 Rectangular..simple shape...seems to have a guard rail on it to keep people from falling in. Doesn't seem to be too extremely deep. Deep enough to hurt you. Maybe 30 feet, 35 feet. It's hard to tell 'cause I'm even up higher than I was. Uh..trying to get the configuration of this thing here. Seems it really.....almost like a cavern like feeling.

#66 See the activity at the pit. See the activity at the pit. Describe what goes on at the pit.

#10.5 Alright. In this one I have.....empty..... then, maintaining emptiness, sweeping stuff like that. Then..uh..activity there, maintenance activity is occurring in and around a great girdle ..uh..uh..that is in the bottom of the pit. Uh... it's a...a frame a bed structure. Curves (mumbling) line, semi-circles and...like a carriage, OK. Then I have a...what do I have..a...I got this thing ...what yeah...I got this image in the end of it looking back in towards the control tower of a ...that.....super structure nestled in the framelike a cross section, that's all. That was like I was looking at somebody's schematic.

+40

#66 What type of vessel?

#10.5 Configuration is a 4. I have feeling of a submarine as opposed to surface vessel. The image I had was again no one of con...and cigar shape They just sort of came to me matter of factly, I just, that was the one that fit in there. These girdles are.....

#66 Right now, at the present time, is there a vessel in the pit?

#10.5 No. Not this.....

#66 Are there other pits?

~~SECRET~~

~~SECRET~~

#10.5 That's what I was going to work on next. If there are any others I will have to go look for 'em. That was when you asked me, "What was going on in the pit?" My first thing was...this empty pit was guys working in it, but with the girdle there and everything.....and when you asked me, "What was done there?" then I 'sort of put together the progression of what was done there. And when you asked me again, I went back to the control tower and I got an empty pit again.

#66 OK. I understand.

#10.5 But, I'd have to say..at least to this place...it's nothing going on right now, more maintenance and clean up and fixing repairs on equipment and stuff. Now.....my feeling is that.....this bay or pit rectangular shape thing is perpendicular to the path of the railroad track, or the little track that I followed in. It seems to me that this thing goes from right to left as I stand to the end of that thing. Now.....

#66 OK. At this time I'd like you to relax and concentrate for a moment. Relax and concentrate on your image.

(turned tape over)

PAUSE

+45 #66 And what is it you perceive?

#10.5 I get a little bigger view.....I get.....ah....I get this feeling of some...a...nodes...like a...like a turn table..or railroad train, you know. They're like rays emanating off of this and that those are maybe the bays or the pits. I just had...I was trying to get across this place and looked back where I was to get sort of a greater view and I had the...had the feeling of the pit, or whatever, empty was closed off and dry...uh...in it but that like radiating around were several more...I don't know.

+50 I also had the same feeling that there was another one just up the line that had a...a vessel in it.

~~SECRET~~

~~SECRET~~

#10.5 I don't know, I'm not getting too much here.

#66 OK. I'd like to move you to a different area.
Are you ready?

#10.5 Yes.

#66 I'd like you to reorient yourself outside the
east end of the building. Tell me when you're there.

PAUSE

#10.5 Alright.

#66 Describe what you see.

#10.5 I'm looking at the parallel between the two buildings
and in front of me is this covered area.

#66 Alright. Face the large building, please.

#10.5 Alright.

#66 Move up in the air, parallel with the roof.

#10.5 Alright.

#66 Move on to the roof.

#10.5 Alright.

#66 Move to the west end of the building.

#10.5 Alright.

#66 Standing on the edge of the building, look down over
the edge. Stay up on the top, look down over the edge
and describe what you see.

PAUSE

#10.5 I see right under me, I see water. Like a small
river, embankment; what else do I see?

~~SECRET~~

~~SECRET~~

#66 Go on.

#10.5 Yeah. I get the feeling there's a..a..shoot for water. It's a...OK.

#66 Looking right down the edge of the building, right straight down the edge of the building... What's right down at the bottom?

#10.5 What's right down at the bottom?

#66 Stand. Stay up on the top of the building, now.

#10.5 I am.

PAUSE

#10.5 ...right down the edge of the building..... Well, I want to say I see a catwalk.

#66 That's fine.

#10.5 ...or something that is below me...uh...catwalk that goes...at least over the middle part of the building...I don't think it goes all the way from one end to end but inner section right under me ...catwalk on..uh..

#66 ...and on...moving away from the building, what's on the other side of the catwalk? Moving, out, away from the building.

+55 #10.5 ...Away from the building...catwalk. I got a feeling of things that are..uh..what are they like upside down "L"s. Upside down capitol "L"s. They seem to be like ..something like that shape. Uh..whatelse is it. I got a feeling..wait a minute...yeah..some sort of metal work which is a rectangular...that I...it appears to me it straddles where the water is. It's like a bigget, goes over this thing and..uh.. The first impression I had was like overhead lighting ...exterior light things sticking up out of the ground. And...uh...seems to be almost a row of these that go off away from the building. There's a row of regular things somewhere and at the foot of them, I want to say that there's a chain link fence that goes out on either side too. Sort of like to keep people from getting in close.

~~SECRET~~

~~SECRET~~

#66 OK. I'd like to change your perspective, now. Center yourself on the top..on the top of this of the building. In the middle of the building space. Move now at the same height. The height of the building. Move now 300 feet west of the building. Move 300 feet out and away from the building. What is below you?

PAUSE

#10.5 Another...below me...oh man!...I feel that there's a curve and there's a whole conglomerate. A slight curve or something..only maybe 50 or 20 degrees. But, I have the feeling that there's some sort of control booth or little structure that almost.. again, almost like a little air traffic control tower or something. ...that sits on the inside of that curve there.

#66 Looking back at the building from this perspective describe this end of the building.

#10.5 A line of a...my feeling is it's essentially white. Except for a..appeared to be right up and into the roof line...there appears to be at least one row of windows, ventilator areas. Something up there seems to go the full length of.....there's a square tunnel feeling when looking back up this thing..what I think is up it anyway.

PAUSE

I got the feeling...uh...OK. I got the feeling of ...something is not square...if there is a portal in the end of that building, the bottom of the legs of the four door wider than the top of the legs..... of the portal. I have the feeling of more like hanger doors than the other doors that we've had here. I feel like massive doors moving apart rather than going up or down. And those doors....my feeling is that those doors are augmented below them with another set of gates or doors that would be inside this canal, or whatever it is...I seem to see them in there too, which would allow them to service locks, and..uh... but those are interesting. I got a different movement with those. The movement I got with those is that they turned inward instead of simply pulling apart, like the upward doors. It's almost like a dutch door set up.

~~SECRET~~

~~SECRET~~

#66 OK. Fine

PAUSE

#10.5 That's all I'm getting

#66 Alright. Fine. I want you to move now back around

#10.5 I'm getting tired.

#66 Alright. Fine.

#10.5 What do you want?

#66 I have one more question I'd like to ask you.
Move back on top of the building where you were
already. Back on top of the west end looking down
over the airfield.

Alright. Tell me when you can see clearly what's
down below. Tell me when you have a clear impression
where you are at

#10.5 (mumbling)

#66 Alright. Now perceiving yourself to be at the target
I want you to close your eyes at the target so that
you see nothing. As I talk to you your eyes are closed
at the target and you see nothing at all. When you
open your eyes again it will be January 1st, 1980.

+66 #66 Open your eyes now. Tell me what you see.

PAUSE

#10.5the first feeling I had was that water and I had
a feeling of a round cylindrical snout which is
coming out of the building beneath me. And it was
coming out.....

#66 OK.

#10.5 That's the first. What else?

PAUSE

#66 Do you have anything you would like to add?

~~SECRET~~

~~SECRET~~

- #10.5 I'm working on it.....yeah.....oh yeah. Looking around. Not knowing what to look at, it's hard to tell whether anything is different.
- #66 I have no further questions.
- #10.5 Well, I can't see. I can't discern ...uh... anything that's going to be hurdle. That's the only thing that I got.....that's the only thing that I got. I didn't get any new feeling of configuration or any new ...or any structural change... or ...or anything like that. That's the only thing I can say. Event for 1 January is the submarine exits.
- #66 You're pretty tired...you'd like to work on this later. I would like you now to move your arms, stretch.
- #10.5 I'm moving ..all at once.
- #66 When you're ready, let's sit up and draw.
- #10.5 Felt like I had a body cramp.
- #66 Would you like to take a little break before you draw.....look around a little bit.
- #10.5 No. That's OK.
- #66 Do you have to go to the bathroom, or anything?
- #10.5 NO. Let me go next door.
- PAUSE
- #66 We're now recording again after we've taken a break.
- #10.5 Where do I begin?
- #66 Your first perception I believe was outside the east end of the building. I am interested in the connecting thing between the two buildings and the activity going on there.

~~SECRET~~

~~SECRET~~

#10.5 OK.

PAUSE

#10.5 I had the feeling the small building on the right had a slightly peaked roof. OK.

This thing like.....open ground but it was actually elevated off the ground a little ways and then it was more just a screen. On the face of this building there were either one or two very large, you know, rather large, they're not large compared to other things we've seen but they're large compared to the proportions of the building. That's the only thing that I have to go by. OK. There's either one or two.....and I will draw the second one in dotted line. Large door.

Now here, now here on this sketch, notice how I've lifted it up off this dotted line which is actually what would be the ground line, right. Now, and under there, under that, it's hard to draw. I'll draw an interior view of this thing. It will be better.

#66 Draw me a sign that says large building and an arrow and small building and an arrow.

#10.5 Yeah. Large building to west, with peaks, OK, tunnel, open space, tunnel or screen.

#66 What makes you use the word screen?

#10.5 Well, because the dam thing was of no struc....when I got into it it was of no structural consequence. You follow what I mean. In other words it wasn't big massive steel girders or something that did anything, it was something that was just sus...to me it appeared it was just built over the top of this thing. Like a covered walkway in a hospital to keep the patients dry. That type of a..of a feeling is what I had. You know. When you go from building to building, covered over so you don't get...like an awing almost. Screen, I mean screen, not in a screen, not in a screen like in a window screen. I mean a screen like in a visual screen. You see, I'm using it in that term.

¹⁴
~~SECRET~~

~~SECRET~~

#10.5 Open space beneath two feet.....OK...and my height on this thing is plus, minus, 20 feet plus or minus. That's what I....not plus or minus. Twenty feet plus or minus, that's the way to do that. OK. Now here, I had the feeling on the left to that, just shyon the big building to the left that there was...that there was some sort of a stair out the outside of the building, which I'm doing here with this squiggly line; and I don't know where it went. I didn't go up it.

Now you have to remember your perspective on this thing. This looks like it protrudes out of the building, it doesn't, it goes up the side of the building, from the distance into the foreground, OK.

#66 Now, if I remember, I want to explain why my perception of this, I'm not saying your perception as you are viewing this is incorrect, but I'm saying my perception of this is you were inside your passage-way when you perceived this.

#10.5 Right. I perceive it to be outside on the other side of the screen. In other words, if I was, if I was there I really couldn't see it. But I could see it because I was there the way I was there.

#66 Alright. So it is definitely on the outside of the building and not on the inside of the building.

#10.5 I'm pretty sure of that, yes.

#66 But, normally as it were you can't see through this passageway.

#10.5 Normally, you can't, no.

#10.5 There, that shows it more in perspective like that. OK. It's a stairway like a fire escape.

#66 OK.

#10.5 OK. Now I had the feeling that I was on flat, solid ground out here and I might even have been on hard top. Black top or something, OK.

~~SECRET~~

~~SECRET~~

#66 OK. Then I asked you to move inside this passageway.

#10.5 Yes. OK. Give you a better sketch there, that should go.....let me draw you a quick aerial, OK. That will be sketch 2.

Make straight lines.....

.....you mean you had me here, the X which will be 3, and you had me there, this thing was taller and significantly wider than the other building, OK.

This I didn't see, so that's misleading. So I'll just draw a dotted line there.

Here would be the staircase, OK. Stairs or fire escape, OK. Come 2 we'll go inside then. Uh.. I only had the feeling of a single set of tracks, rails of some kind and I wanted to try to make them into railroad rails, right, but...with ties and all that...but I didn't and I'm not going to say they're that kind of rail. But they're a metal rail of some significant weight, OK. Ability... alright, nowand had the definite feeling that this thing stood up on posts, off of the ground, OK. Like this OK. Now this is on 3.

And they just continued on...now I had the feeling, is that sheet metal or wood. If I had the choice, I would say wood, more wood in this construction. It sits up on these posts, as a matter of fact, now that I think about it, I'll just throw this post in there. It was as though I was standing right up here on sketch one. I was standing real close to it and I said, "I wonder if I can look in under this thing?" I got down on my,,,bent over like this and I could see all the way through. I could see the rails here, I could see under the other side, I could see out on.....

Like towards the water in the dock that's...up there, you know. You know, I had the feeling that light showed in under it. OK.

#66 Now, then I asked you to move to the little building. So I am interested in seeing the sketch of where the tracks end in the little building and the very interesting object that you perceived that moves along these tracks.

~~SECRET~~

~~SECRET~~

#10.5 Alright. First I'll do in 4. I'll do in 4 to be what....uh..I saw track wise, again, if I can do it. OK. OK. This is the interior of the building. Depth of it may be off because I've got to get ...I've got to have enough room to work with my sketch. But, I felt that the track went into the building and then forked like almost with switching ...like it was heavy equipment, but it wasn't heavy railroad equipment. But that it was equipment so that a number of stations could inter-connect with the main track that moved to the other building.

So I had this feeling of...uh...uh...track, along here, OK, and then track moving over to here, and track moving over to here, like this, on the floor of this thing. Almost like a miniature railroad yard type set up, OK. I had the feeling there may be three or four spurs, I'll call them spurs, three or four spurs coming off this track.

#66 And this is inside the little building.

#10.5 Yes. Now, whether they come off the track or whether they come off themselves, I don't know. I can't..... I have the idea but I don't have the details. You see what I mean. In and amongst these places are like work and manufacturing positions and assembling positions that are serviced by these rails.

#66 In this drawing on page 4 here, how about drawing me an arrow that shows two large buildings where this track goes out of the building.

#10.5 OK. It would be.....OK. Large building is behind this as we look at it. Direction of movement is also of this other (mumbling). OK. On 5 I'll give you.....

#66 Five, a picture of the thing that moves.

#10.5 Yes. This thing is about like..a..I have a pretty good feeling about the width of these tracks. They're sub-normal size. They're about half-gauge, or whatever you want to call it. You know, something you'd expectlike a mine...like the size you would find in a mine. You know how it's a sub-size railroad track for the mining cars. That's what I'm talking about, that size of track. Call it 2 feet. OK. Now what did I see?

~~SECRET~~

~~SECRET~~

#10,5 I'm going to try to give you the perspective that also gives you the equipment.

PAUSE

#10.5 OK. It's odds-rails, right. Alright. Now this sucker...this was the general configuration of the thing. OK. Now I had the feeling that...I'll write what the dimensions are...ok...later...uh... It's really much bigger than this. This dam thing sits up.....

#66 OK. It's time for me to change the tape so while you're drawing that I'll go ahead and put a different tape on here.

PAUSE

#66 OK. We're back now with a new tape and we're recording again.

#10.5 This is generally the shape of it here with a perspective view, ok. And, this is it in perspective on the wagon or the thing, the cart, and a man standing here. OK. It's this high. I'm drawing it up here in the upper right hand corner.

#66 To kind of give us an idea of the perspective.....

#10.5 To kind of give us an idea of the perspective of this thing. Yes.

#66 Can you tell me some more about this object? Can you tell me about the colors of it and tell me about the different pieces?

#10.5 Well, I had the feeling...first of all, I can... let me just give you a couple things here. I am... I have not a good feeling about the back end of this thing, here. My sketch, because I can't draw what it is, my sketch shows generally that the small long end of this thing is a...also a cowl of some kind. It's not. It's raw...I had the feeling that it was raw machinery sticking out but that the other two sections of it were covered with cowl. Like this thing was put into something and it was protected somewhere else. You see what I mean. This is like raw machinery as though, dried shaft...

#66 As though this fit into something.....

~~SECRET~~

~~SECRET~~

- 10.5 Yes. Like a dried shaft. You know how a dried shaft has got all knobs and bumps and stuff... you can tell it's not a cover, you can tell it's the actual thing, instead of being covered.
- #66 Alright.
- #10.5 But these things are cowlings of some kind. They're made out of...they're sheet metal. They're light and they're silver gray sheet metal.
- #66 You're telling me it's an outside surface.
- #10.5 ...for the rest of the machinery that's inside.
- #66 OK. But the long tube thing sticking out the is not an end product thing. It's like...it still fits into something else.
- #10.5 Well, it's the end product of the element.
- #66 Alright.
- #10.5 But, it interconnected with something else. You're right. Supposedly, that other thing whatever that is would then give it the necessary protection from the elements, or from the air or from damage because it's going to be hidden inside something.
- #66 Now, on this cart draw me an arrow...the way this thing goes to the building...the main building, the big building.
- #10.5 OK. And this is.....
- #66 Do you get any other feelings about this thing? Is it mechanical, electrical? Is it...any other feelings. Just kind of draw impressions.....
- #10.5 I'm going to give you that... electrical coils, copper coil...a...looking under...you can see copper coils when you look...I'll draw the arrow in under that cowling, ok. You can see it. If

~~SECRET~~

~~SECRET~~

you took a front view of it you can see a pretty good size dome. But, then around it...the bigger dome.. shield, you can look in under the front edge of that shield and see all this mish-mash of copper coils and copper wrapping and everything like that around it. As though the thing was a generator, or something like that. You can look in...under the second, in under that second shield, like a little air space, like a little cooling air space.

#66 Can you draw me a picture of that? This would be in the upper left hand corner of 5, here.

PAUSE

#10.5 OK. Arrow. This is the forward...I'll call it forward. This is the forward cowl and then this is the middle cowl and in here...what did I do. OK this is the back end of it. See all these squiggly lines around it. OK. Well the same thing is like repeated in here.

#66 And, what do you feel those squiggly lines are?

#10.5 That's the copper wiring and coils and everything. I'll draw.....inside the middle cowl. OK. It's continuous all the way around it. So. That's that.

Cowlings are sheets of metal, thin metal sheeting, steel gray. I'll put a question mark. I didn't really catch...thinking back I seem to think that it was just very bland, very bland steel colored gray colored metal, you know.

#66 OK. Now, how about a picture of the....as the tracks went into the new building and they went up to the pit?

#10.5 OK....6...6. I'm going to number 6 likewise. Need a little more depth here.

PAUSE

#10.5 OK. I had the feeling on the left that there were in the foreground...ok...some more of these objects on the left side. Like they'd been taken off and parked in there.

#66 About how many of them are there?

~~SECRET~~

~~SECRET~~

#10.5 About two or three, that's all.

PAUSE

#10.5 Again I see those same objects. Alright, I wrote two or three of objects in number 5. Over here on pallats was more heavy equipment. You know, bigger stuff. Uh...what would I say...gaskets, valves, pipes, hoses, ok. I didn't see...I didn't recognize ...I didn't identify any other massive elements, mostly pieces. Stuff that's desk size, table size, instead of stuff that is truck size. You know what I mean? And then over...far over in the back, if you recall I had my...I said I think I see things over there, ok. On the left side here I have a feeling there was a wall there. But the built-in front of this wall, or in this niche, in this corner here, was a box, ok. I'm just going to call it a monitor, supervisor box, and there was something sitting down here.

#66 OK. Now, when I asked you to move up into the box yourself and look down at the pit, draw me...what that looks like.

#10.5 It was...7. I'll try to do this thing with a reasonable amount of finesse here. Now. This thing was ribbed...let me draw...let me start with one and see if I can draw the second...was ribbed and...there. That's the feeling I want to give. Inside the pit itself, looking down, ok, I've drawn the edge of this thing black so it will stick out. Let me see if I can draw another one. They were about...I had the feeling they were about 30 feet apart, maybe 20...more like 30 feet apart. I'll draw the other one on the other perspective because it's opposite my viewpoint...down to there...and like that...and down...and up. There's one peculiar thing wrong with this, now that I think about this. I've got them too skinny at the bottom. They stood above...you're talking about b-i-g old equipment. There, that's better. That's what the problem is.

#66 Now in your picture in number 7, here, I see the end of the pit to the right here in your drawing.

#10.5 Right.

~~SECRET~~

~~SECRET~~

#66 Earlier you said there was a rail around this so the people didn't fall into it or something. Now in your drawing you haven't drawn the left side of the pit.

#10.5 No. Just because I started the picture that way. I was thinking when I started that I would have to tape two of them together.

#66 My question is, "Could you see the left end of the pit?" We didn't explore...

#10.5 I had a feeling there was a set of gates. I had the feeling there was a set of gates down there. That's what my feeling was. It was just a blank wall, in essence. A set of gates of some kind.

The thing that I want to get across here in this one, I'm looking down. I'm actually looking down. I'm a little bit back in the control box from this view. The box goes right up to the edge. Actually, the box is standing right here and you can look right down in the thing, but I just can't draw it. So I'm giving you sort of an off-view. Just from the simple mechanics of it. But the inside of this thing, the inside lip of the pit that you can't see is just a mirror image of the opposite side. These things just go down, they curve around, they come up the other side.

A man's size is...he was in there. What I had going on in this activity was that the pit was empty and that there were some people in there running around amongst these things, these supports or these cradles, sweeping up, cleaning up dirt, everything...uh...general maintenance type activity.

OK. I'll go to 7-A and I'll do it this way.

#66 It appears then that the track thing and the booth thing that you saw appeared to be more at one end of this pit than in the center of this pit.

#10.5 Yes. I didn't get the feeling that there was duplication on the other side, but it seemed like it was. I can't really say. Maybe that's off. Maybe I'm screwed up. It might service the middle but it might service the right half. It might be centrally located but it might be the right half. I really don't know.

~~SECRET~~

~~SECRET~~

#66 OK. We know you could have winked in here quite a bit. The question is...I'm noticing your drawings which are...drawings you know are sometimes very interestingly accurate.

PAUSE

#10.5 ...gates or doors at the other end. Like that.

PAUSE

#10.5 ...and these things are repeated down the length of it.

#66 OK. Why don't you just write in there...more ribs or whatever. Or you can draw them.

#10.5 I'll just draw them. ...more cradle ribs, number unknown.

#66 ...anything else you (mumbling) about the ...

#10.5 I just want to say it was dry. I went through and I figured out...you asked me what they did...you know...go ahead and figure out what they do here. So I did things. But then when you got me back up in the control tower one more time and you said OK what's going on here now, I ended up with the same picture again.

#66 Alright. You perceive it to be dry now but that there is some sort of vessel construction in there that's the activity concept of the thing.

#10.5 Yes. I'll go ahead and draw you the thing. I'll go ahead and draw you that which is an interesting. That might give you some size conception as well

#66 OK. Activity concept then.

#10.5 Right.

PAUSE

#10.5 OK. Now here are these things....we end up with a dry well. The ultimate thing that I wanted to get across is that in perspective...I'm trying to get a

~~SECRET~~

~~SECRET~~

size determined here for you, whatever. What are we going to call this...this is going to be 8.

#66 OK.

#10.5 Is...that...the big part stuck up above the edge at about ...a little bit above. So that's what I'm trying to say...that's what I'm trying to figure out...let me just draw you a simple cross-section. Simple cross-section is that the lip of this... that's too high...that the lip of this bay came in like this. On the submarine (mumbling) referred to is the con...sticking above the lip...if you stood on...stood at the base of the con on top of the submarine the lip might be three or four feet above you over here. So then you have the con go on up straight, passed you. Stick up above...protrude above the lip. And...it sits in there like that.

#66 What was the status of the submarine that you saw in there when I asked you to think about what the work concept was or what goes on in there, what was the status?

#10.5 No. I didn't get anything. That's all I got...was this...like...what is the progression of events. Not what is actually done. I didn't pick up on any work or anything like that.

#66 OK. And what did you see?

#10.5 Just that. Just this cross-section. Just as though I was standing at the...on sketch 7...if I was standing at the right end of the bay, about half-way down it looking at the ass-end of the submarine, I saw this silhouette. And then the bay was sitting like that, you know. Just the sketch I have right there.

#66 OK. You didn't see what work was being done, or anything, just this submarine.

#10.5 No.. Now the progression of general activity, what I think I picked up was the series of dry bay, open gates, flood, move vessel in, close gates, pump bay dry, vessel sits in dry-dock.

~~SECRET~~

~~SECRET~~

#10.5 To get the thing out of that is just the reverse of it. Vessels water tight, you open the gates, you flood the bay, you float the vessel out, you close the gates, you pump it dry, and you maintenance...you know...you perform your maintenance on the bay, not on the vessel. The vessel's already done.

PAUSE

#10.5 I would like to say one thing. That...that... building is a hell of a lot bigger. I definitely got that feeling this time through...that...that this was just...a...one side of the building and that outside those gates was a water course. Inside the building but outside those gates was like the main water course that they did they're flooding and they're...everything...with...you know...They're main thing came...was out...There was water out there inside the building but that there was water out there and that this particular case the water was being locked out so that they could screw around in this dry bay.

#66 OK. Now, you before...in...during this session had this kind of feeling about more pits or... Can you kind of give me a sketch of an overview of what your impressions were there.

#10.5 Yes. Certainly. I had two different feelings and that's why it was confusing about me...or confusing to me. On...9...I had this impression, I had two impressions and I'll do them on 9. One was that at least two bays were side-by-side. It was like an island between them. I had this feeling. My bay where I was starting...what I perceived to be the east end of that building was closed. That was perception. But the bay next to it I had the feeling that there was something in it.

#66 OK. If you can call this a room area, was this in the same room area. In other words, if you were to stand...could you see both submarines from the tower? Or was it another room type concept?

~~SECRET~~²⁵

~~SECRET~~

#10.5 I don't think you could see the other...you... you couldn't see the other submarine from that same tower. I have the feeling that there was redundancy of pattern there. That the control tower is a thing geared to that bay, and that the next bay over has one just like it. There's assorted piles and jumbles of stuff and equipment on this middle island here. See it here, in between. That sort of blocked your view.

When I was at the first one, I could look down in the mine but I had...into my pit...but I had the feeling that I couldn't look over into the other pit because there's something in the way. I didn't know at the time what that was. I just forgot about it. Just literally forgot about it. Then, I came up with this concept that there are series of bays serviced by a central core.

#66 OK. This is more of a feeling of the concept as opposed to you actually saw a nice plans....

#10.5 No. I saw these two. Remember, I made a comment on the tape. I'm over across the room trying to look back where I was. That's...this is what I saw. I saw mine closed and dry and I saw another one next to it, maybe 150-200 feet away that had something in it. Whereas, mine was empty.

#66 OK. Well, can you draw me kind of a water level concept there so that we can see the situation here?

#10.5 I don't see what you mean...water level.

#66 Well, you've got them kind of raised...you have these one bay doors closed and then you have this other submarine thing and they're kind of raised up....

#10.5 Oh, yes. But still water level is...ok. Is that what you mean?

#66 OK. If a...where the bay doors open on...for this other submarine or closed or...

#10.5 I could see the submarine. I had the feeling that it was open. But that's ...you know...what validity that has...I don't know. I just look through them. For all I know...just ignore them and see if there was something in the next bay.

~~SECRET~~

~~SECRET~~

- #66 But you're saying then that they could float out of these individual bays. Or you said there is some central core thing. Can you give me an overview of that or.....
- #10.5 Yes. I'm just giving you my two feelings. This was a feeling. The other feeling which will be on the right hand side of the paper, I'll call it 9A here, was that the...that it was like...if you serviced the area using the palm of your hand that your splayed fingers being the pits. The other idea...I did not see this...this was just a thought that occurred to me more than having...than actually seeing it...was more one of taking this linear concept and making it semi-circular, is basically what it is.

PAUSE

- #10.5 They're irregular, but you get the idea.
- #66 But, you didn't actually see this.
- #10.5 I didn't actually see this, no.
- #66 OK. I understand.
- #10.5 Sort of...sort of...like an enclosed lake. Float these things in it and you turn them around. Remember, I used the term turntable, railroad turntable on the tape during this session. You take the train, you put it on this platform, you turn it around, you head it toward the right track and you drive it off. Same, same here. The idea was that you get the thing floated in, you can't make a ninety degree angle with it. Of course, they don't make a ninety degree angle with it. They just float the sucker around and they steer it in the right direction. Now whether this thing is a total circle or if it's just a semi-circular pattern...it's hard...you know, I don't know. But it might be that in order to lessen ..lessen the problem of angle to dangle on this thing they may have some central area where they can adjust the boat and then move it in. Anyway it was just like splayed hands. Splayed fingers. I'll darken it up a little bit.

²⁷
~~SECRET~~

~~SECRET~~

#10.5 I'll write this concept, thought, and this is imagery.

PAUSE

#10.5 Submarines slash boat pits in circular or semi-circular pattern, OK. That was more the concept or thought. This is what was...you see as I was coming back I had across...you see I had been over here and I was trying to back over here to look at it.

#66 I'd like to move now over to the west end of the building.

#10.5 OK.

#66 You started out by standing on the roof of the building and looking down.

#10.5 I'll label this...looking down.

I can make this thing smaller, because we're dealing with a massive thing. Let me do the same thing but do it lengthwise, ok.

#66 OK. I'm concerned...

#10.5 I can get it all together here.

#66 OK. Remember now just as a concept when you look down over the edge of the building and you're right there on the edge you may not see the entire length of the building underneath you. You may only perceive only a very narrow focus right underneath you.

#10.5 OK. I dig what you are saying to me. Without any building lines to draw the perspective I'll just draw you an aerial. Catwalk, or something protruding. Again, I had the feeling it was like metal scaffolding. Catwalk, question mark. Now I had the feeling that there was a very solidly, defined water course that proceeded out of the building here. I had the feeling that the dam thing was like a runway off the Hoover Dam. That type of construction, sharp white angular poured concrete, and it wasn't a dug canal, I didn't think. I had the impression it was more a poured concourse.

~~SECRET~~

~~SECRET~~

- #66 There was some deliberateness in making this a ...a piece of water here, or what.
- #10.5 Yes. Right. Now it looked like a long swimming pool. You know, swimming pool. Sides to it and everything else. Add the sides to it. It's like a concrete apron that surrounds it. Fence on both sides...some distance back from...you know...from the water course, or whatever. Now, I had the feeling, here in the foreground I have metal scaffolding or screening, catwalk, question mark...that I feel is attached to the building wall. Like a couple stories down, maybe, so that it overlooks the big entrance gate to this thing. But I had the feeling of something...of other things that were out that straddled this concrete water course at intervals.
- I'll label this...concrete water course.
- #66 Then I moved you out away from the building and asked you to look back at the building.
- #10.5 OK. Now let me draw you one of these things on here, real quick.
- #66 These are the things you saw when you looked down?
- #10.5 Right.
- #66 Oh. You're saying this is something that goes over the top of this.
- #10.5 Right.
- #66 OK. This is now outside of the building, there's something over the top of the water that leads into the building.
- #10.5 Right.
- #66 It must be very large.
- #10.5 That type of a thing. Like more metal scaffolding done atyou know.

~~SECRET~~

~~SECRET~~

#66 How many are there?

#10.5 I don't know. I had the impression that these things just continued on out the water course. Like maybe every 75 feet. That type of thing. They're just free-standing metal structure.

PAUSE

#66 You're angry.

#10.5 (Laughter)..Ok. Now you want me to go back and look.

#66 OK. That's good. Out...away from the building looking back at the building.

#10.5 OK. I told you that I thought.....

#66 This will be number, what...ll.

#10.5 OK. There's the water course looking as it goes into the building. Now...like lock gates. Question mark. They open in...was my impression. Over top of them though, I had the feeling that this existed. A little bit of a storm shield for big doors or something. See, it does have some depth...a little bit of wing to it...you know... protruding out from the edge of the building. But these doors move that way and they were bloody huge. They were 45-50 feet tall, something like that. They were multiple story tall. And, that, up above this...or part of it possibly, catwalk was up there. Now the catwalk may be the top of that too. Because, I don't know the thing that was looking like a catwalk could be that very same thing.

(not audible)...some locked gate of some kind... a bolder gate...a locked gate that swing open like this. But then above it, it shielded by sliding hanger type doors that move out.

#66 What else?

#10.5 That was about it. Now here in the foreground would be one of these metal things, you see.

~~SECRET~~

~~SECRET~~

#10.5 One of those...like that.

PAUSE

#10.5 They open inward and this is the...very definitely man made, and man covered, poured. I have the feeling of poured concrete, you know, that this thing was made out of...and that this edge here,,, you know...like when you dig a ditch or you dig a canal you have a rounded edge and sort of crumbly and everything...weeds grow on it and it gets all mucky and soft...but it's sort of..softens out. This edge was 90 degrees sharp. I had a feeling of concrete, very stark, and it wasn't going to move. Wasn't going to wear out with age.

#66 OK. Now. Was there water there when you looked at it?

#10.5 I kept getting these dry images. I don't know. You notice, I've drawn...a...

#66 When I first asked you to look over the edge of the building you said you see water. OK. But then in your drawings here, you've drawn me things that are very crisp and clear without any water in them. So, now, I am asking you whether or not there was water there.

#10.5 Uh...I did not...I did not readily identify it with the water. It was not like I was standing on top of the lake or anything like that. The water wasn't there. But it may have been, because of what I was trying to do. I was trying to find out all about it so that I just ignored the water and got the true contours. But if I had to pick one or the other, I would say the bloody thing was dry. And the same thing goes...now...even though I drew, I put blue in there, even that...this concept here. You know, you asked me where the water line would be, but I did not feel water at that time...but that water was to be there, but it wasn't there at that time.

~~SECRET~~

~~SECRET~~

- #66 That's inside the building.
- #10.5 Inside the building in number 9...and in...even in the thoughts concept at 9A, I did not see this big pool of water. I saw more of the concrete structure that the water would ultimately or is occasionally ...already maybe...contained in when the time is right. But it's not there. I have the feeling it's not there now.
- #10.5 OK. And you asked me what I would see...the last thing you asked me what I would see is go back on the roof and see what was happening on 1 Jan 79, no 80, or whatever the date was.
- #66 Yes. 1 January 1980.
- #10.5 Yes. Well...uh...1 January 1980. The best thing I can do is give you a different picture to log... but...ok.
- #66 This will be number 12.
- #10.5 Right. Ok. I had this feeling, and I had a definite feeling of water.
- #66 Now you feel water. When I asked you to look at 1980, you're saying that was definitely water.
- #10.5 Right.
- #66 As to the proposed to the somewhat nebulous feeling you had.
- #10.5 Right.

PAUSE

- #66 Just put a number 12 on that page.
- #66 Is there anything you want to add? How do you feel about this imagery? How do you feel about what we did here?

~~SECRET~~

~~SECRET~~

#10.5 I feel...uh...I feel good about what I got, but, I think a couple of your questions threw me. I had the...I had to sort of drop back and regroup, and a couple of times during the thing I probably did not answer....where I'd been distracted by something going on upstairs. I just...you know...all of a sudden I found myself just..a...what in the hell is that going on, type of thing.

#66 You're interrupted by noise and stuff. OK.

#10.5 You know...it would take me about a minute or a minute and a half to two minutes to get back to what it was. Always going back to my last imagery to get it back firm.

I feel good. I feel reasonably good about it all, but it's the enormity of the dam target which was almost mind blowing. It's hard to maintain your perspective when you're dealing with something that's apparently as massive as this. If in your own human reality you've never been placed in something like it. The only thing I have going for me is having worked with aircraft...commercial aircraft before...you know. Dealing with these huge bodies that make you feel miniscule and huge and these huge aircraft hangers, and things like that. I do have that, at least to draw on, you know, as far as...uh...perspective. It's like dragging it up out of my past. But generally the imagery is about the same as before. Yes, about the...oh, wait a minute. I forgot to tell you...there's that control thing. Let me draw you a quick one here. Number 13. I'll just draw the edge of the building (mumbling). This is like the building, and this...

#66 When I asked you to go 300 feet out, or something.

#10.5 Yes. Right. I have the feeling there is a little curve...general curve starts in this thing to the right looking out from the building...and that there are these...these things are over it. They may have something to do with the towing and movement power. Another thing I asked...I sort of asked myself...is there anything located along the banks that these things would be tied up to...towed in...but I couldn't get anything out of it. But I did...

33
~~SECRET~~

~~SECRET~~

#10.5 ...this feeling of these overhanging things was rather strong. I had this feeling like...you know...hellas sketch of the overpass with all the concentric circles. When you had me out there looking back in the building it was almost like that. It was just like rectangle inside a rectangle all the way down to the edge of the building. It was that...it was very good feeling that there were those things there...and that they were in a regular pattern all the way along this thing. Anyway...in... that...right here sort of at the end of this curve is this little glass ...control booth...maybe a control booth, maybe something totally different, but I had the feeling like it was an observation post.

(mumbling) traffic. That was the feeling there. OK. That's about it.

~~SECRET~~

TAB

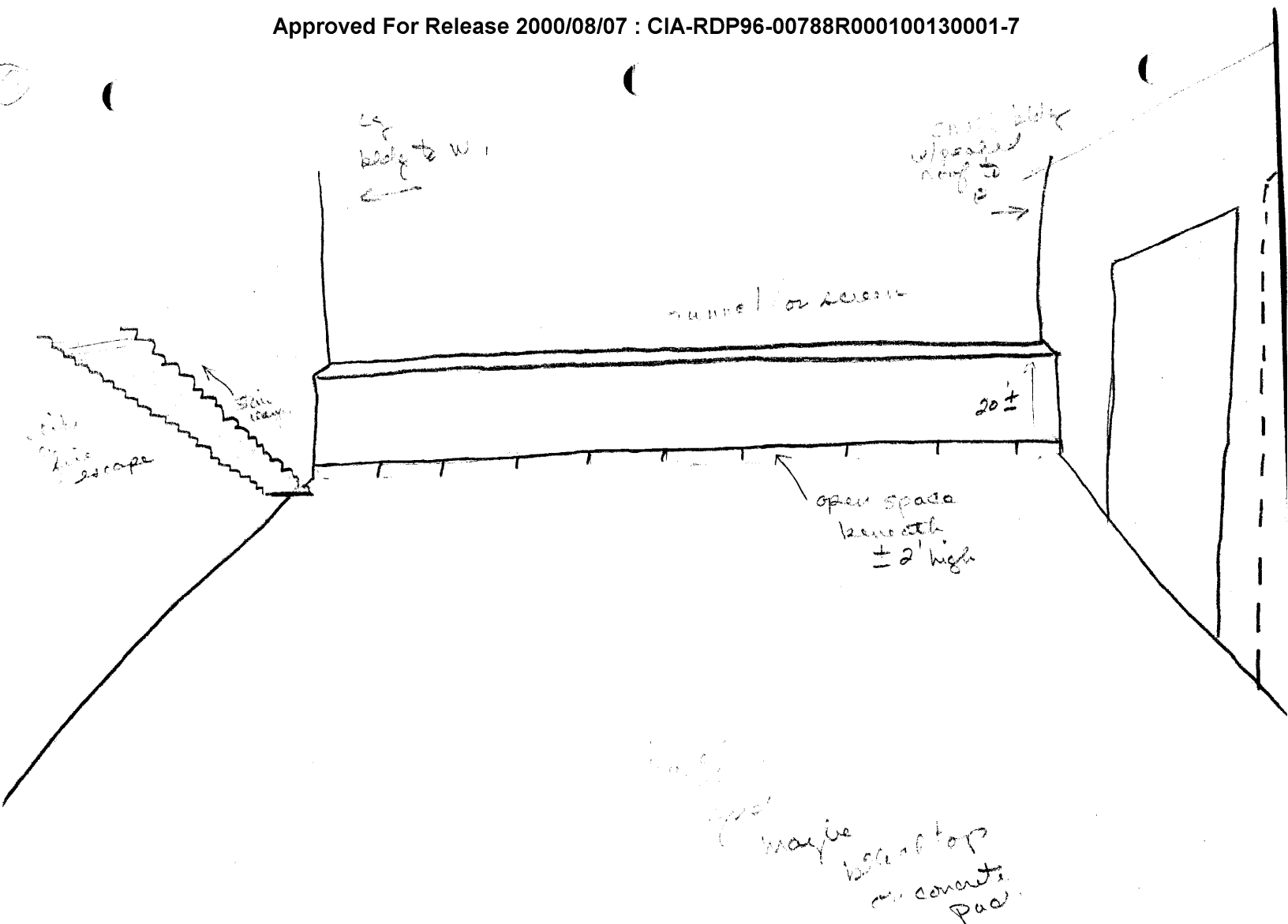

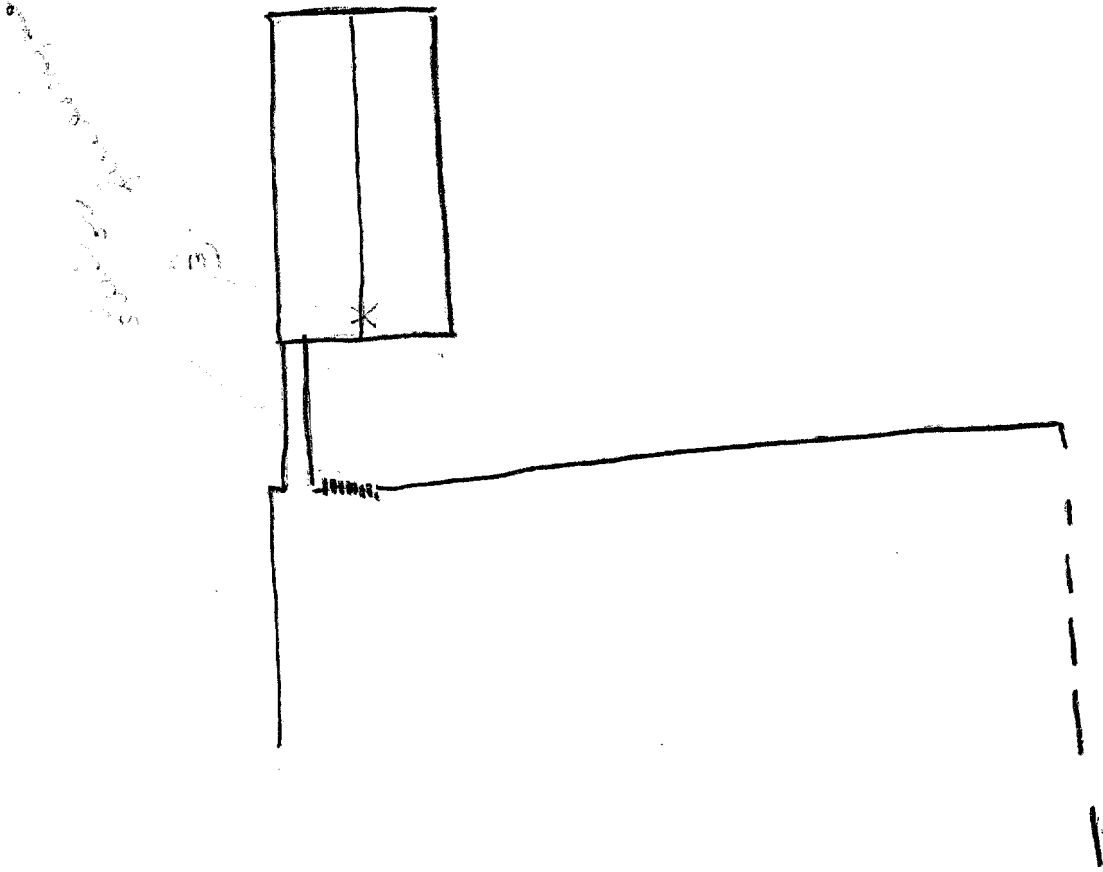

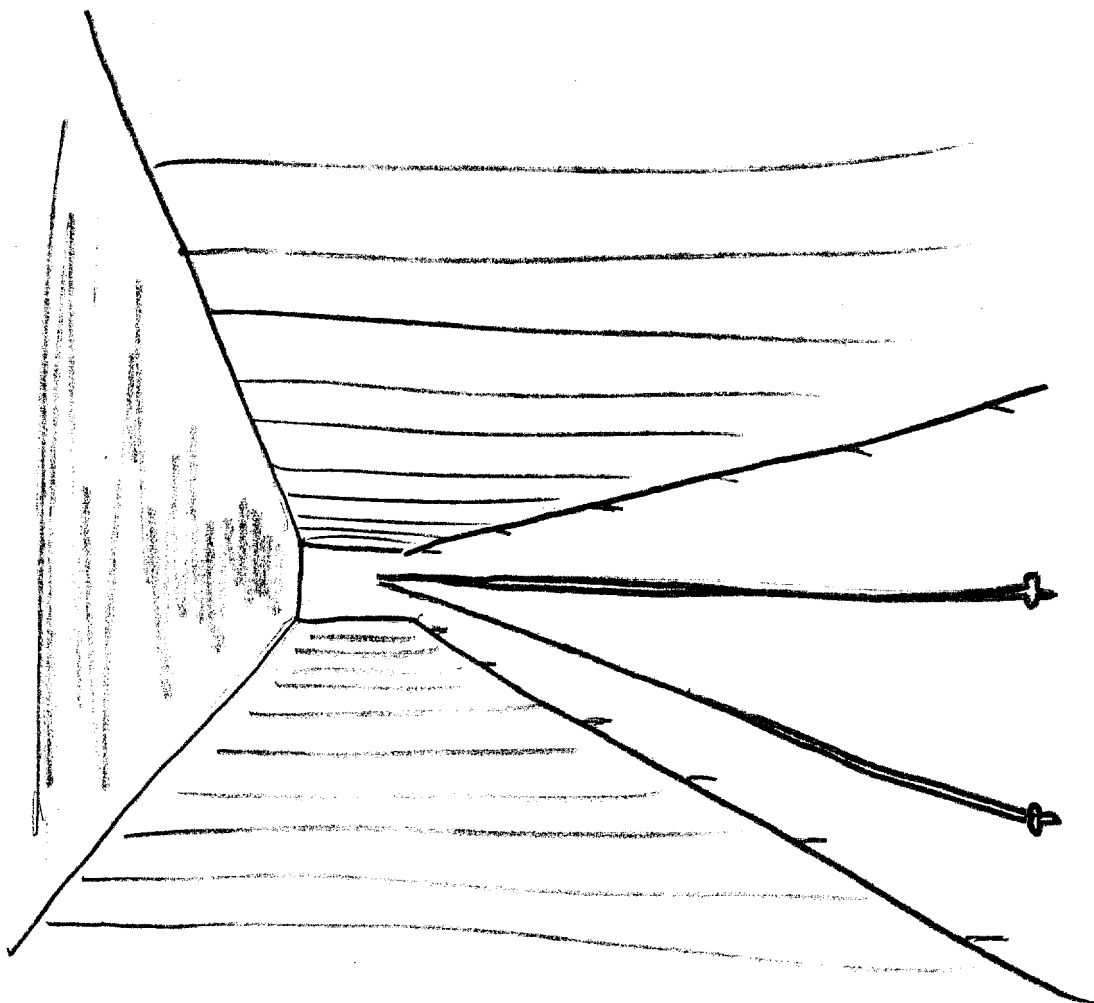

3 or 4 spare
copies of
book

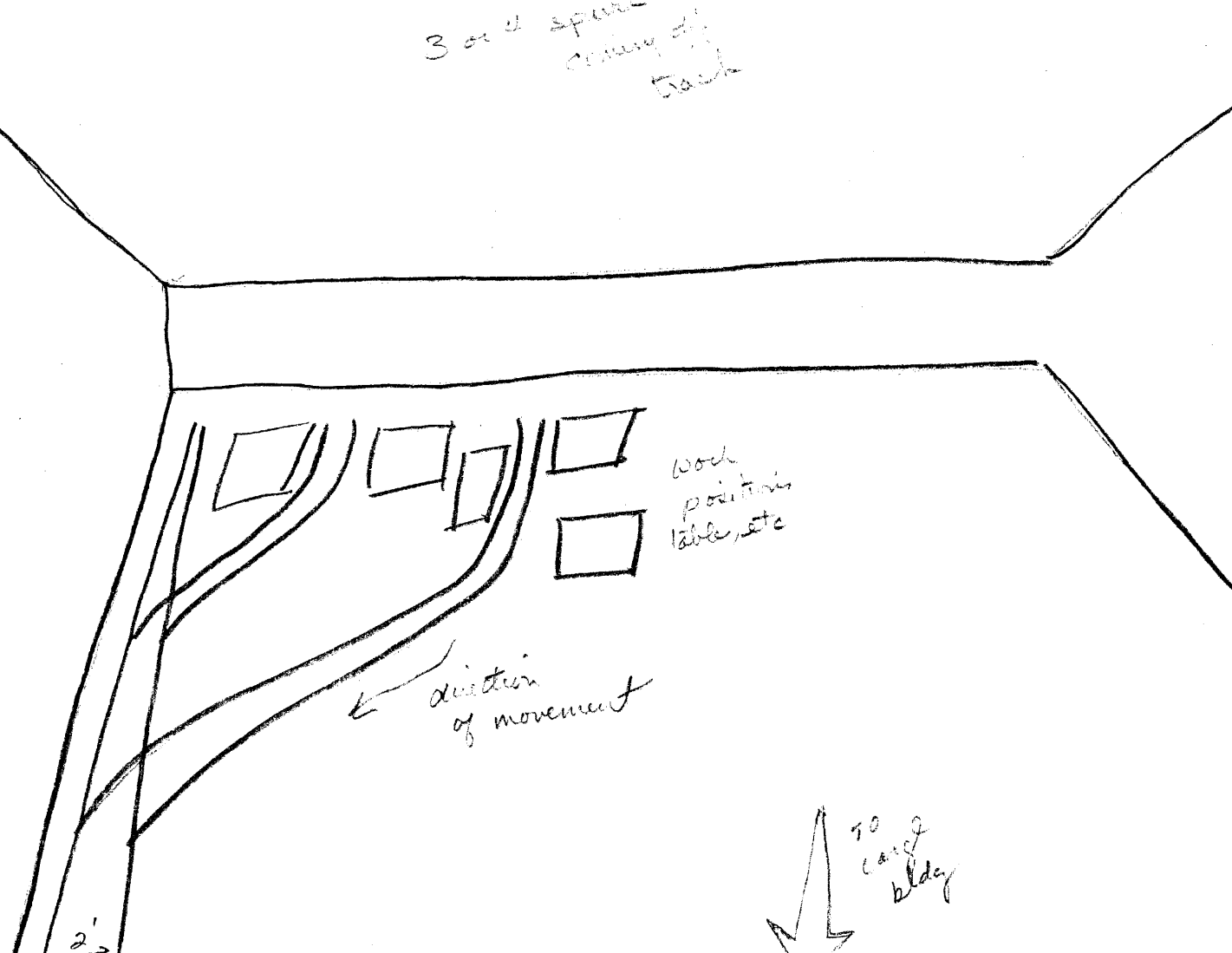

wood
position
table, etc

direction
of movement

to
camp
bldg

2-
← →

5

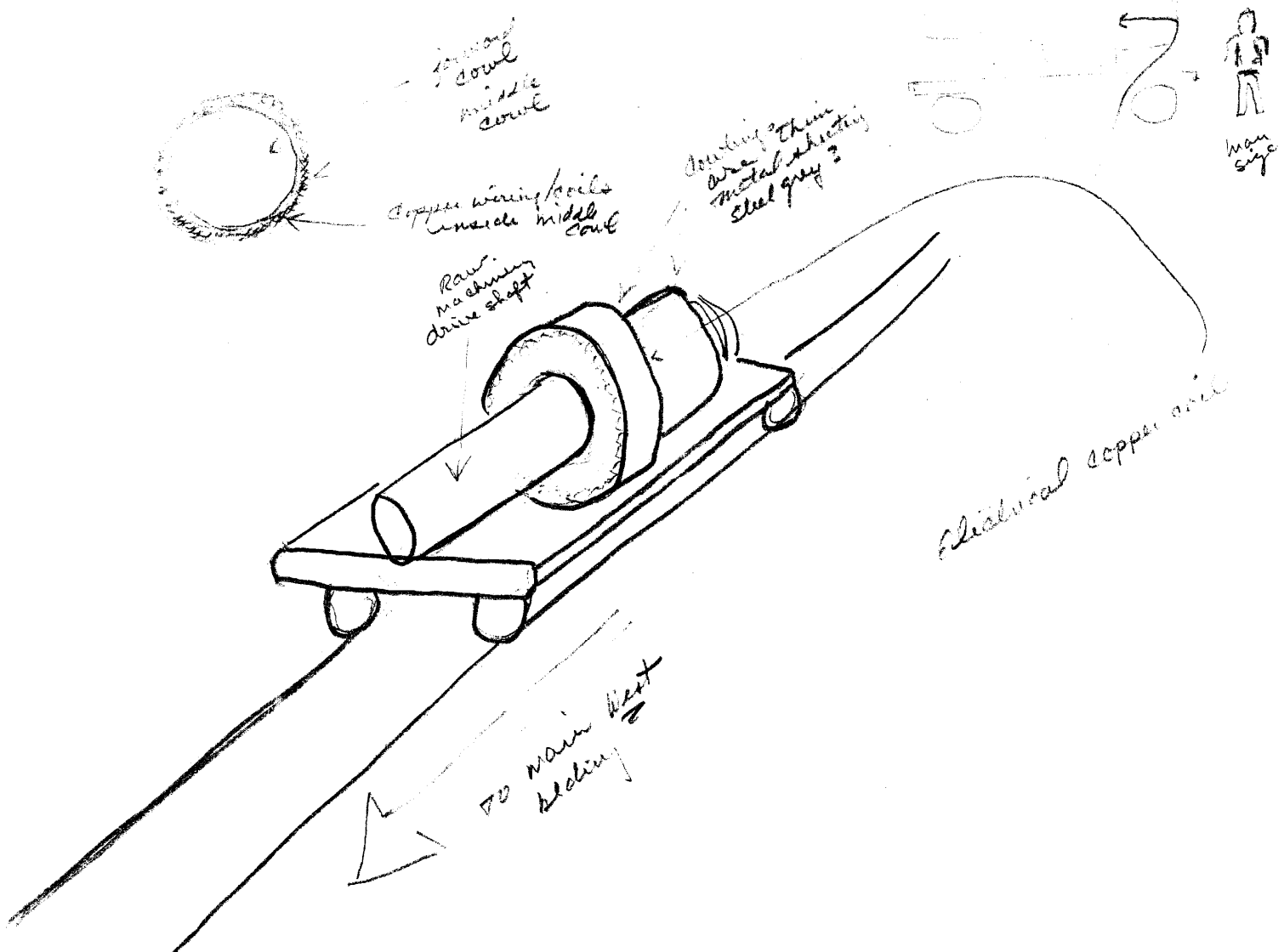

16

monitor or
supervisor
box

glass

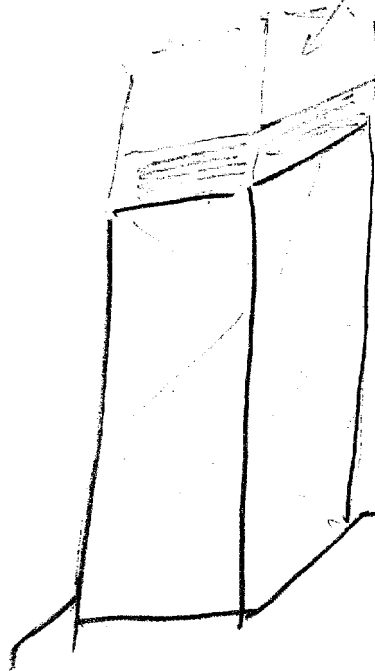

pit edge



closed
dark
shelter

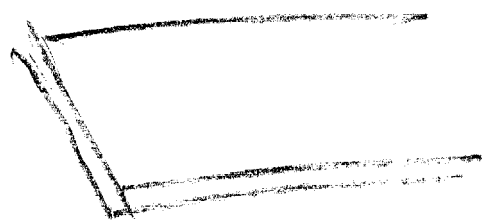
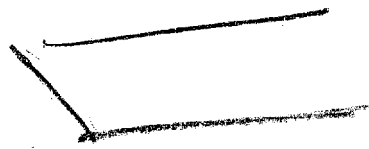

2 or 3
or objects from
#5

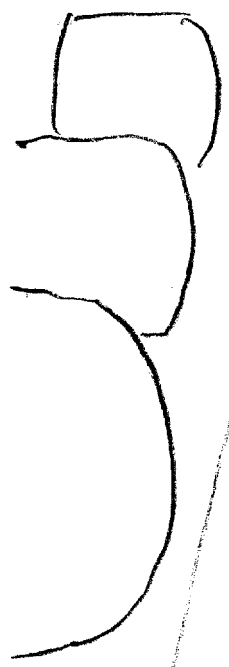

gaskets
valves
pipes
hoes

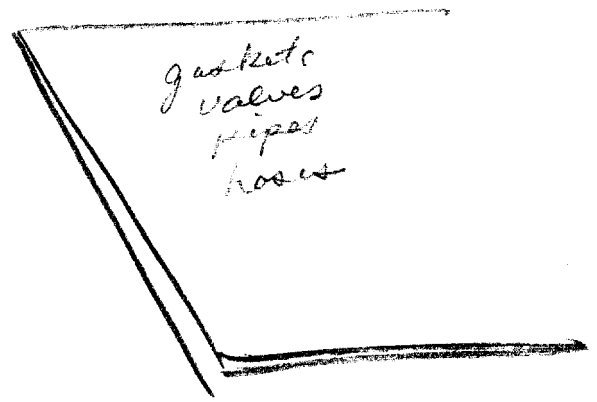

⑦

Approved For Release 2000/08/07 : CIA-RDP96-00788R000100130001-7

*it was
obj at
mission
time*

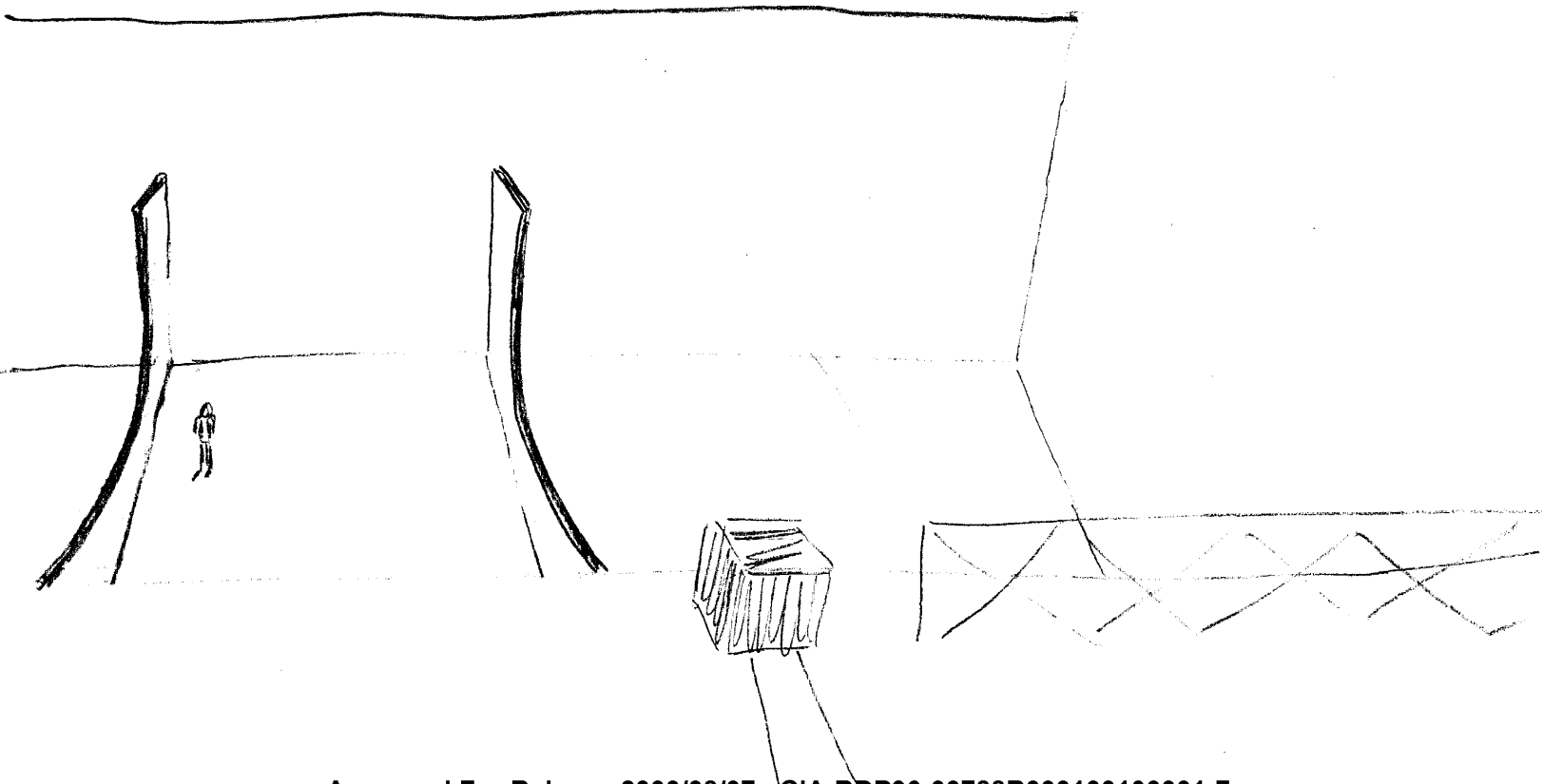

Approved For Release 2000/08/07 : CIA-RDP96-00788R000100130001-7

Approved For Release 2000/08/07 : CIA-RDP96-00788R000100130001-7

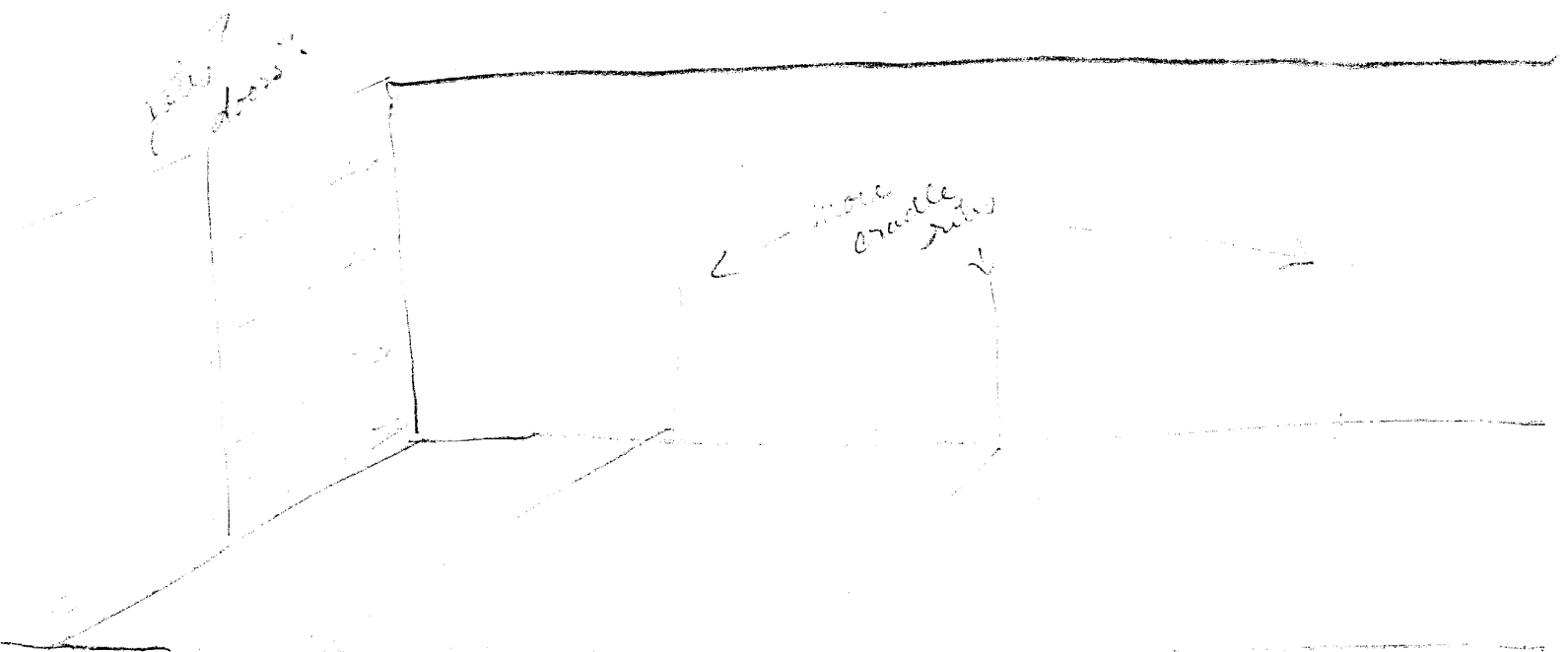

Approved For Release 2000/08/07 : CIA-RDP96-00788R000100130001-7

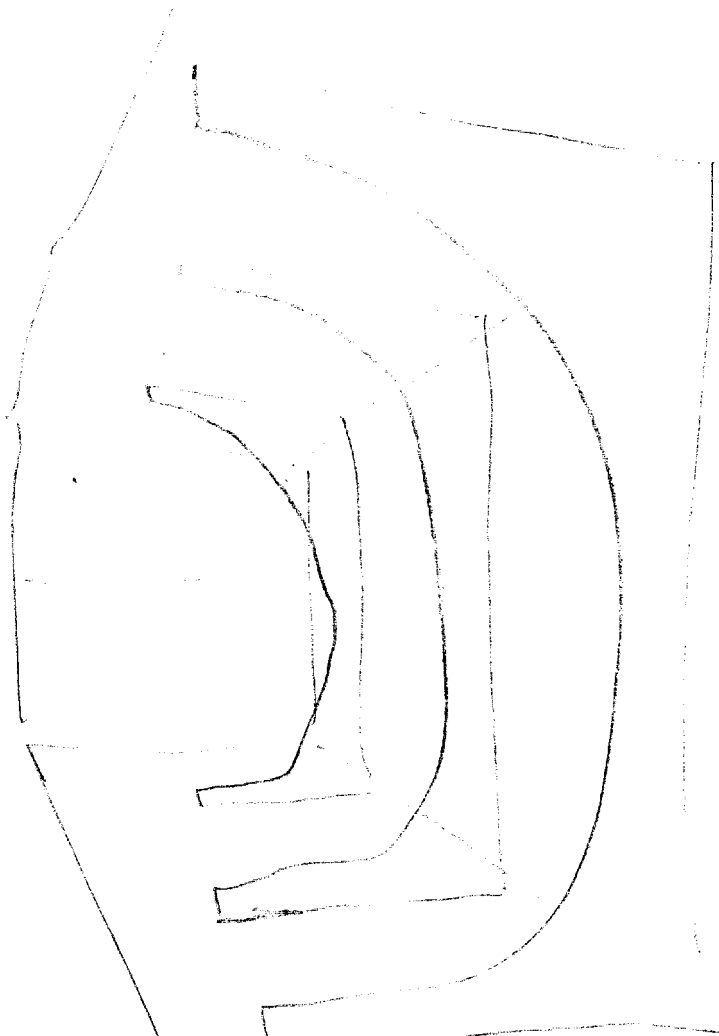
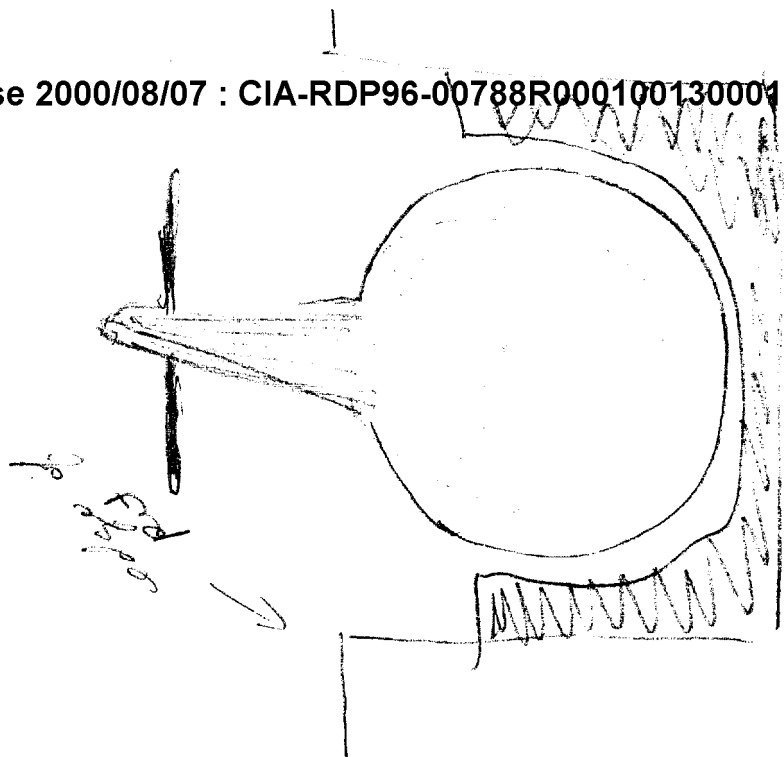

9

imagery

9a

Concept / thought

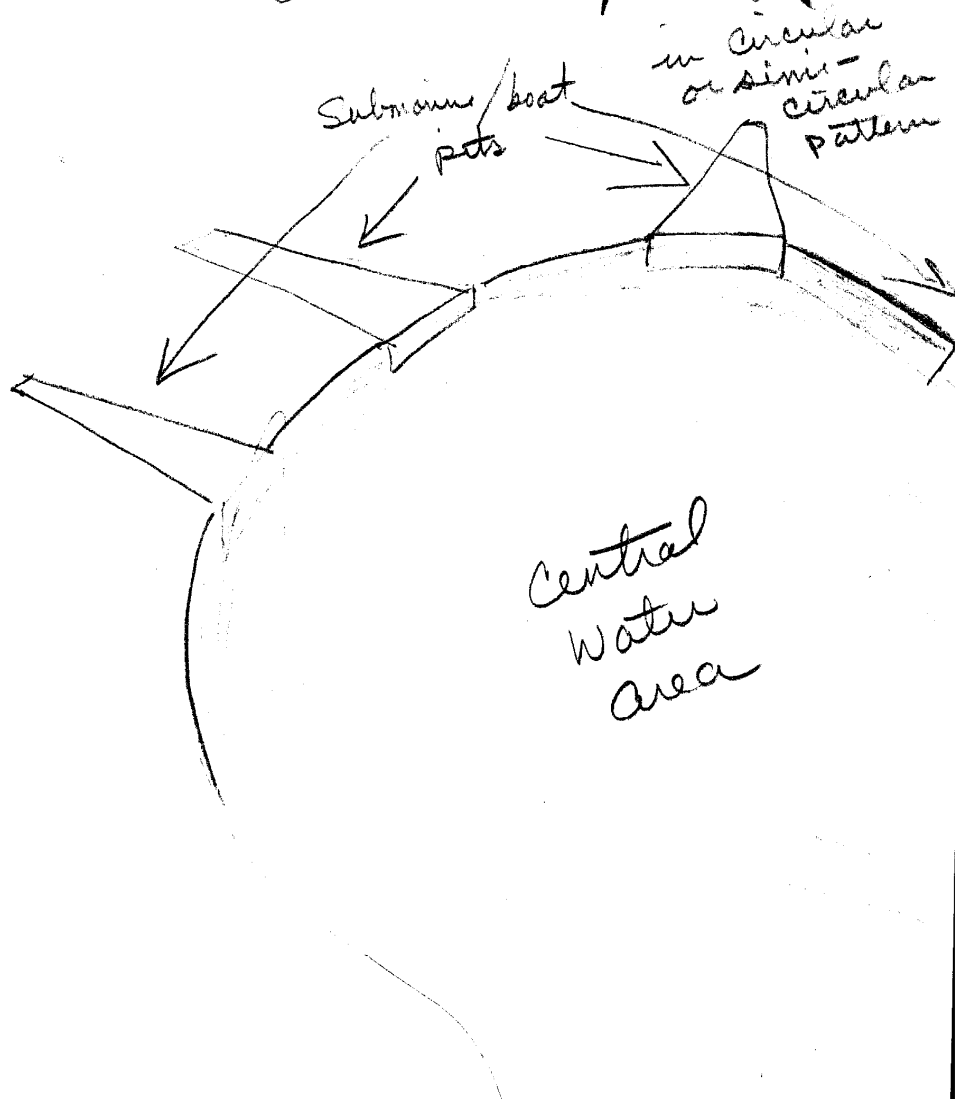
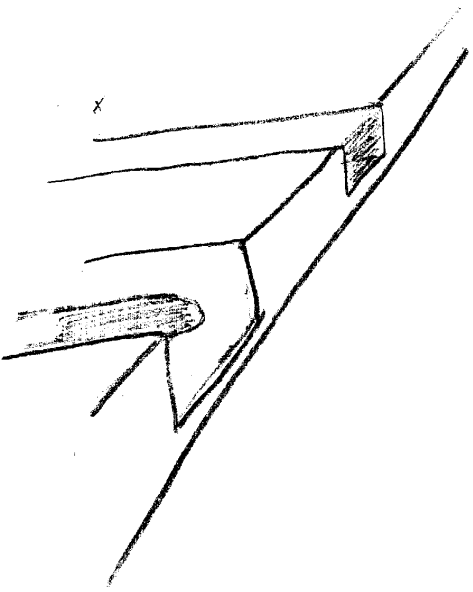

(10)

West end of body
Look in down
river

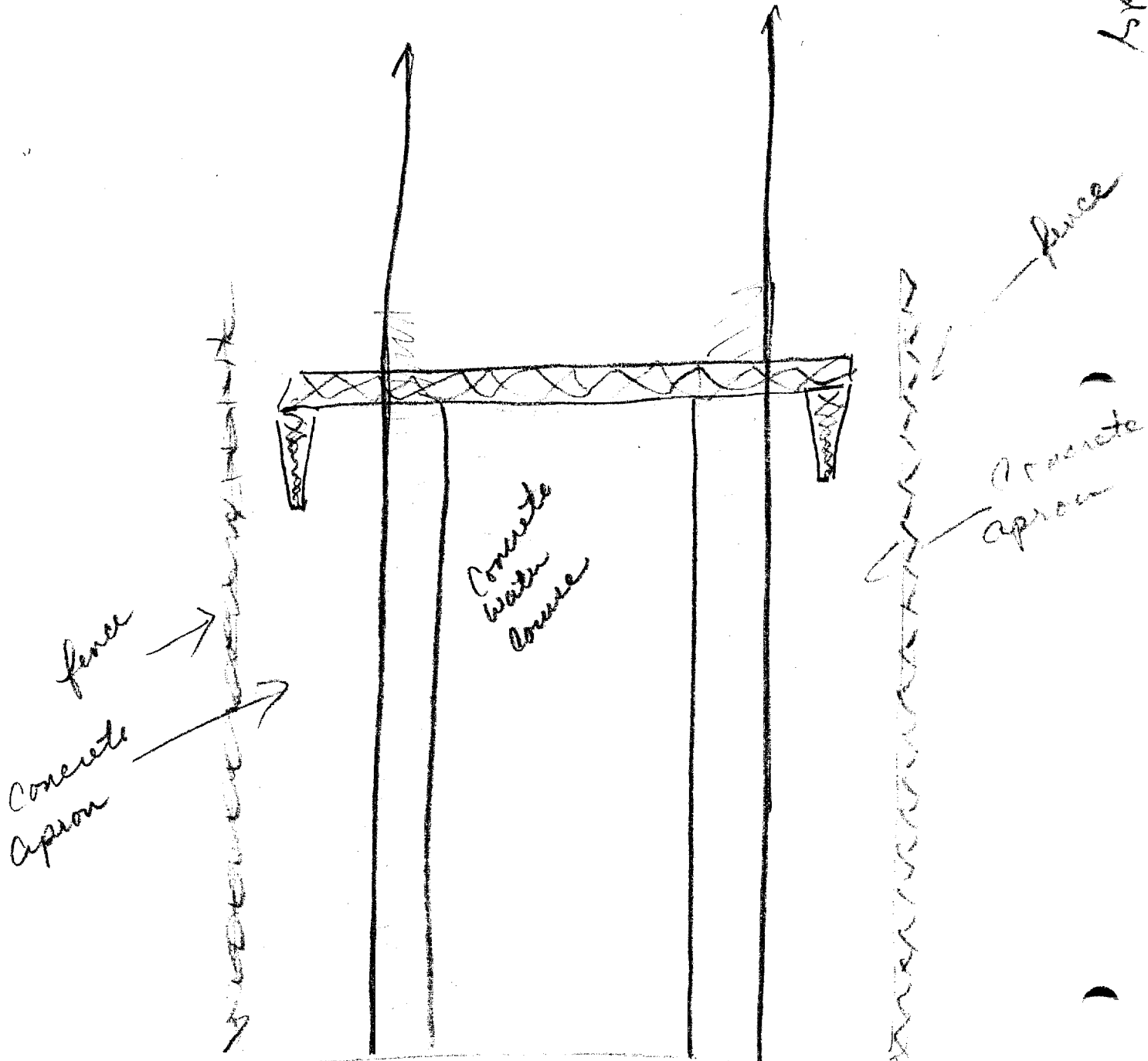

11

blde wall
in
background

catwalk
door
shield

sliding
hangar type
doors

Lock
gates
open
inward

water course

(12)

—

—

—

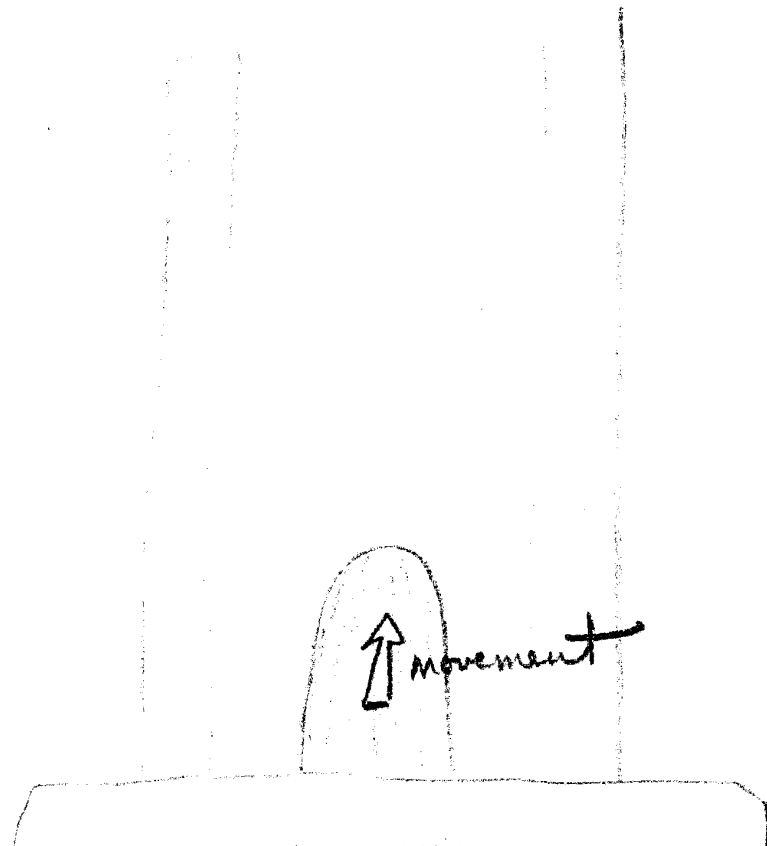

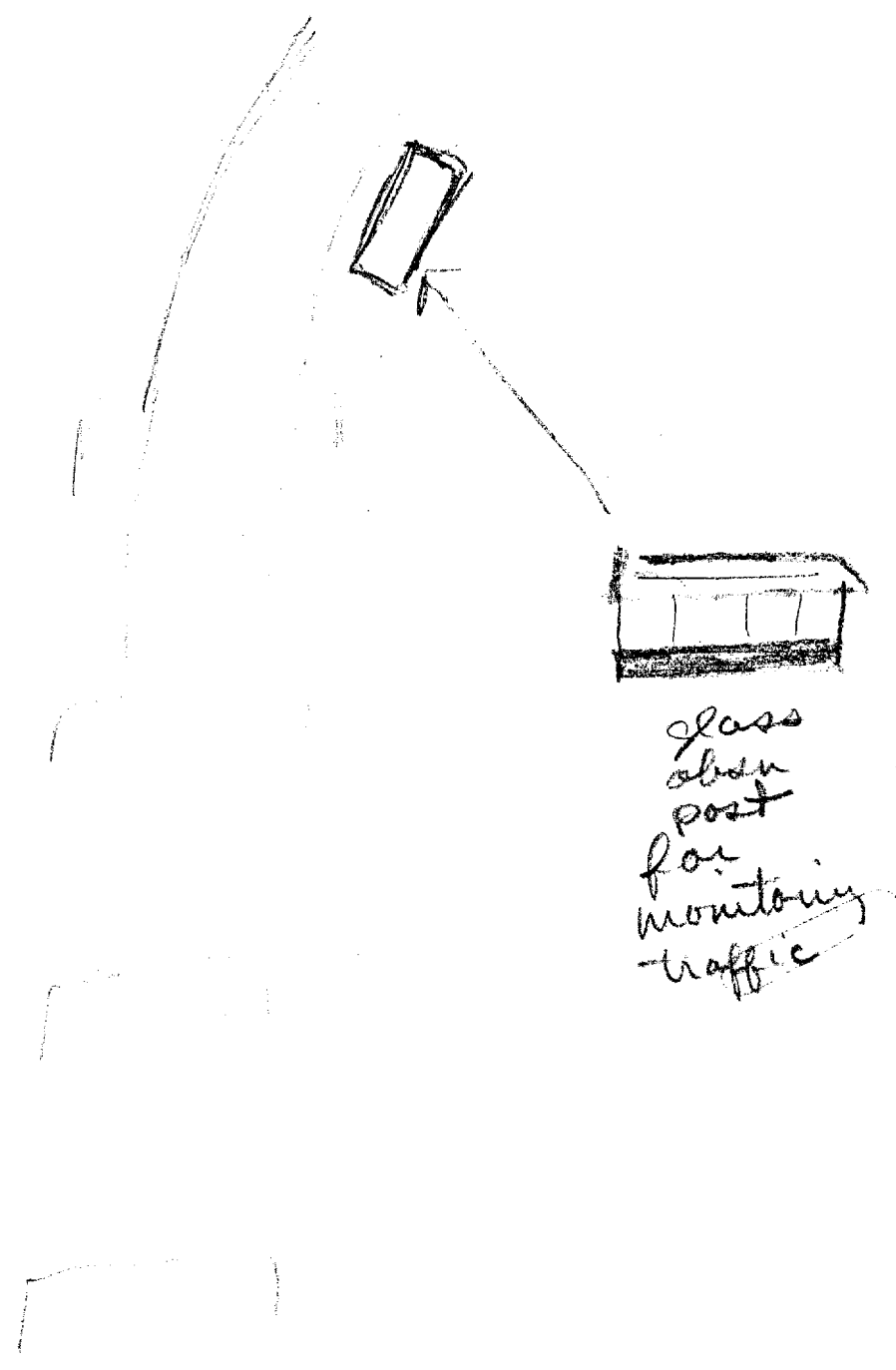

TAB

SG1A

Approved For Release 2000/08/07 : CIA-RDP96-00788R000100130001-7

Approved For Release 2000/08/07 : CIA-RDP96-00788R000100130001-7