

C/FED

25 June 1986

MEMORANDUM FOR: Acting Chief, Monitoring Operations Division
 Chief, Field Engineering Division

THROUGH: Chief, Engineering Support Group
 Chief, Operations Group

FROM: Chief, Field Support Branch, Field Engineering Division

SUBJECT: C/Bangkok Memo Dated 5 June 1986 plus Attachments

1. It is important to recognize that the conclusion Chief, Bangkok Bureau refers to in the first paragraph of the referenced memo may be accurate but is definitely not complete. The choice of sites three and four was elected so that the major ROSETS would not have blind spots in their coverage. Any decision to build additional antennas is subject to the same restrictions e.g., soil conditions, the need for retaining walls, and the coverage required, taking into account viewing angle blockage.

2. In the last paragraph of the attachment to this memo entitled "Satellite Recordings", reference is made to MOD pressing ESG for equipment to breakout time division multiplex signals. To the best of my knowledge, no one in your organization is "pressing" for this capability nor have they identified any signal in this format that is of operational interest. FYI, on our own initiative, we have begun an investigation of various demodulators to deal with infrequently employed modulation formats. We have elected to focus on those signals, in this category, which appear most frequently but can divert this effort to focus on signals that have been identified as important to FBIS, as in the case of the Soviet Pressfax.

STAT



- Distribution:
- 1 - AC/MOD
 - 1* - C/FED
 - 1 - C/ESG
 - 1 - C/OPS
 - 1 - Chrono

[Handwritten signature]

5 June 1986

MEMORANDUM FOR: Acting Chief/MOD

FROM: , C/Bangkok Bureau *RUB*

STAT

SUBJECT: Additional ROSETs for Bangkok or Okinawa Bureau

REF: Minutes of MOD Meeting with C/Okinawa Bureau,
22 April 1986

STAT

1. I would like to correct a few misconceptions concerning the placement of additional ROSETs for Bangkok Bureau. Four possible sites were considered at Bang Ping for the two 13-meter dishes which were recently completed. Sites 1 and 2 were rejected because building and tower interfered with the primary look-angle of the dishes and because the lead-in cables would have to be longer than from sites 3 and 4, not because of soil conditions. Soil testing was done only at sites 3 and 4. The conclusion was that with the proper foundation the ROSETs could be built at these locations. The firm did not make any soil tests at other locations near the building since they concluded that the soil conditions were the same. In other words, with the proper foundation a ROSET could have been built anywhere near the building.

2. The total cost for the foundation and breakwall of each 13-meter ROSET amounted to approximately \$40,000, a mere fraction of the total ROSET cost.

3. We believe that ample space exists just to the south of the Bang Ping building for the construction of additional satellite dishes. If these dishes were in the 8 to 9 meter range the foundation costs would also be proportionally less. In addition, we believe that these dishes can be built under the existing agreement with the Thai Government and additional authorizations are unnecessary.

4. In my view the construction of additional ROSETs should be based on operational requirements not on the relative conditions of the soil. If we are to use such comparative measures I would only need to mention the current cost of Thai labor versus Japanese labor. If it is determined by all concerned that Bangkok needs additional ROSETs to handle its assigned coverage, I can assure you that we will find room for them at Bang Ping.

cc: C/Ops
C/ESG
C/Okinawa Bureau

CONFIDENTIAL

STAT

OKINAWA BUREAU, 22 April (Kline)

Staff Cruisers -- Kline noted that Deputy Chief Gilbertson has prepared an Advance Work Plan for staff cruiser [redacted]. He noted Dan is doing very well, and just needs more experience and training. MOD noted it would like to keep a cruiser in Bangkok. Kline inquired about the designation of a "regional cruiser" and his location. MOD noted that this should be the most competent and experienced cruiser in the region, and Okinawa would be the best place for him. At the end of cruiser [redacted] tour his replacement will be determined on the basis of experience and how he compares with Shirey. MOD noted that Bangkok Bureau wanted to send Stiglitz on TDY's, and Kline concurred. MOD pointed out that Dan should continue to work shifts and do HF cruising and supervise, so that he can continue to learn from his 2-year PCS assignment. Kline noted he is progressing and the bureau has had no problems with his performance. MOD noted that cruising messages from Okinawa seem to have "dried up" recently, and urged that more messages be filed on cruising observations. MOD also inquired why an associate editor always signs off on Dan's messages. Kline noted that the desk editor is supposed to review all outgoing messages, but he said on his return he would point out that it is not necessary for the editor to sign off on cruising messages. MOD stressed that Dan should have a good background in cruising on the 10-meter dish at Okinawa before he attempts a TDY to Bangkok and works with the bigger 13-meter dishes there.

STAT

STAT

ROSET -- MOD confirmed Okinawa's plans for use of the new ROSET dish, which is the former PESOS dish used by MOD. The smaller dish will be used primarily for Soviet TV coverage, which will free the existing larger dish for cruising tasks and possible PRC pressfax coverage. MOD noted the bureau should check reception of known transmissions with the smaller dish to determine its limits. Kline noted that the smaller dish would be used as a backstop for the larger dish when it is down for repairs 2-19 May 1986. He noted that the addition of the smaller dish does not represent a major expansion of ROSET capabilities. He suggested that additional Far East ROSETs be placed in Okinawa instead of Bangkok, as there is room in the bureau compound and the foundation work would be much simpler than in the loose soil of the Bangkok remote site at Bang Ping. He noted that ESG is considering this option.

Satellite Cruising -- MOD requested that Shirey backstop Bangkok's cruising observations, which would give MOD a better understanding of the satellite footprints and coverage possibilities. MOD sent a message to Okinawa requesting this. MOD noted that more data is needed to make plans for satellite coverage sharing. MOD pointed out that Bangkok is conducting a comprehensive cruising survey before any coverage decisions are made. Okinawa Bureau should take advantage of its 24-hour operations to cruise satellite transmissions when Bangkok Bureau is closed. At present MOD does not believe much is available on Ku band in the Far East.

STAT

CONFIDENTIAL

Philippines -- Kline summarized the results of the December cruising survey from Cebu. He was accompanied on the survey by staff cruiser Shirey and Hong Kong monitor Escota. He noted that at Cebu they were able to hear government regional and southern opposition stations very well, but reception of Radio Veritas was poor. However he noted that during the survey they were not sure if they had the correct frequencies for Radio Veritas. He believes that with a better antenna at Cebu reception of the Mindanao and Negros stations might be better. Kline noted that he had made calls from Cebu and Clark AFB to both Okinawa and Hong Kong and they were good quality international connections. He said that while Clark AFB is a good operating site, the reception of the southern regional stations is not as good as it was at Cebu. The USIS office at Cebu was very enthusiastic about the remote operation, and Cebu base also expressed its willingness to help operate the site. MOD summarized the current status of the remote operation. State has sent a Roger channel message about the plans for the remote site, and FBIS is waiting for a response. USIS in Washington was somewhat reticent about the operation, and said it did not want FBIS' equipment in their Cebu operation. A message was also sent to the [redacted] MOD said that when it received official authorization for the operation it would inform the bureau. Kline commented that he was in favor of a USIS operation, but operating out of the consulate would also be fine. The local USIS representative, Van Svengsouk, is a radio buff and was very helpful and interested in the remote operation. [redacted], was also very supportive. The bureau plans to use programmable Sony 2001 receivers and a phone patch for the remote operation. Kline pointed out that FBIS has to be very careful and cautious with any operation, as our presence is a touchy issue for the Philippine Government.

STAT

STAT

Cities Tapes -- MOD noted that the Japanese Cities tapes were very well received by consumers. Kline mentioned that some TV programs are broadcast in both English and Japanese. MOD asked him to look into recording the English audio to the news, if it was broadcast, and send it back with the Cities tapes. Kline said he would pursue the matter.

Emergency Coverage -- MOD noted that the emergency coverage plans present a worst-case scenario which the bureau should use as a starting point for any emergency coverage, depending on the circumstances of the emergency.

Cruiser Trainees -- MOD noted that cruiser trainees would be sent to Panama Bureau until a senior cruiser was back in Okinawa.

Satellite recordings -- MOD noted it is pressing ESG for equipment capable of breaking out time division multiplexed signals, and suggested the local technicians at Okinawa might be able to check into these signals received by ROSET. MOD will send a message to Okinawa asking the bureau to check into these signals. Kline was also urged to drop MOD copies of messages on data recordings being sent to ESG for analysis. MOD also pointed out the importance of checking for programming changes on Soviet satellites. This would give FBIS an indication of transmissions which have been shifted to Raduga satellites, which we are currently unable to monitor.

cc: C/Ops, C/OW, C/BK, C/HK

CONFIDENTIAL

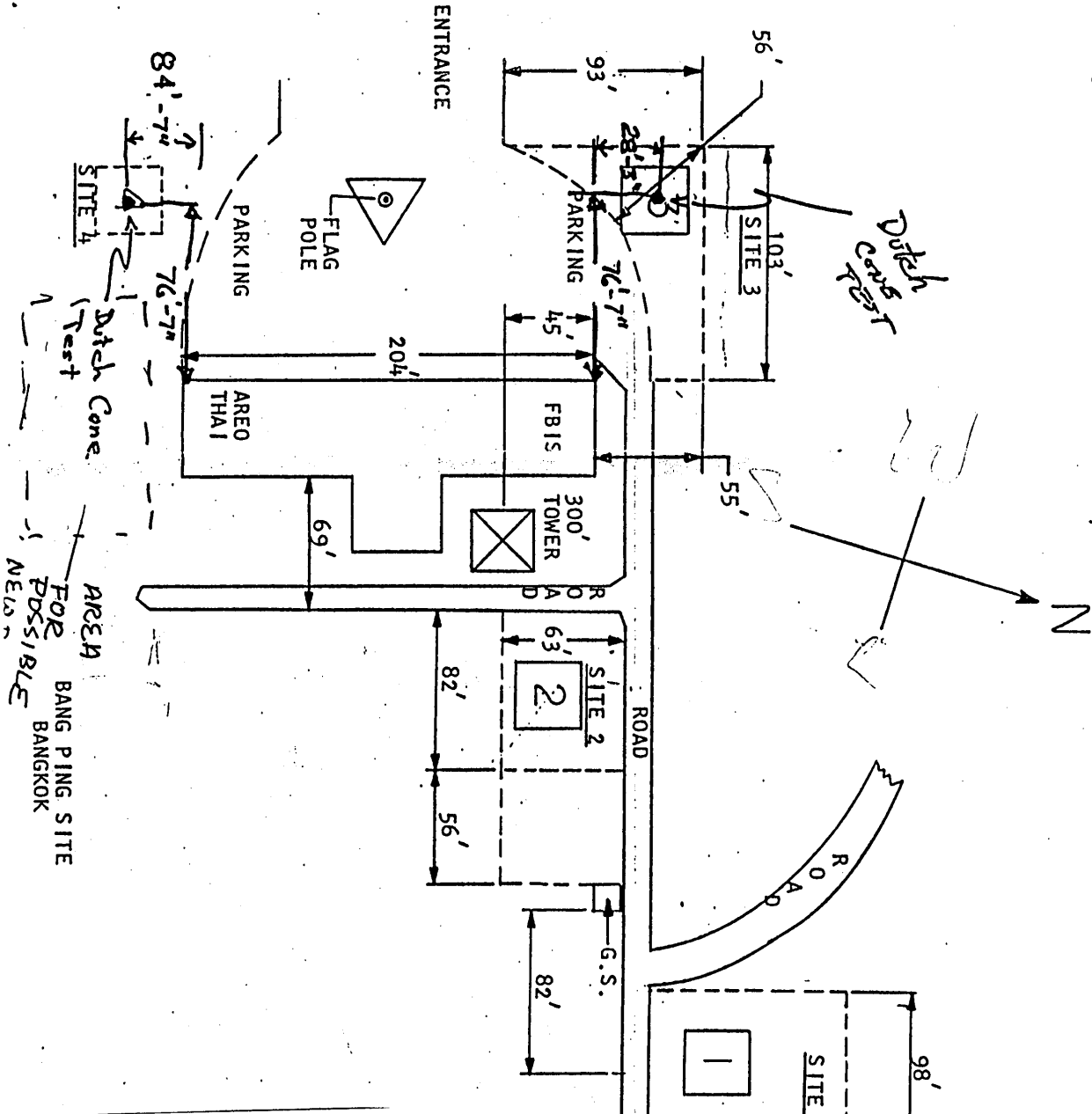

SITE 1	OBSTRUCTION	AZIMUTH	ANGLE
SHOT ON MARK X	FBIS BLDG	242°	7°
	BLDG	224°	5°
	AREO BLDG	205°	6°
	300' TOWER	228°	53°
SITE 2	FBIS BLDG	255°	15°
APPROX. CENTER	BLDG	205°	17°
	AREO BLDG	219°	12°
	300' TOWER		60°
SITE 3	FBIS BLDG	91°	18.5°
APPROX. CENTER	BLDG	124°	12°
	AREO BLDG	141°	9.5°
	300' TOWER	96°	60°

EXHIBIT 1A