

INTELLOFAX 29

INFORMATION REPORT

COUNTRY USSR (Ukrainian SSR) DATE DISTR 28 Feb 1952
 SUBJECT Kurakhov GRES Power Plant near Roza NO OF PAGES 2
 PLACE ACQUIRED [] NO OF ENCLS. LISTED BELOW 2
 DATE OF INFO. [] SUPPLEMENT TO REPORT NO. []

25X1

25X1
25X1

THIS DOCUMENT CONTAINS INFORMATION AFFECTING THE NATIONAL DEFENSE OF THE UNITED STATES WITHIN THE MEANING OF TITLE 18, SECTIONS 793 AND 794, OF THE U. S. CODE AS AMENDED. THE TRANSMISSION OR REVELATION OF ITS CONTENTS TO OR RECEIPT BY AN UNAUTHORIZED PERSON IS PROHIBITED BY LAW. THE REPRODUCTION OF THIS FORM IS PROHIBITED.

THIS IS UNEVALUATED INFORMATION

[]

25X1

1. Location:

The Kurakhov-GRES power plant is located south of a large reservoir, between ROYA (37°18'N/47°59'E), Ukrainian SSR, and a metallurgical plant.

2. Plant installations:

The first turbine was tested in 1946. The second turbine was put into operation in 1948 and, simultaneously, five boilers were installed and started operating. The turbine house had facilities for four turbines. The installation of the third turbine and the construction of bases for the fourth were started in the middle of 1949. The boilerhouse was planned for the installation of 12 boilers. Seven boilers were installed and foundations for two more boilers were laid in June 1949. This building was to be extended by an annex and will be about 450 feet long. The turbines came from the large Klingenberg Power Plant in BERLIN-RUMMELSBURG.

3. Work forces:

about 550 Soviets and 1,600 PWs doing construction work.

4. For plant layout see Annex 1. For side view see Annex 2.

25X1

Comment:

[]

25X1

b. The reported arrangement of the plant buildings agrees with former reports. The side view of the plant, as seen from the east, is forwarded for the first time.

c. The statement that the turbines arrived from the power plant is contrary to previous information that the turbines originated in MECHTAL near GLEIWITZ.

2 Annexes: 1. Power Plant ROYA

2. Sideview of the Power Plant ROYA, as seen from the east

STATE		NAVY		NSRB		DISTRIBUTION	
<input checked="" type="checkbox"/>	<input checked="" type="checkbox"/>	<input checked="" type="checkbox"/>	<input checked="" type="checkbox"/>	<input type="checkbox"/>	<input type="checkbox"/>	<input type="checkbox"/>	<input type="checkbox"/>
ARMY		AIR		FBI			
<input checked="" type="checkbox"/>	<input checked="" type="checkbox"/>	<input checked="" type="checkbox"/>	<input checked="" type="checkbox"/>	<input type="checkbox"/>	<input type="checkbox"/>	<input type="checkbox"/>	<input type="checkbox"/>

25X1

Document No. 8
 No Change in Class.
 Declassified
 Class. Changed To: TS S C
 Auth.: HR 70-2
 Approved For Release 2006/03/03 : CIA-RDP82-00457R010600340008-3 []

25X1

CONFIDENTIAL - CONTROL

25X1

CENTRAL INTELLIGENCE AGENCY

25X1

Legend to Annex 1 and 2

- 1 Boiler- and turbine house, 1,000 x 500 x 120 feet
 - a Turbine-hall with turbines
 - b Boiler-hall
 - c Six-kilowatt stations
 - d Grinding mills for coal
 - e Administration
- 2 Switch station, 300 x 45 feet
- 3 Electro-filter (regulator), 80 x 1,000 feet
- 4 Two brick smokestacks, 200 feet high, and one concrete smokestack under construction to be 200 feet high
- 5 Water basin, 50 feet in diameter, 65 feet deep, called Baganaya (sic)
- 6 Coal grinder, 80 x 80 feet
- 7 Coal storage bunker, 900 x 45 feet
- 8 Slanting lift
- 9 Cleaning building, 300 x 60 feet
- 10 Boilerhouse, 300 x 60 feet, with connecting pipes running to 9
- 11 Pipes to pumping station
- 12 Pumping station
- 13 Transformer station, 450 x 90 feet
- 14 Open-air transformers
- 15 Switches
- 16 Open-air switch station, 900 x 750 feet
- 17 Mechanical workshop
- 18 Boiler forge
- 19 Manufacture of masts
- 20 Administration building.

CONFIDENTIAL

25X1

CONFIDENTIAL

25X1

CENTRAL INTELLIGENCE AGENCY

Attachment 2

25X1

Power Plant Roy

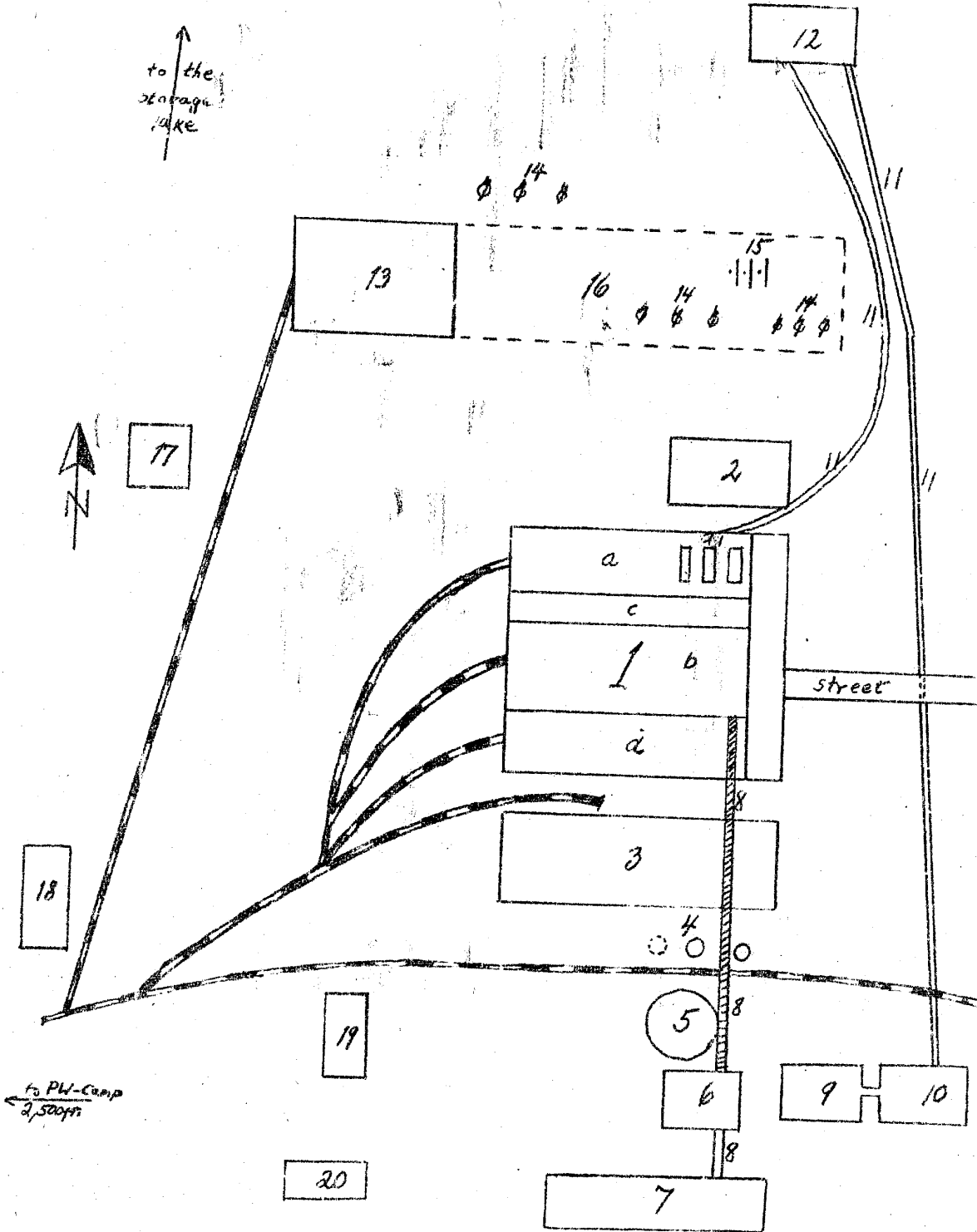

Legend: See report

CONFIDENTIAL

25X1

CONFIDENTIAL

25X1

CENTRAL INTELLIGENCE AGENCY

Attachment 2

25X1

Legend: See report

Sideview of the Power Plant ROYA

as seen from the East.

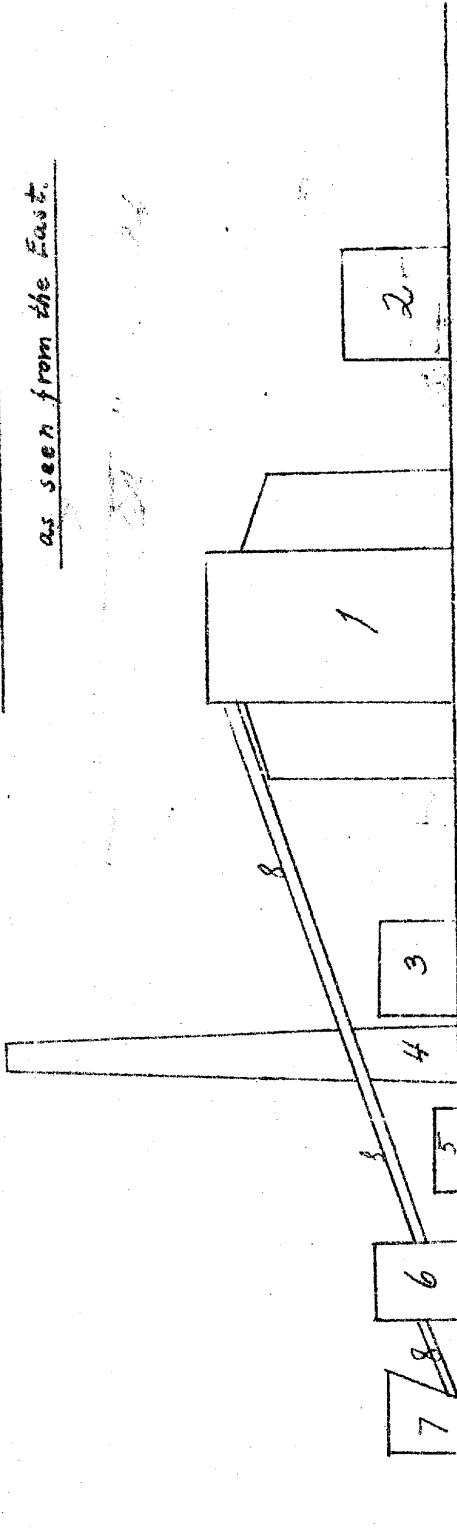

Figures correspond to legend of Annex 1.

CONFIDENTIAL

25X1