

Handwritten initials and date: 7/13/51

INTELLOFAX 23

CLASSIFICATION ~~SECRET~~

25X1A

CENTRAL INTELLIGENCE AGENCY

REPORT NO. [REDACTED]

INFORMATION REPORT

CD NO.

COUNTRY Rumania

CONFIDENTIAL

DATE DISTR. 13 July 1951

SUBJECT Galati Airfield

NO. OF PAGES 1

25X1A

REFERENCE COPY

NO. OF ENCLS. 1 sketch (LISTED BELOW)

25X1A

DO NOT CIRCULATE

SUPPLEMENT TO REPORT NO.

25X1X

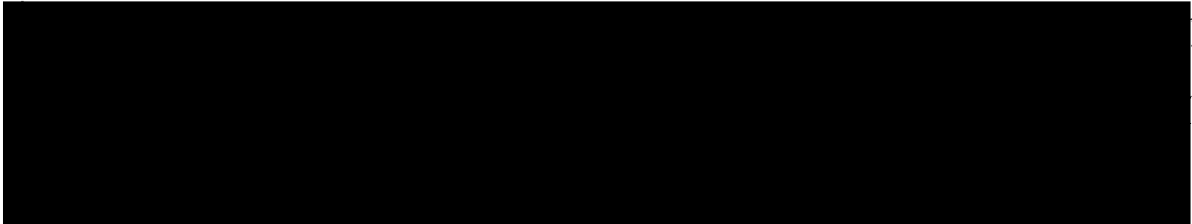

25X1X

SO



1. The Galati airport is divided into three sections, Postal, Military and TARS (the Soviet-Rumanian airline for civilian travel). TARS and the Postal section utilize twin motor planes with Studebaker engines (sic). They have a capacity of four crew members.
2. In the case of TARS, the four crew members are said to be:
 - a. Pilot
 - b. Guard for the pilot; he is armed with a machine gun and side arm.
 - c. Wireless operator.
 - d. Guard for the wireless operator; he is armed with a machine gun and side arm.
3. TARS has five or six planes stationed at the field; the Military's number varies; there are six Postal planes.
4. The Postal planes are either of Studebaker or IGAR make. The military are IAR-85, made at the IAR factory in Stalin (Brasov). This factory no longer produces planes, but is used exclusively for tractor manufacture.
5. The Galati field is two and one half kilometers in length, one and one half kilometers in width. It has four TARS hangars, three Postal Service hangars and twelve Military hangars.
6. There are two other fields used by the Postal Service, at Tutova and Iasi. The regional control office for Rumania is at the Iasi field.

This document is hereby regraded to CONFIDENTIAL in accordance with the letter of 16 October 1978 from the Director of Central Intelligence to the Archivist of the United States.
 Next Review Date: 2008

Document No. 2
 No Change in Class.
 Deleted
 Class. Changed To: TS S C
 Auth.: HR 78-2
 Date: 27-3-78
 By: BT

CLASSIFICATION ~~SECRET~~

STATE #	<input checked="" type="checkbox"/>	NAVY #	<input checked="" type="checkbox"/>	NSRB		DISTRIBUTION								
ARMY #	<input checked="" type="checkbox"/>	AIR #	<input checked="" type="checkbox"/>	FBI										

CONFIDENTIAL

SECRET

25X1A

CENTRAL INTELLIGENCE AGENCY

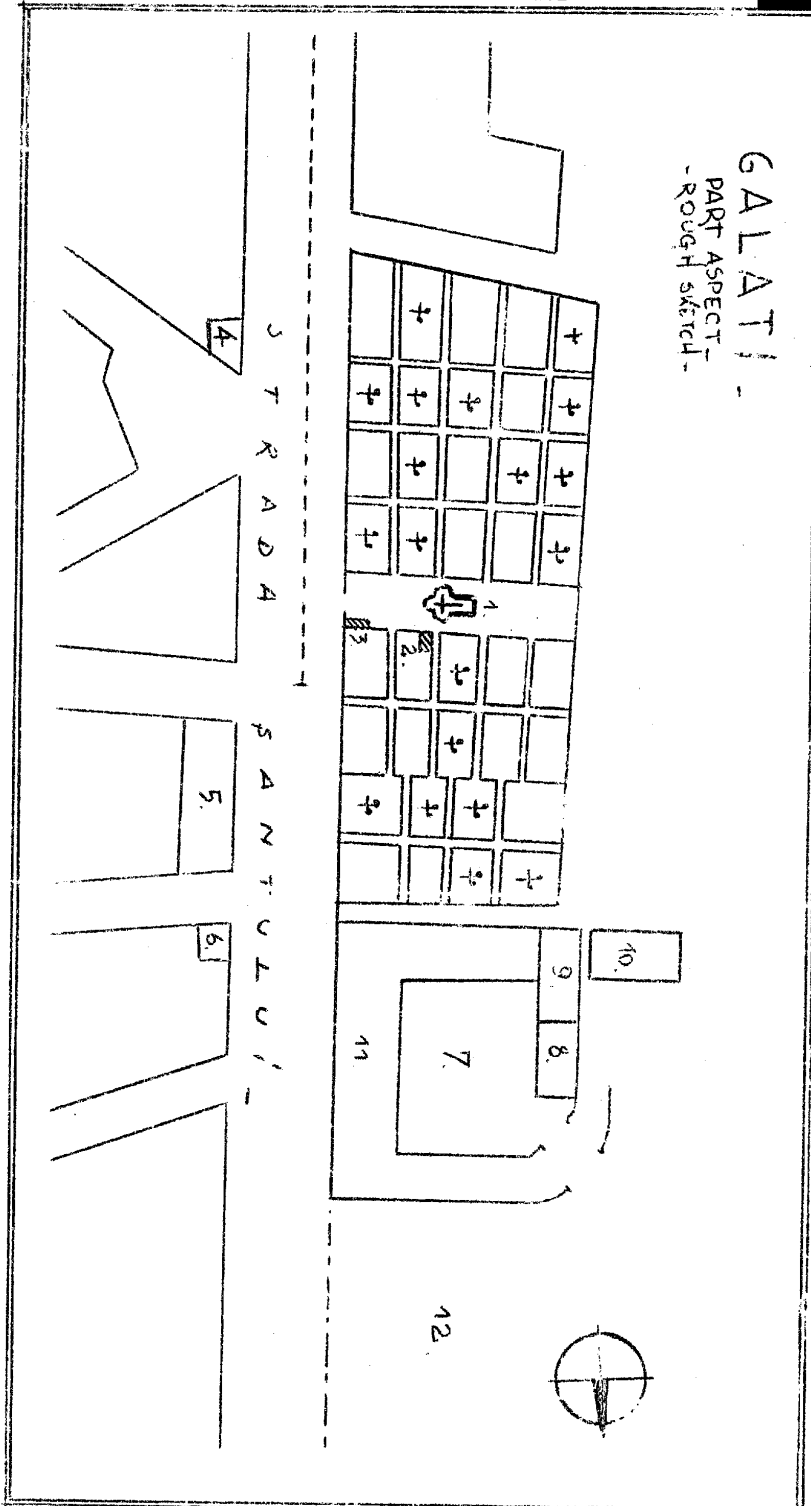

1. Church of the Cemetery
2. Office of the Cemetery
3. Gate Keeper
4. Restaurant
5. R.A.T.A. garage
6. Restaurant
7. Airfield main building
8. Hangar (5 planes)
9. " "
10. " "
11. Yard
12. Airfield

Drawn from memory by Informant and submitted to an intermediate Source