

CENTRAL INTELLIGENCE AGENCY 50X1
INFORMATION REPORT

ational Defense of the United States within the meaning of the Espionage Laws, Title 18, U.S.C. Secs. 793 and 794, the transmission or revelation of which in any manner to an unauthorized person is prohibited by law.

~~C-O-N-F-I-D-E-N-T-I-A-L~~

VF

50X1

COUNTRY	USSR (Murmansk Oblast)	REPORT NO.	
SUBJECT	Urban Area of Murmansk	DATE DISTR.	
DATE OF INFO.		NO. OF PAGES	5
PLACE ACQUIRED		REQUIREMENT NO.	RD 50X1
		REFERENCES	50X1 (G)

THE SOURCE EVALUATIONS IN THIS REPORT ARE DEFINITIVE.
THE APPRAISAL OF CONTENT IS TENTATIVE.
(FOR KEY SEE REVERSE)

2 copies

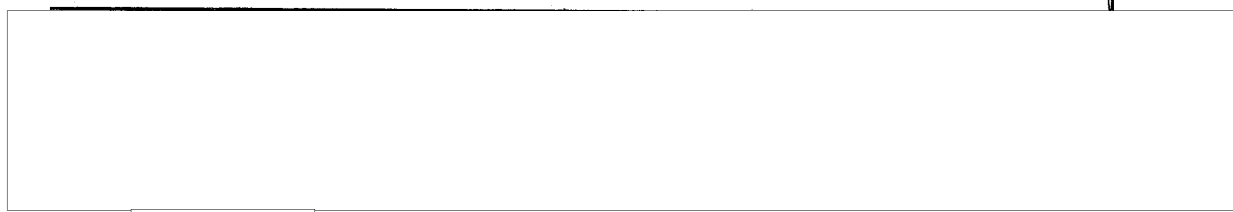

Comments: 50X1

1. Reference Nos. 40 and 44 on page 3, according to previous information, Vorovskaya ulitsa leads west to the railroad station and ulitsa Kominternu runs north and south, about 100 yards in front of the station.
2. Reference No. 66 on page 4, previous information states that the ship repair plant is a part of the fish combine.

3-02-0406

4/56

621.43

417N

30 (+1)

~~C-O-N-F-I-D-E-N-T-I-A-L~~

50X1

STATE	#X	ARMY	#X	NAVY	#X	AIR	#X	FBI		AEC				
-------	----	------	----	------	----	-----	----	-----	--	-----	--	--	--	--

(NOTE: Washington distribution indicated by "X"; Field distribution by "#".)

CONFIDENTIAL

50X1

REPORT NO.

50X1

COUNTRY USSR(Murmansk Oblast)

DATE DISTR. 27 January 195

SUBJECT Urban Area of Murmansk

NO. OF PAGES 4

DATE OF INFORMATION

REFERENCES:

50X1

PLACE ACQUIRED

50X1

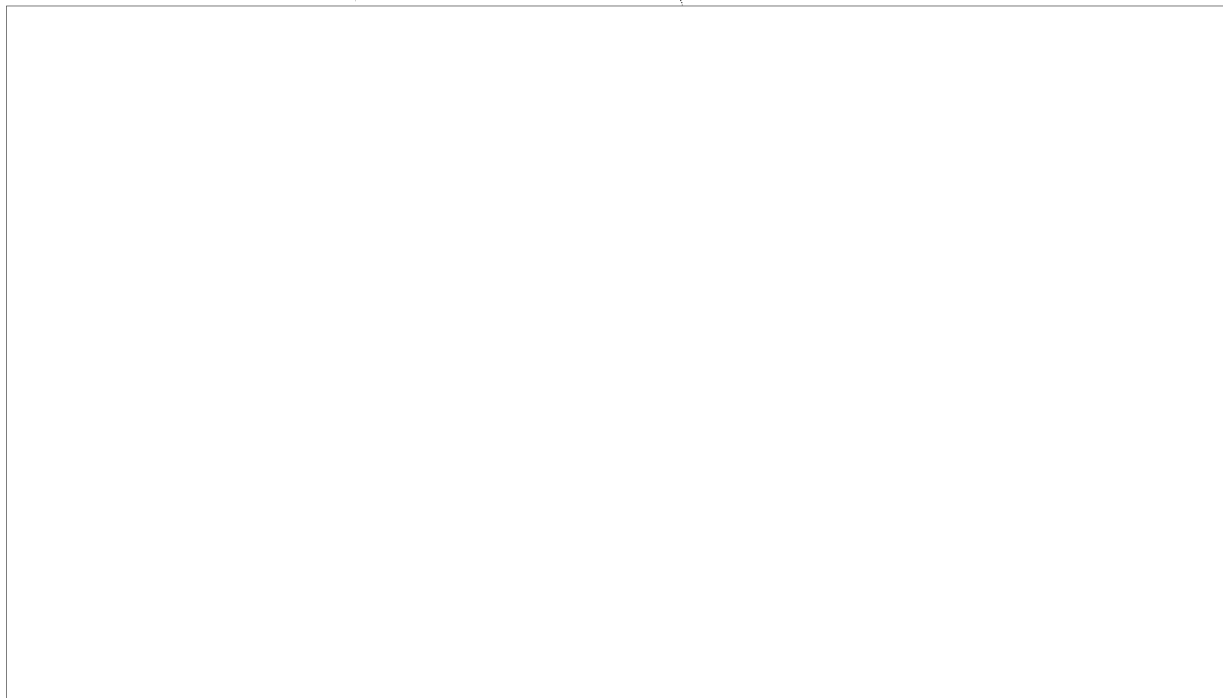

Enclosure A is a memory sketch of Murmansk. Following is the legend to this sketch. Numbers in parentheses refer to numbers on the sketch. Numbers 66 to 80 are integral parts of the fish combine.

- (1) Commercial piers - a wood and cement construction. The piers were capable of accommodating three liberty-type cargo vessels on each side.
- (2) Administration building for construction - a wood, one-story building with a gable-type roof.
- (3) Fire inspection point - a wood, one-story building with a gable-type roof.
- (4) Port Administration - a stone, two-story building with a gable-type roof.
- (5) Saw mill - a wood, one-story building with a gable-type roof.
- (6) Primorskaya ulitsa - a cobblestone street, six meters wide, in good condition. It carried medium truck traffic.

(1 ENCL.)

CONFIDENTIAL

CONFIDENTIAL

- 2 -

- (7) Ice collection point - ice trucks reported to this point and loaded up with ice for further distribution throughout Murmansk. Ships also received their ice supply here. Since there were no facilities for internal storage of ice at the collection point, ice was kept under tarpaulins in the open air.
- (8) Railroad electrical depot - a stone, two-story building with a gable-type roof.
- (9) Seaman's clinic - a wood, two-story building with gable-type roof.
- (10) Bakery - a stone, three-story building.
- (11) Seven-year school - a stone, two-story building with a gable-type roof.
- (12) Terskiy pereulok - a six-meter-wide, cobblestone street in good condition. It carried light traffic.
- (13) Chelyuskintsevskaya ulitsa - a six-meter-wide, asphalt street. Heavy traffic including all types of vehicles used this street.
- (14) Intermediate school - a brick, two-story building with a gable-type roof.
- (15) Railroad polyclinic - a brick, two-story building with a gable-type roof.
- (16) Bridge - a wooden, six-meter-wide bridge carrying heavy vehicular traffic. It spanned a ditch.
- (17) Seaman's Club - a brick two-story building with a gable-type roof.
- (18) Seven-year school - a brick, newly-constructed, two-story building with a gable-type roof.
- (19) Rest home used by sailors of the Murmansk Shipping Line between cruises.
- (20) Ulitsa Karla Lipkhnekt - a six-meter-wide, asphalt street in good condition. It carried heavy traffic.
- (21) Oktyabrskaya ulitsa - a six-meter-wide, asphalt street in good condition. It carried medium traffic.
- (22) Volodarskaya ulitsa - a six-meter-wide, asphalt street in good condition. It carried medium traffic.
- (23) City bath - a brick, two-story building with a gable-type roof.
- (24) Stadium - under construction.
- (25) Police station - a brick, three-or four-story building with a gable-type roof.
- (26) Gorkom (Gorodskoy Kommissariat) - city commissariat).
- (27) Rodina Theatre - a brick, two-story building with a flat roof.
- (28) Public square - landscaped with shrubs.
- (29) Leningradskaya ulitsa - an eight-meter-wide, asphalt street in good condition. It carried light traffic.
- (30) Hotel Arktik - a brick, four-story building with a gable-type roof.
- (31) Prospekt Lenina - a 10-meter-wide, asphalt street in good condition. It carried medium traffic.

CONFIDENTIAL

CONFIDENTIAL

- 3 -

- (32) Main post office - a brick, two-story building with a gable-type roof.
- (33) Ulitsa Profsoyuzov - a five-meter-wide, asphalt street in fair condition. It carried light traffic.
- (34) Naval hospital - a brick, four-story building with a gable-type roof.
- (35) Bank - a brick, one-story building with a gable-type roof.
- (36) Department store (univermag) - a brick, three-story building with a gable-type roof.
- (37) Dom Kultury i/n Kirov - brick, two-story building with a gable-type roof.
- (38) Ulitsa Pushkina - an eight-meter-wide, asphalt street in good condition. It carried medium traffic.
- (39) Sofiya Petrovskaya ulitsa - a six-meter-wide, cobblestone street in fair condition. It carried medium traffic.
- (40) Vorovskaya ulitsa - a six-meter-wide, cobblestone street in fair condition. It carried light traffic.
- (41) ObKom (Oblastnoy Komitet - province committee) - a brick, two-story building with a gable-type roof.
- (42) Public square - cement.
- (43) Five corners (Pyat Uglov).
- (44) Ulitsa Kominterny or Profinterny - a six-meter-wide, cobblestone street in fair condition. It carried light traffic.
- (45) Raykom (Rayonnyy Komitet-Rayon Committee) - a brick four-story building with a gable-type roof.
- (46) Old stadium - dimensions and capacity unknown.
- (47) Intermediate school - a brick, two-story building with a gable-type roof.
- (48) Teachers' institute - a brick, two-story building with a gable-type roof.
- (49) Stalinskiy prospekt - a 10-meter-wide, asphalt street in good condition. It carried medium auto traffic.
- (50) Fishing fleet rest home - a brick, four-or five-story building with a gable-type roof.
- (51) VoyenKomat - a wooden, one-story building with a gable-type roof.
- (52) Seaman's school - a brick, two-story building with a gable-type roof.
- (53) Employment administration - a wood, one-story building.
- (54) Bath - a brick, two-story building with a gable-type roof.
- (55) Railroad station - a brick, two-story building with a hangar-type roof.
- (56) Railroad coach repair yard -
- (57) Railroad yard -

CONFIDENTIAL

CONFIDENTIAL

- 4 -

- 58) City Electric Power Station - a brick construction.
- 59) Railroad electrical station - a brick, one-story building with a gable-type roof.
- 60) Tralovaya ulitsa - a six-meter-wide street made of cobblestone in fair condition. It carried medium traffic.
- 61) Shipyard of the fishing fleet - the shipyard performed maintenance work required by ships of the fishing fleet.
- 62 and 63) Fish combine - consisted of two tall, brick, two-story buildings with gable-type roofs.
- 64) Embarkation and Debarkation Station for Steamship Passengers - a wooden, two-story building with a gable-type roof.
- 65) Boiler plant for fish combine - a brick, one-story building with a gable-type roof.
- 66) Fence - surrounded the ship-repair plant. It was built of wood, two-meters high, topped with barbed wire.
- 66A) Boiler plant entrances - guarded by an unarmed civilian. Although a plant pass was required to gain access to the plant, source stated that once the guard recognized employees, it was no longer necessary to show a pass. Security measures in the plant were apparently non-existent.
- 67) Pipe fitting shop - a brick, one-story building with a gable-type roof.
- 68) Electrical shop - a brick one-story building with a gable-type roof.
- 69) Molding and casting shop - a brick, one-story building with a gable-type roof.
- 70) Blacksmith shop - a brick, one-story building with a gable-type roof.
- 71) Boiler shop - a brick, one-story building with a gable-type roof.
- 72) Woodworking shop - a wood, one-story building with a gable-type roof.
- 73) Mechanical repair shop - a brick, one-story building with a gable-type roof.
- 74) Administration office - a stone, two-story building with a gable-type roof.
- 75) Compressor shop - a stone, one-story building with a gable-type roof.
- 76) Boiler room of the electrical station.
- 77) Plant electrical station - a stone, one-story building with a gable-type roof. The plant used 220 volts AC for light and 380 volts AC for power.
- 78) Machine shop - a stone, one-story building with a gable roof.
- 79) Welding shop - a brick, one-story building with a gable-type roof.
- 80) Plant dock - a steel dock which accommodates three liberty-type ships.
- 81) Passenger dock - a wood, dock with accommodations for two or three small passenger ships.

CONFIDENTIAL

CONFIDENTIAL

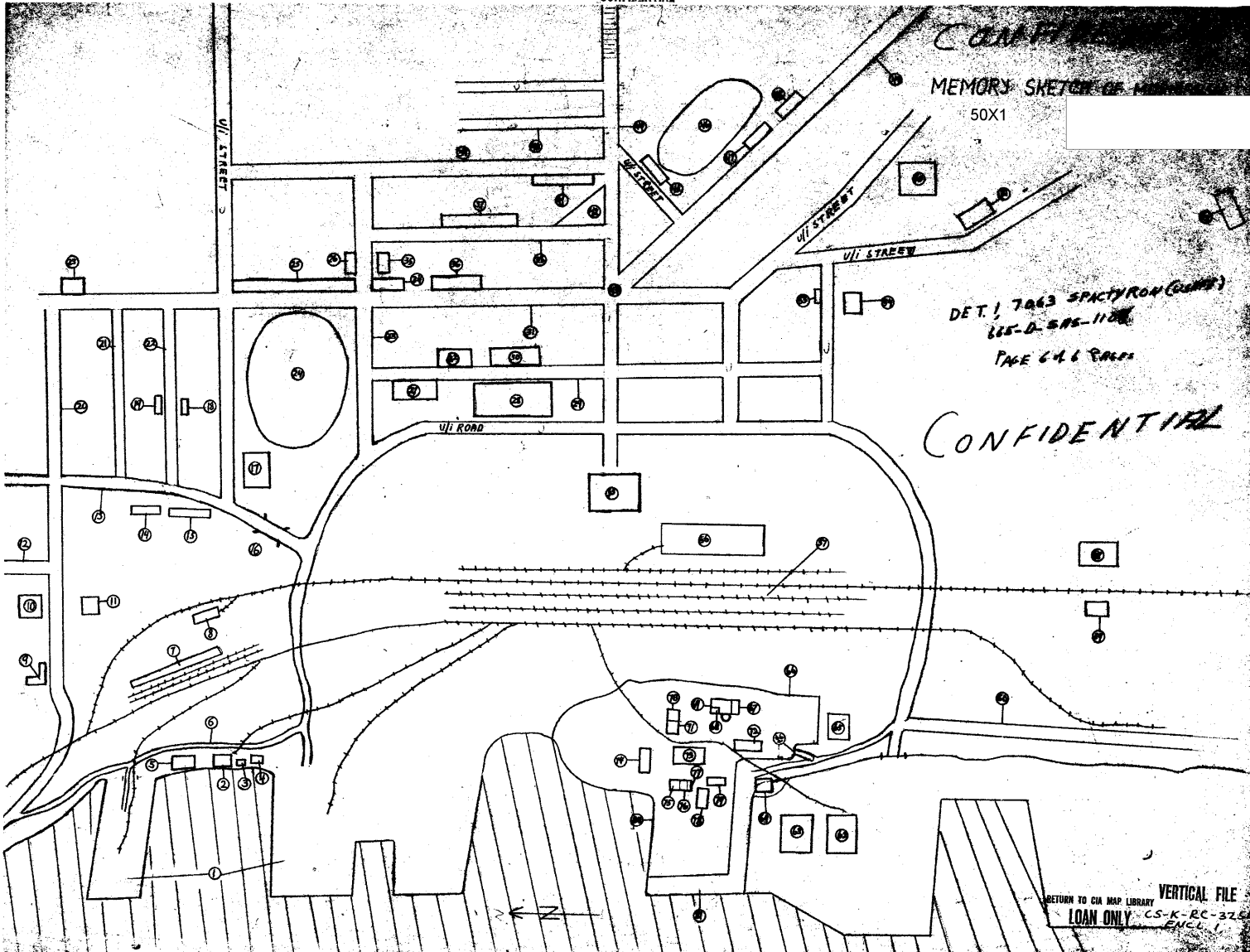

CONFIDENTIAL
MEMORY SKETCH OF
50X1
DET. 1 7063 SPACTYRON (G...)
685-D-505-1100
PAGE 646 PAGES
CONFIDENTIAL

RETURN TO CIA MAP LIBRARY
LOAN ONLY
VERTICAL FILE
CS-K-RC-326
ENCL. 1

CONFIDENTIAL

Secret

AREA A

Planning Location and Layout Sketch of "Wagner Barracks" in BIAWITZ

Map Reference: Sheet 3504 Series M61, "Walden West" 1:25,000
Basis of Info: Memo was assigned to 3714 St. Regis St. 1444
Commence from Sep 52 to Aug 53. In another fragment
it says to 1100 604 St. 217 St. of this Command from
Oct 53 to Apr 54.
Date of Info: April 1956

CSK NO. 3696

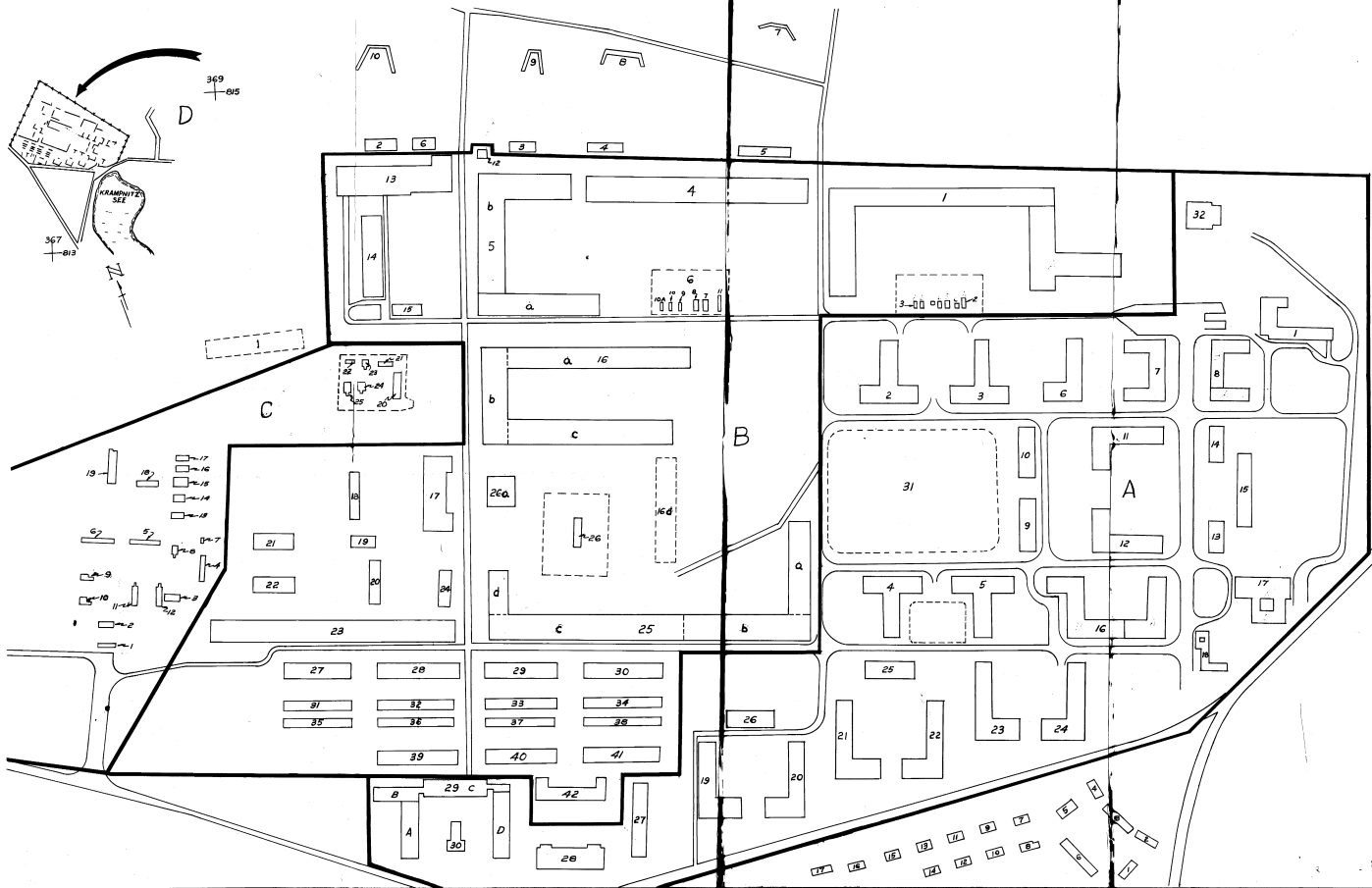
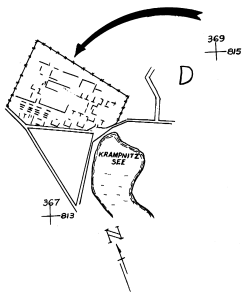

Secret

5-6-1302

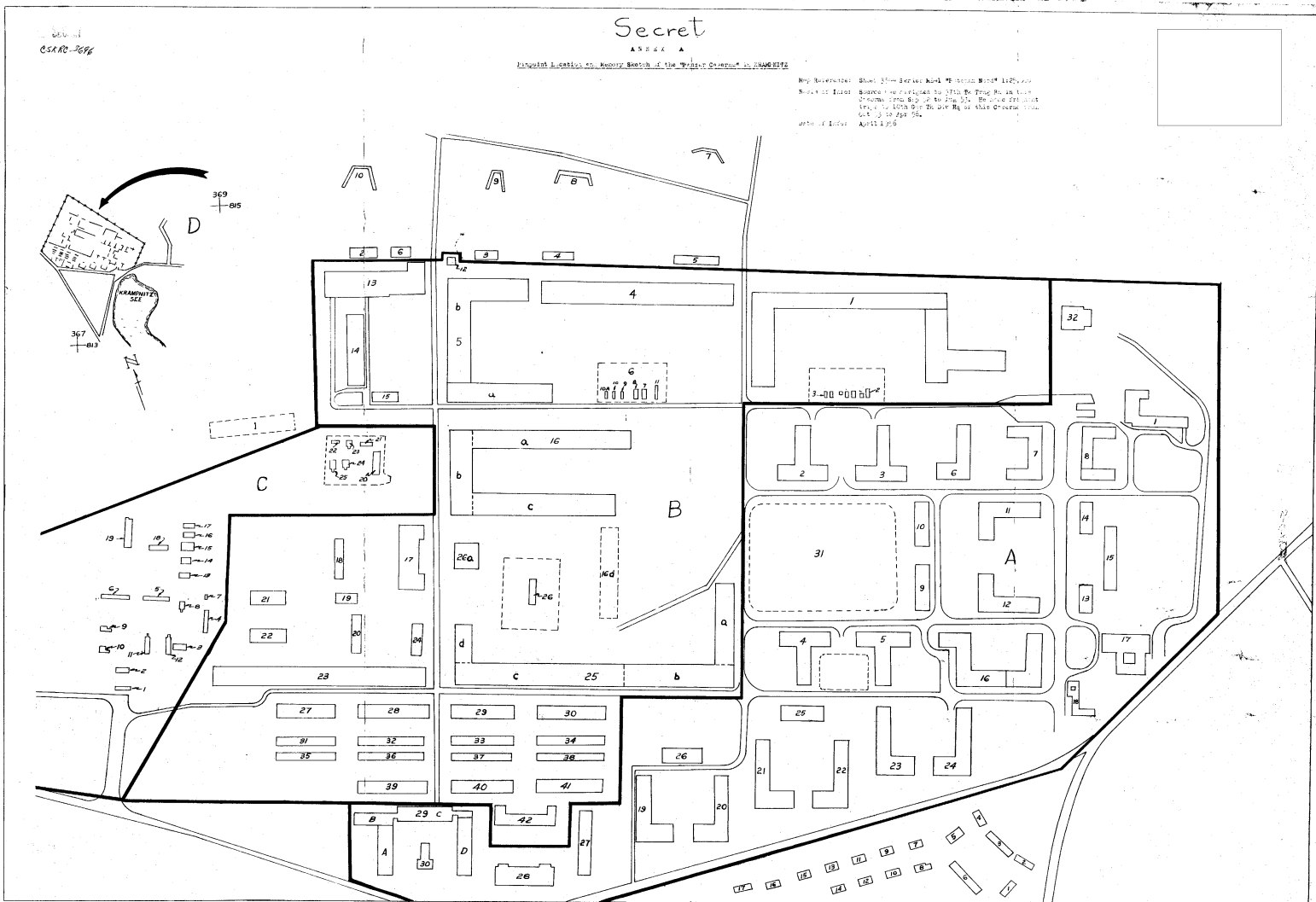

Secret

APPENDIX 3

Pinpoint Location and Memory Sketch of "Triangle Gasarve" in POTSDAM
(Memory sketch is not to scale)

Map Reference: Sheet 3944 AMB 1:50,000 "POTSDAM KAMP" 1:25,000,
and aerial photo of "Triangle Gasarve" POTSDAM
Basis of Info: Source was assigned to the 6th Sds TK Regt, which
moved into this Gasarve in October 1953 and was
still there when Source defected in May 1956.
Date of Info: May 1956

CSK No 3696

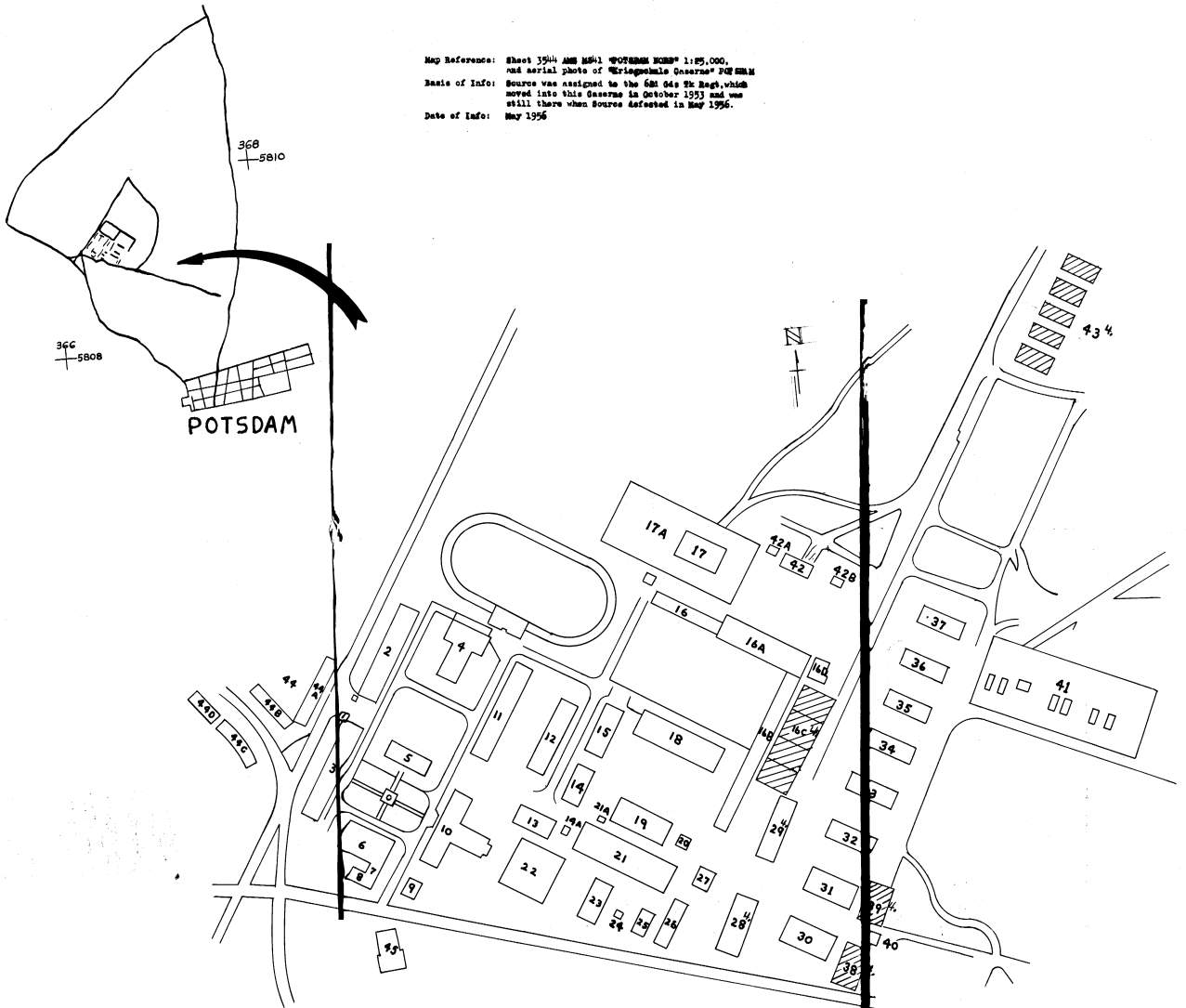

Secret

SECRET
CSARC-2676

Secret
ANNEX B

Hand-drawn sketch of the memory sketch of "Kriegshalle Course" at POTSDAM
(Memory sketch is not to scale)

Map Reference: Sheet 25: AMS No-1 "POTSDAM KURD" 1:75,000,
and aerial photo of "Kriegshalle Course" POTSDAM
Scope of Info: Source was assigned to the 6th Sig Tn Regt, which
moved into this Course in October 1953 and was
still there when Source departed in May 1956.
Date of Info: May 1956



50X1

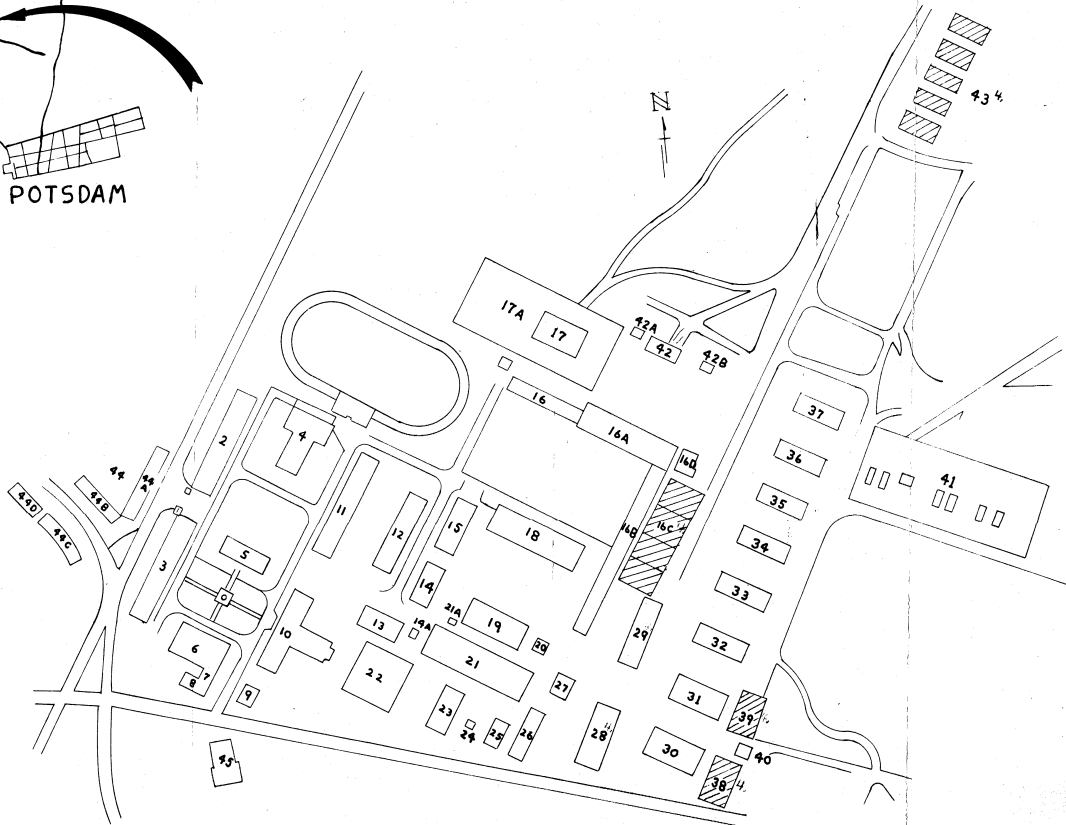
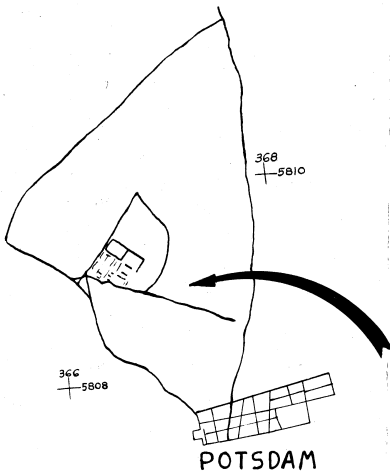

Secret

56-1302