

PROCESSING COPY *OCR*

**INFORMATION REPORT INFORMATION REPORT**

**CENTRAL INTELLIGENCE AGENCY**

This material contains information affecting the National Defense of the United States within the meaning of the Espionage Laws, Title 18, U.S.C. Secs. 793 and 794, the transmission or revelation of which in any manner to an unauthorized person is prohibited by law.

**SECRET**

COUNTRY	East Germany	REPORT	[Redacted]	25X1
SUBJECT	Wildpark Repeater Station in the Berlin Area	DATE DISTR.	11 February 1957	
		NO. PAGES	3	
		REQUIREMENT NO.	RD	
DATE OF INFO.	[Redacted]	REFERENCES		25X1
PLACE & DATE ACQ.	[Redacted]			

**ENCLOSURE ATTACHED  
PLEASE ROUTE**

SOURCE EVALUATIONS ARE DEFINITIVE. APPRAISAL OF CONTENT IS TENTATIVE.

[Redacted]

- a. Name and Postal Address: Verstaerkeramt Wildpark, Kuhfort.
- b. Location: Near the Wildpark railroad station, on the outskirts of Berlin. See Appendix I for a sketch of the location.

2. Functions of the Station.

Wildpark is a repeater station of great importance in both the static military and civil telecommunications networks of East Germany. It fulfils the following principal functions:

- Intermediate station on the Berlin Ring cable route FK201.
- Western terminal of the West Berlin by-pass cables FK150, 151 and 153.
- Terminal of the Mueggelberge - Grossbeeren - Gueterfelde-Wildpark coaxial cable route FK160 1/2.

Adequate connection is also provided with the Berlin-Magdeburg-Hannover trunk route via a spur from FK59 which joins the main cable at the nearby Geltow switching point.

3. Building and Surrounding Features.

- Building. The building consists of two parts, namely, the original station, which is a semiunderground concrete bunker, and a brick extension, which has very recently been built at surface level. These are shown in plan and elevation on Appendices I and II respectively. The original building reaches 3 m. below ground level and 2.5 m. above it. It has a concrete roof, made waterproof with tar and asphalt. Each part has a separate entrance from the outside, and intercommunicating doors are provided.

**SECRET**

[Redacted]

STATE	<input checked="" type="checkbox"/> ARMY	<input checked="" type="checkbox"/> NAVY	<input checked="" type="checkbox"/> AIR	<input checked="" type="checkbox"/> FBI	AEC						
-------	--	--	---	---	-----	--	--	--	--	--	--

(Note: Washington distribution indicated by "X"; Field distribution by "#".)

SECRET

-2-

25X1

- b. Surrounding Features. See Appendix I. House "A" is occupied by German repeater station personnel and House "B" by Soviet signal troops supervising the station. House "A" contains the entrance to an underground chamber which formerly housed a teleprinter office forming part of Hermann Goering's headquarters. The chamber still exists but is unused.
- c. Security. The windows of the concrete building are fitted with iron shutters. The door is protected by a grill, which may be locked but at present is in a damaged condition. No such security measures have been taken with the new building.

4. Personnel.

The principal technical personnel are as follows:

Otto Possier,  
Paul Kraatz,  
Fritz Koehler,  
Rudi Kunicke,  
Gerhard Hoppe,

25X1

The following shifts are worked: 0700-1500, 0800-1600, 1300 - 2100, 2100-0700 hours. The night shift consists of two men, and the total personnel of 12-16. House "A" (Appendix I) is occupied by Lau (fnu), [redacted] SED group secretary, and his family, and by Gerhard Donzek. House "B" contains a Soviet signal unit consisting of an officer and about twenty men, two of whom are present day and night on supervisory duties in the repeater station.

25X1

5. Power Supplies.

For layout see Appendix III. Two mobile gasoline engine-driven generators are kept in the yard.

6. Equipment.

For layout see Appendix III. It is estimated that about 95% of the installed equipment is in operation. The provision of five additional through repeaters is planned. Their intended position is shown on the floor plan. The Z8 carrier systems housed in a small room in the old building just inside the entrance have been recently installed. The installation consists of four terminals, each terminal comprising two bays, marked "1" and "2".

7. Cables.

The following trunk cables are brought into the station:

FK150 Berlin/Lichtenberg - Wildpark 63 pairs  
 FK151A (Berlin/Lichtenberg) - Babelsberg - Wildpark 97 pairs  
 FK153B (Berlin/Lichtenberg) - Gueterfelde - Wildpark 114 pairs  
 FK59 Berlin/Winterfeldstrasse - Hannover 218 pairs, spur from Geltow  
 FK201B Berlin Ring Cable, Treuenbrietzen - Wildpark section 97 pairs  
 FK201E Berlin Ring Cable, Wildpark - Biesenthal section 97 pairs  
 FK201F Berlin Ring Cable, Spur to Potsdam  
 FK160 1/2 Berlin/Mueggelberge - Wildpark, 2 parallel cables each containing one coaxial tube plus 17 unloaded pairs.

SECRET

25X1

**SECRET**

[Redacted]

25X1

-3-

The position of the cable terminating bays is shown on the floor plan Appendix III. (Kabelaufteilungsraum and Kabelendverschluesse).

8. Circuits.

No information [Redacted]

25X1

9. Other Installations in the same Building.

Nil.

[Redacted]

25X1

[Redacted]

**SECRET**

[Redacted]

25X1

SECRET

APPENDIX III  
WILDFANG REPEATERS STATION  
STATION, Bismarck Harbor (Navy Co. SEAW)

*Korridorraum - Wildpark (Bismarck)*

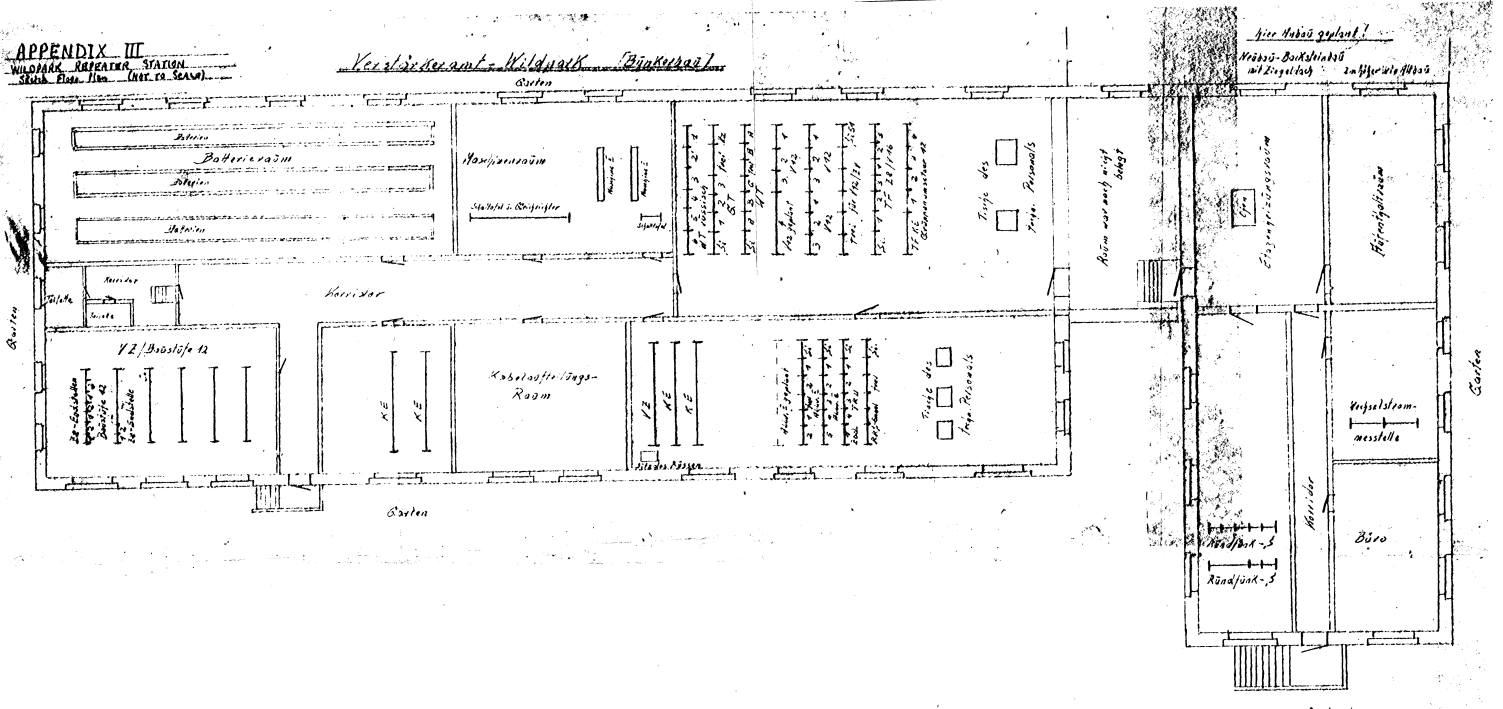

Röhre

SECRET

APPENDIX I  
WILDPARK REPEATER STATION  
Sketch Location Plan  
NOT TO SCALE

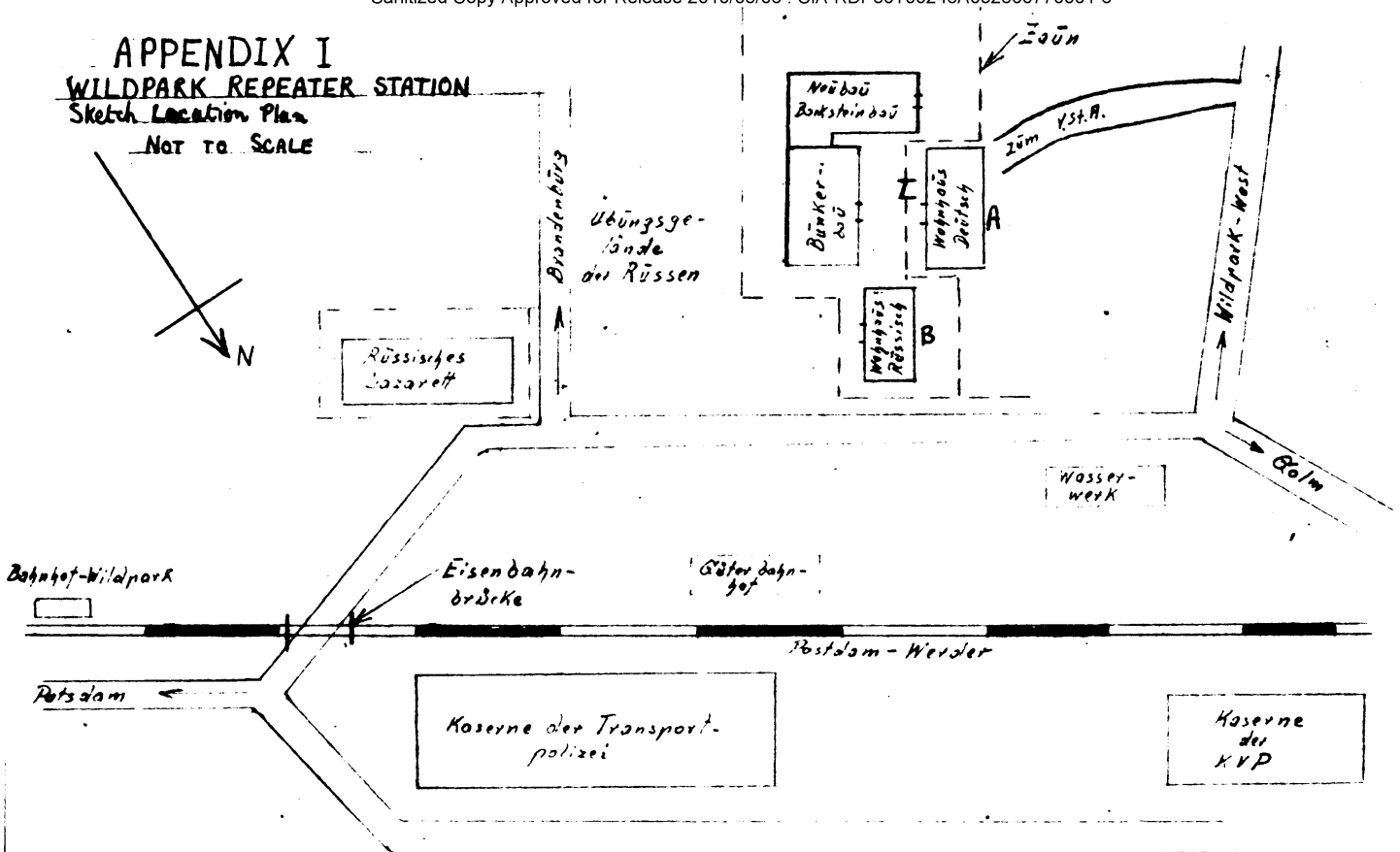

**APPENDIX II**  
**WILDPARK REPEATER STATION**  
*Sketch Cross-Section of Buildings*  
NOT TO SCALE

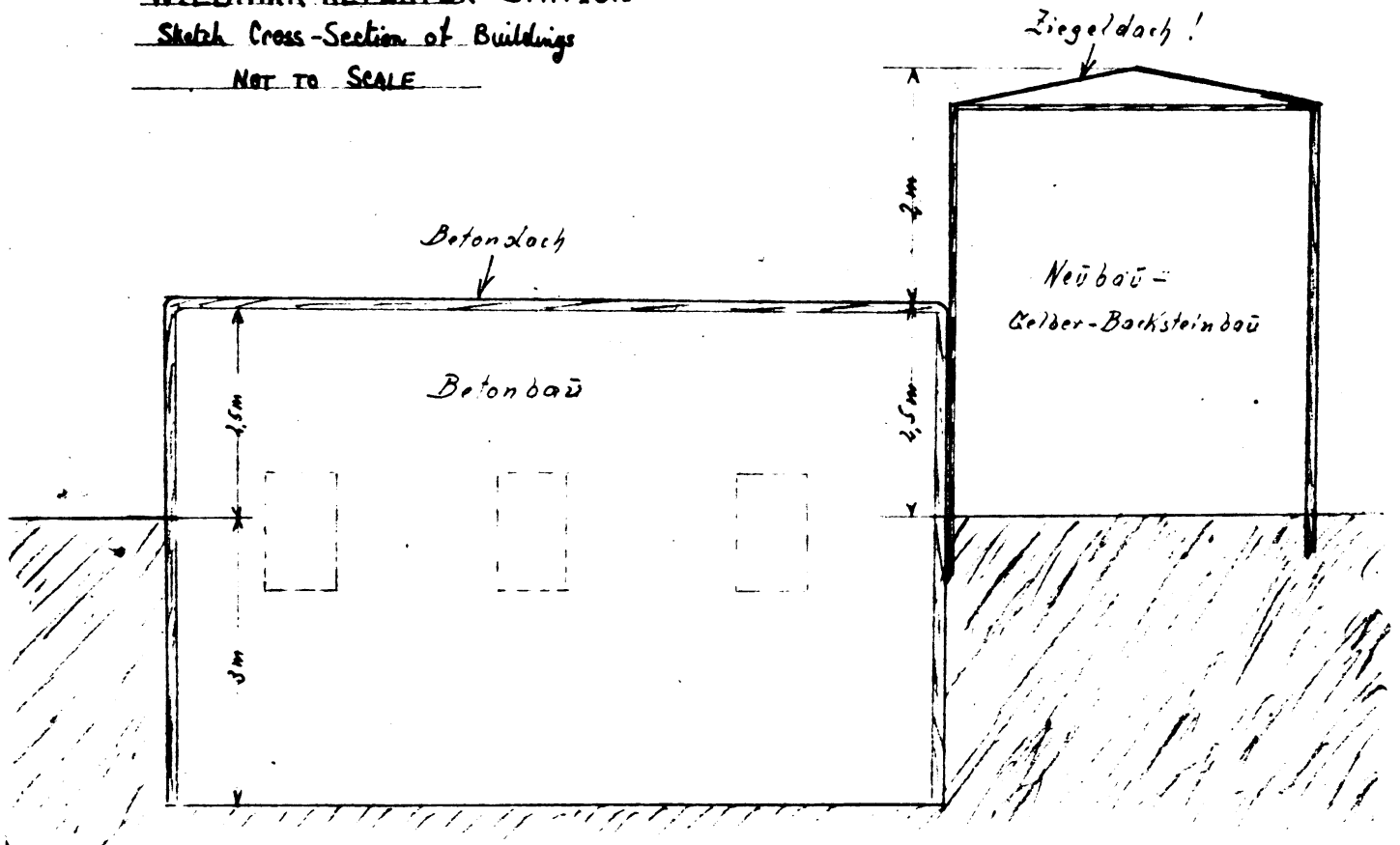

Sanitized Copy Approved for Release 2010/05/06 : CIA-RDP80T00246A032500770001-6

25X1

**Page Denied**

Sanitized Copy Approved for Release 2010/05/06 : CIA-RDP80T00246A032500770001-6