

SECRET

25X1

Zabrzka Fabrika Maszyn Gornice - Zabrze, Poland
(Mining Machine Factory)

[redacted]

[redacted] during this period the plant was engaged in the manufacture of general mining machinery including electric motors. Electric power for the plant was furnished by the Elektrownia Zabrze (OEW), Zabrze, Poland, by means of cables traversing a distance of about 3 km. Each line carries 6 KW (prob hv) which after passing through transformers was reduced to 380 Volts.

25X1

[redacted]

[redacted] in 1952 the plant embarked on a building expansion program. Further, [redacted] in 1953 the plant converted from mining machinery to the manufacture of armor plate for tanks, bunkers and pill boxes. The latter were described as having three slits and one doorway cut into the armor. The armor plate varied in thickness but [redacted] one size [redacted] was 30cm.

25X1

25X1

With this conversion, the labor force was augmented from about 900 to approximately 2500 employees. The skilled labor portion was made up of former German nationals; the unskilled portion consisted of Polish personnel. In addition there were 7 Polish repatriates [redacted]

25X1

[redacted] The supervisory force constantly changed with every production failure. [redacted] one of the earlier postwar directors was a Russian.

[redacted] major machinery failures were weekly occurrences. [redacted] this plant contained the greatest assortment of foreign machinery [redacted] Transformers, motors, lathes, milling machines, and other equipment bore manufacturer's stamps from Russia, Poland, Czechoslovakia, [redacted] Germany,

25X1

[redacted] As a result it was impossible to operate efficiently.

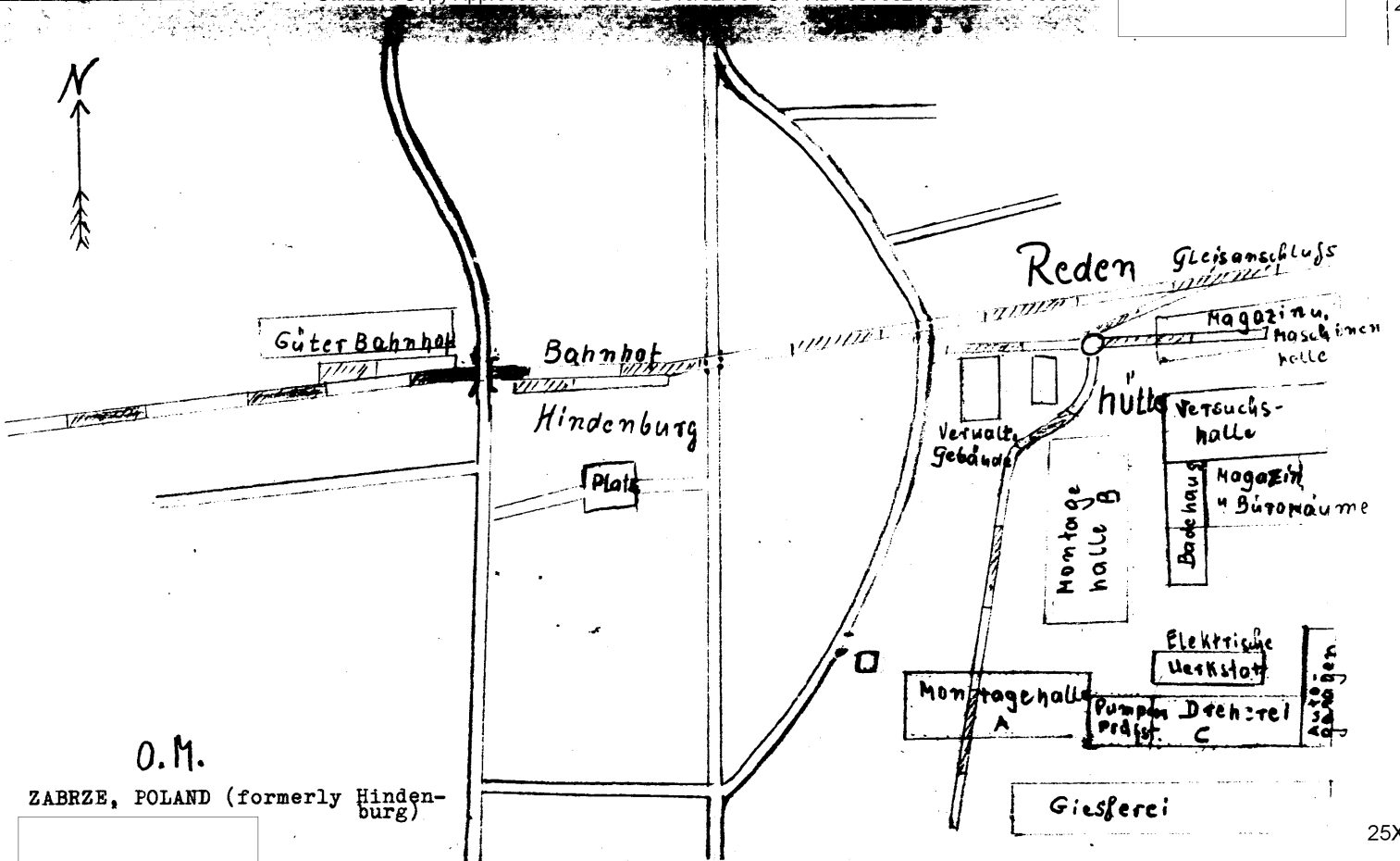

O.M.

ZABRZE, POLAND (formerly Hindenburg)



SKETCH NO. 1



SECRET

Gleisanschluss an Hauptbahn **SECRET**

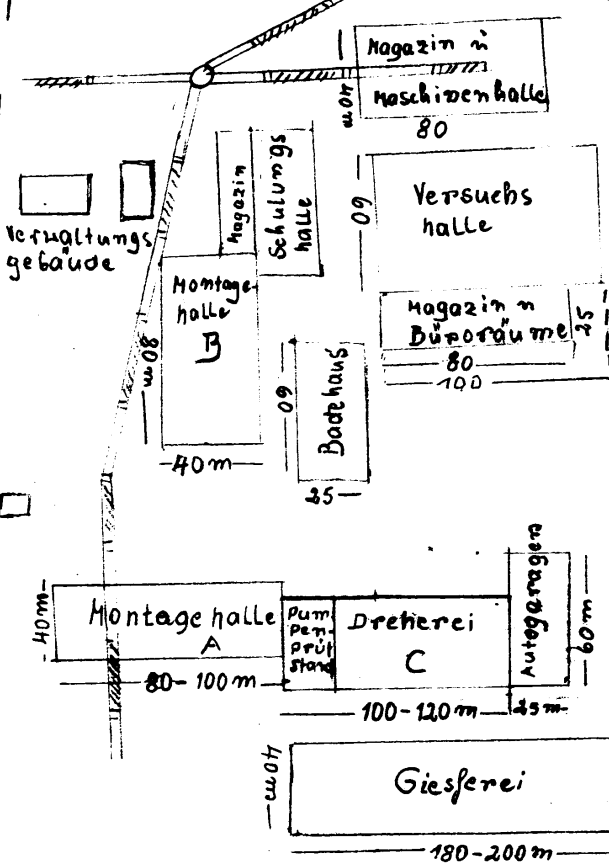

Reden-
hütte

(Zabrska Fabrika Maszyn Górnicze)

Lagerplatz
in Kraman-Lage



25X1

Maßstab: 1:200

1cm = 20m.

AS OF MAR 1951

ZABRZE, POLAND
(formerly Hindenburg)

25X1



SECRET

SKETCH No 2.

Page Denied

Next 1 Page(s) In Document Denied