

Page Denied

INFORMATION REPORT INFORMATION REPORT

CENTRAL INTELLIGENCE AGENCY

This material contains information affecting the National Defense of the United States within the meaning of the Espionage Laws, Title 18, U.S.C. Secs. 793 and 794, the transmission or revelation of which in any manner to an unauthorized person is prohibited by law.

50X1

S-E-C-R-E-T

COUNTRY	Rumania	REPORT	[Redacted]
SUBJECT	Industrial, Military and Municipal Installations in Floesti and Vicinity (Keyed layout of Portions of the Area Plus Description and Manpower Information on Some Industrial Installations)	DATE DISTR.	27 November 1959 50X1
		NO. PAGES	35
		REFERENCES	RD
DATE OF INFO.	[Redacted]		50X1-HUM
PLACE & DATE ACQ.	[Redacted]		50X1-HUM

SOURCE EVALUATIONS ARE DEFINITIVE. APPRAISAL OF CONTENT IS TENTATIVE. 50X1-HUM

Building Company No. 131

1. Building Company No. 131 (Intreprindere De Constructie No. 131) of the Ministry of Construction is directly subordinate to Trust No. 13 with headquarters at 3, Maria Rosetti Street, Bucharest. Trust No. 13, which executes various building projects, mainly in the oil industry area, controls the following four companies:
 - a. Building Company No. 131 in Floesti - construction
 - b. Building Company No. 132 in Targoviste - construction
 - c. Building Company No. 136 in Bucharest - installations.
 - d. Building Company No. 138 in Bucharest - industrial constructions.
2. Building Company No. 131 has its main offices at 5, Golesti Street, Floesti, in a two-story building which formerly belonged to a Dr. Comanescu. This company has been operating under its present name since 1955. During the years 1951-1955 it was called Sovromconstructie; during 1949-1950 its name was Intreprindere M-4, while during the years 1946-1948 it was called Constructie Industriale Si Civile (CIC). The company employs about 3,000 workers, approximately 800 of whom compose the administrative and technical staffs. Since 1946 it has executed a large number of projects, mainly in the field of industrial building. The following details are reported:
 - a. During the years 1946-1948 it was mainly occupied with the reconstruction of refineries and residential buildings in Floesti.
 - b. During the years 1948-1950 it built:
 - 1) A high school for oil technicians in Floesti.

4/11

151

S-E-C-R-E-T

50X1-HUM

STATE	X ARMY	X NAVY	X AIR	X FBI	AEC				
-------	--------	--------	-------	-------	-----	--	--	--	--

(Note: Washington distribution indicated by "X"; Field distribution by "#".)

INFORMATION REPORT INFORMATION REPORT

S-E-C-R-E-T

50X1-HUM

- 2 -

50X1

- 2) A large restaurant (which also serves for theatrical performances) at No. 3 Refinery in Floesti.
 - 3) Two elementary schools in Floesti.
 - 4) A new industrial hall at the "1 Mai" plant in Floesti.
 - 5) A special clinic for oil industry workers in Floesti.
 - 6) Two stores for antiaircraft guns at the barracks of an antiaircraft unit on 23 August (formerly Cantacuzino) Street, Floesti.
 - 7) Various military barracks in Floesti were repaired and renovated.
 - 8) The building of the provincial Securitate office on Vasile Lupu Street, Floesti.
 - 9) Barracks in Campina (30 kilometers from Floesti) for a Securitate unit.
 - 10) A large restaurant in the "1 Mai" plant; this building also serves for theatrical performances..
 - 11) An additional industrial hall ("M-3", i.e. mechanical department No. 3) at the above-mentioned "1 Mai" plant.
- c. During the years 1951-1958 the company executed the following work:
- 1) During 1951 it erected a new industrial hall at the ceramic works (Uzinele Ceramice) in Floesti.
 - 2) In 1951 two new industrial halls were constructed and a transformer station erected at the Ferro Email plant in Floesti.
 - 3) In 1951 industrial and residential buildings were erected at the Ilie Pintilie arms factory in Margineanca (Flopeni), about 12 kilometers from Floesti.
 - 4) In 1951 a power plant and large laboratory were built at No. 2 refinery in Floesti.
 - 5) Work started in 1951 at the "Victor Poni" sulphuric acid plant in Valea Calugaresca (10 kilometers from Floesti); work there is still in progress.
 - 6) The construction of a large oil refining plant was started in 1951 at No. 3 Refinery.
 - 7) During the years 1951-1952 the ISAR (formerly Macazul), a repair plant for equipment used in the oil industry, was expanded.
 - 8) The expansion and modernization of a steel foundry at the "1 Mai" plant; the work included construction of a pattern marker's shop and a number of air raid shelters.
 - 9) In 1952 three cooling towers and a large restaurant (which also serves for theatrical performances) were built at No. 1 Refinery, Floesti.

S-E-C-R-E-T

50X1-HUM

S-E-C-R-E-T

50X1-HUM

- 3 -

50X1

- 10) During the years 1954-1957 a tar paper factory was constructed in Teleajen near Floesti.
- 11) During the years 1954-1956 a dyeing department and nursery school were built at Dorobantul Textile Plant in Floesti.
- 12) In 1955 an antiaircraft command post was built in Floesti.
- 13) During 1956-1957 large laboratories for plastic materials research were erected on the premises of the former Xenia refinery in Floesti.
- 14) Since 1956 work has been in progress on a large plastics factory in Brazi (six kilometers from Floesti), opposite No. 6 refinery.
- 15) A new post office was built in Floesti during 1956-1958.

In addition, Building Company No. 131 has built many residential buildings and other structures in Floesti.

Oil Refineries

3. The following seven oil refineries are operating at present in Floesti and vicinity:
 - a. No. 1 Refinery (the former Astra Romana) situated at its prewar location in a southern suburb of Floesti, on Bulevardul Petrolului (formerly Bulevardul Cratulescu).
 - b. No. 2 Refinery (the former "Vega" refinery), also situated at its prewar location north of Floesti at the beginning of the Floesti-Valeni road.
 - c. No. 3 Refinery, Teleajen (the former Rafineria Romano-Americana), located east of the town, at its prewar location.
 - d. No. 5 Refinery (the former Standard) located in the southern part of Floesti, opposite the "1 Mai" plant (formerly "Concordia").
 - e. No. 4 Refinery (the former Rafineria Steaua Romana) at its prewar location in Campina.
 - f. No. 6 Refinery (the former Rafineria Creditul Minier) in Brazi (six kilometers from Floesti), located at its prewar site opposite the railway station.
 - g. No. 7 Refinery (the former "Columbia" or "9 Mai") is situated at the end of Petre Gheorghe Street, on the southwestern outskirts of Floesti.
 - h. No. 10 Refinery is known to be located at Onesti.
4. The following refineries in Floesti are no longer operative:
 - a. Rafineria Redeventa was completely liquidated and dismantled and on its premises warehouses were erected for the storage and maintenance of heavy equipment belonging to the TCR (Trust Constructie Rafinerie)

S-E-C-R-E-T

50X1-HUM

S-E-C-R-E-T

50X1-HUM

- 4 -

50X1

- a special building company of the Ministry of Oil and Chemical Industries.
- b. Rafineria Cometa which existed before World War II, opposite the former Rafineria Redeventi, was also liquidated and residential buildings were built on the site.
 - c. All the equipment of the former Xenia Refinery was dismantled. Its buildings, together with newly erected ones, now house a large research laboratory of plastic materials of Petrochim, a plastics factory which is to be established.
 - d. The former Fratia Refinery was closed down and residential buildings constructed on the site.
 - e. The former Lumina, Noris and Orion Refineries now constitute integral parts of No. 1 Refinery.
 - f. On the site of the Unirea Refinery, which was completely dismantled, new industrial halls were built which constitute the Uzina De Reparatie Utilaj Petrolifer (oil equipment repair shop).
 - g. The former Luciana Refinery was completely dismantled but nothing was built on the site.
 - h. The Dacia Romana Refinery was also dismantled and new industrial halls were built which comprise an oxygen plant.
5. Refinery No. 1 is the largest and best organized refinery in Floesti. Prior to 1955 large investments were made at this plant for the construction of three new concrete cooling towers (details unknown) and a workers' restaurant. The restaurant can seat more than 1,000 people. No new investments were made at this refinery during the 1955-1957 period. In 1958 the improvement and modernization of its equipment was started. This will reportedly require an outlay of approximately 50 million lei. Its total daily (24 hours) output is reported to be 1,000 tons. As is the case in all Floesti refineries, gasoline produced does not attain a rating higher than 70 octane.
 6. Since 1952 this refinery has been under expansion north from the old plant up to the Teleajen River. Hundreds of workers are occupied in building the "Elocul De Ulei", part of which started to operate in 1958. Within the area a 25,000 kilowatt thermal power station was built during 1953-1957. (Details regarding exact location, connection of high-tension lines, etc. are unknown)
 7. A lubrication oil plant for aircraft is located about one kilometer from Refinery No. 3.
 8. According to reports, Refinery No. 6 in Brazi has an output of 800 tons of petroleum products per day. A new cracking plant (the design and part of the equipment were supplied by the USSR), has been under construction there since 1954. Annual investments reportedly amount to about 200,000 lei.

S-E-C-R-E-T

50X1-HUM

S-E-C-R-E-T

50X1-HUM

- 5 -

50X1

Industrial Enterprises

9. Uzinele 1 Mai (formerly Concordia S.A.R.), the largest industrial plant in Ploesti, is situated in the southern part of the town, about 500 meters from the Gara De Sud and opposite Refinery No. 5. Before World War II, the plant engaged in the repair of oil industry equipment, including tank cars, and in production of road-building machinery. In 1938 it started to produce artillery shells. Construction was started on a number of buildings in which the production of guns was begun in 1940. During the years 1945-1948, the war-damaged plant was rebuilt. Expansion work started in 1948 and included the following:
- a. New industrial hall (M-1) was erected for the assembly of oil drilling equipment.
 - b. An additional industrial hall (M-4) was erected which serves as a machine shop.
 - c. The tank car and fuel container producing department was rebuilt.
 - d. A building was erected which serves as a hospital and dispensary.
 - e. A building was erected which serves as a restaurant and theater.
 - f. A building was erected for the technical bureau.
 - g. A pattern maker's shop was built.
 - h. The steel casting department was expanded.
 - i. A concrete water tower with a capacity of 1,000 cubic meters was built.
 - j. Transformer stations and air raid shelters were built.
10. The following are particulars regarding the principal departments of the "1 Mai" plant:
- a. The iron casting shop, which occupies a brick building with a metal roof (approximately 100 by 20 by 12 meters), operates on natural gas. It contains two horizontal furnaces (cubilouri) of three tons' capacity each and a half-ton horizontal furnace for the casting of non-ferrous metals.
 - b. The steel casting shop is housed in a building of concrete and bricks, with a half-round concrete roof covered with tar paper. It contains:
 - 1) Two electric furnaces of Belgian make with a capacity of 1.5 tons each.
 - 2) One Steiner electric furnace of three tons' capacity.
 - 3) One furnace for drying patterns.
 - 4) Two overhead cranes with lifting power of ten tons each.
 - 5) One overhead crane for patterns with a lifting power of five tons.
 - 6) A mechanical installation for conveying and removing burned sand.

S-E-C-R-E-T

50X1-HUM

S-E-C-R-E-T

50X1-HUM

- 6 -

50X1

- c. The precision casting shop has only one half-ton furnace; casting is done in bakelite moulds.
- d. No. 1 hall (M-1) which is the assembly shop for oil-drilling equipment, is 108 meters long, about 30 meters wide and about 15 meters high, with concrete walls on a steel frame, an oakwood floor, and a metal roof. There are two overhead traveling cranes, a 20-ton crane installed in 1951 and a 50-ton crane installed during 1956-1957.
- e. The old machine shop (also designated M-1) is a brick building with a metal roof and an area of about 100 by 30 by 10 meters. It comprises at least 100 metal-working machines of various types, as well as a 10-ton overhead traveling crane.
- f. Machine shop "M-4", a metal-roofed concrete structure with an area of 100 by 20 by 12 meters, contains 50 to 60 metal-working machines of various types and a 10-ton overhead crane.
- g. The "M-2" department, which is also a machine shop (where guns were manufactured during World War II), extends over an area approximately 80 by 10 meters. Whereas most machine tools in the other departments are of foreign make, all 100 machines here were made in Rumania by the firm Infratirea Oradea. The equipment includes two 10-ton overhead cranes. A special section engages in the production of bearings.
- h. No. 3 department (M-3), precision mechanics shop, includes 30 to 40 machines and one 5-ton overhead crane.
- i. The thermal processing shop occupies a brick building with an area of about 60 by 40 meters.
- j. The forge is in a building of about 30 by 50 by 10 meters and contains:
- 1) Three hydraulic hammers of 500 to 1,000 kilograms.
 - 2) One hydraulic press (more powerful than the above).
 - 3) In 1958 a new hydraulic press, which was brought from East Germany, was installed. It is more powerful than all other machinery in the shop.
 - 4) Two furnaces operating on natural gas.
11. As compared to a total staff of 3,000 in 1938, the plant now employs about 10,000 workers operating in two shifts (from 0700 to 1500 hours and from 1500 to 2300 hours). (One informant reported 6,000 workers were employed at the plant.) Until 1955 the entire enterprise worked in three shifts; since that time this arrangement has been restricted to a few departments. At present the main products are: oil-drilling equipment including rigs, pumps for removal of dirt which operate on the Duplex system and are mounted on 7-ton Tatra trucks, 10- and 20-ton tank cars, and fuel tanks. In addition, the plant produces large quantities of metal constructions for overhead cranes, bridges, industrial buildings and high-tension lines. The plant manufactures oil-drilling equipment only for export (Reportedly, one complete drilling installation was sold to Communist China for one million dollars). The plant does not manufacture guns or other military items at the present time nor does it plan to do so in the near future.

S-E-C-R-E-T

50X1-HUM

S-E-C-R-E-T

50X1-HUM

- 7 -

50X1

12. Following are details on other enterprises in Floesti and vicinity:

a. I.S.A.R. (Intreprindere De Stat Ateliere De Reparatinni), situated 600 to 700 meters southwest of the Gara De Sud in Floesti. Before World War II this plant was called Uzinele Metalurgice and engaged solely in the repair of locomotives working in a single shop building (at present Hall No. 1), approximately 100 meters long and 60 meters wide. At present it repairs oil equipment and motor vehicles. Since 1951 the plant has been expanded considerably by the erection of the following buildings:

- 1) Hall No. 3 - a truck repair shop 80 meters long and 60 meters wide; built of reinforced concrete with a concrete roof.
- 2) Hall No. 2 - similar in structure and area to Hall No. 3, which serves as a machine shop.
- 3) Laboratory
- 4) Transformer station
- 5) Steam plant
- 6) A building housing a casting shop and forge.
- 7) A one-story administration building.

About 1,000 workers, operating in two shifts, are employed at the plant. I.S.A.R. is controlled by the Geological Commission located at 126, Calea Victoriei, Bucharest.

- b. A textile factory for woolen and cotton products which was known before World War II under the name of Dorobantul, is situated in the eastern section of Floesti at the end of Mircea Besarab Street. War damage necessitated reconstruction of the plant. It was expanded by the enlargement of its weaving and spinning departments and by the addition of a new dyeing department, a nursery school and a swimming pool. Most of its 1,000 workers (operating in two shifts), are women.
- c. Ferro Email, a pre-World War II plant subordinate to the Ministry of Building, is located in the eastern section of Floesti, at the end of Mihai Bravu Street. It employs about 1,000 workers in the production of bathtubs, radiators and sanitary installations.
- d. The Ilie Pintilie plant is situated about 12 to 16 kilometers north of Floesti in the Margineanca Forest, in the vicinity of the Floesti-Slanic railway line and the Teleajen River. The plant is subordinate to the Ministry of Metal Industry. It was established during World War II by the Germans for the manufacture of guns and artillery shells. It did not suffer any damage during the war. At present it manufactures artillery shells, small arms ammunition, and agricultural machinery. Since 1948 the plant has been under expansion, mainly by building within its area housing for its 6,000 workers. The workers two shifts (0700 - 1500 hours and 1500 to 2300 hours). Most of them live in the housing projects attached to the plant.
- e. Macazul Factory, located opposite the northern railway station, employs 600 workers in the manufacture of agricultural implements.

S-E-C-R-E-T

50X1-HUM

S-E-C-R-E-T

50X1-HUM

- 8 -

50X1

- f. The "Flacara" factory (formerly "Ferum"), located on Gheorghe Doja Street, and equipped with casting furnaces, manufactures cast iron cooking and heating stoves, industrial furnaces, various sanitation bowls and other consumer goods. It has approximately 500 employees.
- g. The "Ceramica" factory is situated in the northern section of Floesti and manufactures glass, porcelain and ceramic ware. Adjoining this plant there is a plant which produces electric and telephone cables.

Military Objectives in Floesti

- 13. Prior to World War II, all military barracks of Floesti were concentrated in the western part of town, between 23 August and Stefan Gheorghiu Streets. All these were reconstructed and renovated after the war. At the compound of the former Regimental 32 Mircea, two new structures for storage of anti-aircraft guns were erected in 1950, as well as an additional barracks building. Each of the gun sheds is 100 meters long, about 10 meters high and built of reinforced concrete with a tar-papered plank roof.
- 14. Several units are stationed in the old barracks within the town and in the surrounding village. It is uncertain whether or not all Soviet troops have been evacuated from the area, as many Russians wearing civilian clothes have been in town and the population suspects them to be Soviet troops. The following military units were stationed in the barracks along 23 August Street:
 - a. In 1957, a Soviet unit was stationed in the barracks known before the war by the name of "Scoala De Pregatire De Ofiteri."
 - b. Rumanian supply unit No. 3245 is stationed in the barracks formerly known as "Regimental 19 Artilerie."
 - c. In 1957, a Soviet supply unit was stationed in barracks on 23 August Street, past the "Regimental 19 Artilerie" barracks.
- 15. Rumanian units are reported to be stationed in the following locations outside of Floesti:
 - a. In newly constructed barracks (1953-54), located northeast of town near the Floesti-Buzau road, between two to ten kilometers from Bucov village. Field and artillery units have been seen in these barracks. The barracks are one-story buildings with red tile roofs.
 - b. In a concentration of barracks four to five kilometers from the south-eastern edge of Floesti, near the Floesti-Slobozia road. These barracks were constructed during the period, 1950-1952. The barracks, one-story buildings with red tile roofs, are located about two kilometers southeast of the Teleajen pumping station. They can be clearly seen from trains on the Floesti-Buzau line.
 - c. Other units are stationed in the village of Paulesti on the road to Slanic at a distance of 14 kilometers from Floesti. This is also the site of a large World War II military hospital which has been expanded in recent years.

S-E-C-R-E-T

50X1-HUM

S-E-C-R-E-T

50X1-HUM

- 9 -

50X1

16. A military airfield and flying school are located in the southwestern part of Ploesti, on the road to Strejnic. Air force officers and troops in air force uniforms are often seen in town. Training aircraft are frequently observed passing over the town and sometimes jet aircraft are also seen. Civilian aircraft do not land at the field.

Municipal Services

17. The building of a new central post office was started in 1949 and completed in 1958 at 2 or 4, Bulevardul Independentei. The building is three stories high, 60 meters wide (front) and 85 meters long, built of bricks on a reinforced concrete frame and with a concrete roof 10 cm. thick covered with metal sheeting. It serves as the central post and telegraph office. The ground floor is reserved for the public while the other three floors (with a total of 40 large rooms) houses the telegraph and other offices. The former building of the central post office, an old one-story structure on Cogalniceanu (formerly Franceza) Street, now serves as a branch post office.
18. The automatic telephone exchange is situated in its pre-World War II location on Krupskaya Street (formerly Puskin Street, behind the Palace of Culture). The building is two stories and is 50 meters long and 30 meters wide. It is a brick structure on a reinforced concrete frame with a metal roof. The exchange was made automatic before the war. There are approximately 3,000 subscribers; the telephone numbers consist of four digits. The exchange has not been enlarged since the war and no new extensions can be added.
19. The thermal power station is located on the left-hand side of Mihai Bravu Street coming from the town center, nor far from the Militia offices. The station produces alternating current. Electrical installations in the town were adapted to alternating current in 1956.
20. The medical facilities of Ploesti include the following:
- a. Hospital No. 1, located on Postei Street; it was greatly enlarged in 1958.
 - b. Hospital No. 2, located on Rudului Street; it has also been enlarged since World War II.
 - c. The former "Boldescu" Hospital, located on Vasile Roaita Street (present name unknown).
 - d. The railway employees' hospital, located near the southern railway station.
 - e. The maternity hospital is located on Buna Vestire Street. A first story was added to this former ground floor building in 1957.
 - f. The children's hospital (the former "Spitalul Preminger"), is located on Transilvaniei Street. It has been enlarged with the addition of a new wing.
 - g. Military hospital, located on Rudului Street opposite Hospital No. 2. It is a small hospital which includes a dispensary. A two-story building, it housed a private hospital before World War II.

S-E-C-R-E-T

50X1-HUM

S-E-C-R-E-T

50X1-HUM

- 10 -

50X1

21. The following changes have been made in the names of streets in Ploesti:

<u>New Name</u>	<u>Former Name</u>	
Piata Stalin	Piata Florilor	
I.C. Frimu Street	Regala Street	
Transilvaniei Street	Predinger Street	
23 August Street	Cantacuzino Street	
Zhdanov Street	C.A. Rosetti Street	
Republicei Street	Regele Ferdinand Street	
Gheorghe Doja Street	General Dragalina (Oilor) Street	
Vasile Roaita (or Grivita Rosie Street)	Romana Street	
Calea Campinei	Bulevardul Regele Ferdinand	
Kirov Street	Calea Valeni	
I. L. Cargiale Street	Gloriei Street	
Stefan Gheorghiu Street	Regele Carol II Targsor Street	
Petre Gheorghe Street	Barbudel Varancea Street	
Lupeni Street	Banu Manta Street	
Karl Marx Street	Bunavestire and later Gheorghe Constantinescu Street	
Vladimir Malacovski Street	Stefan Apostol Street	50X1-HUM

- 23.

Sketches of individual plants in Ploesti are attached as a part of this report.

S-E-C-R-E-T

50X1-HUM

S-E-C-R-E-T

50X1-HUM

- 11 -

50X1

24. The following is the legend to sketch map showing the location of No. 2 Refinery:

- 1 - Kirov Street (formerly Calea Valeni) leading from the town to the refinery.
- 2 - Residential buildings
- 3 - Grivita Rosie (formerly Romana) Street.
- 4 - Macazul rolling stock components factory.
- 5 - Flour mill, granary and bakery (trust of Ploesti municipality).
- 6 - Gara De Nord (northern railway station)
- 7 - New factory for chemical products (shoe polish, etc.) of Ploesti municipality.
- 8 - Railway line in the direction of Targoviste.
- 9 - New rolling stock repair plant (Atelierele C.F.R. Triaj Nord).
- 10 - Railway line in the direction of Valeni De Munte (Note: After World War II this line was moved about 1 kilometer from the highway and now passes west of it).
- 11 - Ploesti - Valeni De Munte road
- 12 - Gravel road to the Tintareni village.
- 13 - Tintareni village.
- 14 - Section of the S6s De Centura - a new asphalt road constructed after World War II (which circles the whole of Ploesti).
- 15 - Teleajen stream
- 16 - Area of No. 2 Refinery
- 17 - Main entrance to refinery

S-E-C-R-E-T

50X1-HUM

S-E-C-R-E-T

50X1-HUM

Sketch A
Location of No. 2 Refinery

- 12 -

50X1

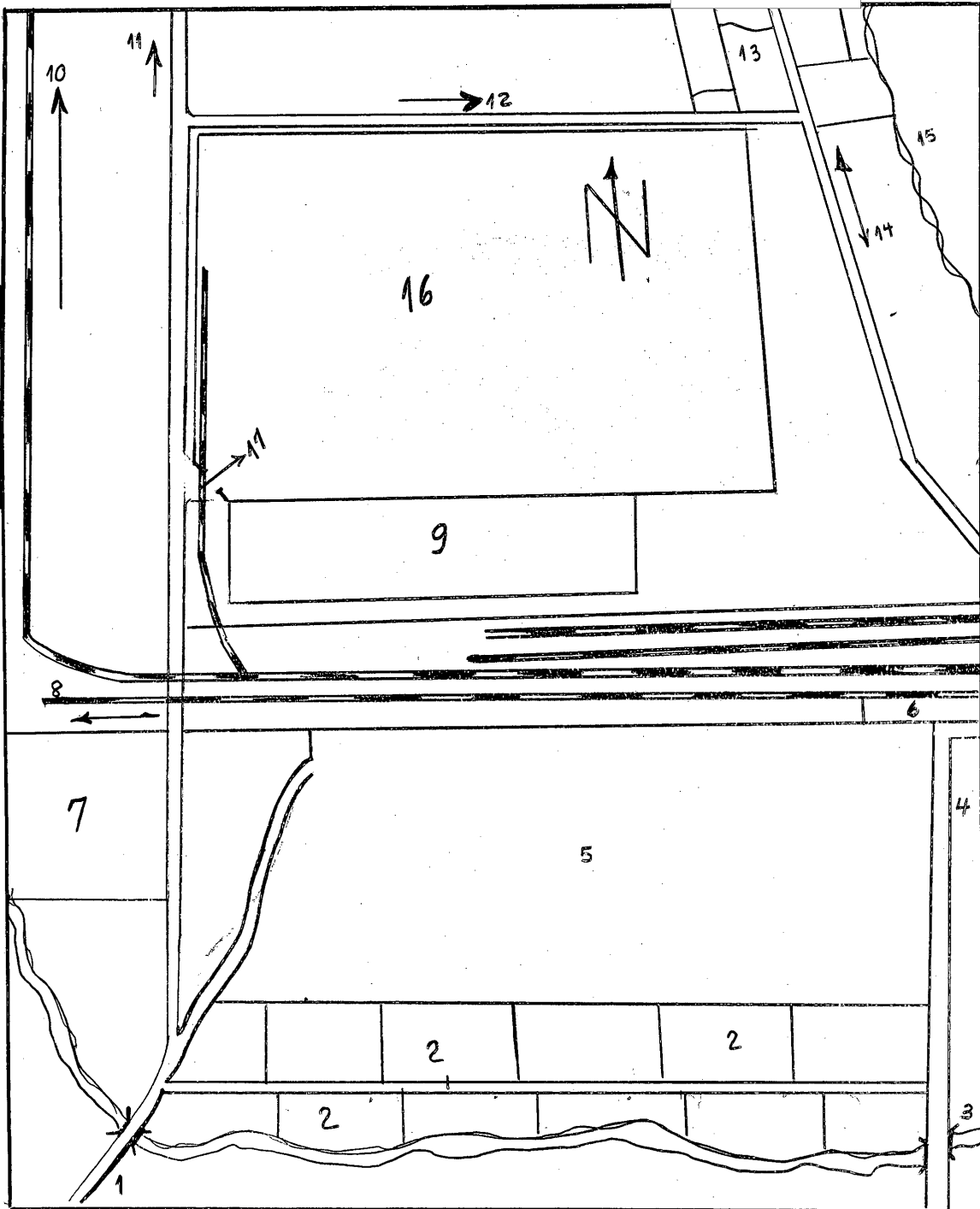

S-E-C-R-E-T

50X1-HUM

S E C R E T



50X1-HUM

- 13 -



50X1

25. The following is the legend to sketch map showing the layout of No. 3 Refinery:

- 1 - Direction of Ploesti Sud railway station
- 2 - Central fuel stores and installations for pumping fuel to Constanta (Statie De Pompare Teleajen)
- 3 - Direction of military barracks built in 1948 and AAA emplacements situated about 2 kilometers from the Ploesti - Buzau railway line.
- 4 - Direction to Buzau and the USSR
- 5 - Direction of the Berceni tar paper factory
- 6 - Fereo Email factory
- 7 - Oxygen factory on the site of the former Dacia Romana Refinery
- 8 - Direction of Gara De Nord
- 9 - Section of the Soseaua De Centura - new road circling Ploesti.
- 10 - Expansion area of No. 3 Refinery
- 11 - Teleajen stream
- 12 - Ploesti - Berceni gravel road
- 13 - Entrance gates to the refinery
- 14 - Housing of refinery workers
- 15 - Football grounds
- 16 - Restaurant - theater
- 17 - Administration building of the refinery
- 18 - Machine shops
- 19 - Laboratories
- 20 - Loading site
- 21 -) Fuel tanks
- 22 -)
- 23 - Special railway line for transportation of refinery workers.
- 24 - Bereasca Stream.

S E C R E T



50X1-HUM

S-E-C-R-E-T

50X1-HUM

Sketch B
Layout of No. 3 Refinery

- 14 -

50X1

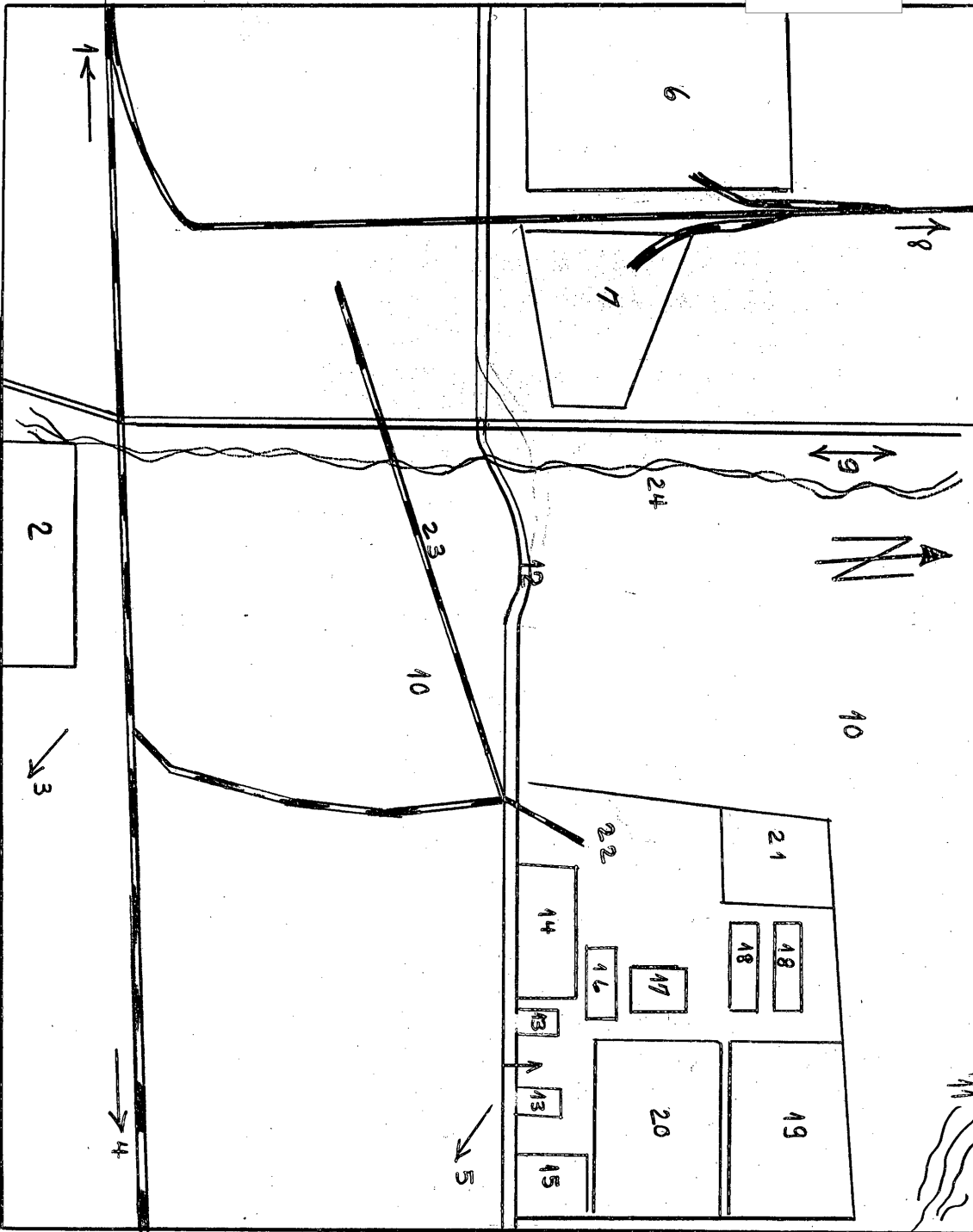

S-E-C-R-E-T

50X1-HUM

S-E-C-R-E-T

50X1-HUM

- 15 -

50X1

26. The following is the legend to sketch map showing the layout of No. 5 Refinery:

- 1 - Gara De Sud
- 2 - Warehouses of the above railway station
- 3 - Part of No. 1 Refinery
- 4 - Concrete bridge in Democratiei (formerly Regina Maria) Street.
- 5 - Part of Uzinele 1 Mai
- 6 - Barcanesti Street
- 7 - Democratiei road
- 8 - Direction of Bucharest
- 9 - Sticlaria Arahova (glassware factory)
- 10 - Cooperative glassware factory
- 11 - Cimitirul Eternitatea (cemetery)
- 12 - Oil equipment repair plant (Uzina De Reparatie) on the site of the former Unirea Refinery.
- 13 - Gravel path in the direction of Ghighiu village (Drumul Rafon)
- 14 - Residential quarter (Cartier Motoi)
- 15 - Lupeni (formerly Banu Manta) Street
- 16 - Karl Marx (formerly Buna Vestirea) Street
- 17 - Main entrance to the refinery
- 18 - Dispensary and offices
- 19 - Laboratories
- 20 - Warehouses (?)
- 21 - Steam plant
- 22 - Refinery installations
- 23 - Fuel tank

S-E-C-R-E-T

50X1-HUM

Sketch C
Layout of No. 5 Refinery

S-E-C-R-E-T

50X1-HUM

50X1

- 16 -

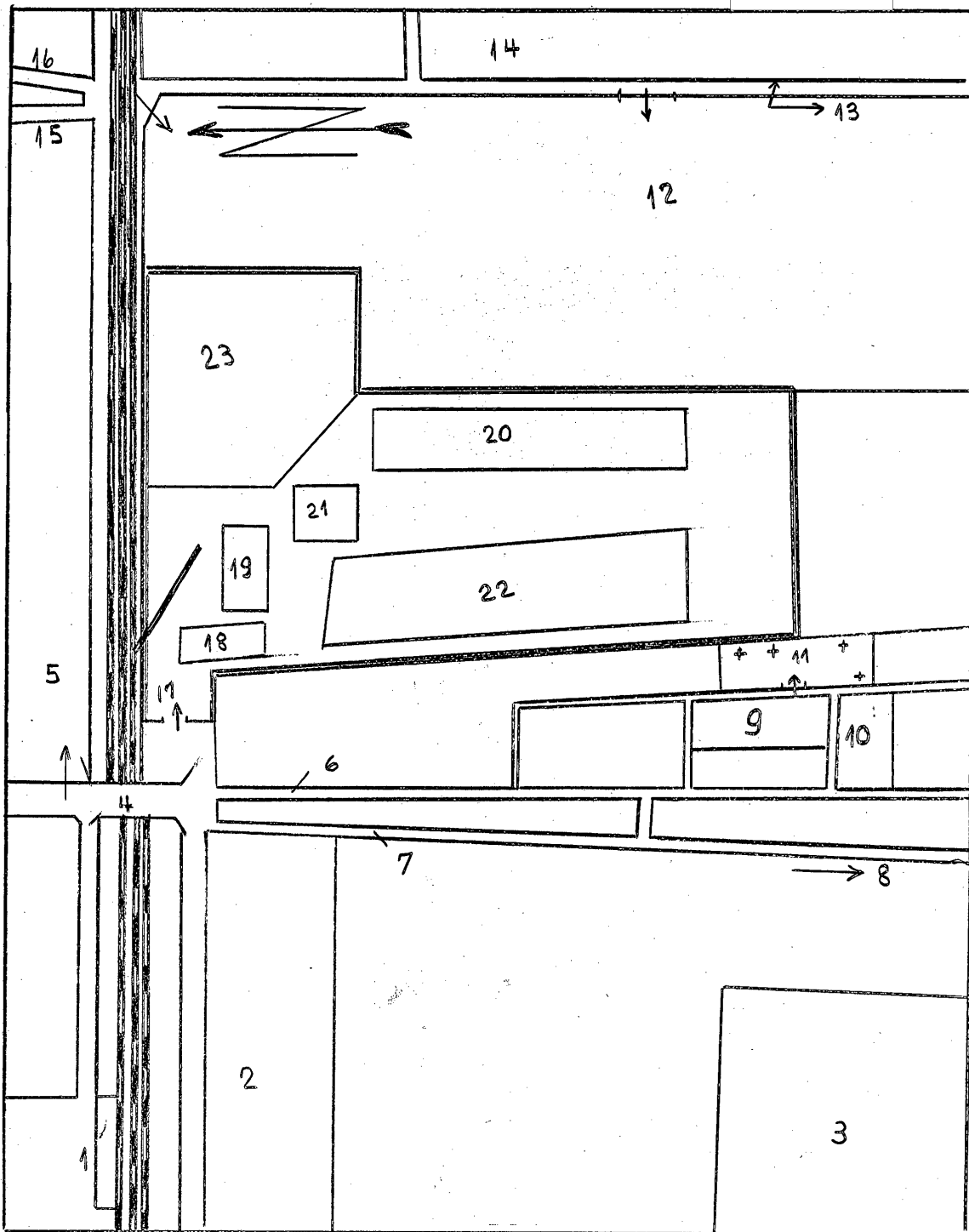

S-E-C-R-E-T

50X1-HUM

S-E-C-R-E-T

50X1-HUM

- 17 -

50X1

27. The following is the legend to sketch map showing the layout of No. 6 Refinery:

- 1 - Direction of the Ploesti-Sud railway station.
- 2 - Depoului Street.
- 3 - Petre Gheorghe (formerly Barbu Delavrancea) Street.
- 4 - Part of No. 7 Refinery.
- 5 - Fabrica De Cruzotat (Chemical processing of railway sleepers and wooden poles).
- 6 - Gara De Vest (railway station)
- 7 - Stajia De Pompare Ploesti-Vest (pumping station)
- 8 - Locomotive depot.
- 9 - Direction of railway line to Brasou.
- 10 - Part of No. 1 Refinery.
- 11 - Bd. Petrolului (formerly Bd. Cratulescu)
- 12 - Warehouses for oil drilling equipment of I.S.E.M. (Intreprindere De Stat Pentru Exploatare Minere).
- 13 - Rolling stock repairshops (Atelierele C.F.R. Ploesti-Sud)
- 14 -)
15 -) } Freight stations.
- 16 - Marshalling yards (the largest in Rumania)
- 17 - Mimiu gypsy quarter.
- 18 - Ploesti-Triaj station
- 19 - Direction of military airfield Aeroportul Strejnic (about 5 kilometers distance)
- 20 - AAA emplacement.
- 21 - Section of the Sos De Centura (road)
- 22 - No. 6 Refinery.
- 23 - New plastics factory (Petrochim Brazi).

S-E-C-R-E-T

50X1-HUM

~~S-E-C-R-E-T~~

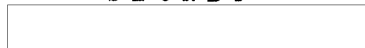

50X1-HUM

- 18 -

50X1



- 24 - Local railway line (new).
- 25 - Triajul Brazi.
- 26 - Railway station in Brazi.
- 27 - Direction of Bucuresti.

~~S-E-C-R-E-T~~



50X1-HUM

30-11-57



Sketch D
Layout of No. 6 Refinery

S-E-C-R-E-T

50X1-HUM

- 19 -

50X1

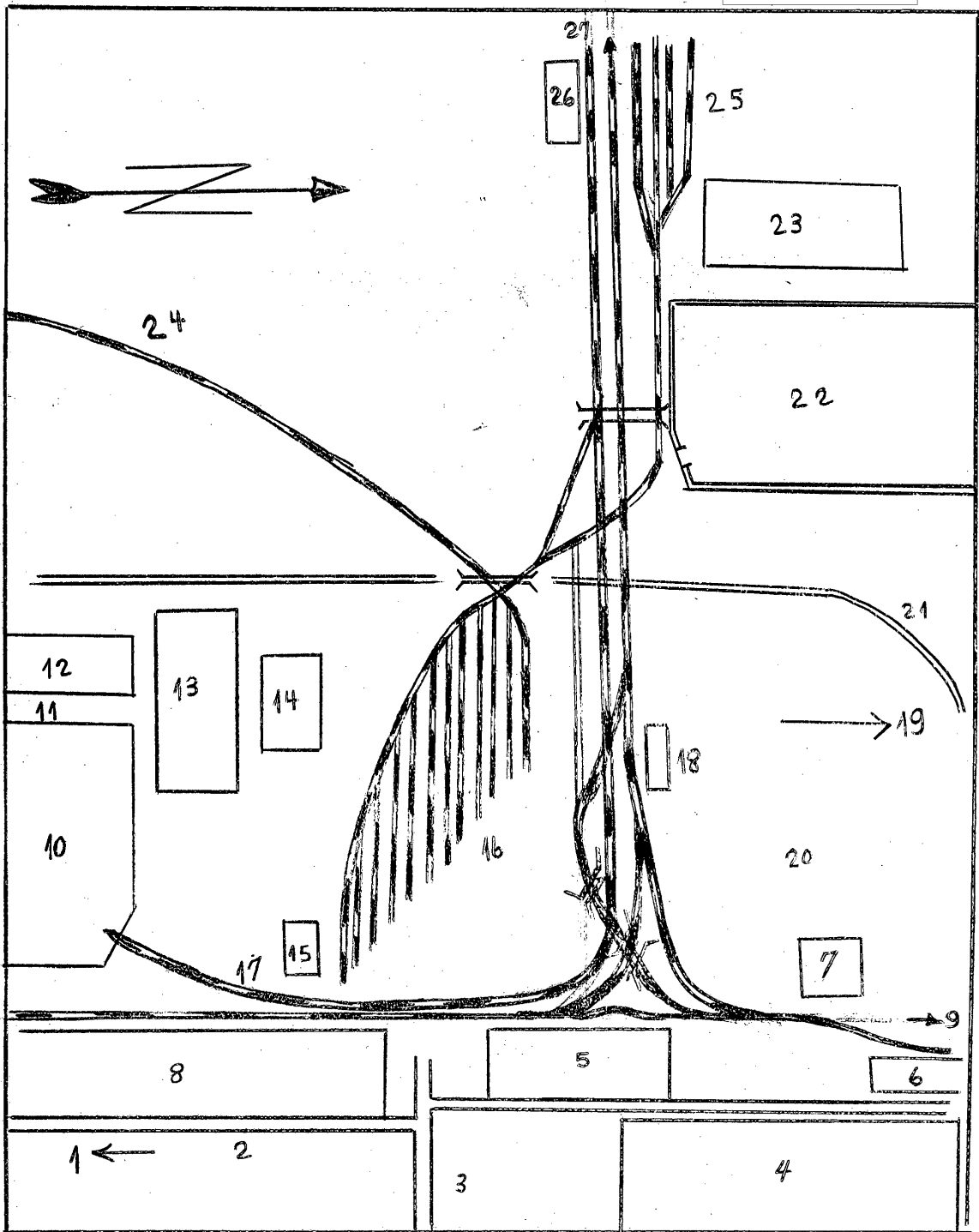

S-E-C-R-E-T

50X1-HUM

S-E-C-R-E-T

50X1-HUM

- 20 -

50X1

28. The following is the legend to sketch map showing the location of Uzinele 1 Mai:

- 1 - Bd. Independentei
- 2 - Eminescu Street
- 3 - New housing project for No. 6 Refinery workers.
- 4 - Veronica Micle Street.
- 5 - Piata Gari De Sud
- 6 - Gara De Sud
- 7 - Str. Garii (the road was considerably enlarged during World War II).
- 8 - Morilor Street
- 9 - Concrete bridge
- 10 - Democratiei Street
- 11 - Uzinele 1 Mai
- 12 - No. 5 Refinery
- 13 - Road to Bucharest
- 14 - Barcanesti Street
- 15 - Oil equipment repair plant on the site of the former Unirea Refinery
- 16 - Residential quarter Cartierul Motoi
- 17 - Railway line in the direction of Buzau
- 18 - Karl Marx Street.
- 19 - Lupeni Street
- 20 - AAA emplacements in a vegetable garden.
- 21 - Lapusneanu Voda Street.
- 22 - Muzicantilor Street
- 23 - Jianu Street
- 24 - Residential buildings
- 25 - Garage of No. 138 Building Company.

S-E-C-R-E-T

50X1-HUM

Sketch E
Location of Uzinele
I Mai

S-E-C-R-E-T

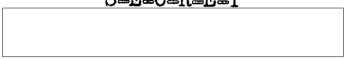

50X1-HUM

50X1

- 21 -

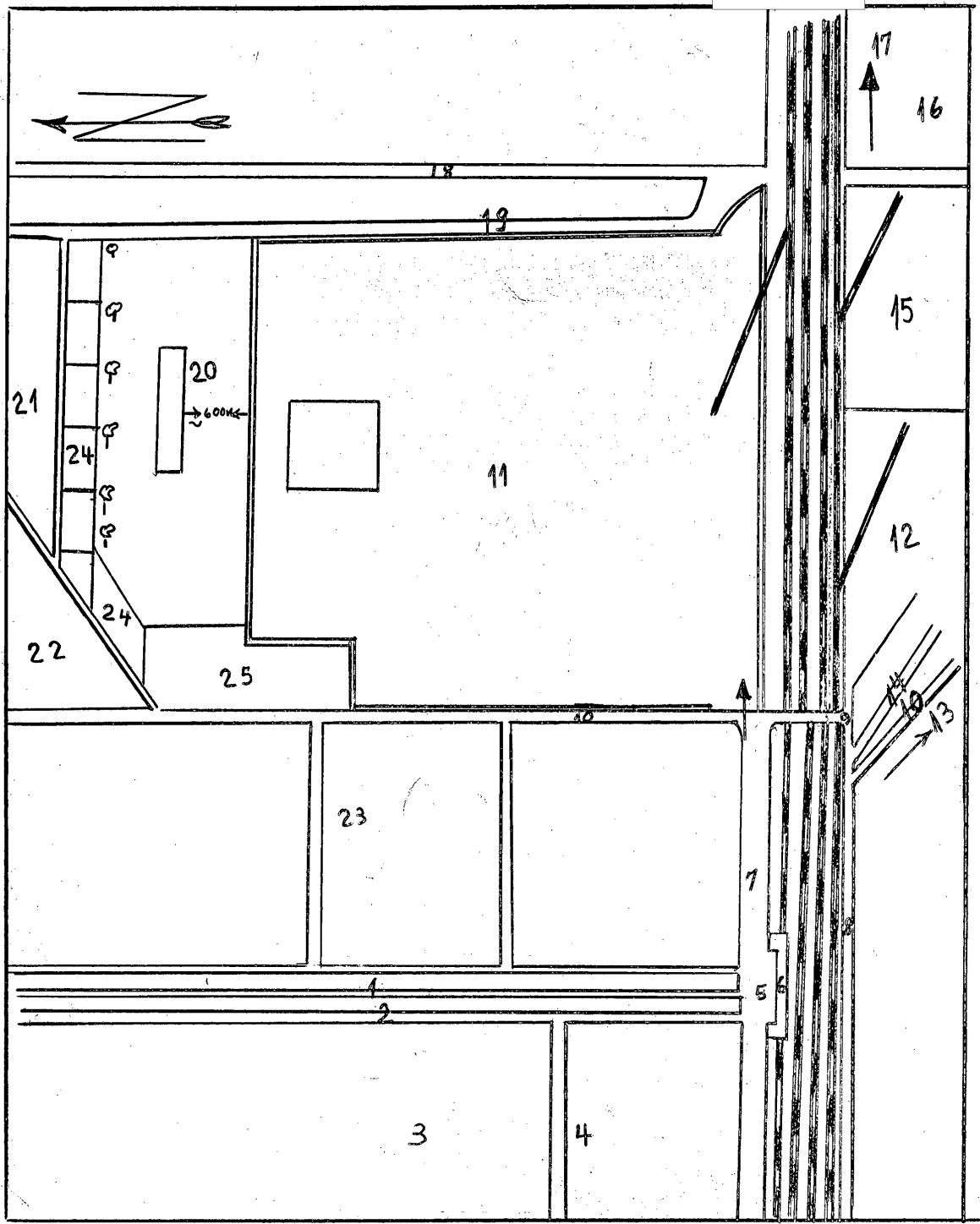

S-E-C-R-E-T

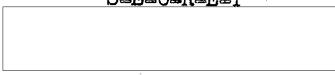

50X1-HUM

S-E-C-R-E-T

50X1-HUM

- 22 -

50X1

29. The following is the legend to sketch map showing the buildings and installations of Uzinele 1 Mai.
- 1 - Democratiei Street.
 - 2 - No. 1 entrance to the plant (pedestrians and vehicles) opposite an internal main thoroughfare.
 - 3 - No. 2 entrance (only for vehicles with raw materials)
 - 4 - Entry permits office
 - 5 - Gatekeeper's lodge
 - 6 - No. 1 transformer station (the plant receives current from a hydro-electric station at Dobresti).
 - 7 - Station for regulation of natural gas supply
 - 8 - Hala M-1 (machine shop and assembly
 - 8a - Hala M-1 (machine shop)
 - 9 - Iron casting shop
 - 10 - Open-air steel storage lot with 20-ton overhead crane
 - 11 - Forge
 - 12 - Steam plant
 - 13 - Warehouses for materials and offices
 - 14 - Warehouses for materials.
 - 15 - Air raid shelter for about 600 plant workers (area: 50 by 50 by 3 meters, with air conditioning, covered by a 2 meter layer of earth).
 - 16 - Precision casting shop (Turnatoria De Precizie)
 - 17 - Steel casting shop
 - 18 - Furnace for drying of moulds
 - 19 - Electric furnaces
 - 20 - Bunker for molding sand.
 - 21 - Acetylene station

S-E-C-R-E-T

50X1-HUM

S-E-C-R-E-T

50X1-HUM

- 23 -

50X1

- 22 - Scrap iron stroes (open air)
- 23 - Water tower
- 24 - Civil defense command post (Post De Comanda) - 8 meters underground, mazimum capacity of 20 persons, with three entrances, air condition, kitchen, foodstuff stores, etc).
- 25 - Pattern maker's shop (Modelerie)
- 26 - Technical bureau
- 27 - Cleaning shop for castings (Curatitoria) with 5-ton (?) overhead crane
- 28 - Hala M-2 (machine shop)
- 29 - Administration offices
- 30 - No. 2 transformer station
- 31 - No. 3 transformer station
- 32 - Hala M-4 (machine shop)
- 33 - Thermal processing shop
- 34 - Precision mechanics shop (Hala M-3)
- 35 - Plant management offices
- 36 - Chief mechanic's department
- 37 - Testing area of the oil equipment produced by the plant
- 38 - Compressor station
- 39 - Air raid shelter for plant workers (similar to that in No. 15)
- 40 - Department for manufacture of tank cars and fuel tanks (Cazangeria)
- 41 - Metal constructions shop
- 42 - No. 3 entrance
- 43 - Garage and vehicle repairshop
- 44 - Hospital and dispensary
- 45 - No. 4 entrance
- 46 - Bath
- 47 - Restaurant - theater
- 48 - Lupeni Street

S-E-C-R-E-T

50X1-HUM

Sketch F
Buildings and Installations
of Uzinele 1 Mai

S-E-C-R-E-T

50X1-HUM

- 24 -

50X1

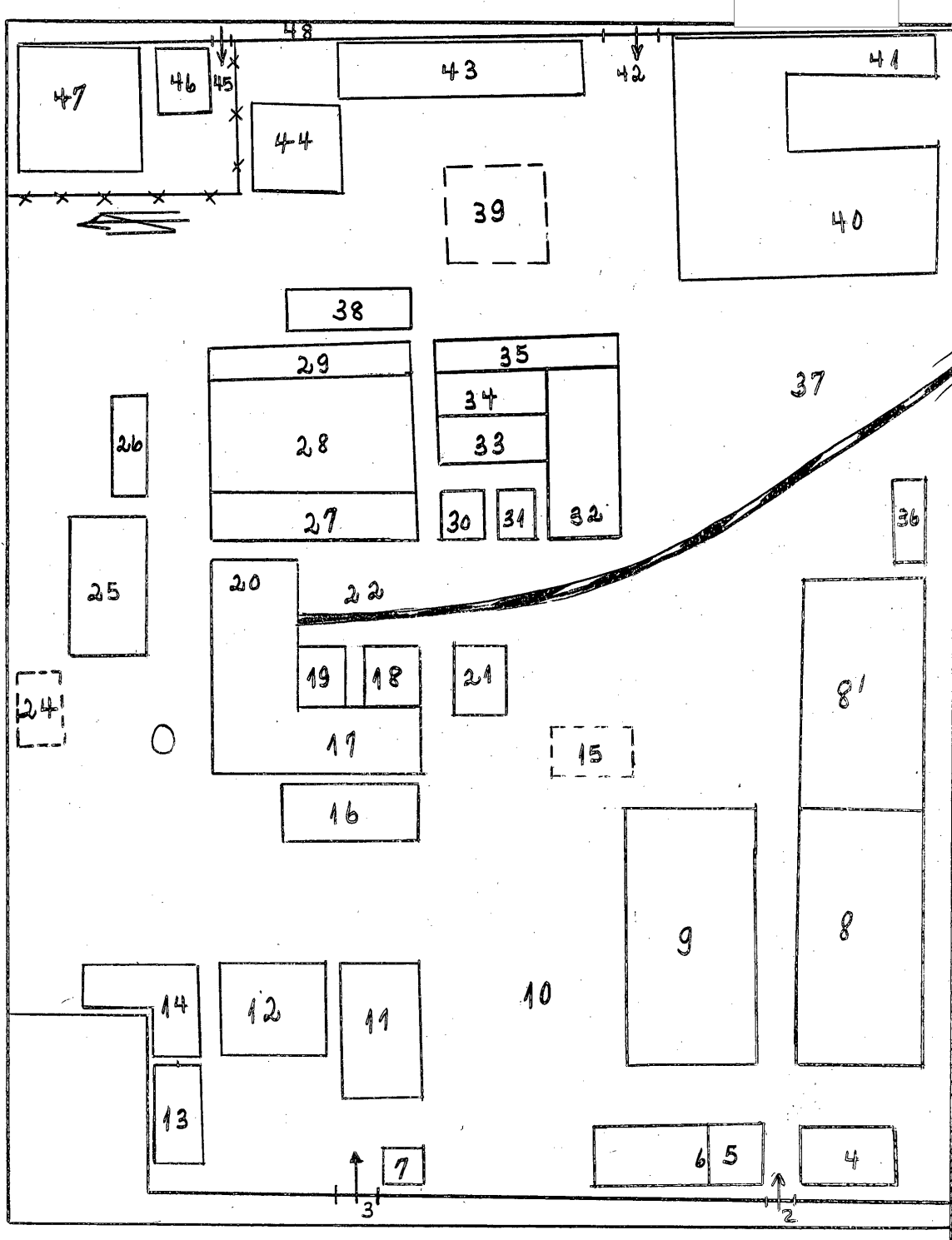

S-E-C-R-E-T

50X1-HUM

S E C R E T

50X1-HUM

- 25 -

50X1

30. The following is the legend to sketch map showing the location of the I.S.A.R. oil equipment repair plant:

- 1 - Direction of Gara De Sud
- 2 - Depoului Street
- 3 - Zhdanov (formerly C.A. Rosetti) Street
- 4 - Veronica Micle Street
- 5 - Residential buildings of No. 6 Refinery workers
- 6 - Marin Brutaru Street
- 7 - Military engineers unit
- 8 - Restaurant and hostel of I.S.A.R. workers
- 9 - Morilor Street
- 10 - I.S.A.R.
- 11 - Nicolae Christea (formerly Miron Costin) Street
- 12 - Direction of anti-aircraft gun positions, in a vegetable garden, about 500 meters from the plant.
- 13 - Engine depot
- 14 - Direction of Bucharest
- 15 - Direction of Brasov
- 16 - Stindardului Street
- 17 - Petre Gheorghe Street

S-E-C-R-E-T

50X1-HUM

Sketch G
Location of the I.S.A.R. Oil
Equipment Repair Plant

S-E-C-R-E-T

50X1-HUM

- 26 -

50X1

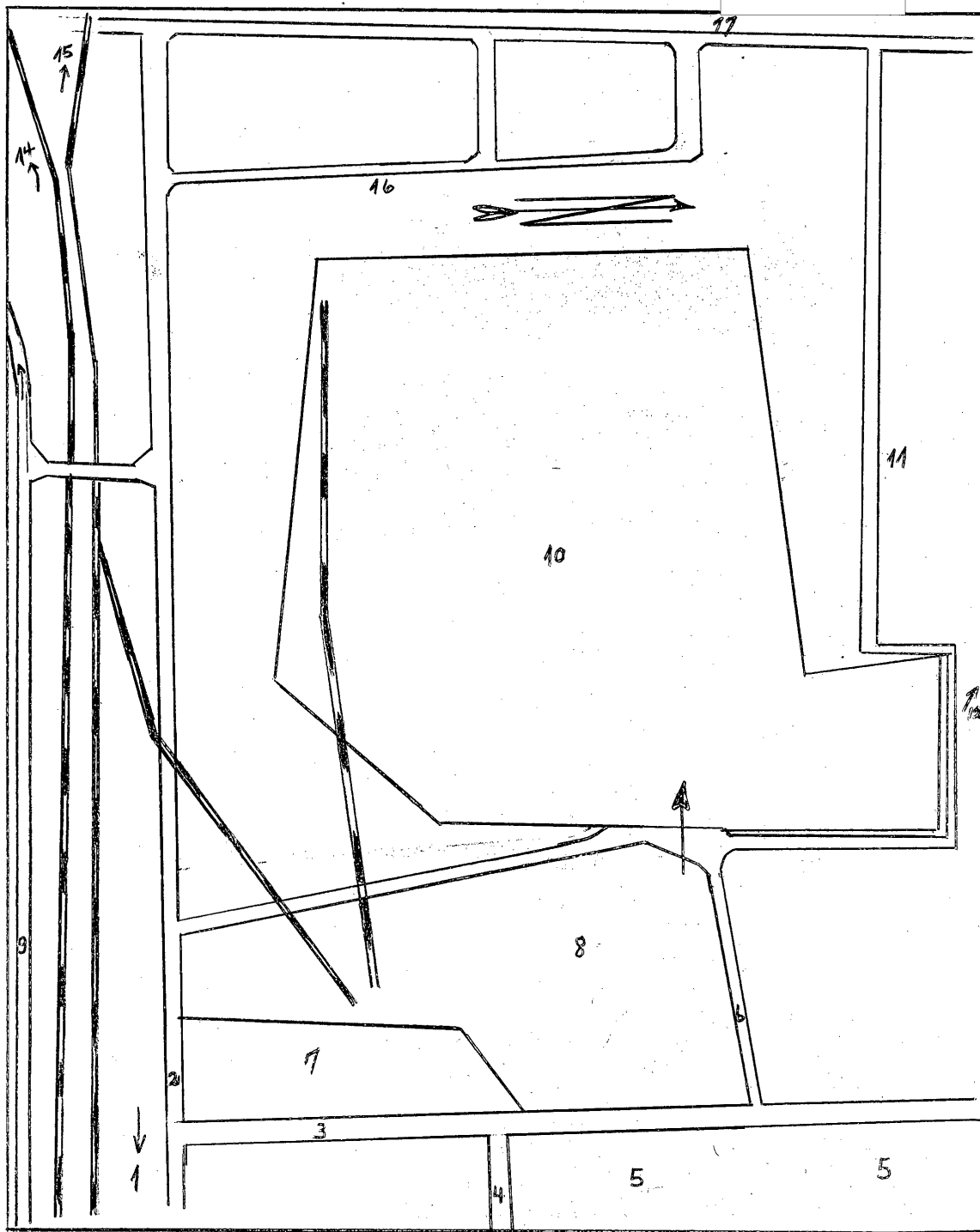

S-E-C-R-E-T

50X1-HUM

S-E-C-R-E-T

50X1-HUM

- 27 -

50X1

31. The following is the legend to sketch map showing the layout of I.S.A.R.:

- 1 - Gatekeeper's lodge
- 2 - Management and administration offices
- 3 -)
- 4 -) } Open-air raw materials' stores
- 5 - Store offices
- 6 - Dispensary
- 7 - Hala-1 (machine shop)
- 8 - Offices
- 9 - Hala-2 (machine shop)
- 10 - Hala-3 (vehicle repairshop)
- 11 - Laboratory
- 12 - Transformer station
- 13 - Steam plant
- 14 - 30 meters high chimney (from prefabricaters)
- 15 - Natural gas supply regulating station
- 16 - Forge
- 17 - Welding shop
- 18 - Casting shop
- 19 - Showers and lavatories
- 20 - Open-air steel store

S-E-C-R-E-T

50X1-HUM

S-E-C-R-E-T

50X1-HUM

Sketch H
Layout of I.S.A.R.

- 28 -

50X1

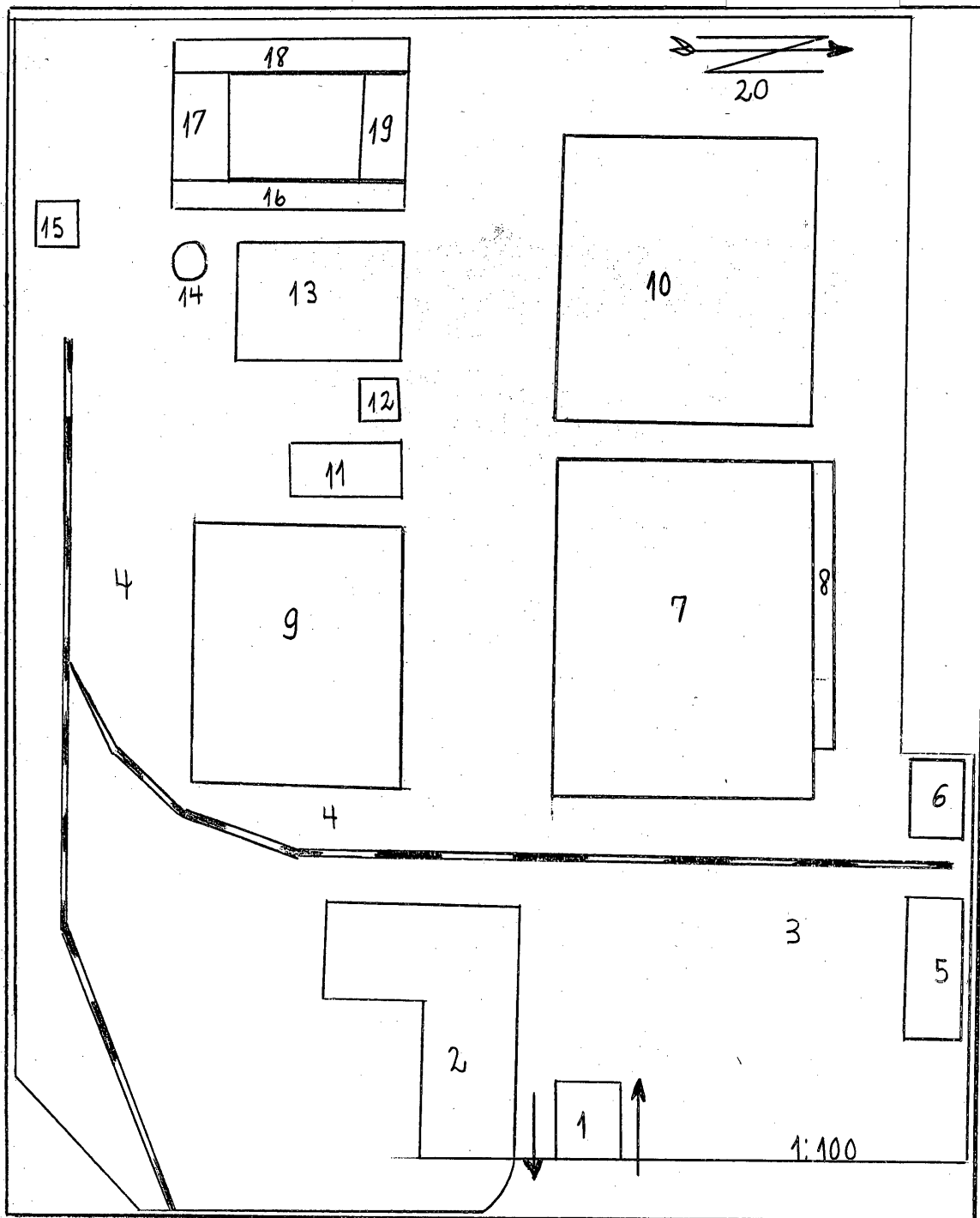

S-E-C-R-E-T

50X1-HUM

S-E-C-R-E-T

50X1-HUM

- 29 -

50X1

32. The following is the legend to sketch map of the Ilie Pintilie Plant in Margineanca:

- 1 - Gageni railway station
- 2 - Residential buildings of Gageni village
- 3 - Gravel road Ploesti - Gageni
- 4 - Direction of Cinteabaiciu (oil areas)
- 5 - Ploesti-Slanic railway line
- 6 - Hospital and dispensary of the plant
- 7 - Football field
- 8 - Workers' housing project
- 9 - Fabrica No. (agricultural machinery)
- 10 - Workers' housing
- 11 - Plant management offices
- 12 - Workers' housing project
- 13 - Marketplace
- 14 - Fabrica No. 2 (ammunition)
- 15 - Firing range
- 16 - Railway branch
- 17 - Plopeni railway station
- 18 - Teleajen Stream
- 19 - Direction of Punctul Recea (source of water supply for the entire plant)
- 20 - Slanic stream
- 21 - Stream (name unknown)
- 22 - Gavanele railway station
- 23 - Railway branch
- 24 - Underground ammunition stores and buildings above ground, surrounded by two-three rows of barbed wire.
- 25 - Margineanca railway station

S-E-C-R-E-T

50X1-HUM

S-E-C-R-E-T

50X1-HUM

Sketch I
The Pintilie Plant in
Margineanca

- 30 -

50X1

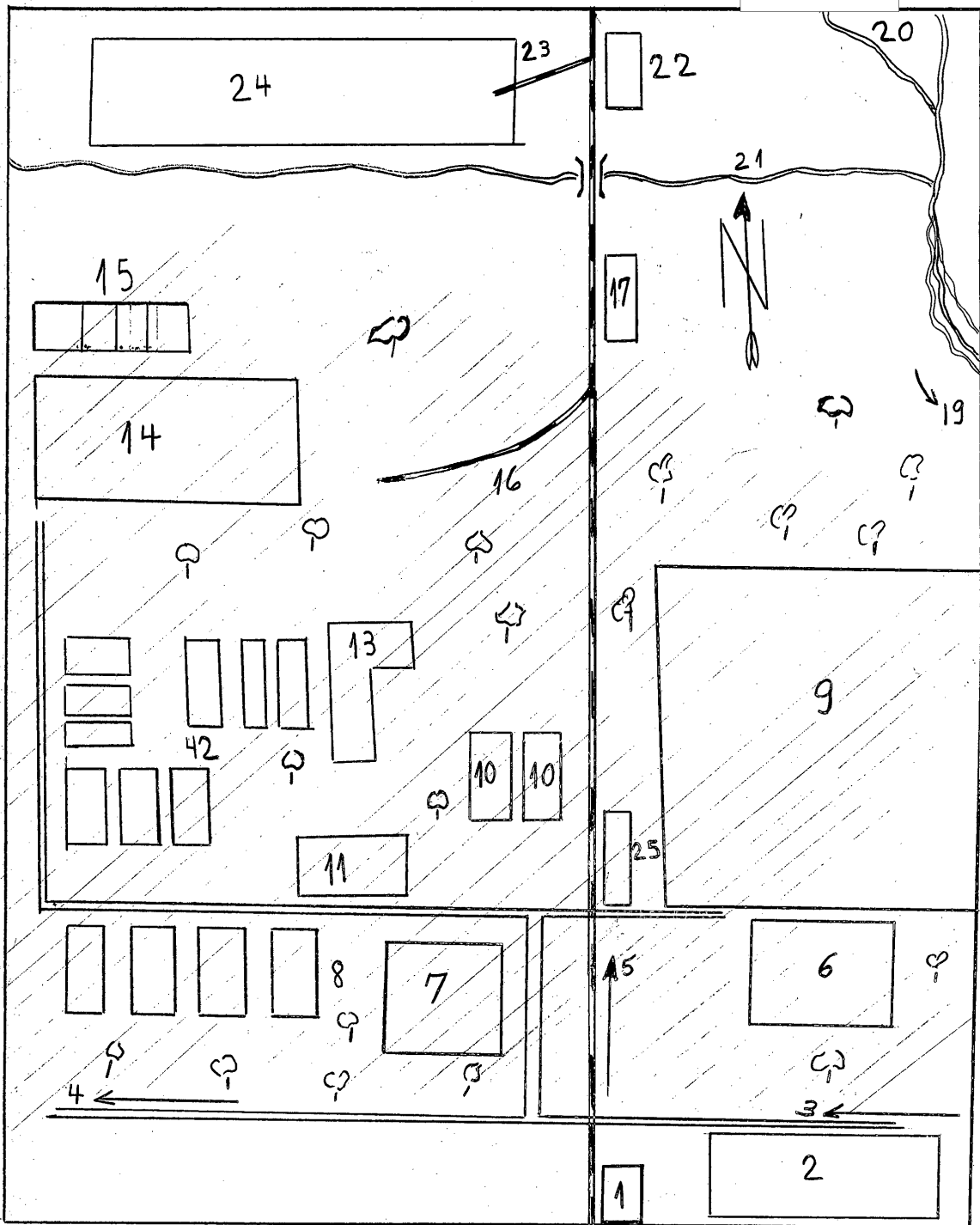

S-E-C-R-E-T

50X1-HUM

S-E-C-R-E-T

50X1-HUM

-31-

50X1

33. The following is the legend to sketch map showing the military barracks in 23 August Street - Ploesti:

- 1 - Stefan Gheorghiu Street
- 2 - Tudor Vladimirescu Street
- 3 - 23 August (formerly Cantacuzino) Street
- 4 - Domnisorii Street
- 5 - Gara De Vest
- 6 - Direction of Brasov
- 7 - Direction of Targoviste
- 8 - Direction of military airfields at Strejnic and Targoviste.
- 9 - Road to Targoviste
- 10 - Eroilor Street
- 11 - Prahova oxygen factory
- 12 - Residential buildings
- 13 - Former school for infantry officers, occupied by the Soviets until 1958 (present occupancy unknown)
- 14 - Infantry unit (no details available)
- 15 - Two-story building, housing administration offices of a military unit commanded by a colonel.
- 16 - Canteen in groundfloor building
- 17 - One-story barracks
- 18 - Stores
- 19 - Administration building of an AAA unit commanded by a colonel
- 20 - Canteen
- 21 - Stores
- 22 - Barracks
- 23 - Two sheds for AA guns
- 24 - Training grounds

S-E-C-R-E-T

50X1-HUM

S-E-C-R-E-T

50X1-HUM

-32-

50X1

- 25 - Field-artillery unit
- 26 - Cavalry unit
- 27 - Large fruit warehouse of the Fruct Export agency
- 28 - Direction of Cartierul Eroilor, a residential quarter of Party functionaries workers

S-E-C-R-E-T

50X1

S-E-C-R-E-T

50X1-HUM

- 33 -

50X1

Sketch J
Military Barracks in
23 August Street - Ploesti

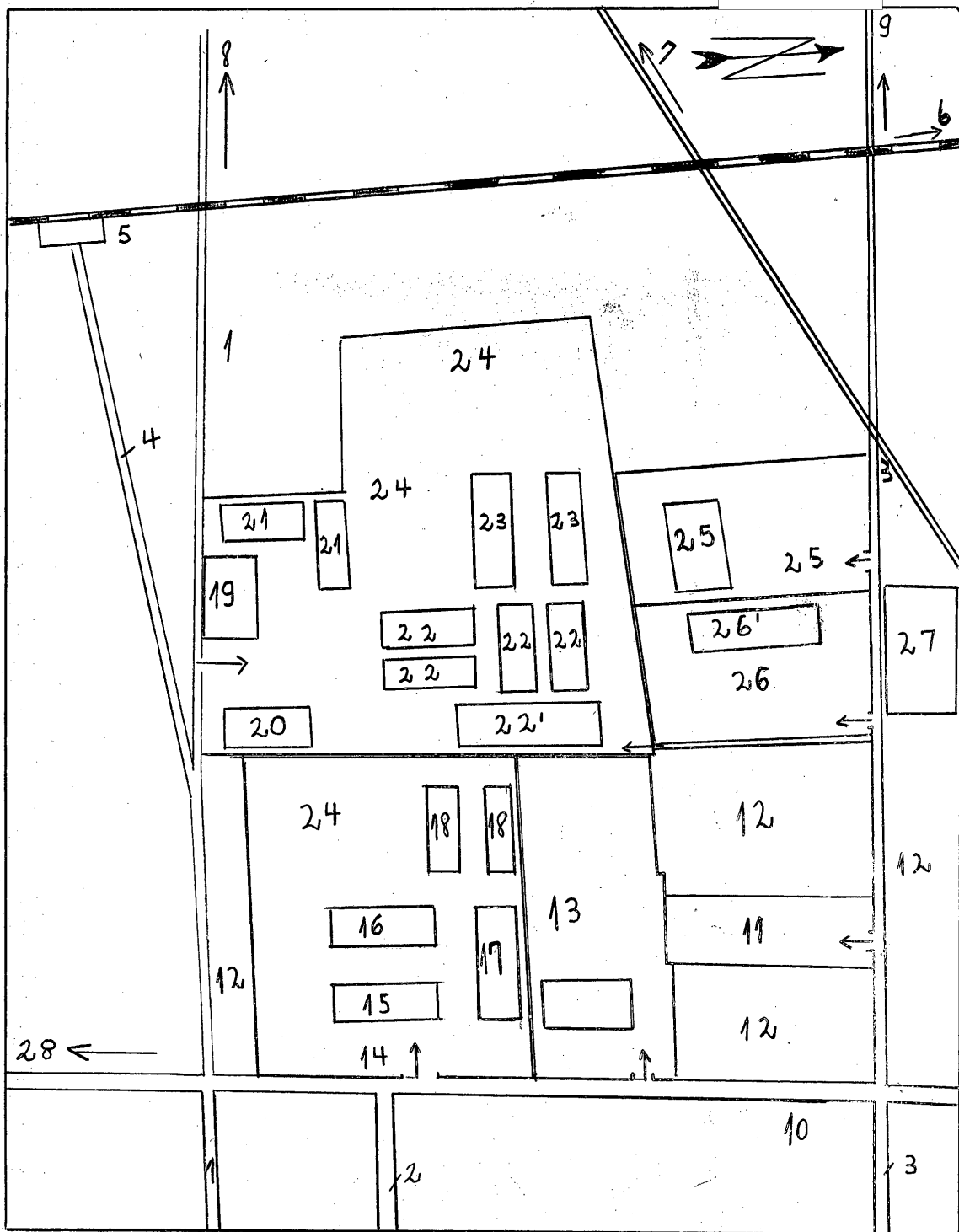

S-E-C-R-E-T

50X1-HUM

S-E-C-R-E-T

50X1-HUM

- 34 -

50X1

34. The following is the legend to sketch map showing the location of the Provincial Securitate offices in Ploesti:

- 1 - Vasile Lupu Street
- 2 - Elena Doamna Street
- 3 - Residential buildings
- 4 - Traian Street
- 5 - Vehicle entrance
- 6 - Entrance for officials
- 7 - One-story building serving as barracks of the guard and services corps.
- 8 - Two-story building - the basement contains about 80 detention cells and interrogation rooms, while the ground and first floors house the offices.
- 8I - Yard
- 8II - Vehicle entrance
- 9 - Groundfloor building: the basement contains detention cells and the groundfloor offices.
- 10 - One-story building containing kitchen and canteen
- 11 - Sports grounds
- 12 - Garage
- 13 - Hall for fire arms' practice
- 14 - One-story building serving as barracks for the guard and auxiliary services.

S-E-C-R-E-T

50X1-HUM

S-E-C-R-E-T

50X1-HUM

Sketch K
Location of Provincial
Securitate Offices in Floesti

- 35 -

50X1

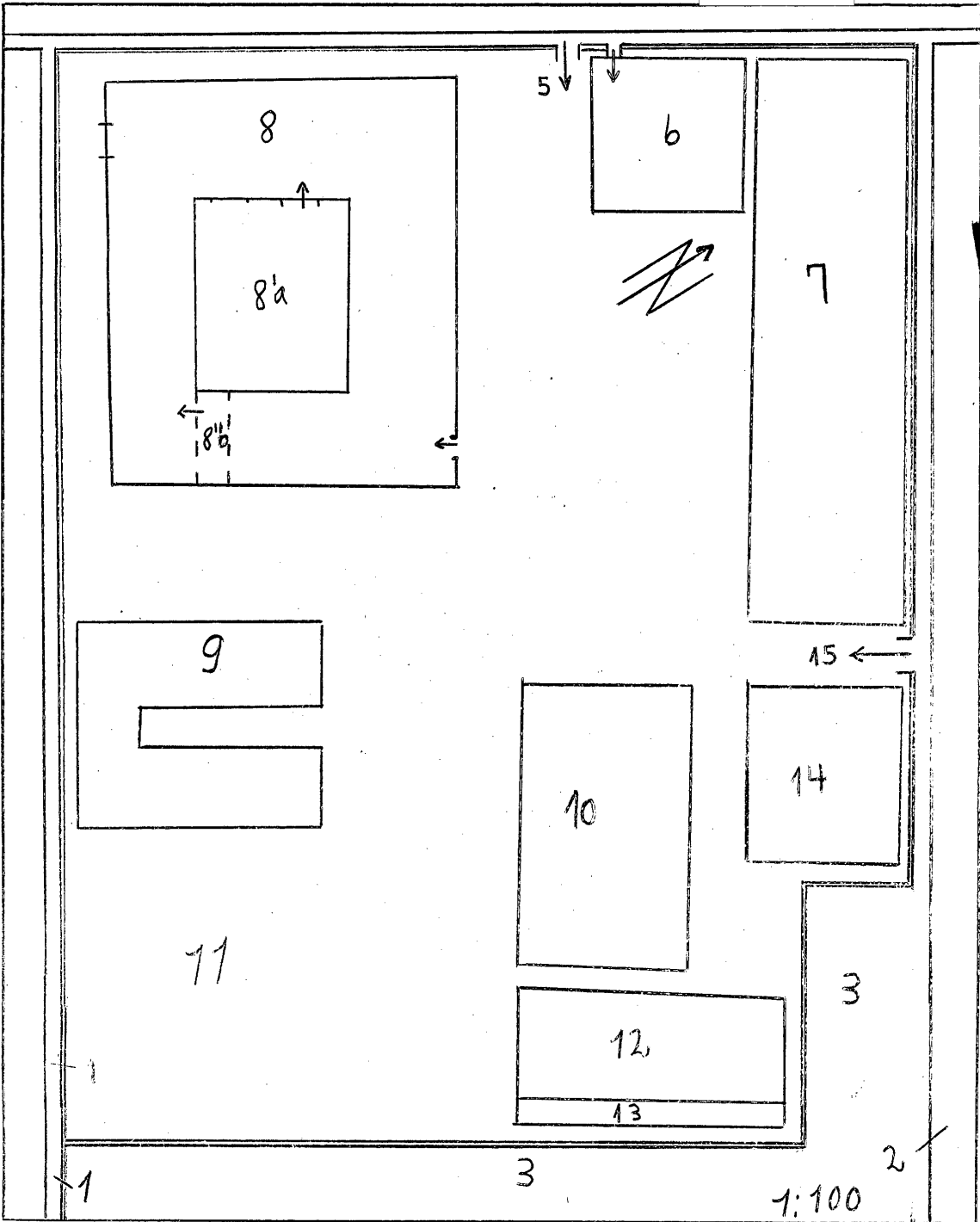

S-E-C-R-E-T

50X1-HUM

Attachment to CS-3/418,896

Subject: Overlay of the City of Floesti

Date of Info.: September 1958

Legend for the overlay of Floesti

- 1 - Road in the direction of Rudului
- 2 - Railroad in the direction of Bucharest
- 3 - Road in the direction of Bucharest
- 4 - Road in the direction of Rafov (there is a large state farm in Rafov)
- 5 - Railroad in the direction of Slobozia
- 6 - Road in the direction of Slobozia
- 7 - Railroad in the direction of Buzau
- 8 - Road to Buzau
- 9 - Road to Valeri de Munte
- 10 - Railroad in the direction of Valeri de Munte
- 11 - Road to Gageni (Margineanca)
- 12 - Road to Orasul Stalin (Brasov)
- 13 - Railroad in the direction of Orasul Stalin
- 14 - Road to Targoviste
- 15 - Railroad in the direction of Targoru Nou and onwards to Targoviste.
- 16 - Road to military airfields at Strejnic and Targoru Nou.
- 17 - Strejnic airfield
- 18 - Offices of Strejnic airfield
- 19 - Sos de Centura (road circling Floesti)
- 20 - No. 6 Refinery
- 21 - Floesti-Triaj railroad station
- 22 - Marshalling yard
- 23 - Statia de Pompare Floesti-Vest (pumping station)
- 24 - Floesti Vest railway station
- 25 - No. 7 Refinery

- 26 - Plant for chemical processing of railway sleepers and poles (Uzina de Creuzotat).
- 27 - Cimiturul Eroilor (cemetery)
- 28 - Engine depot
- 29 - I.S.A.R.
- 30 - Mimi (gypsy quarter)
- 31 - No. 1 Refinery
- 32 - Oil equipment stores (I.S.E.M.)
- 33 - Hippodrome
- 34 - Cimiturul Eternitatea (cemetery)
- 35 - Prahova glassware factory
- 36 - No. 5 Refinery
- 37 - Oil equipment repair plant (on the site of the former Unirea Refinery)
- 38 - Cartierul Motoi (residential quarter)
- 39 - Triajul Ghighiu marshalling yards
- 40 - Ghighiu convent
- 41 - Dambu railway station
- 42 - Barracks erected after World War II
- 43 - Teleajen pumping station
- 44 - Dorobantul textile factory
- 45 - Field for flower growing
- 46 - Ferro Email factory
- 47 - Oxygen factory (on the site of the former Dacia Refinery)
- 48 - No. 3 Refinery
- 49 - Teleajen railway station
- 50 - Berceni tar-paper factory
- 51 - Plant for the repair of equipment of the municipal building company
- 52 - Plant for the repair and storing of building equipment of the Ministry of Oil and Chemical Industries (on the site of the former Redeventa Refinery).
- 53 - Bereazca quarter

- 3 -

SECRET

54 - Public bathing place



50X1-HUM

55 - Bereazca stream

56 - Teleajen stream

57 - Bucov village

59 - Bucov brick factory

60 - 30 Decembrie factory for bricks and prefabricates

61 - Tintareni village

62 - Metalochimica paint factory

63 - File factory

64 - Rolling stock repair plant (Atelierele C.F.R. Floesti Nord)

65 - No. 2 Refinery

66 - Dambu stream

67 - Blejoi factory (industrial glass)

68 - Blejoi village

69 - Antiaircraft gun positions (in a field)

70 - Antiaircraft gun positions (in a field)

71 - Research laboratories for plastics (on the site of the former Xenia Refinery)

72 - Uzinele Ceramice (factory for ceramic products)

73 - Movila contagious diseases hospital

74 - Municipal transformer station

75 - Cimitirul Viisoara (cemetery)

76 - Jewish cemetery

77 - Garage and repair shop for municipal buses

78 - Municipal factory for chemical products (shoe polish, etc.)

79 - Plaster of Paris factory

80 - Flour mill, granary and bakery (municipal trust)

81 - Gara de Nord (railway station)

82 - Macazul rolling stock repair plant

SECRET

50X1-HUM

50X1-HUM

- 83 - Grivita Rosie (or Vasile Roaita Street
- 84 - Boldescu general hospital
- 85 - Children's hospital (formerly Spitalul Predinger)
- 86 - Vlahita Factory (formerly Ferrum) for metal utensils
- 87 - General secondary school (formerly commercial high school)
- 88 - Gheorghe Doja (formerly Gen. Dragalina) Street
- 89 - Principal municipal market
- 90 - Palace of Culture (formerly Palatul Justiiei)
- 91 - Calea Campinei Street
- 92 - Central textile warehouses
- 93 - Kirov Street
- 94 - Central station for buses running between Floesti and towns in vicinity
- 95 - Telephone exchange
- 96 - Municipal building
- 97 - Provincial council building
- 98 - New central post office
- 99 - State Bank
- 100 - Municipal bath
- 101 - Provincial Party Committee
- 102 - State Theater
- 103 - Provincial Militia
- 104 - Municipal stadium
- 105 - Maternity hospital (formerly Gheorghe Constantinescu Hospital)
- 106 - Thermal power station
- 107 - Town Party Committee
- 108 - I.L. Cargiale Street
- 109 - 23 August Street

SECRET

50X1-HUM

- 110 - Military barracks
- 111 - Stefan Gheorghiu Street
- 112 - Town police station
- 113 - Provincial Securitate offices
- 114 - Jamming station
- 115 - Petre Gheorghe Street
- 116 - Central fire brigade station
- 117 - General Hospital (Hospital No. 2)
- 118 - Prison
- 119 - Military hospital
- 120 - Antiaircraft gun positions
- 121 - Gara de Sud
- 122 - Uzinele I Mai
- 123 - Antiaircraft gun positions
- 124 - Central civil defense town command post.
- 125 - Antiaircraft gun positions
- 126 - Rolling stock repair shop (Atelierele C.F.R. Floesti-Sud)
- 127 - Teterani village
- 128 - Municipal waterworks in the Crangul Bot (woods)
- 129 - Statia Floesti-East
- 130 - Statia Floesti-Crang
- 131 - Statia Floesti-Nord-Vest
- 132 - Zhdanov (formerly C.A. Rosetti) street
- 133 - Democratiei Street
- 134 - Lupeni Street
- 135 - Town police station
- 136 - Karl Marx Street

SECRET

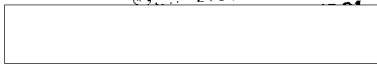

137 - Vladimir Maiacovski Street (formerly Sf. Apostol)

138 - Malinovski (formerly Postei) Street

139 - Municipal slaughter house

140 - Hospital for skin and venereal diseases.

141 - Tuberculosis Hospital

SECRET