

INFORMATION REPORT INFORMATION REPORT

CENTRAL INTELLIGENCE AGENCY

This material contains information affecting the National Defense of the United States within the meaning of the Espionage Laws, Title 18, U.S.C. Secs. 793 and 794, the transmission or revelation of which in any manner to an unauthorized person is prohibited by law.

S-E-C-R-E-T

50X1-HUM

COUNTRY USSR(Kazakh SSR)

REPORT

SUBJECT 1. Cement Plant at Elton Lake
2. Supplementary Information on the Town of Dzhanybek

DATE DISTR. 28 October 1958

NO. PAGES 8

REFERENCES

DATE OF INFO.

50X1-HUM

PLACE & DATE ACQ.

50X1-HUM

SOURCE EVALUATIONS ARE DEFINITIVE. APPRAISAL OF CONTENT IS TENTATIVE.

S-E-C-R-E-T

50X1-HUM

STATE	X	ARMY	X	NAVY	X	AIR	15	FBI		AEC		ORR/Ev	X
(Note: Washington distribution indicated by "X"; Field distribution by "#")													

INFORMATION REPORT INFORMATION REPORT

S-E-C-R-E-T

50X1-HUM

- 2 -

CEMENT PLANT AT ELTON LAKE

1. [redacted] an MIS in Dzhanybek (N 49-30, E 46-51) cement plant located near the northeastern end of Elton Lake. (See overlay of Dzhanybek area, page 6, indicating location of plant.) [redacted] 50X1-HUM 50X1-HUM

[redacted] there were approximately six, one-story, white painted brick buildings and two smokestacks, all of fairly recent construction, within the plant grounds. [redacted] 50X1-HUM

2. Cement used by the Dzhanybek MIS was supplied by this plant, [redacted] did not know what other installations or construction projects utilized cement manufactured at this site. [redacted]

[redacted] approximately 20 grey-painted oxygen bottles stored in a warehouse near the cement plant buildings. Oxygen for the MIS was also obtained at this point and [redacted] it seemed strange that this oxygen supply was stored at a place so far away from the more accessible, local railroad depot in Dzhanybek. [redacted] 50X1-HUM 50X1-HUM

3. [redacted] the cement plant employed a small work force, since [redacted] only a few workers in the area, none of whom wore a military uniform. A railroad spur serviced the cement plant area and [redacted] cement was shipped by rail to other destinations. [redacted] electric power for the plant was supplied by a diesel generator [redacted] 50X1-HUM 50X1-HUM

50X1-HUM

50X1-HUM

S-E-C-R-E-T

50X1-HUM

S-E-C-R-E-T

50X1-HUM

- 3 -

50X1-HUM

SUPPLEMENTARY INFORMATION ON THE TOWN OF DZHANYBEK

50X1-HUM

4. [redacted] the following numerically designated points on the attached sketch of the Town of Dzhanybek, page 7.

- (1) Dzhanybek Railroad Station. This was the largest railroad station in the area with extensive railroad yards and spur lines for detached railroad freight cars.
- (2) Theater. A wood, concrete, and adobe constructed building which contained a movie theater and a community center.
- (3) Dining Hall. A cafeteria-style eating place located in a one-story, wood, concrete, and adobe constructed building.
- (4) Food and General Merchandise Store.
- (5) Library.
- (6) Toy Shop.
- (7) Clothing and General Merchandise Store. This one-story building also contained a farmers exchange where produce could be traded for store articles.
- (8) Militia.
- (9) Fire Station.
- (10) Pharmacy.
- (11) Offices of the Kolkhozy.
- (12) Communist Party Headquarters.
- (13) Pasportnyy Stol.
- (14) Post Office, Telephone and Telegraph Building.
- (15) Veterinarian's Office.
- (16) Veterinarian's Office.
- (17) Local Bank.
- (18) Tailor Shop.
- (19) Boot Factory.
- (20) Grain Elevator Offices.
- (21) Grain Elevators. These structures were approximately 100 meters high, the tallest buildings constructed in Dzhanybek.

S-E-C-R-E-T

50X1-HUM

S-E-C-R-E-T

50X1-HUM

- 4 -

50X1-HUM

- (22) MTS Offices. MTS employees were also quartered here.
- (23) Grocery and General Merchandise Store.
- (24) Cemetery.
- (25) Elementary School for Kazakhs.
- (26) Primary School for Kazakhs.
- (27) Recreation Hall for MTS Employees.
- (28) One-story, private homes.
- (29) Public Bath House.
- (30) Komsomol Office.
- (31) Electric Power Station. Power was generated by a tractor diesel engine which operated intermittently.
- (32) Elementary School for Russians (through the tenth grade).
- (33) Primary School for Russians.
- (34) Local Slaughterhouse.
- (35) Petroleum Station (domestic).
- (36) Grocery Store.
- (37) Large Clothing Shop.
- (38) Selsovet. Checkpoint for all new arrivals in Dzhanlybek area.
- (39) Book and Magazine Store.
- (40) Veterinarian Pharmacy.
- (41) Local Hospital.
- (42) Polyclinic.
- (43) Radio Station (local).
- (44) Railroad Employees' Shack.
- (45) Warehouses.
- (45a) Warehouse Offices.
- (46) Large Gasoline and Oil Dump. This area contained large tanks and was surrounded by a fence.
- (47) Meteorological Station. [redacted] meteorological station personnel supplied weather information for the kolkhozy. 50X1-HUM
- (48) Living quarters for personnel of meteorological station.
- (49) Military Radio Telemetering Station.

S-E-C-R-E-T

50X1-HUM

S-E-C-R-E-T

50X1-HUM

- 5 -

50X1-HUM

- (50) Grocery Store.
- (51) Water Point. (sic)
- (52) Railroad Employees' Shack.
- (53) Barbershop.
- (54) Railroad Signal Point for Traffic Control.
5. [redacted] the local meat supply was augmented by an abundance of wild ducks which were plentiful during the months of May and June. Kolkhoz crops were molested by ratlike animals called "susliki" (Siberian marmots) and a bounty of from 42 to 50 kopeks was offered for each suslik pelt. Wolves, wild boar, and poisonous snakes were also prevalent in the Dzhanzybek area. Horses and camels were used as pack animals in areas which were inaccessible to trucks. 50X1-HUM
6. Every kolkhoz had sweet water wells which supplied water for human consumption and other wells of salty, bitter water for the stock. 50X1-HUM
7. [redacted] an MTS office building in Dzhanzybek. (See [redacted] sketch of the town of Dzhanzybek, point 22, page 7 .) This unpainted adobe building was approximately four meters high and had a 45 degree angle pitched roof. The MTS compound contained storehouses, garages, and shops, all of which were one-story, flat-roofed adobe structures except for one new, brick-constructed, repair shop which had a pitched roof. (See [redacted] sketch of the MTS grounds in Dzhanzybek, page 8 .) [redacted] the machinery in this repair shop was old and needed constant maintenance. The shop was not equipped with a crane for removing tractor motors, but instead had an improvised tripod rig for accomplishing this phase of motor repair work. Electric power was generated for the MTS by a 54-HP diesel engine. [redacted] security measures were nominal at the MTS and the duty of the only guard was to check vehicles in and out. 50X1-HUM
8. During August every year, students and factory workers from as far north as Moscow and as far south as Astrakhan came to the Dzhanzybek area to help harvest the grain crops. The entire temporary labor force was controlled by the MTS. [redacted] no other strangers in the area except those who came to the meteorological station in 1955. [redacted] several trains of troops [redacted] passed southward through Dzhanzybek en route to unknown destinations. 50X1-HUM

S-E-C-R-E-T

50X1-HUM

~~SECRET~~

50X1-HUM

- 6 -

50X1-HUM

Reference: World Aeronautical Chart (235)
Lake Elton USSR
Scale: 1:1,000,000
Overlay: Showing Dzhanymbek: And Surrounding Areas.

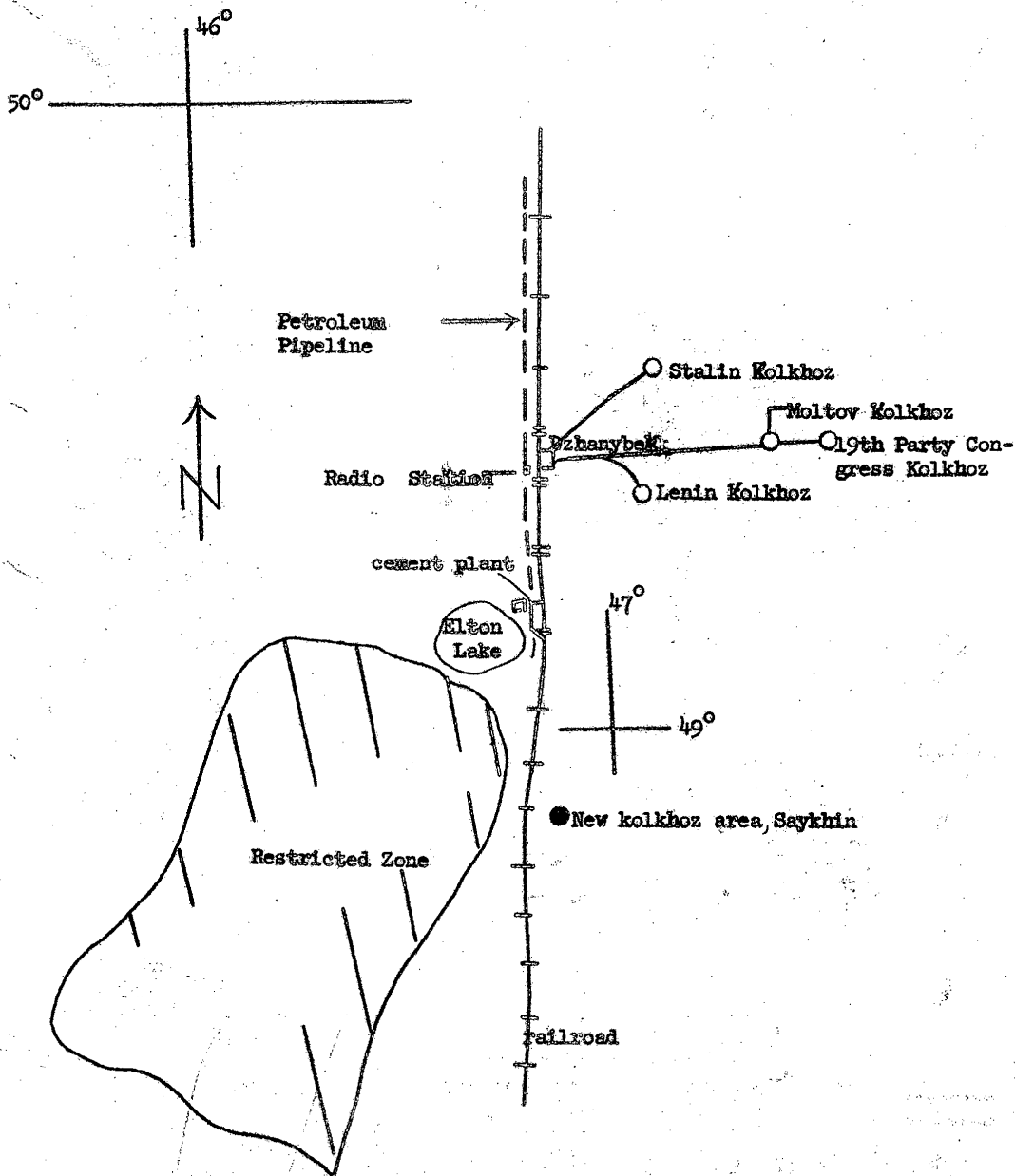

~~SECRET~~

50X1-HUM

S-E-C-R-E-T

50X1-HUM

- 7 -

50X1-HUM
50X1-HUM

Sketch of the
Town of Dzhanibek

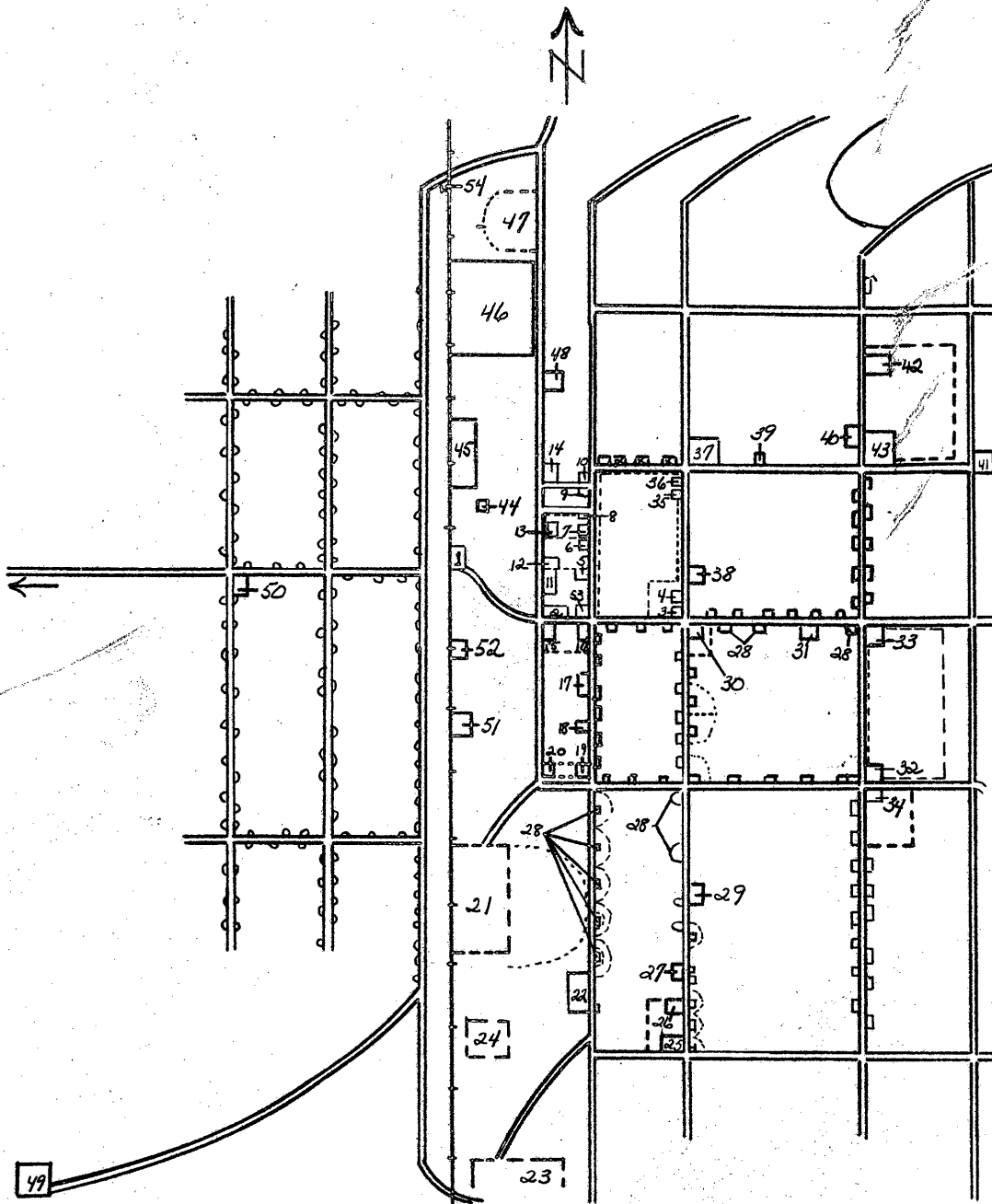

S-E-C-R-E-T

50X1-HUM

Layout of MTS and Grounds

