

CLASSIFICATION S-E-C-R-E-T
NOFORN
CENTRAL INTELLIGENCE AGENCY

REPORT
CD NO. 50X1-HUM

INFORMATION REPORT

COUNTRY Czechoslovakia

DATE DISTR. 4 April 1955

SUBJECT Uranium Ore Sorting and Dispatching Station at Vykanov

NO. OF PAGES 7

PLACE ACQUIRED
DATE OF INFO.

NO. OF ENCLS (LISTED BELOW)
SUPPLEMENT TO REPORT NO. 50X1-HUM

THIS DOCUMENT CONTAINS INFORMATION AFFECTING THE NATIONAL DEFENSE OF THE UNITED STATES, WITHIN THE MEANING OF TITLE 18, SECTIONS 793 AND 794, OF THE U. S. CODE, AS AMENDED. ITS TRANSMISSION OR REVELATION OF ITS CONTENTS TO OR RECEIPT BY AN UNAUTHORIZED PERSON IS PROHIBITED BY LAW. THE REPRODUCTION OF THIS FORM IS PROHIBITED.

THIS IS UNEVALUATED INFORMATION

50X1-HUM

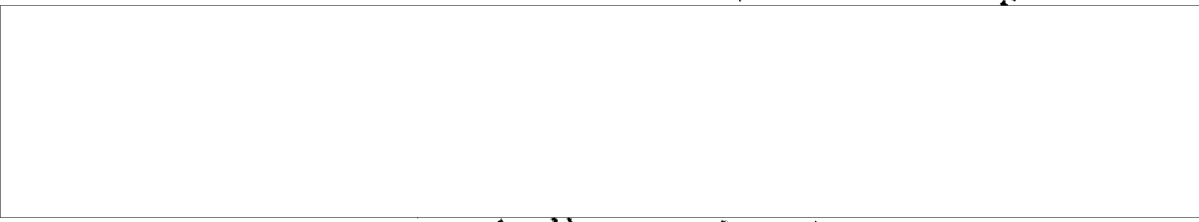

1. The uranium-ore sorting and dispatching station at Vykanov was built in 1951. The uranium ore delivered by the mines near Jachymov, Bozi Dar, Horni Slavkov, Zadni Chodov, and Pribrag were processed at Vykanov. The ore arrived on Tatra 110 trucks and was in barrels or boxes. The ore sent to Vykanov was shipped in trucks to the sorting station where it was reground and then conveyed over a bucket belt to the flotation plant where it was washed with chemicals. After the dressed ore had been dried, it was sent to the analytical department for chemical tests and pressed there into bricks, 8 x 4 x 3 cm. The pressed ore looked black, and each brick weighed exactly 1 kg. Laboratory assistants stated that these bricks had a radioactivity from 0.2 to 0.7 percent.
2. Ten pressed-ore bricks each were put on wooden frames and taken into the storage shed for pure ore. There the bricks were packed in boxes and barrels whose net weight was exactly 80 kg. The boxes and barrels were loaded into special sheet-metal-lined boxcars. Each of these boxcars was guarded by a Soviet sentry and an SNE man. One boxcar was, allegedly, loaded with 280 boxes of ore.
3. Generally, railroad cars were loaded with uranium ore only twice a month, and, in rare cases, three times a month. Groups of four railroad cars were loaded. It was believed that uranium-ore trains were dispatched to Poland and the USSR via Ostrov, Prague, and Cesky Tesin. At Horni Slavkov it was heard that uranium ore from Czechoslovakia was also sent to the USSR via Cierna nad Tisou.
4. The OTE ore-sorting plant at Vykanov employed about 400 forced laborers. Soviet personnel worked at the so-called "Kollektoren".
5. Observations indicated that some of the uranium ore produced in Czechoslovakia was dispatched to the USSR via Cop. Forced laborers working in uranium ore mines stated that pure ore, which was also referred to as snolka, was packed in

CLASSIFICATION S-E-C-R-E-T
NOFORN

STATE	<input checked="" type="checkbox"/>	NAVY	<input checked="" type="checkbox"/>	NSRB		DISTRIBUTION		
ARMY	<input checked="" type="checkbox"/>	AIR	<input checked="" type="checkbox"/>	FBI	AEC	<input checked="" type="checkbox"/>	OSI/NEP	Ev x

50X1-HUM

S-E-C-R-E-T
NOFORN

- 2 -

[REDACTED] 50X1-HUM

into sheet metal containers, shipped to Karlovy Vary and from there by air to the USSR. Other forced laborers stated that uranium ore was also dispatched to the GDR via Usti nad Labem.

1. [REDACTED] Comment. For schematic diagram indicating the layout of the OTK plant in Vykmánov, see Annex 1. 50X1-HUM
2. [REDACTED] Comment. This installation has been previously reported under the name Technical Control Office. The abbreviation of its Czech name, OTK, has been variously reported as standing for Odborna tecimicka kontrola or for Oddeleni technicke kontroly. 50X1-HUM
3. [REDACTED] Comment. For floor plan of the OTK in Vykmánov, see Annex 2. 50X1-HUM

S-E-C-R-E-T
NOFORN

~~S-E-C-R-E-T~~
NOFORN

- 3 -

Annex 1



50X1-HUM

= 2 =

Legend:

Graphical representation of ore processing in various departments of the OTE in Vykmánov.

- 1 - Horný Zdar railroad station.
- 2 - Railroad line to Ostrov on which the ore was dispatched to the USSE.
- 3 - Route of ore arriving from Jachymov.
- 4 - Route of ore arriving from other mining areas such as Slavkov.
- 5 - Incoming ore shipments.
- 6 - Ore-sorting station.
- 7 - Flotation plant.
- 8 - Analytical department.
- 9 - Storage of pure ore.
- 10 - Route of outgoing boxcars filled with uranium ore.
- 11 - SNB station.
- 12 - Building of Inspectorate II.

~~S-E-C-R-E-T~~
NOFORN

S-E-C-R-E-T
NOFORN

50X1-HUM

Annex 2

- 2 -

Legend:

- 1 - Watchtower. To the north, the complex was secured by a board fence 2.5 meters high. The other sides were surrounded by a double wire fence.
- 2 - Main gate.
- 3 - Guardhouse, single-story brick building, about 10 x 5 meters.
- 4 - Main laboratory, single-story brick building, about 50 x 20 meters.
- 5 - New laboratories, a three-story brick building, about 50 x 30 meters. The building was scheduled to be completed by December 1954.
- 6 - Single-story brick building (manganese plant), in an area surrounded by a wooden fence. Material was shipped from installation item No. 14 to this building.
- 7 - Dump of undetermined material which arrived on Tatra trucks from places outside Vykmanov. The material was tested at the measuring station (item No. 8) and from there conveyed to installation item No. 14 and installation item No. 19.
- 8 - Measuring station.
- 9 through 13 Brick and wood buildings of undetermined size. Building item No. 9 was provided with a ramp where boxes and sheet metal containers were unloaded from trucks. The buildings items No. 9 through 13 were interconnected by gangways and it appeared that conveyer belts were installed in them.
- 14 through 16 Brick buildings. Buildings items No. 14 and 15 had two stories; building item No. 16 was a 10-story tower of red bricks, a conspicuous landmark of the OTK. From the buildings items No. 15 and 16 material was trucked to building item No. 19. A metallic noise which sounded as if steel was striking steel was heard from the tower.
- 17 - Single-story brick building, 60 x 40 meters, with a ramp along the railroad track. From this ramp sheet-metal containers were loaded into boxcars.
- 18 - Large quantities of new empty metal containers.
- 19 - Roofed-over loading bridge from which the ore was dumped through chutes. From the dumps the ore was loaded by means of conveyer belts into railroad cars.
- 20 - Railroad track.
- 21 - Transformer station.
- 22 - Timber yard.
- 23 - Five new temporary buildings; behind them were six dwelling houses quartering StB personnel.

S-E-C-R-E-T
NOFORN

~~S-E-C-R-E-T~~
NOFORN

50X1-HUM



Annex 2

~~5~~

- 3 -

- 23 a - SSB guardhouse where the telephone lines from the watchtowers converged.
- 24 - SSB vehicle-check point .
- 25 - Camp Vymanov II.
- 26 - Camp Vymanov I.
- 27 - To Vymanov.
- 28 - To Ostrov.

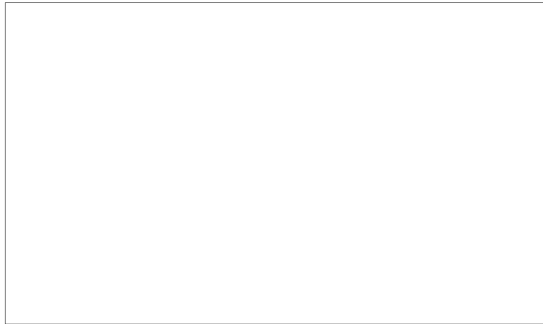

50X1-HUM

~~S-E-C-R-E-T~~
NOFORN

S-E-C-R-E-T
NOFORN

50X1-HUM

-6-

Annex 1

Graphical Representation of Ore Processing in Various
Departments of the OTR in Vykmanov

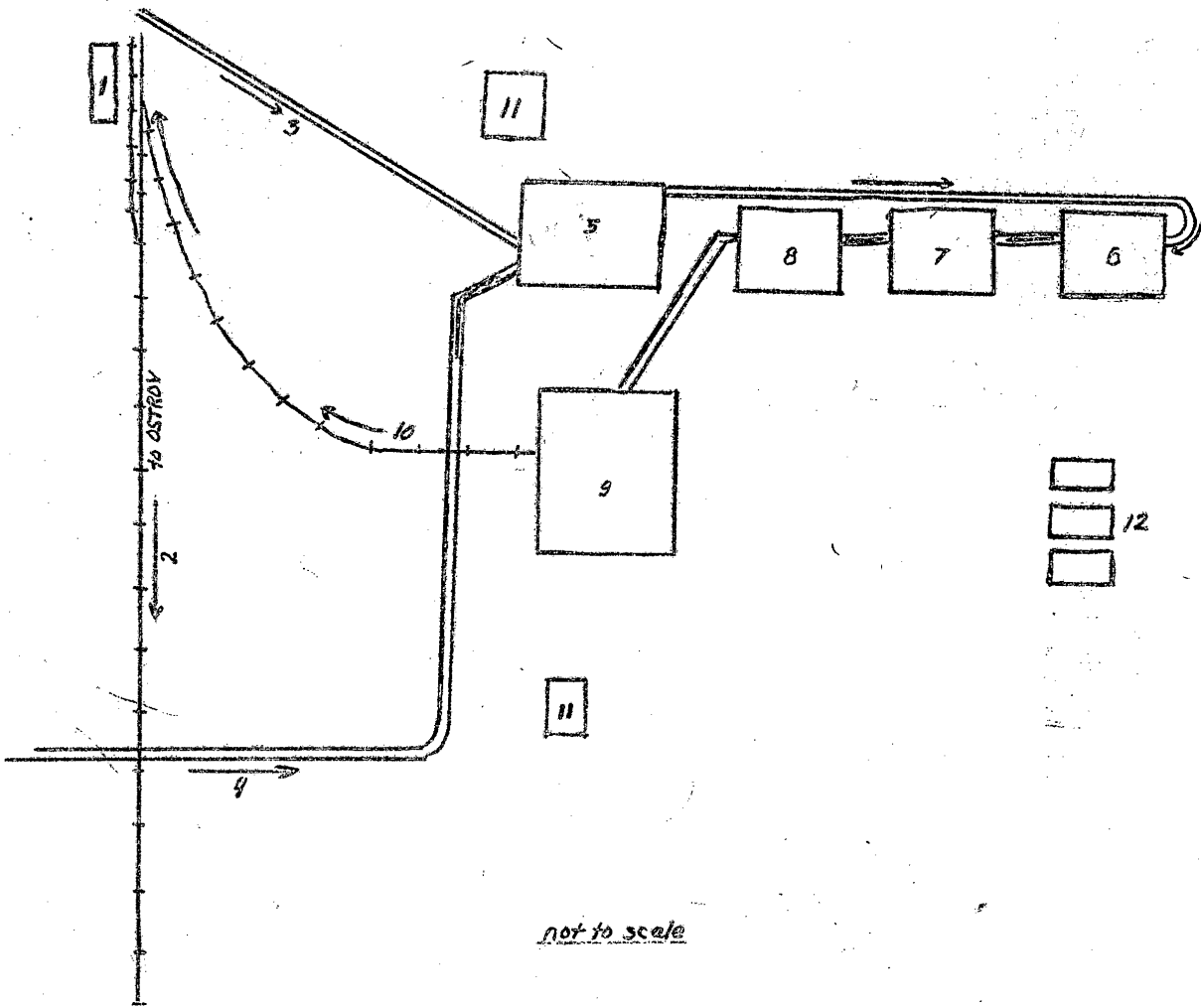

S-E-C-R-E-T
NOFORN

S-E-C-R-E-T
NOFORN

Annex 2

50X1-HUM

-7-

23

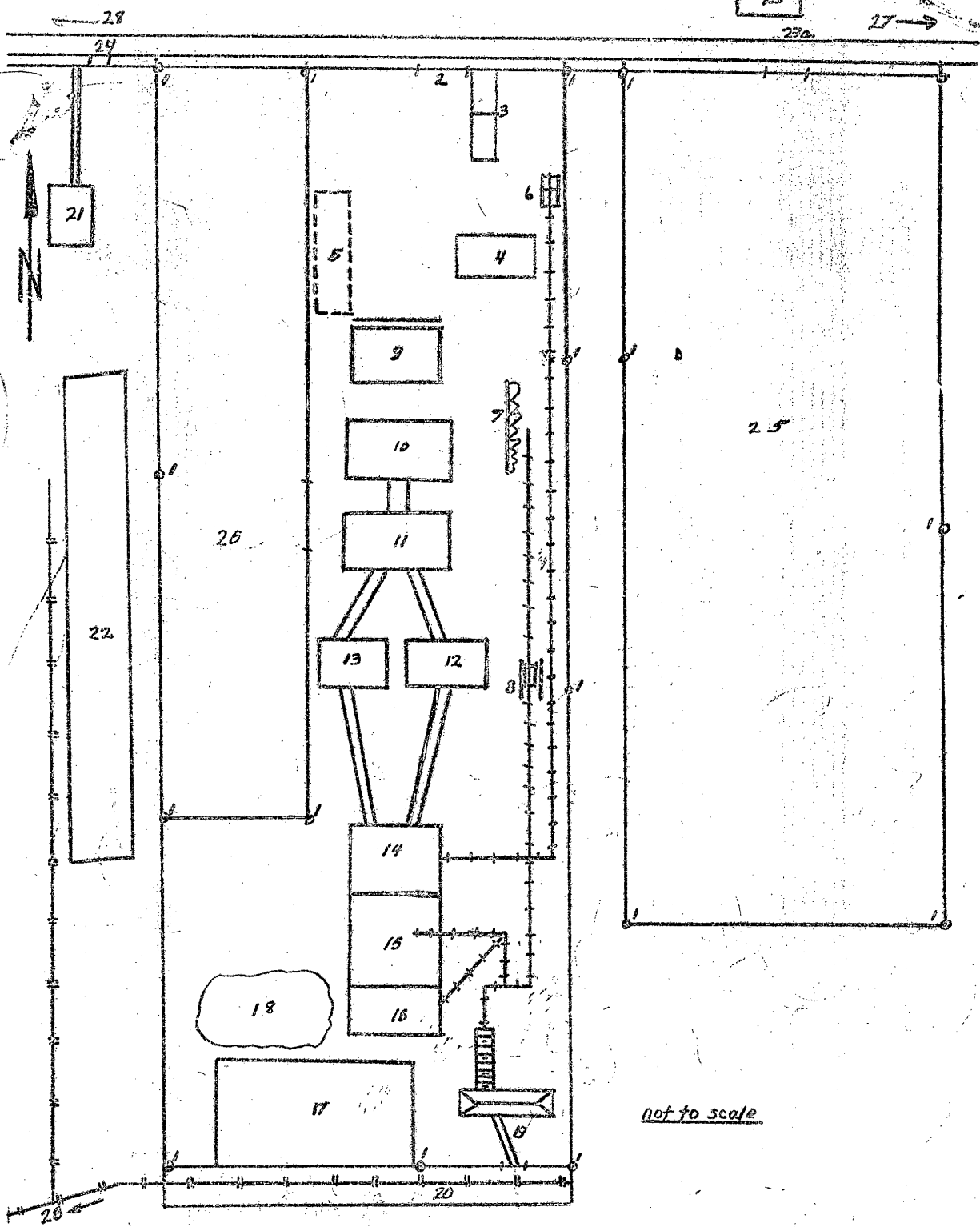

not to scale

Layout of the OFK in Vylcaney

S-E-C-R-E-T
NOFORN

50X1-HUM

Page Denied