

Page Denied

Next 3 Page(s) In Document Denied

50X1-HUM

INTELLURAX 7

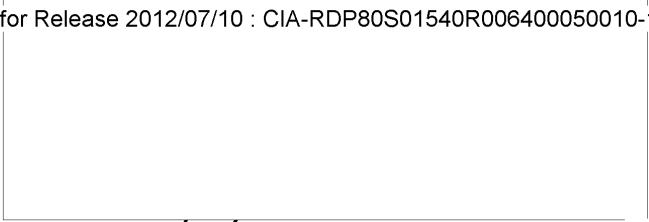

CENTRAL INTELLIGENCE AGENCY

50X1-HUM

INFORMATION REPORT

This Document contains information affecting the National Defense of the United States, within the meaning of Title 18, Sections 793 and 794, of the U.S. Code, as amended. Its transmission or revelation of its contents to or receipt by an unauthorized person is prohibited by law. The reproduction of this form is prohibited.

SECRET-U.S.OFFICIALS ONLY

50X1-HUM

COUNTRY Hungary

REPORT

SUBJECT Machine Tool Factory in Budapest

DATE DISTR. 15 February 1955

NO. OF PAGES 1

50X1-HUM

DATE OF INFO.

REQUIREMENT NO. RD

PLACE ACQUIRED

REFERENCES

THE SOURCE EVALUATIONS IN THIS REPORT ARE DEFINITIVE.
THE APPRAISAL OF CONTENT IS TENTATIVE.

report concerning the Budapest Machine Tool Factory

50X1-HUM

SECRET-U.S.OFFICIALS ONLY

STATE	ARMY	NAVY	AIR	FBI	AEC			OCD	X
-------	------	------	-----	-----	-----	--	--	-----	---

(Note: Washington Distribution Indicated By "X"; Field Distribution By "#") Form No. 51-61, January 1953

50X1-HUM

U.S. OFFICIALS ONLY

INFORMATION ON A MACHINE-TOOL FACTORY IN BUDAPEST

50X1-HUM



The machine-tool factory is located in the 13th district of Budapest, Vaci Avenue Ut 19 (Vaci ~~Street~~ 19), and can be located more exactly on the sketch. Formerly called "Salgotarjani Gepgyar" (Salgotarjan Machine-Tool Factory), it is now called "Budapesti Szerszamgepyar" in Hungarian. It was severely damaged in the war and has only been in operation again since 1947.

The work force consists of about 1,300 employees, of ^{whom} ~~which~~ one-fourth are women. The work is done in two shifts, except for the foundry, where only one shift works. There is no shortage of workers. On the contrary, the factory operation is insufficient for the available work force. For that reason working conditions are not favorable and the average wage is below the standard for this type of work.

The factory is under civil administration, the superior state authority being the Ministry of Mining and Machine Building. General manager of the factory is Communist Karoly Antal; party secretary is Istvan Szabo; trade union secretary Sandor Racs, also a Communist; foundry manager is Jozsef Trammer, ^{without party affiliation.} ~~party boss.~~

The production schedule is as follows:

- 1.) weekly, one turning lathe 150 centimeters long;
- 2.) daily, two turning lathes 120 centimeters long, received in semi-finished state from the Kobanya Machine-Tool Factory, finished and then delivered to Kobanya;
- 3.) daily, two mechanics' bench vises, likewise delivered to Kobanya;
- 4.) daily, one ~~simultaneous~~ bottling machine for ^{filling} 250 bottles, ^{simultaneously.}

U.S. OFFICIALS ONLY

~~U.S. OFFICIALS ONLY~~

50X1-HUM

The production schedule is in general adhered to, although delays often occur in the delivery of raw material, which comes principally from the Matyas Rakosi Works in Csepel.

Almost the entire production is exported to Rumania, China and the USSR by trucks of the "TEFU" (State Freight Transfer Enterprise), since the factory itself owns only two ^{3-ton} Csepel trucks ~~and one passenger auto~~ and one passenger auto.

In the ground-floor foundry and machine shop section, measuring about 65 ~~by~~ 15 meters over-all, the following equipment is located: (8)

- two old molding machines (capacity of 40 units each per shift);
- four new, completely automatic molding machines, delivered from the USSR since 1952 ^[combined?] (capacity of 2,000 units per shift);
- four new Hungarian pneumatic hammers, (250 strokes [? Füllungen ?] per hour;
- two smelting furnaces, capacity of six tons together per shift;
- three overhead cranes, ~~of~~ five tons each;
- one smelting oven being built;

In the alloy ~~work~~ shop section (5):

- two automatic cutting machines;
- three grinding machines;
- one crane, ~~of~~ two tons.

In the forge and ^{fitter's} ~~work~~ shop (4), about 20 by 10 meters, ground-floor:

- one electric furnace;
- three grinding machines;
- two drilling machines;
- one lathe.

In the ground-floor assembling shop, 40 by 12 meters:

- one grinding machine;
- two drilling machines;
- two lathes;
- one crane, ~~of~~ five tons.

-U.S. OFFICIALS ONLY

-8-

50X1-HUM

~~U.S. OFFICIALS ONLY~~

The factory has no plant ^{guards} ~~protection~~. There is only one fire-fighting unit of ten trained workers.

At the entrance to the factory is a doorkeeper. Entry to the factory is permitted only with permission of the management.

Explanation of the sketch:

1. Entrance
2. Ground-floor turning section, about 15 by 10 meters
3. Administrative office
4. Forge and ^{Fitter's} ~~mechanical~~ shop
5. ~~Alloy work shop~~ Alloy work shop on the ground-floor, about 25 by 10 meters
6. Assembling shop
7. Management and engineering offices
8. Foundry and machine shop
9. Boilerhouse with central heating installation, air compressing installation, and emergency power installation.

-9- U.S. OFFICIALS ONLY

50X1-HUM



~~SECRET~~
-U.S. OFFICIALS ONLY

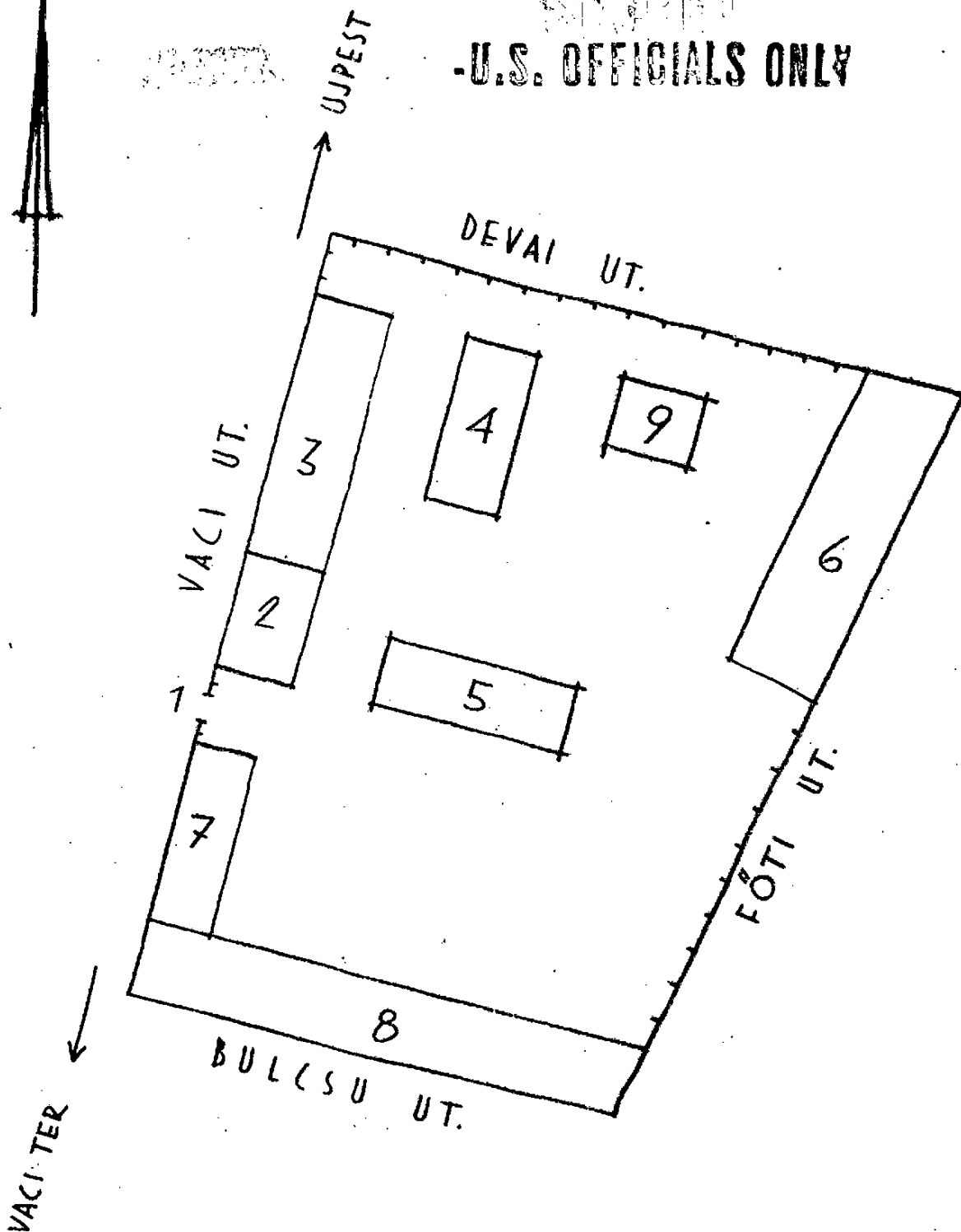

~~SECRET~~

-U.S. OFFICIALS ONLY