

25X1

CENTRAL INTELLIGENCE AGENCY
INFORMATION REPORT

This material contains information affecting the National Defense of the United States within the meaning of the Espionage Laws, Title 18, U.S.C. Secs. 793 and 794, the transmission or revelation of which in any manner to an unauthorized person is prohibited by law.

SECRET - U. S. OFFICIALS ONLY

COUNTRY	Czechoslovakia	REPORT	
SUBJECT	Tesla Holesovice, National Enterprise, in Prague - Holesovice	DATE DISTR.	19 January 1955
DATE OF INFO.		NO. OF PAGES	16
PLACE ACQUIRED		REFERENCE NO.	RD
		REFERENCES	

This is UNEVALUATED Information

25X1

THE SOURCE EVALUATIONS IN THIS REPORT ARE DEFINITIVE.
 THE APPRAISAL OF CONTENT IS TENTATIVE.
 (FOR KEY SEE REVERSE)

1. Plant No. 01 of Tesla Holesovice, National Enterprise, is located in Prague-Holesovice, about 300 meters west of the Vltava River, on the corner of Delnioka and Jankovicova Streets. To the west is the street called V Haji. To the south is Tuserova Street.
2. The factory has about 1,500 employees, of whom about 65% are women. There are no brigade workers or prisoners working in the plant.
3. Machinery, in addition to the machines described in the legends (see Annexes), includes about six lathes in the cellar workshops, two belts for washing bulbs, and a few electric machines for measuring the bulbs.
4. Raw materials:
 - a. From Eastern Germany: Wolfram, sometimes ready-made filaments of very poor quality.
 - b. From Hungary: Molybdenum and wolfram.

25X1

25X1

25X1

5. Production:
 - a. BH program (sic): 1,700 bulbs for aircraft, tension 24 V and 200 V, 7,000 bulbs for cars.
 - b. Production for the domestic market: 50,000 bulbs 60 V, 1,000,000 bulbs 25 V, 80,000 bulbs 15 V, 27,000 bulbs 200 V, 18,000 filaments for neon lights, 25 and 40 V.

SECRET - U. S. OFFICIALS ONLY

STATE	X	ARMY	X	NAVY	X	AIR	X	FBI		AEC		ORR	EV	X		
-------	---	------	---	------	---	-----	---	-----	--	-----	--	-----	----	---	--	--

(NOTE: Washington distribution indicated by "X"; Field distribution by "#".)

SECRET - U. S. OFFICIALS ONLY



25X1

- 2 -

6. The incandescent filaments are shipped to the Tesla Holesovice plant in Usti nad Labem; it is not known where the bulbs are shipped.
7. The machinery is in poor condition. The material for making filaments is of bad quality, especially the wolfram wire from Germany. The glass delivered has different measurements from that ordered, and the gas is badly purified.
8. The five-year plan for bulb production is fulfilled 110%. The filaments department plan is fulfilled 50%.

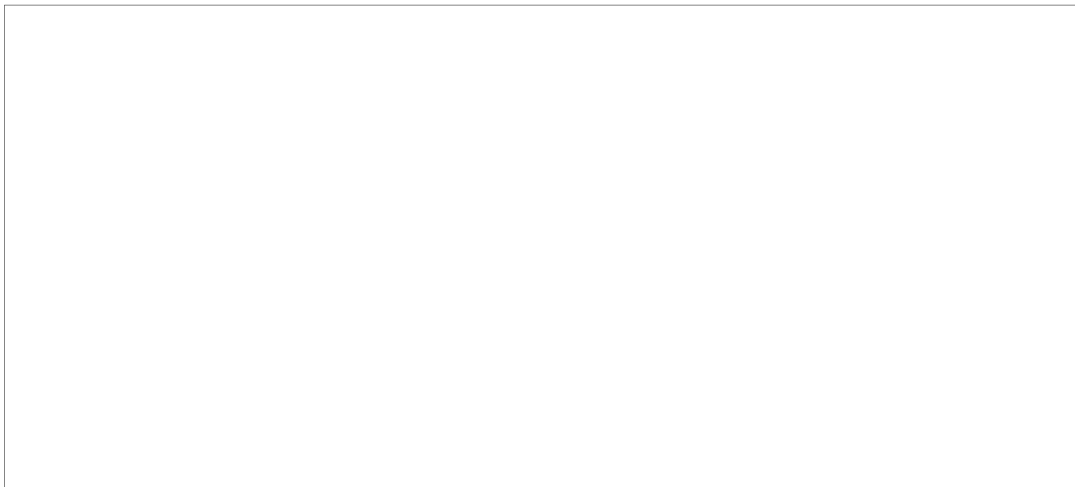

25X1

10. There are always two members of the plant guard armed with pistols at the gatekeepers' post. From time to time one member of the plant guard patrols the factory.
11. Morale is poor; there is dissatisfaction with the night shifts and with the machinery, and generally with management. Most of the people take their meals in the factory canteen.
12. Political instruction is held once a week for a ten-minute period. Meetings take place once a month.

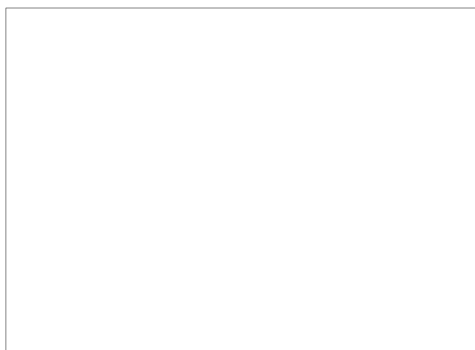

25X1

SECRET - U. S. OFFICIALS ONLY

- 3 -

ANNEX A: Holesovice Plant No. 01

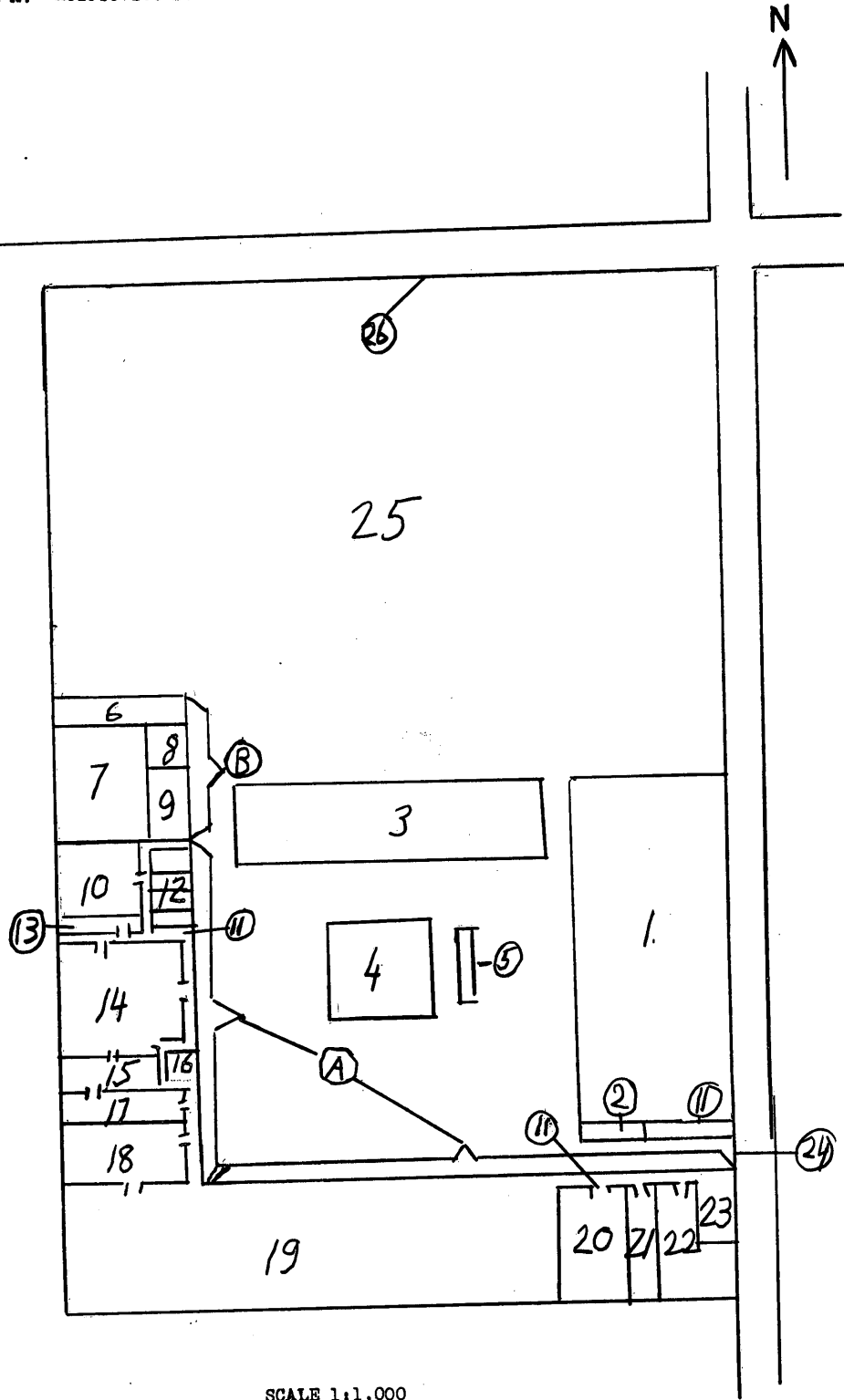

SCALE 1:1,000

SECRET - U. S. OFFICIALS ONLY

SECRET - U. S. OFFICIALS ONLY

25X1

- 4 -

Legend:

1. Administrative building, brick, four-story. On the third and fourth floors are apartments for employees.
 2. Gatekeeper's post, brick, single-story.
 3. Storage for acids and production material. Wooden, single-story building, 5 m. high.
 4. Storage for compressed gas. Underground, concrete pit, the roof of which is approximately 50 cm. above ground. Depth unknown.
 5. Basin, concrete, full of water. Depth about one meter.
 6. Plant kitchen.
 7. Canteen.
 8. Catering office.
 9. Plant physician.
 10. Wire department.
 11. Corridor.
 12. Offices.
 13. Distributor for compressed gas.
 14. Filaments department.
 15. Office of the manager of the filaments department.
 16. Elevator.
 17. Disc department.
 18. Technical control.
 19. Bulb department.
 20. Department for special bulbs.
 21. Laboratory.
 22. Development department.
 23. Boiling room.
 24. Iron gate.
 25. Park belonging to the factory.
 26. Brick wall.
- A. This is a single-story building, about six meters high, with basement, where some of the workshops are located.
- B. This building is about the same height as A, and was built in about 1947.

SECRET - U. S. OFFICIALS ONLY

SECRET - U. S. OFFICIALS ONLY



25X1

- 5 -

ANNEX B: Filaments Department

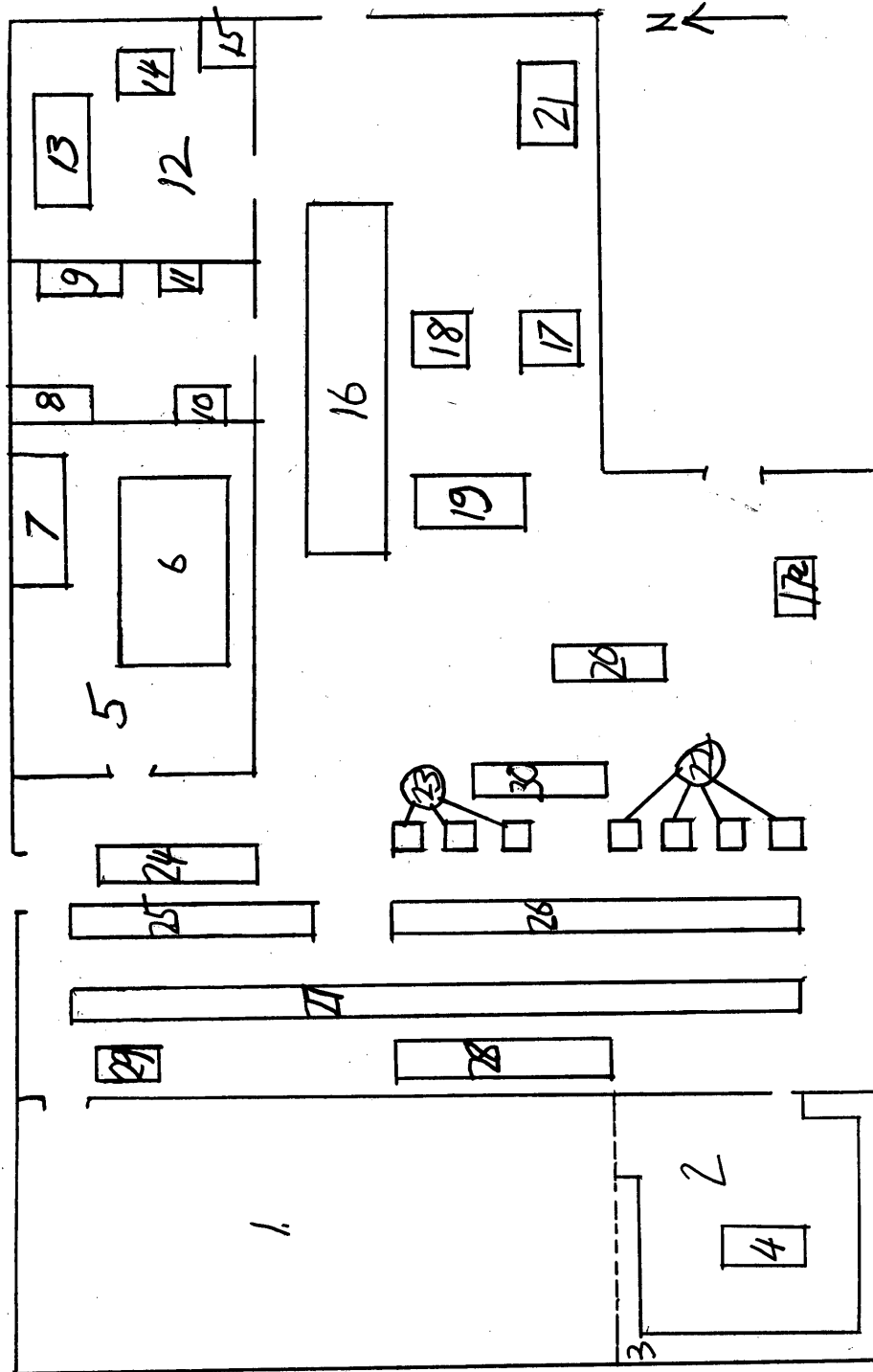

NOT TO SCALE

SECRET - U. S. OFFICIALS ONLY

SECRET - U. S. OFFICIALS ONLY

25X1

- 6 -

Legend

1. Office.
2. Distribution of material.
3. Shelves.
4. Bench.
5. Filament control.
6. 8 torsion balances for weighing filaments of wolfram wire, new, sensitivity 2-5 tenths of a milligramme.
7. 2 dispensing scales for weighing filaments, older type.
8. Work bench.
9. Cupboard.
10. 1 grinder, older type.
11. 1 vertical drilling machine, old.
12. BH program department.
13. See 26 below (sic).
14. See 25 below (sic).
15. Bench.
16. 2 cutting and 2 bending machines for filaments.
- 17a. 2 vertical furnaces for shaping spirals, one old and one new, installed in April 1953.
18. 1 boat-shaped hand-operated furnace, for reducing filaments.
19. 1 continuous furnace for reducing filaments, older type.
20. 1 horizontal shaping furnace, duplex older type.
21. Decreasing of filaments.
22. 4 WUD machines for making filaments, old.
23. 3 Brueckner 2200 machines for making filaments, old.
24. 12 FO-1 machines for making filaments, Hungarian make.
25. 6 Brueckner 2400 machines for making filaments, old.
26. 14 WF798 machines for making filaments, old. Filaments for 60 watts and upwards are made on these machines.
27. 40 WF machines of 4800 revolutions and 6 of 2400; old.
28. Winding machines for winding wolfram wire in coils.
29. 1 Dutch filament machine, old.
30. 8 FO-5 machines for making filaments, new, installed in May 1953.

SECRET - U. S. OFFICIALS ONLY

SECRET - U. S. OFFICIALS ONLY



- 7 -

ANNEX C: Dulb Department

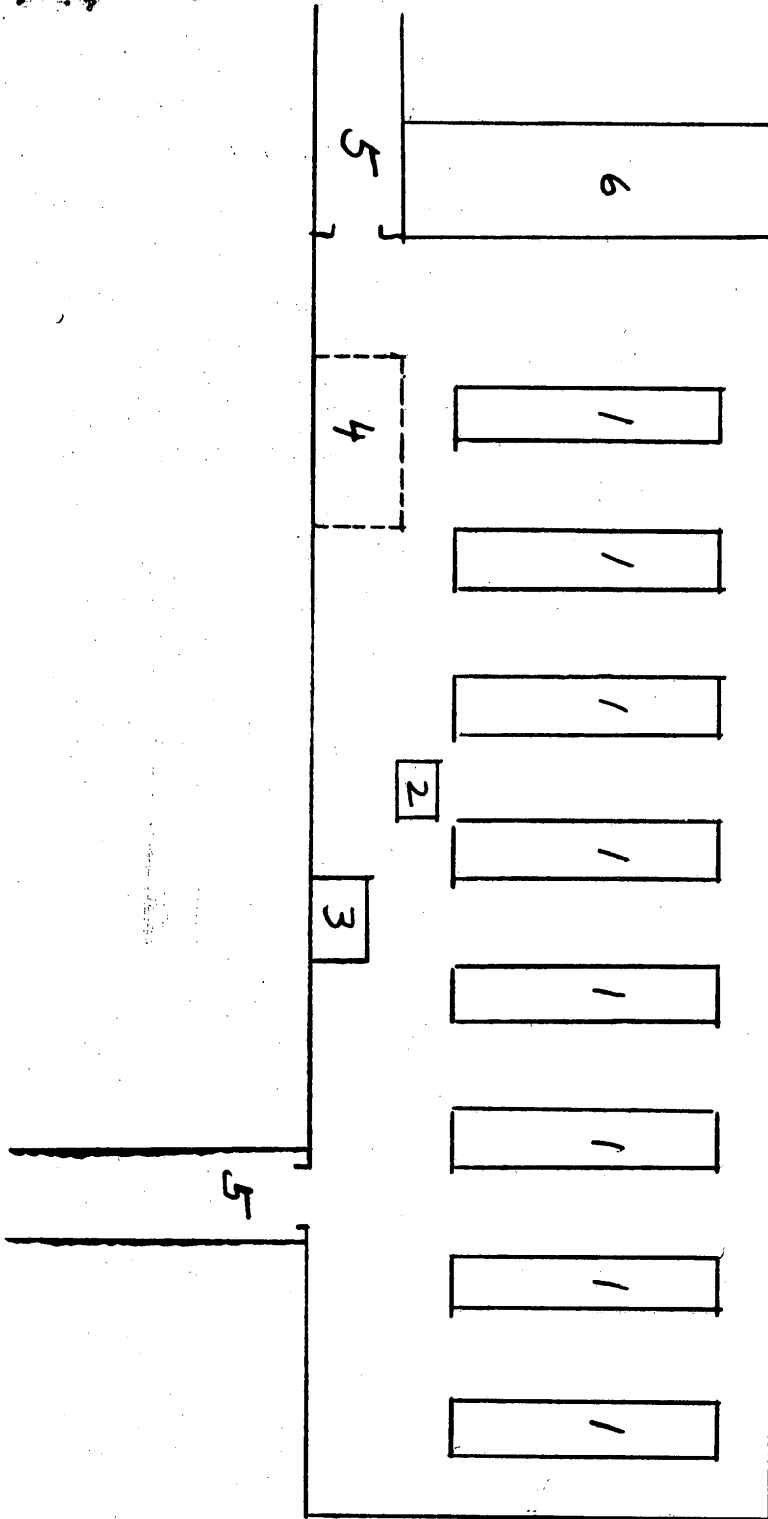

NOT TO SCALE

SECRET - U. S. OFFICIALS ONLY



SECRET - U. S. OFFICIALS ONLY



- 8 -

Legend

1. 8 production belts.
2. Chamber for testing bulbs.
3. 1 apparatus for spraying filaments with phosphorus.
4. Office.
5. Corridor.
6. Production of special bulbs (by hand).

SECRET - U. S. OFFICIALS ONLY

SECRET - U. S. OFFICIALS ONLY



25X1

ANNEX B: Wire Department and Gas Distribution

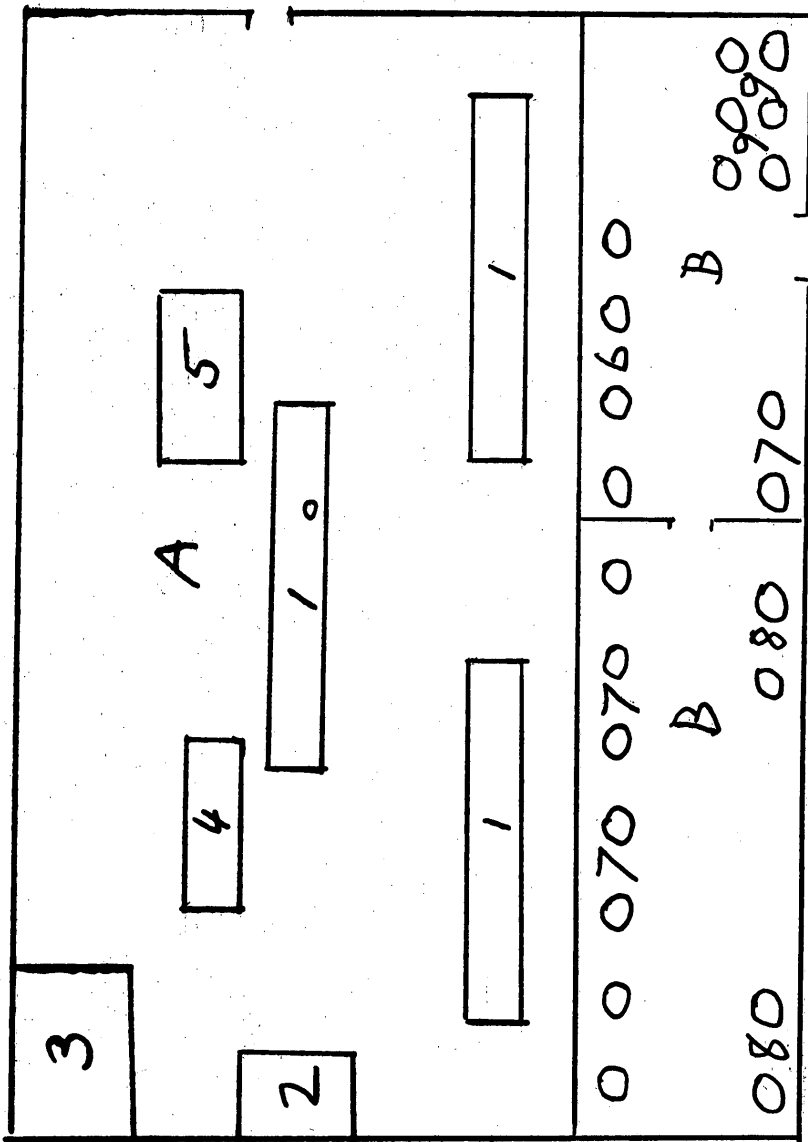

NOT TO SCALE

SECRET - U. S. OFFICIALS ONLY

SECRET - U. S. OFFICIALS ONLY

25X1

- 10 -

Legend**A. Wire Department****B. Gas Distribution**

1. 3 machines for wire production (wires introducing current into the bulbs).
2. Control of wire.
3. Bench.
4. 2 machines for winding molybdeum wire.
5. Hand production of wire.
6. Oxygen cylinders.
7. Nitrogen cylinders.
8. Hydrogen cylinders.
9. Supply of gas cylinders.

SECRET - U. S. OFFICIALS ONLY

SECRET - U. S. OFFICIALS ONLY



25X1

- 11 -

ANNEX B: Boiling Room

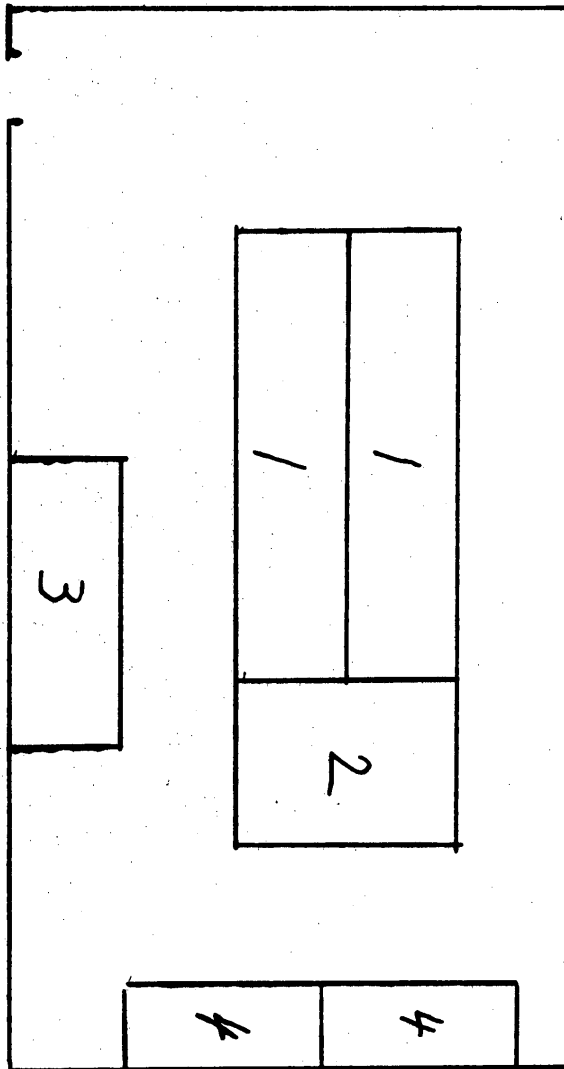

NOT TO SCALE

SECRET - U. S. OFFICIALS ONLY

SECRET - U. S. OFFICIALS ONLY



25X1

- 12 -

Legend

1. 2 baths of water for boiling filaments. Here the cores on which the filaments are wound are boiled in acids (the cores are generally iron or molybdenum).
2. Filaments-drying range.
3. Bench.
4. Cupboards.

SECRET - U. S. OFFICIALS ONLY

SECRET - U. S. OFFICIALS ONLY



25X1

- 13 -

ANNEX B - Development Department

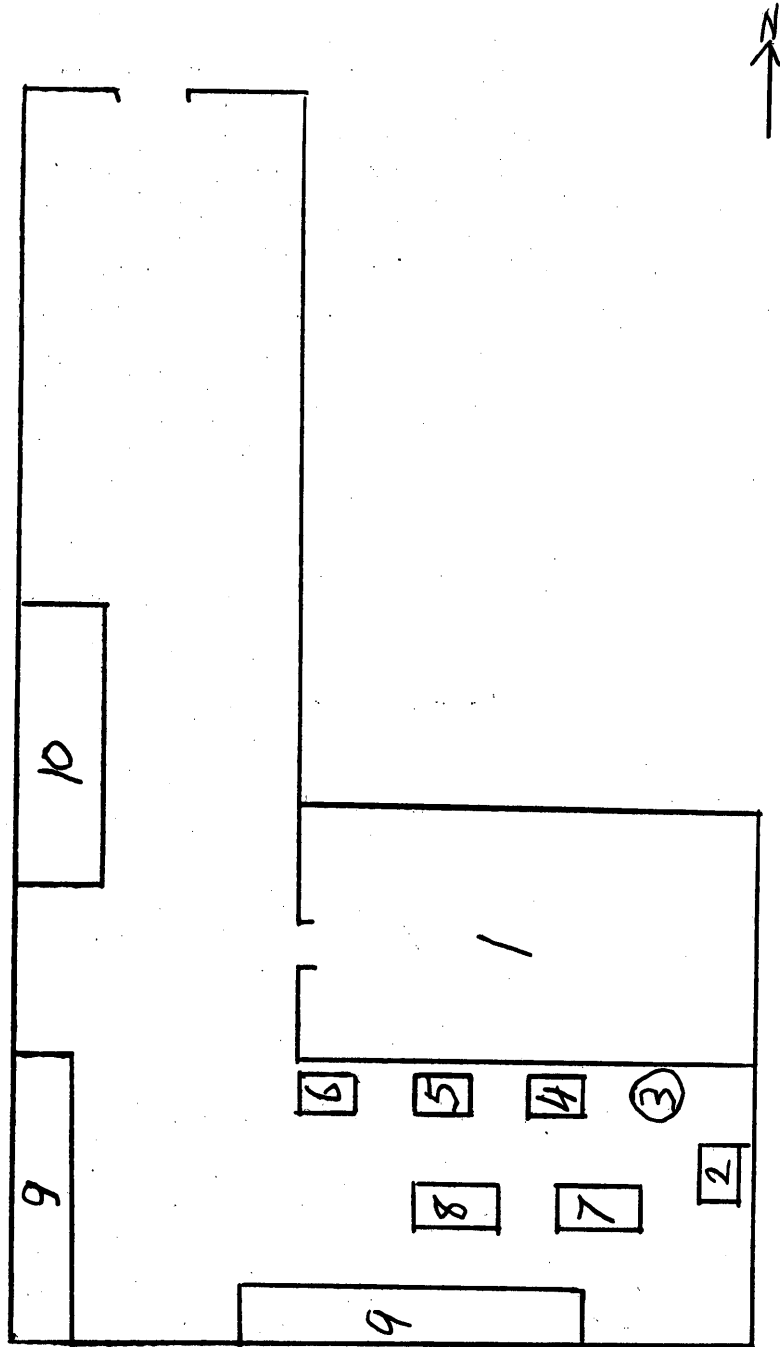

NOT TO SCALE

SECRET - U. S. OFFICIALS ONLY

SECRET - U. S. OFFICIALS ONLY



25X1

- 14 -

Legend

1. Office.
2. 1 electric furnace for tempering filaments.
3. Hydrogen cylinder.
4. 1 Brueckner 2200 machine for making filaments.
5. 1 WF 798 machine for making filaments.
6. 1 Brueckner 2400 machine for making filaments.
7. Storage place for wheels of the machine.
8. 1 cutting machine for filaments.
9. Work benches.
10. 1 machine for filling and sealing bulbs.

SECRET - U. S. OFFICIALS ONLY

SECRET - U. S. OFFICIALS ONLY



25X1

- 15 -

ANNEX G: Disc Department

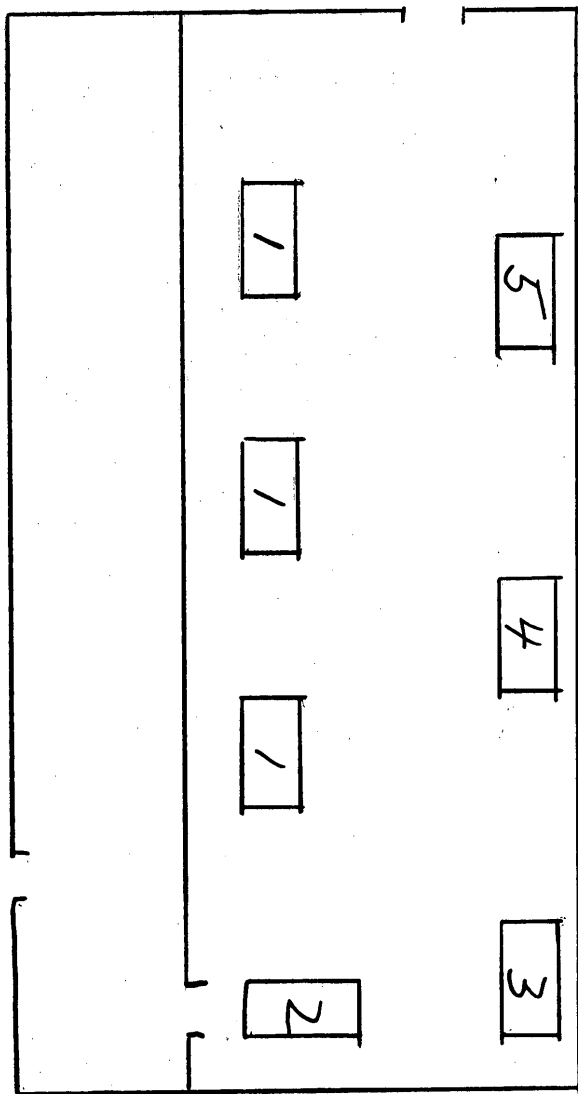

NOT TO SCALE

SECRET - U. S. OFFICIALS ONLY

SECRET - U. S. OFFICIALS ONLY



- 16 -

Legend

1. 3 machines for disc production, old.
2. Bench.
3. 2 machines for cutting glass rods.
4. Control for rods.
5. 1 grinder for head cutting of rods.

SECRET - U. S. OFFICIALS ONLY