

25X1

CENTRAL INTELLIGENCE AGENCY

INFORMATION REPORT

This Document contains information affecting the National Defense of the United States, within the meaning of Title 18, Sections 793 and 794, of the U.S. Code, as amended. Its transmission or revelation of its contents to or receipt by an unauthorized person is prohibited by law. The reproduction of this form is prohibited.

CONFIDENTIAL

COUNTRY	Bulgaria	REPORT	
SUBJECT	Fortifications Around Svilengrad	DATE DISTR.	11 August 1954
		NO. OF PAGES	6
DATE OF INFO.		REQUIREMENT NO.	RD 25X1
PLACE ACQUIRED		REFERENCES	641236

This is UNEVALUATED Information

THE SOURCE EVALUATIONS IN THIS REPORT ARE DEFINITIVE.  
THE APPRAISAL OF CONTENT IS TENTATIVE.  
(FOR KEY SEE REVERSE)

25X1

Bunkers

1. A camouflaged bunker is located in the southernmost part of the southern outskirts of Novo Selo village (N 41-46, E 26-09), the Svilengrad railroad station. It is immediately south of the road connecting Novo Selo with the "Gebran" Quarter of Svilengrad. The bunker is camouflaged to look like an ordinary village house. It is about 8 by 6 meters in size; outside it is distinguished by a layer of unbaked bricks, unpainted, roofed with red Marseilles tiles, and a little chimney. On its wall looking toward the south are apertures (window frames) without glass. On the west side is a lean-to, and on the east a little concrete well with pulley and roof above it. [redacted] there are two embrasures on the south side of the bunker, almost at ground level, which [redacted] are for canister shots. The entrance is located on the east side. The bunker was constructed by the Germans. 25X1
2. Approximately 200-300 meters south of the above camouflaged bunker and immediately south of the tank ditch running through this area, approximately 200 meters north- 25X1

CONFIDENTIAL

STATE	X	ARMY	X	NAVY	X	AIR	X	FBI		AEC					
-------	---	------	---	------	---	-----	---	-----	--	-----	--	--	--	--	--

(Note: Washington Distribution Indicated By "X"; Field Distribution By "#")

CONFIDENTIAL

-2-

25X1

east of the railroad line, is another concrete bunker. The following sketch shows the latter type of bunker:

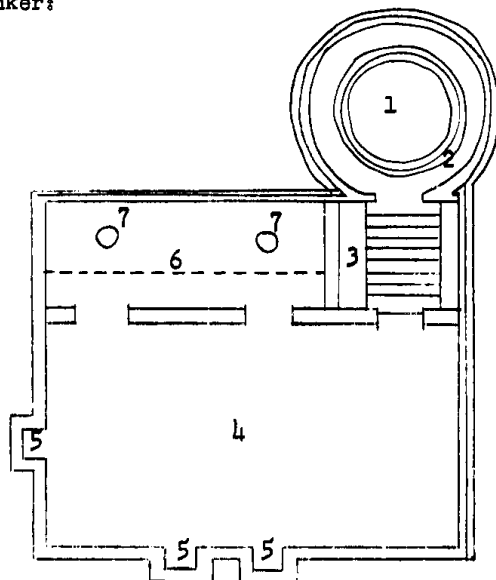

1. Entrance into bunker, through the cupola.
2. Inside platform of the cupola.
3. Stairs.
4. Central part.
5. Niches for munitions storage.
6. Sleeping quarters.
7. Air vents.

This is completely built into the earth, with only a cupola about 0.50 meters high and about two meters in diameter showing on the surface. The cupola is uncovered and serves as the entrance into the bunker. From the cupola one goes into the dome, about 1.5 meters deep, which terminates in a platform larger in diameter than that of the surface. From the inside platform starts the stairway, about 5-6 steps, into the inside of the bunker which ends in a little room about two meters square. From this little room, one enters another underground room about seven by four meters in size; this room has three niches, with completely concrete walls, in which the guard munitions are probably stored. From this room, there are two doors into a third room, about five by two meters in size, in which sleeping accommodations have been built. The whole bunker is of reinforced concrete construction. 25X1

the walls of the cupola are about 20-30 centimeters thick. 25X1  
 antiaircraft guns or howitzers are probably located on the platform of the cupola, while the underground part of the bunker serves to conceal the crews. There are a total of three doors inside the bunker. 25X1

There are two air vents, 25X1  
 laminated tubes, extending about 20 centimeters above the ground. 25X1  
 these chimneys are not run from the walls of the bunker (as is usually the case) but from the roof, which admits the air directly into the interior of the bunker. 25X1  
 These are located in the roof of the sleeping room of the bunker. The rooms are about three meters high. There are no embrasures in the bunker. There is no barbed wire fence or wall enclosing the bunker. The bunker was constructed by the Germans.

CONFIDENTIAL

CONFIDENTIAL

-3-

25X1

3. Another bunker is located south of the road to Mezek village (N 41-44, E 26-05), Svilengrad Okoliya, about 100 meters west of the place where the rail line crosses this road, about 200 meters south of the road, and immediately east of a little road breaking off from the road to Mezek about 100 meters from the railroad line and continuing almost due south to the vineyards. This is a reinforced concrete above-ground bunker, extending about four meters above the ground, about 10 meters long and five meters wide.

25X1

25X1

25X1

25X1

4. Approximately 300-400 meters east of the place where the two roads starting from the Svilengrad railroad station join and continue as one to Svilengrad, and about 50 meters north of the road, in the middle of a small woods, a bunker is located. This is a reinforced concrete, above-ground construction, naturally concealed in the little woods, and is barely visible to a person travelling along the road. This bunker is absolutely identical to the one described in paragraph 2 above, except that it is completely above ground. It has a direct entrance on the west side, consisting of a heavy metal door. The bunker was constructed by the Germans. There are soldiers in this bunker day and night. These soldiers are not subordinate to the Border Guards, but are part of the construction soldiers who serve to guard the explosives depot located about 300-400 meters west of the bunker.

25X1

25X1

25X1

25X1

25X1

5. Reinforced concrete bunkers in the "Trite Chuki" (The Three Hammers) locality (N 41-46, E 26-08), located at the angle formed by the road to Mezek village and the railroad line. "Trite Chuki" locality has three hills, located about 400 meters north of the road to Mezek village, and about 400-500 meters west of the railroad line. The bunkers have been constructed on the peaks of the hills. The hills are in a line (southwest to northeast), and their peaks are about 150-200 meters from each other. The road connecting Novo Selo village with Siva Reka village runs to the north and east side of them. The bunkers are dug into the earth and extend about one meter above the ground level. They all have two embrasures, one facing south and one facing east. They were constructed by the Germans.

25X1

25X1

25X1

6. Reinforced concrete bunkers are located in the "Suudzhatu," locality, neighboring on the north the "Trite Chuki" locality. The bunkers are located on the southern slope of the gully at this location, which is overgrown with willows and has a small creek, and about 200 meters west of the two adjacent bridges (road and railroad). The bunkers are mainly dug into the earth and extend above the ground only about one meter. They have two embrasures, looking to the south and toward the road. Another bunker, exactly like the others, has been constructed 200 meters farther west, on the same side of the gully. These bunkers were constructed by the Germans. Since

25X1

7. Four or five bunkers of exactly the same type as described in paragraph 2 above located in the "Starite Lozva" (The Old Vineyards) locality (N 41-44, E 26-08), south of the Svilengrad railroad station and a little above the border line, neighboring the "Byalata Prust" (The White Land) locality (N 41-45, E 26-09).

25X1

25X1

25X1

25X1

25X1

they are in the southwest half of the "Starite Lozva" locality. They are constructed exactly like the bunkers described in paragraph 2 above.

CONFIDENTIAL

CONFIDENTIAL

-4-

25X1

8. [redacted] there are almost no strategic heights to cover approaches or on which to construct bunkers or other types of fortification installations in the area between Mezek village, Svilengrad Okoliya, the Mezek-Novo Selo road, the Maritsa River, and the border line. 25X1

Trenches

9. [redacted] there are an extremely large number of trench lines around Svilengrad (manned by the Border Guard uchastuk) and between Mezek village (N 41-44, E 26-05), Svilengrad Okoliya, and the Maritsa River. [redacted] there are few places in the area which are free of trenches. 25X1

10. [redacted] location of [redacted] two lines [redacted] 25X1

a. One row of trenches starting at the right bank of the Maritsa River, about 1,500 meters northwest of the bridge at Svilengrad; they start out toward the west, go about 100-150 meters north of the bunker described in paragraph 4 above, then veer slightly south and cross the road to Svilengrad about 100 meters east of the place where the two roads from Svilengrad join into one; from there the trenches go in a southwest direction, running near the southeast outskirts of Novo Selo village, then go between the bunkers described in paragraph 1 above, and stop at the railroad line [redacted] 25X1

[redacted] the trenches are built in a zig-zag fashion; and 25X1

b. Another row starting somewhere north of Mezek village, extending in a zig-zag fashion toward the north; about two kilometers east of Siva Reka village (N 41-46, E 26-04), they cross the road which connects the village with the Istanbul Highway and continue north to Lyubimets village, Svilengrad Okoliya. 25X1

11. The trenches are about 1-1.2 meters deep and about 0.8 meters wide. They were constructed in 1950. [redacted]

25X1

Barbed Wire Fences

12. [redacted] a barbed wire fence has been constructed near the large tank ditch, about 100-150 meters north of the ditch and along its total length. 25X1

13. [redacted] two parallel lines of about 5-8 strands of barbed wire were strung from Mezek village, Svilengrad Okoliya, to Nova Levka village (N 41-52, E 26-16), Svilengrad Okoliya; [redacted] The area between the strands was cleared and mined, probably with infantry mines. In 1945, the wires were taken down and the minefields were dismantled by military units, but in spite of this forgotten mines in places cause accidents for men and animals. 25X1

14. [redacted] a new line of barbed wire was being put up along the tank ditch between the Maritsa River and the rail line as of 4 July 1953. 25X1

Sketch

15. A sketch of the fortifications in the Svilengrad area is enclosed herewith as an Appendix, page 6. The legend to the Appendix is on page 5.

CONFIDENTIAL

CONFIDENTIAL

Legend to Appendix

-5-



25X1

1. Svilengrad.
2. Novo Selo, Svilengrad Okoliya.
3. Svilengrad railroad station.
4. Sofia-Istanbul railroad line.
5. Istanbul Highway.
6. To Siva Reka (N 41-47, E 26-04), Svilengrad Okoliya.
7. To Mezek village (N 41-44, E 26-06), Svilengrad Okoliya.
8. To Momkovo village (N 41-51, E 26-09), Svilengrad Okoliya.
9. Road to Pustrogor village (N 41-51, E 26-12), Svilengrad Okoliya.
10. Road to Levka village (N 41-52, E 26-16), Svilengrad Okoliya.
11. Road to Raykova Mogila village (N 41-49, E 26-18), Svilengrad Okoliya.
12. Route to Chernodub village, Svilengrad Okoliya.
13. Maritsa River.

⌘ Komandatura.

⌘ Zastava.

X "Sekret" post.

..... Patrolled path.

..... Tank ditch.

~~~~~ Border line.

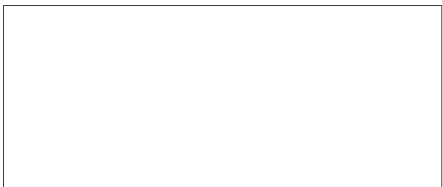

25X1

CONFIDENTIAL

CONFIDENTIAL

APPENDIX

-6-



25X1

Fortifications in the Svilengrad Area - Scale 1:50,000

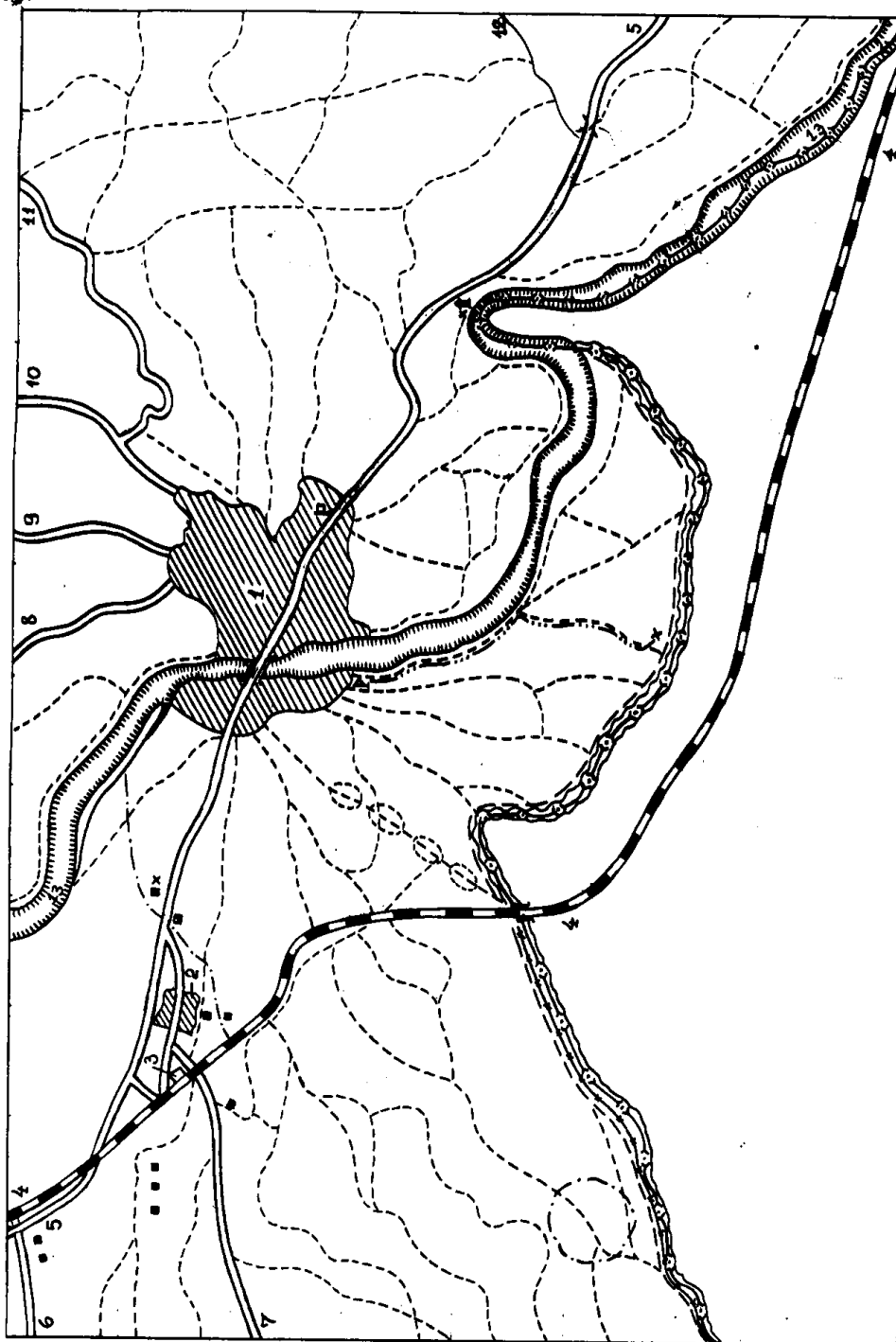

CONFIDENTIAL