

FLD 485

CENTRAL INTELLIGENCE AGENCY

INFORMATION REPORT

This Document contains information affecting the National Defense of the United States, within the meaning of Title 18, Sections 793 and 794, of the U.S. Code, as amended. Its transmission or revelation of its contents to or receipt by an unauthorized person is prohibited by law. The reproduction of this form is prohibited.

SECRET/CONTROL - U. S. OFFICIALS ONLY
SECURITY INFORMATION

50X1-HUM

COUNTRY	Albania	REPORT	
SUBJECT	1. Town Plan of Leskovic 2. The Prisons at Korce	DATE DISTR.	14 August 1953
DATE OF INFO.		NO. OF PAGES	5
PLACE ACQUIRED		REFERENCE NO.	RD
		REFERENCES	50X1-HUM

THE SOURCE EVALUATIONS IN THIS REPORT ARE DEFINITIVE.
THE APPRAISAL OF CONTENT IS TENTATIVE.
(FOR KEY SEE REVERSE)

Attached herewith are maps showing the town plan of Leskovic and the
prisons at Korce. 50X1-HUM

SECRET/CONTROL - U. S. OFFICIALS ONLY

STATE	X	ARMY#	X	NAVY #	X	AIR #		FBI		AEC				
-------	---	-------	---	--------	---	-------	--	-----	--	-----	--	--	--	--

(Note: Washington Distribution Indicated By "X"; Field Distribution By "#".)

SECRET/CONTROL - U. S. OFFICIALS ONLY



ATTACHMENT 1

page -2-

Leskovik (QM 8506)

Legend:

1.	Infantry regiment headquarters
2.	Military area
2a.	Infantry stables
2b.	Infantry barracks
2c.	Convalescents building
2d.	Restaurant-Kitchen
2e.	Dormitories
2f.	Guard quarters
9, 9a, 9b.	Concrete casements
11, 11a	VAIN observation post
14.	Police station
16.	Border guard regiment headquarters
16a.	Ammunition depot, Border guard regiment
16B.	Stables, Border guard regiment
16c.	Entertainment center
16d, 16e	Officer residence area
16f.	Food supply depot
16g.	Hog pens
16h.	Bakery
16b.	Post exchange
23 .	Bus agency
35 .	Post Office
41 .	Blacksmith Cooperative
41a.	Tinsmith Cooperative
41b.	Shoemaker Cooperative
41c.	Tailor Cooperative
41d.	Barber Cooperative
41e.	Tinsmith Cooperative (lamp section)
41f.	Confectioners and Wine Sellers Cooperative
41g.	Carpenters Cooperative
45.	Localitet
45a.	Peoples Council
47 .	Gymnasium
47a.	New Gymnasium building
51 .	Polyclinic
51a.	Chemist shop
57 .	Coal distribution center
57a.	Coal depot
61 .	Sport field
62 .	Unkhown soldier monument
63 .	Orthodox church
64 .	Mosque
90 .	Eggs and poultry collecting center and warehouse
90a.	Cereals collecting center and warehouse
90b.	Vegetable collecting center and warehouse
90c.	Dairy collecting center and warehouse
91 .	Salt warehouse
92 .	Slaughter house
92a.	Hotel and restaurant
92b.	Coffee house
92c.	Bakery
92d.	Brokers Cooperative
92e.	Rationing cards distribution center
92f.	Pawn Cooperative
92g.	Special Cooperative
93 .	Oil tank (petroleum depot)
94 .	Library
95 .	Military tailor

Legend:

⊙	Sentries
△	Observation posts
■	Concrete casements
xxxxx	Barbed wire fence
⊕	Hydrants

NOTE: Numbers 16g, 41a, 41e, 41g, 51a, and 92g omitted from the map

SECRET/CONTROL - U. S. OFFICIALS ONLY

SECRET/CONTROL - U. S. OFFICIALS ONLY

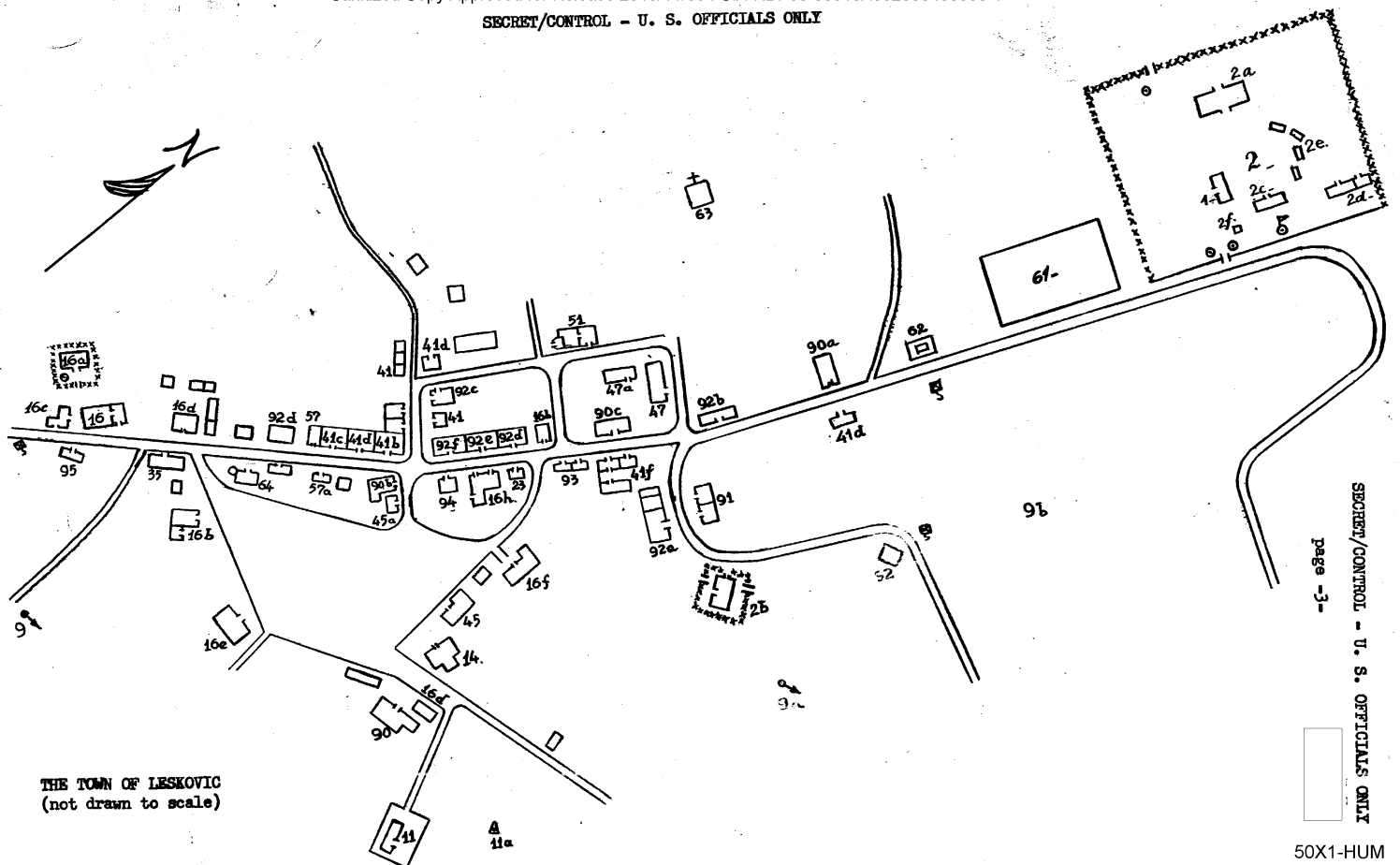

THE TOWN OF LESKOVIC
(not drawn to scale)

SECRET/CONTROL - U. S. OFFICIALS ONLY
page - 3 -

50X1-HUM

SECRET/CONTROL - U. S. OFFICIALS ONLY



- 4 -

50X1-HUM

ATTACHMENT 2

The Prison at Korce

Legend:

1. Former Prefecture building
2. Prison Directorate
3. Guard quarters
4. Prison for women
5. Prison for men
6. Yard
7. Prison iron gates
8. Police building
9. Stairs
- 10 & 11 Stairs
12. Prison building
13. Police sentry posts

SECRET/CONTROL - U. S. OFFICIALS ONLY

SECRET/CONTROL - U. S. OFFICIALS ONLY

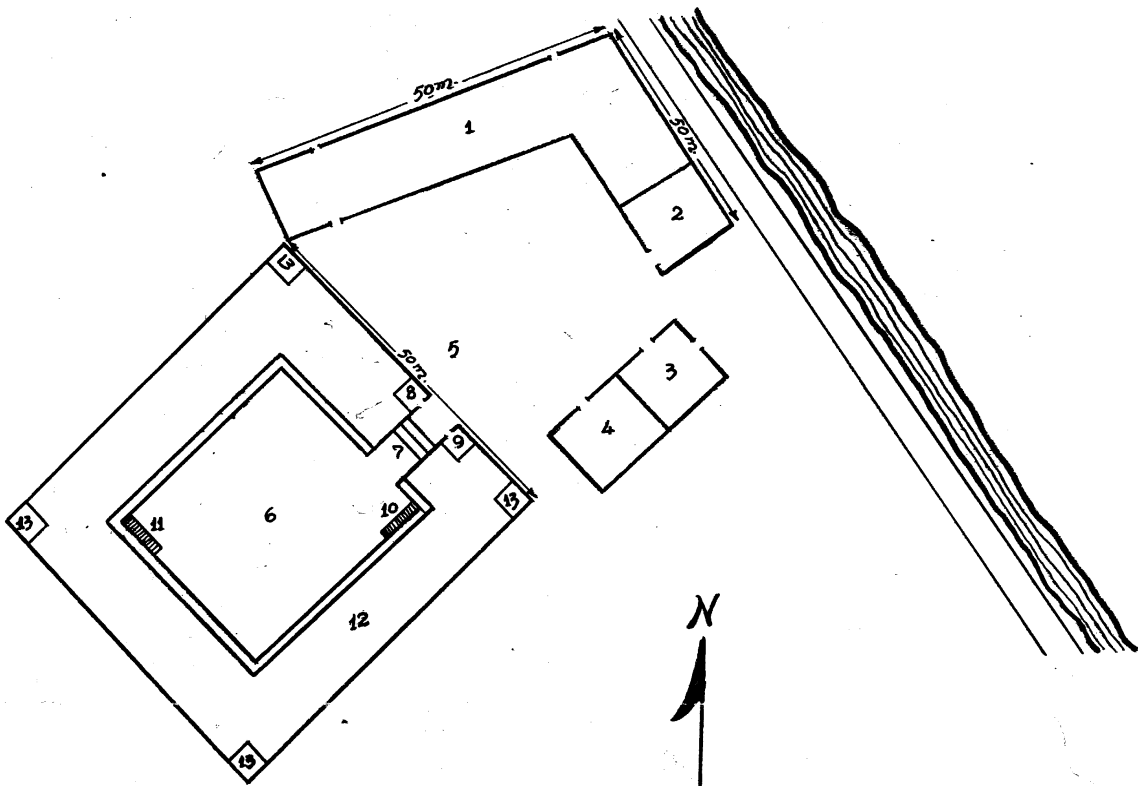

SECRET/CONTROL - U. S. OFFICIALS ONLY

- 5 -

50X1-HUM