

CONFIDENTIAL

-2-

50X1-HUM

1948 - 3,500,000 East marks
 1947 - 2,500,000 " "

4. Enclosure (A) is a sketch of the plant area. Enclosure (B) is a sketch of the layout of the office building. Enclosure C is a sketch of the layout of the factory building. All of the buildings were constructed of brick about 1900. About 1938, the structures were modernized.
5. In early 1953 the plant employed approximately 560 workers who were divided as follows: - -
- 130 administrative, sales, and technical
 - 45 apprentices
 - 15 toolmakers
 - 120 machinists (in two shifts)
 - 15 test laboratory
 - 10 painters
 - 10 kitchen
 - 8 plating and packing
 - 15 stockroom
 - 11 guards, chauffeurs, and powerhouse employees
 - 180 assemblers
6. Major customers of Rheostat-Habega were;
- A. Electro Apparate Werke, Berlin-Treptow, (for cement mills destined for the USSR) - 1951 1,500,000 East marks worth of electrical equipment
 1952 1,500,000 " " " " "
 1953, 1,500,000 " " " " "
 - B. V.E.M., Rostock, (electrical equipment for small ships)
 1949 - 1,500,000 East marks
 1950 - 1,000,000 " "
 1951 - 750,000 " "
 1952 - 100,000 " "
 - C. Riesa near Dresden (electrical parts for cranes)
 1948 - 1953, about 150,000 East marks per year
 - D. Stahlwerke, Brandenburg, (electrical parts for cranes)
 1948 - 1953, about 100,000 East marks per year
 - E. Maximilian, Saalfeld, (electrical equipment for rolling mill controls)
 1949-1953 - about 100,000 East marks per year
 - F. Eberswalde, in Eberswalde (electrical equipment for cranes)
 1949-1953, about 100,000 East marks per year.
 - G. Groeditz, in Groeditz (electrical equipment for cranes)
 1949-1953 about 100,000 East marks per year
 - H. Schwerin, in Schwerin (electric equipment for cranes)
 1949-1953, 50,000 to 100,000 East marks per year
 - I. Koethen, in Koethen (electrical equipment for cranes)
 1948-1953, 50,000 to 100,000 East marks per year
 - J. Bleichert, in Leipzig (electrical equipment for cranes)
 1947-1953, 200,000 to 400,000 East marks per year
 - K. Uruhnikbig, in Leipzig (electrical equipment for cranes)
 1947-1953, 150,000 to 300,000 East marks per year

CONFIDENTIAL

50X1-HUM

CONFIDENTIAL

-3-



- L. Fürstenberg, in Fürstenberg near Polish border (electrical equipment for cranes)
1951-1952, 80,000 East marks per year
- M. V.E.M., Kottbus (electrical equipment for Lanchhammer plant)
1951-1952, 150,000 East marks per year
- N. V.E.M., Erfurt (electrical equipment for mining machinery)
1949-1953, several hundred thousand East marks per year.



50X1-HUM

- end -

- ENCLOSURE (A): Sketch of the IKA Plant Area
(B): Sketch of the Layout of the IKA Office Building
(C): Sketch of IKA Factory Layout

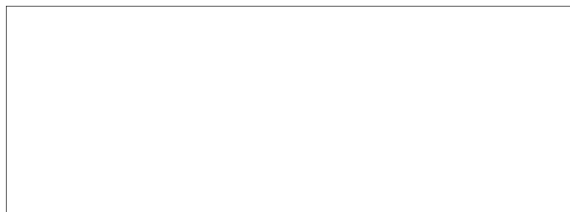

50X1-HUM

CONFIDENTIAL

CONFIDENTIAL

ENCLOSURE (A)



50X1-HUM

SKETCH OF THE IKA PLANT AREA

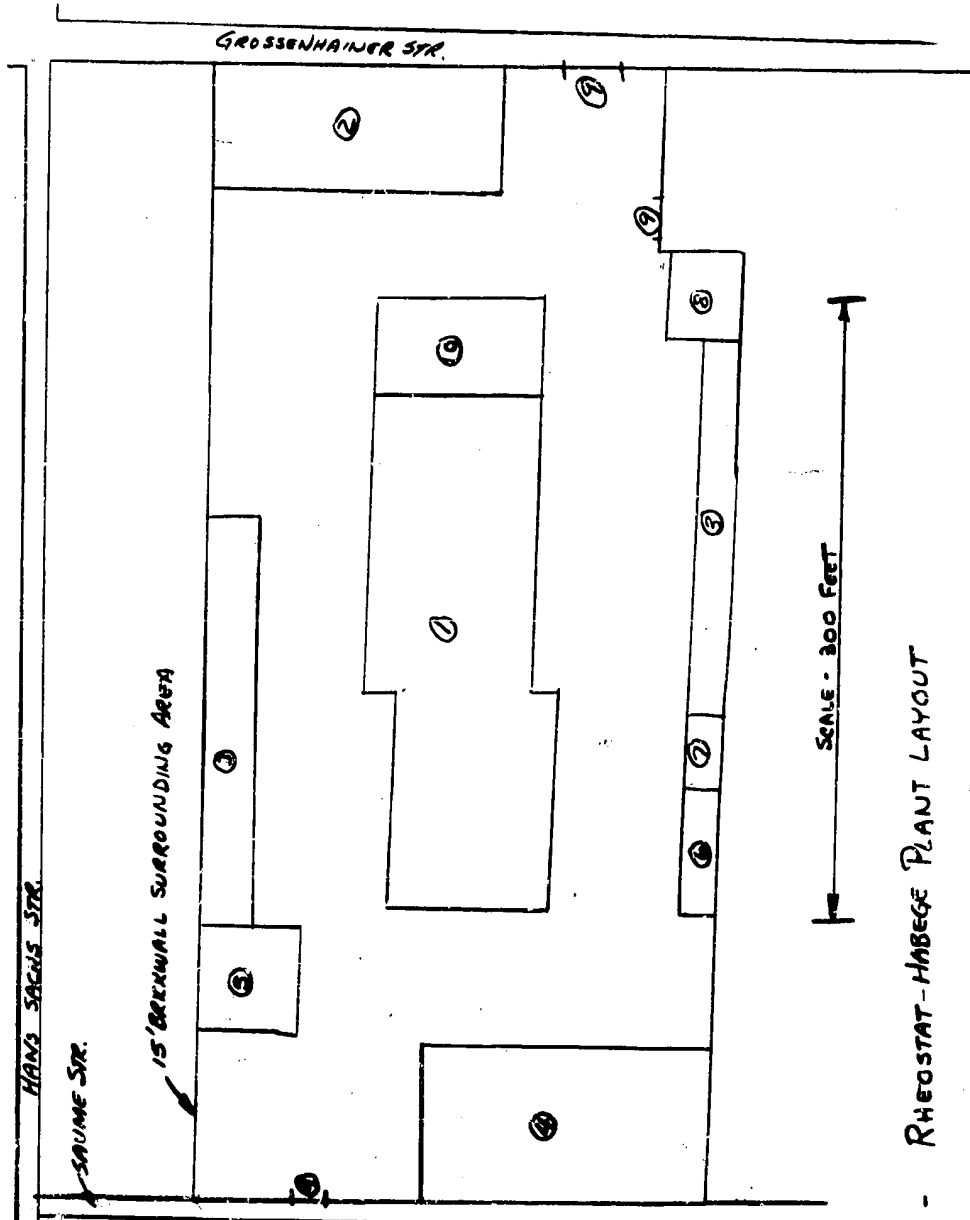

ENCL. A - RHEOSTAT-HABEGE PLANT LAYOUT

- 1. FACTORY - 3 FLOORS
- 2. OFFICES - 3 FLOORS
- 3. WARE HOUSES
- 4. CANTINA (RECREATION)
- 5. YOUTH MEETING ROOM
- 6. PLATING SHOP
- 7. BLACKSMITH SHOP
- 8. GARAGE
- 9. GATES
- 10. POWER PLANT - APPROX. 100 H

CONFIDENTIAL

50X1-HUM

ENCLOSURE (B)

CONFIDENTIAL

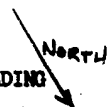

SKETCH OF THE LAYOUT OF THE IKA OFFICE BUILDING

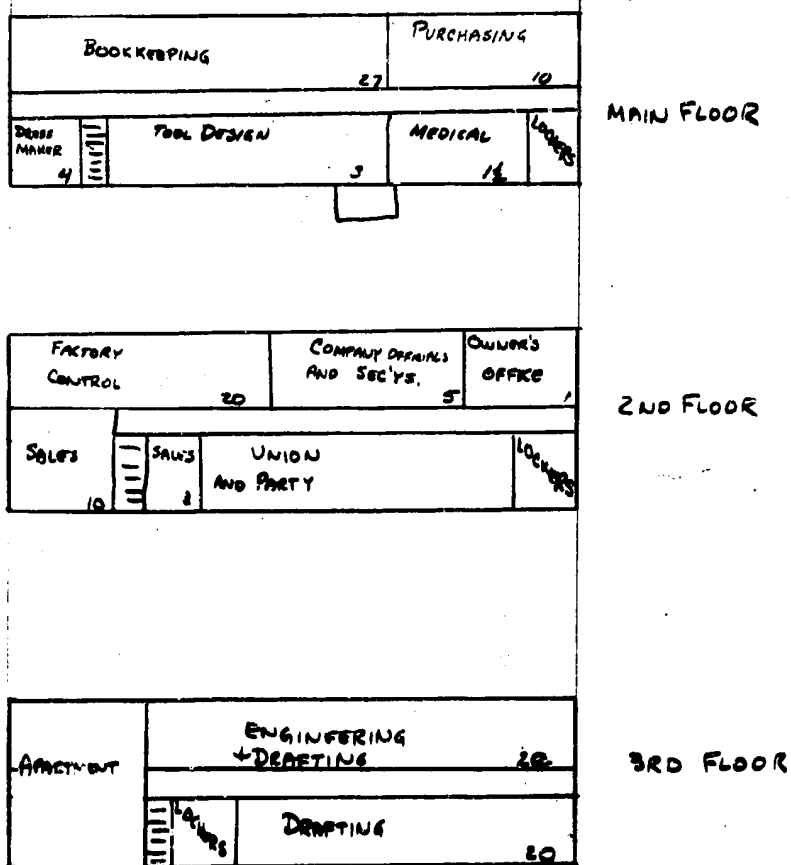

NUMBERS REFER TO THE
NUMBER OF PERSONNEL IN EACH
DEPARTMENT.

ENCL B - RHEOSTAT - HASSEGE
OFFICE BUILDING

CONFIDENTIAL

ENCLOSURE (C)

CONFIDENTIAL

50X1-HUM

SKETCH OF IKA FACTORY LAYOUT

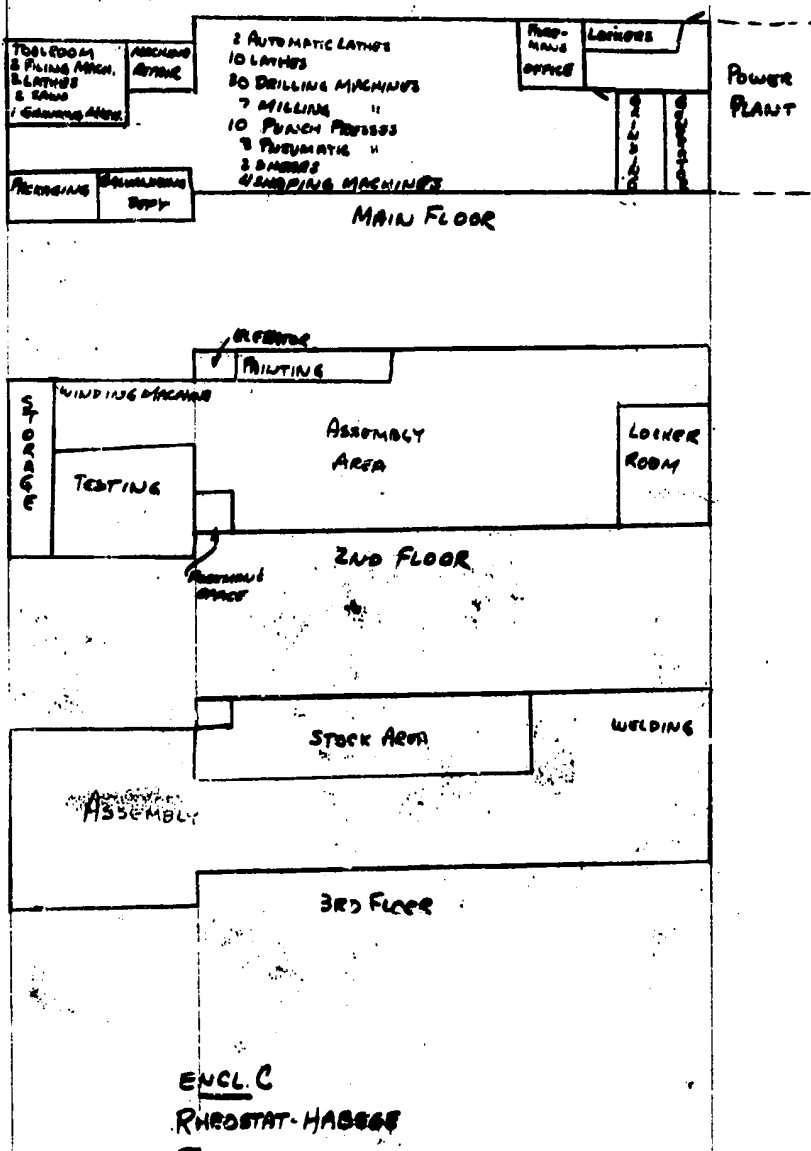

ENCL. C
RHODSTAT-HABEE
FACTORY LAYOUT

CONFIDENTIAL