

1. Separate power source
2. Desiccant drier - separate Coolant w/ expansion
3. Vacuum
4. Standby - Vac + air -
- 5.

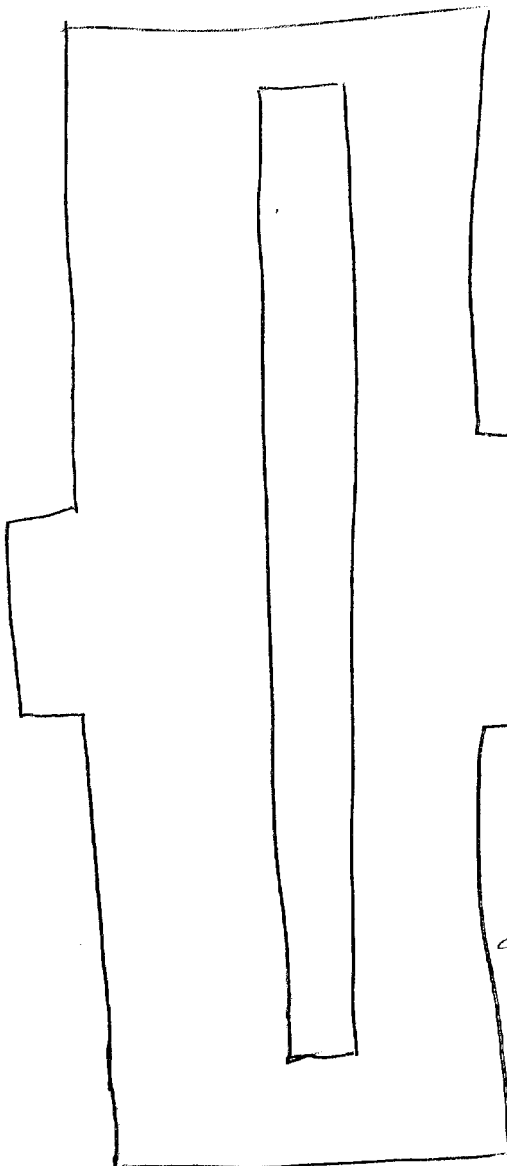

2 Refrig units
 2 Air chils
 1 Vac pump.

STATOTHR

Med anow or vac. Standby

from [redacted] to GSA.

17 Feb - Office of authorization w/ sub source - force + security.

1 Mar (2 wks) - specs drawn up & bid out by GSA. (doubtful + weeks)
 15 Mar - Award (2 weeks)
 15 Apr - shop drawings w/ approval
 2 approved - procurement ~~start~~
 begins. 6 week procurement cycle takes us to 1 June
 60 day installation makes 1 Aug. to complete.

GAS

1. Command structures to begin programming.
2. Bi-monthly reports
3. Form 1841 - Request for Contact Security Authorization - for each person used on installation & training. (4 mo in advance)
4. Vacuum - 80 cuft/minute @ 1 PSI.

Coolant ~~Atly the system - 42° @ 50% RH~~

8° Room variance in temperature

Area has 55% humidity ± 5%

Temp 8° var @ 68° OH
 Hum 55% ± 5% RH
 Vac 80 cuft/m @ 1 PSI

(3)
 Motors - 20x3" inlet
 Controls 20x14" inlet

{ Motors - 50° @ 700 cuft/minute
 40° @ 500 " "
 3 micron filtration -
 low rel hum air
 Air out of motors @ 19° C
 " " rack @ 30° C.

POUSTATOTHOV - 30A



~~spec was prepared~~

STATOTHR

Meeting - 13 Feb 64 - @ [redacted]

Attendees: - STATOTHR

- Logistics [redacted] ✓
- Bldg Engineers ✓
- Real Estate + Construction Div. (OL/RECD) ✓
- Commercial Design (Contractor)
- GSA Monitor ✓

STATOTHR

[redacted] ✓
Tech Rep ✓

1. Room requirements:

- Equipment locations ✓
- Power Outlet Requirements + locations (Ceiling Walls Floor)
- Room size, insulation, door + glass wall locations
- Coolant inlet stack locations } Floor inlet
- Exhaust stacks - rack } Ceiling walls floor
- Vacuum line locations

Sound Insulation - Booster Fan

2. Want to design complete system to satisfy requirements - permanent location - everything ready to install, hook-up, plug-in + operate.