

Approved For Release 2000/05/02 : CIA-RDP78-05867A000519110008-5
 PHOTO NO. 1141047
 DATE 13A 19 66
 MAP REFERENCE
 LATITUDE 0057N
 LONGITUDE 10634E

COUNTRY	PROVINCE WAC 9820							
AREA NO	10	SUBJECT Dm	SUBJECT D44	SUBJECT	SUBJECT	SUBJECT	SUBJECT	SUBJECT
P E L A B U H A N R A T U	5			10		15	B E A C H	
T R E E	25			30		35		40
	45			50				

25X1A

(2, 1, 1, C)



DATE OF PHOTO	TYPE	QUALITY	CLASS	NO. OF CARDS
Dec 63	4	2	3	2

CAPTIONED BY

Approved For Release 2000/05/02 : CIA-RDP78-05867A000519110008-5

Approved For Release 2000/05/02 : CIA-RDP78-05867A000519110008-5

COUNTRY		PROVINCE		LONGITUDE	
		WAC 982 D		10024E	
AREA NO	SUBJECT	SUBJECT	SUBJECT	SUBJECT	SUBJECT
1D	Dn	D4V	AKC	AKF	
PEL	5	HAN	10	15	20
LAB		RA			BEACH
TR	25	30	35	40	
E E E		BOAT		BLDG	
NET	45	50			
		REPAIRING			

25X1A

DATE OF PHOTO	TYPE	QUALITY	CLASS	NO. OF CARDS	SO
Dec 63	4	2	3	4	[REDACTED]
CLASSIFICATION			CAPTIONED BY		
Conf			[REDACTED]		

Approved For Release 2000/05/02 : CIA-RDP78-05867A000519110008-5

PHOTO ANALYSIS REPORT

PHOTO NO. *11110* Approved For Release 2000/05/02 : CIA-RDP78-05867A000519110008-5
 LOT NO. *2000/05/02* MAP REFERENCE *50910008-5* LATITUDE *106 58 E* LONGITUDE

COUNTRY _____ PROVINCE *WAC 982D*

AREA NO	SUBJECT	SUBJECT	SUBJECT	SUBJECT	SUBJECT	SUBJECT	SUBJECT	SUBJECT
<i>1D</i>	<i>5(9D)</i>							
<i>6 E D E</i>	<i>5</i>	<i>G U N U N G</i>	<i>10</i>			<i>15</i>	<i>V I E W</i>	<i>20</i>
<i>F M O</i>	<i>25</i>	<i>U N T A I N</i>	<i>30</i>			<i>35</i>		<i>40</i>
	<i>45</i>		<i>30</i>					

25X1A

DATE OF PHOTO	TYPE	QUALITY	CLASS	NO. OF CARDS	SO
<i>Apr 64</i>	<i>4</i>	<i>v</i>	<i>3</i>	<i>1</i>	

CLASSIFICATION *Conf* CAPTIONED BY *[Signature]*

PHOTO NO. **114E050** Approved For Release 2000/05/02 : CIA-RDP78-05867A000519110008-5

COUNTRY: [Blank] PROVINCE: **WAC 982D**

AREA NO	SUBJECT	SUBJECT	SUBJECT	SUBJECT	SUBJECT	SUBJECT	SUBJECT	SUBJECT
1D	5 (9D)							
6 E D E	5	G U N U N G	10			15	V I E W	20
F M O	25	U N T A I N	30			35		40
	45		50					

25X1A

DATE OF PHOTO	TYPE	QUALITY	CLASS	NO. OF CARDS
Apr 64	4	2	3	1

CLASSIFICATION: [Blank] CAPTIONED BY: [Blank]

PHOTO NO. **1141051** LOT NO. **2000705102** MAP REFERENCE **66 CIA-RDP78-05867A000519110008-5** LATITUDE **16 47 N** LONGITUDE **106 58 E**

COUNTRY _____ PROVINCE **WAR 982 D**

AREA NO	SUBJECT	SUBJECT	SUBJECT	SUBJECT	SUBJECT	SUBJECT	SUBJECT	SUBJECT
1 D	3 (D)							
6 E D E	5	G U N	10	U N G		15	T U	20
F M D	25	U N	30	T A	35	40	E W	40
	45		50					

25X1A

DATE OF PHOTO	TYPE	QUALITY	CLASS	NO. OF CARDS	SO
Apr 64	4	2	3	1	

CLASSIFICATION **Conf** CAPTIONED BY **[Signature]**

PHOTO NO. **141052** LOT NO. **2000/05/02** MAP REFERENCE **MS** LATITUDE **02° 10' 00" N** LONGITUDE **106° 57' E**
 Approved For Release 2000/05/02 : CIA-RDP78-05867A000519110008-5

COUNTRY _____ PROVINCE **WARREN**

AREA NO	SUBJECT	SUBJECT	SUBJECT	SUBJECT	SUBJECT	SUBJECT	SUBJECT	SUBJECT
1D	DOD	DET						
G E D E	⁵	G U N U N G	¹⁰		V I E W	¹⁵		²⁰
F M O	²⁵	N T A I N	³⁰		M U D	³⁵	O U T	⁴⁰
A S H	⁴⁵		⁵⁰					

25X1A

DATE OF PHOTO	TYPE	QUALITY	CLASS	NO. OF CARDS
Apr 64	4	✓	3	2



CLASSIFICATION **Conf** CAPTIONED BY **[Signature]**

PHOTO NO. *1111053* Approved For Release 2000/05/02 : CIA-RDP78-05867A000519110008-5
 MAP REFERENCE *1111053* LATITUDE *10° 10' N* LONGITUDE *106° 58' E*

COUNTRY _____ PROVINCE *WAR 982D*

AREA NO	SUBJECT	SUBJECT	SUBJECT	SUBJECT	SUBJECT	SUBJECT	SUBJECT	SUBJECT
<i>1D</i>	<i>DOD</i>							
<i>G E D E</i>	<i>5</i>	<i>G U N U N G</i>	<i>10</i>			<i>V I E W</i>	<i>20</i>	
<i>F M O U N T A I N</i>	<i>25</i>	<i>30</i>				<i>35</i>	<i>40</i>	
	<i>45</i>	<i>50</i>						

25X1A

DATE OF PHOTO	TYPE	QUALITY	CLASS	NO. OF CARDS
<i>June 64</i>	<i>4</i>	<i>✓</i>	<i>3</i>	<i>1</i>



CLASSIFICATION _____ CAPTIONED BY _____

Approved For Release 2000/05/02 : CIA-RDP78-05867A000519110008-5

PHOTO NO. 114105A REFERENCE 13119-67 LATITUDE 18658E

COUNTRY PROVINCE WAC 982D

AREA NO	SUBJECT	SUBJECT	SUBJECT	SUBJECT	SUBJECT	SUBJECT	SUBJECT	SUBJECT
10	DOD	DEF	ALL					20
5	G E D E	G U N	U N G					15
25	F M O U N T A I N	B G						35
45	F I C L D S	F G						40

25X1A

DATE OF PHOTO	TYPE	QUALITY	CLASS	NO. OF CARDS
June 64	4	2	3	3



Approved For Release 2000/05/02 : CIA-RDP78-05867A000519110008-5

PHOTO NO. 114106 *P 315766* APPROVED FOR RELEASE 2000/05/02 : CIA-RDP78-05867A000519110008-5 *80910* LATITUDE *107 36 E* LONGITUDE

COUNTRY _____ PROVINCE WAC 982D

AREA NO	SUBJECT	SUBJECT	SUBJECT	SUBJECT	SUBJECT	SUBJECT	SUBJECT	SUBJECT
<u>10</u>	<u>DED</u>	<u>DEF</u>	<u>AKU</u>					
<u>GU</u>	<u>UN</u>	<u>UN</u>	<u>NG</u>	<u>TAN</u>	<u>G</u>	<u>KU</u>	<u>BAN</u>	<u>PRAH</u>
<u>U</u>	<u>LK</u>	<u>G</u>	<u>F</u>	<u>R</u>	<u>O</u>	<u>EY</u>	<u>ON</u>	<u>D</u>
<u>BAN</u>	<u>G</u>	<u>T</u>	<u>W</u>	<u>D</u>	<u>S</u>	<u>M</u>	<u>T</u>	<u>(SC)</u>

25X1A

DATE OF PHOTO	TYPE	QUALITY	CLASS	NO. OF CARDS	SC
<u>Dec 68</u>	<u>4</u>	<u>2</u>	<u>3</u>	<u>3</u>	

CLASSIFICATION CONF CAPTIONED BY _____

PHOTO NO. **1141057** P 352764 2000/05/02 CIA-RDP78-05867A000519110008-5 LATITUDE 107 36 E LONGITUDE

COUNTRY	PROVINCE	SUBJECT	SUBJECT	SUBJECT	SUBJECT	SUBJECT	SUBJECT	SUBJECT
	WAC 982 D	DOS	Du					
1 D								
G U N U N G			T A N G K U B A W P R A H					
CP		(M T)	B E A C H					

25X1A



DATE OF PHOTO	TYPE	QUALITY	CLASS	NO. OF CARDS	CAPTIONED BY
June 6 4	4	2	3	2	

Approved For Release 2000/05/02 : CIA-RDP78-05867A000519110008-5

PHOTO ANALYSIS REPORT

Release 2000/05/02 : CIA-RDP78-05867A000519110008-5

PHOTO NO. 1141058

LONGITUDE 106 47 E

COUNTRY	PROVINCE	SUBJECT	SUBJECT	SUBJECT	SUBJECT	SUBJECT	SUBJECT	SUBJECT
	WAC 98vD							
AREA NO. 1D		SUBJECT D3L	SUBJECT D48	SUBJECT RKN				
B O G O R			K	10	I B U N		15	R A Y A
R I D G E				30	F O R E S T		35	R I V E R
				45				

25X1A

DATE OF PHOTO	TYPE	QUALITY	CLASS	NO. OF CARDS	SO
May 64	4	✓	3	3	
CAPTIONED BY					

Approved For Release 2000/05/02 : CIA-RDP78-05867A000519110008-5

PHOTO ANALYSIS REPORT

PHOTO NO. **1141059** Approved For Release 2000/05/02 : CIA-RDP78-05867A000519110008-5

COUNTRY: **INDONESIA** PROVINCE: **WAC 98x D**

AREA NO	SUBJECT	SUBJECT	SUBJECT	SUBJECT	SUBJECT	SUBJECT	SUBJECT	SUBJECT
10	CV6	AKU	C2G					
B O G O R	(N A)		10	F R U I T	15		V E N D	20
6 R	(F G)	[R D]	30	O C D G	35			40
			50					

25X1A

DATE OF PHOTO	TYPE	QUALITY	CLASS	NO. OF CARDS	SOURCE
6/6	4	2	3	3	[REDACTED]

CLASSIFICATION: **CONF** CAPTIONED BY: **[Signature]**

PHOTO NO. **1141060** Case 2000/05/02 CIA REP 78-05867A000519110008-5 LATITUDE **106 47 E**

AREA NO	SUBJECT	SUBJECT	SUBJECT	SUBJECT	SUBJECT	SUBJECT	SUBJECT	SUBJECT
1D	CR6	CR6						
B O G O R	(N R)		10	R A M B U T A N	15			20
E N D O R	(B C D G)		30		35			40
			45					

25X1A



DATE OF PHOTO	TYPE	QUALITY	CLASS	NO. OF CARDS	SOURCE
Early 66	4	2	3	2	

CLASSIFICATION Approved For Release 2000/05/02 : CIA REP 78-05867A000519110008-5

PHOTO ANALYSIS REPORT

Approved For Release 2000/05/02 : CIA-RDP78-05867A000519110008-5

PHOTO NO. 1141061
 COUNTRY [blank]
 PROVINCE WAC 982D
 LATITUDE [blank] LONGITUDE 10738E

AREA NO	SUBJECT	SUBJECT	SUBJECT	SUBJECT	SUBJECT	SUBJECT	SUBJECT	SUBJECT
10	D3A	841						
15	DA 60							
20								
25								
30								
35								
40								
45								

25X1A

(1929. C)



DATE OF PHOTO	TYPE	QUALITY	CLASS	NO. OF CARDS
Nov 63	4	✓	3	2

CAPTIONED BY [signature]

Approved For Release 2000/05/02 : CIA-RDP78-05867A000519110008-5

PHOTO ANALYSIS REPORT

PHOTO NO. **1141062** | REFERENCE NO. **2000/05/02** | CIA-RDP78-05867A000519110008-5 | LATITUDE **10° 34' E** | LONGITUDE **107° 34' E**
 AREA NO. **1D** | SUBJECT **D3A** | SUBJECT **D41** | PROVINCE **WAC 982D**

AREA NO.	SUBJECT	SUBJECT	SUBJECT	SUBJECT	SUBJECT	SUBJECT	SUBJECT	SUBJECT
DA 60	5	W U	10	D A G O	15	F A C C	20	
(F. K. E. S. 17)	25		30		35		40	
	45		50					

DATE OF PHOTO: **Nov 63** | TYPE: **4** | QUALITY: **2** | CLASS: **3** | NO. OF CARDS: **2**
 CAPTIONED BY: *[Signature]*

Approved For Release 2000/05/02 : CIA-RDP78-05867A000519110008-5
 PHOTO ANALYSIS REPORT

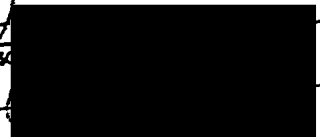

PHOTO NO. 1141063
 RELEASE 2000/05/02
 CIA-RDP78-05867A000519110008-5

AREA NO	SUBJECT	SUBJECT	SUBJECT	SUBJECT	SUBJECT	SUBJECT	SUBJECT	SUBJECT
10	DA 60	D3A	541					
15								
20								
25								
30								
35								
40								
45								

PROVINCE WAC 912D

25X1A

(18, 29, C)

DATE OF PHOTO	TYPE	QUALITY	CLASS	NO. OF CARDS
Nov 63	✓	✓	3	2



CLASSIFICATION Approved For Release 2000/05/02 : CIA-RDP78-05867A000519110008-5

Release 2000/05/02 : CIA-RDP78-05867A000519110008-5

PHOTO NO.	114106	PROVINCE	WAC 982D					LATITUDE	107 26 E	LONGITUDE
AREA NO.	1D	SUBJECT	AYC	AYZ	AG0					
	PURWA		KART							
	HUR		HE							
	GU		PT							

15 J A T A I L U
35 (-) B L D
40
50 OF 2-PT PANORAMA.
See CIA.

25X1A

(217. C)



DATE OF PHOTO	TYPE	QUALITY	CLASS	NO. OF CARDS	SOURCE
Mar-Apr 64	4	2	3	3	
CAPTIONED BY					

Approved For Release 2000/05/02 : CIA-RDP78-05867A000519110008-5

PHOTO ANALYSIS REPORT

PHOTO NO. 1141065
 AREA NO. 1D
 PROVINCE WAC 982D
 LATITUDE 000539110008-5
 LONGITUDE

AREA NO	SUBJECT	SUBJECT	SUBJECT	SUBJECT	SUBJECT	SUBJECT	SUBJECT	SUBJECT	SUBJECT
10	AYC	AYC	AYC						
5	PURWAKART								
15									
25	HURHE								
35									
45									
50									

6 UJ 45 PT 2 OF 2-PT PROGRAM
 See CIA

25X1A

DATE OF PHOTO	TYPE	QUALITY	CLASS	NO. OF CARDS	SO
Mar-Apr 64	4	2	3	3	

CLASSIFIED BY [Redacted]

PHOTO ANALYSIS REPORT

APPROVED FOR RELEASE 2000/05/02 : CIA-RDP78-05867A000519110008-5

PHOTO NO. 1141066	PROVINCE WAC 982 D	SUBJECT		SUBJECT		SUBJECT		SUBJECT		LONGITUDE 107 20
AREA NO. 10	SUBJECT AVC	SUBJECT AVC	SUBJECT AGD	SUBJECT ASJ	SUBJECT	SUBJECT	SUBJECT	SUBJECT	SUBJECT	
PURWA	AKA	RITA	D	JA	T	A	I	L	K	20
HUR	HE	PROJECT	-	REF						40
ERU	OR									50

25X1A

(1729, C)



DATE OF PHOTO	TYPE	QUALITY	CLASS	NO. OF CARDS	SOU
Mar-Apr 64	4	2	3	4	

APPROVED FOR RELEASE 2000/05/02 : CIA-RDP78-05867A000519110008-5

Approved For Release 2000/05/02 : CIA-RDP78-05867A00051910008-5

PHOTO NO. 1141067
 SUBJECT *Prisoner*
 PROVINCE *WAC 982D*
 LATITUDE *0659*
 LONGITUDE *10726E*

AREA NO	SUBJECT	SUBJECT	SUBJECT	SUBJECT	SUBJECT	SUBJECT	SUBJECT	SUBJECT
<i>ID</i>	<i>A4C</i>	<i>A4v</i>	<i>A60</i>	<i>A4J</i>				
<i>PUR</i>	<i>WAKAR</i>	<i>T A</i>			<i>D J A T</i>	<i>A I L U</i>		
<i>HUR</i>	<i>HE</i>	<i>P R O J E C T</i>				<i>-</i>	<i>R E F</i>	
<i>ERU</i>	<i>OR</i>							

25X1A

(17.4.0)



DATE OF PHOTO	TYPE	QUALITY	CLASS	NO. OF CARDS	SOURCE
<i>Mar-Apr 64</i>	<i>4</i>	<i>2</i>	<i>3</i>	<i>4</i>	

Approved For Release 2000/05/02 : CIA-RDP78-05867A00051910008-5

Approved For Release 2000/05/02 : CIA-RDP78-05867A000519110008-5

PHOTO NO. 1141068
 SUBJECT P38896
 LATITUDE 060519
 LONGITUDE 10726E

COUNTRY PROVINCE WAC 982D

AREA NO	SUBJECT	SUBJECT	SUBJECT	SUBJECT	SUBJECT	SUBJECT	SUBJECT	SUBJECT
1D	AYC	AY	AY	AY	AY	AY	AY	AY
PUR	WAK	KAR	TAR	TA				
HUR	HE	PR	O	J	E	C	T	
ER	V	O	I	R				

25X1A

(17.4. C)



DATE OF PHOTO	TYPE	QUALITY	CLASS	NO. OF CARDS	SC
Mar-Apr 64	4	2	3	4	

CLASSIFICATION Approved For Release 2000/05/02 : CIA-RDP78-05867A000519110008-5

PHOTO ANALYSIS REPORT

Approved For Release 2000/05/02 : CIA-RDP78-05867A000519110008-5

PHOTO NO. 1141069

LONGITUDE 10726 E

COUNTRY

PROVINCE WAC 9820

AREA NO	SUBJECT	SUBJECT	SUBJECT	SUBJECT	SUBJECT	SUBJECT	SUBJECT	SUBJECT
10	ATC	AT 2	AG 0	AKU				
5	PURWA	AKA	RTA		DISA	TAI	CU	20
25	HUR	HE	PRO	J	ECT	-	ACE	40
45	ESS	ROAD						

25X1A

(17.4. C)

DATE OF PHOTO	TYPE	QUALITY	CLASS	NO. OF CARDS	SOUR
Mar-Apr 64	4	4	3	4	

CAPTIONED BY

Approved For Release 2000/05/02 : CIA-RDP78-05867A000519110008-5

PHOTO ANALYSIS REPORT

Approved For Release 2000/05/02 : CIA-RDP78-05867A000519110008-5

PHOTO NO. 1141070
 SUBJECT P3K96L
 PROVINCE WAC 9MC
 LATITUDE 00° 51' N
 LONGITUDE 105° 20' E

AREA NO	SUBJECT	SUBJECT	SUBJECT	SUBJECT	SUBJECT	SUBJECT	SUBJECT	SUBJECT
10	D20	D48						
JUN	5	G K U L	10	N	P E N	15	I N	A U L A
	25	E O A F T	30	F O R E F T	35			
	45		50					

25X1A

(2, 11, C)



DATE OF PHOTO	TYPE	QUALITY	CLASS	NO. OF CARDS
Dec 63	f	2	3	2

Approved For Release 2000/05/02 : CIA-RDP78-05867A000519110008-5

Approved For Release 2000/05/02 : CIA-RDP78-05867A000519110008-5

PHOTO NO. 1141071

MAP REFERENCE

LATITUDE 105 20 E

COUNTRY

PROVINCE WAC 981C

AREA NO	SUBJECT	SUBJECT	SUBJECT	SUBJECT	SUBJECT	SUBJECT	SUBJECT	SUBJECT
10	D2V	D48						
15	JUN 5	G K U L	10	N	P E N	I N	F U L A	20
20			30		F O R E F T		D E A	40
25	F O A S T		35					
45			50					

DATE OF PHOTO	TYPE	QUALITY	CLASS	NO. OF CARDS
Dec 63	4	2	3	2

CLASSIFICATION

APPROVED FOR RELEASE 2000/05/02 : CIA-RDP78-05867A000519110008-5

CAPTIONED BY

25X1A

(2, 11, C)

PHOTO NO. **1141073** Approved For Release 2000/05/02 : CIA-RDP78-05867A000519110008-5
 LOT NO. **137572** MAP REFERENCE **WAC** LATITUDE **10 520 E** LONGITUDE

COUNTRY _____ PROVINCE **WAC 981 C**

AREA NO	SUBJECT	SUBJECT	SUBJECT	SUBJECT	SUBJECT	SUBJECT	SUBJECT	SUBJECT
10	NAV							
D	JUN	5	G K U L	10	ON	P E N I	N S U L A	20
	25	FOREST		30				40
	45			50				

(F.C.) 25X1A

DATE OF PHOTO	TYPE	QUALITY	CLASS	NO. OF CARDS	SOURCE
Dec 63	4	2	3	1	

CLASSIFICATION **Conf** CAPTIONED BY **[Signature]**

PHOTO NO. 141074 LOT NO. 2000/05/02 : CIA-RDP78-05867A000519110008-5 MAP REFERENCE 105 LATITUDE 10520E LONGITUDE 10520E

COUNTRY _____ PROVINCE WAC 981C

AREA NO	SUBJECT	SUBJECT	SUBJECT	SUBJECT	SUBJECT	SUBJECT	SUBJECT	SUBJECT	SUBJECT
<u>1D</u>	<u>DVA</u>	<u>DVA</u>							
<u>D</u>	<u>JUN</u>	<u>G K U L</u>	<u>ON</u>		<u>PEN</u>	<u>IN</u>	<u>S U L A</u>		
	<u>ET</u>	<u>REAM</u>			<u>FORE</u>	<u>S</u>			

25X1A

18.29.01

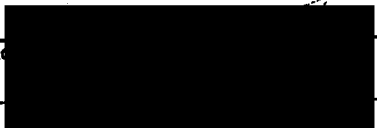
DATE OF PHOTO	TYPE	QUALITY	CLASS	NO. OF CARDS	SOURCE
<u>Dec 65</u>	<u>4</u>	<u>2</u>	<u>3</u>	<u>2</u>	

CLASSIFICATION Conf CAPTIONED BY [Signature]

PHOTO NO. **Approved For Release 2000/05/02 : CIA-RDP78-05867A000519110008-5** LOT NO. **1111075** MAP REFERENCE **7013** LATITUDE **8°09'N** LONGITUDE **105°20'E**

COUNTRY **INDONESIA** PROVINCE **WAC 981 C**

AREA NO	SUBJECT	SUBJECT	SUBJECT	SUBJECT	SUBJECT	SUBJECT	SUBJECT	SUBJECT
10	DW	B44						
D	J	U	N	5	G	K	U	10
				25	B	E	A	30
				45				50

25X1A

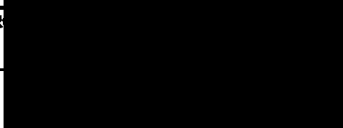
DATE OF PHOTO	TYPE	QUALITY	CLASS	NO. OF CARDS	SOUR
Dec 6 5	4	2	3	2	

CLASSIFICATION **Conf** CAPTIONED BY **[Signature]**

Approved For Release 2000/05/02 : CIA-RDP78-05867A000519110008-5

PHOTO NO. 1141076 *1-254-26* LATITUDE *11° 5'* LONGITUDE *107° 54' E*

COUNTRY PROVINCE *WAC 982D*

AREA NO	SUBJECT	SUBJECT	SUBJECT	SUBJECT	SUBJECT	SUBJECT	SUBJECT	SUBJECT	SUBJECT
<i>1D</i>	<i>CO 2</i>								
<i>N A G R E G</i>	<i>5</i>	<i>P O S I</i>	<i>10</i>			<i>15</i>	<i>M O S Q U E</i>		<i>20</i>
	<i>25</i>		<i>30</i>			<i>35</i>			<i>40</i>
	<i>45</i>		<i>50</i>						

25X1A

(7.10, C)



DATE OF PHOTO	TYPE	QUALITY	CLASS	NO. OF CARDS	SOURCE
<i>Early 65</i>	<i>4</i>	<i>2</i>	<i>3</i>	<i>1</i>	

CAPTIONED BY *[Signature]*

Approved For Release 2000/05/02 : CIA-RDP78-05867A000519110008-5

PHOTO NO. 1141078
 Release 2000/05/02 : CIA RDP78-05867A000519110008-5
 LATITUDE 10 10 15 E
 LONGITUDE 107 01 E

COUNTRY
 PROVINCE WAC 982D

AREA NO	SUBJECT	SUBJECT	SUBJECT	SUBJECT	SUBJECT	SUBJECT	SUBJECT	SUBJECT
1D	D48	D37						
TJ	IB	0	DA	10	E	RE	7	LA
KE				30				
				45				

25X1A

DATE OF PHOTO	TYPE	QUALITY	CLASS	NO. OF CARDS
Dec 63	4	2	3	2

CLASSIFIED BY [REDACTED] (18, 29 C) 7

Approved For Release 2000/05/02 : CIA RDP78-05867A000519110008-5

PHOTO ANALYSIS REPORT

PHOTO NO. **1141079** | Release 2000/05/02 | CIA-RDP78-05867A000519110008-5 | LONGITUDE **107015**

COUNTRY | PROVINCE **WAC 98VD**

AREA NO	SUBJECT	SUBJECT	SUBJECT	SUBJECT	SUBJECT	SUBJECT	SUBJECT	SUBJECT
1D	DUF	AKU						
7J	1B	0	0	10	15	20	25	30
AD								

25X1A

DATE OF PHOTO	TYPE	QUALITY	CLASS	NO. OF CARDS
Dec 63	4	2	3	2

CAPTIONED BY

Approved For Release 2000/05/02 : CIA-RDP78-05867A000519110008-5

PHOTO NO. **1141089** REFERENCE: 2000/05/02 : CIA-RDP78-05867A00051910008-5
 LATITUDE **08° 59' N** LONGITUDE **106° 59' E**

COUNTRY _____ PROVINCE **WAC 982D**

AREA NO	SUBJECT	SUBJECT	SUBJECT	SUBJECT	SUBJECT	SUBJECT	SUBJECT	SUBJECT
1D	DCB	ANM						
AUNT	JAK		10	TEA	E	15	X	T A T E
			30			35		
			45					

25X1A

(1. 24. C)



DATE OF PHOTO	TYPE	QUALITY	CLASS	NO. OF CARDS	SOURCE
16 Feb 66	4	✓	3	2	

CLASSIFICATION _____ CAPTIONED BY _____

PHOTO NO. 1141081
 DATE OF PHOTO 2000/05/02
 REFERENCE NO. P 3859-66
 FILE NO. CIA-RDP78-05867A000519110008-5
 LATITUDE 0513N
 LONGITUDE 10659E

COUNTRY	PROVINCE	SUBJECT	SUBJECT	SUBJECT	SUBJECT	SUBJECT	SUBJECT	SUBJECT
	WAC 982D	AKM	DOB	DOB	AKM			
AREA NO. 1D		AKM	DOB	DOB	AKM			
PUNT		JAK	(N)	(N)	TEA			
TE		TH	LL	S	(V)	LL	ET	

25X1A

(1.24.8. C)



DATE OF PHOTO	TYPE	QUALITY	CLASS	NO. OF CARDS	SOURCE
Dec 65 - Jan 66	4	2	3	4	

CLASSIFICATION Approved For Release 2000/05/02 : CIA-RDP78-05867A000519110008-5

PHOTO ANALYSIS REPORT

Approved For Release 2000/05/02 : CIA-RDP78-05867A000519110008-5

MAP REFERENCE

LATITUDE

LONGITUDE

PHOTO NO. 1141082

P 3834-24

CIA-RDP78-05867A000519110008-5

10654 E

AREA NO	SUBJECT	SUBJECT	SUBJECT	SUBJECT	SUBJECT	SUBJECT	SUBJECT	SUBJECT
1D	AKM	JOB	SOB	AKM				
P A N T	J A K	(N 2)			T E A		E E T A	20
T E	F H	U L	3		(V A	U L E T		40

PROVINCE WAC 982D

25X1A

(1.24 N.C)



DATE OF PHOTO	TYPE	QUALITY	CLASS	NO. OF CARDS	SOURCE
Dec 66	4	2	3	4	

Approved For Release 2000/05/02 : CIA-RDP78-05867A000519110008-5

PHOTO ANALYSIS REPORT

Approved For Release 2000/05/02 : CIA-RDP78-05867A000549110008-5

PHOTO NO. 1141083
 LATITUDE
 LONGITUDE

COUNTRY	PROVINCE	SUBJECT	SUBJECT	SUBJECT	SUBJECT	SUBJECT	SUBJECT	SUBJECT	SUBJECT
1D	WAC 982D	DCB	ANM						
MOUNT		JAK		10	TEA	E	15	T	A
				20					
				30	LD	G	35		
				40					
				45					

25X1A

(1.74. C)



DATE OF PHOTO	TYPE	QUALITY	CLASS	NO. OF CARDS	SOURCE
Sept. Jan 66	4	✓	3	2	

Approved For Release 2000/05/02 : CIA-RDP78-05867A000519110008-5

PHOTO ANALYSIS REPORT

PHOTO NO. 1141084
 Release 2000/05/02
 MAP REFERENCE CIA-RDP78-05867A00051910008-5
 LATITUDE 0513
 LONGITUDE 10008:510659E

AREA NO	SUBJECT	SUBJECT	SUBJECT	SUBJECT	SUBJECT	SUBJECT	SUBJECT	SUBJECT
1D	ANM	DOB	DOQ	AKU				
P4	5 JAK	(NM)			15 TEA		EST	20 A
TE	25 [HILLA]				35 (VALLEY)			40 RD]
	45							

PROVINCE WAC 982D

25X1A

(I. 24. 2. C)

DATE OF PHOTO	TYPE	QUALITY	CLASS	NO. OF CARDS	SOURCE
Dec 5 - Jan 6 6	4	2	3	4	[REDACTED]

Approved For Release 2000/05/02

CIA-RDP78-05867A000519110008-5

LONGITUDE

PHOTO NO. 1141085

PST 9-66

LATITUDE

106 59 E

COUNTRY

PROVINCE *WAC 9820*

AREA NO

ID

SUBJECT *AKU*

SUBJECT *AKY*

SUBJECT *CAF*

SUBJECT *DAV*

SUBJECT

SUBJECT

SUBJECT

SUBJECT

P. H. N. T.

J. A. K.

ROAD

REPAIR

WORK

25X1A

(8, 18, 21, C)



DATE OF PHOTO

TYPE

QUALITY

CLASS

NO. OF CARDS

SQU

Early 66

4 2

3

4

CAPTIONED BY

Cap

CLASSIFICATION

Approved For Release 2000/05/02

CIA-RDP78-05867A000519110008-5

GPO 871-245

FORM NO. 174 USE PREVIOUS EDITIONS

PHOTO ANALYSIS REPORT

PHOTO NO. **1141086** LOT NO. **2000/05/02** MAP REFERENCE **78-05867A000519110008-5** LONGITUDE **10516 E**

COUNTRY **PHILIPPINES** PROVINCE **WACAYIC**

AREA NO	SUBJECT	SUBJECT	SUBJECT	SUBJECT	SUBJECT	SUBJECT	SUBJECT	SUBJECT
1D	Dm	D23	D44					
P U L A U	5	A E U T	10	J A N I G	15	(B E A C	20	
H ,	25	B A Y ,	30	F O R C E & I	35		40	
	45		50					

25X1A

(2, 15, 3)

DATE OF PHOTO	TYPE	QUALITY	CLASS	NO. OF CARDS
Dec 63	4	2	3	3

CLASSIFICATION **Conf** CAPTIONED BY *[Signature]*

PHOTO NO. *1111087* Approved For Release 2000/05/02 : CIA-RDP78-05867A000519110008-5
 LATITUDE *10 44 N* LONGITUDE *105 16 E*

COUNTRY *LAOS* PROVINCE *WACAVIC*

AREA NO	SUBJECT	SUBJECT	SUBJECT	SUBJECT	SUBJECT	SUBJECT	SUBJECT	SUBJECT
<i>1D</i>	<i>D22</i>	<i>D23</i>	<i>D44</i>					
<i>PULLAU</i>	<i>5</i>	<i>A E U T</i>	<i>J A N G</i>	<i>10</i>	<i>15</i>	<i>(B E A C</i>	<i>20</i>	
<i>H, B</i>	<i>25</i>	<i>A Y</i>	<i>F O R E F</i>	<i>30</i>	<i>35</i>	<i>A</i>	<i>40</i>	
	<i>45</i>			<i>50</i>				

25X1A

(2, 1, C)



DATE OF PHOTO	TYPE	QUALITY	CLASS	NO. OF CARDS	SC
<i>Dec 63</i>	<i>4</i>	<i>2</i>	<i>3</i>	<i>3</i>	

CLASSIFICATION *Conf* CAPTIONED BY *[Signature]*

PHOTO NO. **1141088** Approved For Release 2000/05/02 : CIA-RDP78-05867A000519110008-5
 MAP REFERENCE **PHU LAU** LATITUDE **16° 15' N** LONGITUDE **105° 16' E**

COUNTRY **LAOS** PROVINCE **WACAPIC**

AREA NO	SUBJECT	SUBJECT	SUBJECT	SUBJECT	SUBJECT	SUBJECT	SUBJECT	SUBJECT
1D	D22	D23	D24					
PHU LAU	5	A E U T	J A N G	10	15	(B. C. A. C.)	20	
H	25	B A Y	F O R C E	30	35	(B. C. A. C.)	40	
	45			50				

25X1A

(2, 1, 1)

DATE OF PHOTO	TYPE	QUALITY	CLASS	NO. OF CARDS	SC
Dec 63	4	2	3	3	

CLASSIFICATION **Conf** CAPTIONED BY **[Signature]**
 Approved For Release 2000/05/02 : CIA-RDP78-05867A000519110008-5
 FORM NO. 174 USE PREVIOUS EDITIONS PHOTO ANALYSIS REPORT GPO 871-245

PHOTO NO. 1141089
 LOT NO. P213966
 RELEASE 2000/05/02
 CIA-RDP78-05867A000519110008-5
 LATITUDE 100085
 LONGITUDE 105105

COUNTRY
 PROVINCE WAC 981 C

AREA NO	SUBJECT	SUBJECT	SUBJECT	SUBJECT	SUBJECT	SUBJECT	SUBJECT	SUBJECT
10	C28	B44						
	15							20
PULAU	5	PIEU	10	TJ	AN	G		40
E.	25	FORES	30					
	45		50					

25X1A

(ZIEC)



DATE OF PHOTO	TYPE	QUALITY	CLASS	NO. OF CARDS	SO
Dec 63	4	2	3	2	

CLASSIFICATION Approved For Release 2000/05/02 : CIA-RDP78-05867A000519110008-5

PHOTO ANALYSIS REPORT

PHOTO NO. 1141090 LOT NO. 2000/05/02
 MAP REFERENCE A000519110008-5 LATITUDE 05 24 N LONGITUDE 105 24 E
 COUNTRY Approved For Release 2000/05/02 : CIA-RDP78-05867A000519110008-5 PROVINCE WAC 981C

AREA NO	SUBJECT	SUBJECT	SUBJECT	SUBJECT	SUBJECT	SUBJECT	SUBJECT	SUBJECT	SUBJECT
1D	DVC								
PULAU	5	SER	10	TUNG	15	VIEW	20		
OF	25	ISLAND	30	PT	35	OF	40		
PT	45	PANORAMA	50						

See CIA

25X1A

DATE OF PHOTO	TYPE	QUALITY	CLASS	NO. OF CARDS	SO
Dec 63	42	3	1		

CLASSIFICATION Conf CAPTIONED BY [Signature]

PHOTO NO. 1141091
 RELEASE 2000/05/02 : CIA-RDP78-05867A000519110008-5
 LATITUDE 02 25 N
 LONGITUDE 105 25 E

COUNTRY	PROVINCE WAC 9PIC									
AREA NO	1D	SUBJECT	SUBJECT	SUBJECT	SUBJECT	SUBJECT	SUBJECT	SUBJECT	SUBJECT	SUBJECT
		DVC							15	VIEW
	PULAU								35	2 OF 2
	OF								40	
	-PT								50	

See CIA

→ Anuk Krakatau (center)

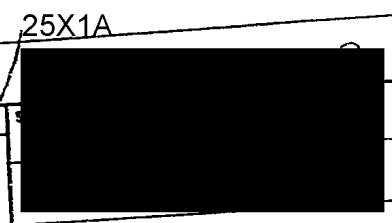

DATE OF PHOTO	TYPE	QUALITY	CLASS	NO. OF CARDS
Dec 63	42	3	1	
CAPTIONED BY				

Approved For Release 2000/05/02 : CIA-RDP78-05867A000519110008-5

Approved For Release 2000/05/02 : CIA-RDP78-05867A000519110008-5

PHOTO NO. 1141092 P3857-66

COUNTRY [] PROVINCE WAC 981C

AREA NO. 1D SUBJECT DEL SUBJECT D4V SUBJECT [] SUBJECT [] SUBJECT [] SUBJECT [] SUBJECT [] SUBJECT [] SUBJECT [] SUBJECT []

H	A	N	D	5	E	U	L	E	U	M	10	I	S	L	A	N	D	15	20
E	A	C	H	25	F	O	R	E	S	T	30							35	40
				45							50								

25X1A

(2,18,C)

DATE OF PHOTO	TYPE	QUALITY	CLASS	NO. OF CARDS	SOURCE
Dec 63	4	2	3	2	[REDACTED]

CAPTIONED BY [Signature]

PHOTO NO. 1141093
 DATE 2000/05/02
 CIA REF ID: A660519110008-5
 LOT NO. P315966

AREA NO	SUBJECT	SUBJECT	SUBJECT	SUBJECT	SUBJECT	SUBJECT	SUBJECT	SUBJECT
ID	DLV	D44						
HAND	5	E U	10	LE U M		15	ISLAND	20
EACH	25		30			35		40
	45		50					

PROVINCE WAC 981C

25X1A

DATE OF PHOTO	TYPE	QUALITY	CLASS	NO. OF CARDS	SO
Dec 63	4	2	3	2	

PHOTO NO. **1141094** Approved For Release 2000/05/02 : CIA-RDP78-05867A000519110008-5
 MAP REFERENCE **115198** LATITUDE **19 35** LONGITUDE **105 24 E**

COUNTRY _____ PROVINCE **WAR 951C**

AREA NO	SUBJECT	SUBJECT	SUBJECT	SUBJECT	SUBJECT	SUBJECT	SUBJECT	SUBJECT
ID	D44	D48						
HA ND	5	EU	10	LE U M	15	IS L	20	AN D.
E A C H	25	F	30	OR	35	E S	40	7
	45		50					

25X1A

DATE OF PHOTO	TYPE	QUALITY	CLASS	NO. OF CARDS	SC
Dec 63	4	2	3	2	

CLASSIFICATION **Conf** CAPTIONED BY **[Signature]**

PHOTO NO. 1141095
 LOT NO. P3159/06
 APPROVED FOR RELEASE 2000/05/02 : CIA-RDP78-05867A000519110008-5
 LATITUDE 05 10 58
 LONGITUDE 105 24 E

COUNTRY	PROVINCE	SUBJECT	SUBJECT	SUBJECT	SUBJECT	SUBJECT	SUBJECT	SUBJECT
	WALYALIC							
AREA NO. 1D		SUBJECT 548						
HAND		EU	LEUM			15	CAN	10
NEW		OF	18	30	LAW	35	EU	40
		FOR	ET	50				

25X1A

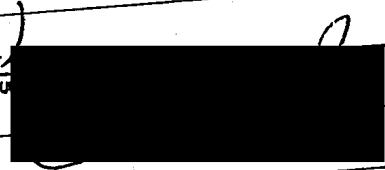

DATE OF PHOTO	TYPE	QUALITY	CLASS	NO. OF CARDS	SOURCE
Dec 63	4	2	3	2	

CAPTIONED BY [Signature]

APPROVED FOR RELEASE 2000/05/02 : CIA-RDP78-05867A000519110008-5

PHOTO ANALYSIS REPORT

Release 2000/05/02 : CIA-RDP78-05867A000519110008-5

PHOTO NO. 1141096

PROVINCE WACAPIC

LONGITUDE 102°46'E

AREA NO	SUBJECT	SUBJECT	SUBJECT	SUBJECT	SUBJECT	SUBJECT	SUBJECT	SUBJECT
10	ONE	ONE						
15	HAND	EU	LEUM			ISLAND		10
20	OR	ENT				CENTER	OF	10
25	SLAND							10

25X1A

DATE OF PHOTO	TYPE	QUALITY	CLASS	NO. OF CARDS	SO
Dec 63	4	2	3	2	

CLASSIFIED BY [REDACTED]

APPROVED FOR RELEASE 2000/05/02 : CIA-RDP78-05867A000519110008-5

FORM NO. 174 USE PREVIOUS EDITIONS

PHOTO ANALYSIS REPORT

GPO 871-248